

WIRING SCHEMATIC

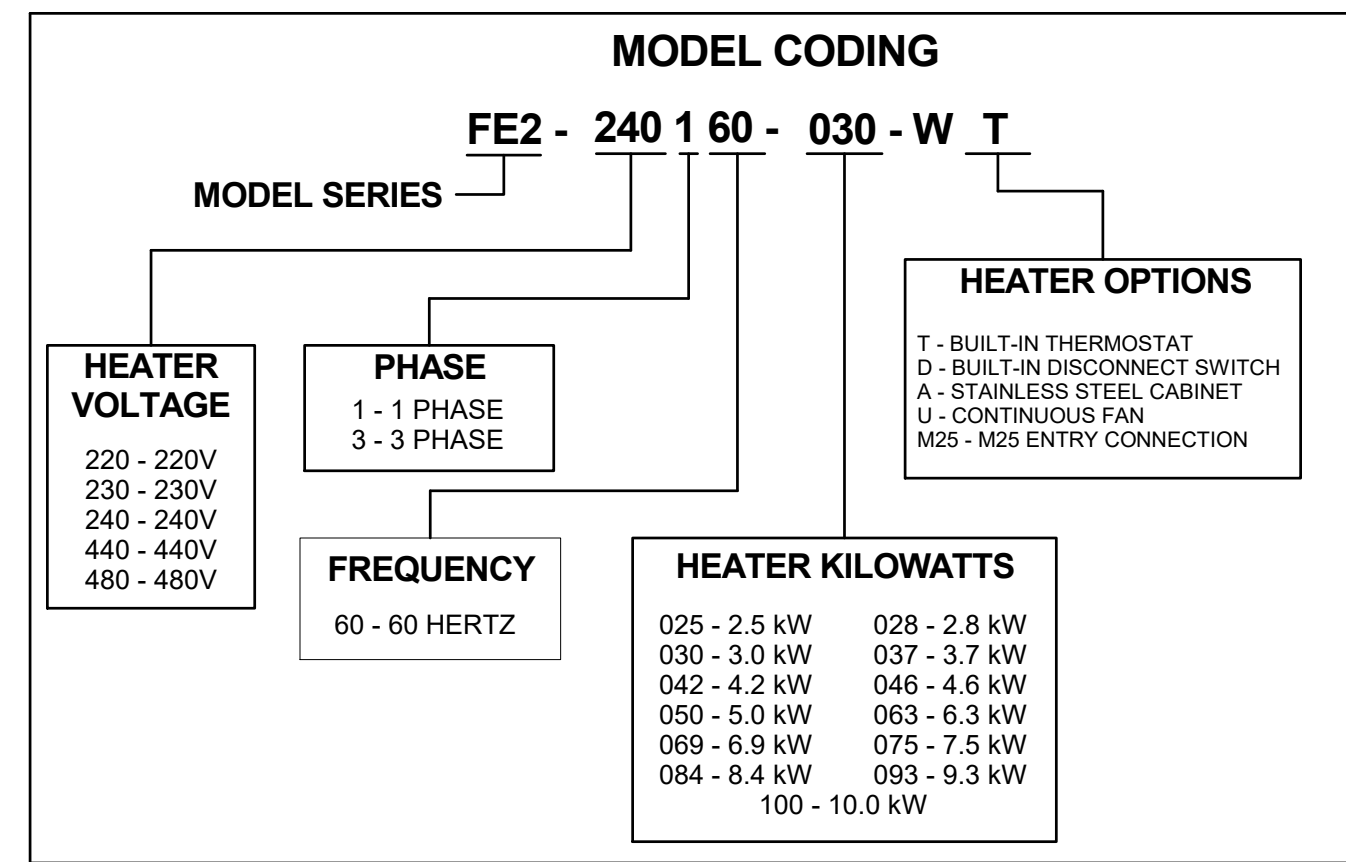
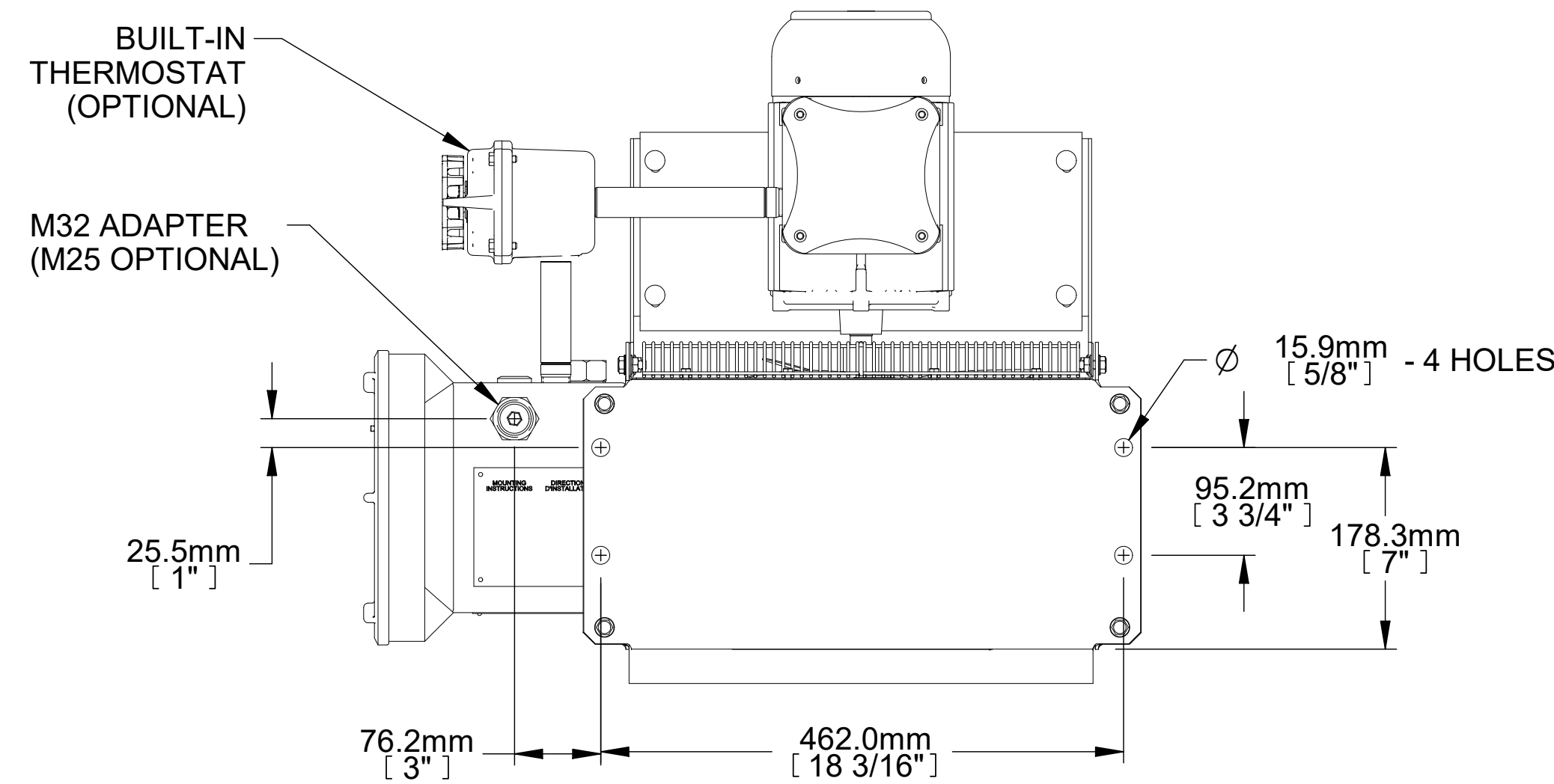

TABLE 1 - TECHNICAL DATA (60HZ)

| MODEL          | OUTPUT (kW) | VOLTAGE (VOLTS) | FREQ. (Hz) | PHASE | CURRENT (AMPS) | AIR FLOW (M <sup>3</sup> /HR) @ 21°C |
|----------------|-------------|-----------------|------------|-------|----------------|--------------------------------------|
| FE2-220160-025 | 2.5         | 220             | 60         | 1     | 11.4           | 861                                  |
| FE2-220160-042 | 4.2         |                 |            |       | 11.1           |                                      |
| FE2-220160-063 | 6.3         |                 |            |       | 28.6           |                                      |
| FE2-220160-084 | 8.4         | 38.2            |            |       | 1465           |                                      |
| FE2-230160-028 | 2.8         | 12.0            |            |       |                |                                      |
| FE2-230160-046 | 4.6         | 20.0            |            |       | 866            |                                      |
| FE2-230160-069 | 6.9         | 29.9            |            | 1472  |                |                                      |
| FE2-230160-092 | 9.2         | 39.9            |            |       |                |                                      |
| FE2-240160-030 | 3.0         | 240             |            | 1     | 12.4           | 860                                  |
| FE2-240160-050 | 5.0         |                 |            |       | 20.8           |                                      |
| FE2-240160-075 | 7.5         |                 |            |       | 31.2           |                                      |
| FE2-240160-100 | 10.0        | 41.7            |            |       | 1462           |                                      |
| FE2-440360-042 | 4.2         | 440             | 3          |       |                | 5.5                                  |
| FE2-440360-084 | 8.4         |                 |            |       | 11.0           | 1325                                 |
| FE2-480360-030 | 3.0         | 480             |            | 3.6   | 815            |                                      |
| FE2-480360-050 | 5.0         |                 |            | 6.0   |                |                                      |
| FE2-480360-075 | 7.5         |                 |            | 9.0   |                |                                      |
| FE2-480360-100 | 10.0        |                 |            | 12.0  | 1386           |                                      |



**NOTES:**

- NET WEIGHT: 79 KG
- SHIPPING WEIGHT: 103 KG
- OPERATING AMBIENT TEMP: -20° TO +40°C  
-50° TO +40°C FOR SUFFIX "B" UNITS
- HAZARDOUS LOCATION CLASSIFICATION: Ex II 2 G Ex d IIB T3 Gb
- TEMPERATURE CLASS: T3 200°C
- MATERIALS: CABINET: 12 GA. EPOXY POWDER COATED RUFFNECK GREEN  
CORE: STEEL WITH INTEGRAL ALUMINUM FINs
- CERTIFIED TO:  
EN 60079-0:2012+A11:2013  
EN 60079-1:2007

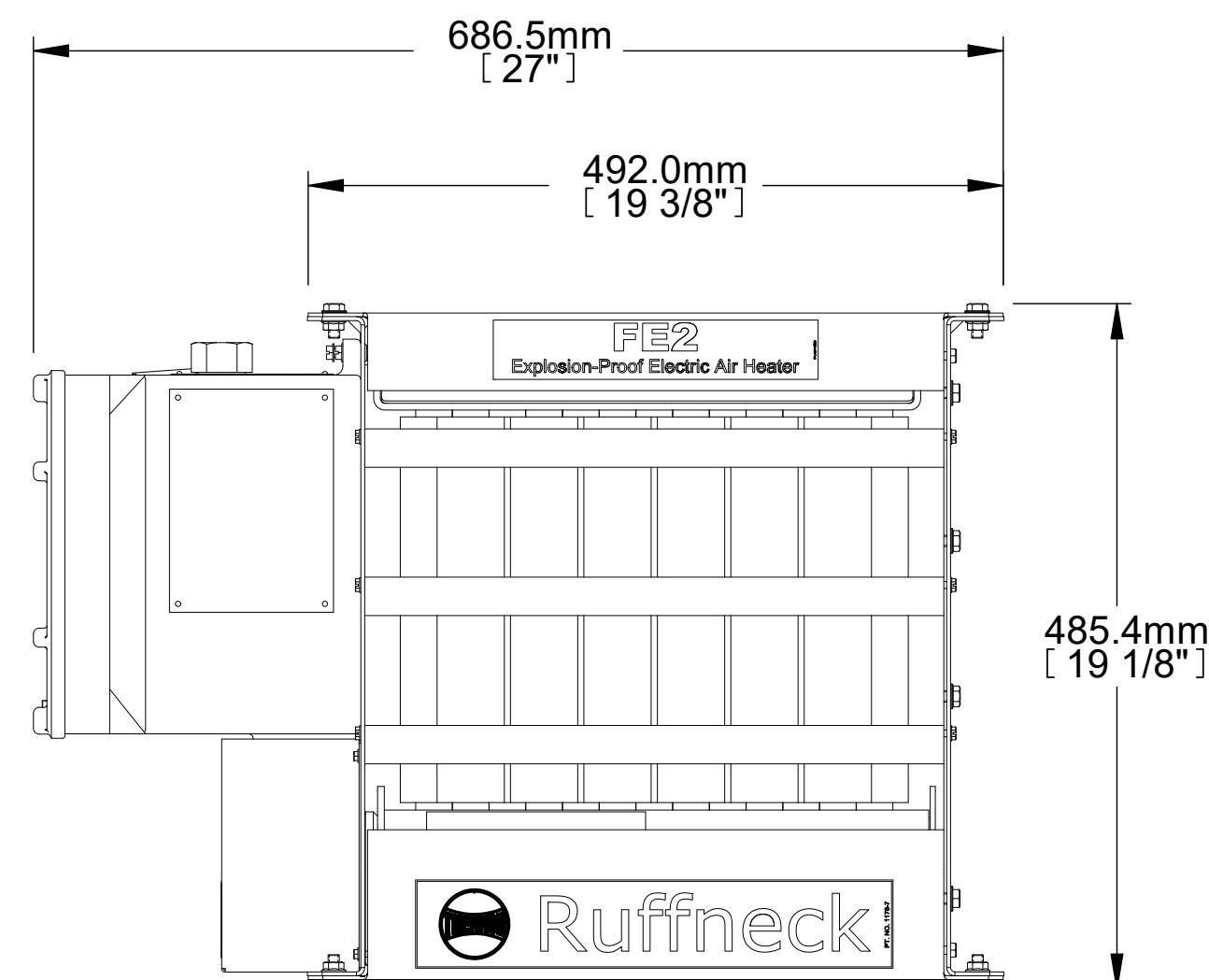
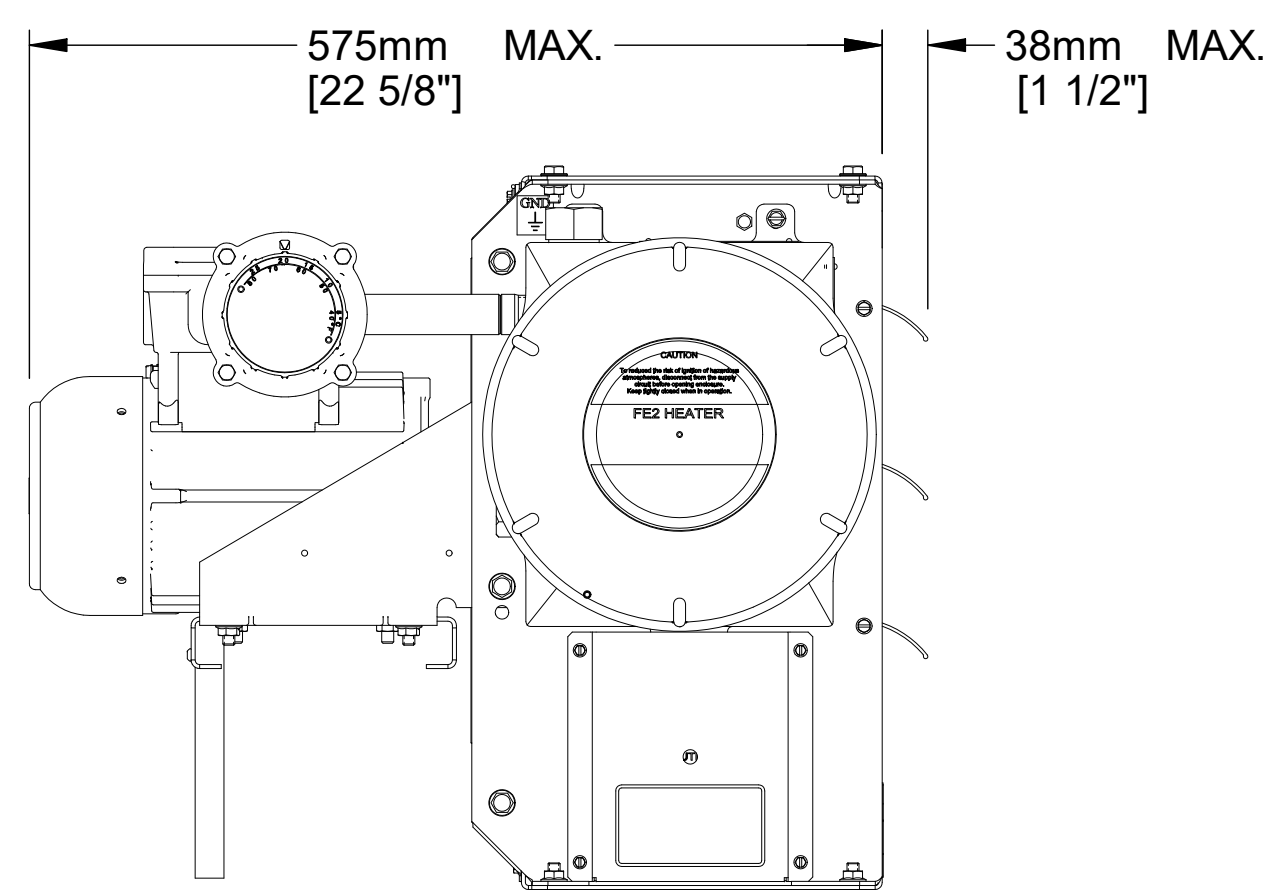

| REV.   | REVISION DESCRIPTION | DATE                             | BY            |
|--|----------------------|----------------------------------|---------------|
| TITLE: FE2 RUFFNECK HEATER DATA SHEET<br>2.5 - 10.0 kW @ 60 Hz |                      |                                  |               |
| DWG NO.: 51922-D SHEET: 2 OF 2                                 |                      | TOLERANCE UNLESS NOTED OTHERWISE |               |
| SYTLINE NO.: N/A   |                      | ± 1/2" ANGULAR                   | ± N/A DECIMAL |
| SCALE: NONE  |                      | ± 1/8" FRACTIONAL                | ± 3 mm METRIC |
| DRN BY: nsanchez   |                      | 09 May 2016                      |               |
| CHK'D BY:  |                      |                                  |               |
| APP'D. BY:   |                      |                                  |               |

