



SPECIFICATIONS

Product Description: **BLOWER**
 Part Number: **9518-20, 9518-24**
 Style: **20" (50.8 cm) and 24" (60.9 cm) PNEUMATIC JET FAN**

GENERAL DESCRIPTION:

When operated, compressed air is pushed through a nozzle at the tip of each fan blade, which propels the fan at high speeds creating up to 11,000 CFM (18,689 m3/hr) at 80 psig inlet pressure quickly and efficiently. The unit's flange is designed to fit standard API tank openings. These units can be used as blowers or exhausters, by simply reverse mounting. These blowers are easily transported from one place to another by using its recessed carry handles, or it may be rolled.



CONSTRUCTION:

- Heavy duty aluminum fan and fan housing
- Spark-resistant
- Heavy duty ball bearings (permanently lubricated and sealed for the life of the product)
- Stainless steel fan shaft eliminates internal rust
- 3/4" (1.9 cm) NPT side mount inlet connector for 20" model, 1" (2.54 cm) NPT for 24" model
- OSHA standard safety screens

Size	Inlet Pressure (PSIG)	Air Consumption (SCFM)	CFM at Given Static Pressure (in Wg) <i>(measured in inches of water)</i>				
			0"	1"	2"	3"	4"
20" (50.8 cm)	40 (2.8 Bar)	125 (212 m3/hr)	7000 (11893 m3/hr)	4500 (7645 m3/hr)	2500 (4247 m3/hr)	1050 (1784 m3/hr)	--
	60 (4.1 Bar)	160 (272 m3/hr)	9500 (16140 m3/hr)	7200 (12233 m3/hr)	5150 (8750 m3/hr)	3450 (5862 m3/hr)	2100 (3568 m3/hr)
	80 (5.6 Bar)	210 (357 m3/hr)	11000 (18689 m3/hr)	9250 (15715 m3/hr)	7500 (12743 m3/hr)	5750 (9770 m3/hr)	4400 (7475 m3/hr)
24" (60.9 cm)	40 (2.8 Bar)	230 (391 m3/hr)	11500 (19538 m3/hr)	9000 (15291 m3/hr)	5200 (8834 m3/hr)	3400 (5776 m3/hr)	--
	60 (4.1 Bar)	324 (551 m3/hr)	14500 (24635 m3/hr)	12500 (21237 m3/hr)	10100 (17160 m3/hr)	7800 (13252 m3/hr)	5650 (9599 m3/hr)
	80 (5.6 Bar)	400 (680 m3/hr)	16900 (28713 m3/hr)	14200 (24125 m3/hr)	11000 (18689 m3/hr)	9500 (16140 m3/hr)	7200 (12232 m3/hr)

Dimensions		
	20" (50.8 cm)	24" (60.9 cm)
A	20.125" (51.1 cm)	24.25" (61.6 cm)
B	22.5" (57.1 cm) (BC)	30.25" (76.8 cm)
C	9.875" (25.1 cm)	11.75" (29.8 cm)
D	24.75" (62.8 cm)	32.75" (83.2 cm)
E	1" (2.8 cm)	1.125" (2.8 cm)
F	75 lbs. (34 kg)	165 lbs. (74.8 kg)

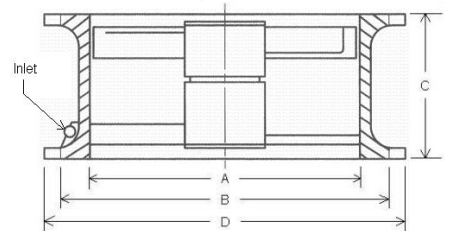
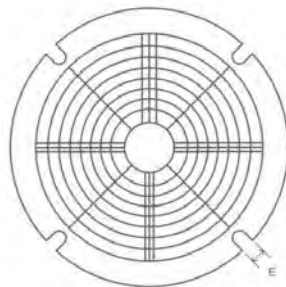

A – Internal Diameter B – Bolt Circle C – Height D – Outer Diameter E – Butterworth (Flange)

NOTE: Maximum operating air pressure is 100 psig. Temp of compressed air should not exceed 200F. Units are NOT designed to run on steam!