

Model 6HK16

Portable Heat Pump

Submittal Data



SD-6HK16-2

STANDARD FEATURES

- 16,800 Btu Cooling Capacity
- 18,500 Btu Heating Capacity
- Spot-Cool / Room-Cool Thermostat Settings
- Internally Insulated with Fiberglass Insulation
- Thermostatic Control with Multi-Speed Fan
- Double Shaft Motor for Two Fans
- R410A Refrigerant
- Optional Easy Install Condensate Pump Kit with Overflow Protection
- 115V/1 Phase
- Directional Nozzles (2)
- Heavy Duty Twin Wheel Casters for Portability
- Auto Fan Speed Option
- Self-Diagnostic Function
- Off-Timer
- Washable Filters
- 12" Hot Air Exhaust Flange

SAFETY DEVICES

- Compressor Overload Protection
- Anti-freezing Thermistor
- Automatic Restart (Power Interruption)
- Compressor Time Delay Program
- High Pressure Sensor & Low Pressure Sensor

SPECIFICATIONS

Model Number	6HK16
Cooling Capacity	16,800 Btu/hr
Heating Capacity	18,500 Btu/hr
Cooling Test Conditions	95°F
Voltage/Phase/Hz	115/1/60
Amperage	16
Fuse Size	20 Amps*
LCDI Plug Configuration	NEMA 5-20P
Power Cord Length	6'
Refrigerant Type	R410A
Dimensions	49"H x 24"W x 30"D
Net Weight	230 Lbs
Shipping Weight	251 Lbs
Condensate Tank Capacity	3.17 Gal

*Time delay fuses and circuit breakers are recommended



ADDITIONAL SPECIFICATIONS

Ambient Temperature Range (Heating)	54-77°F
Ambient Temperature Range (Cooling)	64-113°F
Setting Temperature (In Temp Mode)	Cooling 64-113°F Heating 64-113°F Auto 70-113°F
Setting Temperature (Out Temp Mode)	Cooling 32°F Heating 122°F Auto 70-113°F
Application Area Ft ² (Room Cool Mode)	355
Refrigerant Type / Ounces	R410A / 44.8
Design Pressure High/Low	465 / 160 PSIG
Indoor Air Flow	470 CFM
Hot Air Duct Diameter	12"
Maximum Exhaust Duct Length	50'
Condenser Air Flow	890 CFM
FLA	15.5 Amps
Max Duct Length: Cold Air Supply	45 ft.
Max Duct Length: Hot Air Discharge	50 ft.
Duct Connection Hot Air Discharge	12 in.
Drain Type	Bucket (4 gal.)



260 North Elm St.
Westfield, MA 01085
Phone: 413-564-5520
Fax: 413-564-5815
www.Koldwave.com

Project: _____ Date: _____

Location: _____

Customer: _____

Engineer: _____

Submitted By: _____

For: Reference Approval Construction

Unit Designation: _____

Schedule Number: _____

Model 6HK16-Submittal Data

CONTROL PANEL

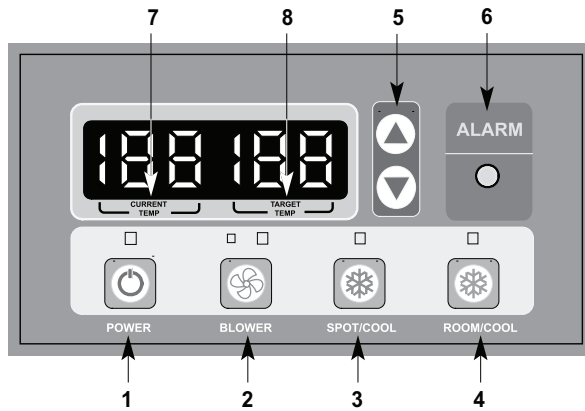

Control Panel Key Buttons:

1. Power
2. Blower
3. Spot/Cool
4. Room/Cool
5. Set Temperature
6. Alarm
7. Current Temperature
8. Target Temperature

COMPONENT PARTS

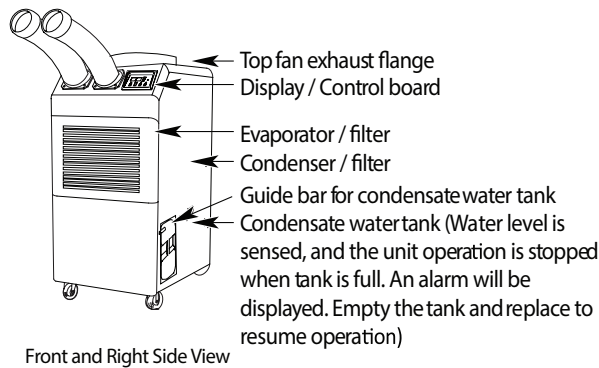

Front and Right Side View

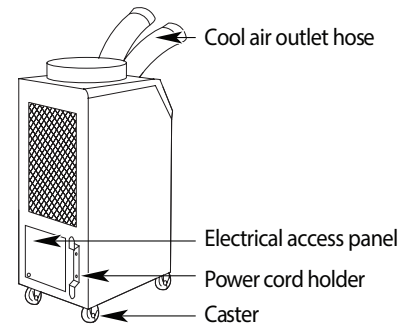

Back and Left Side View

DIMENSIONS (In Inches)

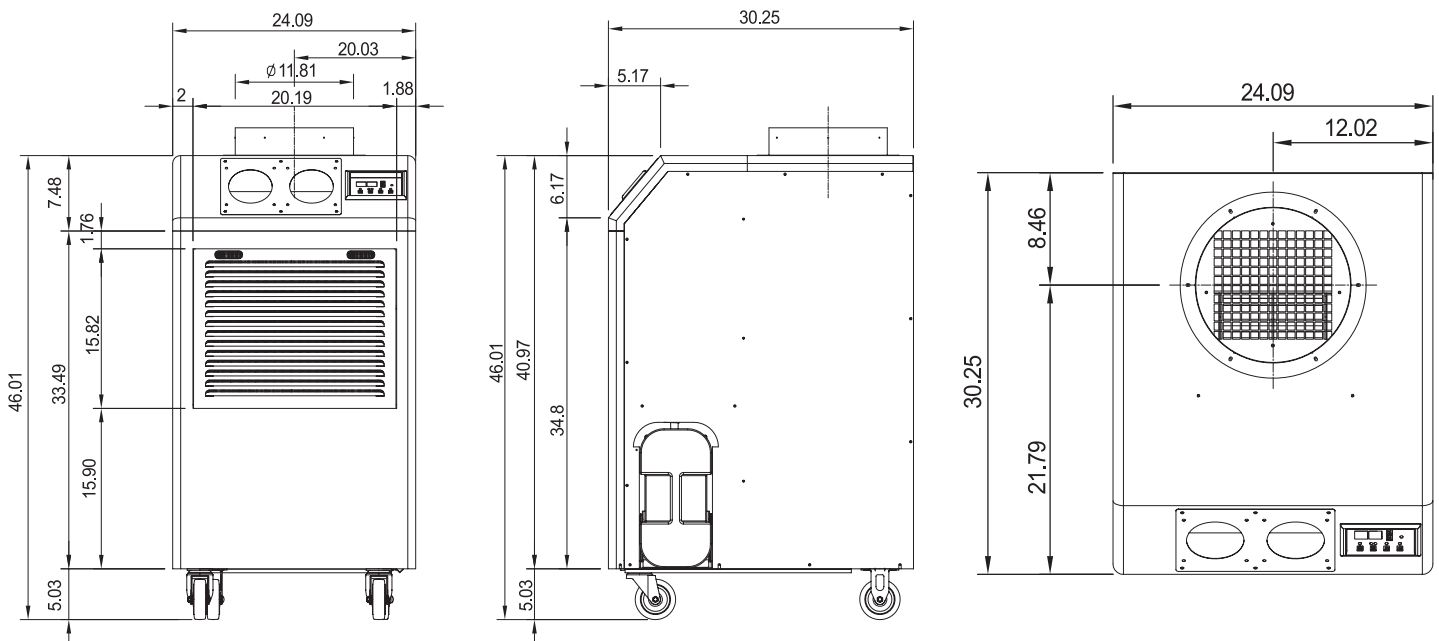

ASSEMBLY

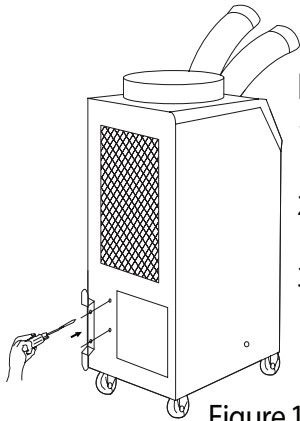

Figure 1

POWER CORD HOLDER

1. Take out the cord holder from the accessory box.
2. Place the cord holder on the back side of the unit
3. Use screws (enclosed inside of accessory box with cord holder) to install the cord holder on the air conditioner as shown in Figure 1.

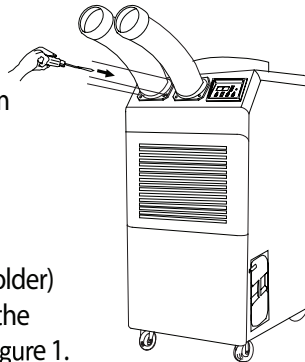

Figure 2

DISCHARGE DUCTS/SUPPLY AIR DUCT

1. Remove cool air outlet hose(s) from carton.
2. Place the cool air outlet hose(s) on the front top of the unit
3. Use screws (enclosed inside of box with cool air outlet hose(s) to install the cool air outlet hose(s) on the unit as shown in Figure 2.

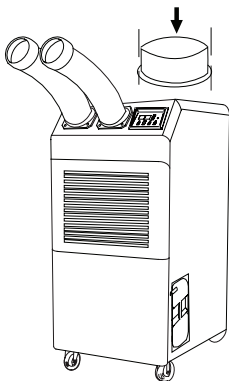

Figure 3

TOP FAN EXHAUST FLANGE

1. Remove the top fan exhaust flange from carton.
2. Place the top fan exhaust flange on the top of the unit.
3. Use screws (enclosed inside of box with the top fan exhaust flange) to install the top fan exhaust flange on the unit as shown in Figure 3.

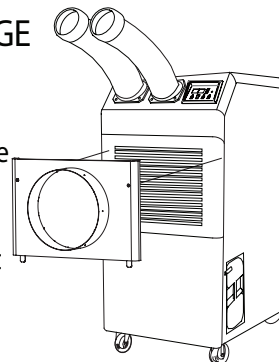

Figure 4

EVAPORATOR PLENUM (Optional)

An evaporator plenum can be purchased separately. Plenum fits over the evaporator to duct evaporator air to the unit to improve cooling efficiency.

1. Remove the evaporator cover from the unit.
2. Remove the filter from the evaporator cover and put it into the plenum.
3. Install the plenum in front of the evaporator.

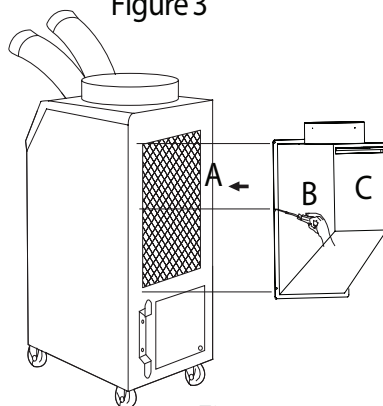

Figure 5

CONDENSER PLENUM (Optional)

Condenser plenum can be purchased separately. Condenser plenum fits over the condenser to duct condenser air to the unit to improve cooling efficiency

1. Remove the Filter("A")
2. Check the Filter("C") is inserted properly in Condenser plenum("B")
3. Install "B" which contains "C" by using driver with enclosed bolts (6ea.) as Figure 5.

Accessory Parts

Part Name	Part Number
Condensate pump kit (115V)	SA057-0072
Condenser plenum/return air adapter	SA076-4018
Remote Controller (26 ft with line)	SA076-4006
16 FT Temperature Sensor	SA076-4007
Cool air duct connecting flange (D5", L3")	SA076-4008
Long cool air duct assembly (D5", L40")	SA076-4009
Condenser return/discharge kit	SA076-3635
Replacement washable filter, evaporator	KWPCFLT-07E
Replacement washable filter, condenser	KWPCFLT-08C