



clearwater
LIGHTS™



Installation Manual

KTM 1290 Super Adventure

Krista/Erica/Sevina LED Light Kit

Dimmable

Patent Pending



Made in USA

Step 1: Parts List and Bike Preparation

Please be sure to read our instructions thoroughly before attempting installation.

- Check Parts list below with your kit to be sure all parts are handy. If something is missing, please call us at (916) 852-7029.

E-K 74 - 1290SA (2015-2016), 1290SA T (2017+), 1190A Crash Bar Kit 21-22mm (2013-2016)

2 KristalEicaSerina Lights



2 Mod Bracket

B7Z1 - KES UNIVERSAL HARNESS BAG / KES Wiring Harness



B709 - KES POT BAG:



1 Pot Assembly



B8Z1 - KES CONNECTION BAG

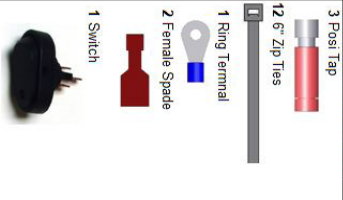

B151 - HARDWARE BAG

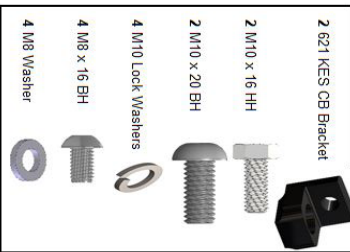

2 621 KES CB Bracket

2 M10 x 16 HH

2 M10 x 20 BH

4 M10 Lock Washers

4 M8 x 16 BH

4 M8 Washer

B67 - BRACKET BAG

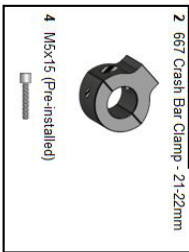

2 667 Crash Bar Clamp - 21-22mm

4 M5x15 (Pre-installed)

B7Z1 - KES KTM CONNECTION BAG

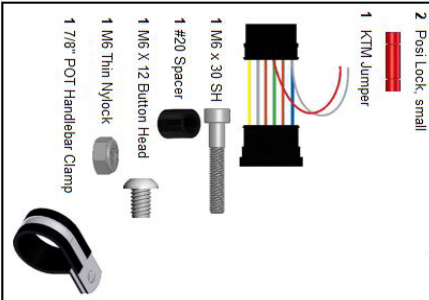

2 Post Lock, small

1 KTM Jumper

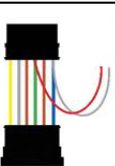

1 M6 x 30 SH

1 #20 Spacer

1 M6 X 12 Button Head

1 M6 Thin Nylock

1 7/8" POT Handlebar Clamp

Last updated: 6/15/20

Step 1: Parts List and Bike Preparation

Please be sure to read our instructions thoroughly before attempting installation.

- Check Parts list below with your kit to be sure all parts are handy. If

****NOTE****

This page is for the 1290 Super Adventure R only

E-K 74b - 1290 Super Adventure R, S Crash Bar Clamp 21-22mm (2017+)

2 Kristal/Fractal/Sawma Lights

2 Mod Bracket



B7Z1 - KES UNIVERSAL HARNESS BAG

KES Wiring Harness



B709 - KES POT BAG:

1 Pot Assembly



1 M6 x 10 BH

1 Plastic Plug

1 M5 x 30 SH

1 L Bracket

1 Spacer #7

1 M5 Flat Washer

BB21 - KES CONNECTION BAG



3 Post Tap

12 6" Zip Ties

1 Ring Terminal

2 Female Spade

1 Switch

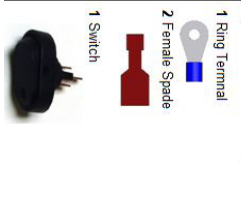

B151 - HARDWARE BAG

2 621 KES CB Bracket

2 M10 x 16 HH

2 M10 x 20 BH

4 M10 Lock Washers

4 M8 x 16 BH

4 M8 Washer

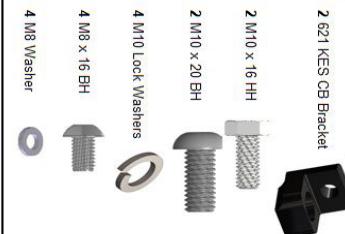

B718 - KITM 1290 SA R CONNECTION BAG

1 Jumper Plug



2 Post lock

1 M6 x 30 SH

1 #20 Spacer

1 M6 X 12 Button Head

1 M6 Thin Nylock

1 7/8" POT Handlebar Clamp



BB7 - BRACKET BAG

2 667 Crash Bar Clamp - 21-22mm



4 M5X15 (Pre-installed)



Last updated: 6/15/20

Step 1: Parts List & Bike Preparation

Bike Preparation:

- First, park the motorcycle on hard pavement or concrete to insure the bike will be stable during the installation. If you can mount the bike on a stand with tie-down straps, this will help secure the motorcycle.
- Follow the manufacturers guidelines for disconnecting the battery. This is important to prevent damage to the electrical system.

Erica / Krista / Sevina Technical:

Erica / Krista / Sevina are very bright LED auxiliary lights. Do not use these with oncoming traffic present unless the dimmer is turned down all the way. Krista / Erica / Sevina are designed as off road only light's due to the powerful light output and specific beam pattern they boast. The wide circular pattern is very useful on mountain roads when on a motorcycle, as it keeps light on the road and in the tree canopy. As the bike leans, lights are still focused on the road. Be certain to use the lights in a manner that does not blind oncoming traffic.

Erica / Krista / Sevina can also be used in a "low" beam mode and a "high" beam mode. The factory handlebar high beam switch is used to select the two different Erica / Krista / Sevina modes.

Krista light output is about 3000+ lumens each light while only using 35 watts of power. Erica light output is 6000+ lumens each light while using about 60 watts of power. Sevina commands 7000+ lumens each light using about 70 watts of power. Erica / Krista / Sevina are easy to install and have many, many uses.

Installation Tips:

There are two main parts to the installation of your new Clearwater Lights. The mechanical portion, and the electrical portion. With this manual, we will go over the basics of both which should allow you to get your lights up and running. If you purchased a bracket made specifically for your bike, refer to our manuals online for that specific installation at:

www.clearwaterlights.com

Note: Motorcycle needs to be turned on before the lights will function.

Step 2: Mounting The Lights / Crash Bar Mount

Mounting The Lights: (Crash Bar)

Mounting the Lights to the Crash Bar is very simple. Pre-assemble the lights, and mounting bracket loosely with the supplied parts. Locate where you would like the light to be pointing and the orientation of either on top or hanging below the bar. Snug the bolts on the clamp so you can now adjust the alignment of your lights.



Pro Tip: A drop of blue loctite can be used on the M8 and M10 bolts so they won't come



Step 2: Mounting The Lights / Fender Mount (Adding Darlas)

Mounting The Lights: (Fender Mount) - OPTIONAL Darlas

Clearwater Lights comes with an assortment of stainless steel bolts that can allow a variety of installations. Pre-assemble the lights, mounting bracket, shoulder washers and spacers with new bolts. Gently screw all bolts in hand tight. Inspect the bolt length and spacer alignment before tightening the bolts.

This location is only for Darla lights.

D74/G74 Fender Kit

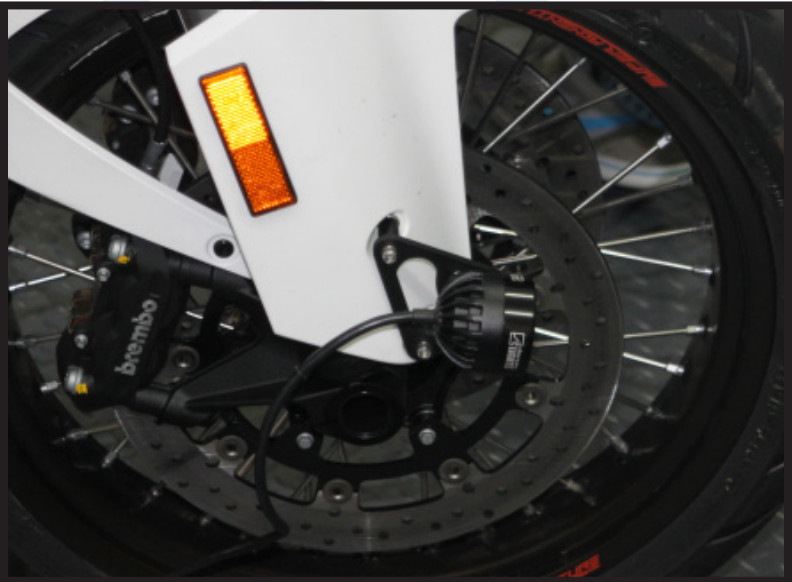
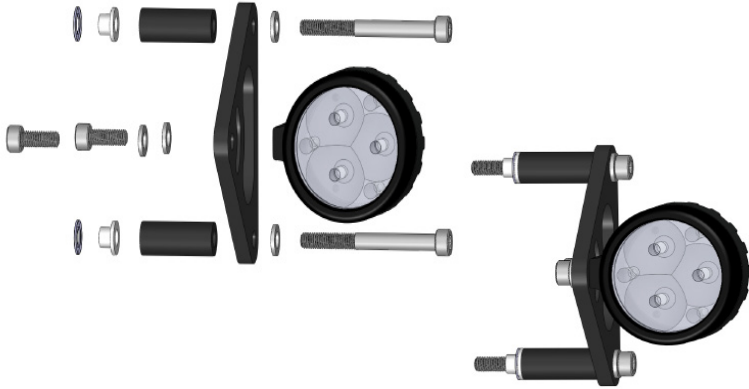

Step 3: Disassembly

Disassembly

Step 1. Remove windshield (T30 x 4)

Step 2. Remove windshield bracket (T30 x 4)

Step 3. Remove side covers (T30 x 3)

Disconnect fog lights

Step 4. Remove tank cover (T30 x 5) and (8mm bolt x 2)

Step 2

Bolt Location

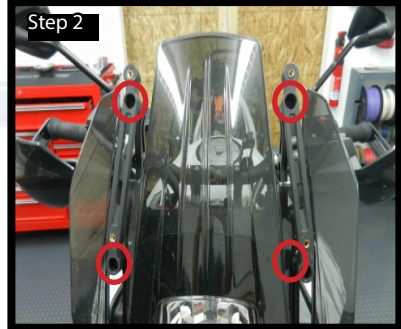
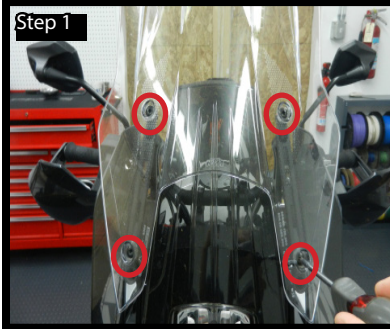

Step 3. This bolt must be removed before the side covers can be removed.

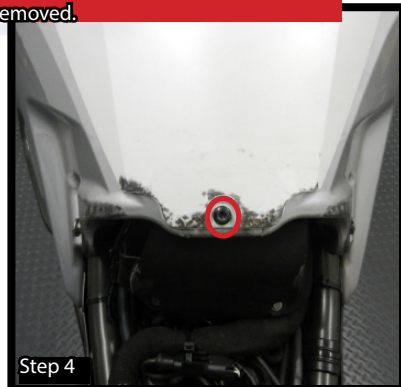
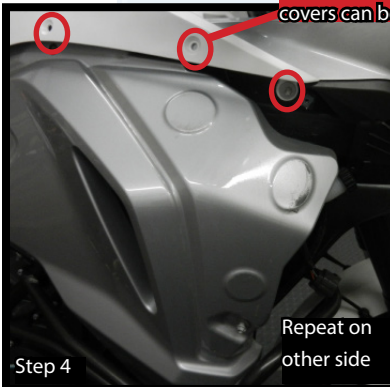

Step 3: Disassembly

Disassembly

Step 5. Remove turn signal covers (T30 x 2) Make note that these bolts are longer than the rest

Step 6. Remove headlight (T30 x 4) Disconnect headlight connector, this is the connector that is going to have the jumper in between

Step 7. Remove undercover (T30 x 6)

Fender Mount Only - Step 8. Remove fender bolts (T30 x 4)

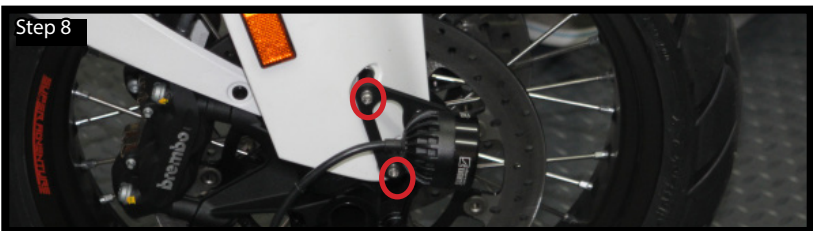
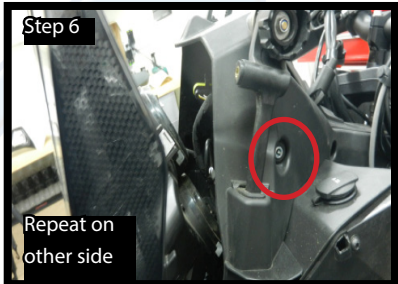
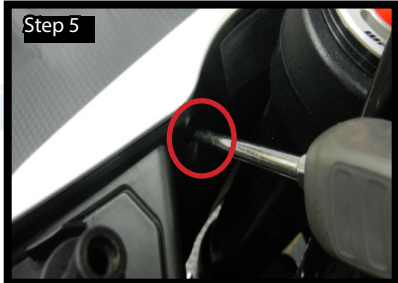
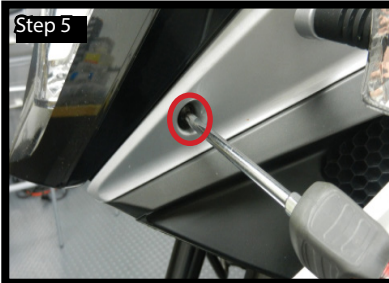

Step 3: Disassembly

****NOTE****

This page is for the 1290 Super Adventure R only

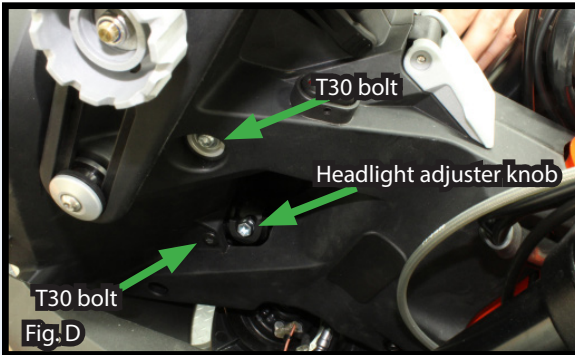

The headlight assembly is also held down by the bolts shown above in (Fig. D). Remove the top torx bolt (shown above on the left, but also on the right), the lower torx bolt, and the headlight adjuster knob.



With the appropriate headlight bolts removed, Carefully pull the headlight assembly out, exposing the cavity underneath (Fig. E). Be sure to unplug connector from the back of the headlight assembly.

Step 4: Wiring (KTM w/NON-LED HEADLIGHT)

Wiring:

- We highly recommend you take a minute to review the wiring diagram below before starting the wiring portion of the installation. Once you feel comfortable with the information below you are ready to begin the electrical portion of the installation. Be sure to keep this diagram handy to reference throughout the installation.

KTM 1290 Krista/Erica/Sevina (KTM w/NON LED HEADLIGHT)

Headlight Jumper Kit: Plug the female connector into your Headlight and then plug the stock connector into the supplied male end.

Horn Option: use a posi-tap to connect the other white wire to the horn hot.

Switch: Connect the Yellow wire marked "Switch Load" to the "load" terminal (Middle terminal) on the switch. Connect the Red wire marked "12V+ to switch" to the "supply" terminal (Opposite side of the LED light terminal) on the switch. Connect the Black wire marked "Ground" to the "earth" terminal (Under the LED light terminal) on the switch.

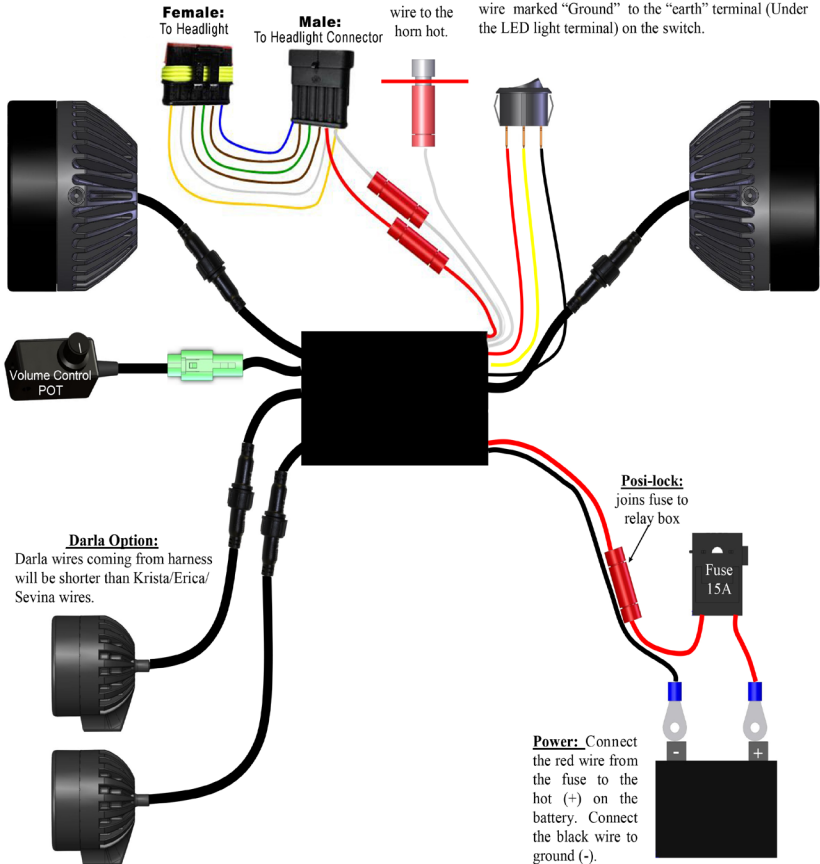

0/3/2010

Step 4: Wiring (SUPER ADV R, 2017+ w/LED HEADLIGHT)

****NOTE****
This page is for the 1290 Super Adventure R only

KTM 1290 SA R Krista/Erica/Sevina (2017+ KTM w/LED HEADLIGHT)

Headlight Jumper Kit: Plug the female connector into your Headlight and then plug the stock connector into the supplied male end.

Horn Option: use a posi-tap to connect the other white wire to the horn hot.

Switch: Connect the Yellow wire marked "Switch Load" to the "load" terminal (Middle terminal) on the switch. Connect the Red wire marked "12V+ to switch" to the "supply" terminal (Opposite side of the LED light terminal) on the switch. Connect the Black wire marked "Ground" to the "earth" terminal (Under the LED light terminal) on the switch.

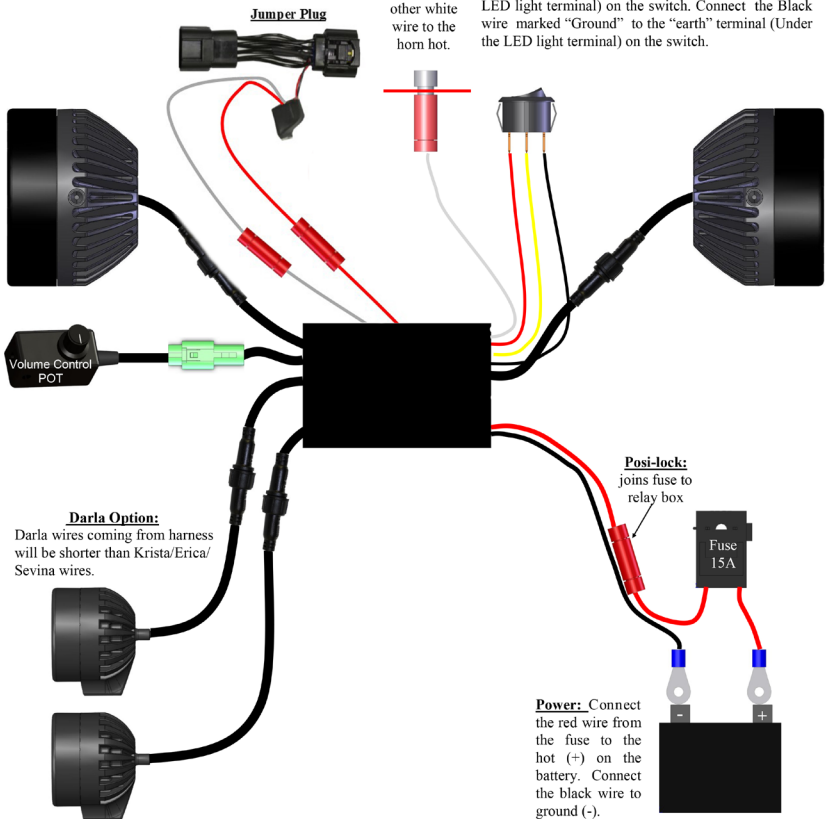

8/3/2018

Step 4: Wiring

Mounting The Control Knob: (Bar Mount)

- Mount the Volume Control Knob to handlebar by using supplied bracket and bolt to the existing controls.



Wire Routing: (Please consult owners manual for wiring diagram and color codes)

- Be sure to route wires so that they cannot become tangled or caught in either a suspension part or steering part. Check movement of both steering and suspension before riding the bike.
- It is sometimes helpful to follow existing wire routing.

The connector that connects the harness to the lights may need to be zip tied in a location where it won't potentially rub on the fork.

Step 4: Wiring (1290 Super Adventure R, 2017+)

****NOTE****

This page is for the 1290 Super Adventure R only

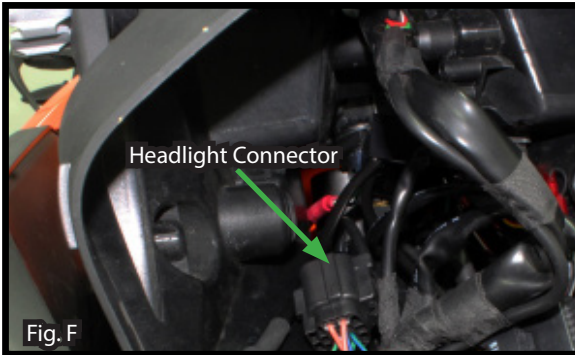

Locate the connector that was plugged into the headlight assembly (Shown above in Fig. F). Connect the included jumper plug to the male and female ends of the headlight connector on the bike. Connect the red and white wires coming out of the jumper plug to the wiring harness with Posi-locks as seen on pg. 10.

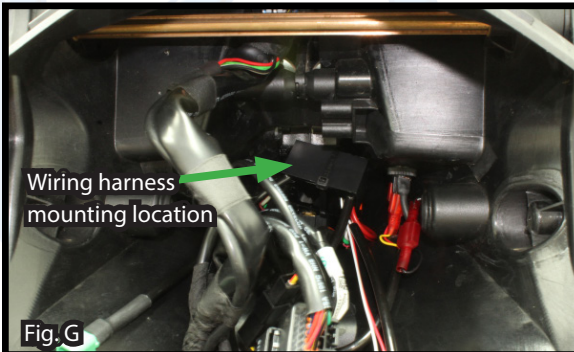

Affix the relay harness box to a solid object somewhere in the headlight cavity using Zip Ties. (Fig. G) shows a possible location.

Step 4: Wiring

Electrical:

- Run the Red and Black power wires directly to the battery. The fuse will protect the system in the event of a short.
- Mount the power relay box in a safe location (see photo below for one recommended location). Secure with a zip tie. It is a good idea to face the relay box with the wires coming out of the bottom. This helps keep everything dry.

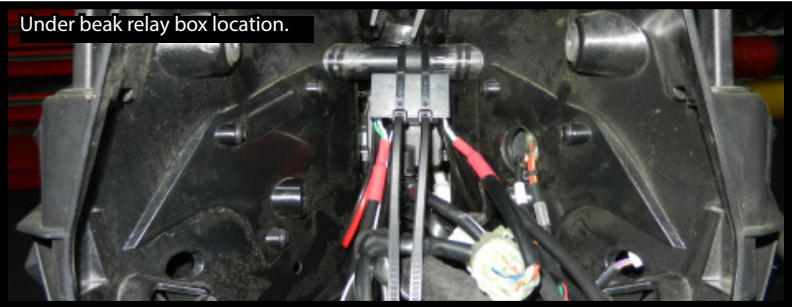

- Route the two Black connectors for the lights to a convenient location where they will not interfere with steering or any other moving parts.
- Install the switch in a convenient location.
- Switch - Crimp spade lugs to red, yellow, wires from relay box. Attach to corresponding tabs on switch. (See wiring diagram)

Horn Feature:

Locate the Horn's hot (+) lead. This will make your lights flash to full when you sound your horn. Use a Posi-tap to connect one of the white wires from the relay box to this wire. It does not matter which white wire you use; both trigger the same way. If you do not want to use this feature, simply tuck the white wire away in a neat fashion.

Step 5: Alignment / Drip Loop Instructions

Aligning The Lights:

As Erica, Krista, and Sevina are designed as auxiliary lights, adjustment is up to the user depending on his needs. Ask an assistant to help you with this procedure. Make sure the bike is on level ground and have an assistant sit on the bike. With a right angle board or object, position the board on the floor and slide it up to the light. The goal is to adjust the lights so that the light is level with the ground.

Passengers and luggage may alter the alignment of the light, so further adjustments may be needed. You may find that a slight downward angle (5 degrees) is helpful. Often times it is helpful to angle the right side light toward the right side of the road. This helps with identifying road terrain and potential critters.



Do Not Kink The Grommet

To maintain the integrity of the water sealling grommet, do not kink, deform or put pressure on the grommet when dressing the wires during install of Clearwater Lights.

Do Not Kink The Grommet

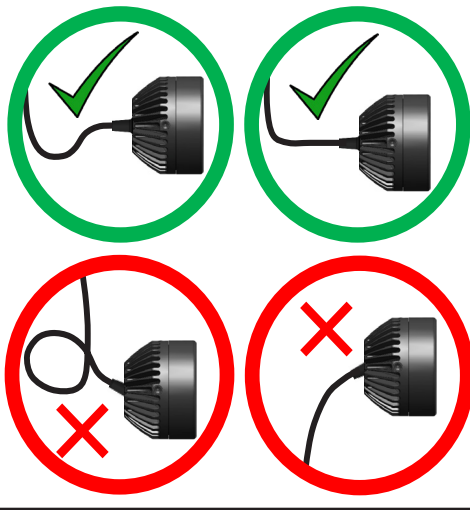

Thank you for purchasing your **Clearwater Lights**. We hope this product will help make you a safer rider. Please feel free to send us comments or suggestions at any time. We learn from you. Visit our website for more exciting products to help you see better at night.

Ride safe!

Sincerely,

Glenn and the team at Clearwater.



The Clearwater Company - 11305 Sunrise Gold Circle, Suite D
Rancho Cordova, CA 95742

Phone: (916) 852-7029 | Fax: (916) 852-9410 | www.clearwaterlights.com

Revised 6/16/20