



clearwater
LIGHTS™



Installation Manual

BMW S1000R/RR

Glenda/Darla LED Light Kit

Dimmable

Patent Pending



Made in USA

Step 1: Parts List and Bike Preparation

Please be sure to read our instructions thoroughly before attempting installation.

- Check Parts list below with your kit to be sure all parts are handy. If something is missing, please call us at (916) 852-7029.

B41 - HARDWARE BAG

4 M6 x 14 Hex head Bolt
 2 M5 x 40 SHCS
 2 M5 x 45 SHCS
 4 M6 Flat Washers
 4 M5 Washers
 4 M5 Shoulder Washers
 4 M6 Plastic Washers
 2 611 Fender Mount Bracket
 2 Spacer #14 - Bottom
 2 Spacer #16 - Top

1 M6 x 40 SHCS
 1 M6 x 35 SHCS
 1 Spacer #20 - M6 POT

Last Updated: 10/29/2019

B309 - 7/8" CLAMP BAG

1 M6 x 12 BH
 1 M6 Thin Nylock
 1 7/8" POT Handlebar Clamp

B803 - DARLA CONNECTION BAG

3 Posi Twist
 2 Posi Tap
 12 6" Zip Ties

B702 - HARNESS BAG

1 Harness
 1 Ring Terminal

1 34" Darla Pigtails (Pair)

1 34" Darla Pigtails (Pair)

D-41

2 Light Assembly

B708 - POT HARDWARE BAG

1 Pot Assembly
 1 M5 x 0.8 x 30mm
 1 M6 X 10 Button Head
 1 M5 Flat Washer
 1 #7 Spacer (3/16 X 5/16")
 1 L-Bracket
 1 Plastic Plug

Please take the time to review the included instructions. Installation of your new Clearwater Lights is straightforward. But, be sure to follow some of the suggestions to keep the installation safe and reliable. If you have any questions or comments, please feel free to contact us. Thank you!

Step 1: Parts List & Bike Preparation

Bike Preparation:

- First, park the motorcycle on hard pavement or concrete to insure the bike will be stable during the installation. If you can mount the bike on a stand with tie-down straps, this will help secure the motorcycle.
- Follow the manufacturers guidelines for disconnecting the battery. This is important to prevent damage to the electrical system.

Note:

We suggest keeping your lights on all the time, we do not furnish an "on-off" switch. It is important to be sure that the wire you use will turn off when the bike is turned off. Otherwise, you will end up with a dead battery. Nobody likes that.



D41 Fork Mount

Installation Tips:

There are two main parts to the installation of your new Clearwater Lights. The mechanical portion, and the electrical portion. With this manual, we will go over the basics of both which should allow you to get your lights up and running. If you purchased a bracket made specifically for your bike, refer to our manuals online for that specific installation at:

www.clearwaterlights.com

Note: Motorcycle needs to be turned on before the lights will function.

Step 2: Mounting The Lights / Fork Mount

Mounting The Lights: (Fork Mount)

Pre-assemble the lights, mounting bracket, shoulder washers and spacers with new bolts. Gently screw all bolts in hand tight. Inspect the bolt length and spacer alignment before tightening the bolts.

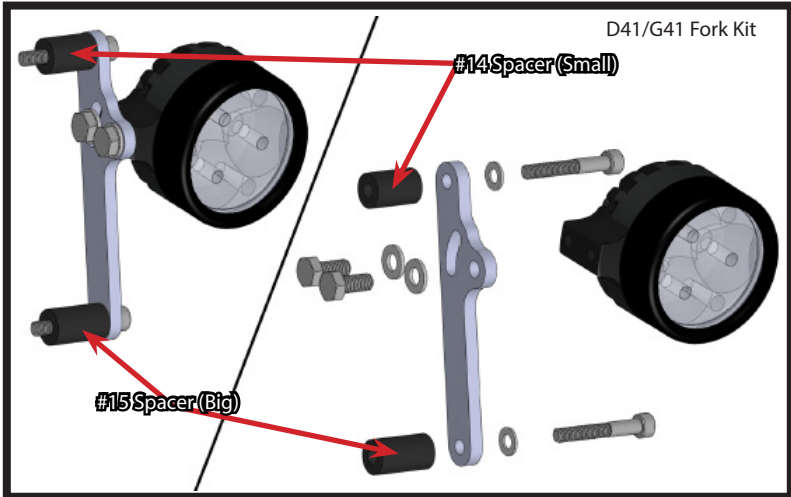

Step 3: Disassembly

Disassembly

Step 1. Remove seat (2 screws at rear of seat)

Step 2. Remove rear seat (insert key and turn key 90 degrees to remove)

Step 3. Remove right side body panel (follow diagram below which can also be found on pg. 181 of your BMW S1000RR owners manual.)

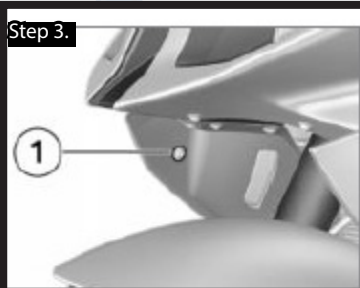
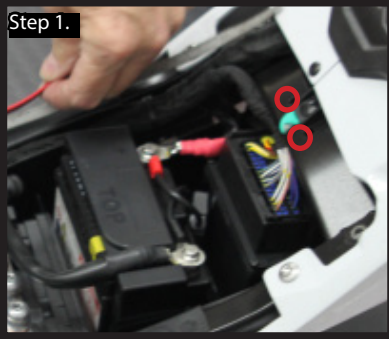

Remove screw **1** on inside of fairing side panel.

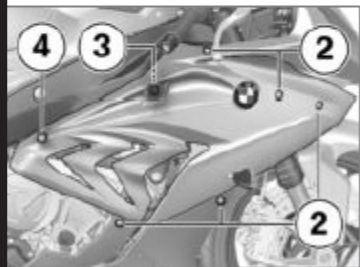

Remove screws **2**.
Detach fairing side panel from grommet **3** and detent pin **4**.

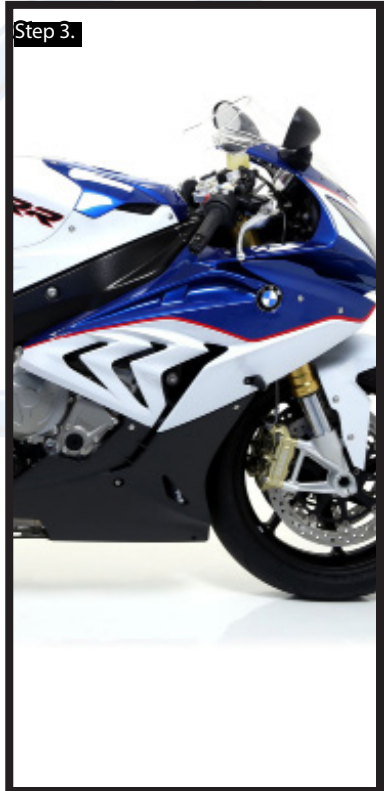

Step 3: Disassembly

Disassembly

Step 4. Remove upper right side body panel

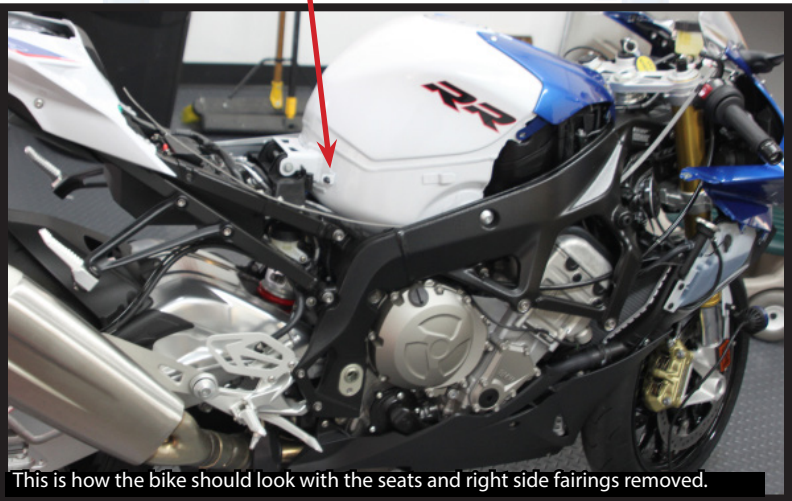
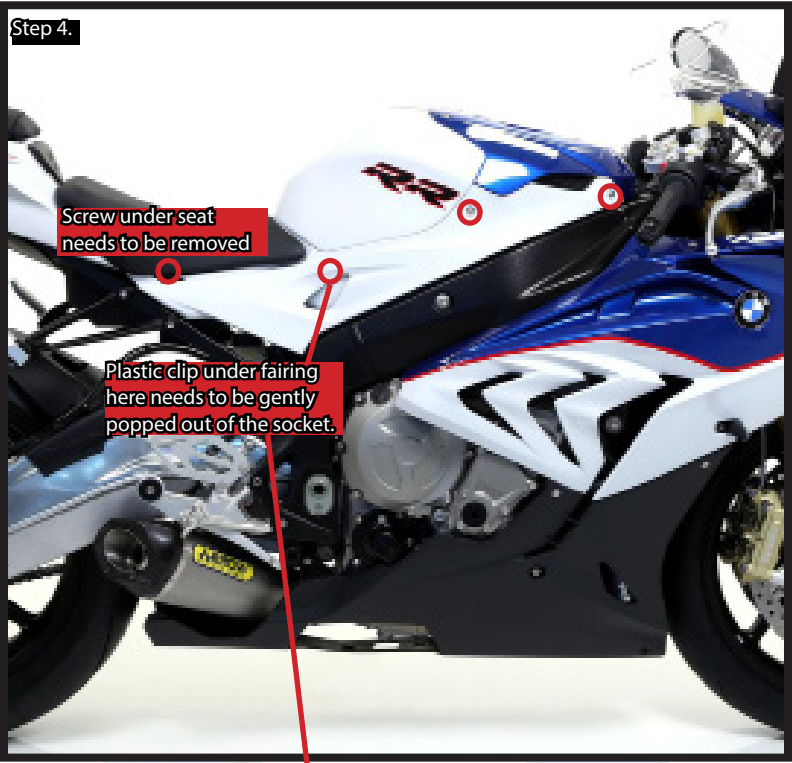

Step 3: Mounting The Volume Control Knob

Mounting The Volume Control Knob: (Bar Mount)

- Mount the Volume Control Knob to handlebar by using supplied bracket and bolt to the existing controls.
- Route wires from lights and volume control knob bracket to area under left side of forks. Connections can be made here and be kept weatherproof.



Hint for High Vibration installations: To keep the Volume Control Knob from rotating itself under high vibration, put a dab of silicone adhesive under the knob and let it dry. Then push the rubber knob back on. The friction of the glue under the knob will keep it in place.

Step 4: Wiring

Wire Routing:

- Be sure to route wires so that they cannot become tangled or caught in either a suspension part or steering part. Check movement of both steering and suspension before riding the bike.
- It is sometimes helpful to follow existing wire routing.

Wiring:

- Main power needs to be connected to a switched hot. This means one that turns off with the key. An Auxiliary hot can be used as an alternative. Using the supplied Posi-twist connectors, connect the wires according to the accompanying color wire diagram. Attach ground lug to ground on frame tab or other suitable location. Be sure not use a Low beam headlight wire on H4 headlight bikes or else the lights will shut off when the high beam is activated.
- Find a good solid ground point for the black wire terminal ring.
- Use a Posi-twist to connect the green wire from the volume control knob to the two green wires from the lights (3 wires).
- Use a Posi-twist to connect red wire from the fuse holder to the red wires from lights and volume control knob (4 wires)
- Connect ground/black wire to black wires from lights and volume control knob. (4 wires)
- If you would like to use the high beam feature (recommended), use a Posi-tap to connect the white wire from the volume control knob to the High Beam headlight hot lead (+). This will be on only when the high beam is illuminated.

Step 5: Alignment / Drip Loop Instructions

Aligning The Lights:

Adjustment is up to the user depending on his needs. Ask an assistant to help you with this procedure. Make sure the bike is on level ground and have an assistant sit on the bike. With a right angle board or object, position the board on the floor and slide it up to the light. The goal is to adjust the lights so that the light is level with the ground.

Passengers and luggage may alter the alignment of the light, so further adjustments may be needed. You may find that a slight downward angle (5 degrees) is helpful. Often times it is helpful to angle the right side light toward the right side of the road. This helps with identifying road terrain and potential critters.

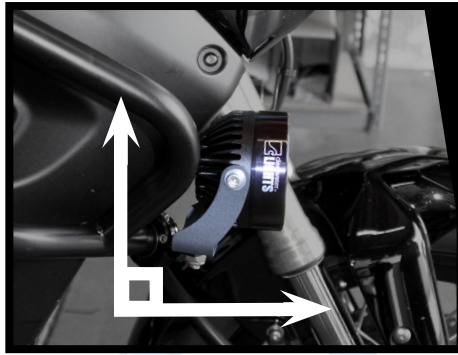

Using a Drip Loop

Though our lights are sealed for ultimate all weather use, sometimes water sneaks by. To make sure this doesn't happen, we highly suggest using a drip loop. When installing the wiring to your lights, use a drip loop as shown below. This will keep water from dripping directly into the light and instead fall off before it can reach the back of the body.

To do this just leave a bit of extra wiring and let it hang below the light. You could make a complete loop if you like, but just make sure the wire hangs below the light as shown below.

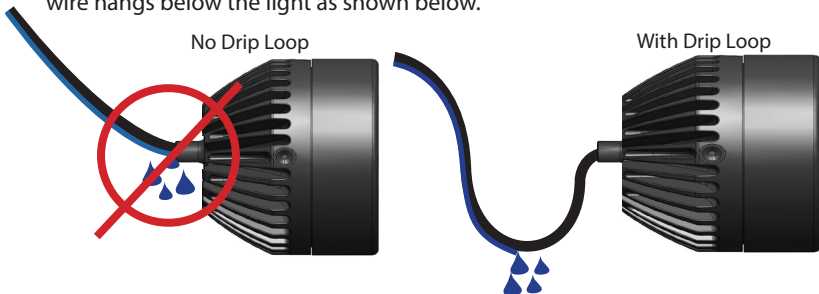

Notes:

Notes:





**1 Year Replacement
Warranty**

*We have over 40,000 satisfied customers around the world.
Our goal is to make you happy. If you have a problem, call
us and we will make things right.*

Thank you for purchasing your **Clearwater Lights**. We hope this product will help make you a safer rider. Please feel free to send us comments or suggestions at any time. We learn from you. Visit our website for more exciting products to help you see better at night.

Ride safe!

Sincerely,

Glenn and the team at Clearwater.



The Clearwater Company - 11305 Sunrise Gold Circle, Suite D
Rancho Cordova, CA 95742

Phone: (916) 852-7029 | Fax: (916) 852-9410 | www.clearwaterlights.com

Revised on 7/23/20