



clearwater
LIGHTS™



Installation Manual

KTM 1290 Super Adventure [R]

Darla LED Light Kit

Dimmable

Patent Pending



Made in USA

Step 1: Parts List and Bike Preparation

Please be sure to read our instructions thoroughly before attempting installation.

D-74 – KTM 1290SA (2015-2016), 1290SA T (2017+), 1190A (2013-2016) and 1090

2 Light Assembly



B818 - JR CONNECTION BAG

3 Post Twist



12 6" Zip Ties

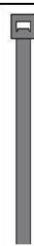

B74 - HARDWARE BAG

2 670 - Triangle Bracket



B717 - KES KTM CONNECTION BAG

2 Post Lock, small



1 Jumper

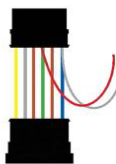

B708 - POT HARDWARE BAG

1 Pot Assembly



1 M5 x 30 SH



1 M6 X 10 BH



1 M5 Flat Washer



1 #7 Spacer (3/16 X 5/16")



1 L Bracket



1 Plastic Plug



B702 - HARNESS BAG

1 Harness



1 Ring Terminal



Last Updated: 11/15/2019

4 Spacer #15



4 M5 x 1.0 x .45



4 M6 X 14 HH



4 M6 Flat Washers



4 M5 Flat Washer



4 M5 shoulder washer



4 Plastic Washers



HANDLEBAR CLAMP HARDWARE

1 M6 X 12 Button Head



1 M6 Thin Nylock



1 7/8" POT Handlebar Clamp



Step 1: Parts List & Bike Preparation

D-G 74b – KTM 1290 SA R, S (2017+)

2 Light Assembly



E708 - POT HARDWARE BAG

1 Pot Assembly



- 1 M5 x 30 SH
- 1 M6 X 10 BH
- 1 M5 Flat Washer
- 1 #7 Spacer (3/16 X 5/16")
- 1 L-Bracket
- 1 Plastic Plug

B#18 -JR CONNECTION BAG

3 Post Twist



12 6" Zip Ties



E702 - HARNESS BAG

1 Harness



1 Ring Terminal



Last Updated: 6/16/20

E74b -HARDWARE BAG

2 6/10 - Triangle Bracket



4 Spacer #10



- 4 M6 x 1.0 x 55 SH
- 4 M6 x 14 HH
- 4 M6 Flat Washers
- 4 M5 Flat Washer
- 4 M5 shoulder washer
- 4 Plastic Washers



E718 - KTM 1290 SA R CONNECTION BAG

1 Jumper Plug



2 Post lock



HANDLEBAR CLAMP HARDWARE

- 1 M6 X 12 Button Head
- 1 M6 Thin Nylock
- 1 7/8" POT Handlebar Clamp



****NOTE****
This page is for the 1290 Super Adventure R only

Step 1: Parts List & Bike Preparation

D-75 – KTM 1290SA (2015-2016), 1290SA T (2017+), 1190A (2013-2016+), 1090 (2017+)

2 Light Assembly



B708 - POT HARDWARE BAG

1 Pot Assembly



- 1 M6 x 30 SH
- 1 M6 X 10 BH
- 1 M6 Flat Washer
- 1 #7 Spacer (3/16 X 5/16")
- 1 L-Bracket
- 1 Plastic Plug

B818 - JIR CONNECTION BAG

3 Post Twist



12 6" Zip Ties

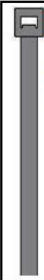

B702 - HARNESS BAG

1 Harness



1 Ring Terminal



Last Updated: 6/7/6/20

B150 - HARDWARE BAG

2 616 G D CB Bracket



4 M6 x 14 SHCS Bolt



2 M10 x 16 BHCS Bolts



4 M6 Flat Washers



2 M10 Lock Washer



B717 - KES KTM CONNECTION BAG

2 Post Lock, small



1 Jumper



HANDLEBAR CLAMP HARDWARE

1 M6 X 12 Button Head



1 M6 Thin Nylock



1 7/8" POT Handlebar Clamp



B87 - BRACKET BAG

2 667 Crash Bar Clamp - 21-22mm



4 M5x15 (Pre-installed)



Step 1: Parts List & Bike Preparation

D-G 75b – KTM 1290 Super Adventure R, S (2017+)

2 Light Assembly



B708 - POT HARDWARE BAG

1 Pot Assembly



- 1 M5 x 30 SH
- 1 M6 X 10 BH
- 1 M5 Flat Washer
- 1 #7 Spacer (3/16 X 5/16")
- 1 L-Bracket
- 1 Plastic Plug

B818 -JR CONNECTION BAG

3 Post Twist



12 6" Zip Ties

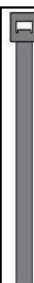

B702 - HARNESS BAG

1 Harness



1 Ring Terminal



B150 - HARDWARE BAG

2 616 G D CB Bracket



4 M6 x 14 SHCS

2 M10 x 18 BHCS



4 M6 Flat Washers

2 M10 Lock Washer



B718 - KTM 1290 SA R CONNECTION BAG

1 Jumper Plug



2 Post lock



HANDLEBAR CLAMP HARDWARE

1 M6 X 12 Button Head

1 M6 Thin Nylock

1 7/8" POT Handlebar Clamp



****NOTE****
This page is for the 1290 Super Adventure R only

Last Updated: 6/18/20

Step 1: Parts List & Bike Preparation

Bike Preparation:

- First, park the motorcycle on hard pavement or concrete to insure the bike will be stable during the installation. If you can mount the bike on a stand with tie-down straps, this will help secure the motorcycle.
- Follow the manufacturers guidelines for disconnecting the battery. This is important to prevent damage to the electrical system.



Please take the time to review the included instructions. Installation of your new Clearwater Lights is straightforward. But, be sure to follow some of the suggestions to keep the installation safe and reliable. If you have any questions or comments, please feel free to contact us. Thank you!

Step 2: Mounting The Lights / Fender Mount

Mounting The Lights: (Fender Mount)

Clearwater Lights comes with an assortment of stainless steel bolts that can allow a variety of installations. Pre-assemble the lights, mounting bracket, shoulder washers and spacers with new bolts. Gently screw all bolts in hand tight. Inspect the bolt length and spacer alignment before tightening the bolts.

This location is only for and Darla lights.

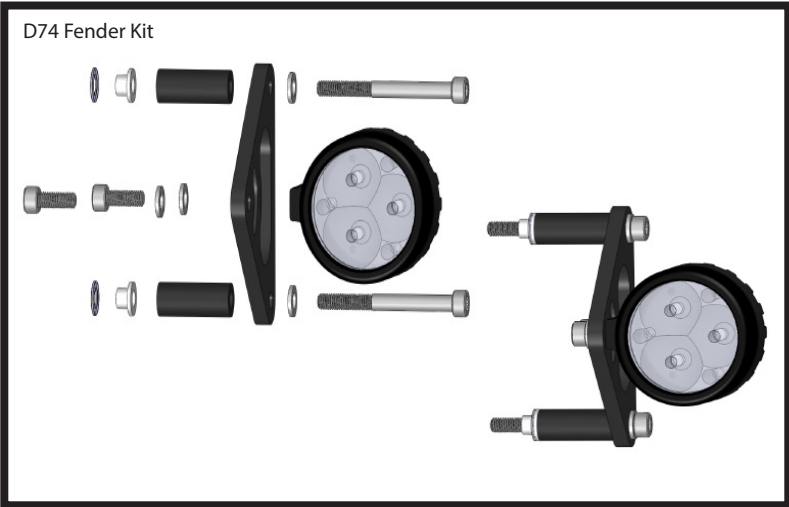

Step 2: Mounting The Lights / Crash Bar Mount

Mounting The Lights: (Crash Bar)

Mounting the Lights to the Crash Bar is very simple. Pre-assemble the lights, and mounting bracket loosely with the supplied parts. Locate where you would like the light to be pointing and the orientation of either on top or hanging below the bar. Snug the bolts on the clamp so you can now adjust the alignment of your lights.

D25 Crash Bar Kit



Pro Tip: A drop of blue loctite can be used on the M10 bolts so they won't come loose.

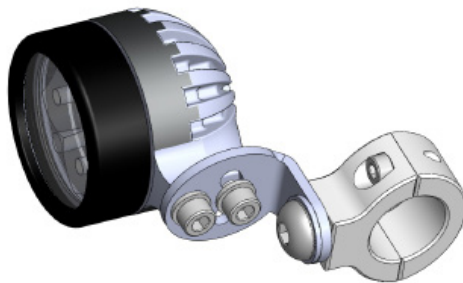
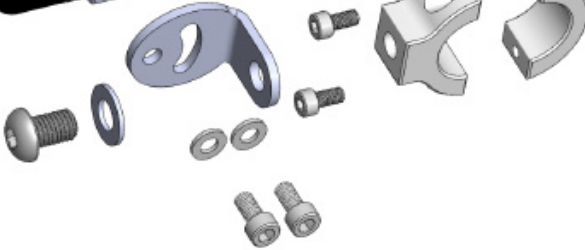

Step 3: Disassembly

Disassembly

Step 1. Remove windshield (T30 x 4)

Step 2. Remove windshield bracket (T30 x 4)

Step 3. Remove side covers (T30 x 3)

Disconnect fog lights

Step 4. Remove tank cover (T30 x 5) and (8mm bolt x 2)

Step 2

Bolt Location

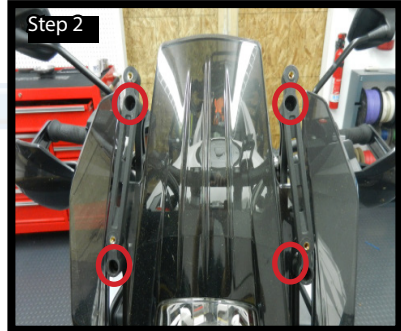
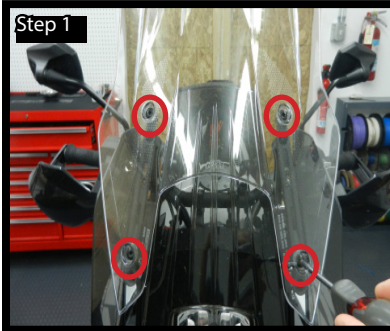

Step 3. This bolt must be removed before the side covers can be removed.

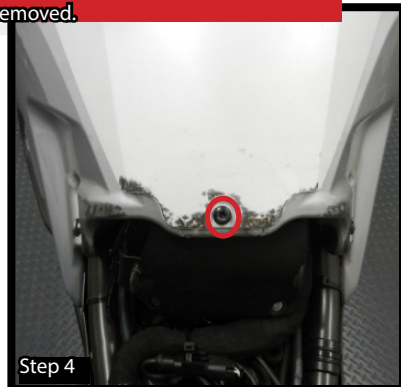
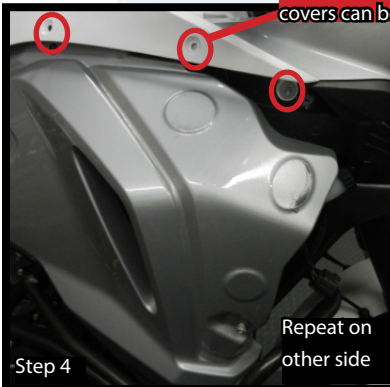

Step 3: Disassembly

Disassembly

Step 5. Remove turn signal covers (T30 x 2) Make note that these bolts are longer than the rest

Step 6. Remove headlight (T30 x 4) Disconnect headlight connector, this is the connector that is going to have the jumper in between

Step 7. Remove undercover (T30 x 6)

Fender Mount Only - Step 8. Remove fender bolts (T30 x 4)

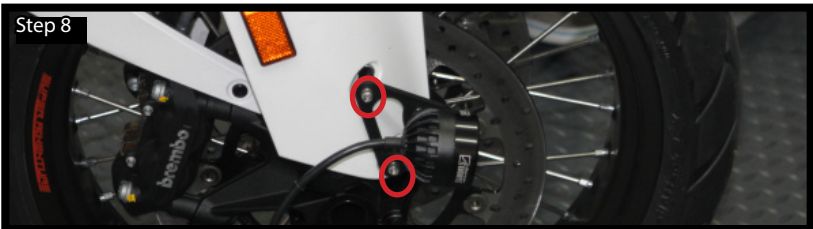
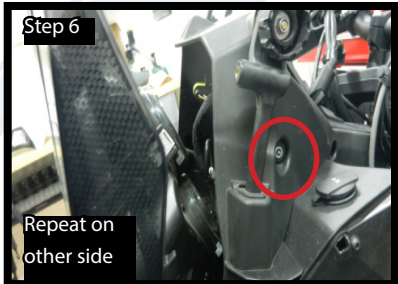
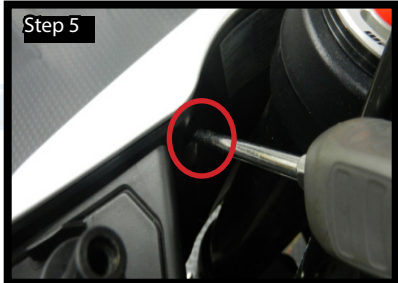
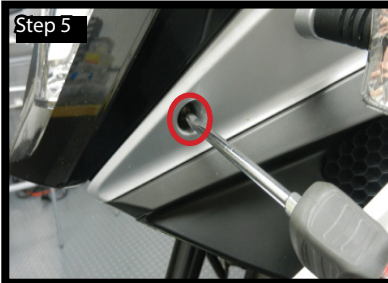

Step 3: Disassembly (1290 Super Adventure R, 2017+)

****NOTE****
This page is for the 1290 Super Adventure R only



Remove the headlight guard shown above in (Fig. A) It is held down by (2) bolts.



Remove the (2) lower bolts holding in the headlight assembly. Shown above in (Fig B) is the left side bolt.

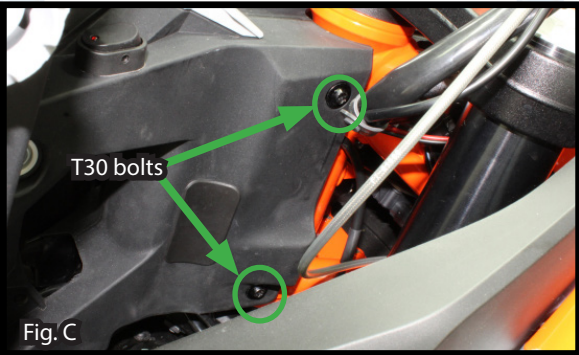

Near the fork, remove the (2) torx bolts shown above on the left hand side in (Fig. C). Remove the same (2) bolts on the right side.

Step 3: Disassembly (1290 Super Adventure R, 2017+)

****NOTE****

This page is for the 1290 Super Adventure R only

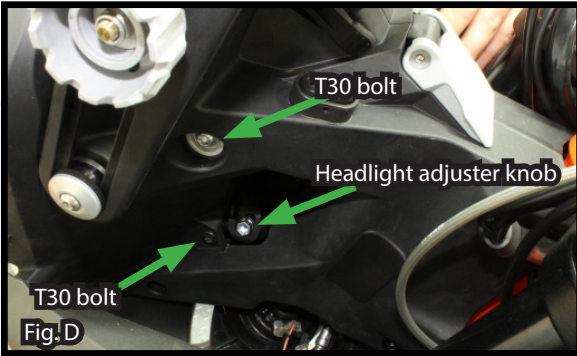

The headlight assembly is also held down by the bolts shown above in (Fig. D). Remove the top torx bolt (shown above on the left, but also on the right), the lower torx bolt, and the headlight adjuster knob.

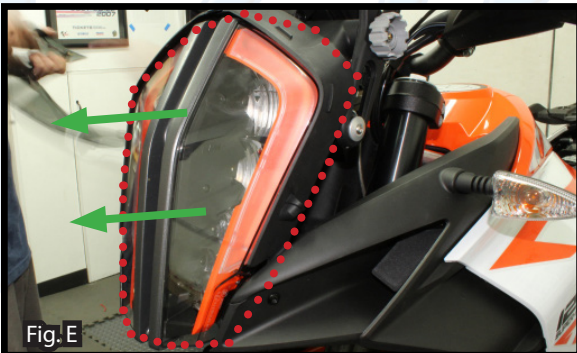

With the appropriate headlight bolts removed, Carefully pull the headlight assembly out, exposing the cavity underneath (Fig. E). Be sure to unplug connector from the back of the headlight assembly.

Step 4: Wiring

Wiring:

- We highly recommend you take a minute to review the wiring diagram below before starting the wiring portion of the installation. Once you feel comfortable with the information below you are ready to begin the electrical portion of the installation. Be sure to keep this diagram handy to reference throughout the installation.

KTM 1290 SA Darla Wiring Diagram

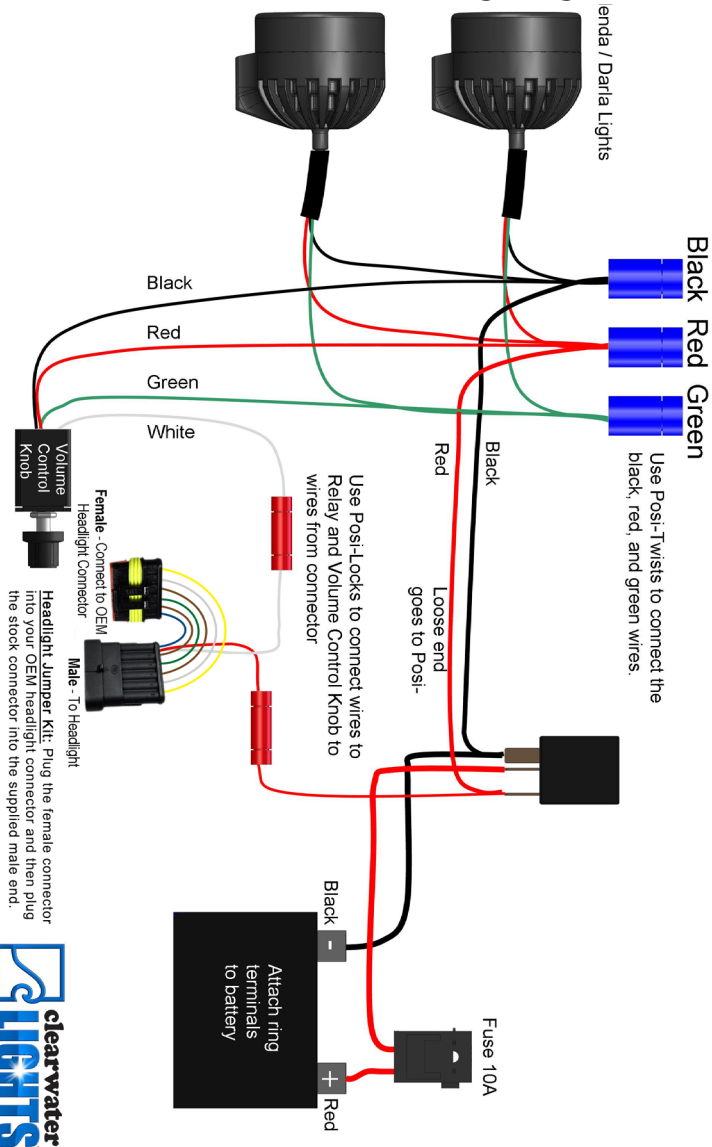

Step 4: Wiring (1290 Super Adventure R 2017+)

****NOTE****
This page is for the 1290 Super Adventure R only

KTM 1290 SA R

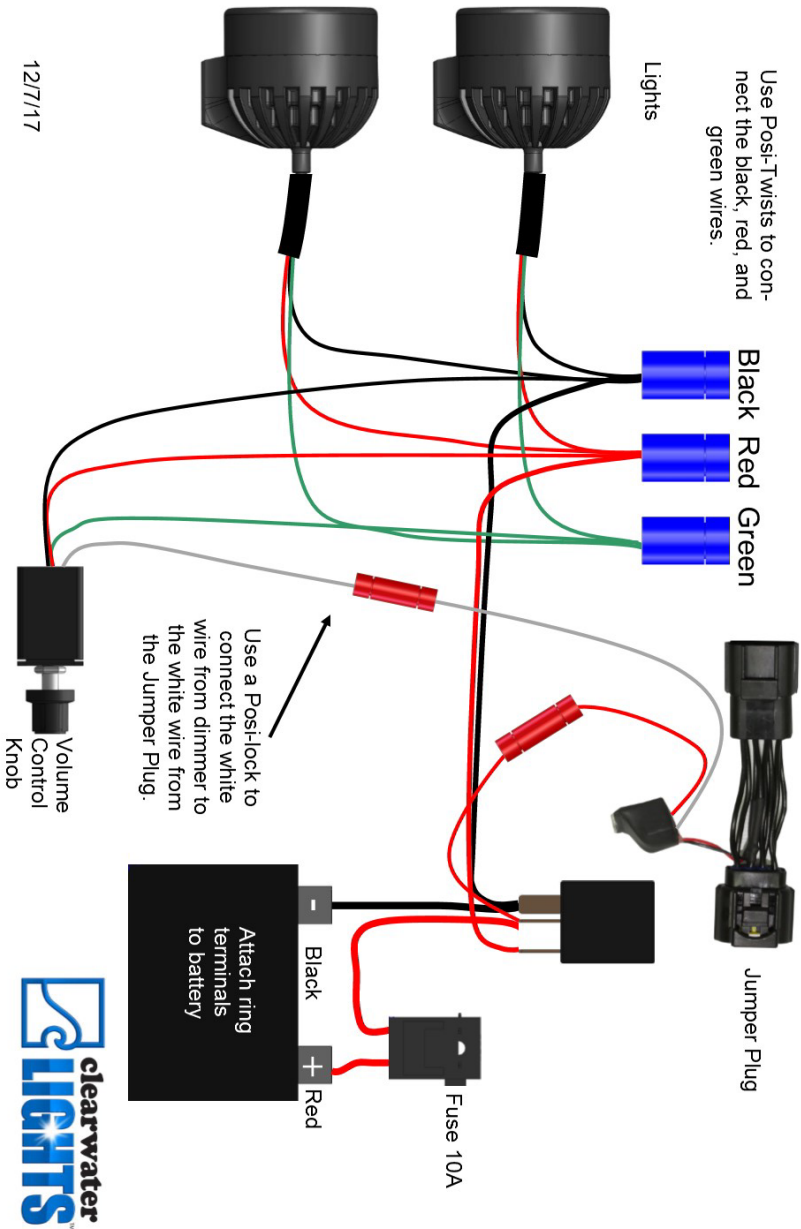

Step 4: Wiring

Mounting The Control Knob: (Bar Mount)

- Mount the Volume Control Knob to handlebar by using supplied bracket and bolt to the existing controls.



Wire Routing: (Please consult owners manual for wiring diagram and color codes)

- Be sure to route wires so that they cannot become tangled or caught in either a suspension part or steering part. Check movement of both steering and suspension before riding the bike.
- It is sometimes helpful to follow existing wire routing.

The connector that connects the harness to the lights may need to be zip tied in a location where it won't potentially rub on the fork.

Hint for High Vibration installations: To keep the Volume Control Knob from rotating itself under high vibration, put a dab of silicone adhesive under the knob and let it dry. Then push the rubber knob back on. The friction of the glue under the knob will keep it in place.

Step 4: Wiring (1290 Super Adventure R 2017+)

****NOTE****

This page is for the 1290 Super Adventure R only

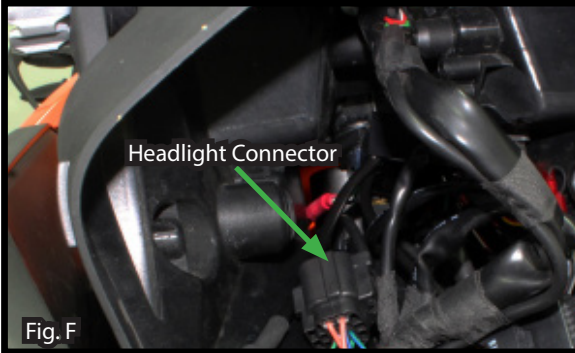

Fig. F

Locate the connector that was plugged into the headlight assembly (Shown above in Fig. F). Connect the included jumper plug to the male and female ends of the headlight connector on the bike. Connect the red and white wires coming out of the jumper plug to the wiring harness with Posi-locks as seen on pg. 11.

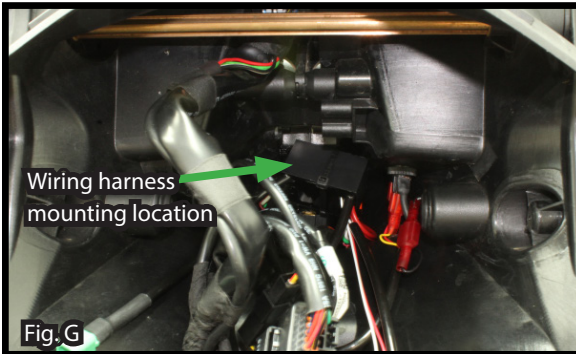

Fig. G

Affix the relay harness box to a solid object somewhere in the headlight cavity using Zip Ties. (Fig. G) shows a possible location.

Step 4: Wiring

Electrical:

- Run the Red and Black power wires directly to the battery. The fuse will protect the system in the event of a short.
- Mount the power relay box in a safe location (see photo below for one recommended location). Secure with a zip tie. It is a good idea to face the relay box with the wires coming out of the bottom. This helps keep everything dry.

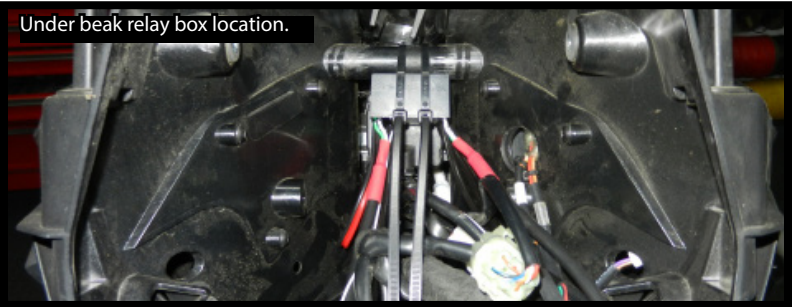

- Main power needs to be connected to a switched hot. This means one that turns off with the key. An Auxiliary hot can be used as an alternative. Using the supplied Posi-twist connectors, connect the wires according to the accompanying color wire diagram (page 7).
- Use a Posi-twist to connect the green wire from the volume control knob to the two green wires from the lights (3 wires).
- Use a Posi-twist to connect red wire from the relay harness to the red wires from lights and volume control knob (4 wires)
- Connect ground/black wire to black wires from lights, relay harness, and volume control knob. (4 wires)
- Use a Posi-lock to connect the white wire from the volume control knob to the male headlight jumper kit connector.
- Use a Posi-lock to connect the red wire from the relay harness to the male headlight jumper kit connector.
- Plug the female headlight jumper kit connector into the OEM headlight connector and then plug the stock connector into the supplied male end.
- Carefully assemble all components in the opposite way they were removed.

Step 5: Alignment / Grommet Precaution

Aligning The Lights:

Being that Darla's are designed as auxiliary lights, adjustment is up to the user depending on his or her needs. Ask an assistant to help you with this procedure. Make sure the bike is on level ground and have an assistant sit on the bike. With a right angle board or object, position the board on the floor and slide it up to the light. The goal is to adjust the lights so that the light is level with the ground.

Passengers and luggage may alter the alignment of the light, so further adjustments may be needed. You may find that a slight downward angle (5 degrees) is helpful. Often times it is helpful to angle the right side light toward the right side of the road. This helps with identifying road terrain and potential critters.

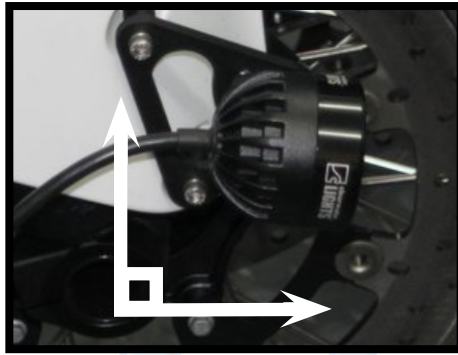

Do Not Kink The Grommet

To maintain the integrity of the water sealling grommet, do not kink, deform or put pressure on the grommet when dressing the wires during install of Clearwater Lights.

Do Not Kink The Grommet

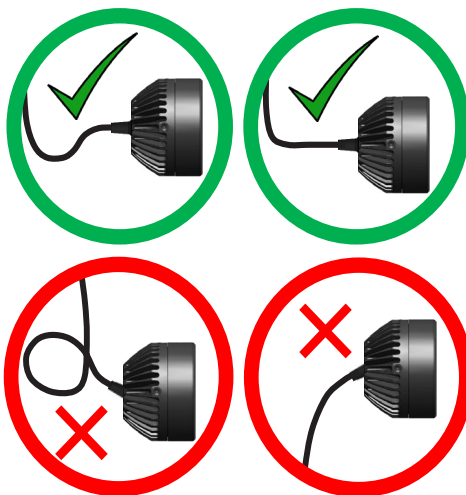

Notes:



Thank you for purchasing your **Clearwater Lights**. We hope this product will help make you a safer rider. Please feel free to send us comments or suggestions at any time. We learn from you. Visit our website for more exciting products to help you see better at night.

Ride safe!

Sincerely,

Glenn and the team at Clearwater.



The Clearwater Company - 11305 Sunrise Gold Circle, Suite D
Rancho Cordova, CA 95742

Phone: (916) 852-7029 | Fax: (916) 852-9410 | www.clearwaterlights.com

Revised 6/16/20