

SETUP GUIDE

POST SIDE HANDRAIL BRACKET

SKU #HRS-P-S-2-ASSY



INSTALL DEMO VIDEO
<https://youtu.be/v6N3LIM9Wsw>

IF INSTALLING IN DRYWALL:

- 1 | Find the stud behind your drywall, and hold the bracket in position. Mark the first hole and remove the bracket.
- 2 | Drill 1/2" pilot hole through the drywall. Place a nylon washer, and set the first screw into the stud/blocking.
- 3 | Level the bracket and tighten the screw. Repeat the process with the second mounting screw.

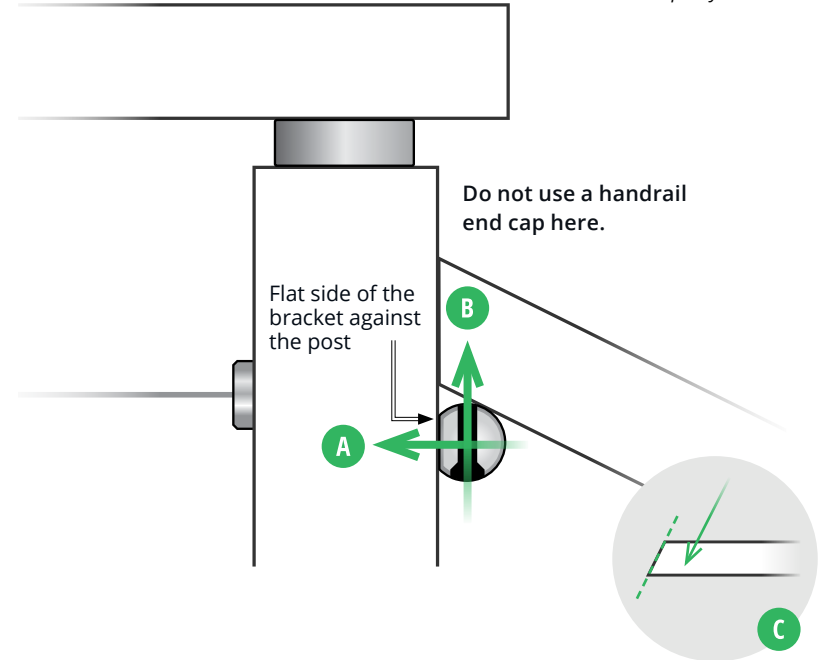
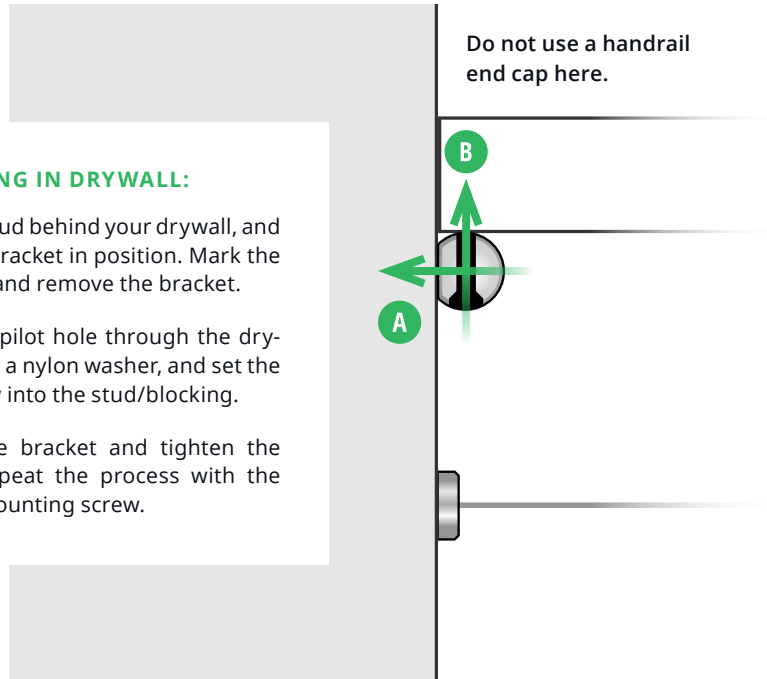

TOOLS & SUPPLIES

- ❑ Drill (with 5/32" cobalt or titanium bit*)
- ❑ Screwdriver (with T20 star drive bit*)
- ❑ Mounting screws (included with bracket)*
- ❑ Speed Square
- ❑ Clamps with rubber pads
- ❑ Level (optional)

* available at www.cablebullet.com

HOW TO INSTALL THE POST SIDE BRACKET

- 1 | Position the bracket with the flat side against your post. Use a speed square to level the bracket. Use a ratcheting clamp with rubber jaw pads to hold the bracket in place.
- 2 | Use a 5/32" bit to drill the first pilot hole through the post wall **A**. Secure the bracket with a single mounting screw for your application. Use a manual socket screwdriver to avoid stripping the screw. Remove the clamp.
- 3 | Use the speed square to check the bracket for level and adjust the bracket as needed before drilling the next pilot hole and securing the second mounting screw. If you're installing handrail between columns, repeat the process with your second bracket.

- 4 | Set your handrail in place against the bracket. Use the ratcheting clamp to keep the handrail from shifting side-to-side. Have a helper hold the handrail firmly in place to keep the handrail from shifting up under pressure. Carefully mark both screw locations using a 5/32" drill bit **B**.
- 5 | Remove the handrail, flip it, and lay it on a flat surface. Drill 2 pilot holes with the 5/32" bit. On sloped rail sections, drill the pilot holes parallel to the bevel cut (see drawing **C**). **TIP:** To keep your drill bit from walking, drill straight down, then carefully adjust the angle.
- 6 | Drive 2 mounting screws through the underside of the bracket and secure the handrail.

GOT QUESTIONS? WE'RE HERE TO HELP!



WWW.CABLEBULLET.COM



INFO@CABLEBULLET.COM



574.742.2737