

IMPORTANT!

Installation procedure has changed.

It is critical to cable life to read and follow installation procedure. Review cable checklist prior to starting cable installation.

Cable Installation Checklist

(use this form to confirm cable is installed correctly)

PEDAL END

- Cable wire was not bent when connecting the cable to the pedal.
- Cable is straight for minimum ½ inch past the end fitting, *(Cable Installation, step 1 and 4, AREAS TO PAY PARTICULAR ATTENTION TO, Recommended cable routing, WARNINGS)*
 - Check with mower deck at mowing height and parking brake released.
 - Check with mower deck in transport position (full up) and parking brake engaged.
- Cable is secured to foot deck to prevent bending at end fitting, *(Recommended cable routing, SECURE WITH CABLE CLAMP/ZIP TIE)*
- Pedal height is set so pedal bottoms out on pedal stop, Test by putting full weight on pedal, pedal should hit hard stop. NOTE: SE pedal with slot on side of pedal only, with flap in closed position; entire head of clevis pin must be visible when looking through slot on side of pedal. *(Cable Installation, step 2, PROPER PEDAL HEIGHT)*
- Minimum ½" of threads visible between rubber boot and jam nut 1.
- Rubber boots is in place on cable fitting, *(Cable Installation, step 3, MAINTAINING THE CABLE)*

FLAP END

- Cable is straight for minimum ½ inch past the end fitting, *(Cable Installation, step 1 and 4, AREAS TO PAY PARTICULAR ATTENTION TO, page 6 installation guide, WARNING)*
 - Check with mower deck at mowing height and parking brake released.
 - Check with mower deck in transport position (full up) and parking brake engaged.
- Brass bushing is installed on flap end of cable.
- Head of clevis pin is on spring side, cotter pin toward front of mower.

ROUTING

- Cable is protected from heat of muffler, *(Cable Installation, step 4, AREAS TO PAY PARTICULAR ATTENTION TO)*
- Cable bends not less than 6-inch radius, *(Cable Installation, step 5, REFERENCE 6" RADIUS)*
- Cable has enough freedom on flap end to travel with mower deck, *(See recommended cable routing)*

GrassFlap Cable Installation

WARNING: PROPER CABLE INSTALLATION AND MAINTENANCE IS CRITICAL TO LIFE OF CABLE

1) Improper cable routing WILL cause failure, usually within the first month of use. The first 1/2 inch of cable conduit (black flexible part) must be straight in line with the end fitting. Cable wire near ball must not be bent during installation.

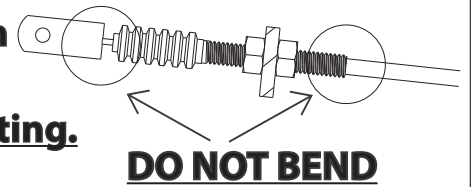

2) PROPER PEDAL HEIGHT:

1. Adjust pedal height so pedal bottoms out with full pressure to prevent cable from carrying full weight of operator. Start with cable fitting as shown - adjust pedal end to raise pedal, adjust flap end to lower pedal. Verify pedal height with flap in balance (half open) position.

Pedal End
(1 thread showing)

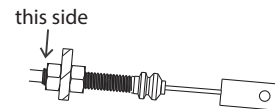

How to set pedal height:



Flap End
(1 thread showing)

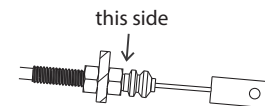

3) MAINTAINING THE CABLE:

1. Be sure the rubber boot is in place to keep dirt and water out of cable.

4) AREAS TO PAY PARTICULAR ATTENTION TO ARE:

1. Do not bend cable wire.
2. Make certain the cable is not in a bind when the deck is raised either manually or when mowing.
3. Leave enough slack where the cable is tied to mower to keep out of the belts for the deck to raise and lower without straining the cable.
4. Avoid direct heat on cable, do not route near muffler
5. Maintain recommended bend radius of 6 inches for all bends.

5) MINIMUM BEND RADIUS

Reference 6" radius for cable routing.

SE, SED & SEL Pedal with Built In Stop

For video showing how to install cable on pedal scan using phone camera.

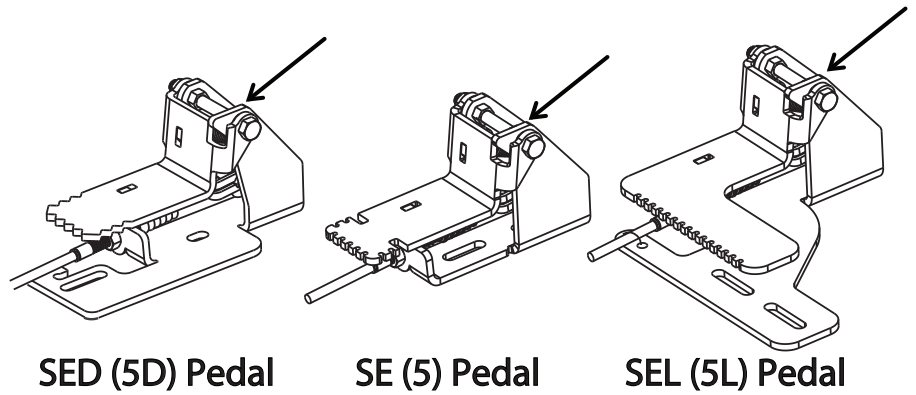

SED (5D) Pedal

SE (5) Pedal

SEL (5L) Pedal

Step 1

Pull **rubber boot** off of cable fitting and spin **nut 1** off of cable fitting. Spin **nut 2** onto fitting so one thread is showing.

Step 2

A) Slip **cable wire** into slot.
 B) Spin **nut 1** onto fitting to secure cable to pedal.
DO NOT OVERTIGHTEN NUTS.
 C) Push **rubber boot** back onto fitting.

Step 3

Position **removable clevis** onto cable ball.

Step 4

A) Position **removable clevis** on pedal with clevis slot on cut out side of pedal.
 B) Insert **1/4 pin** with head on same side as clevis slot.
 C) Insert **cotter pin** and wrap around pin to secure.

Step 5

A) Once pedal is installed on mower attach cable clamp or zip tie to secure cable.
 B) Verify everything is in place and secure.

SE & SEL Pedal with Full Open Position

For video showing how to install cable on pedal scan using phone camera.

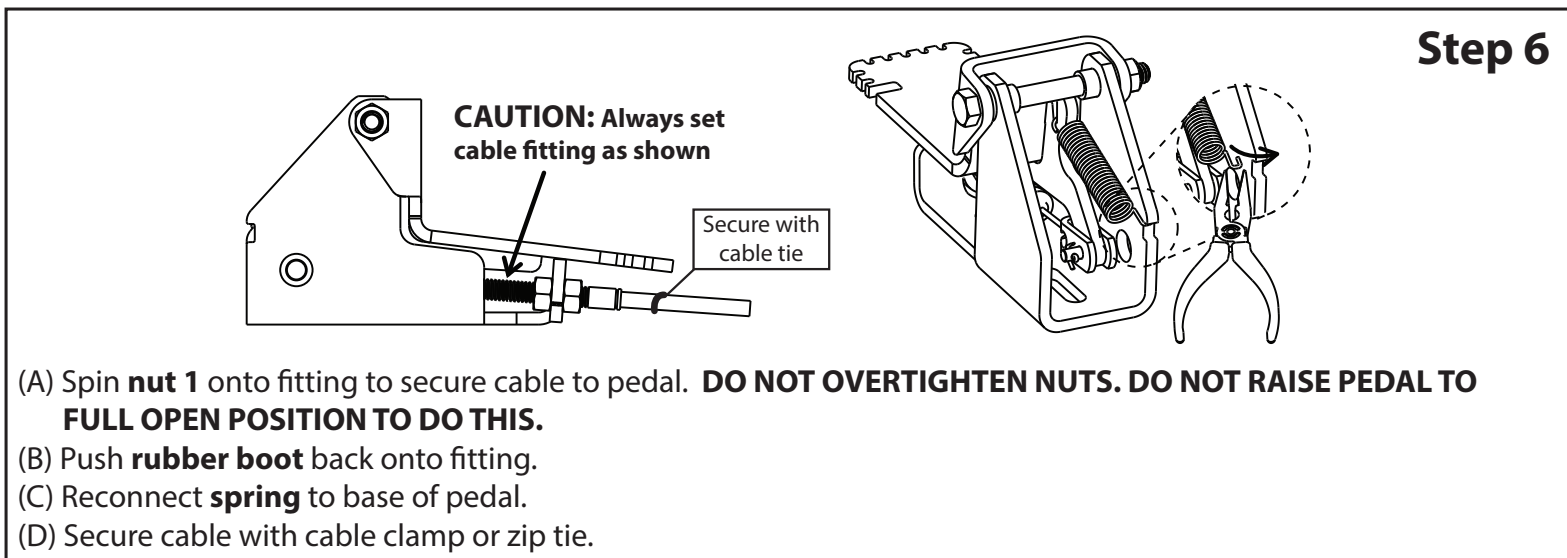
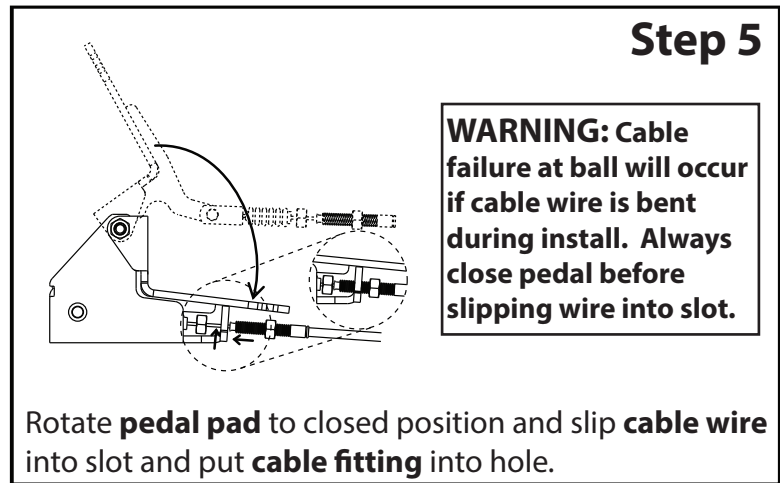
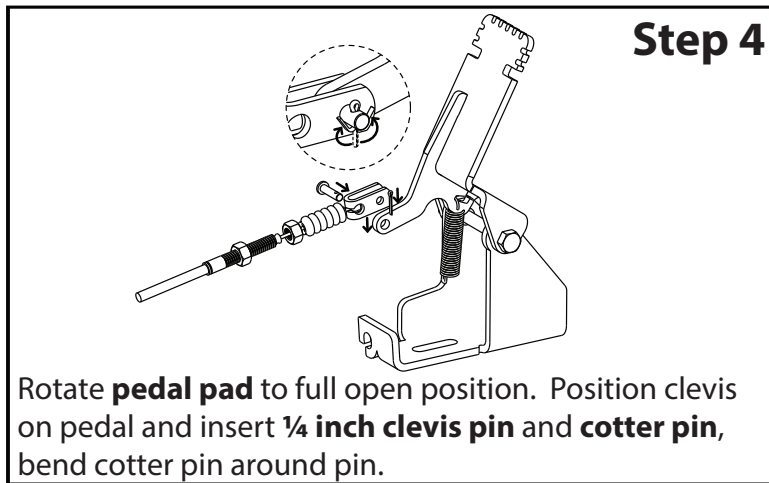
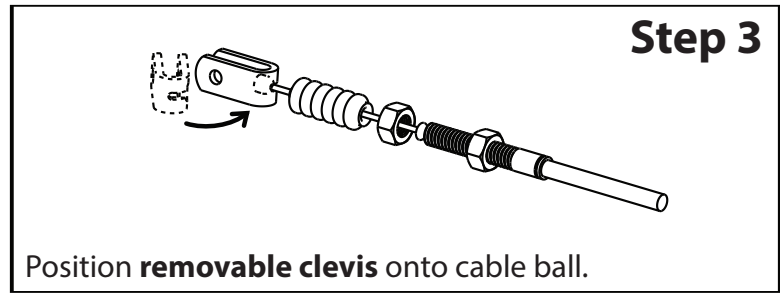
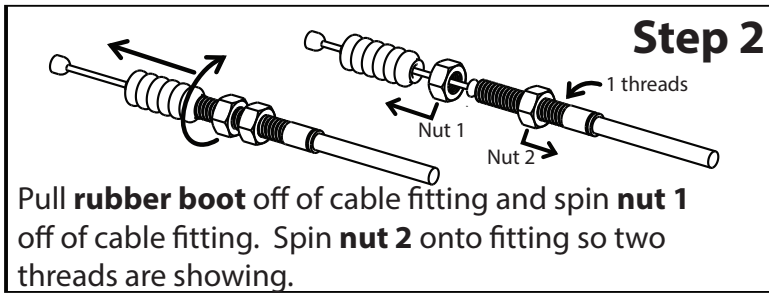
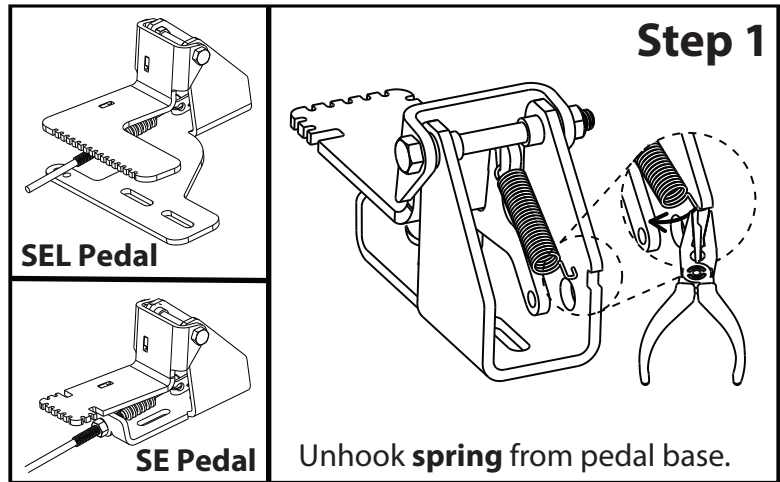

SE Pedal Location & Cable Routing

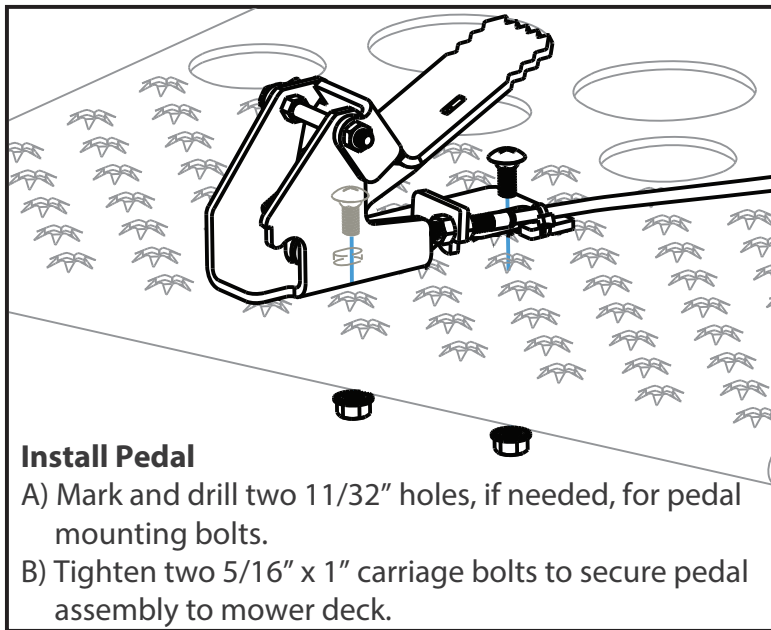
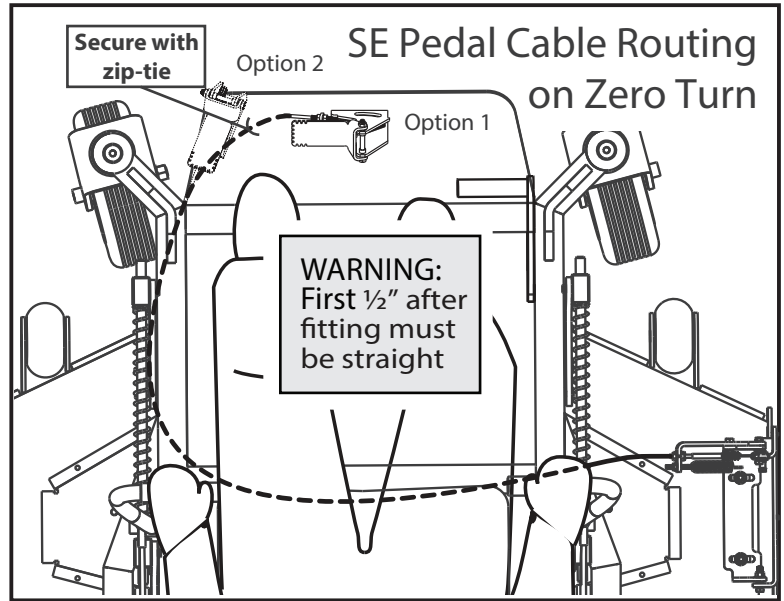
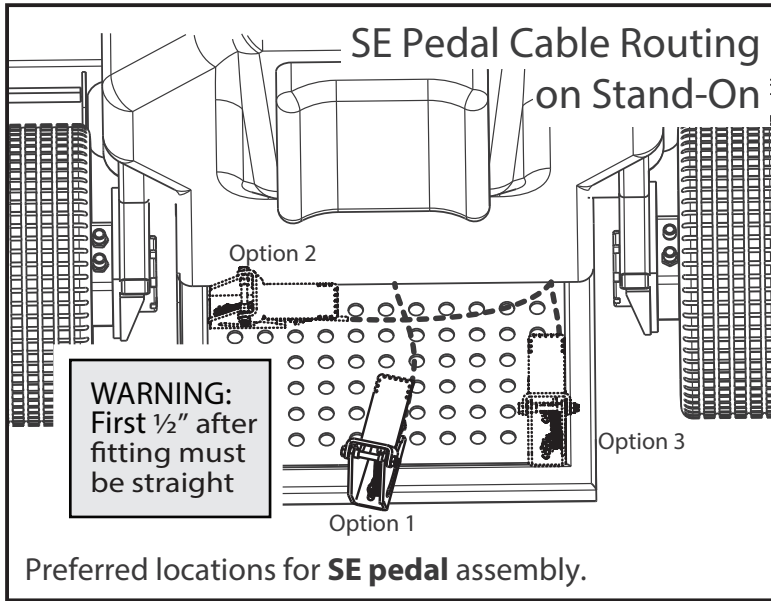

Flap Connection:

- Place 1/4" bushing in flap.
- Slip clevis onto flap.
- Insert 3/16" pin with head on spring side.
- Insert cotter pin and bend around pin.



FLAP CONNECTION

Bushing Cable Pin Flap End
10-99-28

3/16" Clevis Pin
10-99-22

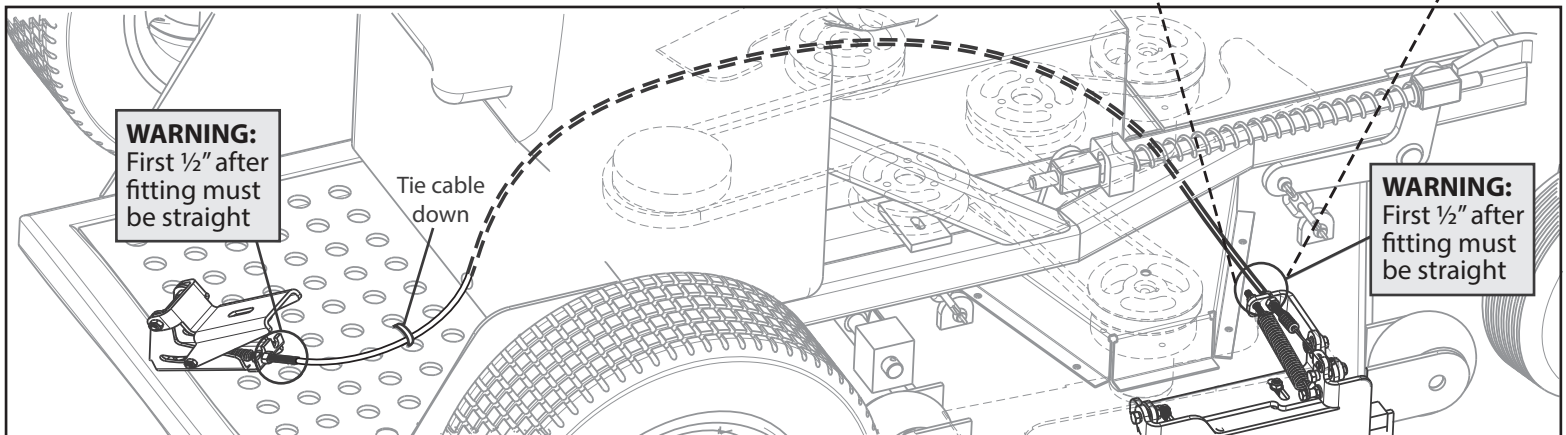
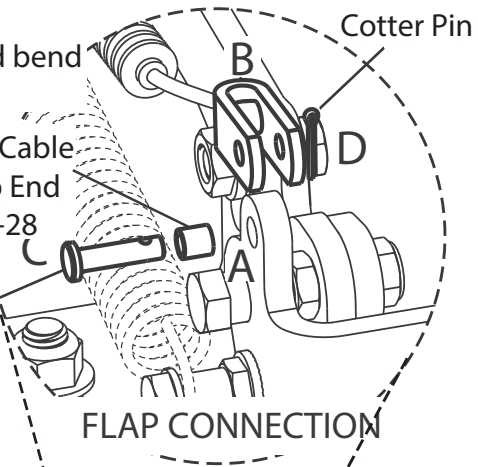

SEL Pedal Location & Cable Routing

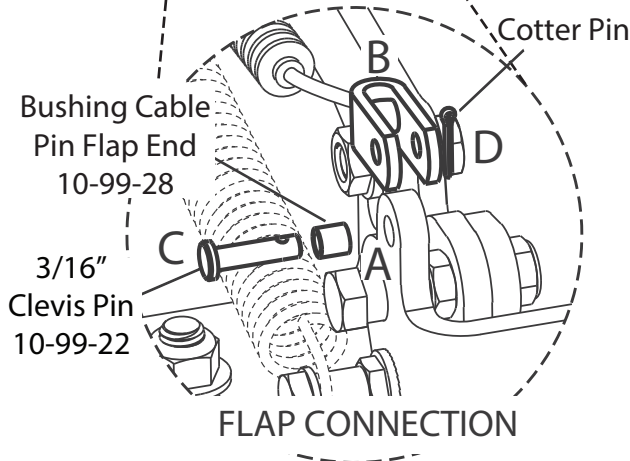
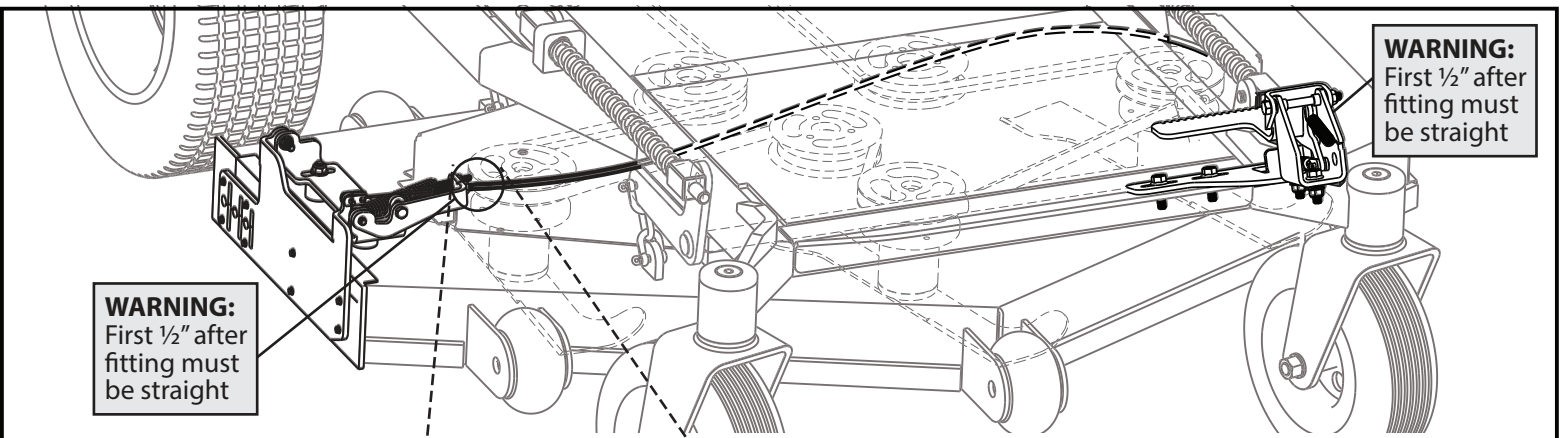
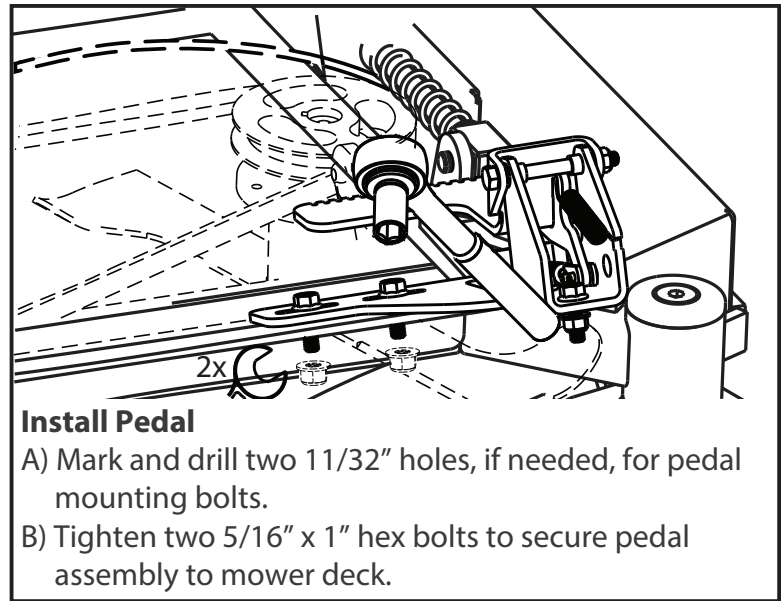
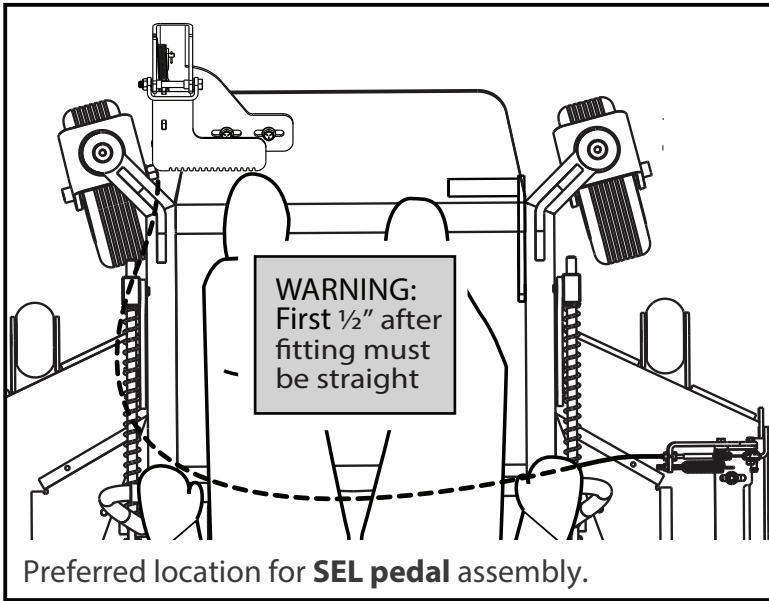

Flap Connection:

- A) Place 1/4" bushing in flap.
- B) Slip clevis onto flap.
- C) Insert 3/16" pin with head on spring side.
- D) Insert cotter pin and bend around pin.



FLAP CONNECTION

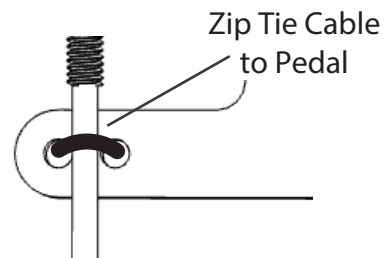

RE Pedal Location & Cable Routing

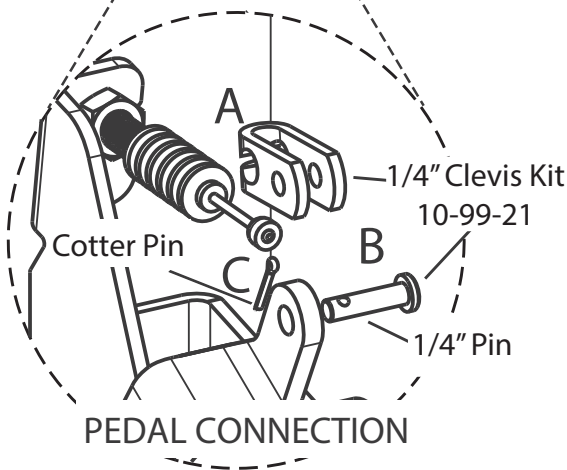
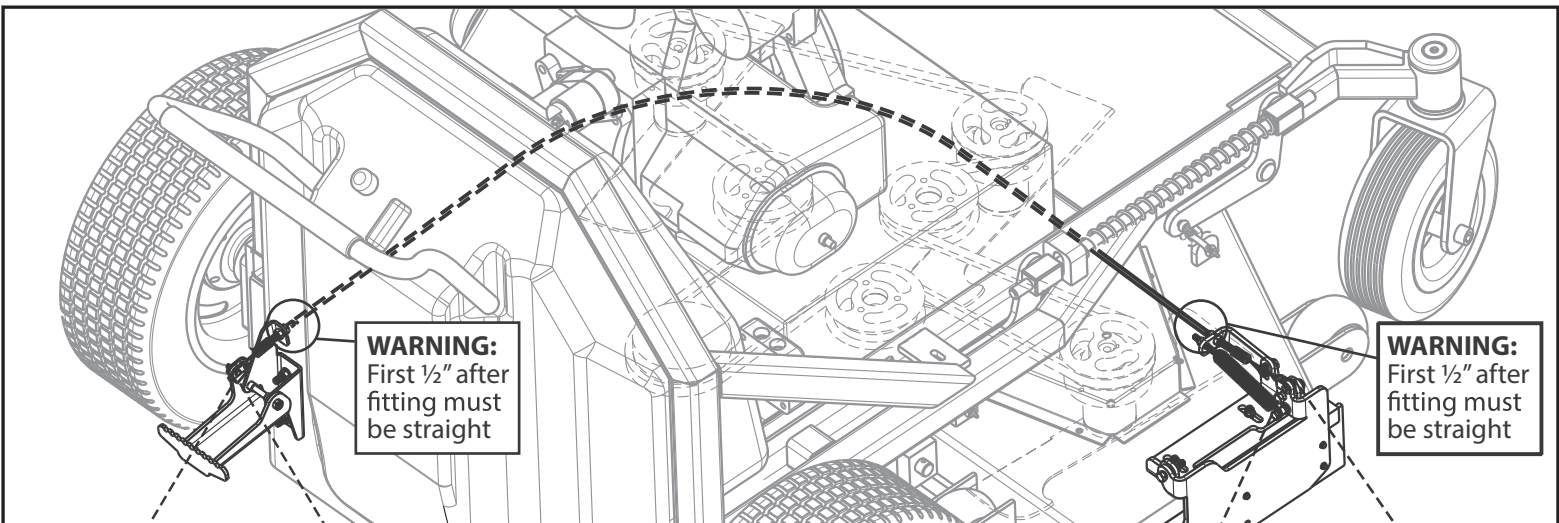
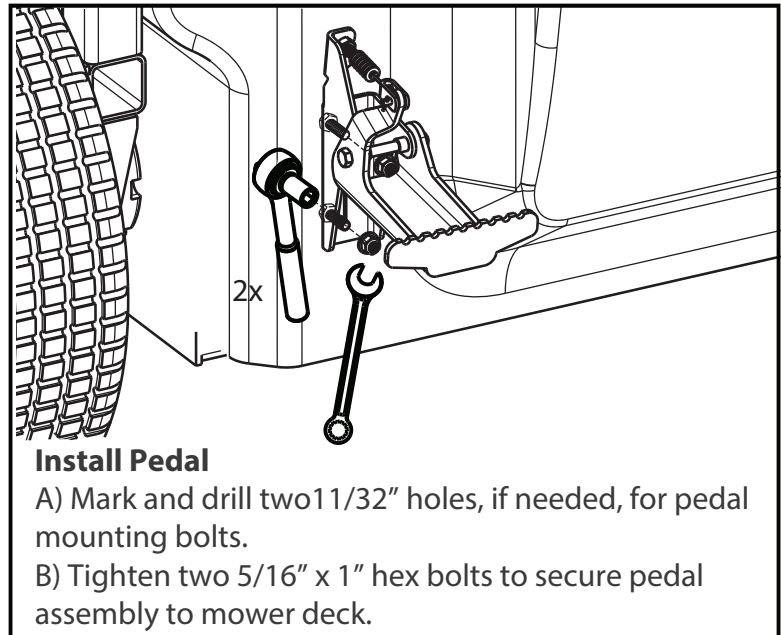
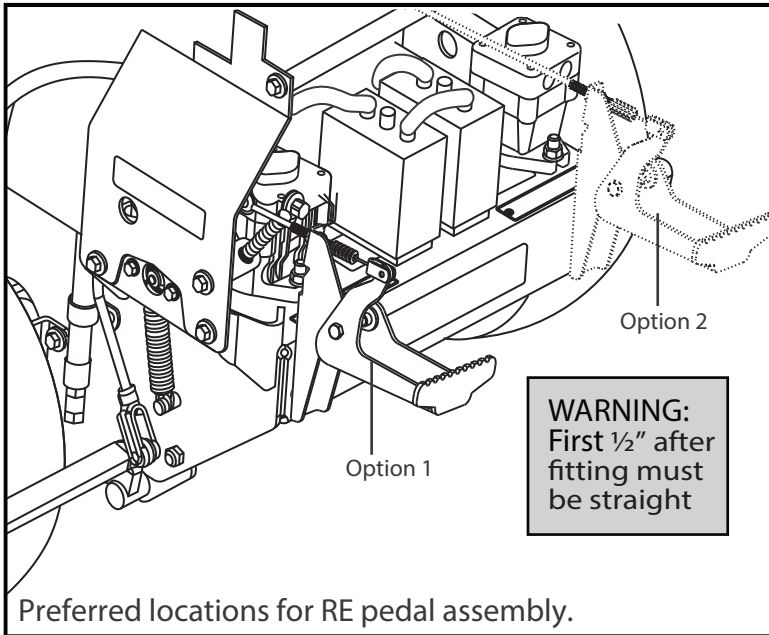

Pedal Connection:

- Place clevis on cable ball and squarely seat in bottom of clevis.
- Insert 1/4" diameter pin.
- Insert cotter pin and wrap around pin.

Flap Connection:

- Place 1/4" bushing in flap.
- Slip clevis onto flap.
- Insert 3/16" pin with head on spring side.
- Insert cotter pin and wrap around pin.

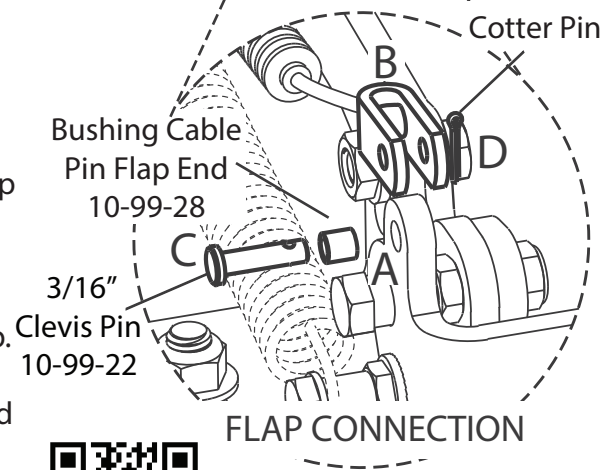

FLAP CONNECTION