

Bushing Kit for Flap Assembly Instructions

Flap with Small Hole Spring Mount

1. Unhook spring from spring bolt.
2. Disassemble pivot bolt & bushing.
3. Assemble rear and front bushings as shown. (head of bolt, head of bushing, hinge plate, serrated nut)
4. Slip flap mount to hinge plate.
5. Install spring mount and center punch locknut on front pivot bolt and secure leaving small gap between bushing and jam nut.
6. Shift hinge plate so front bushing tab is against head of bushing.
7. Position rear bushing bolt so flap bushing tab is centered on bushing by adjusting serrated nut.
8. Install center punch locknut on rear pivot bolt and secure to serrated nut.
9. On both rear and front assembly, verify there is a gap between bushing and serrated nut and flap can rotate.
10. Reconnect spring to spring bolt.

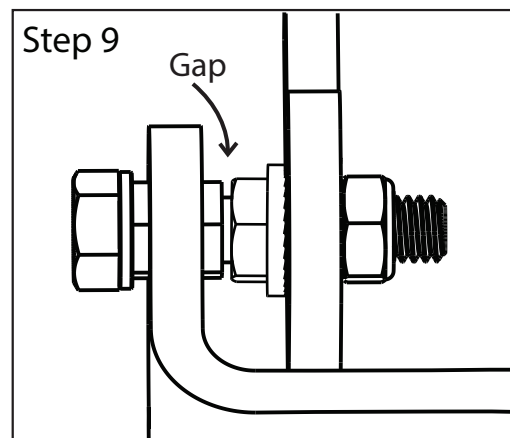
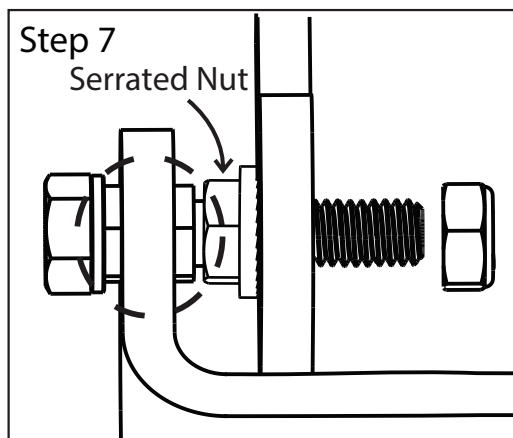
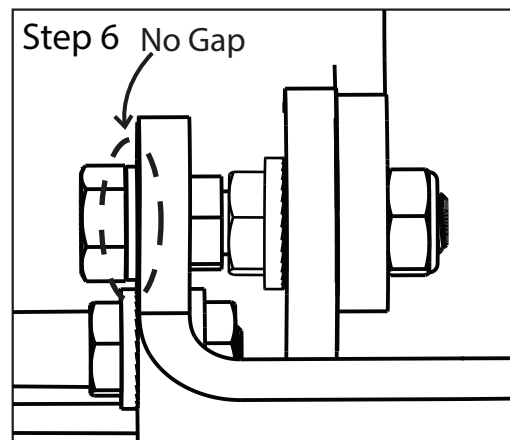
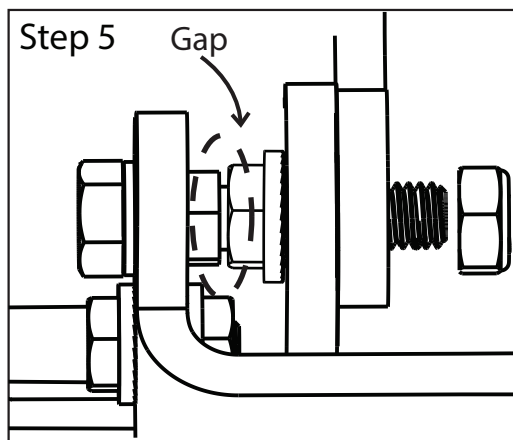
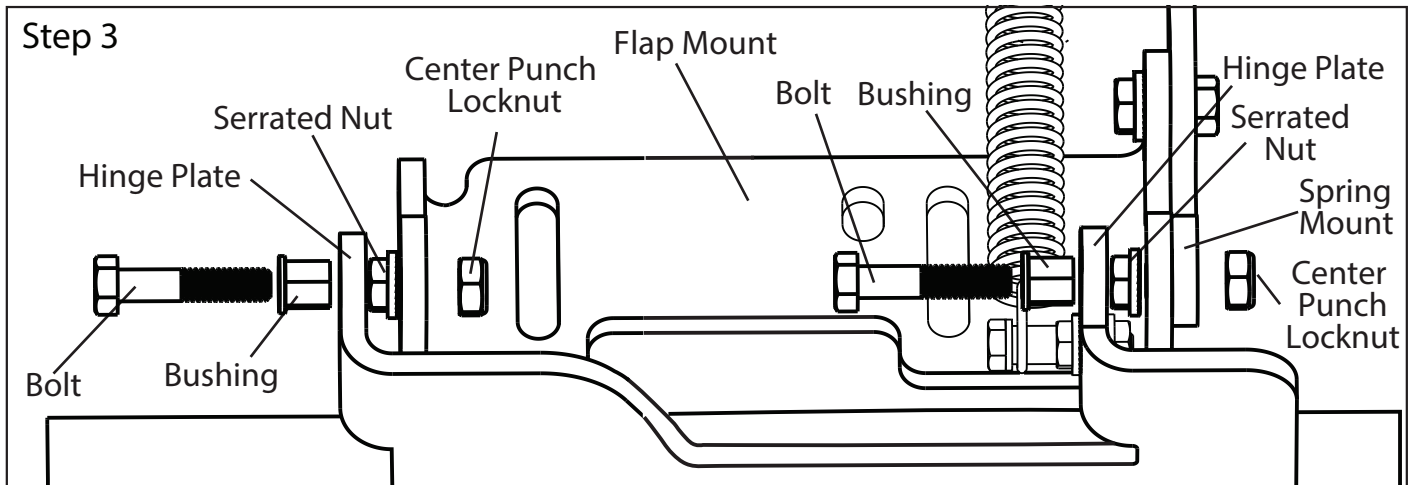

Flap with Large Hole Spring Mount

1. Remove spring mount from flap.
2. Disassemble pivot bolt & bushing.
3. Assemble rear and front bushings as shown. (head of bolt, head of bushing, hinge plate, serrated nut)
4. Slip flap mount to hinge plate.
5. Install center punch locknut on front pivot bolt and secure leaving small gap between bushing and serrated nut.
6. Shift hinge plate so front bushing tab is against head of bushing.
7. Position rear bushing bolt so flap bushing tab is centered on bushing by adjusting serrated nut.
8. Install center punch locknut on rear pivot bolt and secure to serrated nut.
9. On both rear and front assembly, verify there is a gap between bushing and serrated nut and flap can rotate.
10. Reinstall spring mount and connect spring to spring bolt.

