

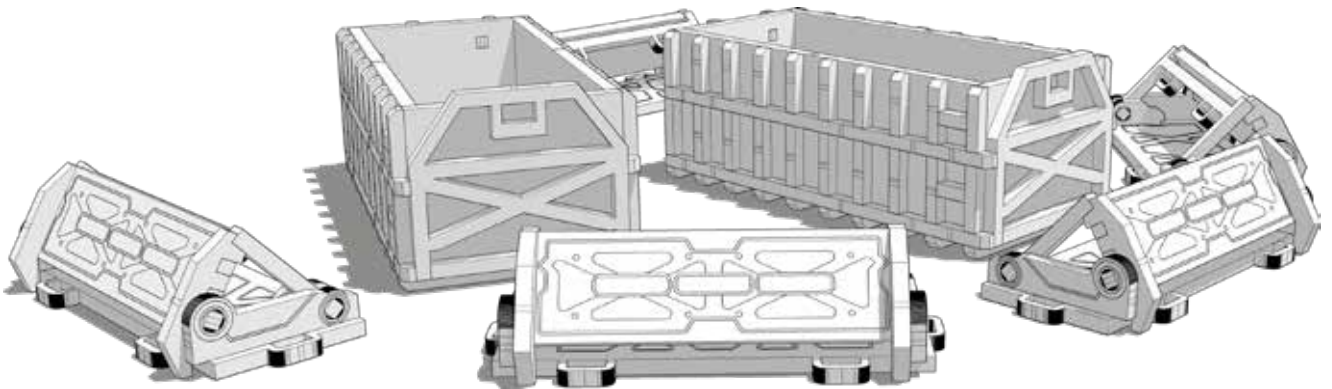

**TABLETOP
SCENICS**

**TTSCW-SFU-166
QDB's and Refuse**



 **TTCOMBAT**



TABLETOP SCENICS

TTSCW-SFU-166
QDB's and Refuse

2

These are a series of icons that may be used throughout the instructions to help your assembly.
If in doubt, scroll ahead to confirm.



Do not glue this part

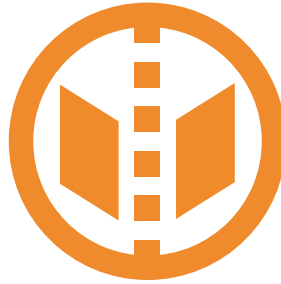

Carefully score and
fold this part

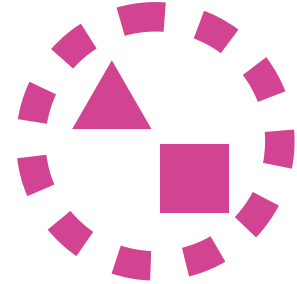

This part - or its placement is
completely optional



Look closely at this step -
The process order or part
used, may be specific



Repeat making this part
the specified number
of times

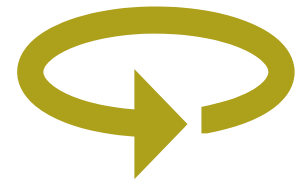

The next instruction step
will be the same assembly
so far, but from a different
angle

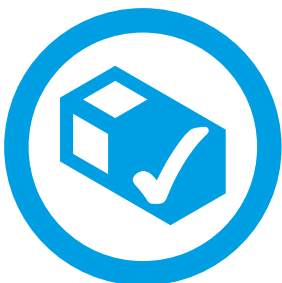

Sub-assembly complete.
This smaller construction
is ready to add to the
main kit



Assembly Complete! There
could be more optional
parts - check to the very end
of instructions



FRAGILE: DO NOT BEND.
“Bendy wood” is designed to
curve around a designed
frame only.



TABLETOP SCENICS

TTSCW-SFU-166
QDB's and Refuse

3

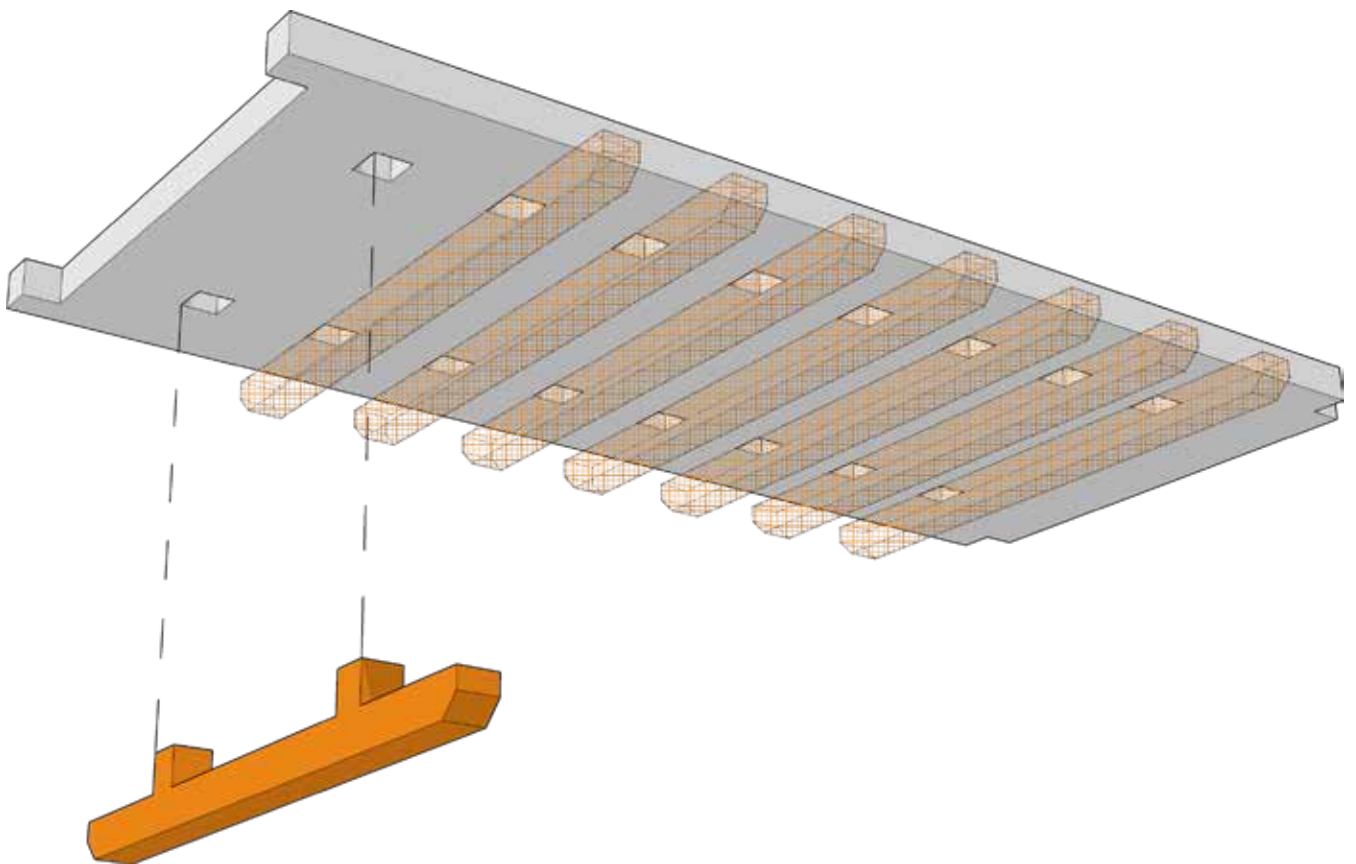

Repeat step for each slot



TABLETOP SCENICS

TTSCW-SFU-166
QDB's and Refuse

4

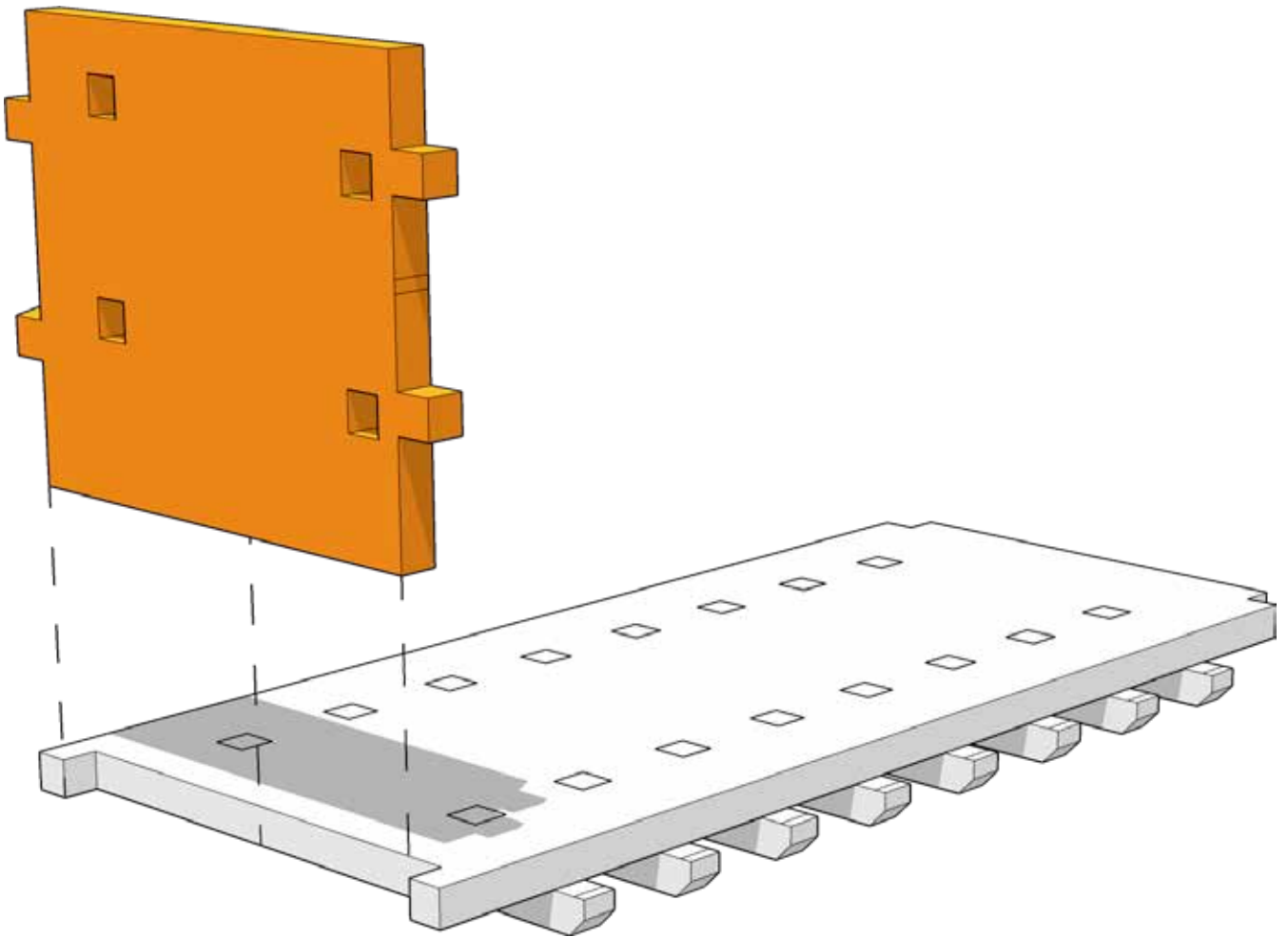

Highlighted part sits flush with the floor



TABLETOP SCENICS

TTSCW-SFU-166
QDB's and Refuse

5

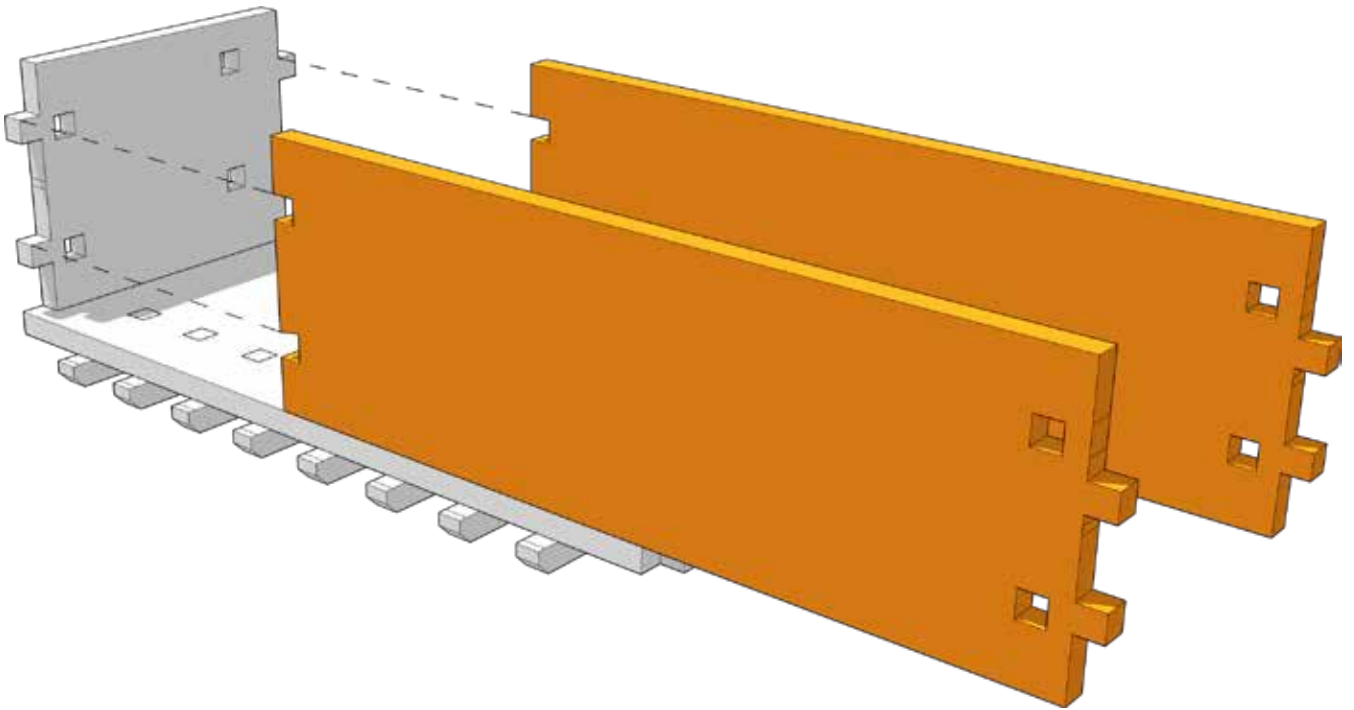

Make sure the holes in the highlighted part are
positioned as shown



 **TTCOMBAT**



TABLETOP SCENICS

TTSCW-SFU-166
QDB's and Refuse

6

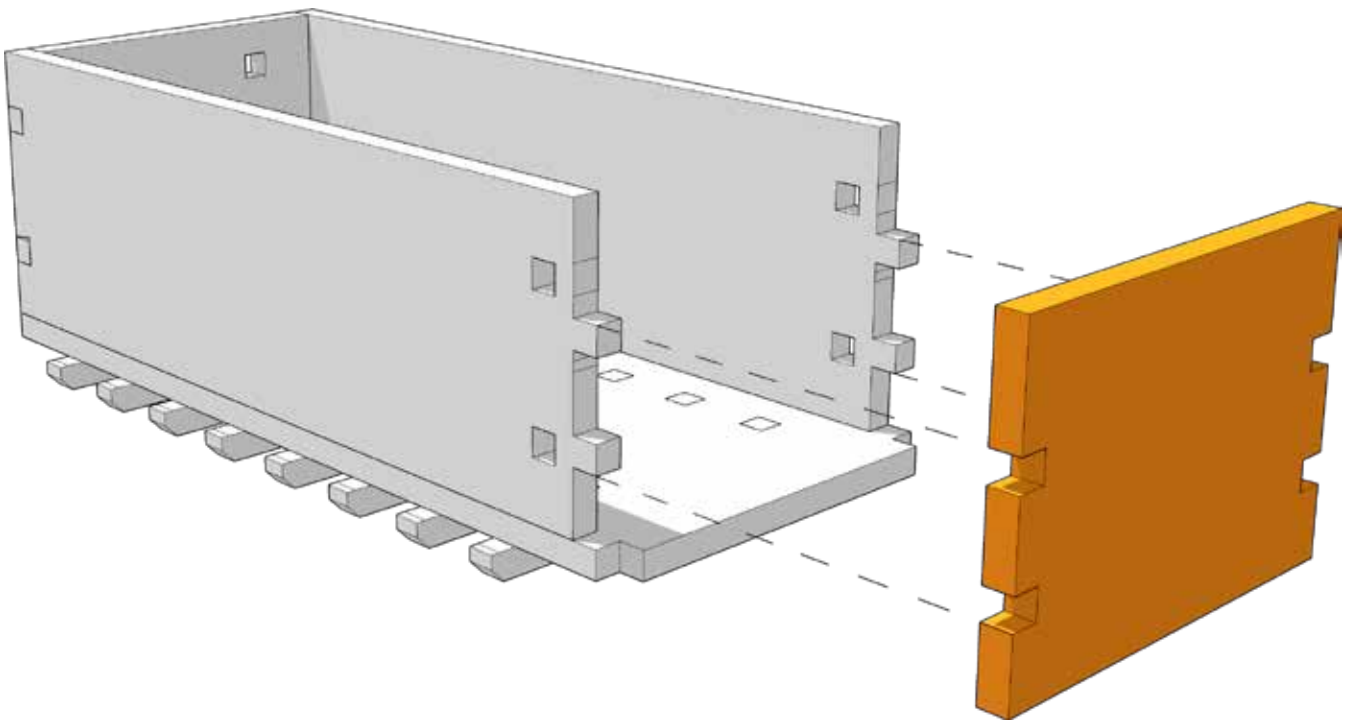



7

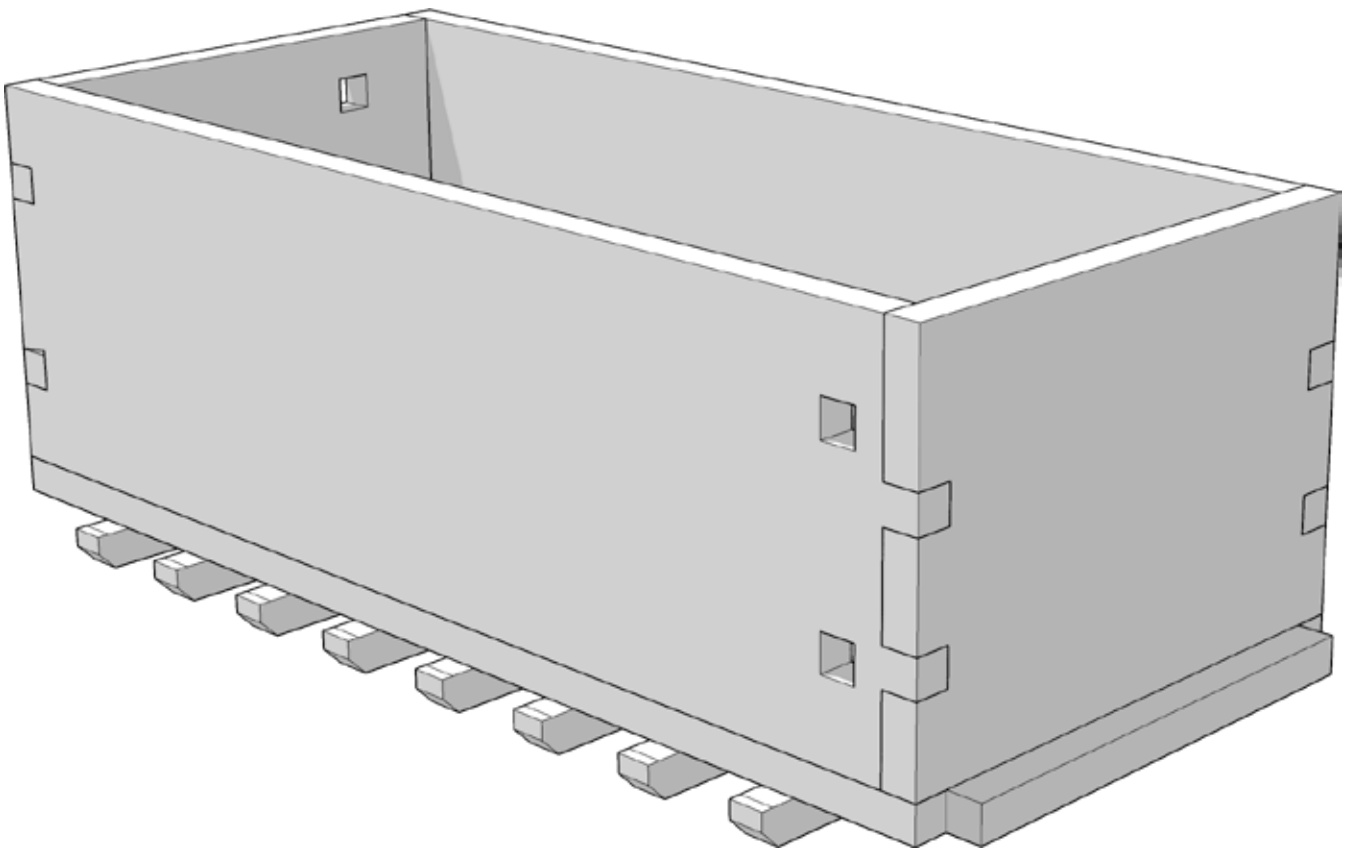



8

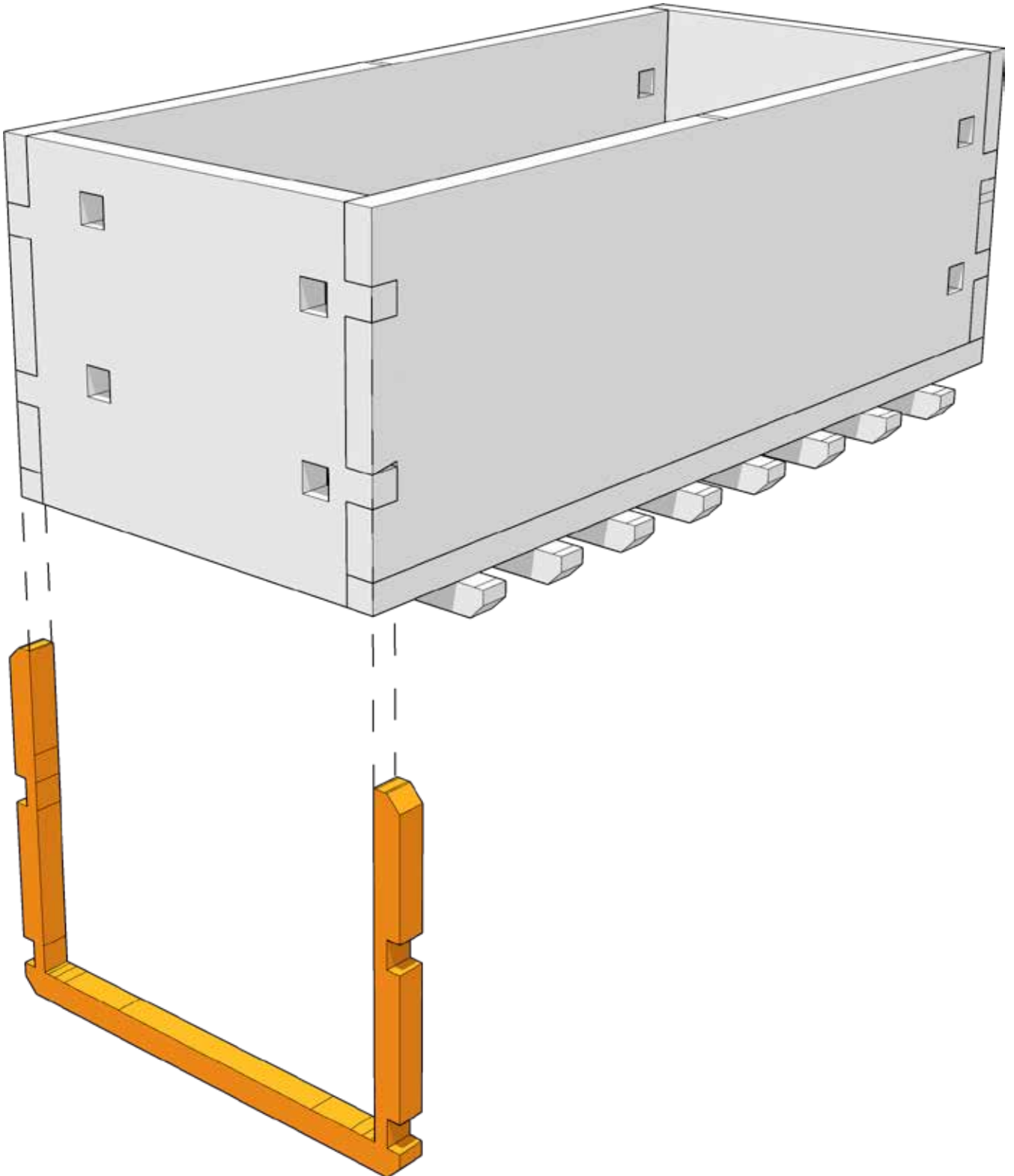

Highlighted part sits flush with the edge of the box. See next step if unsure.



9

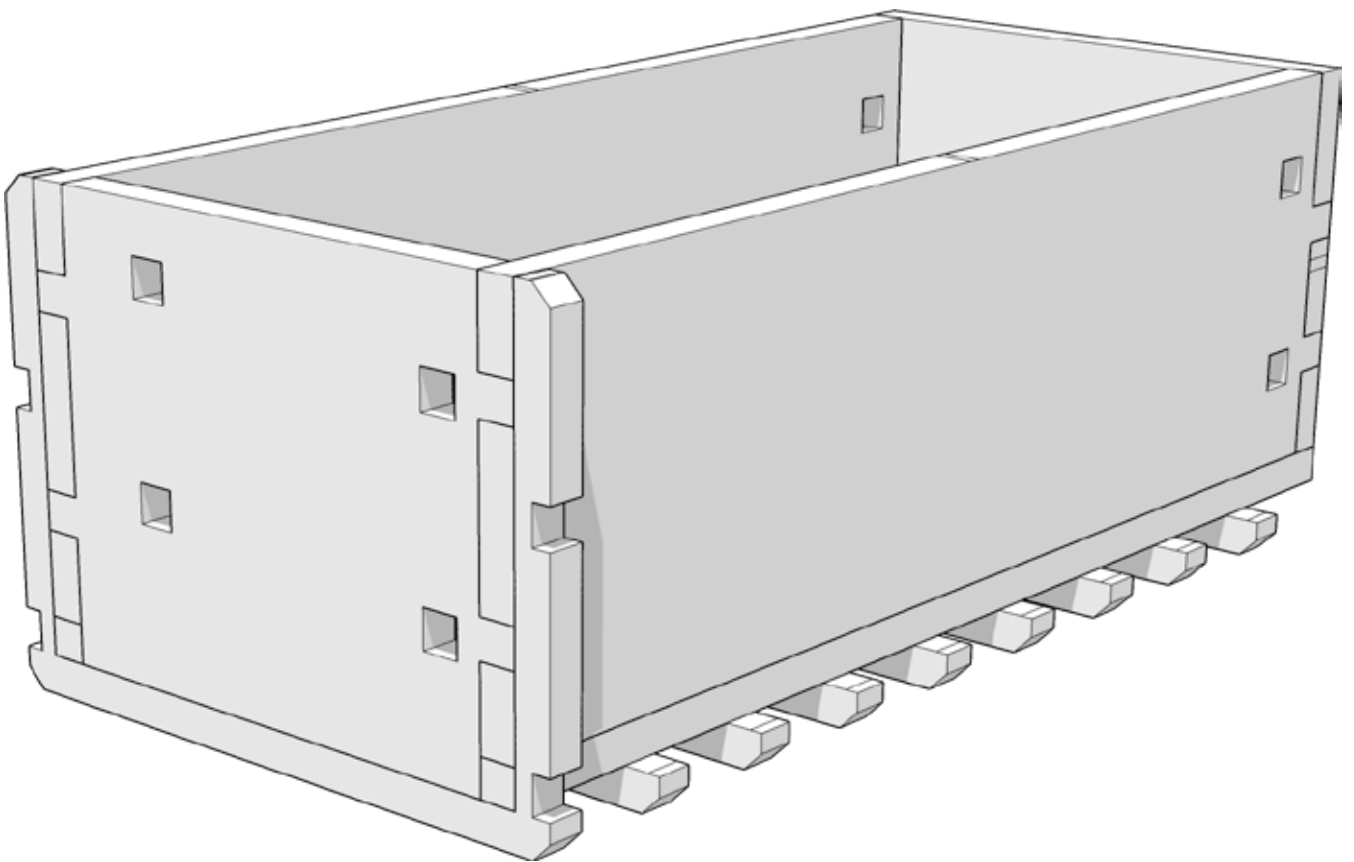



TABLETOP SCENICS

TTSCW-SFU-166
QDB's and Refuse

10

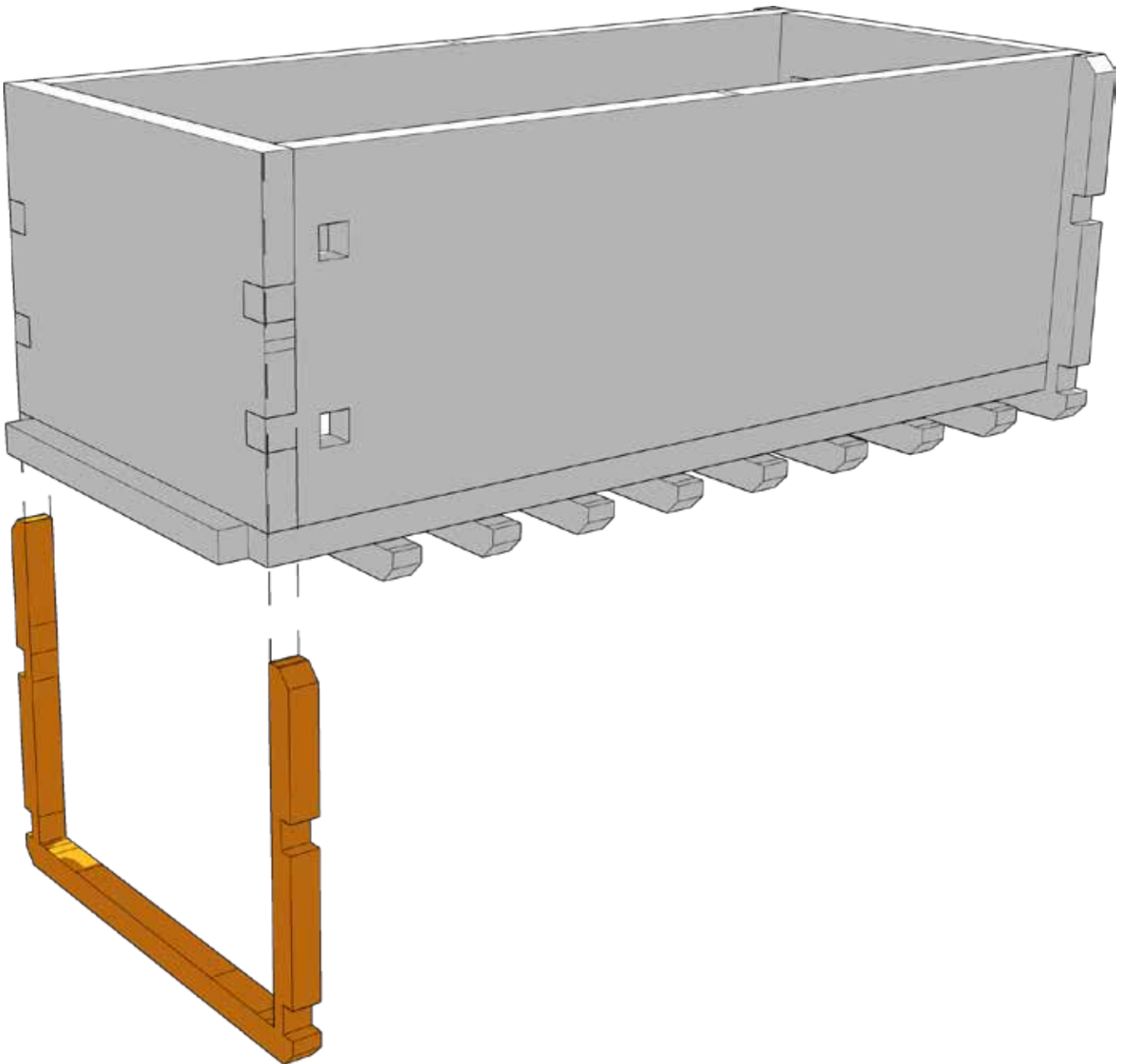

Highlighted part sits flush against the edge of
the box



11

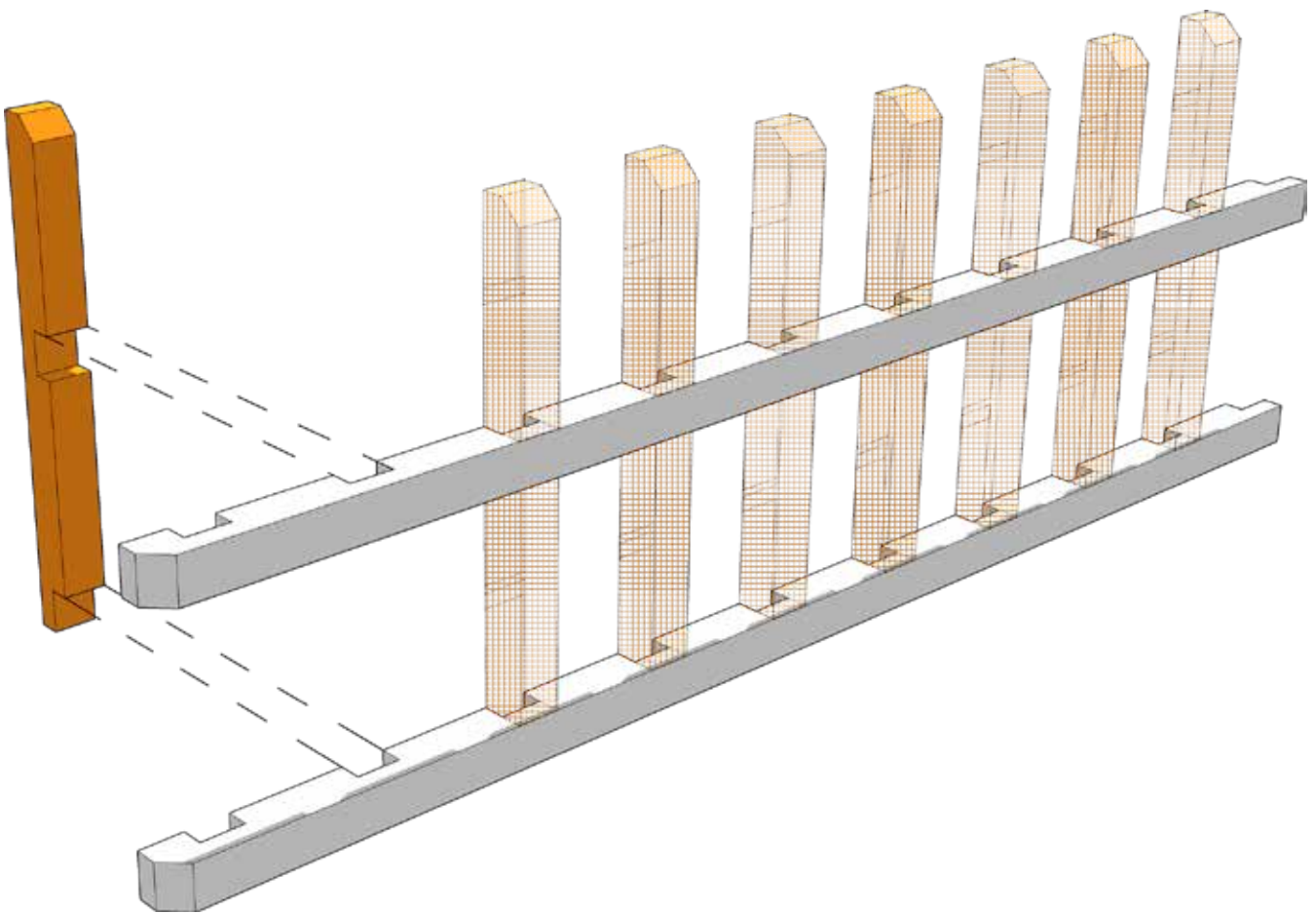

Keep the end slots free on both ends. Make sure the long strips are positioned as shown





TABLETOP SCENICS

TTSCW-SFU-166
QDB's and Refuse

12

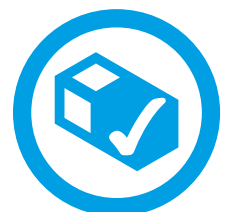
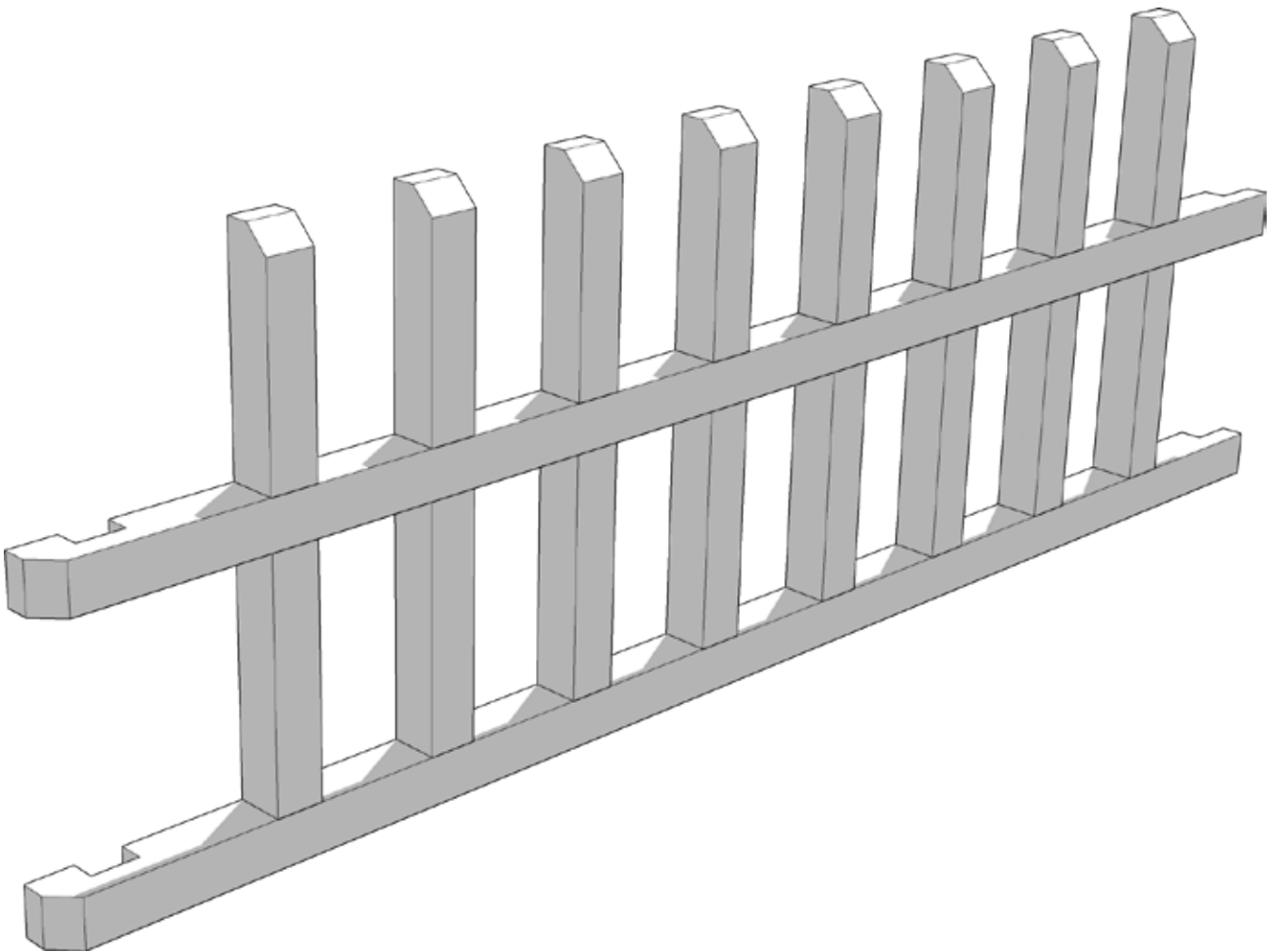



TABLETOP SCENICS

TTSCW-SFU-166
QDB's and Refuse

13

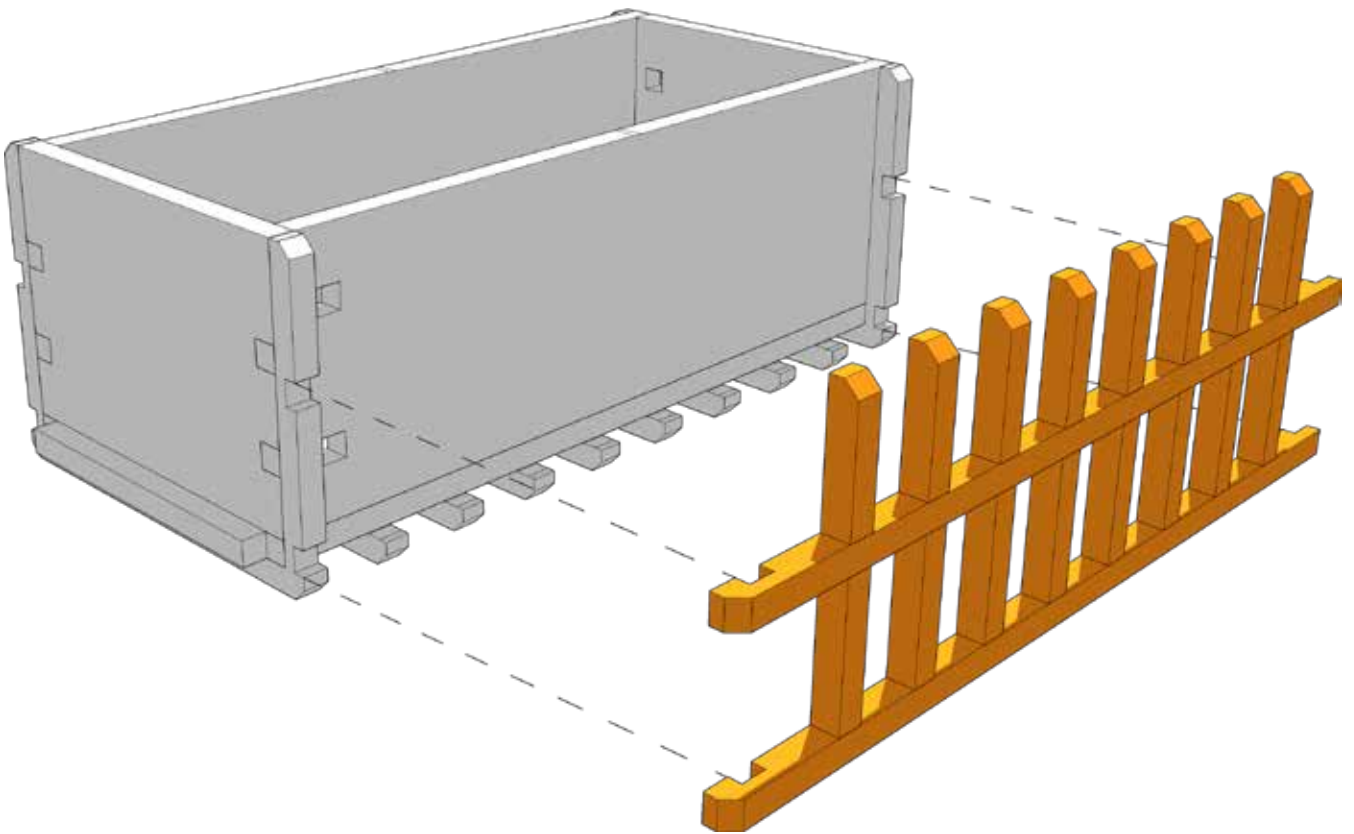

Highlighted part and box must match positions as shown



TABLETOP SCENICS

TTSCW-SFU-166
QDB's and Refuse

14

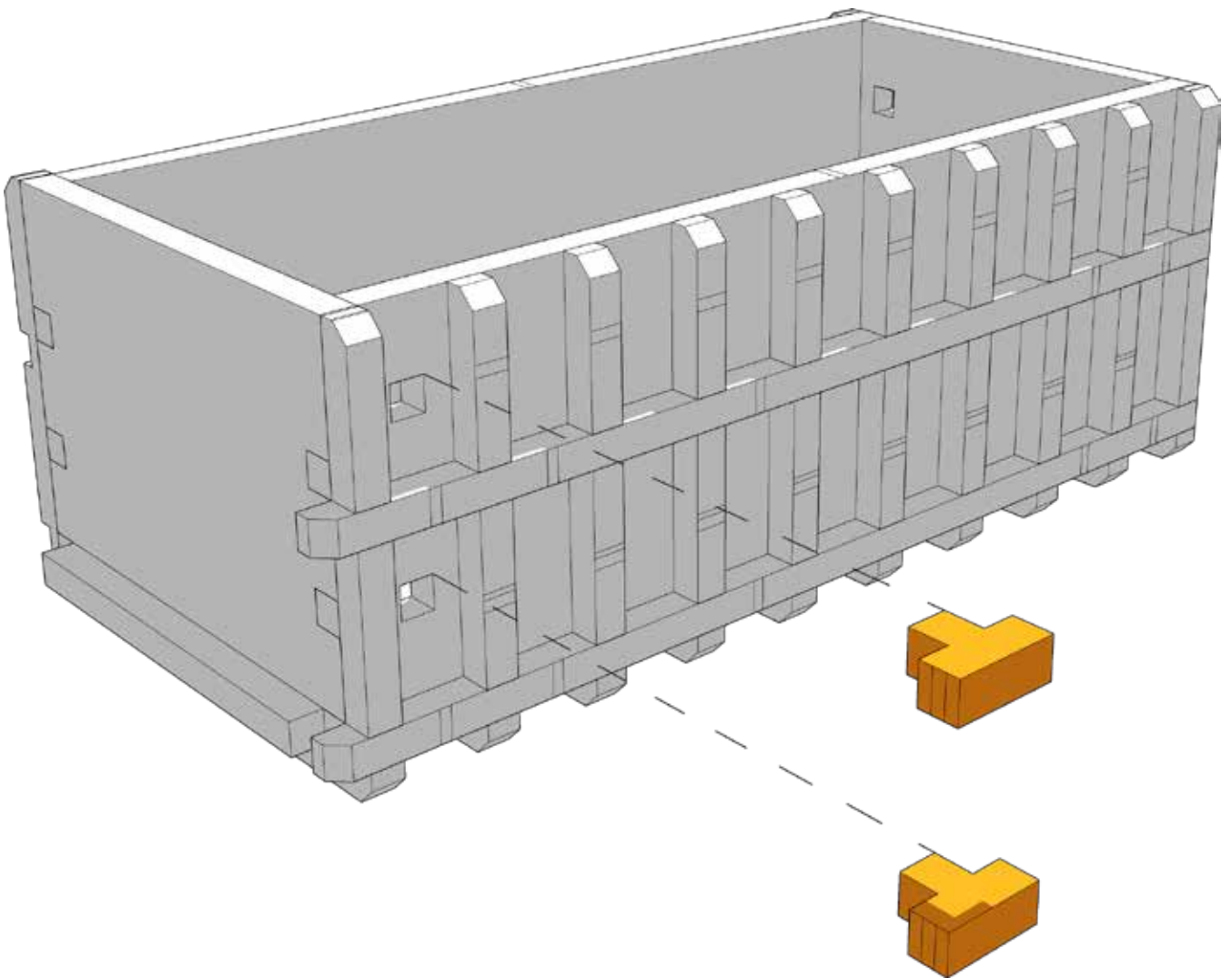



TABLETOP SCENICS

TTSCW-SFU-166
QDB's and Refuse

15

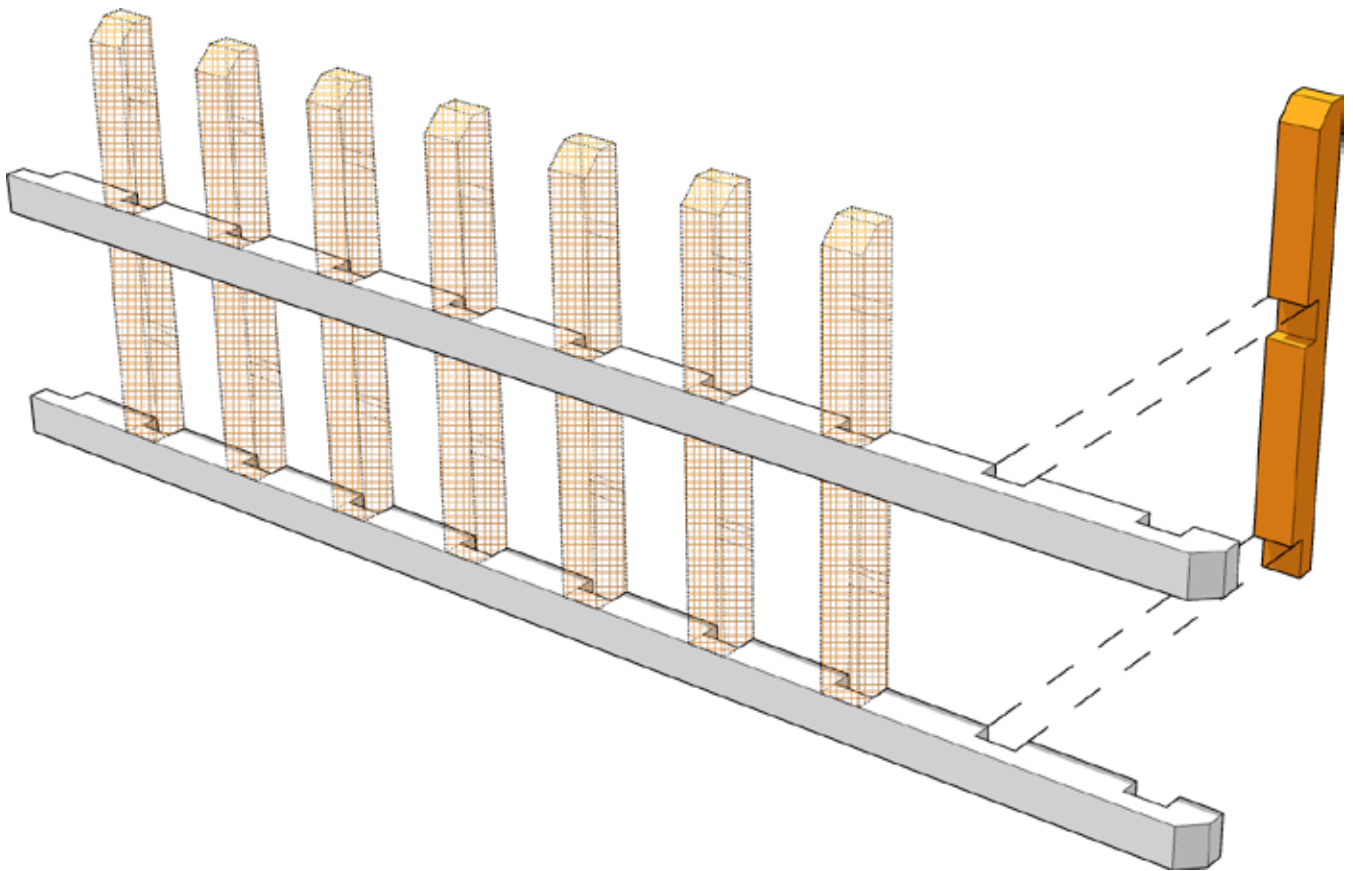

Keep the end slots free on both ends. Make sure the long strips are positioned as shown



 **TTCOMBAT**



TABLETOP SCENICS

TTSCW-SFU-166
QDB's and Refuse

16

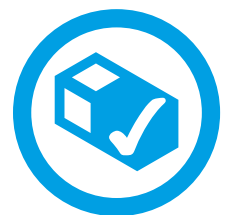
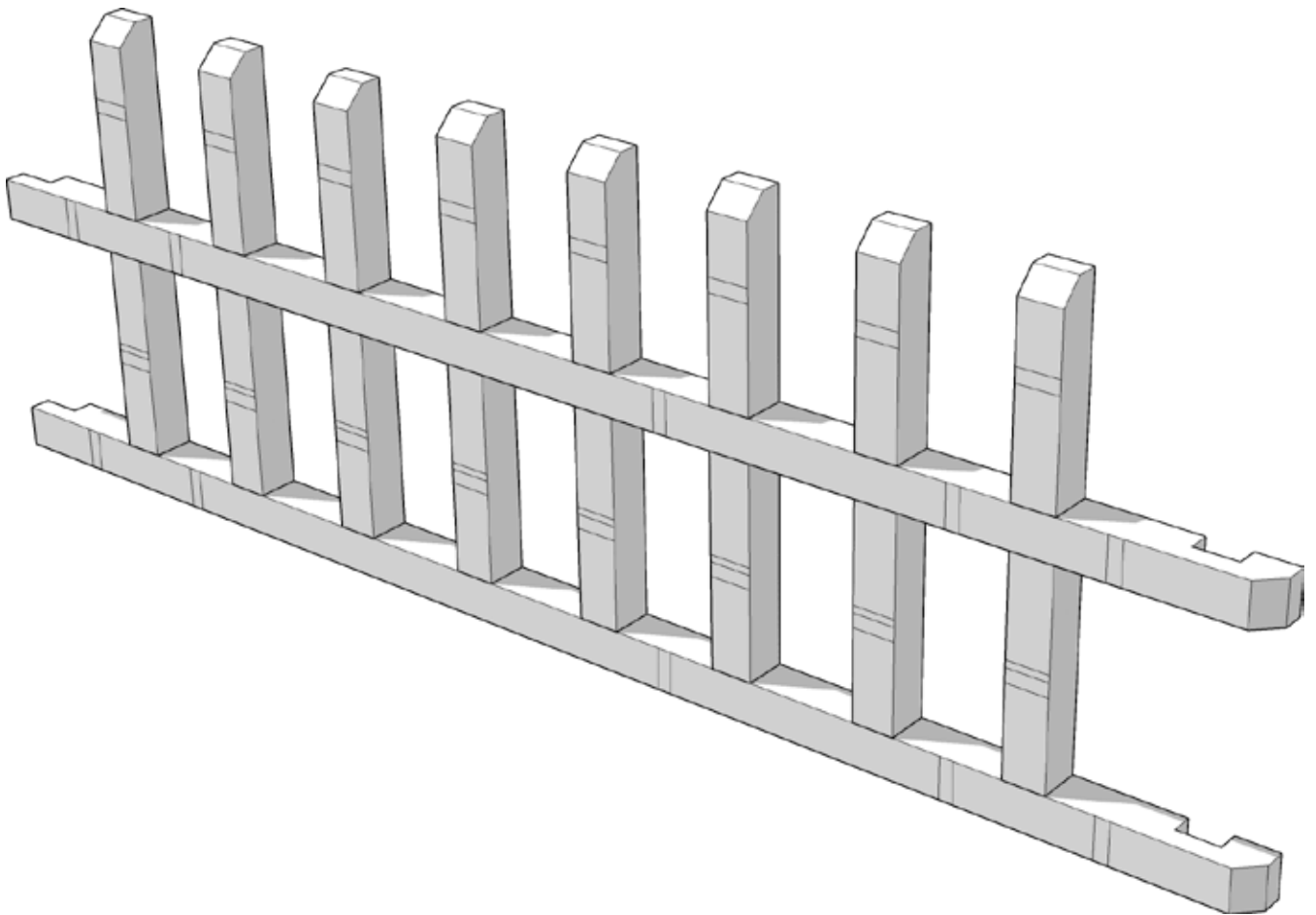



TABLETOP SCENICS

TTSCW-SFU-166
QDB's and Refuse

17

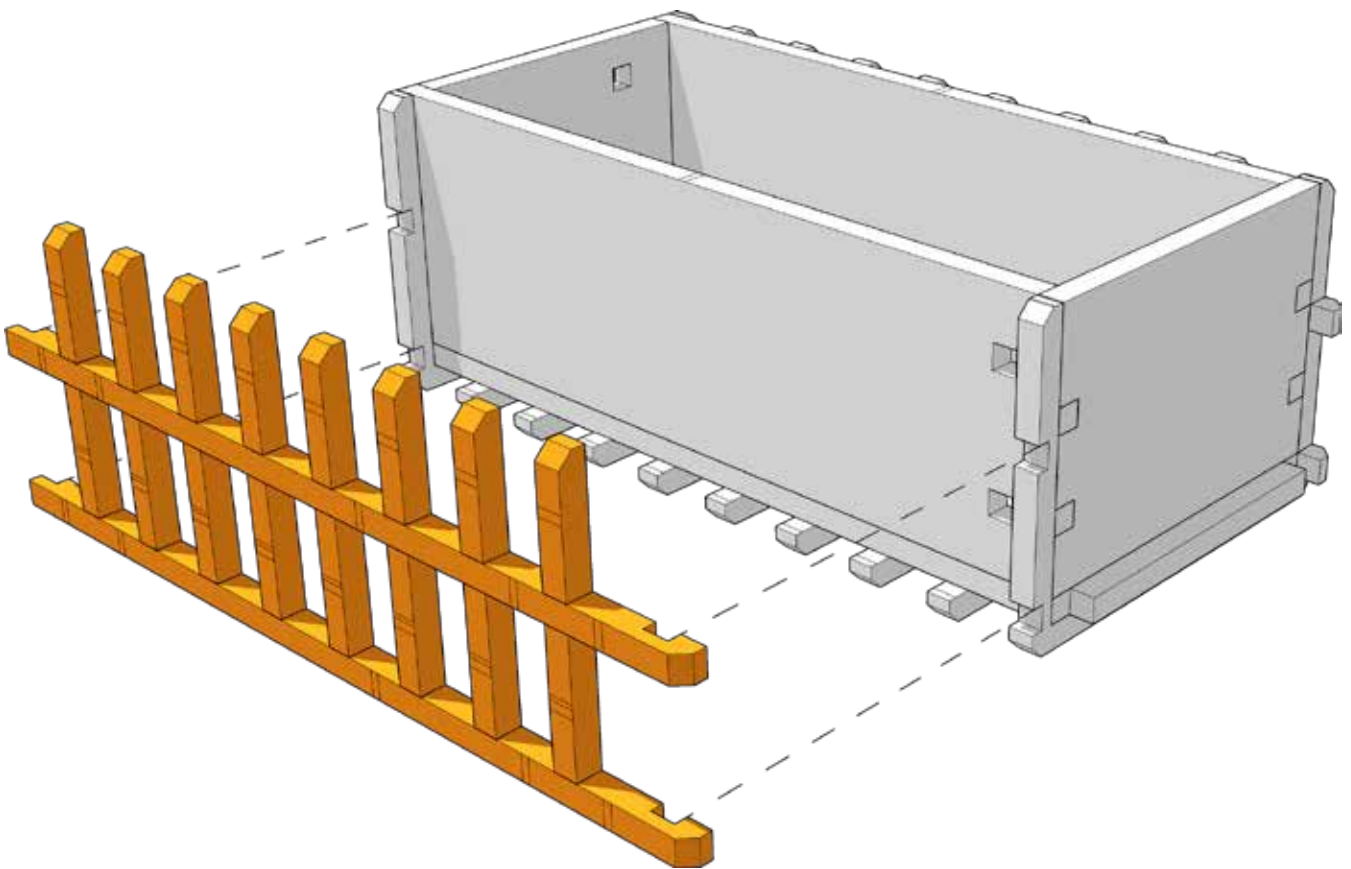

Highlighted part and box must match positions as shown



TABLETOP SCENICS

TTSCW-SFU-166
QDB's and Refuse

18

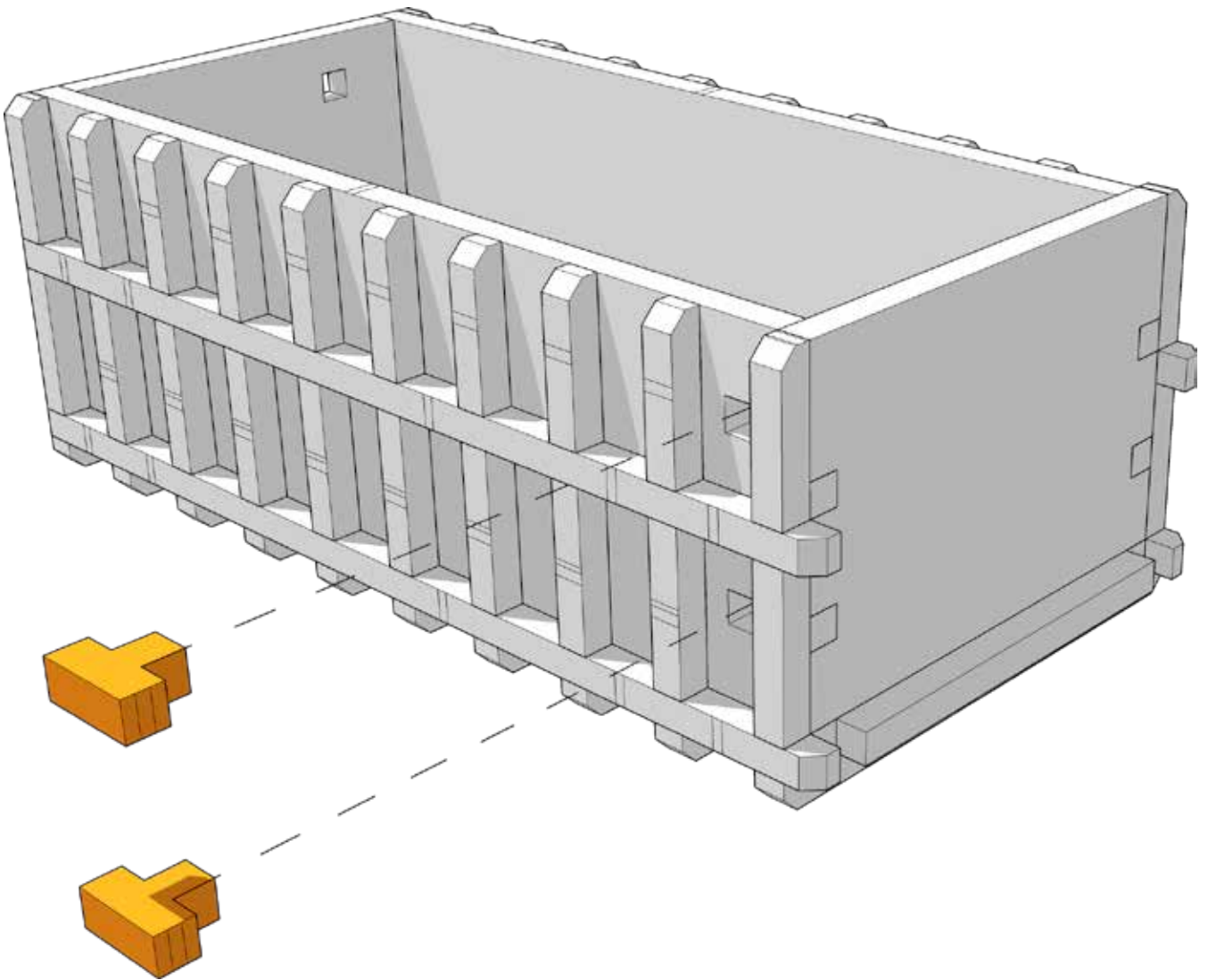



TABLETOP SCENICS

TTSCW-SFU-166
QDB's and Refuse

19

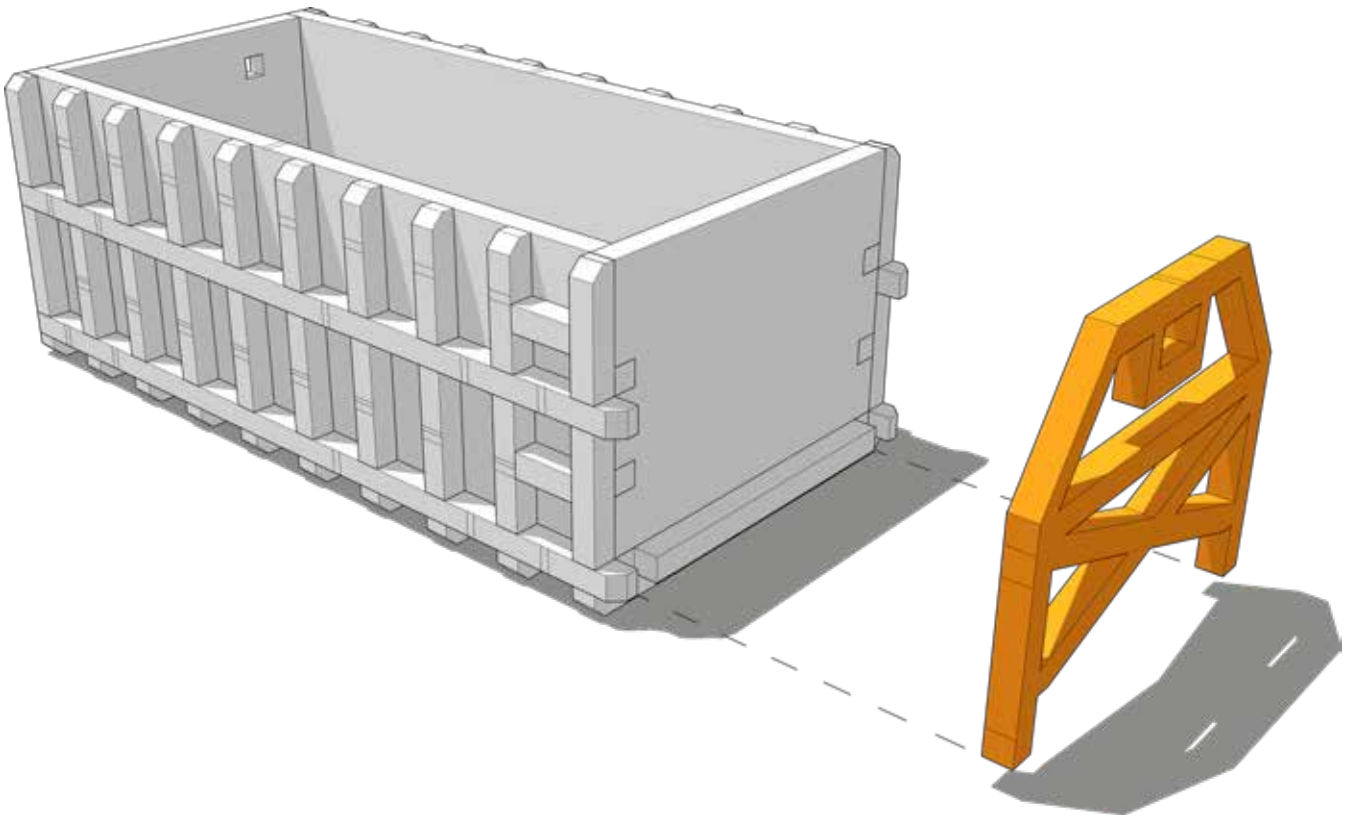

See next step for position if unsure



TABLETOP SCENICS

TTSCW-SFU-166
QDB's and Refuse

20

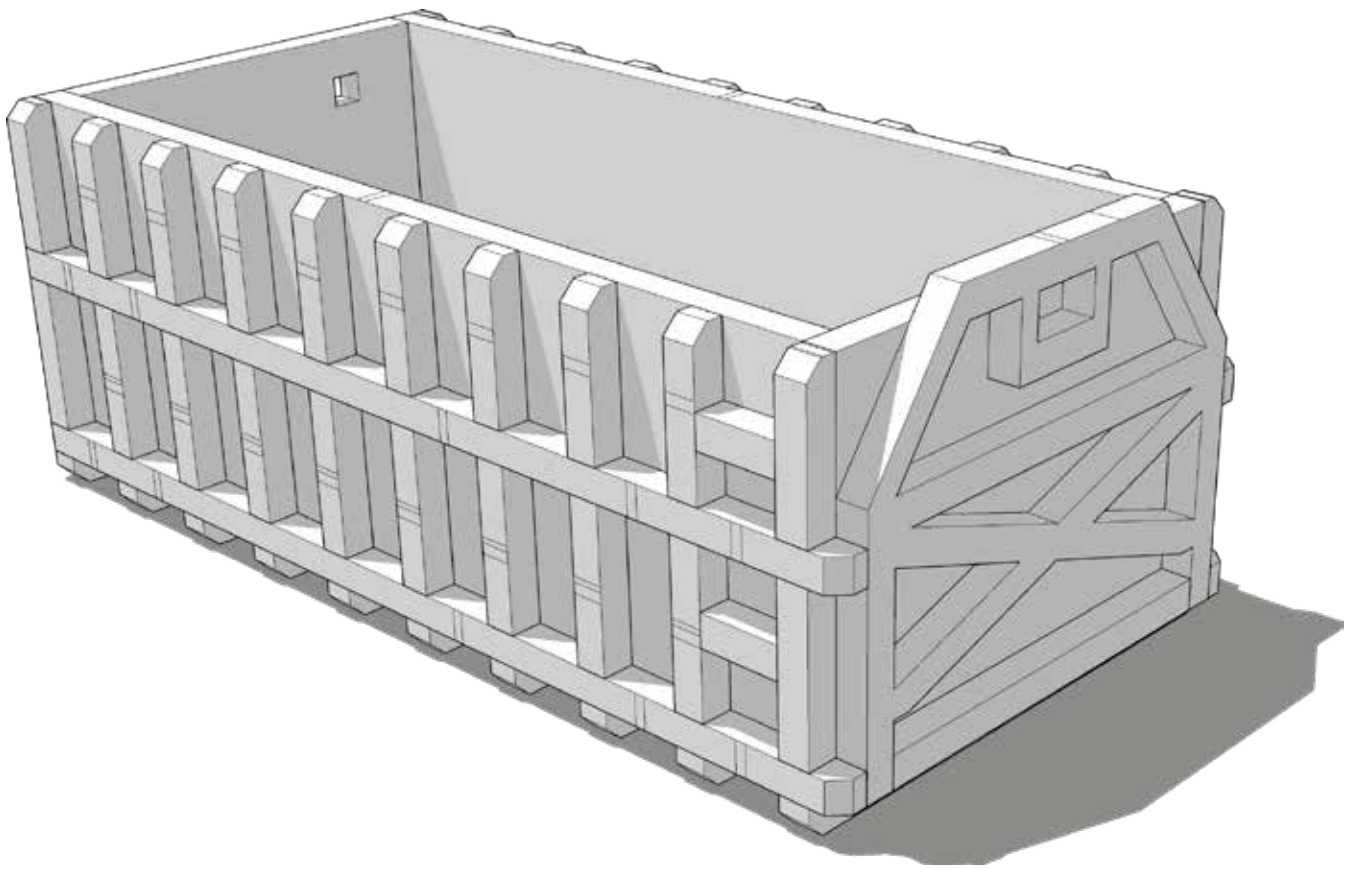



TABLETOP SCENICS

TTSCW-SFU-166
QDB's and Refuse

21

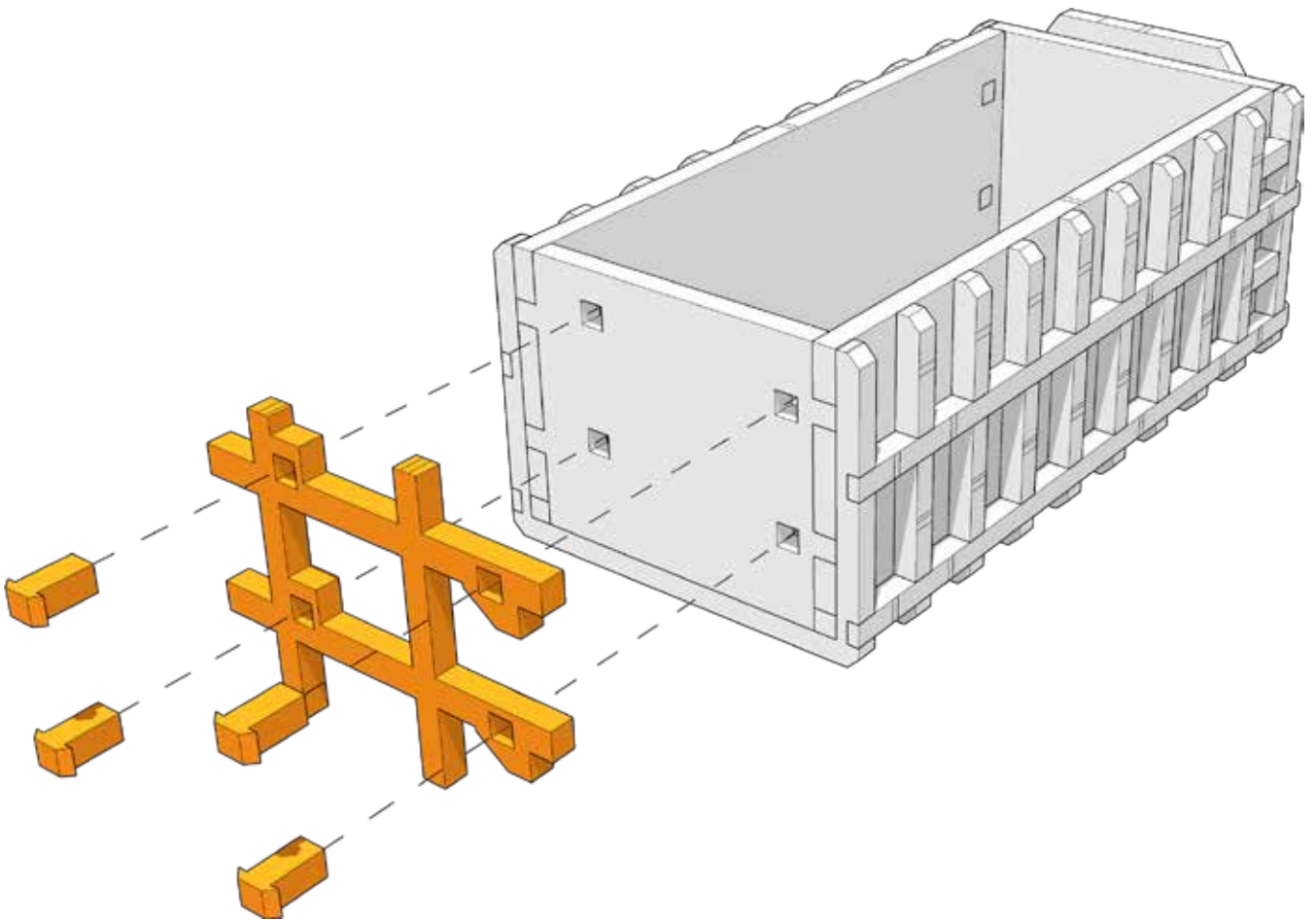



TABLETOP SCENICS

TTSCW-SFU-166
QDB's and Refuse

22

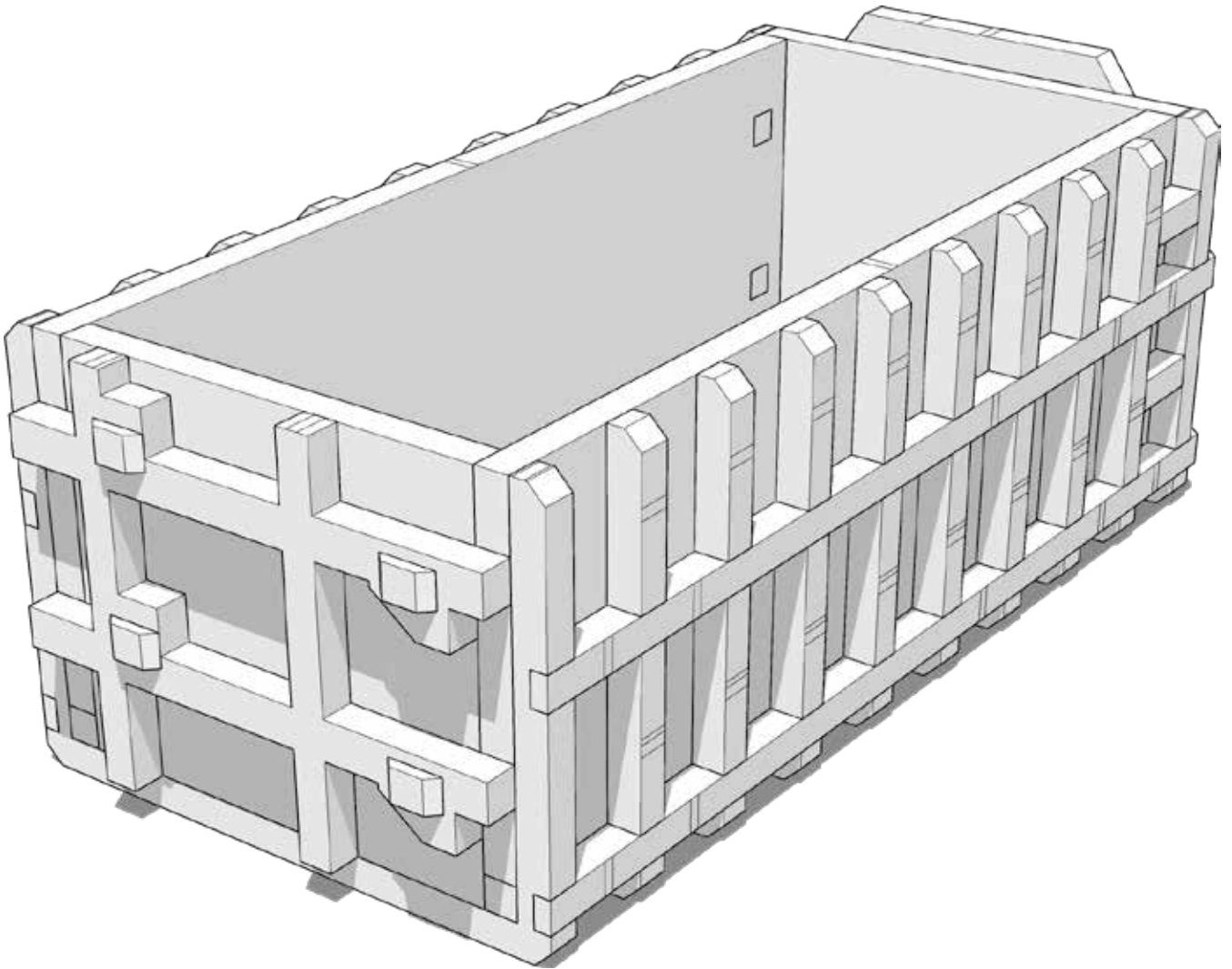

x2



23

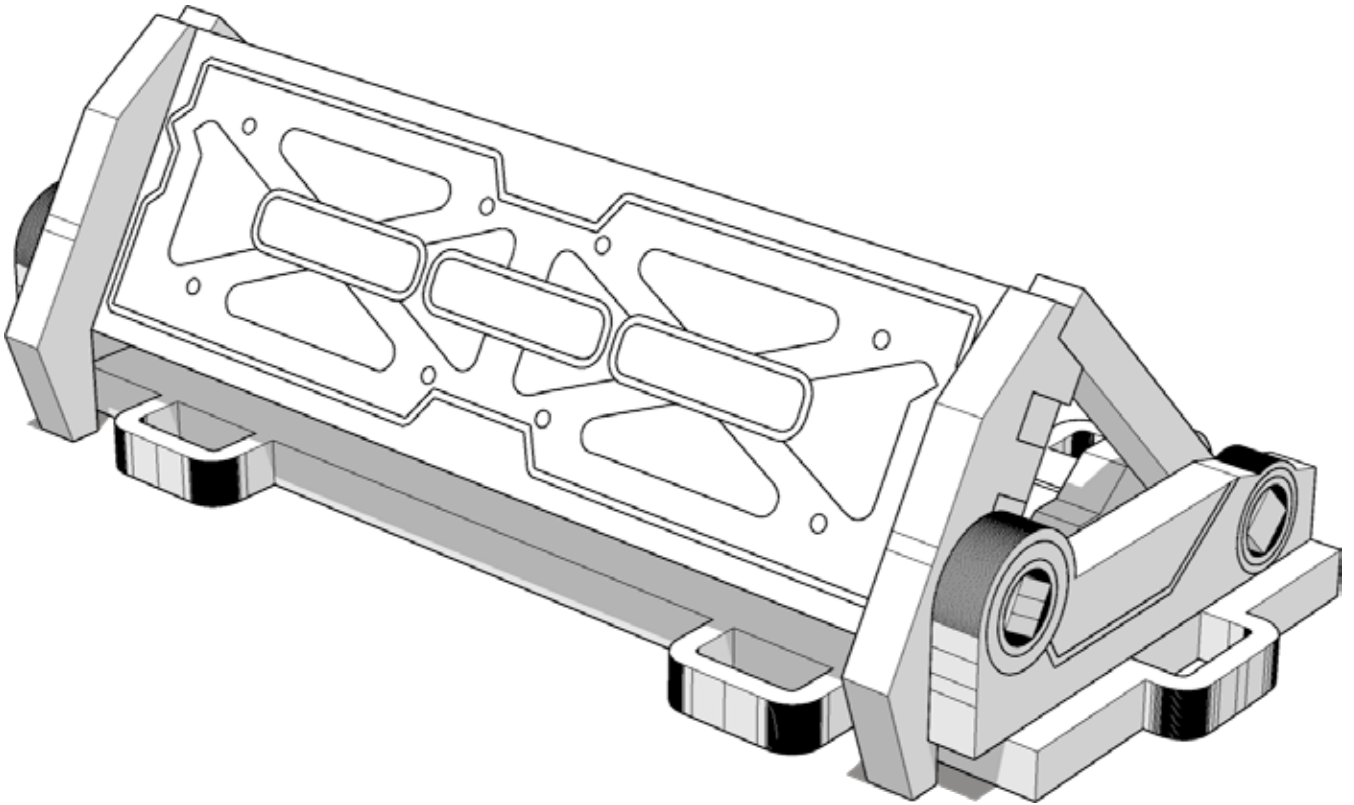

Q.D.B (Quick Deployment Barrier)



24

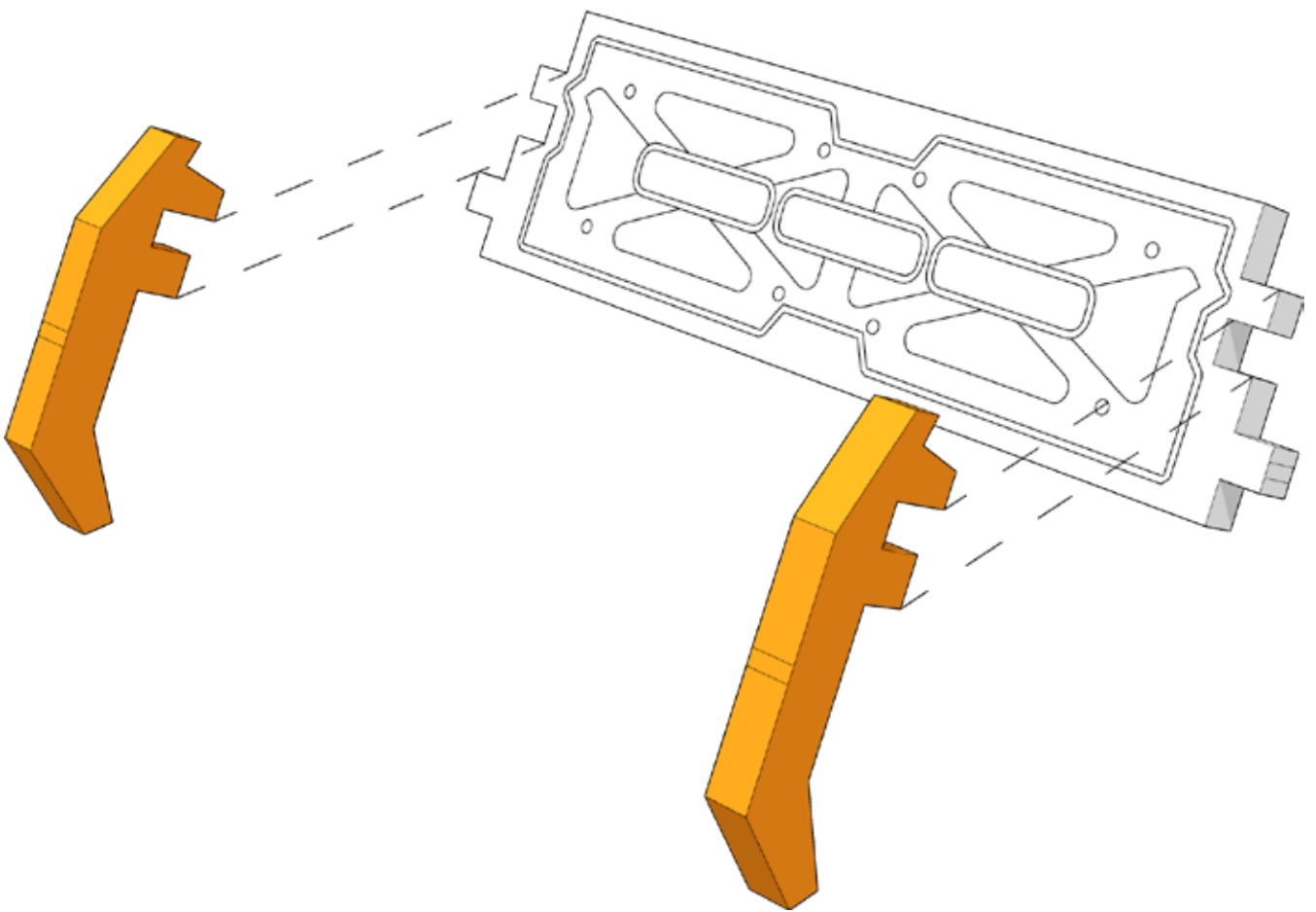



TABLETOP SCENICS

TTSCW-SFU-166
QDB's and Refuse

25

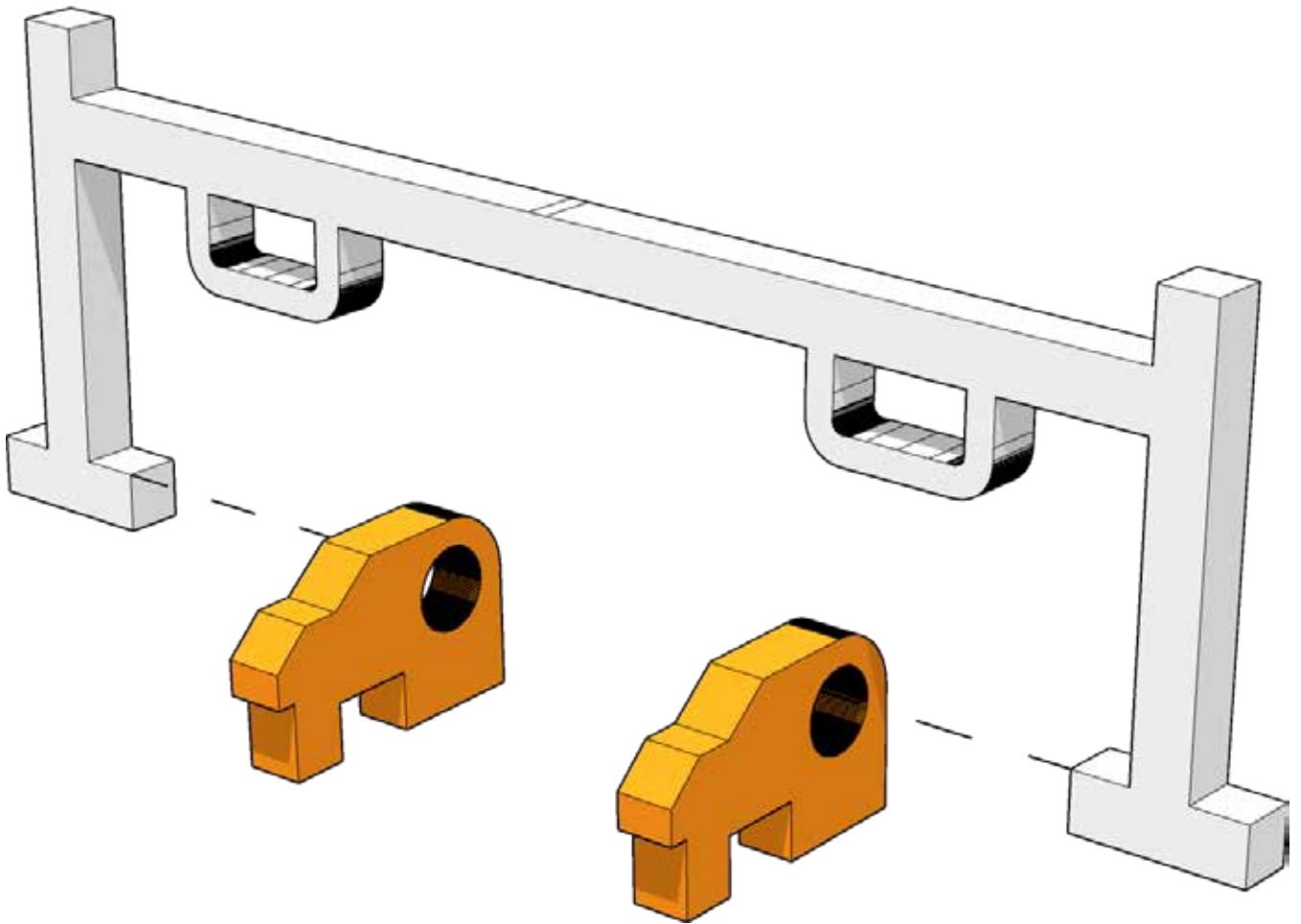



TABLETOP SCENICS

TTSCW-SFU-166
QDB's and Refuse

26

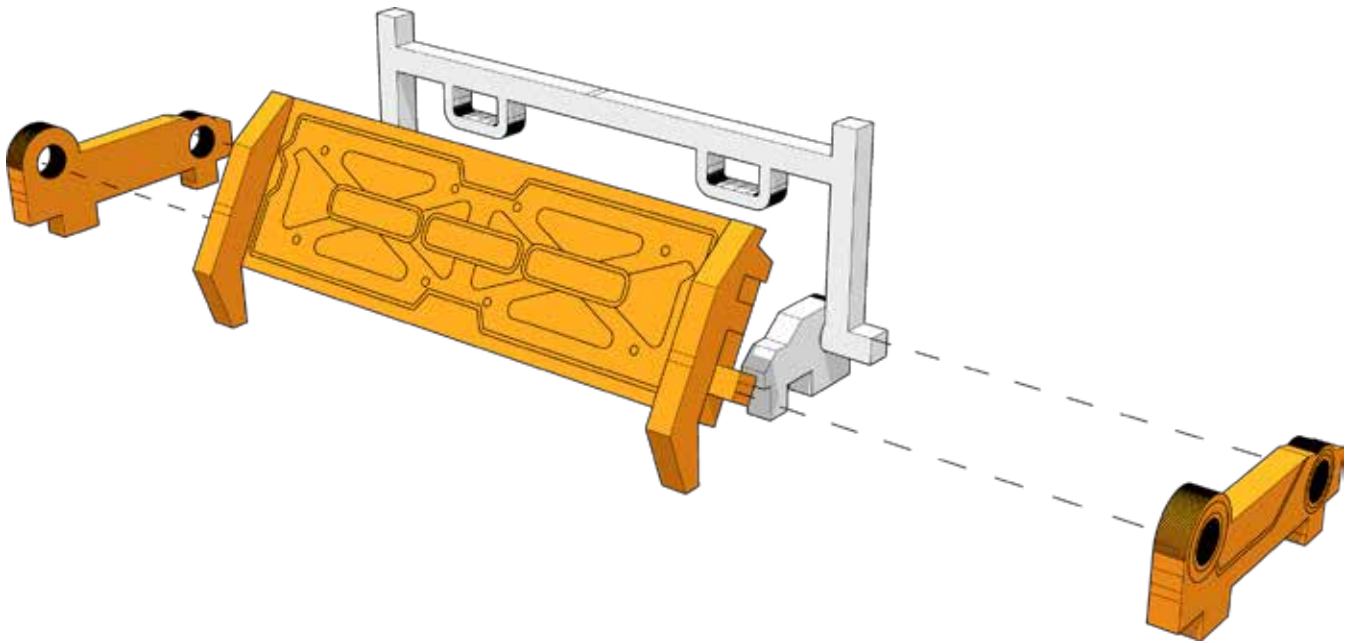



TABLETOP SCENICS

TTSCW-SFU-166
QDB's and Refuse

27

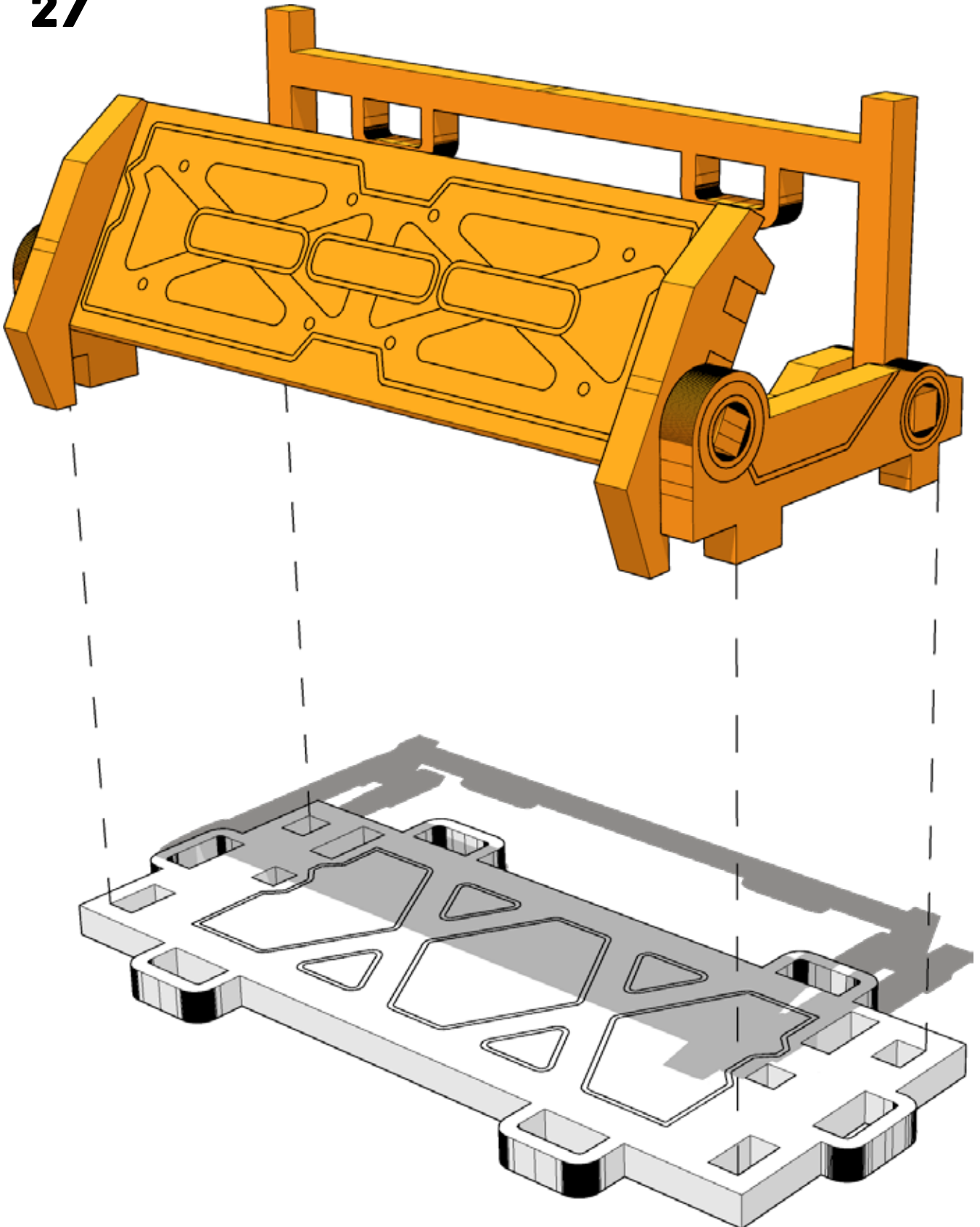

Only glue the tab slots to the floor to allow the QDB to move





TABLETOP SCENICS

TTSCW-SFU-166
QDB's and Refuse

28

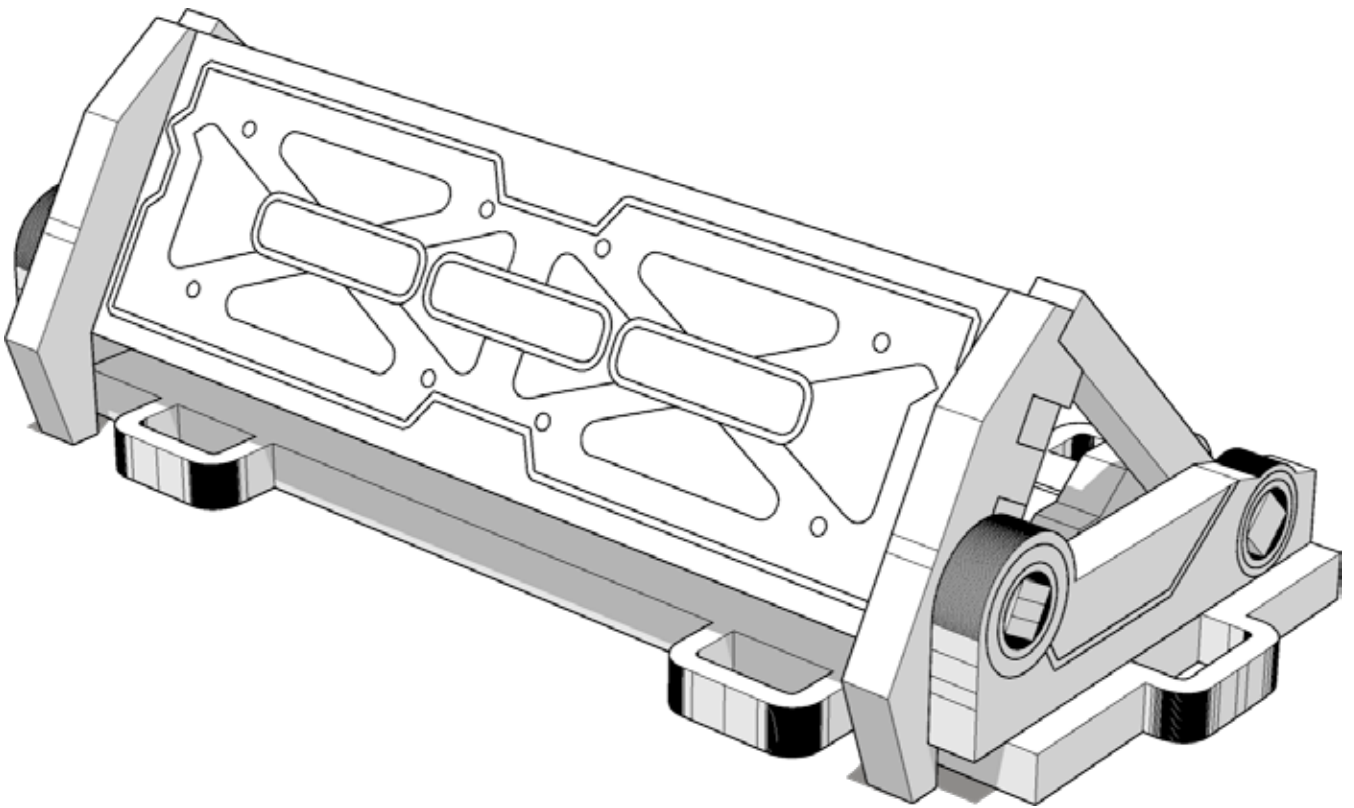

x6



TABLETOP SCENICS

TTSCW-SFU-166
QDB's and Refuse

29

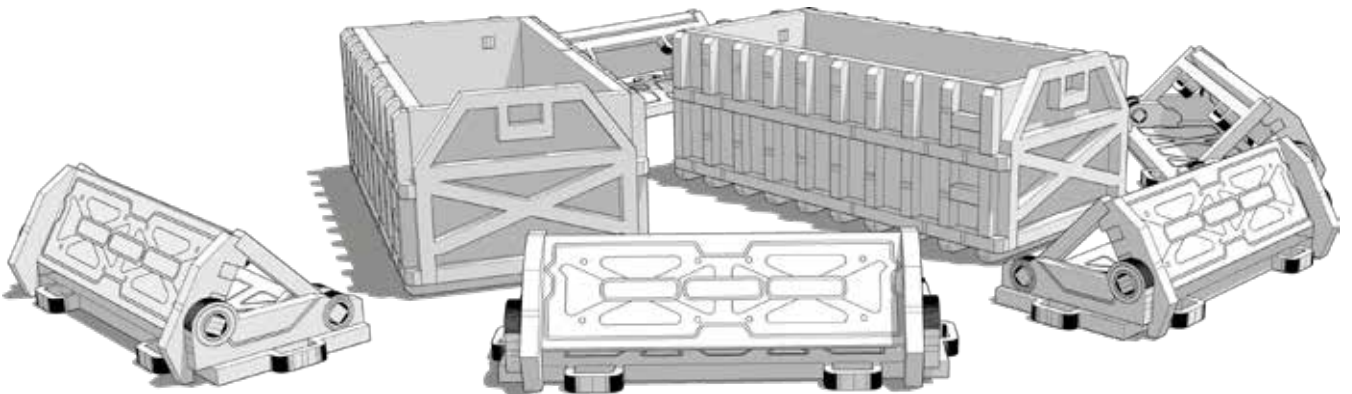

 **TTCOMBAT**