



533 Series Garden Valves

APPLICATION



533 Series Garden Valves

FEATURES

- Pattern casted red brass construction to prevent dezincification
- Solid brass operating stem
- Large unobstructed waterways for greater flow rates
- Cast metal handle assembly with brass mounting screw
- Green standard handle with additional red or blue options
- Packing nut design for years of reliable life
- EPDM smooth turn packing
- 1/2" and 3/4" Female inlet connections
- 3/4" garden hose connection outlet
- Solid brass fast-travel stem with ACME threads
- Each valve individually tested

ORDERING

533.40-

Inlet
40- 1/2" FPT
60- 3/4" FPT

Handle Option
None- Green
B- Blue
R- Red



533 SERIES REPLACEMENT PARTS

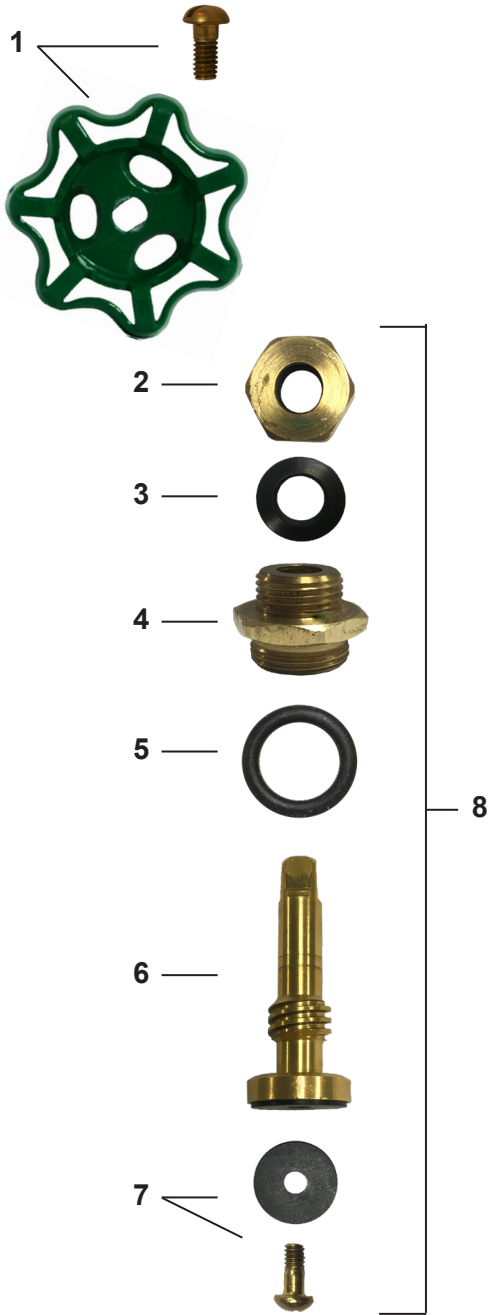

ID	Part No.	Description
1	630-0045	Handle and Screw Kit
2	310-3024	Packing Nut
3	336-3006	Packing Only
4	310-3017	Valve Stem Cap
5	936-3003	O-Ring
6	310-3019	Stem Body
7	630-0047	Bibb Washer and Screw Kit
8	231-3101	Stem Assembly Complete
	630-0043	Service Kit for Garden Valves, Contains: 1, 3, 7

