



LOW VOLTAGE

BISTRO STRING LIGHT
PRODUCT & INSTALLATION
GUIDE

BRILLIANCE LED[®]
A HIGHER LIGHT FORM[®]

TABLE OF CONTENTS

LOW VOLTAGE BISTRO STRING REEL	3
BISTRO STRING END CAP	5
INSTALLING THE BISTRO STRING END CAP.....	5
STRAIGHT CONNECTOR	6
INSTALLING STRAIGHT CONNECTOR TO LANDSCAPE CABLE	7
INSTALLING STRAIGHT CONNECTOR TO SO CABLE	11
T CONNECTOR	14
INSTALLING T CONNECTOR TO SO CABLE	15
CABLE TERMINAL INSTRUCTIONS	19
ATTACHING THE STRAIGHT CONNECTOR TO THE LANDSCAPE CABLE.....	19
ATTACHING THE STRAIGHT CONNECTOR TO THE SO CABLE.....	22
ATTACHING THE T CONNECTOR TO THE SO CABLE	25

Cover Photograph Courtesy of Bryant Outdoor Lighting

LOW VOLTAGE BISTRO STRING REEL



Part Number:
LOW-VOLTAGE-BISTRO-STRING-REEL

DESCRIPTION

The Brilliance Low Voltage Bistro String Reel comes in a 328 ft. spool (100m) and can be cut to length at the distributorship per the buyer's requirements. Use this low voltage bistro string with the corresponding low voltage string connection accessories for custom length bistro lighting.

This string is for use with low voltage lamps only. Mounting cable and turnbuckles are not included. Connection accessories and lamps are sold separately.

NEC® Article 411.5 (B): Lighting systems shall be installed not less than 3m (10ft) horizontally from the nearest edge of the water, unless permitted by Article 680.

LOW VOLTAGE BISTRO STRING REEL



FEATURES

- Patented design (U.S. Patent D898986S)
- String features a waterproof seal
- Two-way mounting holes at each lamp position eliminate the need for zip ties and creates a more secure installation for the life of the string lights

LOW VOLTAGE BISTRO STRING LIGHT REEL

Operating Range	12VAC
Total Length	328 feet reel (100 meters) Can be cut to length at distributor
String Lead Length	At least 10 inches of lead required for connections
Distance Between Lamp Positions	24 inches between lamps
Includes	Low Voltage Bistro String
Connection Accessories Available	Straight Connector: 1 per cable conversion T Connector: 1 per center feed End Cap: 1 per string end
Warranty (years)	2

S14 LAMP REQUIREMENTS

Lamp	1W, 12 VAC	2W, 12 VAC	3.5W, 12 VAC
Max. # of Lamps	75	50	30
Max. Wattage	125.25 with VA	117.5 with VA	117.9 with VA
Max. String Length	150 ft end-to-end	100 ft end-to-end	60 ft end-to-end

BISTRO STRING END CAP



Part Number:

LOW-VOLTAGE-BISTRO-STRING-END-CAP

DESCRIPTION

The Low Voltage Bistro String End Cap is an accessory to customize the length of the Low Voltage Bistro String Reel only. Use with Brilliance Low Voltage Bistro String for wherever you have an end of SO cord. Order one Low Voltage Bistro String End cap for each string end.



**FAILURE TO FOLLOW
INSTRUCTIONS WILL
VOID WARRANTY**

INSTALLING THE BISTRO STRING END CAP

1. Examine the end of the SO cable.
2. Be certain that none of the conductors or strands of cable are touching each other.
3. Apply a small amount of silicone to the end of the SO cable.
4. Slide the end cap over the SO cable jacket to secure it. Refer to the silicon manufacturer's information for the recommended cure time.

STRAIGHT CONNECTOR



Part Number:

**LOW-VOLTAGE-BISTRO-STRING-
STRAIGHT-CONNECTOR**

DESCRIPTION

The Low Voltage Bistro String Straight Connector is an accessory to customize the length of the Low Voltage Bistro String Reel only. Use with Brilliance Low Voltage Bistro String to convert low voltage landscape lighting cable to SO cable. Order one Low Voltage Bistro String Straight Connector for each instance in which you have to convert low voltage landscape lighting cable to SO cable.



**FAILURE TO FOLLOW
INSTRUCTIONS WILL
VOID WARRANTY**

INSTALLING STRAIGHT CONNECTOR TO LANDSCAPE CABLE

1. Unscrew the plastic nut from the straight connector.



2. Using some needle nose pliers, gently remove the two-hole rubber grommet from the throat coupler.

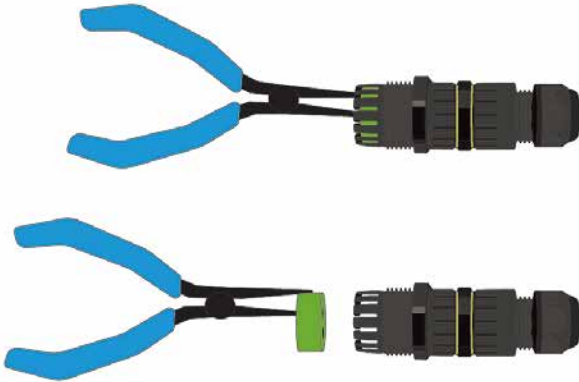

3. Unscrew the throat coupler from the center coupler.



CONTINUED

- Using a Philips screwdriver, unscrew the two cable terminals on either side from each other. The middle terminal is not used for two conductor landscape cable.

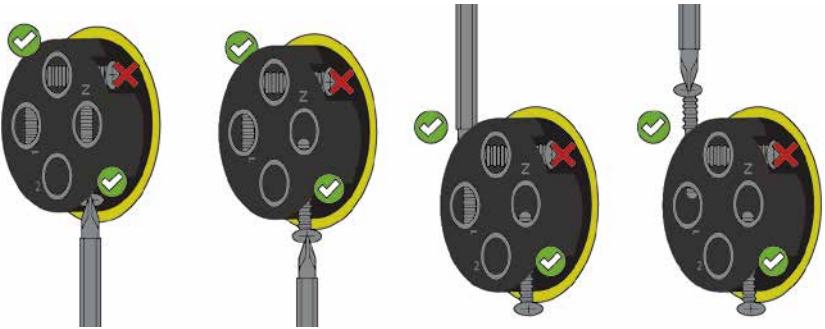

- Strip the landscape cable approximately 1/2 inch.



- Pass the landscape cable through the nut rounded side first.



- Splitting the cable apart, insert each conductor through the holes of the two-hole rubber grommet.



8. Pass the landscape cable through the large side of the throat coupler with the fin side first.



9. Insert one side of the split cable into the open cable terminals and tighten the terminal screw. Repeat this step for the other side of the split cable.

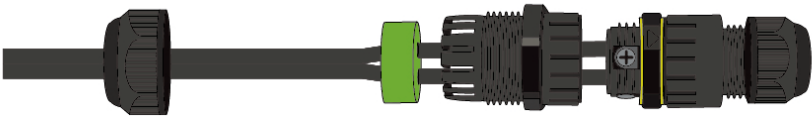

NOTE: See page 19 for specific details about cable connection requirements.

10. Once both conductors have been attached, thread the throat coupler to the center coupler on the terminal side and screw them together to tighten.

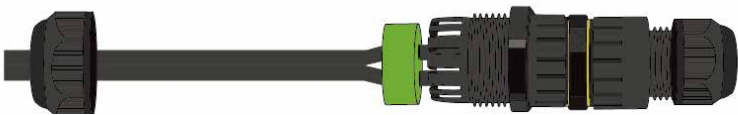

11. Position the two-hole rubber grommet into the fin side of the throat coupler.



CONTINUED

12. Thread the compression nut back on to the fin side of the throat coupler.



13. Hand tighten until the landscape cable has been compressed. Do not over-tighten.



Continue to the next page for instruction on attaching the SO cable to the other side of the straight connector.

INSTALLING STRAIGHT CONNECTOR TO SO CABLE

1. Unscrew the plastic nut from the SO Cable side of the connection.



2. Using some needle nose pliers, gently remove the one-hole rubber grommet from the throat coupler.



3. Unscrew the throat coupler from the center coupler.

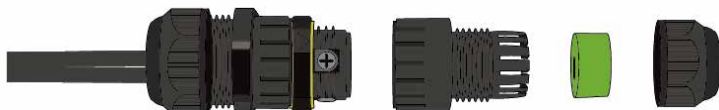

4. Using a Philips screwdriver, unscrew the two cable terminals on either side from each other. The middle terminal is not used for two conductor SO cable.

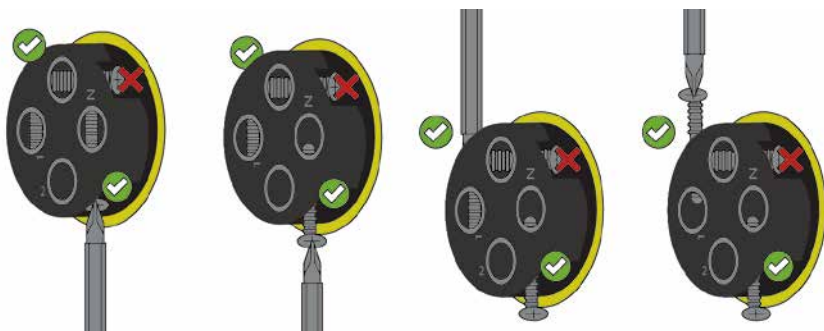

CONTINUED

- Strip the SO cable to reveal the black and white conductors, approximately 1-1/2 inches.



- Pass the plastic compression nut over the SO cable with the rounded side first.



- Insert the SO cable through the hole of the rubber grommet.



- Pass the SO cable through the small side of the throat coupler with the fin side first.



9. Insert the black and white conductors into the opened terminals. Tighten both terminal screws.

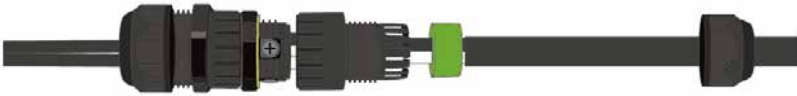

NOTE: See page 22 for specific details about cable connection requirements.

10. Once both conductors have been attached, thread the throat coupler to the center coupler on the terminal side and screw them together to tighten.



11. Position the one-hole rubber grommet into the fin side of the throat coupler.



12. Thread the compression nut back on to the fin side of the throat coupler. Hand tighten until the SO cable has been compressed. Do not over-tighten.



T CONNECTOR



Part Number:

**LOW-VOLTAGE-BISTRO-STRING-
T-CONNECTOR**

DESCRIPTION

The Low Voltage Bistro String T Connector is an accessory to customize the length of the Low Voltage Bistro String Reel only. Use with Brilliance Low Voltage Bistro String for wherever you want to change directions, or when you need to combine two sections of SO cable. Order one Low Voltage Bistro String T Connector for each center feed used.



**FAILURE TO FOLLOW
INSTRUCTIONS WILL
VOID WARRANTY**

INSTALLING T CONNECTOR TO SO CABLE

1. Unscrew the plastic nut from the SO Cable side of the connection.



2. Using some needle nose pliers, gently remove the one-hole rubber grommet from the throat coupler.



3. Unscrew the throat coupler from the center coupler.



CONTINUED

- Using a Philips screwdriver, unscrew the two cable terminals on either side from each other. The middle terminal is not used for two conductor SO cable.

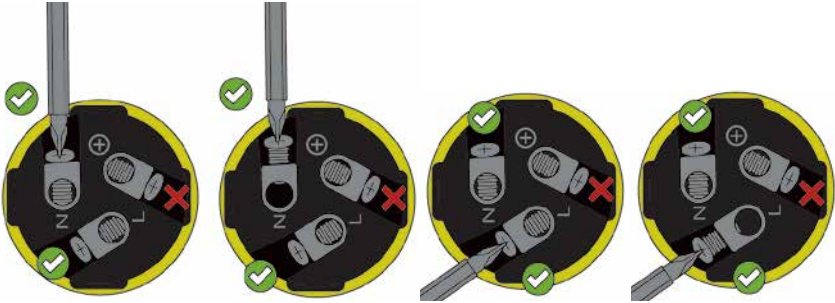

- Strip the SO cable to reveal the black and white conductors, approximately 1-1/2 inches.



- Pass the plastic compression nut over the SO cable with the rounded side first.

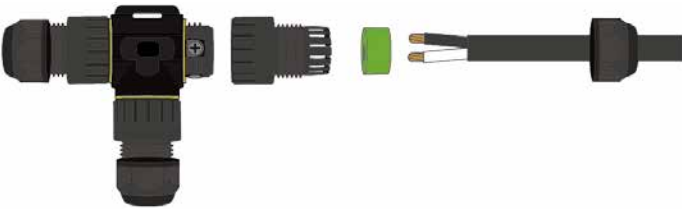

7. Insert the SO cable through the hole of the rubber grommet.



8. Pass the SO cable through the large side of the throat coupler with the fin side first.

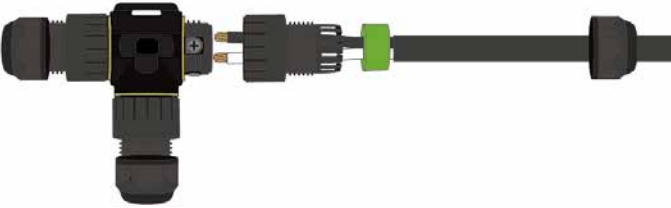

9. Insert the black and white conductors into the opened terminals. Tighten both terminal screws.



NOTE: See page 25 for specific details about cable connection requirements.

CONTINUED

10. Once both conductors have been attached, thread the throat coupler to the center coupler on the terminal side and screw them together to tighten.



11. Position the one-hole rubber grommet into the fin side of the throat coupler.



12. Thread the compression nut back on to the fin side of the throat coupler. Hand tighten until the SO cable has been compressed. Do not overtighten.



Repeat steps 1-12 on each side of the T Connector to complete.

CABLE TERMINAL INSTRUCTIONS:

ATTACHING THE STRAIGHT CONNECTOR TO THE LANDSCAPE CABLE

1. Using a Philips screwdriver, unscrew the two cable terminals on either side from each other. The middle terminal is not used for two conductor landscape cable.

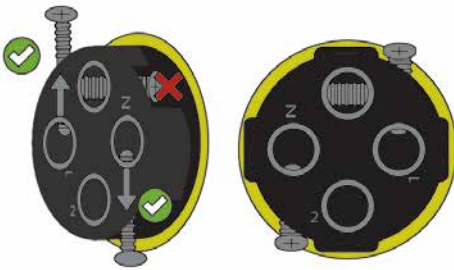

2. Insert the landscape cable into one of the open terminals.



CONTINUED

3. Once the cable is inserted, hold the cable in place and use a Phillips screwdriver to tighten the screw.



4. Once the screw is tightened, the connection is complete.



5. Insert the other cable into the second open terminal.



- 6.** Once the second cable is inserted, hold the cable in place and use a Phillips screwdriver to tighten the screw.



- 7.** Once the screw is tightened, both connections are complete.



CABLE TERMINAL INSTRUCTIONS:

ATTACHING THE STRAIGHT CONNECTOR TO THE SO CABLE

1. Using a Philips screwdriver, unscrew the two cable terminals on either side from each other. The middle terminal is not used for two conductor SO cable.

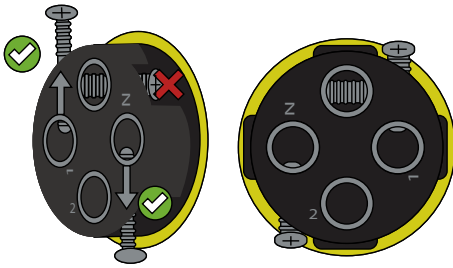

2. Insert the black cable into the terminal marked 1.

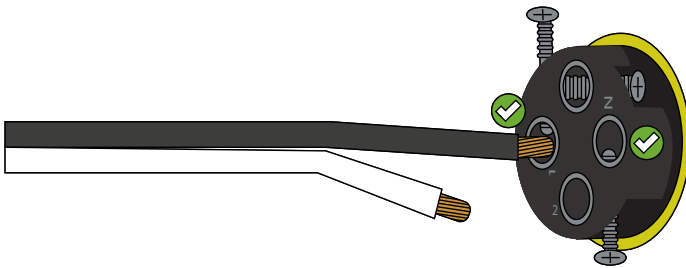

CONTINUED

3. Once the cable is inserted, hold the cable in place and use a Phillips screwdriver to tighten the screw.

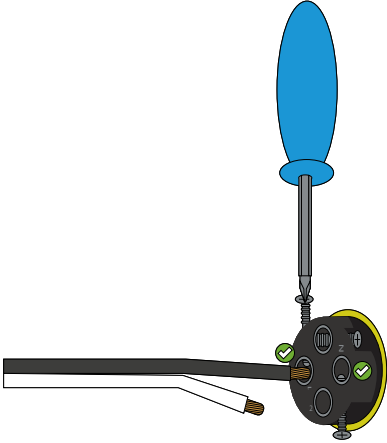

4. Once the screw is tightened, the connection is complete.

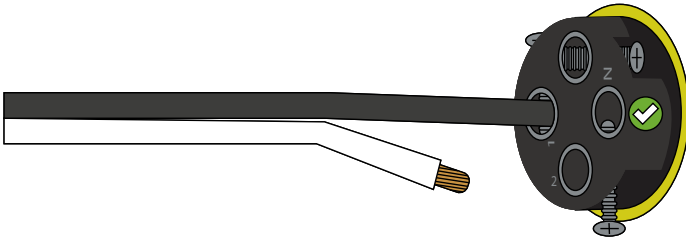

5. Insert the white cable into the terminal marked N.

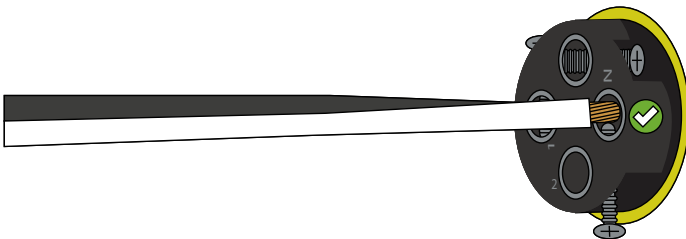

6. Once the second cable is inserted, hold the cable in place and use a Phillips screwdriver to tighten the screw.

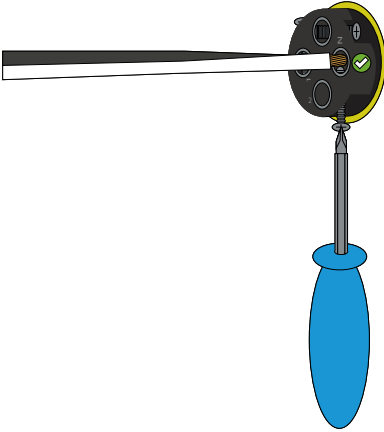

7. Once the screw is tightened, both connections are complete.

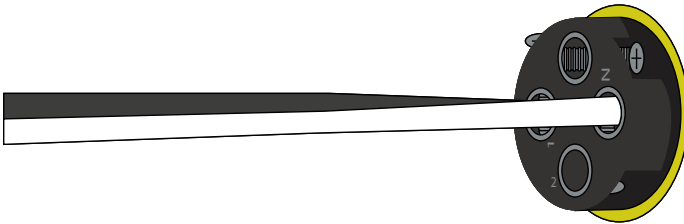

CABLE TERMINAL INSTRUCTIONS:

ATTACHING THE T CONNECTOR TO THE SO CABLE

1. Using a Philips screwdriver, unscrew the two cable terminals on either side from each other. The middle terminal is not used for two conductor SO cable.

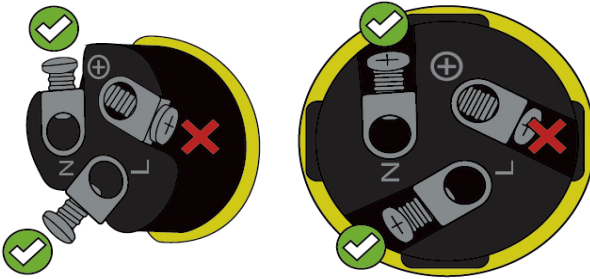

2. Insert the white cable into the terminal marked N.

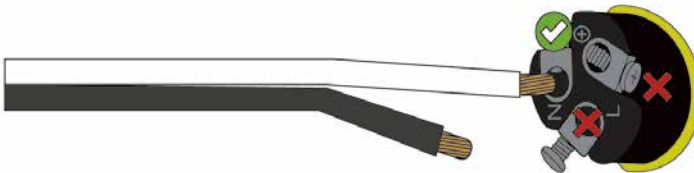

- 3.** Once the cable is inserted, hold the cable in place and use a Phillips screwdriver to tighten the screw.

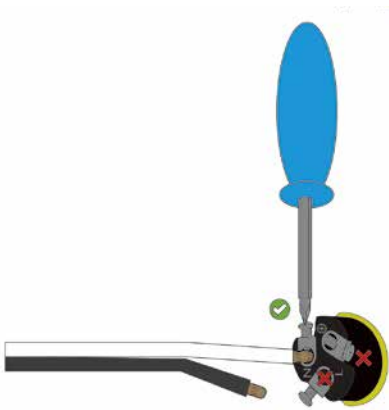

- 4.** Once the screw is tightened, the connection is complete.

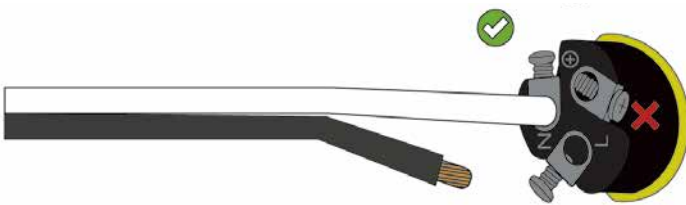

- 5.** Insert the black cable into the terminal marked L.



CONTINUED

6. Once the second cable is inserted, hold the cable in place and use a Phillips screwdriver to tighten the screw.

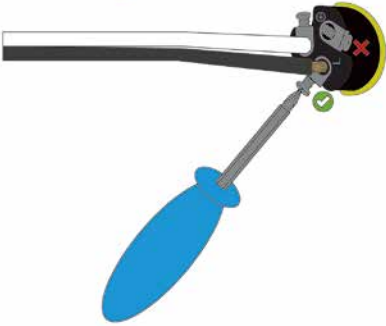

7. Once the screw is tightened, both connections are complete.





brillianceled.com | 800.867.2108
7202 E Cave Creek Rd, Suite 3A
PO Box 2281 Carefree, AZ 85377