

**Tools Required:**

- Soft pry tools
- Radio removal keys

Note: This document is for informational purposes only. Any vehicle modifications should be done by a certified VW mechanic. Eurozone Tuning will not be held liable for actions taken resulting from the information set forth herein.



1. Insert removal keys into slots of the MIB1/2 Brain unit until you hear an audible click. Once you hear the click, gently pull the keys towards you to pull the unit out of its location.

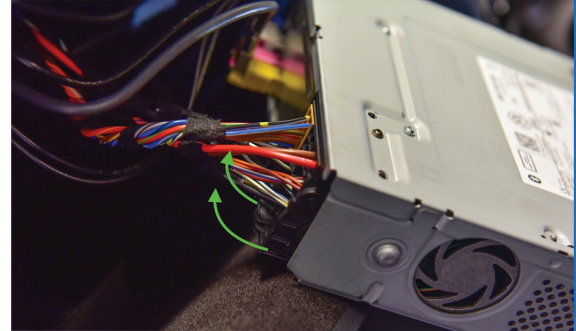

2. Once the brain unit is released from its location, remove the plugs. The large square plug is the main quadlock connector. Pull the bottom tab and swing towards the arrows shown to release the locking mechanism. The other plugs can be plugged out by pressing on their respective tabs and pulling out.



3. The wiring layout will be slightly different on the new MIB2 Brain Unit.

Pink Plug: Goes into Gray slot

Yellow Plug: No longer used. Use the new yellow plug from your new USB kit.

Blue Plug: Goes into Blue Slot

Dark Red Plug: no longer used (SiriusXM Radio)

Quadlock plug goes into Quadlock connector

Note: The Two-pin square connector on the far right is for Fender Audio. If you do not have Fender Audio, this will be left empty.



4. Using the soft pry tools, pry the trim surrounding the climate controls. This will give you access to the ashtray console. You will be replacing the MDI plug inside the console. Gently pull out the console, and you will be able to unplug the two connectors (green and yellow) and remove the MDI assembly.

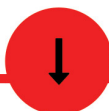



5. Pry out the old MDI assembly using a flathead driver or soft pry tool, and insert new USB assy.



6. Plug in the included cabled into the green and yellow slots of the new USB assy. Feed the other end of the wiring in the radio cavity to plug into the Mib2 brain unit. Plug the new yellow plug into the yellow female input of the new MIB2 brain unit.

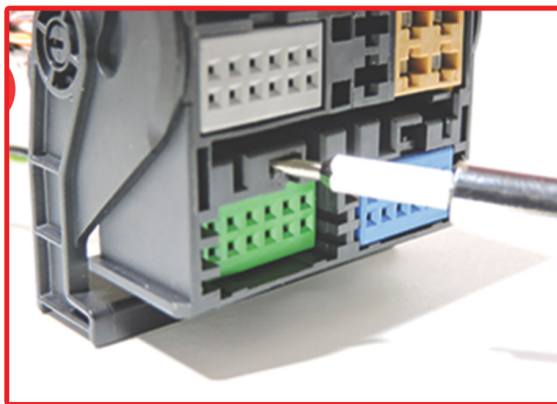

7. Unplug the green block from your car's quadlock connector, and plug in the new green block from your USB kit. To remove the old block, pry the tab as shown in the image above.



8. Insert the MIB2 Brain unit into the glovebox slot until you hear an audible click. Reinstall the ashtray assembly in its proper location, and reinstall the climate control trim piece. Your install is complete!

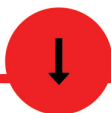



9. If your model is a 2015 and equipped with Fender audio from the factory, follow the next few steps to enable Audio. This is a workaround to enable MIB2 audio to function with an MIB1 amplifier.

**Enabling sound on 2015 vehicles with MIB1 and Fender Audio:**

In module 47 in VCDS

1. Plug in VCDS -  
choose Module "47-Sound System"



2. Choose CODING.

3. Change byte 0 to 0x12. This is the same as going into the drop-down menu and changing from 20 Fender Audio to 10-Dynaudio

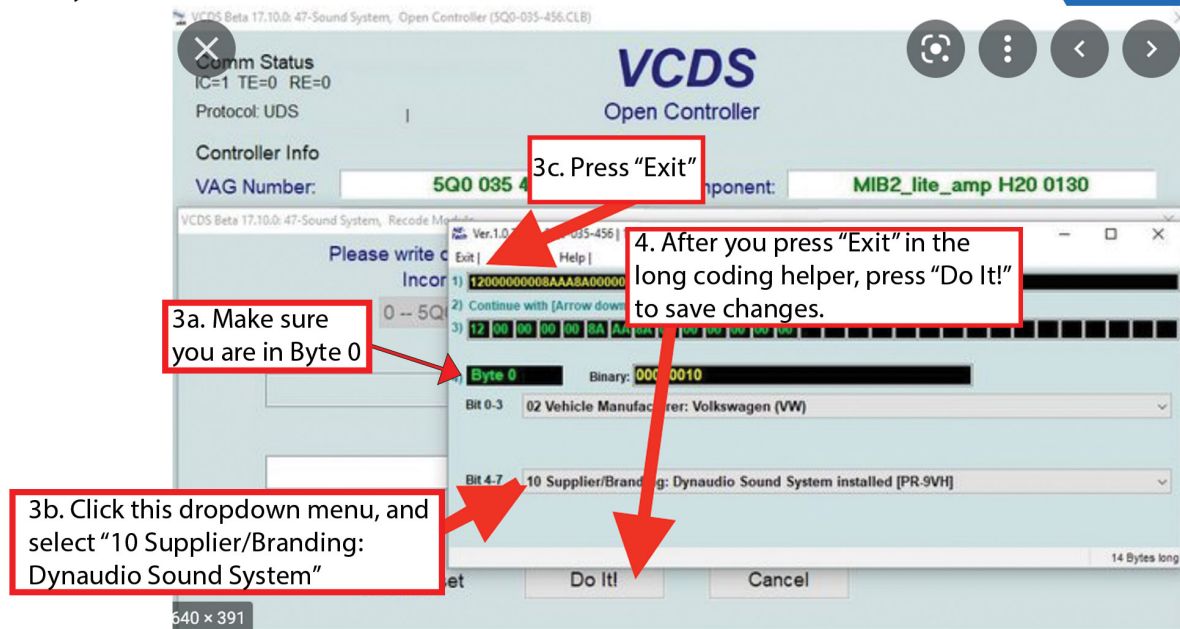

4. Press EXIT, then DO IT to save changes

5. Press and hold the power button on your display for 10-15 seconds to reboot your MIB2/MIB2.5 so the new changes kick in.

Your sound should now work.

**Note:** If you are unable to go into 47-Sound System in VCDS, check to make sure you installed the rectangular 2-pin amplifier plug in the back of the MIB2.

If still unable to access 47-Sound system, temporarily re-install your old MIB1 Brain Unit and perform this programming. Then reinstall the new MIB2 Brain Unit.

**Note:** OBDeleven can also be used to perform this coding, although the menus may be slightly different.