

## Features

- Direct replacement for G24-Q3 / G24-D3 Plug-in CFL lamp with standard dimension
- Compatible with 13/18/26W existing ballast, can also work without ballast
- 120~277VAC universal voltage applicable
- Designed for horizontal mounting
- Long lifespan 35,000hrs
- Optional for various CCT



## Benefits & Applications

- Environmental friendly - No mercury or lead
- 80% energy saving compared to CFL lamps
- Idea for hotels, office, cafe, saloon, meeting room, shopping mall, home, school lighting etc.
- Maintenance free operation, last up to 20 times longer than conventional lamps

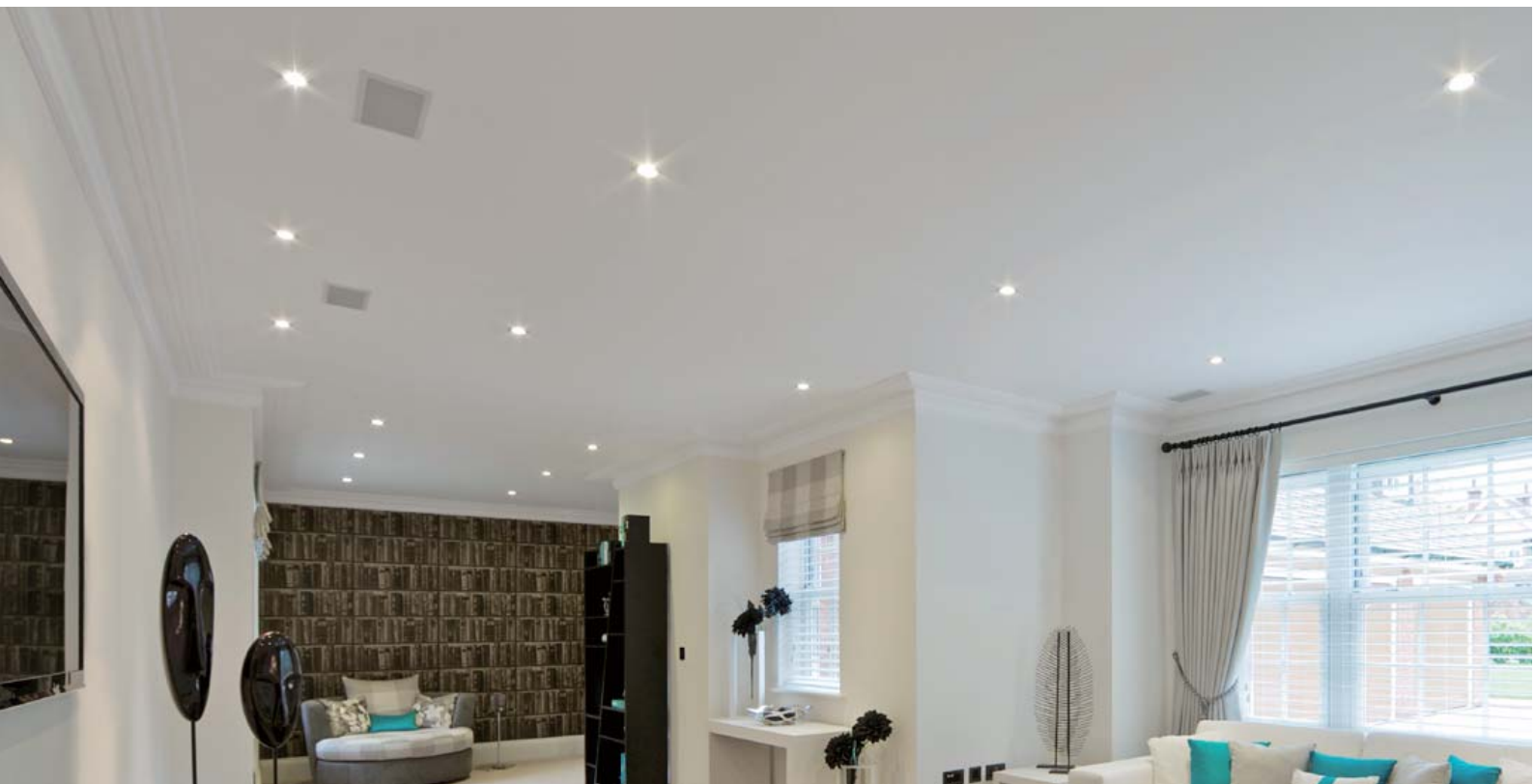

# Ordering Guide

EXAMPLE: PL-09-G24-XXK-BZZ-JLL

Lamp Type	Power Consumption	Lamp Base	CCT	Series	Lamp Base	CRI
Plug-in Light	09 9Watts	G24 G24 Edison screw base	27K 2700K	B Series B	Q G24Q3 screw base	H CRI80
	12 12Watts		30K 3000K		D G24D3 screw base	U CRI90
			40K 4000K			
			50K 5000K			

## Energy Efficiency

Estimated Lighting Costs Using a Standard 26W CFL lamp	
Present Wattage	26 W
× Annual Operating Hours	3,650 hrs
=	94,900 Watts per year

÷ 1,000	=	94.9 kWh per year
× kWh rate of \$0.11	=	\$10.439 per year
× 100 lamps per space	=	\$1,043.9 annual energy cost per space

Estimated Lighting Costs Using a Mester 12W LED PL LAMP	
Present Wattage	12 W
× Annual Operating Hours	3,650 hrs
=	43,800 Watts per year

÷ 1,000	=	43.8 kWh per year
× kWh rate of \$0.11	=	\$4.818 per year
× 100 lamps per space	=	\$481.8 annual energy cost per space
<b>Total Estimated Annual</b>	<b>=</b>	<b>\$562.1</b>
<b>Energy Costs Savings</b>		

\* Based on 100 lamps per space operating at 3,650 hours per year.

This energy saving example shows an application of 100 lamps in a space currently using a 12W LED PL lamp, operating 3,650 hours per lifespan at a cost of \$0.11 per kWh.\*\*As you can see replacing 100 pcs 26W CFL lamp with the Jubilee LED PL lamp, Jubilee provides significant energy cost savings of \$562.1 per year! Your actual savings may vary depending on the energy costs in your geographic location.

\*Light output of the 12W LED PL lamp at 1050 lumens compares to the 26 W CFL lamp at 1700 lumens.

### WARNINGS AND CAUTIONS

- Turn power off before inspection, installation, or removal.
- Suitable for Dry and Damp locations. Operating temperature range between -20°C and +40°C (-4°F and +104°F)
- Do not use in enclosed fixtures.
- Do not open – no user serviceable parts inside. North America use on 120-277VAC 50/60 Hz circuits.
- This device is not intended for use with emergency exit fixtures or emergency exit lights.

## Compatible list of Ballast

PL-09-G24-XXK-BZZ-JLL

Voltage	Ballast Lamp Number	PHILIPS	PHILIPS	PHILIPS	PHILIPS	Triad	Triad	Triad	OSRAM	FULHAM	HATCH	HATCH
		ICF-2S26-M1-BS	ICF-2S42-M2-LD	ICF-2S26-H1-LD	ICF-2S18-H1-LD	C2642UNVBES	C2642UNVME	C213UNVME	2X26CF/UNV	RHA-UNV-226-C	HC218PS/UV/D	HC213PS/UV/D
120V	1							20%				10%
	2							20%				10%
230V	1							20%				10%
	2							20%				10%
277V	1							20%				10%
	2							20%				10%

Note: ■ EXCELLENT ■ WORKING BUT % LESS ON WATTAGE AND LUMENT OUTPUT ■ NO WORKING OR FLIKERING

PL-12-G24-XXK-BZZ-JLL

Voltage	Ballast Lamp Number	PHILIPS	PHILIPS	PHILIPS	PHILIPS	Triad	Triad	Triad	OSRAM	FULHAM	HATCH	HATCH
		ICF-2S26-M1-BS	ICF-2S42-M2-LD	ICF-2S26-H1-LD	ICF-2S18-H1-LD	C2642UNVBES	C2642UNVME	C213UNVME	2X26CF/UNV	RHA-UNV-226-C	HC218PS/UV/D	HC213PS/UV/D
120V	1				5%			25%			10%	15%
	2				5%			25%			10%	15%
230V	1				5%			25%			10%	15%
	2				5%			25%			10%	15%
277V	1				5%			25%			10%	15%
	2				5%			25%			10%	15%

Note: ■ EXCELLENT ■ WORKING BUT % LESS ON WATTAGE AND LUMENT OUTPUT ■ NO WORKING OR FLIKERING

# Dimension

unit: mm

## G24Q (9W)

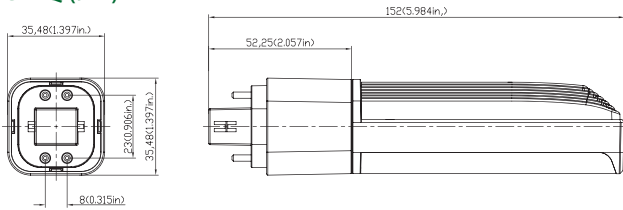

## G24D (9W)

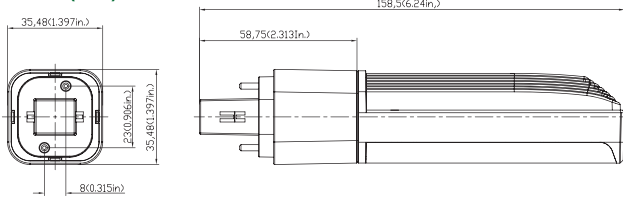

## G24Q (12W)

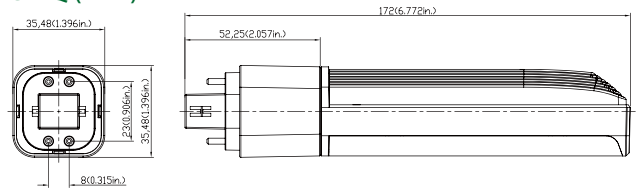

## G24D (12W)

