

M.2 SATA SSD

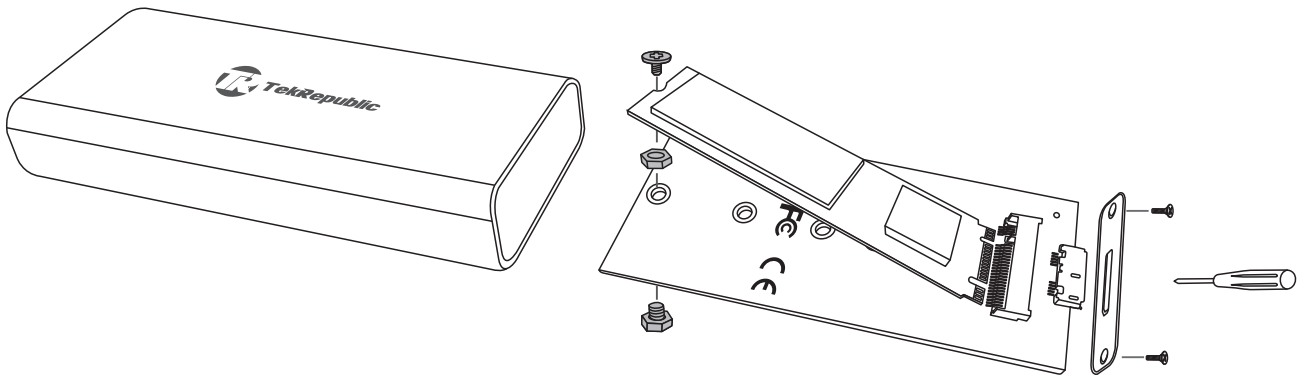

MSATA SSD

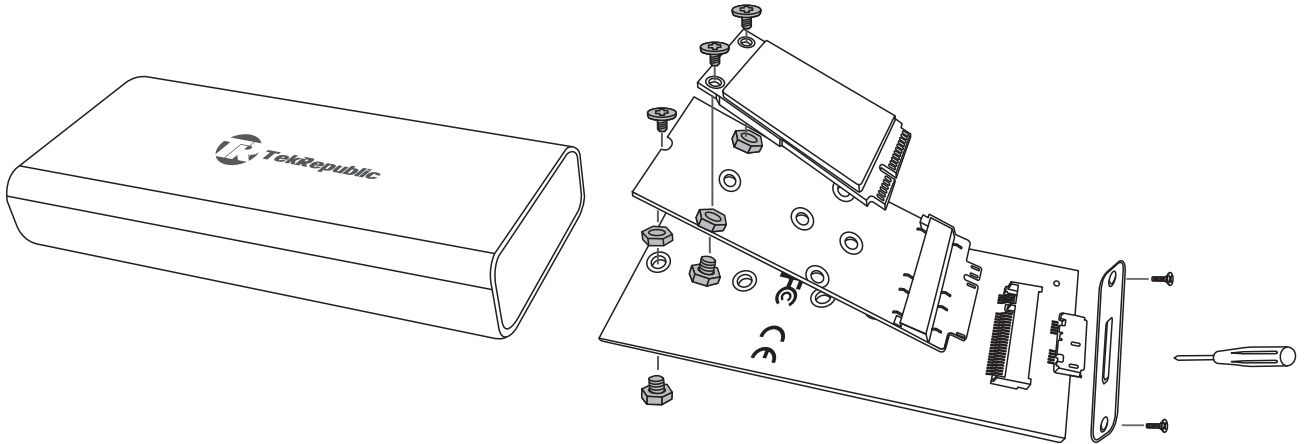

Tek Republic TUE-320 USB 3.0 mSATA and M2 Aluminum Enclosure Installation Guide:



Step 1.

Take one (male) Allen Screw (figure A)



Place the (male) Allen Screw (figure A) at the bottom of the M2 SATA PCB

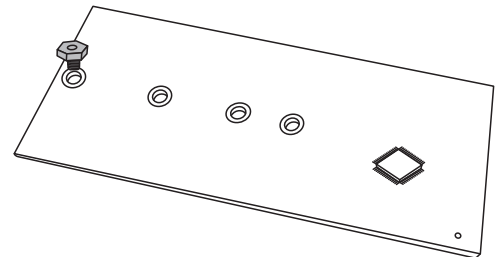

Please take one (female) Allen Screw (figure B)



Place the (female) Allen Screw (figure B) at the bottom the M2 SATA PCB to lock the (male) Allen Screw (figure A)

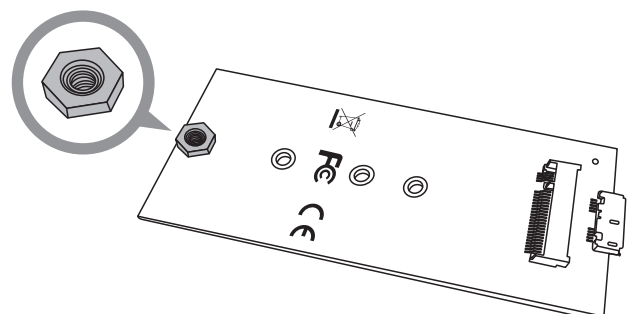



Step 2.

Installing the M2 SATA SSD :

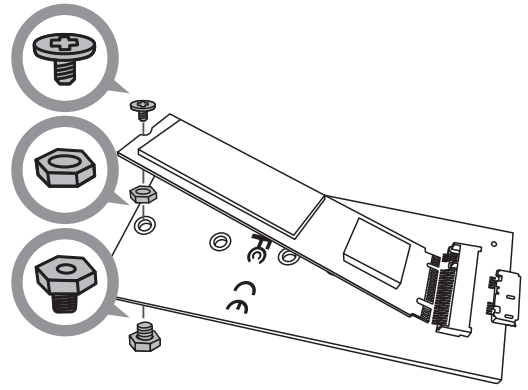
- Install the M2 SSD with a 30 degree angle to the M2 SATA PCB
- Use  (figure C) to screw the M2 SSD into the (female) Allen Screw (figure B) from the M2 SATA PCB



Installing the MSATA SSD

- Place the (male) Allen screw (figure A) on the MSATA SSD PCB to the (female) Allen Screw (figure B)
- Install the MSATA SSD with a 30 degree angle to the MSATA PCB.
Use  (figure C) to screw into the (female) Allen Screw (figure B)
- Install the MSATA PCB at a 30 degree angle to the M2 SATA PCB
- Use  (figure C) to screw the MSATA PCB into the (female) Allen Screw (figure B) from the M2 SATA PCB

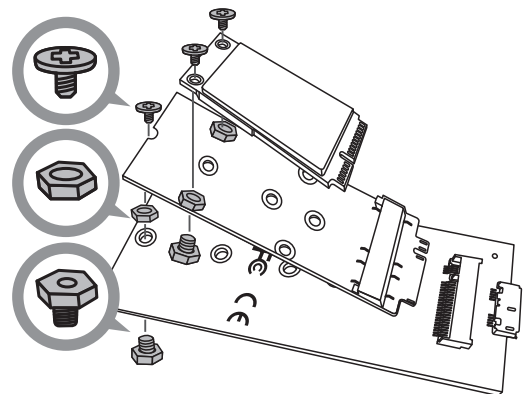
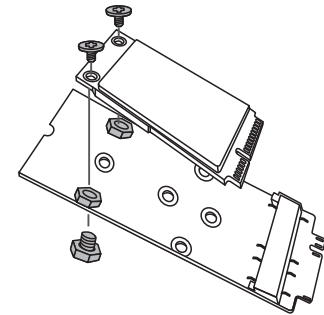
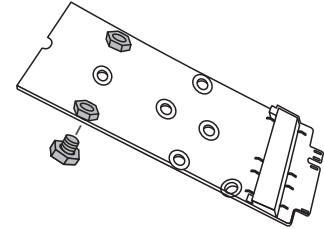

Step. 3

Place the M2 SATA PCB into the TUE-320 case using  (figure D) to screw and lock the lip.

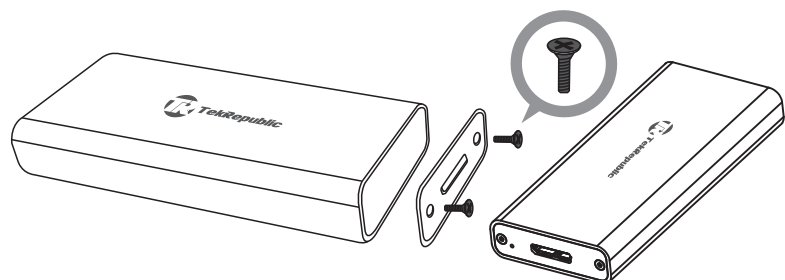

Note: Please check the SSD is initialized, partitioned and formatted.