

insert L brackets facing out

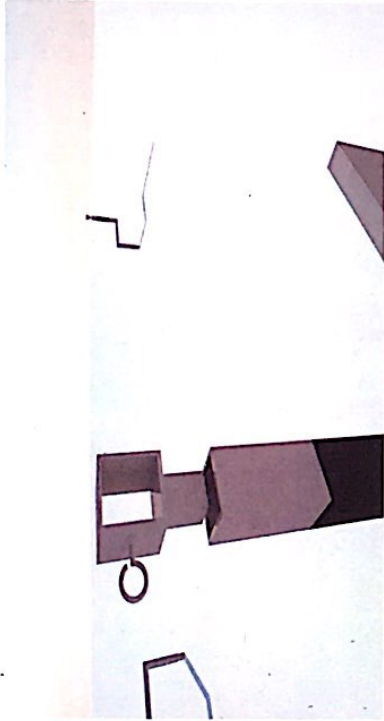

Insert squares into top of L bracket

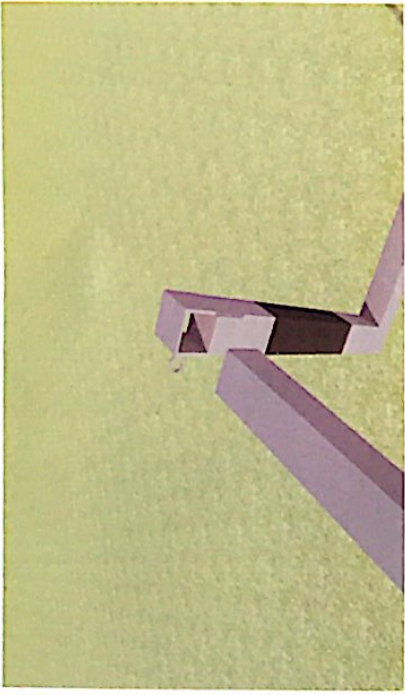

Insert horizontal bar into square and tighten

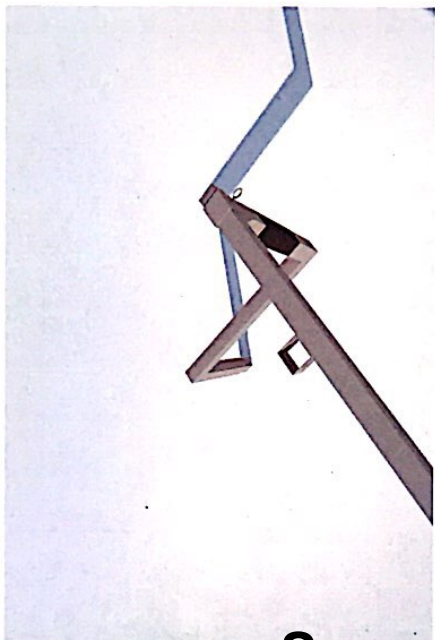

Ensure squares are facing in

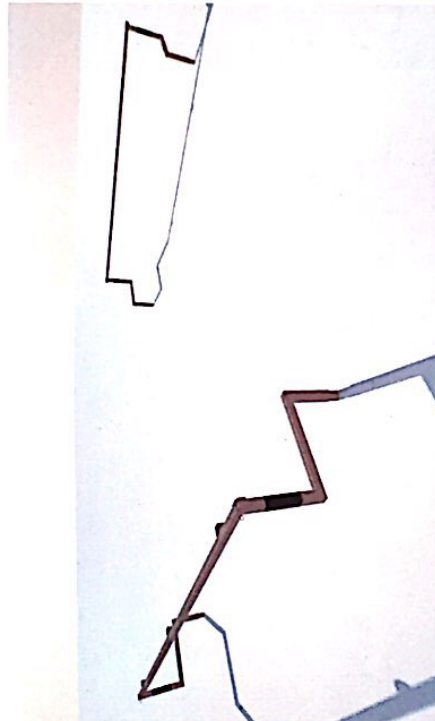

Stage one complete

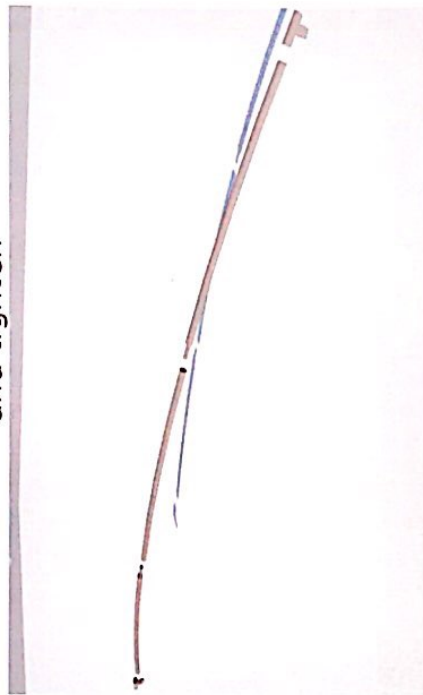

Join arched bars together

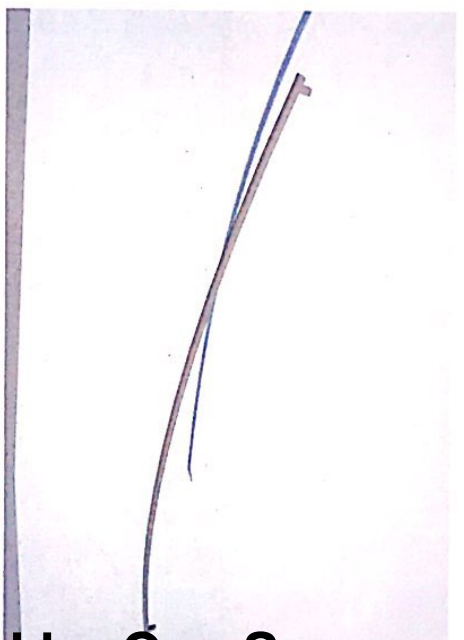

Join 3 bars to create one arch

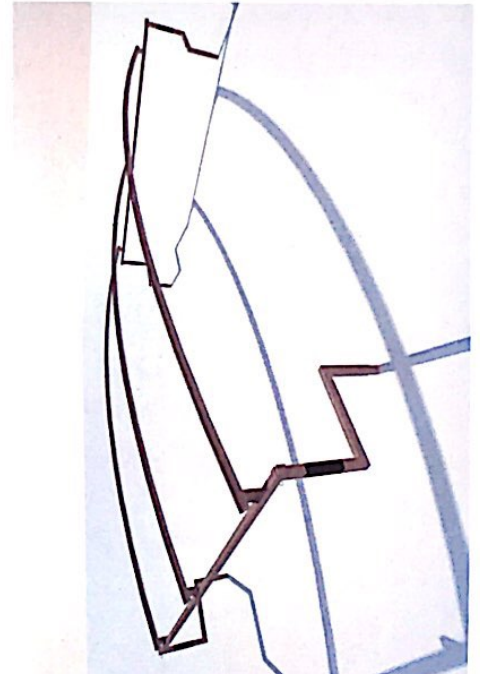

Insert the ends into the squares

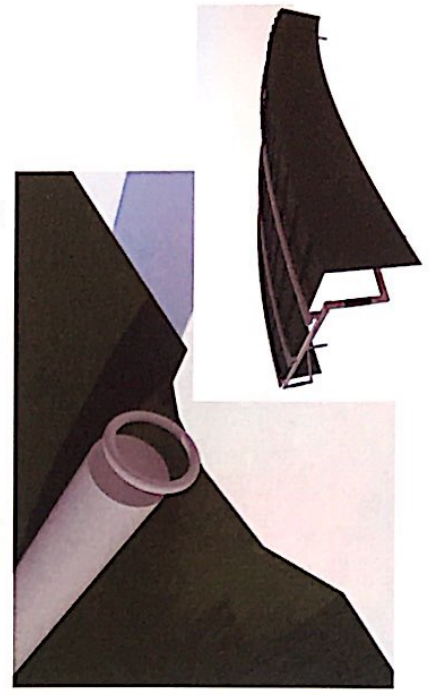

insert the bars through all the rings make sure not to miss any!!

Adjusting the angle

You now need to adjust the angle of the roof, to create a dome shape (fig 1). The center bar/s need to be at a greater angle than the outer bars. To accomplish this you must reconfigure into which hole you insert the screws. The correct configuration are:
2x2 & 2x3 Roof: the center bar screw goes through the 5th hole
Outer bars screw in 4th hole
3x3 & 3x4 Roof: the center bar screw goes through the 4th hole
Outer bars screw in 3rd hole

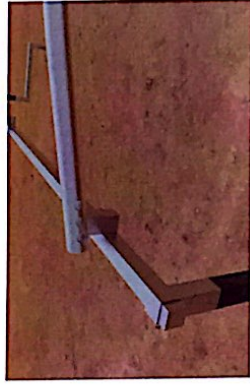

Tip: If you are struggling to get the bars in remove the entire horizontal bar and the L brackets from the sukkah, adjust the angle, and insert back into the top of your sukkah

Pulley System

Hold the long piece of rope in half and attach the center to the roof material.

Now simply pass one end over the material to the other side of the sukkah and keep one end on the near side. you will use one side to open the other side to close. Pulleys are optional.

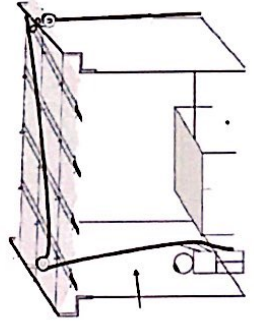

For more help and instruction videos visit our website www.sukkahmart.co.uk



Sukkah Roof Instructions

