

STRAITLINE

COMPONENTS

STEP 1

Mount boomerang using supplied screws and spacers, using the chart and diagram below as a general guideline for spacer thickness. Adjust angle so the boomerang is in the general orientation shown in this diagram. Ensure that there is at least 6mm clearance between the chainstay and the chain guide.

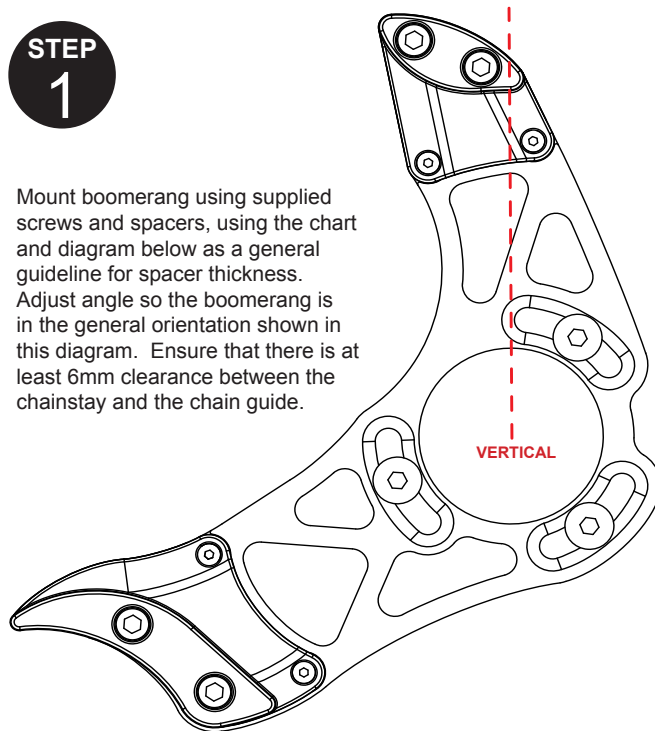

CAUTION! IT IS VERY IMPORTANT TO INSPECT CAREFULLY BEFORE EVERY RIDE

STEP 2

Mount bashguard and sprocket to crankset and install on the bike to check side to side positioning of the boomerang. Bashguard should be slightly proud of the slider as shown, also the distance from the slider to

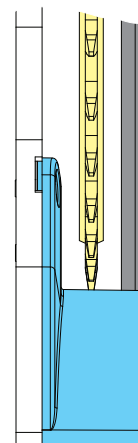

the chainring should be approximately the same as from the chainring to the bashguard. Adjust if necessary using different washer combinations. When correct location is achieved snugly tighten mounting screws. Remove crank arm, install chain, and reinstall with chain on so chain wraps over lower slider.

USE LOCTITE

STEP 3

Go Ride!

Thank you for purchasing the Straitline Silent Guide. A lot of effort has gone into the design and manufacturing of this product to provide you a reliable, durable & great looking product that will enhance your ride for a long time to come.

Thank you,
Straitline
Components

 Proudly
Canadian
Made!

2.5mm or 5.0mm
Spacers
1.25mm Fine
tuning spacers

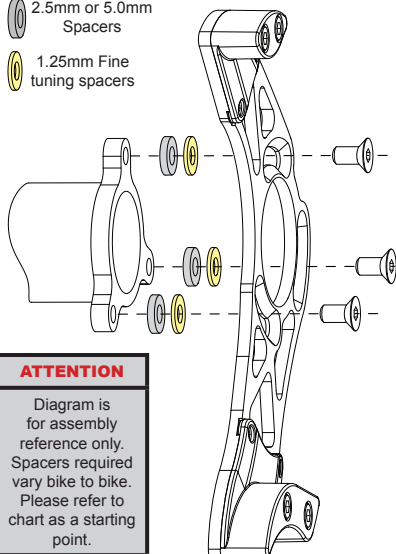

ATTENTION

Diagram is for assembly reference only. Spacers required vary bike to bike. Please refer to chart as a starting point.

BB SHELL WIDTH	BB SPINDLE LENGTH	CHAINLINE	SPACERS REQUIRED
68	113	47.5	NONE
68 OR 73	113	50	NONE
68 OR 73	118	52.5	1 x 2.5mm
68 OR 73	123	55	1 x 5.0mm
68 OR 73	128	57.5	1 x 2.5mm + 1 x 5.0mm
83	128	57.5	1 x 2.5mm
83	133	60	1 x 5.0mm
100	140	63.5	NONE
100	145	65	1 x 2.5mm

Notes:

- 1) Use 1.25mm spacers to fine tune spacing and parallelism.
- 2) Always use mounting screws with the most length that will not bottom out in mounting hole.

MAINTENANCE TIP

Diagram depicts typical wear. This is normal. Replace slider if wear exceeds 5mm of depth. Initially, wear will be rapid, then will slow down significantly once the chain rollers start to contact the polyurethane slider.

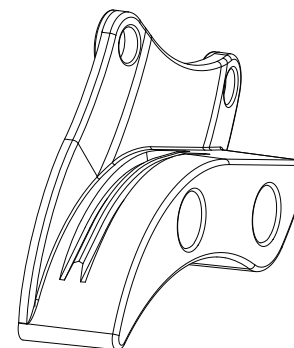

For more information please visit: www.straitlinecomponents.com