

WIRELESS WIFI HOME CAMERA INSTRUCTION MANUAL

STEP 1

- Download “V380 Pro” App from Play Store or Apple Store.

STEP 2

- Click on Register to create new account.

TIP: Account creation is mandatory to access the camera.

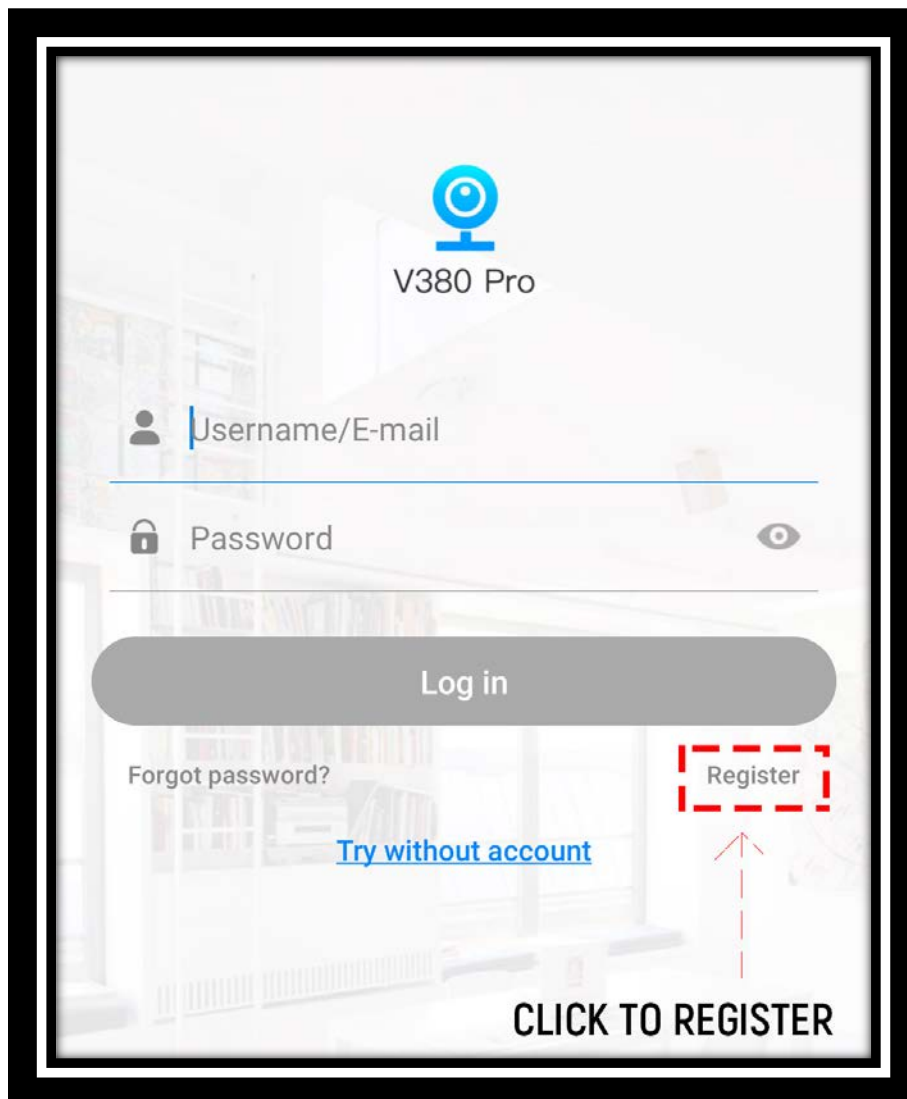

STEP 3

- Choose “ASIA” Region and enter your personal / office e-mail id.
- You will receive a verification code on your email id which you have provided in the “E-mail address” section.
- Enter the verification code and click on “Verify Code” and click on “NEXT BUTTON”.

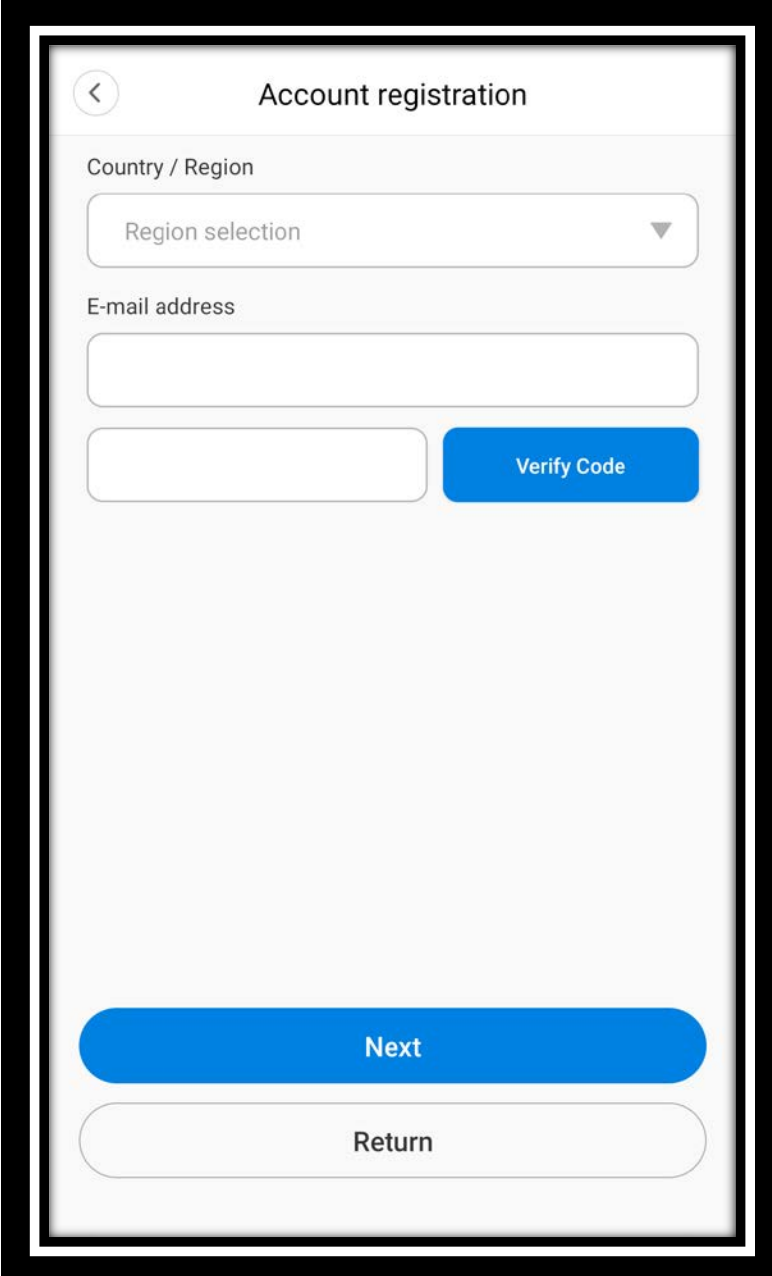

The screenshot displays the "Account registration" screen. At the top left, there is a back arrow icon. The title "Account registration" is centered at the top. Below the title, there is a section labeled "Country / Region" containing a dropdown menu with the text "Region selection" and a downward arrow. Underneath, the "E-mail address" section features a large text input field. Below the email field, there is a smaller text input field for the verification code and a blue button labeled "Verify Code". At the bottom of the screen, there are two buttons: a prominent blue "Next" button and a white "Return" button with a grey border.

STEP 4

- Enter your desired password in “Password” and “Confirm Password” section and click on “SUBMIT BUTTON”.
- Remember the password as it will be used to login into your account in the V380 Pro app.

Account registration

Your account is Support@gadgethug.com
Please set your password

Password 

Confirm password 

Password contains 6–16 characters, using numbers or letters and case-sensitive.

Submit

STEP 5

- Login into the app with the email id and password

STEP 6

- Disable your phone internet
- Go to your Phone Wi-Fi setting and search for camera
- You will find the camera model, e.g. MV564547
- Connect your phone with camera.
- Once connected, enter the app.

STEP 7

- Click on the (+) sign located at the top right corner (See image Below)

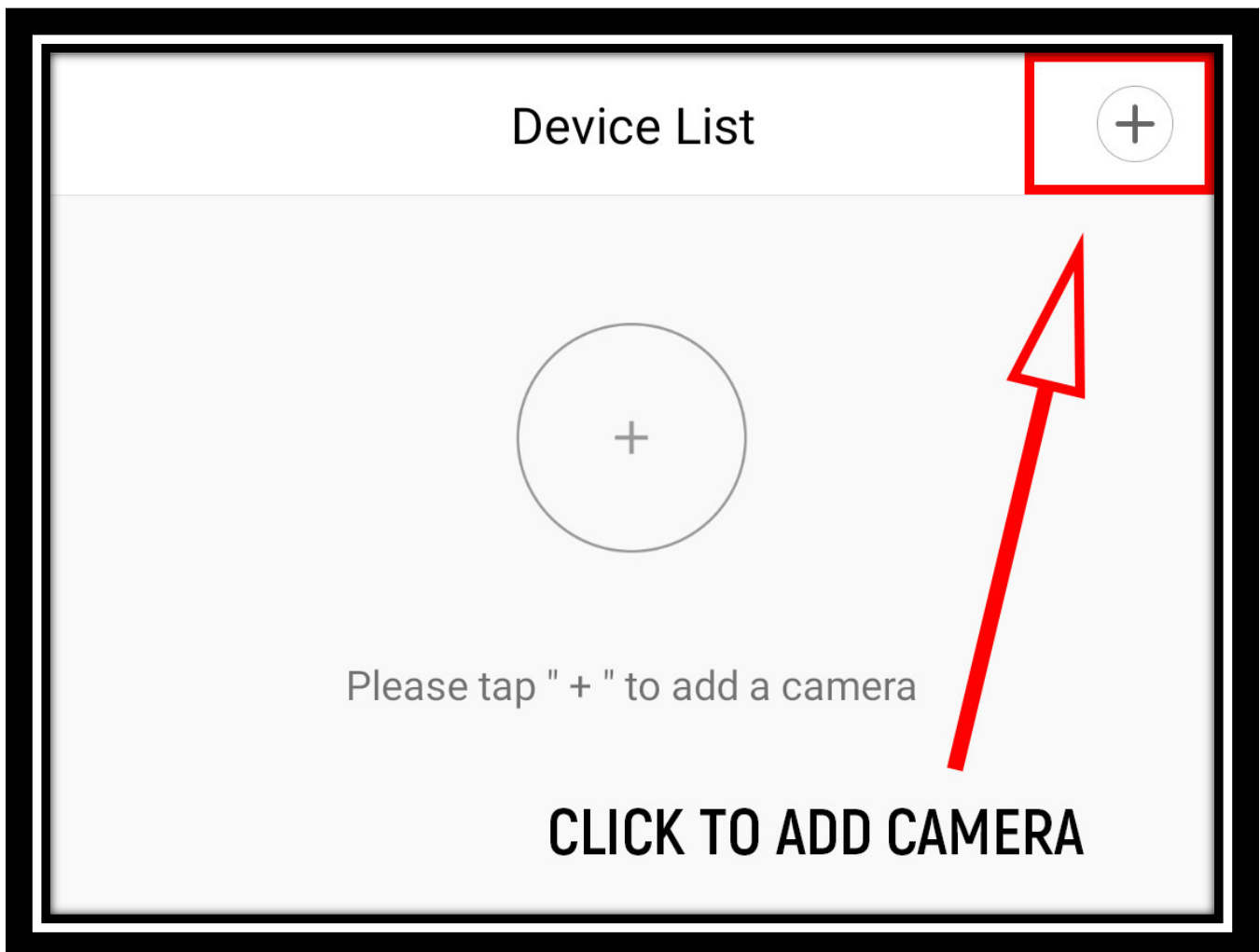

STEP 8

- Click on “Add Camera” option to proceed further (See image below)

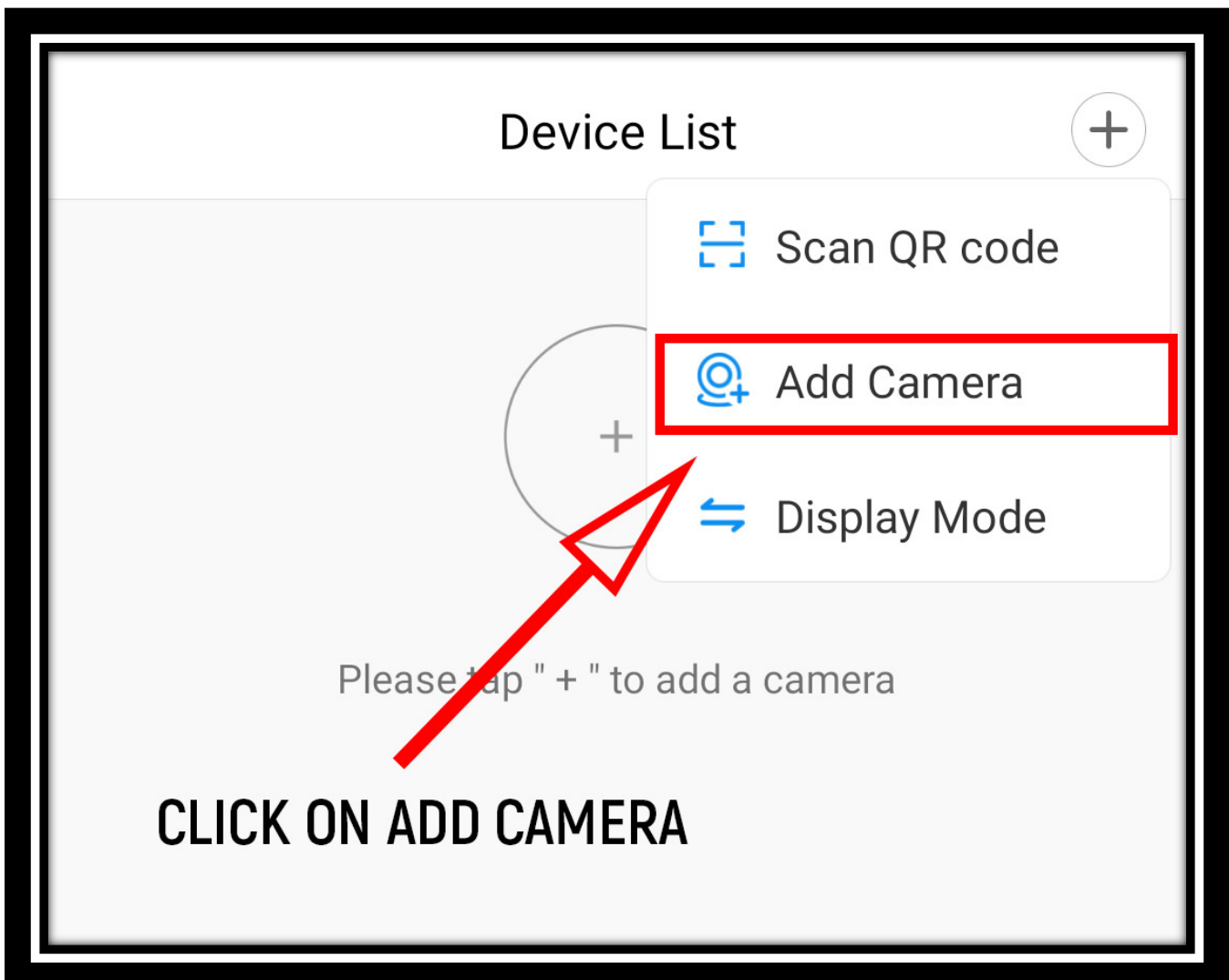

STEP 9

- Click Next



STEP 10

- Click on "Add network connected device"

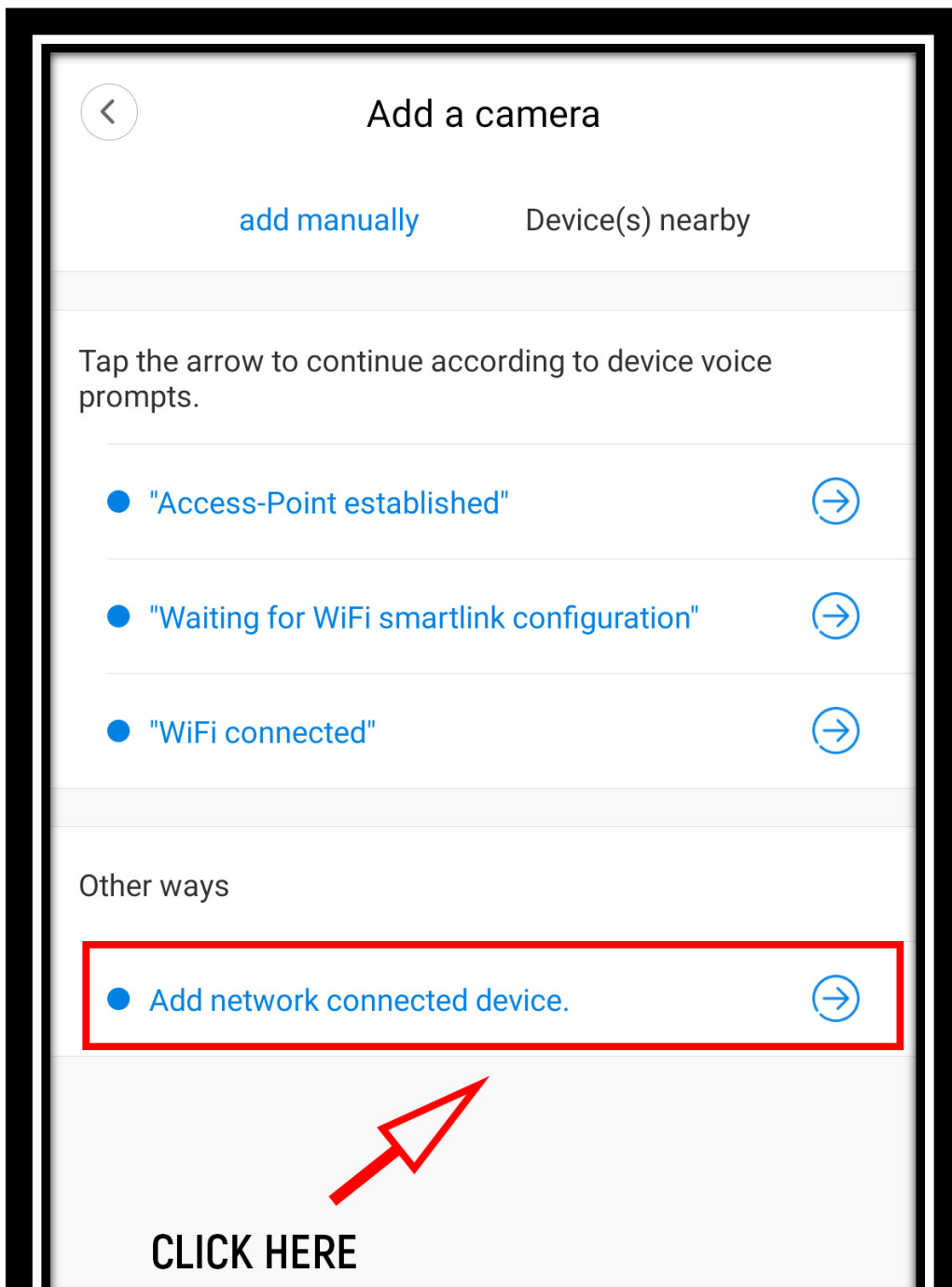

STEP 11

- Click on “Add Device ID”



Add a camera

Follow the Operation Tips after power on



Add device ID

STEP 12

- Click on the “Scanner Icon” which is present in “DEVICE ID” option. (See image below)
- Scan the QR code present at the back of the camera.
- **Do not change username and leave the password section blank.**
- After the code is scanned click on “Confirm”



Add a camera

Device ID



Device Username

Device Password



CLICK ON THE ICON TO SCAN THE QR CODE

Confirm

STEP 13 (OPTIONAL)

- One the camera is scanned; you can name your camera. E.g. Office, Home, Store Room.
- Click on Finish to continue.



Completed

Please select or enter your device name

living room

Home

Office

Bedroom

Doorway

Reception

Kitchen

study

Custom device name

Finish

Skip

STEP 14

- You will see a black screen and at the bottom of the screen you will get “LAN ONLINE” text which means that the camera has been successfully connected to the APP.

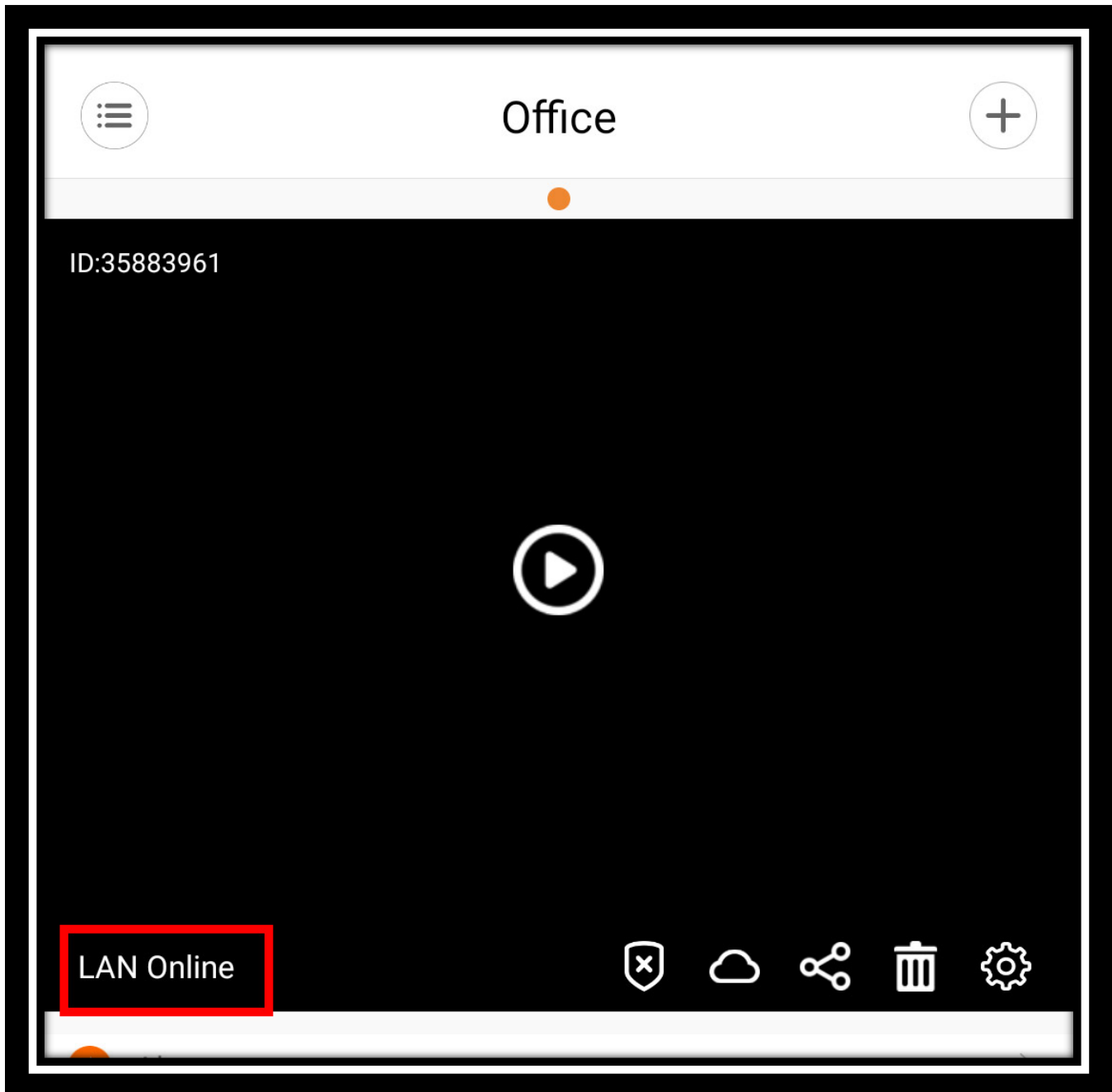

STEP 15

- Click on the Play option to choose password for the camera.
- This password will be used to access the camera from the app.

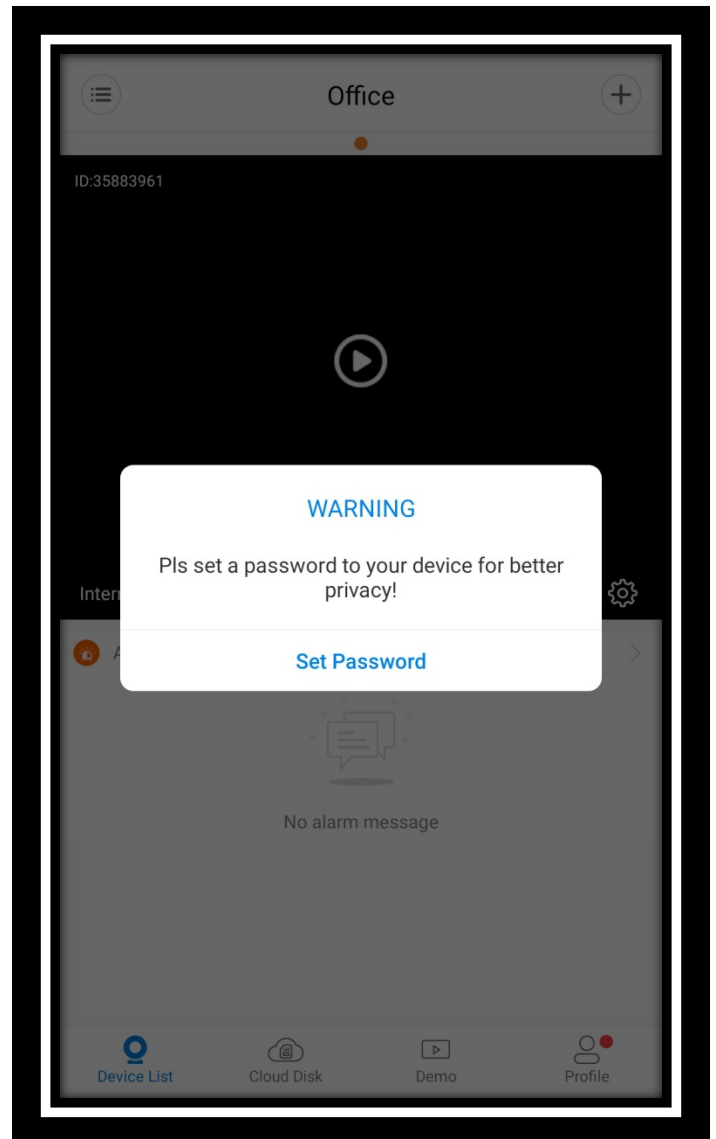
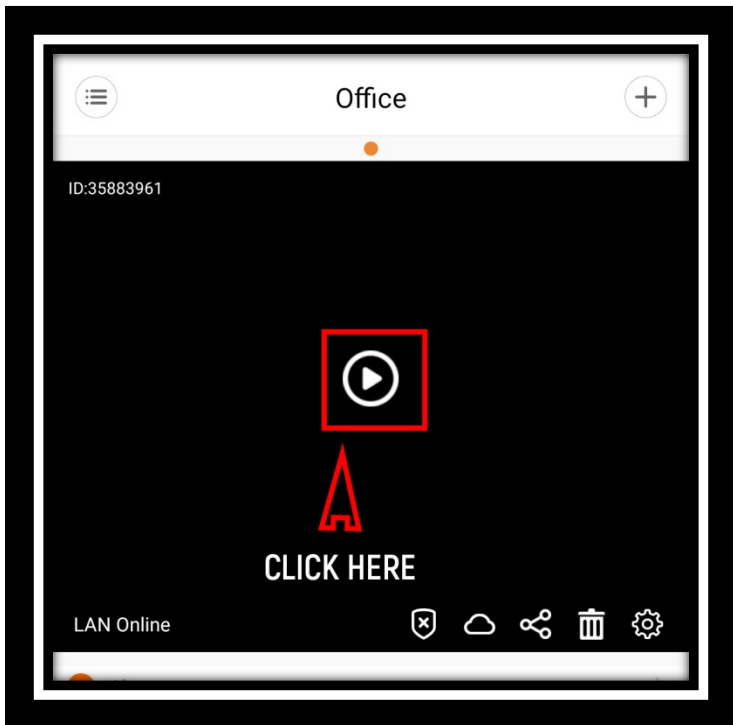

STEP 16

- Once the password is set you need to click on the setting icon which is present at the bottom of the black screen.



Office



ID:35883961



LAN Online



 Alarm message



CLICK HERE

No alarm message



STEP 17

- Now click on “NETWORK” Option and choose “CHANGE TO WIFI STATION MODE”

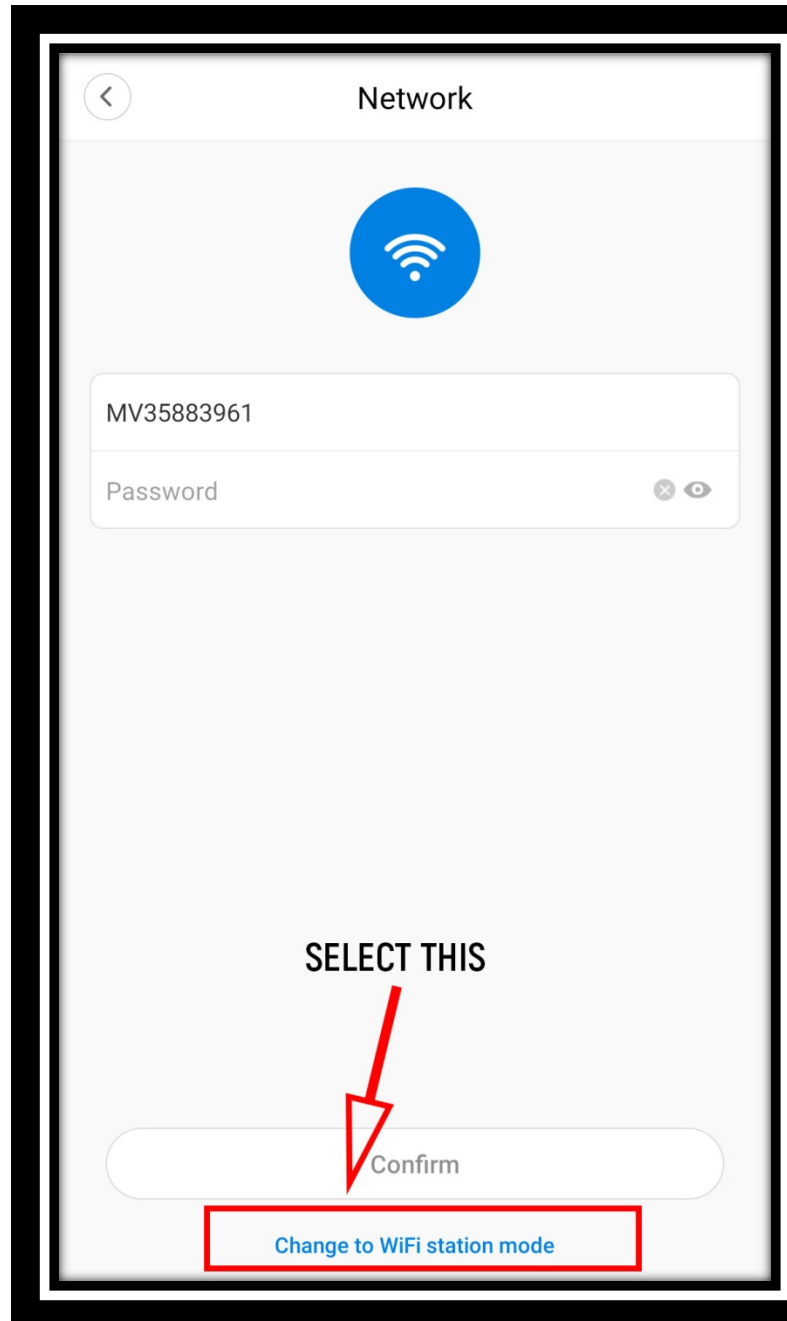
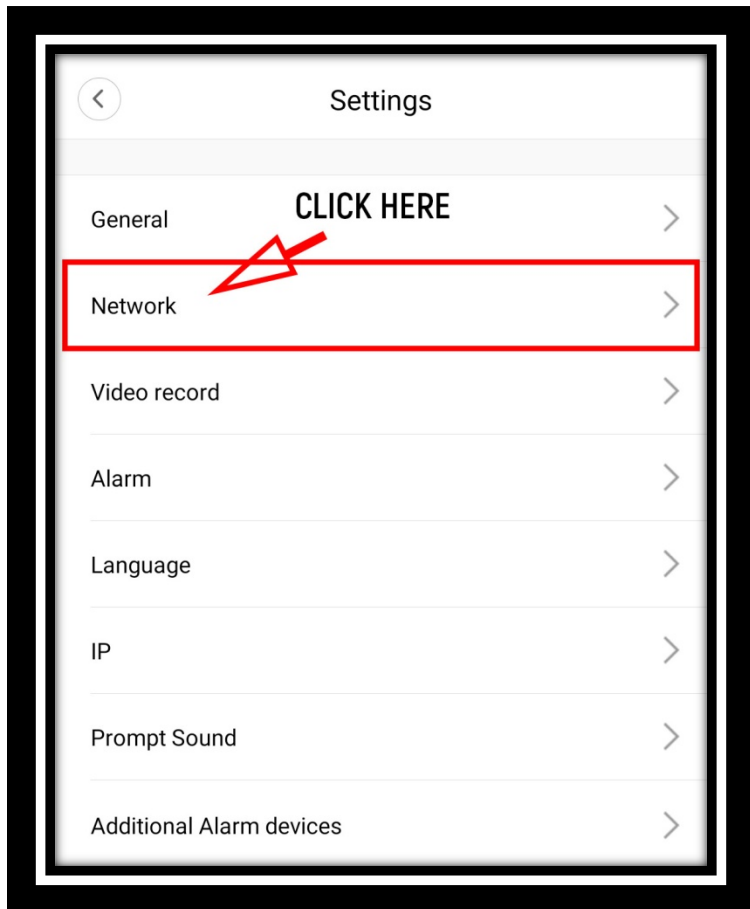

STEP 18

- Select your Wi-Fi name and enter your router password
- Click confirm button to connect the camera to your Wi-Fi

STEP 19

- Once the camera is connected to your Wi-Fi you will be able to access your camera from anywhere through the V380 Pro app.
- You will see “Internet Online” text at the bottom of the screen this means the camera has been successfully connected to your Wi-Fi



Office



ID:35883961



Internet online

