

# BRAINWAVZ<sup>®</sup>

## EARPADS FOR SENNHEISER HEADPHONES

PCX480 | PCX550 | PCX550 II | MB 660 UC | MB 660 UC MC

### QUICK INSTALLATION GUIDE

#### Remove Old Pads

#### **NOTE**

Pads are secured via a set of click-in tabs

- 1 Hold the headphones firmly with one hand (A)
- 2 With your other hand, grip the earpad and pull away from the head unit (B).

You will hear several clicks as the pad releases from the clips.

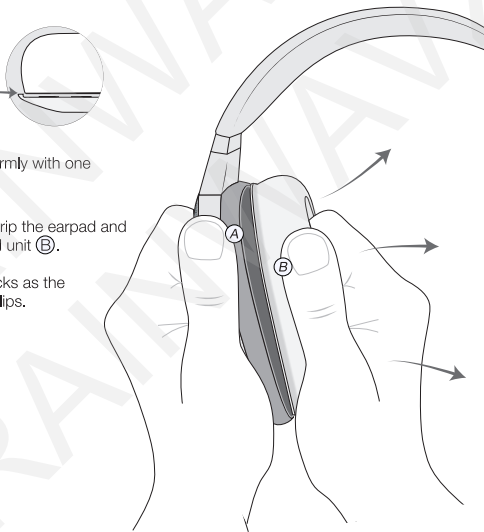

## Get To Know The Earpads

### NOTE:

*There is no specific left or right version, the earpads can be installed on either side of the headset.*



Front View

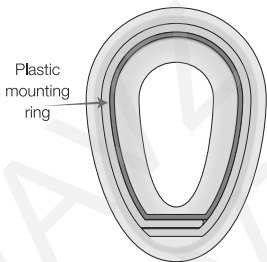

Rear View

## Install Replacement Earpads

- 3** Offer the earpad up to the head unit, flip it over and gently place it into position.

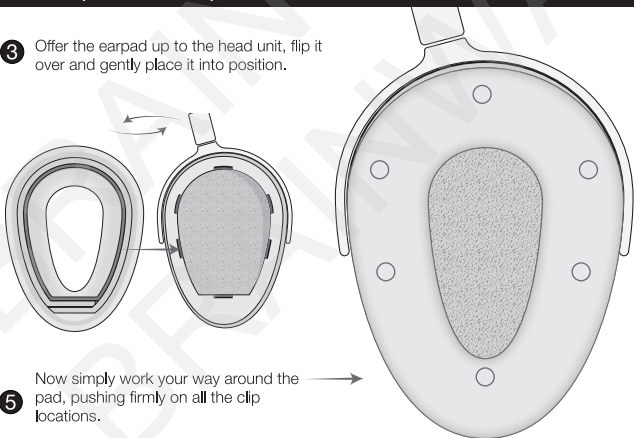

- 5** Now simply work your way around the pad, pushing firmly on all the clip locations.

Gently pull on the pad to ensure all clips are in place.