

BRAINWAVZ[®]

EARPADS FOR JBL

E65BTNC | DUET NC | LIVE 650 BTNC | LIVE 660 NC

QUICK INSTALLATION GUIDE

Remove Old Pads



- 1 Gently insert a flat, blunt tool between the earpad and headphone body (A)
- 2 Carefully twist your tool back and forth until the pad starts to break loose, repeat around the pad until it comes free.

(Use a blunt knife, metal ruler, guitar pick or credit card as a removal tool)

NOTE

Pads are a very tight fit, please be careful not to scratch or damage your headphones when inserting your removal tool of choice

Get To Know The Earpads

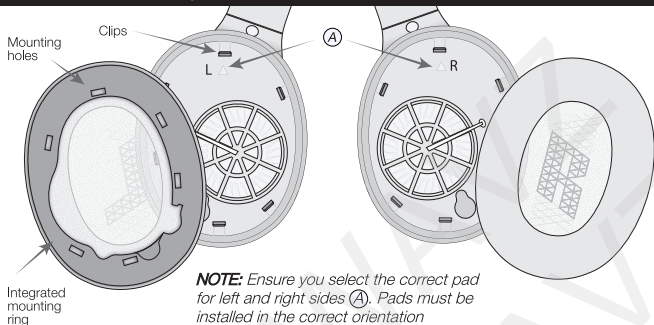

Install Replacement Earpad

- 4 Place the ear pad on the ear cup and align mounting holes with the corresponding clips (B).

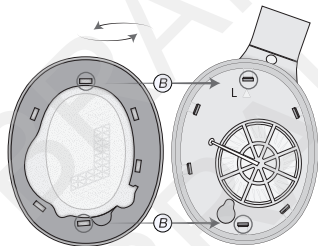

- 5 Press the pad firmly into the ear cup and apply pressure all round until the pad clicks tightly into place.

