

# BRAINWAVZ<sup>®</sup>

## EARPADS FOR BOSE QC35 / 35II

### QUICK INSTALL GUIDE

#### Remove Old Pads

1

Grip the earpad firmly between thumb and fingers.

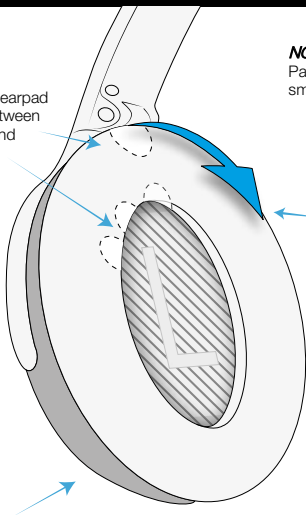

#### NOTE

Pads are secured via small built in tabs

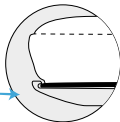

2

Pull the earpads in a forward and downward motion towards the bottom.

You may hear multiple “clicks” as the pad releases from the internal tab system.

3

Remove the Scrim (A) from the earcup (B). This is held on with a small amount of tape and will come free easily.

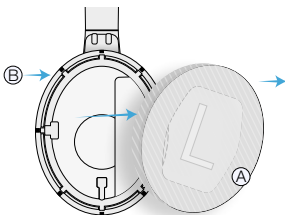

#### NOTE

Hold the headphones steady during the removal procedure.

## Install Replacement Scrim (Dust Protection)

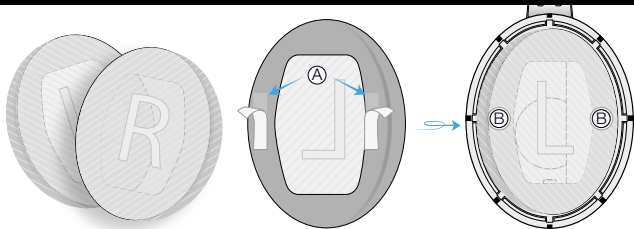

### **NOTE:**

Select the correct Scrim for each side of the headphones.

- 4 Peel the adhesive backing paper (A) from the 2 small pieces of tape.
- 5 Place the Scrim into the centre of the earcup. Lightly apply pressure on the two tape sections (B).

## Install Replacement Earpad

**NOTE:** There is a rigid retaining ring on the rear of the earpad. This is used to secure the pads into the tabs on the earcup.

- 6 Place the earpad onto the earcup, there is no particular orientation.

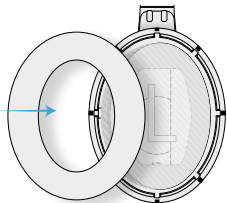

- 7 Push the edges of the earpad retaining ring firmly into each one of the tabs.

Ensure all tabs are correctly inserted, some may take a little more force than others.

