

## HENGJA USER GUIDE

### Warranty + Safety Guidelines

Brainwavz warrants that this product shall be free from defects in material or workmanship for a period of 24 months from the date of purchase from an authorized Brainwavz distributor or reseller. Except where prohibited by applicable law, this warranty is non-transferable and is limited to the original purchaser. This warranty gives you specific legal rights, and you may also have other rights that vary under local laws.

Keep the product away from young children, as this product includes small parts which may create a choking hazard.



Adjustable Headphone Hanger  
User Guide and Warranty Card

In case of any problems please contact us by email:

[help@yourbrainwavz.com](mailto:help@yourbrainwavz.com)



### Adjustment Tool (Included)

Combined 4mm allen/hex key and flathead screwdriver tool.

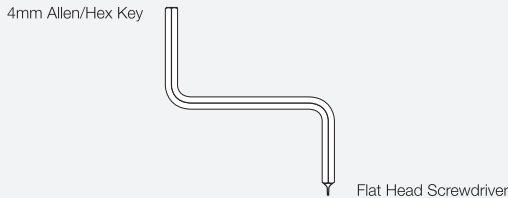

### Product Dimensions

- A** Adjustable Clamp Space :  
min. 14 mm to max. 41 mm
- B** Outer Frame Dimensions :  
min. 42 mm to max. 52 mm
- C** Outer Dimensions incl. Thumb Screw :  
min. 46 mm to max. 73 mm

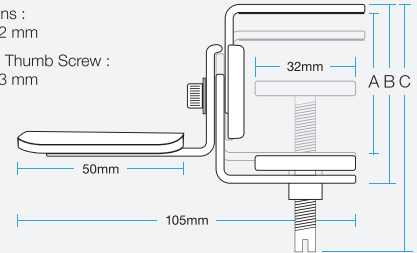

### Clamp Size Adjustment

- 1** Use adjustment tool **A** to turn the Central Bolt **B** counterclockwise one and a half turns to loosen the clamping arms **C**.

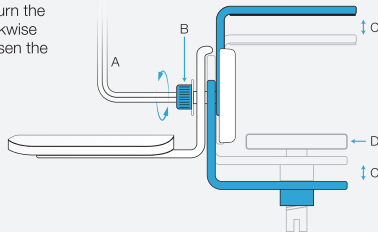

- 2** Move the Clamp Arms **C** up / down until desired size is reached, this should be wide enough to fit the location, with enough space for the Thumb Screw **D** to be tightened.

- 3** Use adjustment tool **A** to turn Central Bolt **B** clockwise to fix the Clamp Arms **C** into position.

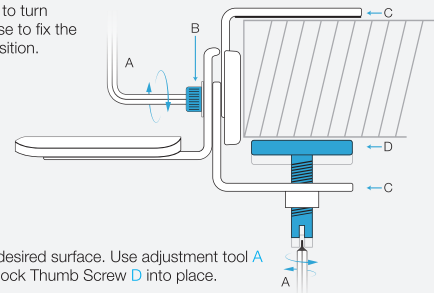

- 4** Place the clamp onto desired surface. Use adjustment tool **A** and turn clockwise to lock Thumb Screw **D** into place.

# Clamp Orientation Adjustment

- Use adjustment tool **A** to turn Central Bolt **B** counterclockwise one and a half turns to loosen Clamp Arms **C**.

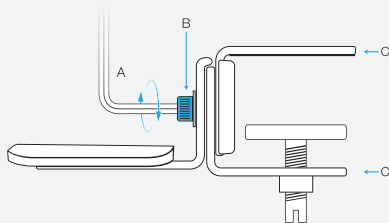

- Rotate the Headphone Seat **A** 90 degrees as shown below.

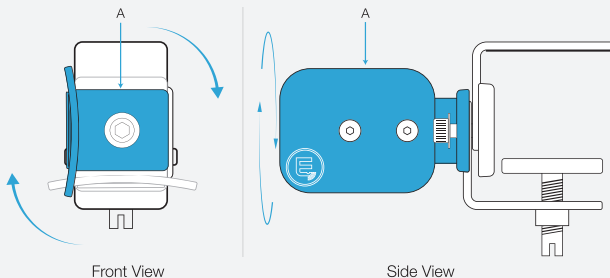

- Use adjustment tool **A** to turn Central Bolt **B** clockwise to tighten Clamp Arms **C** into fixed position.

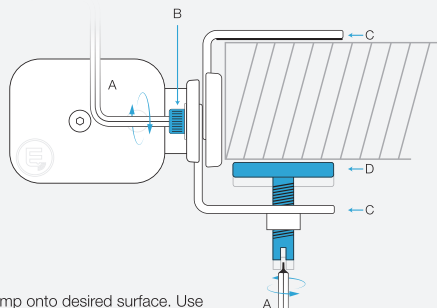

- Place clamp onto desired surface. Use adjustment tool **A** and turn clockwise to lock Thumb Screw **D** into place.



Horizontal Orientation



Vertical Orientation

Design and Specifications are subject to change without notification. Visit [www.brainwavzaudio.com](http://www.brainwavzaudio.com) for latest information on all Brainwavz products.

Brainwavz Model:  Date of Purchase    RMA/Order Number:

Your Name

Your Email Address

Your Mailing Address

Vendor

Description of Problem

To facilitate warranty, please contact the authorized vendor the product was purchased from.