

# BRAINWAVZ<sup>®</sup>

## CLAMP - ASSEMBLY GUIDE

Images in this guide are for illustration only - your product may differ from that shown

### Attach the Clamp

- 1 Slide the clamp **(A)** onto the hangers clamp mounting slot **(B)** from the bottom upwards.

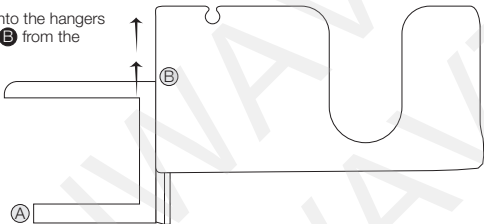

- 2 Ensure the clamp **(A)** is pushed up as far as it can go, then place the bolt **(C)** into the clamp, and finger tighten so it remains in place

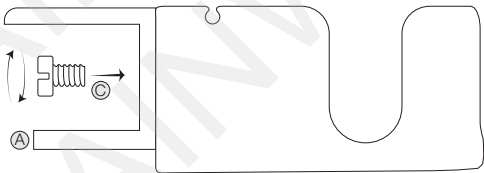

- 3 Use a flat head screwdriver **(D)** and turn the bolt **(C)** clockwise until you feel resistance - DO NOT OVER TIGHTEN

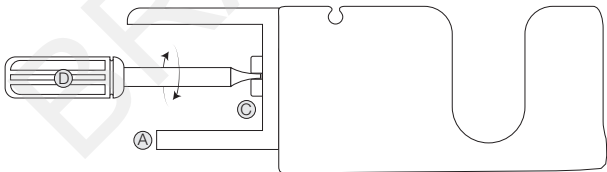

## Apply Non-Slip Furniture Protection Pads

- 1 Stick the felt pads **A** to the underside of the clamp **B**

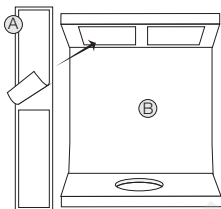

## Install Bolt

- 2 Thread the bolt clockwise (right) **C** into the hole on the bottom of the clamp **B**

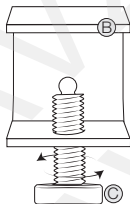

## Attach Brace Plate

- 3 Hold the clamp **B** and brace plate **D** with two hands and press down firmly to clip the plate onto the bolt **C**

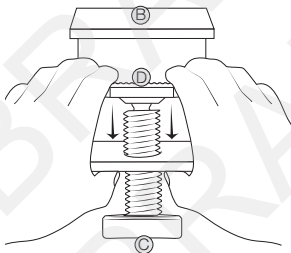

## Clamp on to Desk

- 4 Adjust the bolt so that it is just a little wider than the thickness of intended surface.
- 5 Slide the clamp onto the surface and turn the bolt **C** gently clockwise (right) until you feel a little resistance, then twist the bolt **one more half turn** to fix the clamp firmly in place

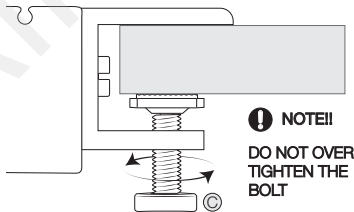

Visit [brainwavzaudio.com/collections/clamp-on-collection](https://brainwavzaudio.com/collections/clamp-on-collection) to see the full range.