

DETACH EARPAD

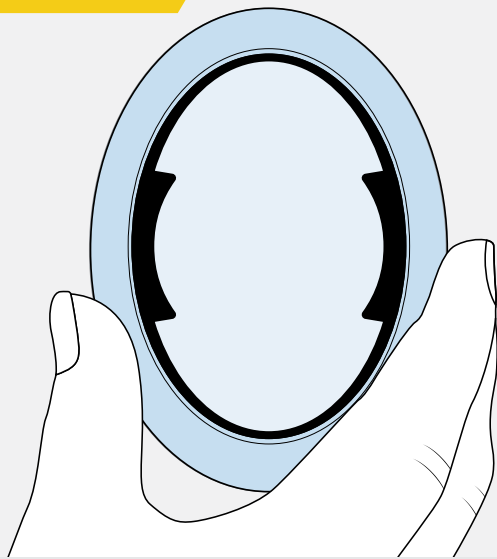

1 Hold earpad mounting ring

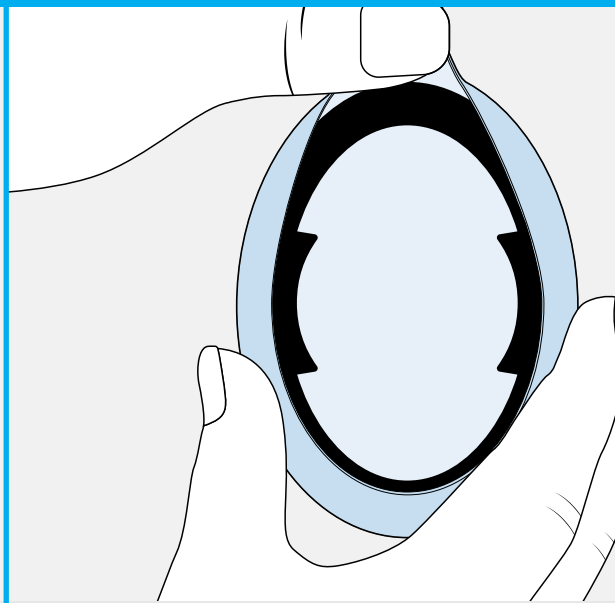

2 Gently pull the inner lip of the earpad

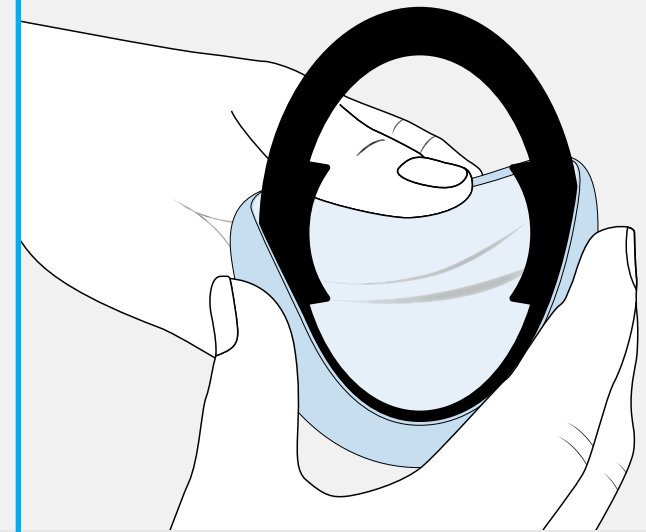

3 Pull back and remove the earpad

ATTACH EARPAD

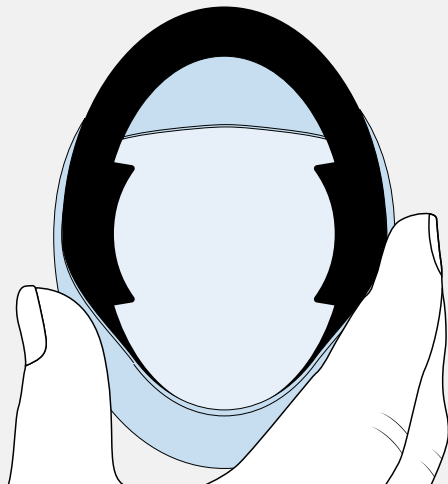

1 Insert earpad mounting ring into inner lip of the earpad

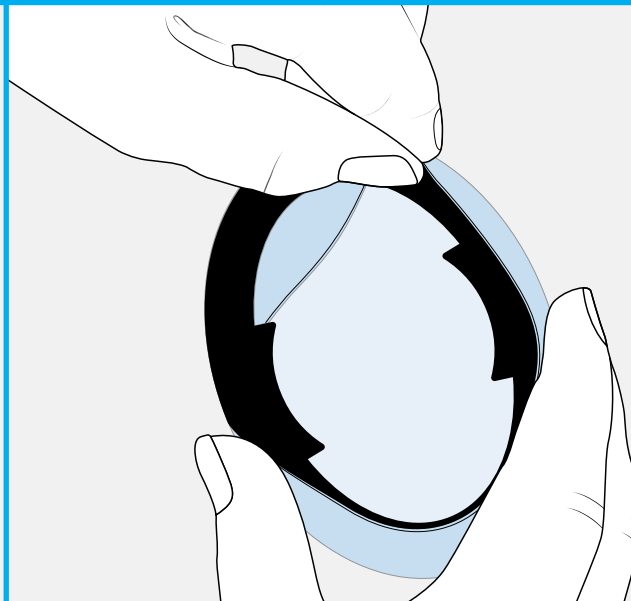

2 Hold the already inserted part in place and further pull the inner lip over the mounting ring

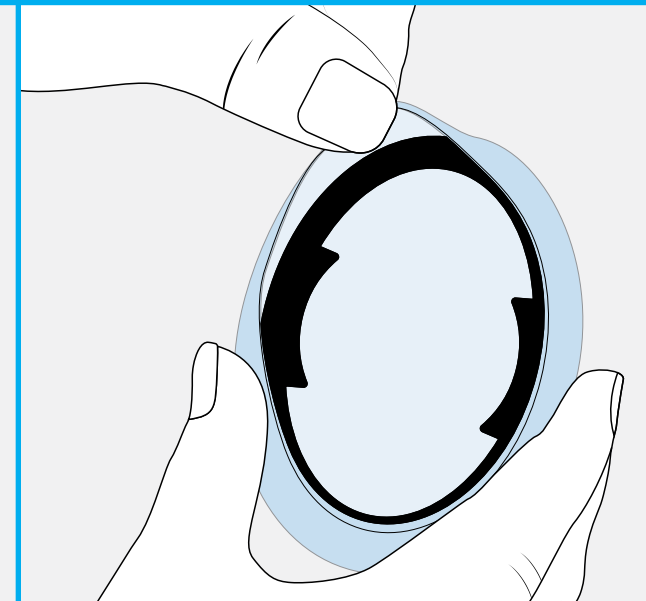

3 The last section may need a little bit of force to fully insert the mounting ring into the inner lip of the earpad



REPLACEMENT QUICK GUIDE

EARPADS