

Brainwavz warrants that this product shall be free from defects in material or workmanship for a period of 12 / 24 months (see packaging for details) from the date of purchase from an authorized Brainwavz distributor or reseller. Except where prohibited by applicable law, this warranty is non-transferable and is limited to the original purchaser. This warranty gives you specific legal rights, and you may also have other rights that vary under local laws.

- Do not use any earphones or headphones at excessively loud levels.
- Using earphones and headphones at high volumes or for extended periods of time (more than 1 hour period per day) can permanently damage your ears.
- Ringing in your ears or other discomfort can indicate that the music volume is too high.
- For safety reasons DO NOT use earphones and headphones while driving a car, biking, walking or operating machinery.
- Keep your earphones or headphones away from young children, this product includes small parts and cables which may create a choking hazard.

USER GUIDE

HM5 | HM100 | ALARA



HEADPHONE

User Guide & Warranty Card

In case of any problems please contact us by email:

help@yourbrainwavz.com



Fitting Guide (Images for illustration purposes - headphone model may differ)

Retractable Headband - All models



The headbands are expandable, providing a good fit for individual head sizes.

Adjustable Ear Cups

The ear cups swivel & pivot to enhance the level of comfort and seal.

Level of adjustability is dependant on each model.

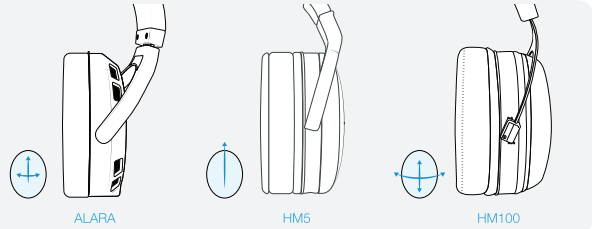

Fitting Headphones

Extend headband to its maximum length.

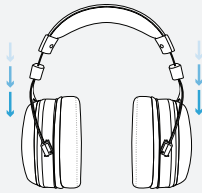

Position the earcups central to the ear canals (A).



Hold cups in place (A) and gently push down headband (B) onto your head.

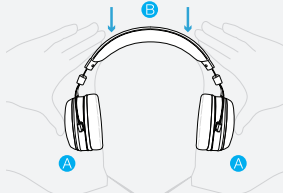

For the best fit and comfort, adjust the headphone to your personal preference.



Care and Storage (Images for illustration purposes)

1 Lay cords over hand.

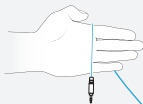

2 Gently wrap cord around your hand.

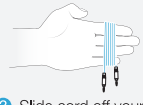

3 Slide cord off your hand.



Oval Case with Removable Pouch

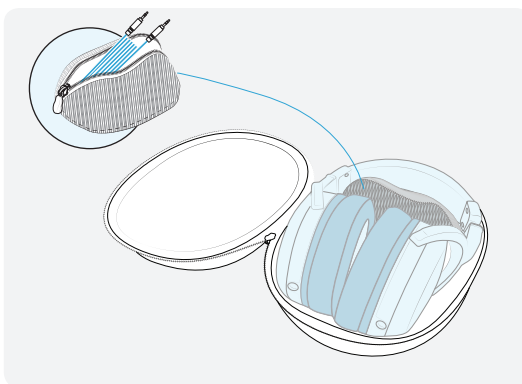

Square Case with Storage Pockets

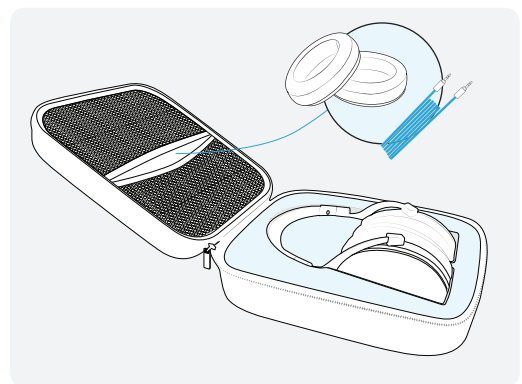

Alara : Exchangeable Earpads

Remove Earpads

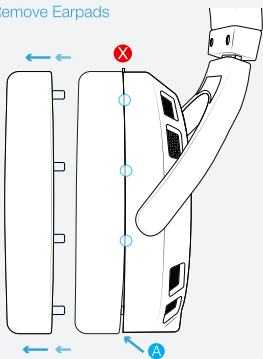

Gently push edge of pad (A) until it starts to release - repeat around the edge (C) until pad comes free.

Attach Earpads

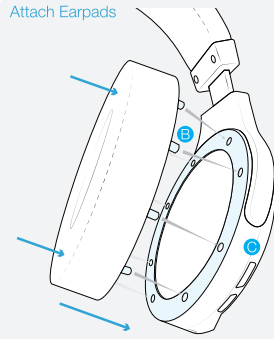

Line up pegs on the pad ring (B) to the holes on the head unit (C), push firmly until flush and pad sits firmly in place.

X Do not push on this tab - this is not part to the earpad system

HM5 / HM100 : Exchangeable Earpads

Remove Earpads

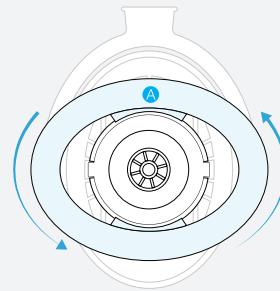

Gently twist the pad and support ring (A) counter-clockwise 90 degrees until they come free.

Attach Earpads

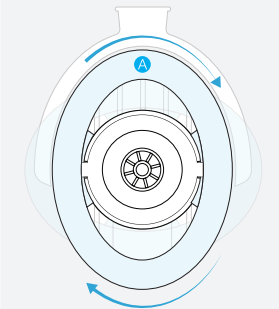

Bring the pad and support ring (A) to the earcup at 90 degrees and twist clockwise until locked in place.

i Illustration shows pad support ring only - please see your earpads instruction manual / guide for adding, removing earpads.

Cables : Connect cables to head units

i Images for illustration purposes only - All headphones use similar plug system : Alara model shown.

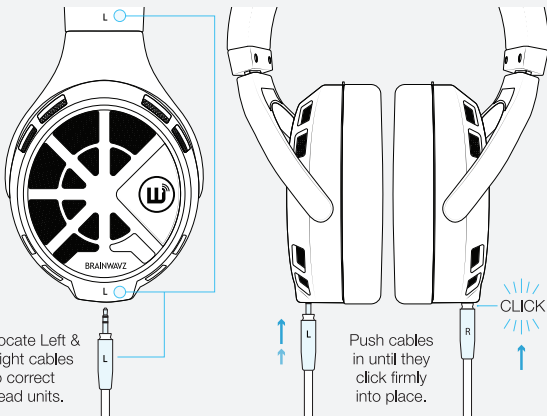

Locate Left & Right cables to correct head units.

Push cables in until they click firmly into place.

Cleaning & Care

i ONLY clean headphones when detached from any audio device or mobile phone!

- If possible, not glued on, carefully remove the earpads from the headphone unit.
- Use a damp (NOT wet) cloth and wipe headphone unit clean.
- Use a gentle cleaner, like soap and warm water, e.g. small amount of dish washing detergent and water.
- Use a gentle cloth with just a small amount of the soap mixture.
- If there is a lot of dirt or dust on the headphones, try brushing them gently with a dry toothbrush.

IMPORTANT

- DO NOT USE too much soap.
- DO NOT USE heavy duty cleaner.
- DO NOT USE too much water.
- NEVER submerge headphones in water, it will damage the wiring.
- NEVER put headphones under running water, not even for just a second.

In case of any problems please contact us by email:

help@yourbrainwavz.com



Brainwavz Model: Date of Purchase RMA/Order Number:

Your Name

Your Email Address

Your Mailing Address

Vendor

Descriptions of Problem