

BLUETOOTH BLU-300

Warranty + Safety Guidelines

Brainwavz warrants that this product shall be free from defects in material or workmanship for a period of 12 months from the date of purchase from an authorized Brainwavz distributor or reseller. Except where prohibited by applicable law, this warranty is non-transferable and is limited to the original purchaser. This warranty gives you specific legal rights, and you may also have other rights that vary under local laws.

- Do not use any earphones and headphones at excessively loud levels.
- Sealed eartips and lower volumes allow for longer periods of safe listening.
- Using earphones and headphones at high volumes or for extended periods of time (more than 1 hour period per day) can permanently damage your ears.
- Ringing in your ears or other discomfort can indicate that the music volume is too high.
- For safety reasons DO NOT use earphones and headphones while driving a car, biking, walking or operating machinery.
- Keep your earphones or headphones away from young children, this product includes small parts and cables which may create a choking hazard.



User Guide & Warranty Card

Bluetooth Earphones

In case of any problems please contact us by email:

help@yourbrainwavz.com



Power On - Power Off

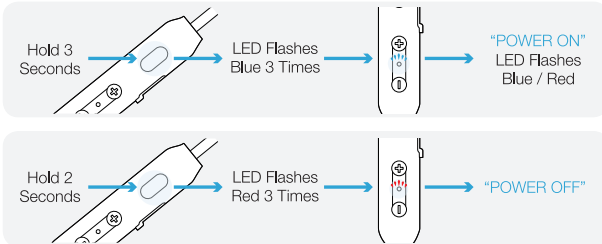

Factory Reset (Remove all previous connections).

Plug Bluetooth headphones into charge before resetting (See CHARGING overleaf)

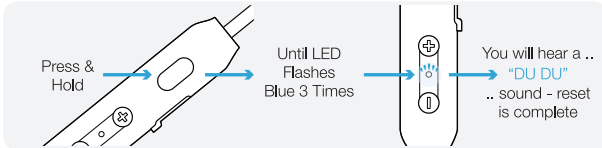

Phone Call Controls

- ANSWER CALL - One quick press
- END CALL - One quick press
- LAST NUMBER DIAL - Two quick presses
- REJECT CALL - Press & hold for 1 second

- VOLUME UP - Quick presses
- VOLUME DOWN - Quick presses



Pairing (Procedure may differ for some devices).

1 Engage PAIRING mode (Ensure headset is OFF before proceeding).



2 Activate your device's Bluetooth mode to find your headset.



Please refer to your phone/ device manual on how to activate Bluetooth and "pair" devices.

3 Select your device to enable connection.

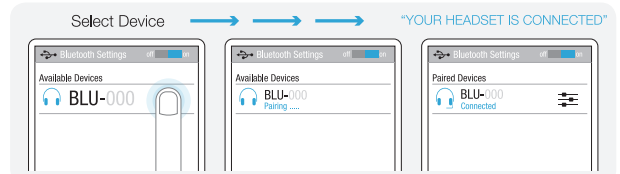

If connection fails repeat steps 1 - 3 (Procedure may differ for some devices).

Media Controls

- PLAY - One quick press
- PAUSE - One quick press

- VOLUME UP - Quick presses
- NEXT SONG - Press & hold for 1 Seconds

- PREVIOUS SONG - Press & hold for 1 Second
- VOLUME DOWN - Quick presses



Charging - (Indicator light will flash red when battery is low)

- 1 Lift the Side Cover **A** on the RIGHT side of the earphones to expose the USB socket **B**.
- 2 Plug in the small end of the USB cable **C** into the USB socket **B**.

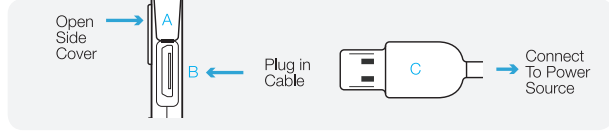

- 3 Plug in the large end **D** into a computer USB socket or USB charger (charger not supplied).

Charging

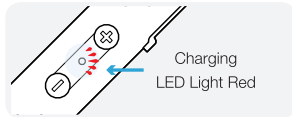

Charging Complete

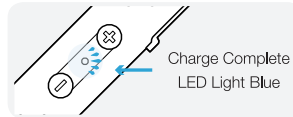

Remote Control Unit / Microphone

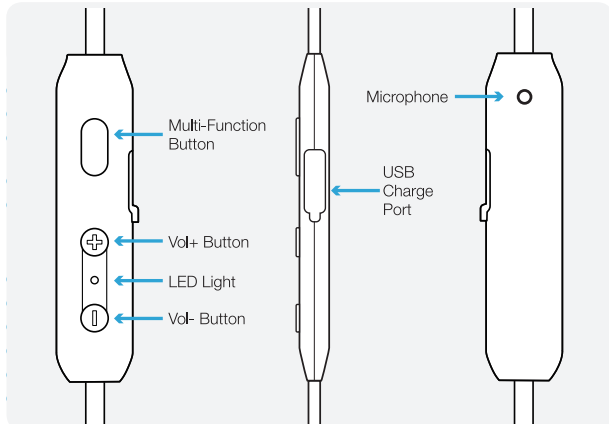

Fitting Guides

Wearing the Earphones

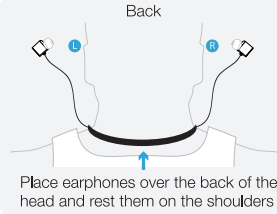

Secure When Not in Use

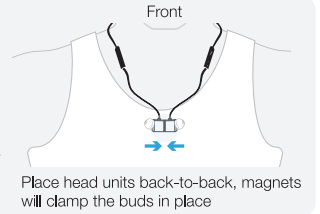

Removing Silicone Ear Tips

Hold earphone body tight **A**, pinch tip with other hand **B**, gently twist left & right while pulling tip in a downward motion.

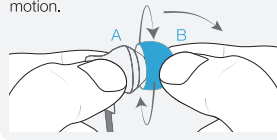

Fitting Silicone Ear Tips

Hold earphone body tight **A**, offer tip to nozzle at 45° angle, twist left and right as you gently push tip forward.

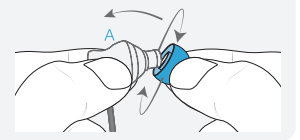

Specifications

Bluetooth Version:	4.1
Chipset:	CSRQCC3003
Profiles:	A2DP, AVRCP, HFP, HSP, DI
Pairing:	Single & Dual Pairing
Operating Range:	Up to 10 m / 30 ft
Voice Prompt:	Yes
Battery:	100 mAh
Play / Standby Time:	~6-8 hours / ~250 hours
Charge Time:	1-2 hours

Design and Specifications are subject to change without notification. Visit www.brainwavzaudio.com for latest information on all Brainwavz products.

Brainwavz Model: Date of Purchase RMA/Order Number:

Your Name

Your Email Address

Your Mailing Address

Vendor

Description of Problem

To facilitate warranty, please contact the authorized vendor the product was purchased from.

12018301811B