

# MLRK1-MRK



## INSERT INSTRUCTIONS

The Command Access MLRK1 is a field installable motorized latch-retraction kit for:

- MLRK1-MRK - Marks M9900 series devices
- MLRK1-DH - Design Hardware 1000 series device

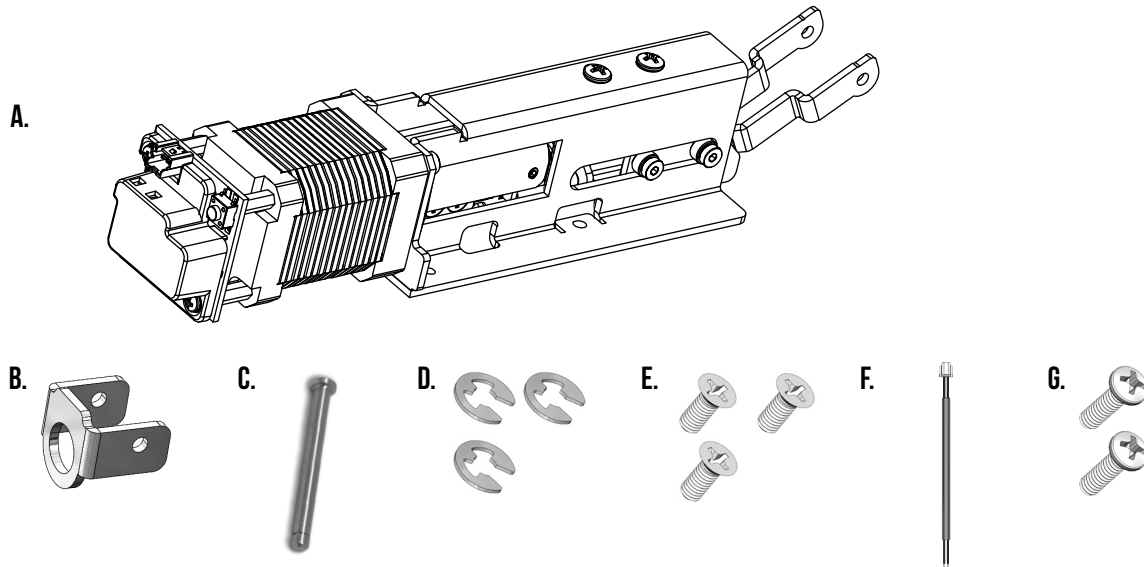

## KIT INCLUDES

- A. (1) 60412 - MLRK1-MRK
- B. (1) 51222 - CONNECTING BRACKET
- C. (1) 51048 - CONNECTING PIN
- D. (3) 40067 - E-CLIP (2 EXTRA)
- E. (3) 40064 - M4 FLAT HEAD SCREW (1 EXTRA)
- F. (1) 50944 - MOLEX PIGTAIL
- G. (2) 40361 - M2 POSITION SET SCREWS



INSTALLATION VIDEO

## SPECIFICATIONS

- INPUT VOLTAGE: 24VDC +/- 10%
- AVERAGE LATCH RETRACTION CURRENT: 900 MA
- AVERAGE HOLDING CURRENT: 215 MA
- WIRE GAUGE: MINIMUM 18 GAUGE
- DIRECT WIRE RUN - NO RELAYS OR ACCESS CONTROL UNITS IN-BETWEEN POWER SUPPLY & MODULE

### OPTIONAL BUILT-IN REX

- SPDT - RATED .5A @24V
- GREEN= COMMON (C)
- BLUE = NORMALLY OPEN (NO)
- GREY = NORMALLY CLOSED (NC)

### RECOMMENDED POWER SUPPLIES: USE A POWER LIMITED CLASS 2 POWER SUPPLY

ALL COMMAND ACCESS EXIT DEVICES & FIELD INSTALLABLE KITS HAVE BEEN THOROUGHLY CYCLE TESTED WITH COMMAND ACCESS POWER SUPPLIES AT OUR FACTORY. IF YOU PLAN ON USING A NON-COMMAND POWER SUPPLY IT MUST BE A FILTERED & REGULATED LINEAR POWER SUPPLY.

1. Slide off **push pad assembly** from exit device.

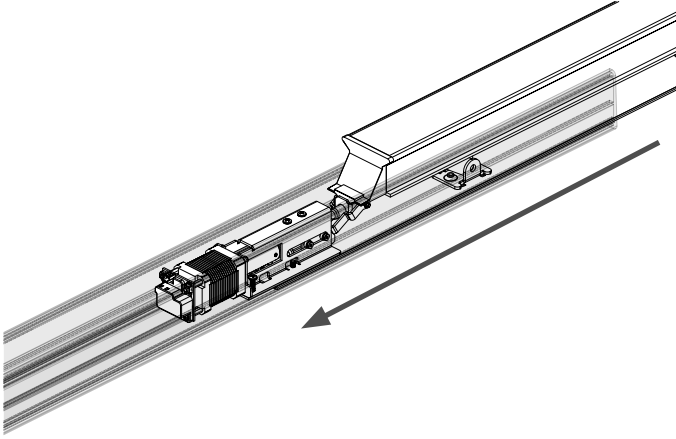

2. Remove existing dogging assembly (if equipped)

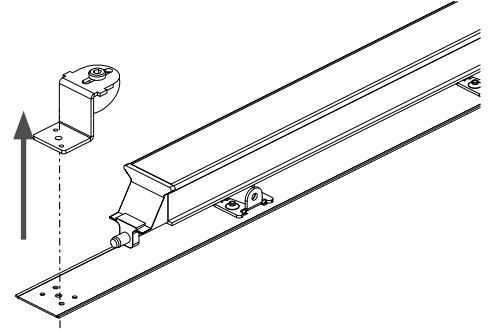

3. Install two (E) screws from underneath the baserail and into the Motor Bracket.

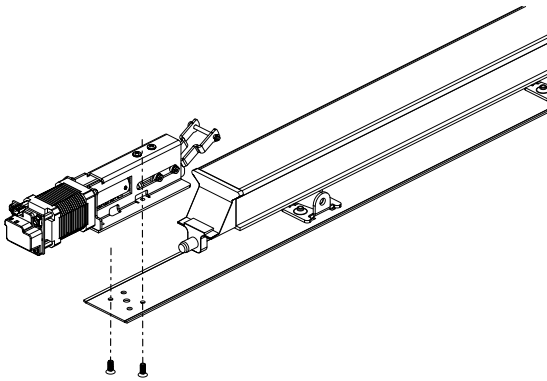

4. Slide the (B) **Connecting Bracket** over the Dogging post at the end of the push pad. Insert (C) **Connecting Pin** through connecting bracket and snap on (D) **E-Clip**.

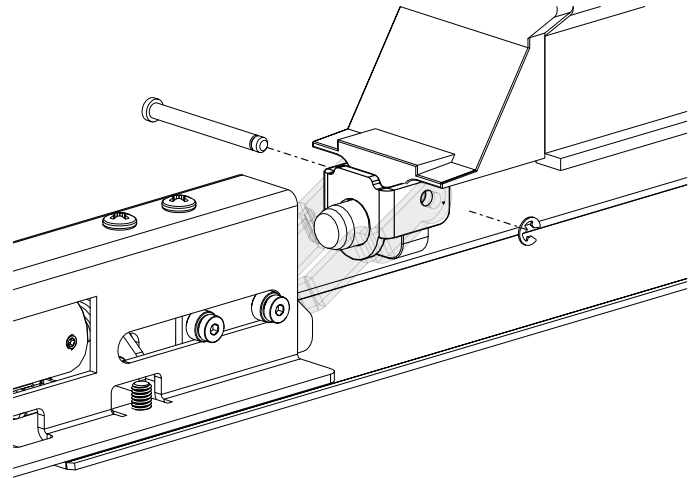

5. Screw in (G) **Position Set Screws (2)** a few threads until flush with the bottom of the motor bracket.

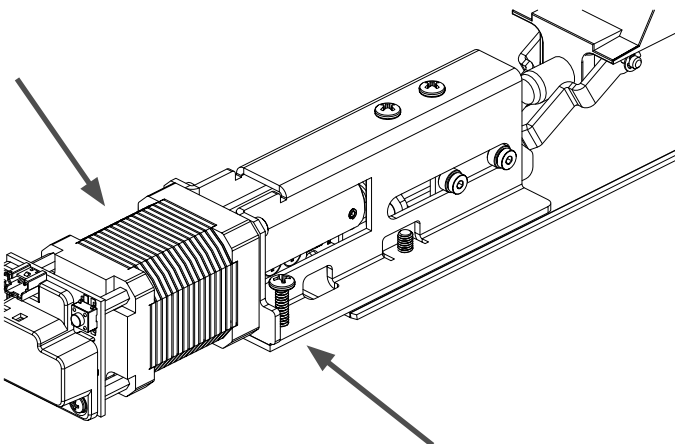

6. Re-install **Base Rail** into **Housing**.

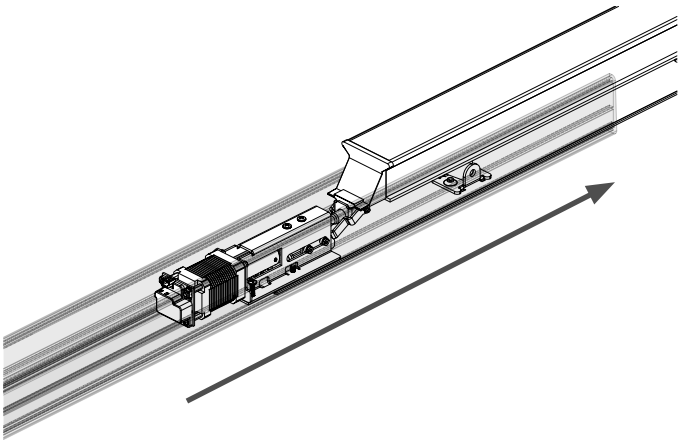

7. Once in position, securely tighten the two **Position Set Screws**.

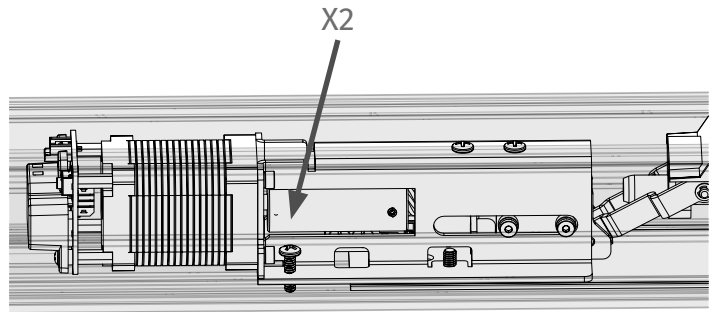

8. Set the "**Push to Set Adjustment**" following the steps on page 2.



## SETTING PUSH TO SET (PTS)

**\*\*IMPORTANT INFO\*\***

**MAKE SURE TO SET PTS BEFORE FINISHING INSTALLATION**

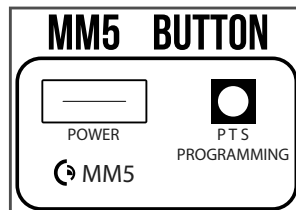

- STEP 1 -** To enter PTS mode: Depress MM5 button & apply power. The device will emit 1 SHORT beep. The device is now in PTS mode.
- STEP 2 -** While depressing the push pad, apply power. (i.e. presenting the credential to the reader).
- STEP 3 -** Continue to keep pad depressed, the device will emit 1 LONG Beep. After the beep has stopped, release the pad and now the adjustment is complete. test the new location, If not to your liking repeat the 3 steps.

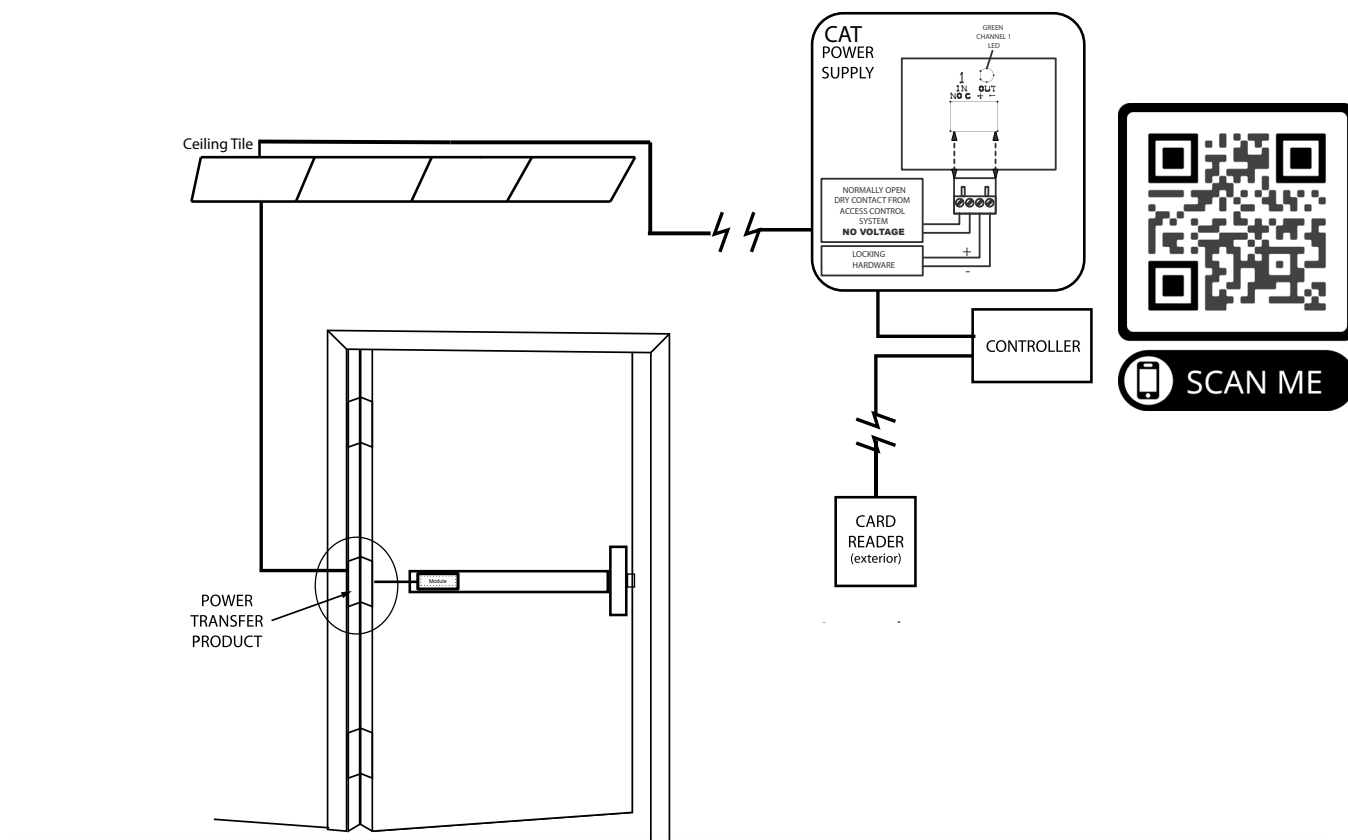

## SETTING PUSH TO SET (PTS)

MAKE SURE TO SET PTS BEFORE FINISHING INSTALLATION

- STEP 1** - To enter PTS mode: Depress MM5 button & apply power. The device will emit 1 SHORT beep. The device is now in PTS mode.
- STEP 2** - While depressing the push pad, apply power. (i.e. presenting the credential to the reader).
- STEP 3** - Continue to keep pad depressed, the device will emit 1 LONG Beep. After the beep has stopped, release the pad and now the adjustment is complete. test the new location, If not to your liking repeat the 3 steps.

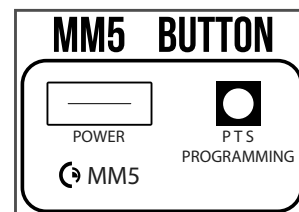

## TROUBLESHOOTING & DIAGNOSTICS

BEEPS	EXPLANATION	SOLUTION
2 Beeps	Over Voltage	> 30V unit will shut down. Check voltage & adjust to 24 V.
3 Beeps	Under Voltage	< 20V unit will shut down. Check voltage & adjust to 24 V.
4 Beeps	Failed Sensor	Verify all 3 sensor wires are installed correctly. Replace sensor if problem persists by contacting office.
5 Beeps	Retraction or dogging failure	After 1st fail: 5 beeps then immediately attempts to retract again. After 2nd fail: 5 beeps with pause in-between for 30 seconds then device attempts to retract again. After 3rd fail: 5 beeps every 7 minutes, device will not attempt to retract. To Reset: Depress bar for 5 seconds at any time.