



# HORIZONTAL BOTTLE COOLERS

## EBC – Series

• EBC37 • EBC50 • EBC65 • EBC80 • EBC95

### Cabinet Construction

Heavy duty stainless steel countertop, rail and lids, and textured and laminated black vinyl exterior. Galvanized steel interior. 1 3/4" thick high density foamed-in-place polyurethane insulation.

### Refrigeration System

- Side mounted condensing unit
- Oversized condenser and evaporator coil cools to set and maintain temperature in minimum time period
- Forced-air cooling with oversized evaporator fan motors providing balanced airflow through out cabinet to ensure faster temperature drop
- Removable side panel and slide-out condensing unit for convenient repair and maintenance
- Environmentally friendly CFC free R-134A refrigerant
- Air defrost controlled by electrical timer
- Copper tube and aluminum fin evaporator with anti-corrosive coating
- Energy efficient condensate drain pan assembly heated by high side copper tube
- Pre-wired and ready to plug, 115V/60Hz/1Ph, NEMA 5-15P

### Lids, Locks, Openers

- Heavy duty stainless steel, easy glide and removable lids
- 3/4" thick lids, foamed-in-place polyurethane insulation
- Ratchet locks to secure lids (Standard)
- Removable bottle cap opener and cap catcher

### Shelving

- Epoxy coated floor wire shelves for cold air circulation
- Adjustable epoxy coated wire bin dividers

### Temperature Control

- Factory preset temperature, 35°F
- Temperature setting range from 33°F to 41°F
- Easy to read digital temperature display
- Easy to program push button temperature control
- Microchip digital monitoring system with a variety of functions to monitor and maintain optimum temperature  
(Note: digital controls applied to models manufactured from April 2013)

### Option

- 2 1/2" and 4" diameter casters (3" and 5" overall height)



EBC37



EBC50



EBC65



EBC80



EBC95

<ul style="list-style-type: none"> <li>• Project / Customer _____</li> </ul>	<h3>Warranty</h3>	<p>2 Year — Parts &amp; Labor 5 Year — Compressor</p>	<p>Please visit our website for updated Energy Efficiency information</p>
<ul style="list-style-type: none"> <li>• Item No. _____</li> <li>• Model No. _____</li> </ul>			<p>201 W. Artesia Blvd, Compton, CA 90220 T. (310) 323-6586, (800) 444-6285 F. (310) 323-7524 <a href="http://www.EVERESTref.com">www.EVERESTref.com</a></p>

# HORIZONTAL BOTTLE COOLERS



## EBC – Series

• EBC37 • EBC50 • EBC65 • EBC80 • EBC95

### Dimensions

#### SIDE VIEW

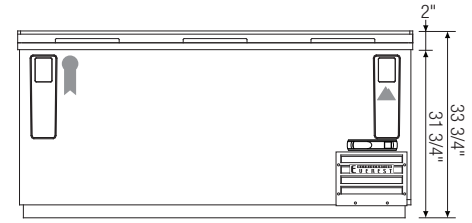
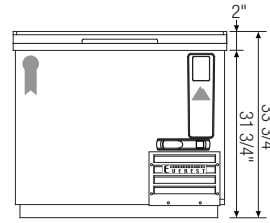
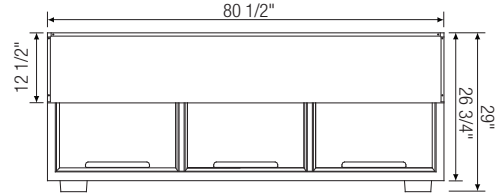
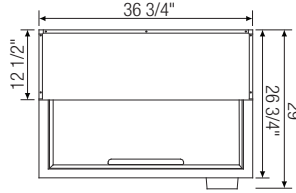
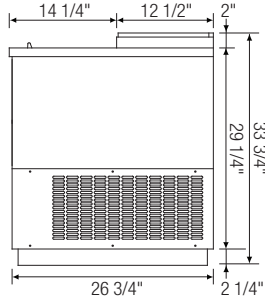

▲ EBC37

▲ EBC80

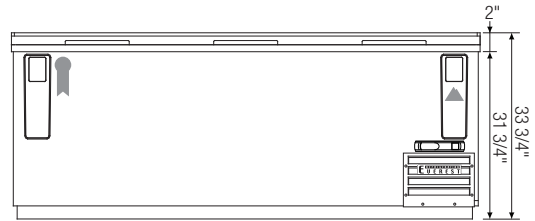
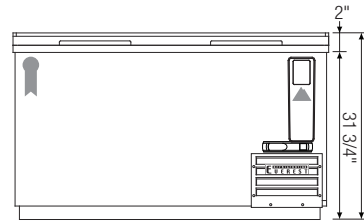
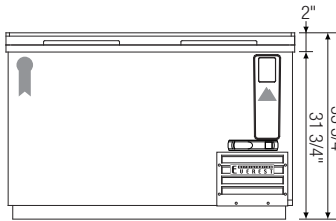
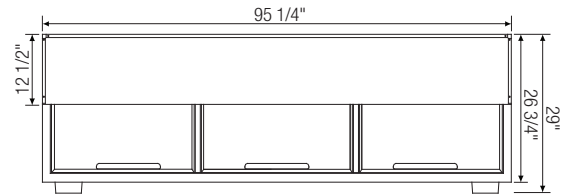
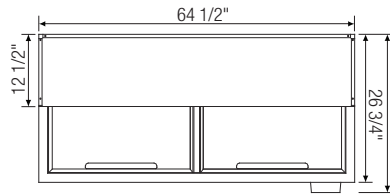
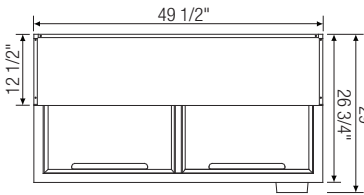

▲ EBC50

▲ EBC65

▲ EBC95

Model	Ref/ Fzr/ Dual	# of Lids	Capacity (Cu.Ft.)	HP	Refrigerant	# of Bin Dividers	# of Floor Shelves	Power (V-Hz-Ph)	Amps	Crated Weight (LBS)	Exterior Dimensions (Inches)			* Depth does not include bottle cap opener with integrated cap receptacle.  Ref = Refrigerator Fzr = Freezer Dual = Ref & Fzr Combo
											L	D	H *	
EBC37	Ref	1	9.30	1/4	R-134A	2	1	115-60-1	4.20	192	36 3/4	26 3/4	33 3/4	
EBC50	Ref	2	13.60	1/4	R-134A	3	2	115-60-1	4.20	236	49 1/2	26 3/4	33 3/4	
EBC65	Ref	2	18.90	1/4	R-134A	4	2	115-60-1	4.20	276	64 1/2	26 3/4	33 3/4	
EBC80	Ref	3	24.40	1/3	R-134A	5	3	115-60-1	5.40	333	80 1/2	26 3/4	33 3/4	
EBC95	Ref	3	29.60	1/3	R-134A	6	3	115-60-1	5.40	370	95 1/2	26 3/4	33 3/4	

Specifications subject to change without notice.

[www.EVERESTref.com](http://www.EVERESTref.com)

201 W. Artesia Blvd, Compton, CA 90220  
T. (310) 323-6586, (800) 444-6285 F. (310) 323-7524