



HORIZONTAL BOTTLE COOLERS

EBC – Series

• EBC37 • EBC50 • EBC65 • EBC80 • EBC95

Cabinet Construction

Heavy duty stainless steel countertop, rail and lids, and textured and laminated black vinyl exterior. Galvanized steel interior. 1 3/4" thick high density foamed-in-place polyurethane insulation. Built in caster thread receptacles for all units.

Refrigeration System

- Side mounted condensing unit
- Oversized condenser and evaporator coil cools to set and maintain temperature in minimum time period
- Forced-air cooling with oversized evaporator fan motors providing balanced airflow through out cabinet to ensure faster temperature drop
- Removable side panel and slide-out condensing unit for convenient repair and maintenance
- Environmentally friendly CFC free R-134A refrigerant
- Air defrost controlled by electrical timer
- Copper tube and aluminum fin evaporator with anti-corrosive coating
- Energy efficient condensate drain pan assembly heated by high side copper tube
- Pre-wired and ready to plug, 115V/60Hz/1Ph, NEMA 5-15P

Lids, Locks, Openers

- Heavy duty stainless steel, easy glide and removable lids
- 3/4" thick lids, foamed-in-place polyurethane insulation
- Ratchet locks to secure lids (Standard)
- Removable bottle cap opener and cap catcher

Shelving

- Epoxy coated floor wire shelves for cold air circulation
- Adjustable epoxy coated wire bin dividers

Temperature Control

- Factory preset temperature, 35°F
- Temperature setting range from 33°F to 41°F
- Easy to set analog thermostat

Option

- 2 1/2" and 4" diameter casters (3" and 5" overall height)



EBC37



EBC50



EBC65



EBC80



EBC95

<ul style="list-style-type: none"> • Project / Customer _____ • Item No. _____ • Model No. _____ 	<p>Warranty</p> <p>5 Year — Compressor Warranty 3 Year — Parts & Labor Warranty</p> <p>Applicable to units purchased after July 1, 2014</p>	<p>Please visit our website for updated Energy Efficiency information</p> <p>201 W. Artesia Blvd, Compton, CA 90220 T. (310) 323-6586, (800) 444-6285 F. (310) 323-7524 www.EVERESTref.com</p>
---	--	--

HORIZONTAL BOTTLE COOLERS



EBC – Series

• EBC37 • EBC50 • EBC65 • EBC80 • EBC95

Dimensions

SIDE VIEW

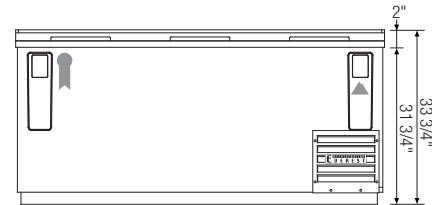
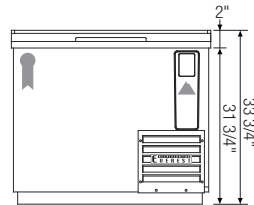
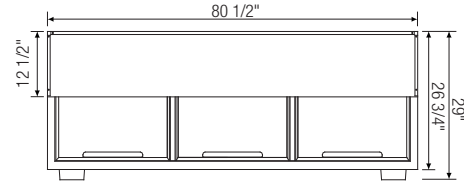
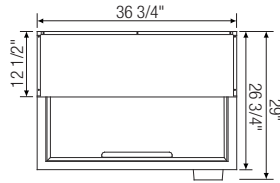
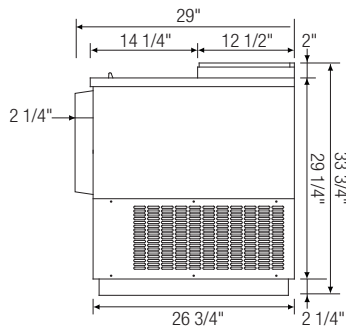

▲ EBC37

▲ EBC80

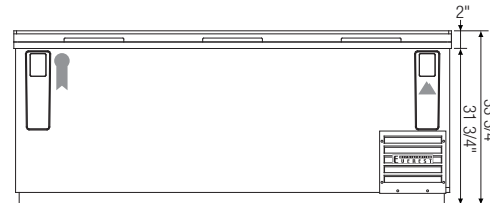
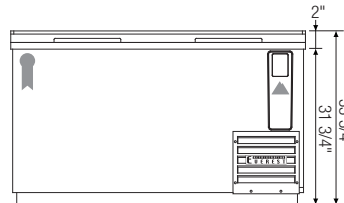
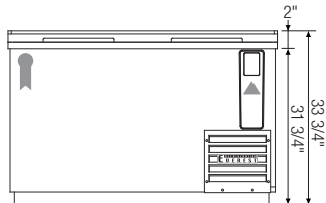
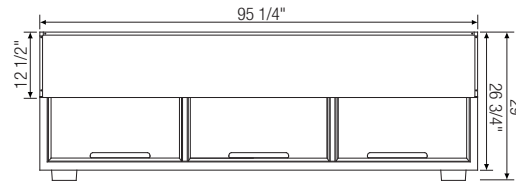
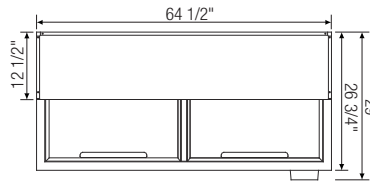
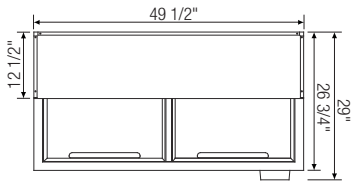

▲ EBC50

▲ EBC65

▲ EBC95

Model	Ref/ Fzr/ Dual	# of Lids	Capacity (Cu.Ft.)	HP	Refrigerant	# of Bin Dividers	# of Shelves	Capacity		Power (V-Hz-Ph)	Amps	Crated Weight (LBS)	Exterior Dimensions (Inches)			* Depth does not include bottle cap opener with intergrated cap receptacle. Ref = Refrigerator Fzr = Freezer Dual = Ref & Fzr Combo
								12 oz. Btts	12 oz. Cans				L	D*	H	
EBC37	Ref	1	9.30	1/4	R-134A	2	1	348	264	115-60-1	4.20	203	36 3/4	26 3/4	33 3/4	
EBC50	Ref	2	13.60	1/4	R-134A	3	2	576	396	115-60-1	4.20	245	49 1/2	26 3/4	33 3/4	
EBC65	Ref	2	18.90	1/4	R-134A	4	2	780	528	115-60-1	4.20	282	64 1/2	26 3/4	33 3/4	
EBC80	Ref	3	24.40	1/3	R-134A	4	3	1,008	720	115-60-1	5.40	333	80 1/2	26 3/4	33 3/4	
EBC95	Ref	3	29.60	1/3	R-134A	6	3	1,320	900	115-60-1	5.40	370	95 1/2	26 3/4	33 3/4	

Disclaimer: Product dimensions are for general purposes and not absolute value. Slight variations may exist. If dimensions are critical, please contact Everest.

Specifications subject to change without notice.

www.EVERESTref.com

201 W. Artesia Blvd, Compton, CA 90220
T. (310) 323-6586, (800) 444-6285 F. (310) 323-7524