



# GLASS DOOR MERCHANDISER REFRIGERATORS

## EM – Series

- EMGR24 • EMGR33 • EMGR48 • EMGR69
- EMSGR33 • EMSGR48 • EMSGR69

### Cabinet Construction

Heavy duty white coated steel for cabinet interior and exterior. High quality 304 stainless steel interior floor with round edges for convenient cleaning. White coated aluminum drain pan. 2.5" thick high density foamed-in-place polyurethane insulation. Adjustable screw legs for leveling. One additional heavy duty adjustable screw leg located at bottom of front cabinet to support weight in the middle for models EMGR69 & EMSGR69

### Refrigeration System

- Bottom mounted condensing unit
- Removable bottom grill and slide-out condensing unit for easy repair and maintenance
- Oversized condenser and evaporator coil cools to set and maintain temperature in minimum time period
- Forced-air cooling with oversized evaporator fan motors providing balanced airflow throughout cabinet to ensure faster temperature drop
- Environmentally friendly CFC free R-134A refrigerant
- Air defrost controlled by thermostat
- Copper tube and aluminum fin evaporator with anti-corrosive coating
- Energy efficient condensate drain pan with wicking pads
- Pre-wired and ready to plug, 115V/60Hz/1Ph, NEMA 5-15P

### Doors

- Black PVC door frames
- Double pane glass system with a layer of transparent thermal insulation film in between two layers

#### [Sliding Doors]

- Automatic self-close by weight
- Removable doors and stainless steel door tracks for easy cleaning

#### [Swing Doors]

- Heavy duty adjustable torsion spring self-closing door system
- One piece snap-in magnetic door gasket for easy replacement
- Heavy duty die-cast door handles

### Lighting

- Safety shielded vertical fluorescent interior lighting with on/off switch

### Shelving

- Four epoxy coated wire shelves per section
- 304 stainless steel pilasters and shelf clips

### Temperature Control

- Factory preset temperature, 35°F
- Temperature setting range from 33°F to 41°F
- Easy to set dial thermostat knob

### Option

- 2 1/2" and 4" diameter casters (3" and 5" overall height)



EMGR24



EMGR33



EMSGR33



EMGR48



EMSGR48



EMGR69



EMSGR69

• Project / Customer \_\_\_\_\_

• Item No. \_\_\_\_\_

• Model No. \_\_\_\_\_

### Warranty

2 Year — Parts & Labor  
5 Year — Compressor



Please visit our website for updated Energy Efficiency information

201 W. Artesia Blvd, Compton, CA 90220  
T. (310) 323-6586, (800) 444-6285 F. (310) 323-7524

[www.EVERESTref.com](http://www.EVERESTref.com)

# GLASS DOOR MERCHANDISER REFRIGERATORS



## EM – Series

- EMGR24 • EMGR33 • EMGR48 • EMGR69
- EMSGR33 • EMSGR48 • EMSGR69

### Dimensions

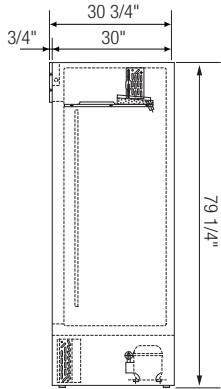

All Sliding Door Units

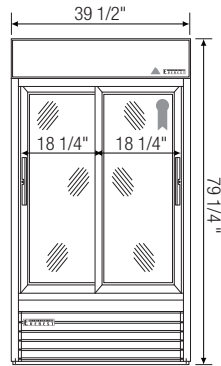

▲ EMGR33

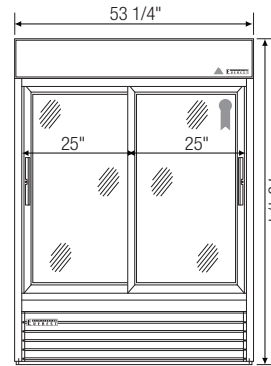

▲ EMGR48

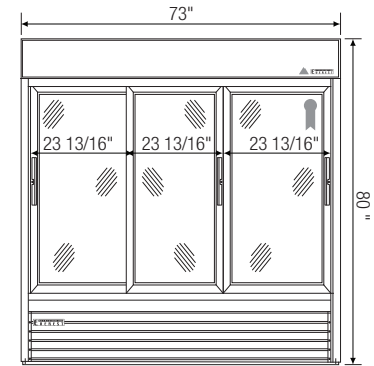

▲ EMGR69

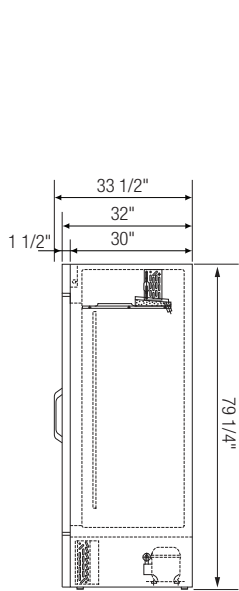

All Swing Door Units

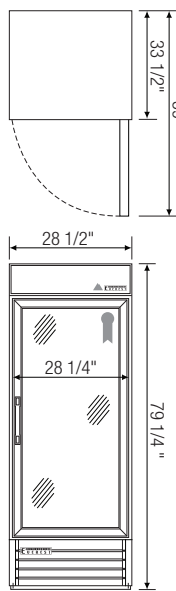

▲ EMGR24

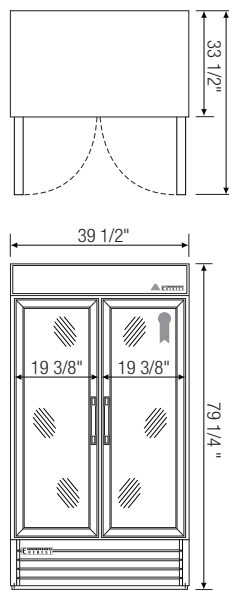

▲ EMSGR33

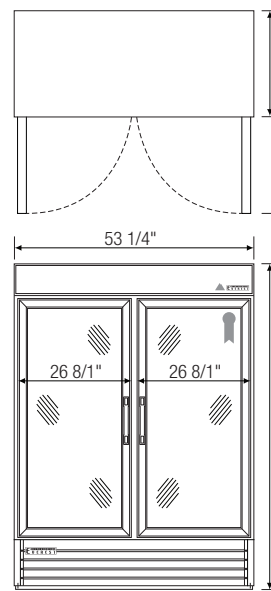

▲ EMSGR48

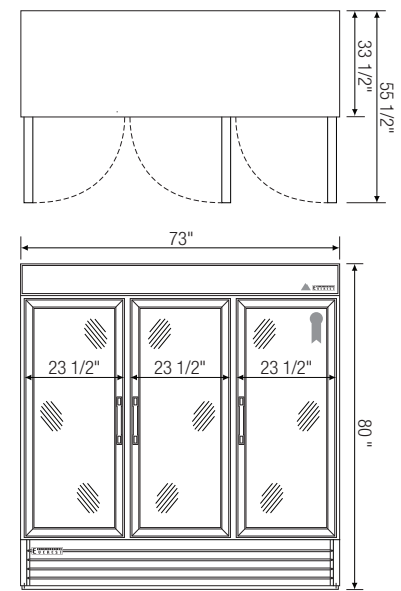

▲ EMSGR69

Model	Ref/ Fzr/ Dual	# of Doors	Capacity (Cu.Ft.)	HP	Refrigerant	# of Shelves	Power (V-Hz-Ph)	Amps	Crated Weight (LBS)	Exterior Dimensions (Inches)			* Exterior depth of swing door units include 1 1/2" of door handle  Ref = Refrigerator Fzr = Freezer Dual = Ref & Fzr Combo
										L	D	H	
EMGR24	Ref	1	24	1/3	R-134A	4	115-60-1	4.07	240	28 1/2	33 1/2 *	79 1/4	
EMGR33	Ref	2(Sliding)	33	1/3	R-134A	8	115-60-1	4.16	403	39 1/2	30 3/4	79 1/4	
EMSGR33	Ref	2(Swing)	33	1/3	R-134A	8	115-60-1	4.16	401	39 1/2	33 1/2 *	79 1/4	
EMGR48	Ref	2(Sliding)	48	1/2	R-134A	8	115-60-1	9.00	531	53 1/4	30 3/4	79 1/4	
EMSGR48	Ref	2(Swing)	48	1/2	R-134A	8	115-60-1	9.00	494	53 1/4	33 1/2 *	79 1/4	
EMGR69	Ref	3(Sliding)	69	1/2	R-134A	12	115-60-1	11.00	650	73	30 3/4	80	
EMSGR69	Ref	3(Swing)	69	1/2	R-134A	12	115-60-1	11.00	670	73	33 1/2 *	80	

Specifications subject to change without notice.

[www.EVERESTref.com](http://www.EVERESTref.com)

201 W. Artesia Blvd, Compton, CA 90220  
T. (310) 323-6586, (800) 444-6285 F. (310) 323-7524