

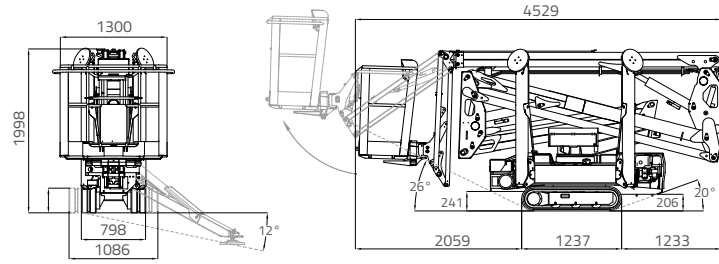

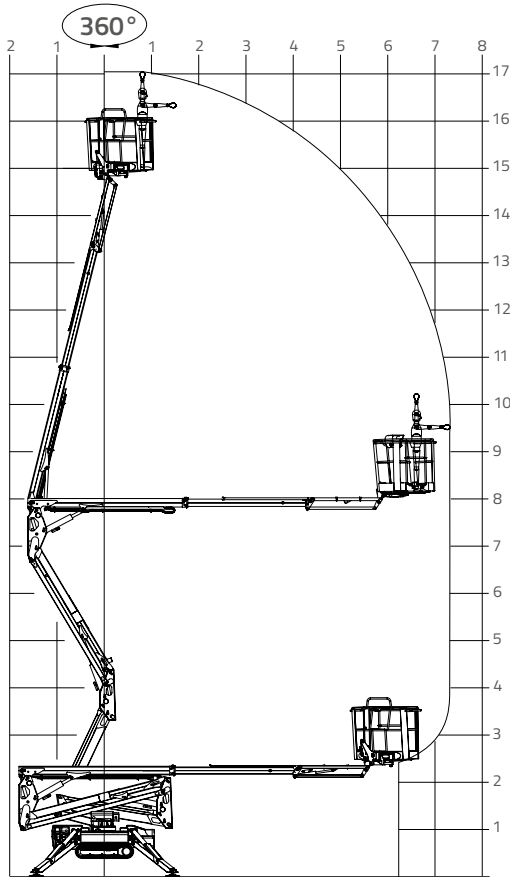







# LIGHTLIFT 17.75

## PERFORMANCE III<sup>S</sup> MK2



-  17,06 m
-  7,50 m
-  4,52 m
-  4,17 m
-  1,99 m
-  1335x690xh.1100 mm
-  124° (+/-62°)
-  16°/28,7%
-  2230 kg / 4916 lb (Honda e Hatz)  
2300 kg / 5070 lb (Lithium-ion)
-  Honda iGX390 Automatic rpm control  
11,7 CV - 3600rpm  
Hatz 1B40 HD Autorev system  
10 CV - 3600rpm

-  2,2kW-230V-50Hz  
2,2kW-110V-50Hz
-  0,6 - 1,4 - 2,7 km/h (Honda)  
0,7 - 1,8 - 3,6 km/h (Hatz)
-  798 - 1086 mm
-  1731 daN - 2,45 daN/cm<sup>2</sup>
-  2884x2889mm
-  Automatic set up system IIS std  
IIS - Abstütz- und Einfahrtomatik  
serienmässig
-  Remote control  
Kabelfernbedienung
-  GPRS-GPS
-  R.A.H.M.
-  100Ah/48V  
Optional - Optional

