



**Selection Criteria for  
Portable Wheelchair  
Ramps for  
3-Step Doorways**

# Type 1: Staircase Parallel to Corridor



## **For Type 1 Corridor**

- Selection is relatively straight forward.
- Recommended Ramp Lengths: 5 to 7 ft, the longer the better.

# Type 2: Staircase Perpendicular to Corridor



- View from Corridor



- Front View

# Measurement of Distance (X)

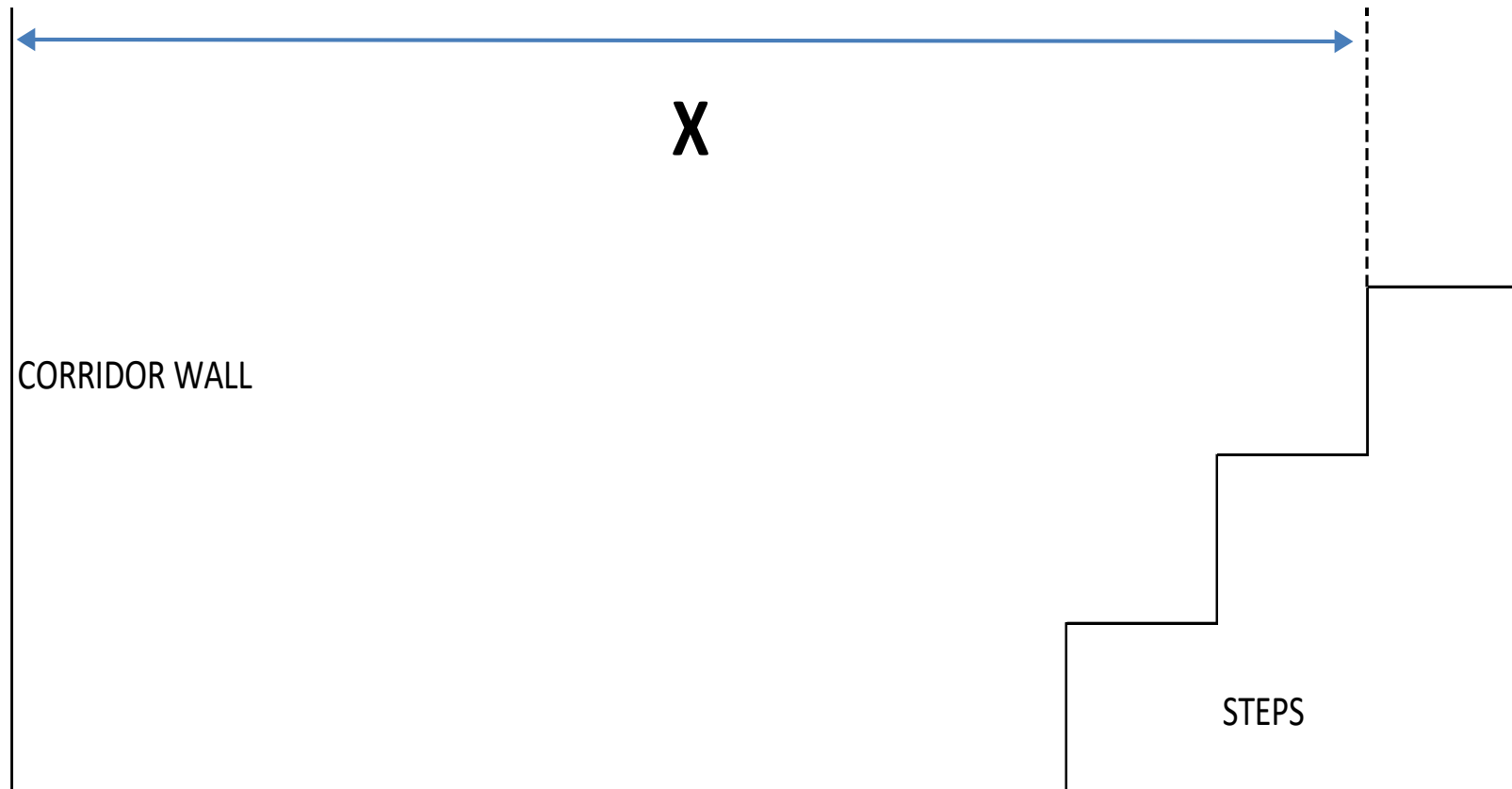

# For Type 2 Corridor

Measure the distance from the corridor to the top of the staircase (X)

<b>Distance X</b>	<b>Ramp Length</b>
Less than 9 ft	Ramps are totally unsuitable
Between 9 to 10 ft	5 ft
Between 10 ft to 11 ft	6 ft
Between 11 ft to 12 ft	7 ft



**140 Paya Lebar Road  
#05-11, AZ @ Paya Lebar  
Singapore 409015**

**Opening Hours:**

**Mon-Fri: 10:00 AM to 6:00 PM**

**Sat: 10:30 AM to 4.30 PM**

**Tel: +65 6774 7518**

**Email: [sales@falconmobility.com.sg](mailto:sales@falconmobility.com.sg)**

**URL: <https://www.falconmobility.com.sg>**