



# **Selection Criteria for Bi-Fold Ramp for 3-Step Doorways**

# Type 1: Staircase Parallel to Corridor



# For Type 1 Corridor

- Selection is relatively straight forward.
- Recommended sizes:
  - Aluminium Bi-Fold Ramp 5 ft or 6 ft
  - Telescopic ramps 7 ft or 8 ft



• **Bi-Fold Ramp**



• **Telescopic Ramps**

# Type 2: Staircase Perpendicular to Corridor



- View from Corridor



- Front View

# Measurement of Distance (X)

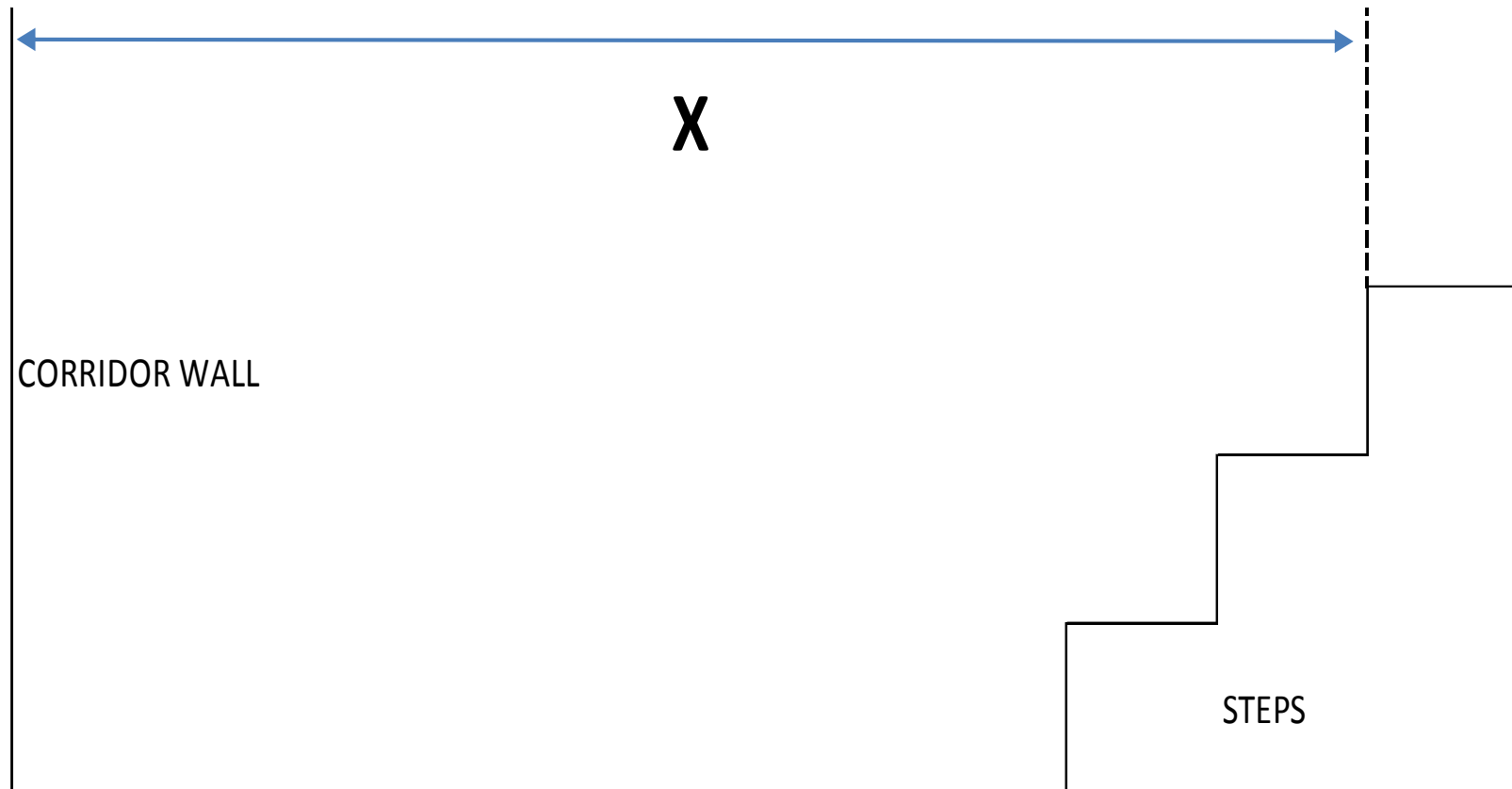

## For Type 2 Corridor

- Measure the distance from the corridor to the top of the staircase (X)
  - If  $X > 9$  feet, best size is 5-ft Bi Fold ramp
  - If X between 8 feet and 9 feet, 4-ft Bi Fold ramp may be suitable (no guarantee). Have to try to find out
  - If  $X < 8$  feet, wheelchair ramp is totally not suitable to be used



**Head Office & East Showroom ((☎: +65 6774 7518)**

**140 Paya Lebar Road  
#05-11, AZ @ Paya Lebar  
Singapore 409015**

**Opening Hours:  
Mon-Fri: 10:00 AM to 6:00 PM  
Sat: 10:30 AM to 4.30 PM**