

Catalog Number:

Project:

Type:

Date:

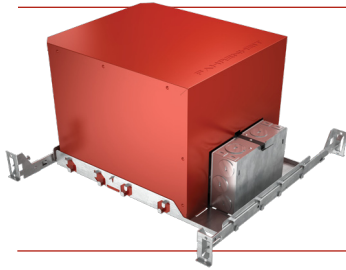

F6FH F6FH2

6" Horizontally Mounted
Compact Fluorescent IC / Non-IC Housing
1 Hour / 2 Hour Fire and Sound Rated

Description

Specification grade fire-rated and sound-attenuating luminaire. Fixture incorporates a non-combustible membrane to prevent the passage of toxic fumes, flames and ignitable gasses into ceiling voids. F6FH is ideal for applications which require a high efficiency downlight and a 60 or 120 minute fire rated L500 floor ceiling design. Suitable for both IC and Non-IC construction.

Housing

Die formed #20 gauge galvanized steel construction. Housing interior is comprised of a flexible non-combustible matt. Two (2) snap on galvanized covers provide easy access into junction box.

Ballast

Compact fluorescent class "P" electronic ballast with high power factor and end of lamp life-protection circuitry. Ballast accommodates 120V through 277V input and is accessible from below ceiling. 0°F minimum starting temperature and total harmonic distortion (THD) less than 10%. Dimmable and emergency ballast available (Consult factory). Default factory brand: Universal Lighting Technologies

Junction Box

Pre-wired #18 gauge galvanized steel junction box with seven 1/2" knockouts and four Romex® knockouts and removable plates. Supplied with quick connectors for easy installation. Through branch wiring maximum of (8) #12 AWG 90°C branch circuit connectors (4in 4out).

Bar Hangers

Pre-installed patented telescopic bar hangers permits placement of housing within 16" O.C joists or suspended ceilings (Consult factory for 24" joist adapters). Bar hanger is scored in two locations allowing installation in tight spaces. Supplied with four (4) captive heavy duty nails.

Lamp Holder

Thermoplastic four-pin compact fluorescent sockets are attached securely to the housing. Pre-wired with #18 gauge, 600V leads to junction box. Utilizes one or two compact fluorescent lamps mounted horizontally. Single lamp configuration is 42W max. Double lamp is 26W max.

Installation

Spacing must not exceed one (1) luminaire per 25 sq. ft. of the ceiling area. Minimum spacing between two adjacent luminaires must not be less than 3 ft.

AirTight

This fixture is designed to restrict air passage through the housing to no more than two cubic feet (2.0 cfm) per minute. Tested to ASTM E283

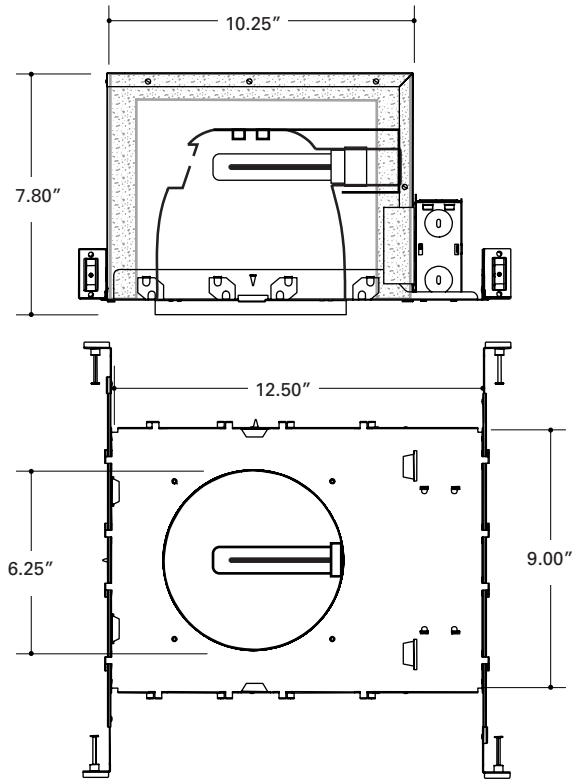

Listings

- UL Classified One or Two Hour Fire Rating
- UL263, ASTM E119, NFPA No. 251
- UL Listed Housing for Damp Location & Through Branch Wiring
- UL Listed Housing for Insulated Ceiling
- Energy Star Compliant
- California Title-24 Compliant
- State of Washington ASTM E283

Designed and assembled in the U.S.A.

Patent Pending

Ordering Example: **F6FH-113-EM**



Housing Type	Lamp Type / Wattage	Option	Trim
<p>F6FH = 6" Fire Rated Housing Horizontally Mounted CFL (1 Hour Rated)</p> <p>F6FH2 = 6" Fire Rated Housing Horizontally Mounted CFL (2 Hour Rated)</p>	<p>113 = One (1) 13W CFL - DTT/TRT - IC / Non-IC</p> <p>213 = Two (2) 13W CFL - DTT - IC / Non-IC</p> <p>118 = One (1) 18W CFL - DTT/TRT - IC / Non-IC</p> <p>218 = Two (2) 18W CFL - DTT - IC* / Non-IC</p> <p>126 = One (1) 26W CFL - DTT/TRT - IC / Non-IC</p> <p>226 = Two (2) 26W CFL - DTT - Non-IC only*</p> <p>132 = One (1) 32W CFL - DTT/TRT - IC* / Non-IC*</p> <p>142 = One (1) 42W CFL - DTT/TRT - Non-IC only*</p> <p>*Not suitable for lensed or wall wash trims.</p>	<p>EM = Emergency Ballast*</p> <p>DIM = Dimming Ballast**</p> <p>*Access above ceiling required.</p> <p>**Access above ceiling required for two-lamps.</p>	<p>Specify desired trim.</p> <p>See reverse side of this page for details.</p>

6" Horizontal CFL Trims

F6FH & F6FH2

Reflector Trims



Regressed Lens / Reflector Trims w/ White Ring



Regressed Lens / Baffle Trims w/ White Ring

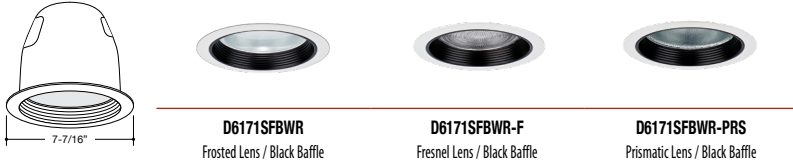

Baffle Trims w/ White Ring



Fixture: **F6FH-213-D6061SFC**
Lamp: **Two (2) 13W (CFQ13W/GX24q/35)**

Polar Candela Distribution

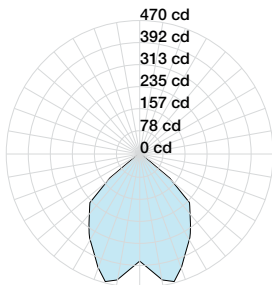

Illuminance at a Distance

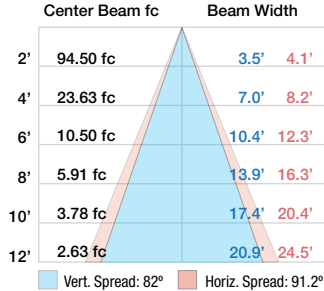

Zonal Lumens Summary

Zone	Lumens	% Lamp	% Fixture
0-30	322.3	17.9	45.4
0-40	506.6	28.1	71.4
0-60	707.7	39.3	99.7
60-90	2.1	0.1	0.3
0-90	709.8	39.4	100
90-180	0	0	0
0-180	709.8	39.4	100

Efficiency Total: **39.4%**

Lumens Per Zone

Zone	Lumens	% Total	Zone
0-10	38.7	5.5	90-100
10-20	118.1	16.6	100-110
20-30	165.4	23.3	110-120
30-40	184.3	26	120-130
40-50	163.5	23	130-140
50-60	37.6	5.3	140-150
60-70	1.8	0.3	150-160
70-80	0.2	0	160-170
80-90	0	0	170-180

Coefficients of Utilization - Zonal Cavity Method

Effective floor cavity reflectance: 20%

RCC %:	80				70				50				30				10				0			
RW %:	20	30	40	Q	20	30	40	Q	20	30	40	Q	20	30	40	Q	20	30	40	Q	20	30	40	Q
RCR: 0	.47	.47	.47	.47	.46	.46	.46	.39	.44	.44	.44	.42	.42	.42	.40	.40	.40	.39						
1	.44	.43	.42	.41	.43	.42	.41	.36	.41	.40	.39	.39	.38	.38	.37	.37	.37	.36						
2	.42	.39	.37	.36	.41	.39	.37	.33	.37	.36	.35	.36	.35	.34	.35	.34	.33	.32						
3	.39	.36	.34	.32	.38	.35	.33	.30	.34	.32	.31	.33	.32	.30	.32	.31	.30	.29						
4	.36	.33	.30	.28	.36	.32	.30	.27	.31	.29	.28	.31	.29	.27	.30	.28	.27	.26						
5	.34	.30	.27	.25	.33	.30	.27	.24	.29	.27	.25	.28	.26	.25	.27	.26	.24	.24						
6	.32	.28	.25	.23	.31	.27	.25	.22	.27	.24	.22	.26	.24	.22	.25	.24	.22	.21						
7	.30	.25	.23	.21	.29	.25	.22	.20	.25	.22	.20	.24	.22	.20	.24	.22	.20	.19						
8	.28	.23	.21	.19	.27	.23	.20	.18	.23	.20	.19	.22	.20	.18	.22	.20	.18	.18						
9	.26	.22	.19	.17	.26	.21	.19	.17	.21	.19	.17	.21	.18	.17	.20	.18	.17	.16						
10	.25	.20	.17	.16	.24	.20	.17	.15	.20	.17	.16	.19	.17	.16	.19	.17	.15	.15						

Fixture: **F6FH-226-D6061SFC**
Lamp: **Two (2) 26W (CFQ26W/G24q/35)**

Polar Candela Distribution

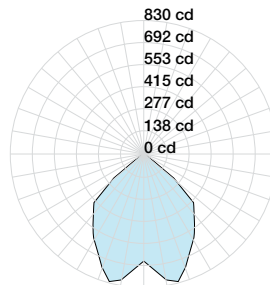

Illuminance at a Distance

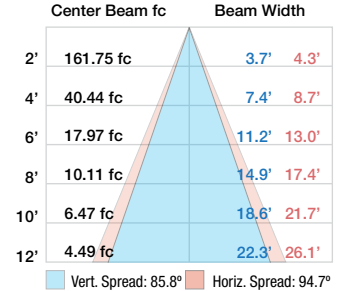

Zonal Lumens Summary

Zone	Lumens	% Lamp	% Fixture
0-30	579.6	16.1	41.2
0-40	919.7	25.5	65.3
0-60	1401.3	38.9	99.5
60-90	6.6	0.2	0.5
0-90	1407.9	39.1	100
90-180	0	0	0
0-180	1407.9	39.1	100

Efficiency Total: **39.1%**

Lumens Per Zone

Zone	Lumens	% Total	Zone
0-10	66.6	4.7	90-100
10-20	118.1	14.7	100-110
20-30	239.2	21.8	110-120
30-40	250.3	24.2	120-130
40-50	211.2	23.2	130-140
50-60	123.9	11	140-150
60-70	46.1	0.4	150-160
70-80	10.9	0.1	160-170
80-90	1.6	0	170-180

Coefficients of Utilization - Zonal Cavity Method

Effective floor cavity reflectance: 20%

RCC %:	80				70				50				30				10				0			
RW %:	20	30	40	Q	20	30	40	Q	20	30	40	Q	20	30	40	Q	20	30	40	Q	20	30	40	Q
RCR: 0	.47	.47	.47	.47	.45	.45	.45	.39	.43	.43	.43	.42	.42	.42	.40	.40	.40	.39						
1	.44	.43	.41	.40	.43	.42	.41	.36	.40	.39	.38	.39	.38	.37	.37	.37	.36	.35						
2	.41	.39	.37	.35	.40	.38	.36	.32	.37	.35	.34	.35	.34	.33	.34	.33	.32	.32						
3	.38	.35	.32	.31	.37	.34	.32	.29	.33	.31	.30	.33	.31	.29	.31	.29	.28	.28						
4	.35	.32	.29	.27	.35	.31	.29	.26	.30	.28	.26	.29	.28	.26	.29	.27	.26	.25						
5	.33	.29	.26	.24	.32	.28	.26	.23	.28	.25	.23	.27	.25	.23	.26	.24	.23	.22						
6	.31	.26	.23	.21	.30	.26	.23	.21	.25	.23	.21	.25	.23	.21	.24	.22	.21	.20						
7	.29	.24	.21	.19	.28	.24	.21	.19	.23	.21	.19	.23	.20	.19	.22	.20	.19	.18						
8	.27	.22	.19	.17	.26	.22	.19	.17	.21	.19	.17	.21	.19	.17	.21	.19	.17	.16						
9	.25	.20	.18	.16	.25	.20	.18	.15	.20	.17	.16	.20	.17	.16	.19	.17	.15	.15						
10	.24	.19	.16	.14	.23	.19	.16	.14	.18	.16	.14	.18	.16	.14	.18	.16	.14	.14						