

MAXFLOW ELECTRIC PRESSURE WASHER

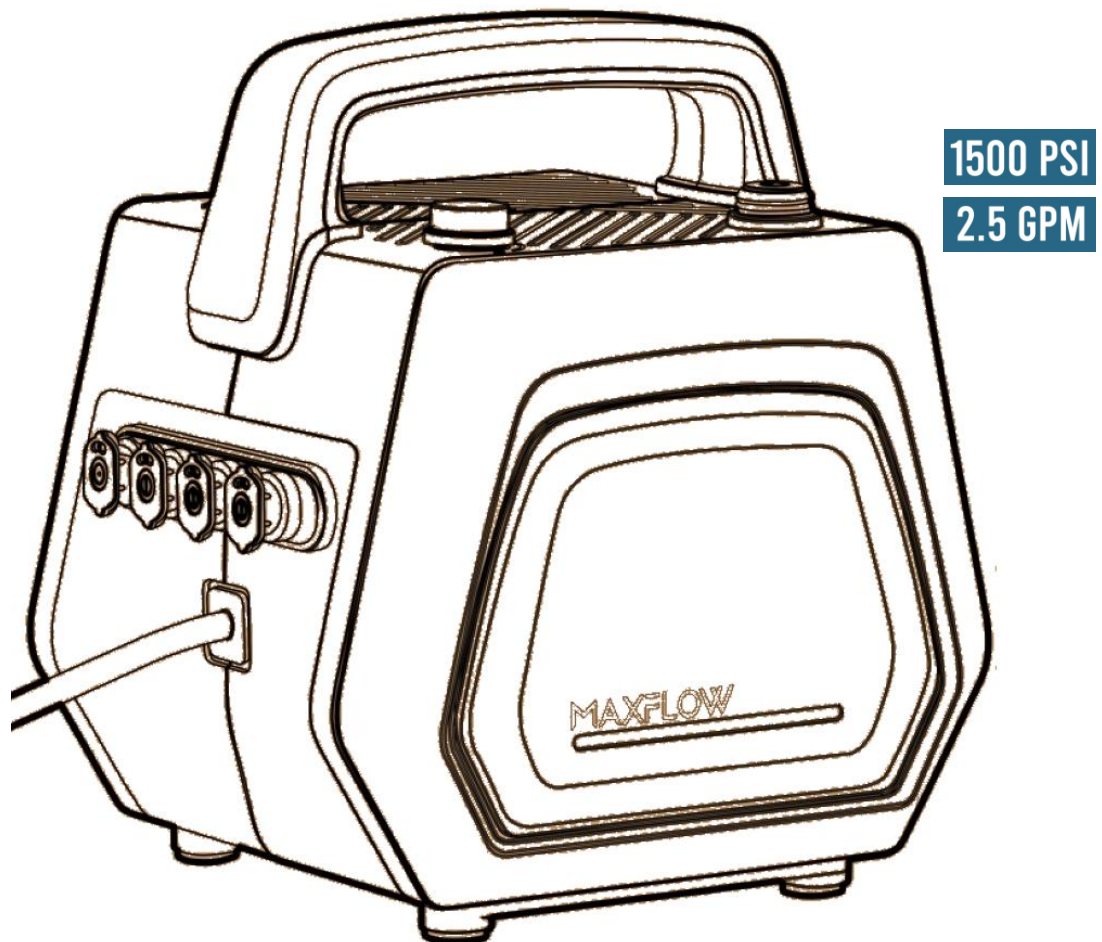

INSTRUCTION MANUAL

WWW.MAXFLOWPRODUCTS.COM

SUPPORT@MAXFLOWPRODUCTS.COM

EQUIPPED WITH SERVICEABLE PUMP – OIL CHANGE REQUIRED TO MAXIMIZE PERFORMANCE, EXTEND LIFE, AND MAINTAIN WARRANTY.

IF YOUR PRESSURE WASHER IS NOT WORKING OR THERE ARE PARTS MISSING OR BROKEN - PLEASE **DO NOT** RETURN IT TO THE PLACE OF PURCHASE. CONTACT OUR CUSTOMER SUPPORT : SUPPORT@MAXFLOWPRODUCTS.COM

READ THIS MANUAL CAREFULLY BEFORE OPERATION

Failure to follow the instructions and safety precautions in this manual may result in property damage, serious injury even death.

NOTE: Photographs and line drawings used in this manual are for reference only and may not represent your specific model.

SAVE THESE INSTRUCTIONS FOR FUTURE REFERENCE

Congratulations on your purchase of your new MAXFLOW™ Electric Pressure Washer! We are proud to bring you an innovative, powerful and reliable tool for tackling the toughest cleaning jobs with ease. Please take a moment to read this manual carefully, become familiar with the components, functions and features before operating the unit.

REGISTER YOUR PRODUCTS AT:

www.maxflowproducts.com

If the manual becomes damaged, lost or otherwise unusable, you may download a digital copy from our website at:

www.maxflowproducts.com

or contact:

support@maxflowproducts.com

Model Number: _____

Serial Number: _____

Purchasing Date: _____

Purchased From: _____

Table of Contents

1	SAFETY PRECAUTIONS.....	4
1.1...	SYMBOL MEANING (TABLE A1)	5
1.2...	PRECAUTIONS AND SPECIFIC SAFETY RULES.....	6
2	WHAT'S INCLUDED (FIGURE A)	8
2.1...	PACKING LIST (TABLE A2).....	9
2.1.1	UNPACKING	9
2.2...	ASSEMBLY STEPS.....	10
3	OPERATING THE UNIT	15
3.1...	OUTPUT PRESSURE ADJUSTMENT	15
3.2...	OPERATING MODES	17
3.3...	SPRAY WITHOUT FOAM BLASTER	17
3.4...	SPRAY WITH FOAM BLASTER	17
3.5...	SHUT DOWN PROCEDURE.....	19
4	CLEANING AND MAINTENANCE	19
4.1...	CLEANING.....	19
4.1.1	NOZZLE MAINTENANCE	19
4.1.2	WATER INLET SCREEN CLEANING	20
4.1.3	OIL CHANGE	20
5	TRANSPORTATION AND STORAGE	24
5.1...	TRANSPORTATION	24
5.2...	STORAGE	24
5.3...	Winterization	24
6	TECHNICAL SPECIFICATIONS (TABLE A4).....	25
7	TROUBLESHOOTING.....	26
8	WARRANTY	29
8.1...	WARRANTY COVERAGE TERMS.....	29

NOTICE

This product is not intended to be used by persons (including children) with reduced physical, sensory, or mental capabilities, or lack of experience and knowledge, unless they have been given supervision or instruction concerning use of the machine by a person responsible for their safety. Children should be supervised at all times to ensure that they do not play with the machine.

DISCLAIMERS

- All information in this instruction manual has been based on the latest product information available at the time of printing. MAXFLOW Products reserves the right to update, change, and/ or improve the product and this document at any time, without notice, and without incurring any obligation.
- This instruction manual may cover more than one machine. The pictures and figures in the manual should be used for reference only. There may be differences between your product and the pictures, drawings, and diagrams in this manual.

1 SAFETY PRECAUTIONS

DANGER:

Indicates an imminently dangerous situation, which if not avoided, will result in property damage, serious injury, and/ or death.

WARNING:

Indicates a potentially hazardous situation, which if not avoided, could result in property damage, serious injury, and/ or death.

CAUTION:









Indicates a hazardous situation, which if not avoided, could result in property damage and/or minor to moderate injury.

NOTICE

Indicates information considered important, but not directly hazard related.

1.1 SYMBOL MEANING (TABLE A1)

The following safety alert symbols are intended to explain the levels of risk associated with this product.

SYMBOL	REPRESENTS	EXPLANATION
	READ INSTRUCTION MANUAL	Read and understand the manual before use to avoid injury.
	SAFETY ALERT	Warns of potential personal injury.
	EYE PROTECTION	Wear ANSI Z87.1-compliant or higher safety level eye protection with side shields.
	WET CONDITION ALERT	Avoid exposure to rain or wet conditions. Never spray near electrical devices.
	RISK OF INJECTION	Equipment can cause serious injury if the spray penetrates the skin. Do not point the gun at anyone or any part of the body.
	RISK OF EXPLOSION	Do not spray flammable liquids. Vapors may ignite and cause severe injury or death.
	KICKBACK	The spray gun kicks back. Hold the handle firmly with both hands during use to avoid kickback injury.
	ELECTRIC SHOCK	Do not spray towards any electric wiring, devices, or directly towards the pressure washer itself, or fatal electric shock may occur.
	CHEMICAL BURNS	Do not use acids, bleaches, solvents, or flammable/industrial-grade chemicals.

1.2 PRECAUTIONS AND SPECIFIC SAFETY RULES

- ❖ This product is designed for general residential applications. Do not modify, apply, or use this product for any other purposes other than what it is intended for. This equipment was not designed or intended for industrial, rental or heavy-duty commercial use.
- ❖ Improper use by untrained adults or children can result in serious injury or death. Ensure all operators are properly instructed, understand safe use, and have read the manual. Do not allow children to operate the unit unsupervised. Keep children and pets away while the unit is running, and always turn it off before leaving the area.
- ❖ Never operate the unit under the influence of alcohol or drugs.
- ❖ Both the operator and the pressure washer should be on solid footing. The operator should stand with both feet balanced while operating the machine. Do not operate the unit on an unstable surface.
- ❖ Don't force this product or install attachment / accessories to do a job it was not designed for.
- ❖ Use only recommended accessories. The use of improper accessories may cause risk of injury. Do not operate this machine with components with specifications rated less than the unit itself (including but not limited to spray guns, hose, wand, fittings and connectors).
- ❖ Wear long pants and sleeves. Avoid loose clothing, jewelry, or neckties. Use rubber gloves, nonslip shoes, and tie back long hair when working outdoors. Do not operate while barefoot or in sandals. Wear sturdy, non-slip footwear for protection and stability.
- ❖ Exercise caution to avoid slipping or falling.
- ❖ Always wear eye protection with side shields marked to comply with ANSI Z87.1 or higher safety level. Following this rule will reduce the risk of serious personal injury.
- ❖ Check damaged parts. Before further use of the product, a part that is damaged should be carefully checked to determine that it will operate properly and perform its intended function. Check for alignment of moving parts, binding of moving parts, breakage of parts, mounting, and any other conditions that may affect its operation. Any part that is damaged must be properly repaired or replaced by an authorized professional to avoid risk of personal injury.
- ❖ Do not cover the pressure washer while in use. The unit will generate heat and requires ample air circulation and ventilation.
- ❖ Never leave product running unattended. Turn power off if taking longer breaks. Don't leave product until it comes to a complete stop.
- ❖ Follow manufacturer's recommendations for safe loading, unloading, transport, and storage of machine.
- ❖ Keep product dry, clean, and free from oil and grease. Always use a clean cloth when cleaning. Never use brake fluids, gasoline, petroleum-based products, or any solvents to clean product.
- ❖ Check the work area before each use. Remove all objects such as rocks, sharp debris, broken glass, nails, wire, or string which can be thrown towards people or pets.
- ❖ Inspect the cord before each use. Do not use a frayed or damaged cord.
- ❖ Do not abuse the cord. Never use the cord to carry the product or to disconnect the plug from an outlet. Keep cord away from heat, oil, sharp edges, or moving parts. Replace damaged cords immediately. Damaged cords increase the risk of electric shock.

- ❖ Ground Fault Circuit Interrupter (GFCI) protection should be provided on the circuit(s) or outlet(s) to be used for the product. Receptacles are available having built-in GFCI protection and may be used for this measure of safety.
- ❖ Avoid using extension cords whenever possible. If you have to use one under certain circumstances, please make sure your extension cord is in good condition and use one heavy enough to carry the current your product will draw. A wire gauge size (A.W.G.) of at least 14 is recommended for an extension cord 25 feet or less in length. If in doubt, use the next heavier gauge. The smaller the gauge number, the heavier the cord. An undersized cord will cause a drop in line voltage resulting in loss of power and overheating. Maximum cord length is 50 feet or 15 meters. Do not use an extension cord that has a rating less than 15A.
- ❖ Use outdoor extension cords marked SW-A, SOW-A, STW-A, STOW-A, SJW-A, SJTW-A, or SJTOWA. These cords are rated for outdoor use and reduce the risk of electric shock.
- ❖ Inspect extension cords periodically and replace if damaged.
- ❖ Keep handles dry, clean, and free from oil or grease.
- ❖ Always disconnect the extension cord from the power source before disconnecting the extension cord from the pressure washer.
- ❖ Keep all connection points dry and off the ground. Do not plug into the receptacles with wet hands.
- ❖ Never direct a water stream toward people or pets. High pressure water can cause serious injury by penetrating the skin. Seek medical attention immediately in case of penetration.
- ❖ Never direct a water stream toward any electric wiring, devices, or directly over the pressure washer itself. Fatal electric shock may occur.
- ❖ Never use an electric pressure washer in areas where gas vapors may be present. An electric spark may cause an explosion or fire.
- ❖ Make sure minimum clearance of 3 feet is maintained from combustible materials.
- ❖ Never spray too close to the surface to be cleaned, as high-pressure stream may damage the surface.
- ❖ After stopping the motor, always pull the trigger on the trigger handle to relieve stored pressure in the high-pressure hose. Failure to do so could result in serious personal injury.
- ❖ Ensure the high-pressure hose is securely connected before using the product.
- ❖ Connect pressure washer only to an individual branch circuit.
- ❖ The spray gun / trigger handle **kicks back**. Hold the trigger handle securely with both hands. Expect the trigger handle to move when the trigger is pulled due to reaction forces. Failure to do so could cause loss of control and injury to yourself and others.
- ❖ Do not use acids, alkalines, solvents, flammable material, bleaches, or industrial grade solutions in this product. These products can cause physical injuries to the operator and irreversible damage to the machine.
- ❖ Do not spray over any combustible or flammable liquids.
- ❖ Before storing, allow the unit to cool.
- ❖ When servicing use only identical replacement parts. Use of any other parts may create a hazard or cause product damage.
- ❖ ONLY use **cold water** supply.
- ❖ Never pick up or carry a machine while the motor is running.

2 WHAT'S INCLUDED (FIGURE A)

*Bare Unit Includes Pressure Washer E Only. Skip All Sections Regarding A, B, C, D, F, G, T and R.

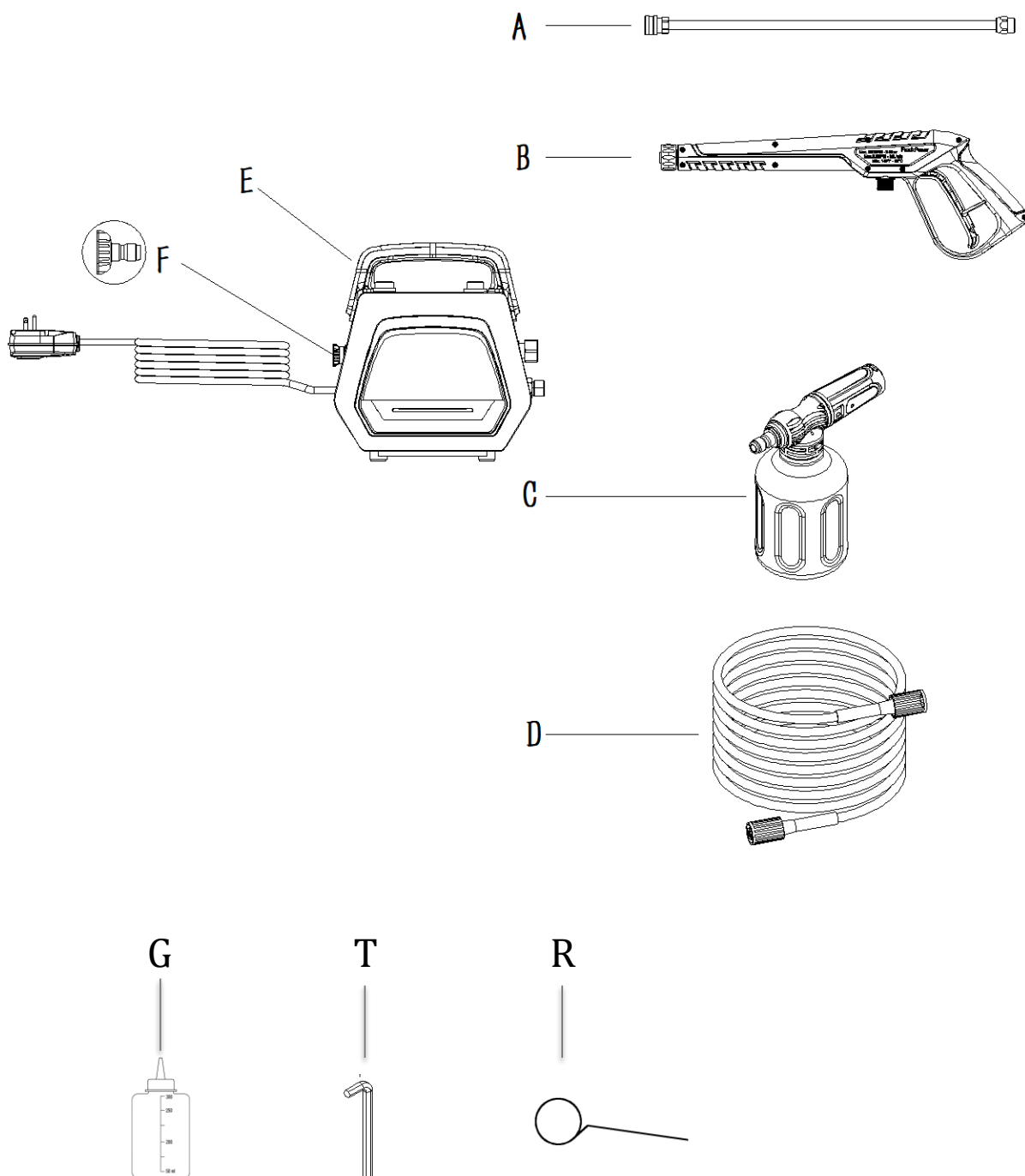

2.1 PACKING LIST (TABLE A2)

Refer to Figure A	Component Name	Quantity
A	Spray Wand / Lance with Quick Connect / Disconnect	1
B	Spray Gun / Trigger Handle Assembly	1
C	Foam Blaster	1
D	High Pressure Hose	1
E	Electric Pressure Washer Unit	1
F	NOZZLE TIPS	4
G	Oil Squeeze Bottle	1
T	4mm Allen Wrench	1
R	Cleaning Needle	1
N/A	Instruction Manual	1

2.1.1 UNPACKING

1. Place the carton on a solid, flat surface.
2. Carefully cut the tape open from the top of the carton.
3. Remove all accessories and the pressure washer from the carton.
4. Inspect all contents. Contact the vendor and or support for any missing or damaged parts. Do not operate the unit with missing parts.
5. Retain the carton and interior packing materials which are designed to be re-used for storage, re-packing and shipping.

2.2 ASSEMBLY STEPS

I. ATTACH HIGH PRESSURE HOSE ENDS

Attach high pressure hose (D) to the spray gun (B) inlet male end (G), and to the pressure washer outlet (F), by hand tightening in clockwise direction. Ensure no foreign objects or debris exist in the connecting points.

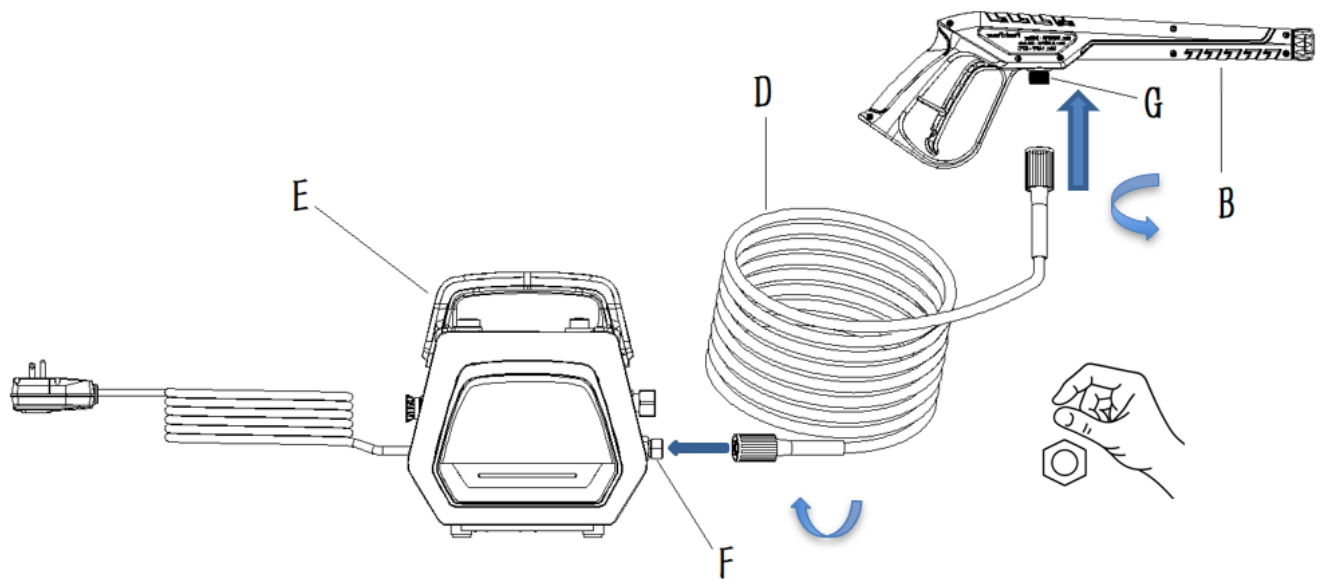

II. ATTACH THE GARDEN HOSE

Attach the garden hose to your water supply and turn water on. Let water run for 30 seconds to purge air and any debris from the supply hose. While water is still running off the hose, shut off the water supply.

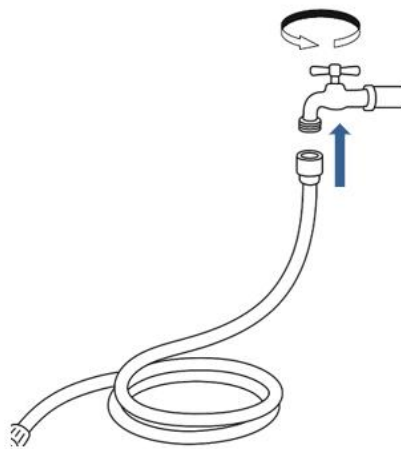

III. CONNECT GARDEN HOSE TO PRESSURE WASHER WATER INLET

Ensure the inlet screen is free of any dirt or debris, the rubber seal seated securely at the bottom of the nut, and the convex side is facing out. While inserting the garden hose (H) (not supplied) male end perpendicular into the inlet nut (I), hand tighten the nut without cross-threading. Do not over tighten.

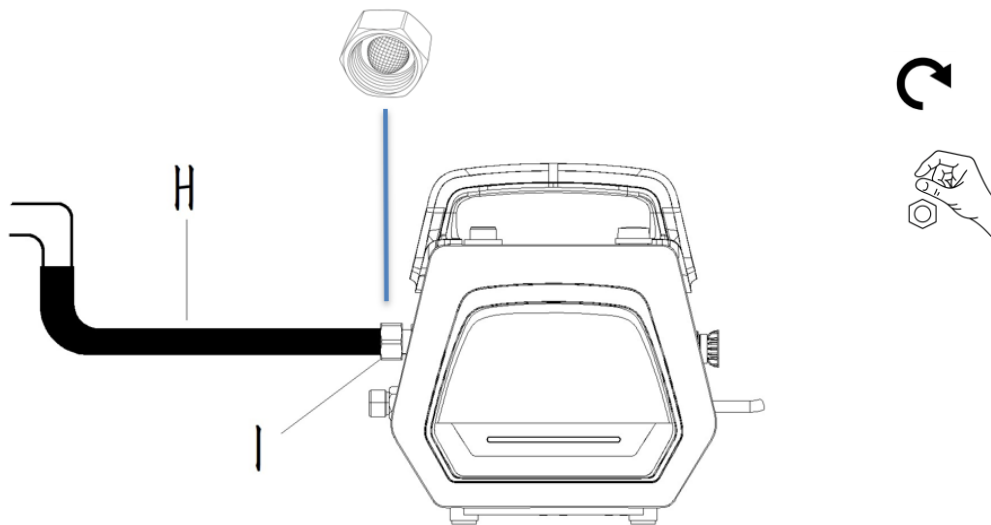

IV. ATTACH SPRAY WAND TO SPRAY GUN

Align the spray wand (A) straight with spray gun (B), insert the wand into the spray gun and rotate the nut clockwise to secure the wand. Do not cross thread. Pull the spray wand to ensure it is firmly attached.

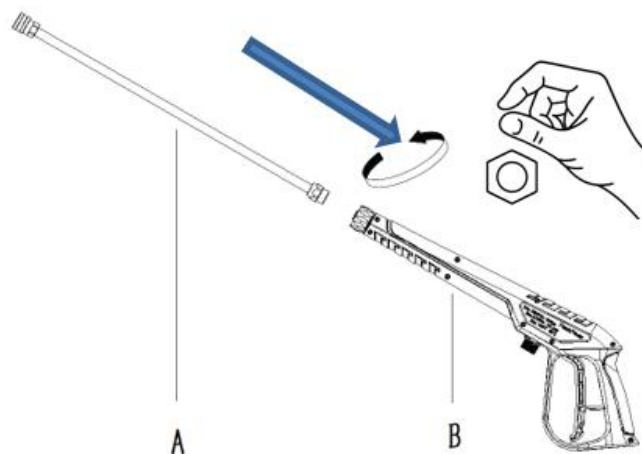

V. INSTALL SPRAY NOZZLE TIPS

Gently pull down the spring collar (M) and insert the nozzle tip (L); release the collar up to lock the tip. Always gently tug on the wand and pull the tip to verify it is locked. A loose tip can be pushed out by high pressure water stream, causing severe property damage and / or personal injury.

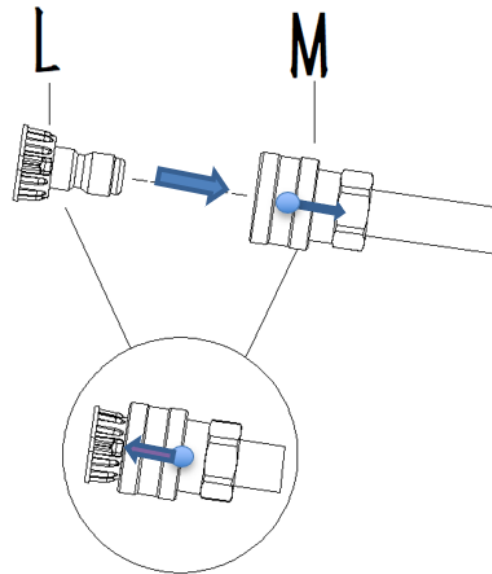

VI. Attach the desired nozzle tip to the spray wand. Refer to the following diagram for spray tip patterns:

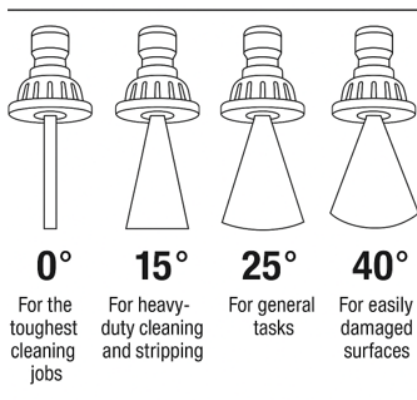

0° (Red): Narrow, highly concentrated stream. This nozzle should only be used on tough surfaces like concrete to remove the most tenacious stains. It's powerful enough to strip paint even puncture soft materials like wood.

15° (Yellow): Produces a powerful, cutting edge that's effective on heavy dirt and grime. A good choice for washing heavy-duty equipment or farm equipment. It can also damage wood or other softer materials.

25° (Green): Produces a moderately powerful spray and a flushing or sweeping effect. Suitable for general cleaning around the house (patio furniture, decks and sidings).

40° (White): This wide, low-pressure spray pattern is ideal for gentle cleaning sensitive surfaces like automobiles, stucco walls, etc.

- VII. Before plugging in GFCI to the power outlet, ensure the main unit power switch (N) is in **OFF** position (fully up / not indented).

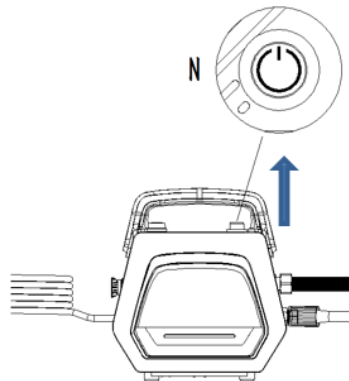

- VIII. Plug GFCI into the power outlet. Firmly press and release the TEST button (A - colored in **white** and on **bottom**) once; press and release the RESET button (B - colored in **red** and on **top**) once. The light on the GFCI should be illuminated in green. The main unit is now powered.

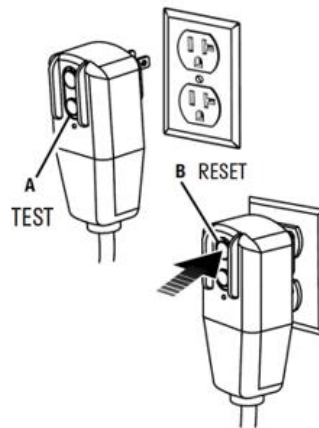

IX. PURGING

- ❖ Running a pressure washer pump without water will severely damage the pump seals and other internal components. To avoid this hazard, make sure your water supply is uninterrupted and at least 5 GPM at 20 PSI, and always purge the air before starting the motor.

If the safety trigger is locked, release it by pushing (J) down to the slot, as shown below:

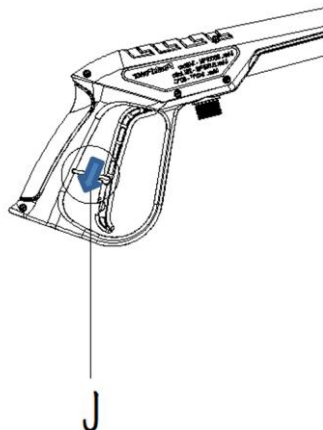

- ❖ While the main unit switch remains OFF, aim the spray gun in a safe direction, squeeze and hold the trigger for at least 30 seconds or until the water runs steady and all the air is purged from the unit and hoses.



NEVER DIRECT A WATER STREAM TOWARD PEOPLE OR PETS. HIGH PRESSURE WATER CAN CAUSE SERIOUS INJURY BY PENETRATING THE SKIN. SEEK MEDICAL ATTENTION IMMEDIATELY IN CASE OF PENETRATION.

- ❖ Turn on the unit: with finger off the trigger and the spray gun pointed at a safe direction, press down the power switch (N). The green indicate light will be on, and the motor is turned on with a humming sound.

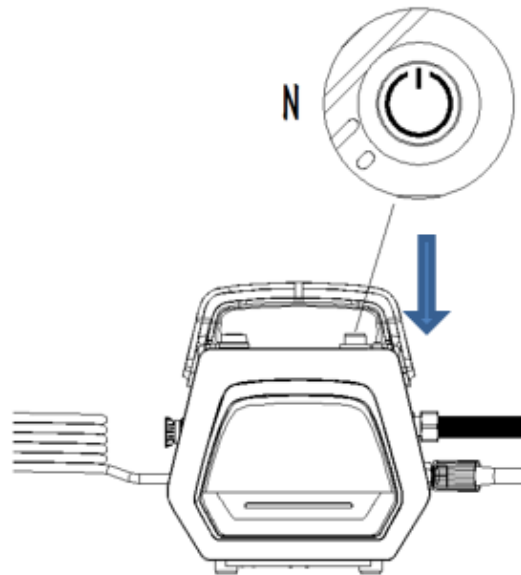

3 OPERATING THE UNIT

3.1 OUTPUT PRESSURE ADJUSTMENT

- ❖ When the unit is running, turn Pressure Adjustment Dial (P) clockwise to raise or counterclockwise to lower the output pressure. The horizontal lightbar (Q) will turn into green, lengthening or shortening while the dial is being turned, matching output strength.
- ❖ When the lightbar is completely filled in green, maximum output pressure is set.
- ❖ A blue or cyan lightbar indicates the machine is back in working mode.

 To prevent unintended dial adjustments, the system ignores any initial three quick dial stops followed by 10 seconds of inactivity. To enter pressure adjustment mode, the operator must begin with three quick dial stops, then continue applying steady dialing force. The green lightbar will respond accordingly, reflecting changes in output pressure.



NEVER OPERATE THE MACHINE
WITHOUT COLD WATER RUNNING
THROUGH THE SYSTEM FIRST!

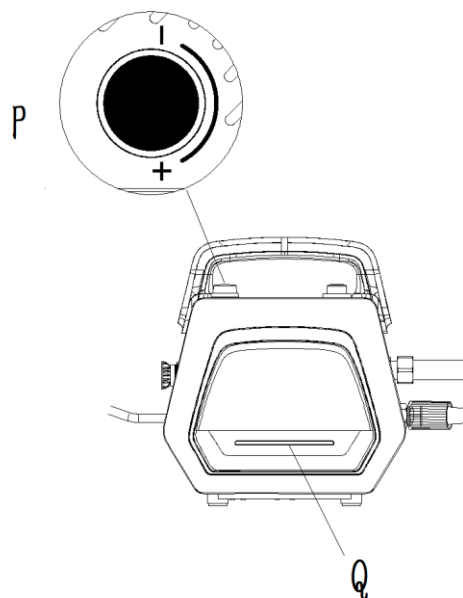

LIGHTBAR INDICATOR (TABLE A3)

COLOR	STATUS	EXPLANATION
BLUE	SEQUENTIAL	MACHINE WORKING IN * NORMAL MODE
	FLASHING	MODE SWITCHING CONFIRMATION (NORMAL VS. CONSTANT – SEE CHAPTER 3.2)
CYAN	SEQUENTIAL	MACHINE WORKING IN * CONSTANT MODE
	FLASHING	MODE SWITCHING CONFIRMATION (NORMAL VS. CONSTANT – SEE CHAPTER 3.2)
GREEN	FULLY LIT	INTELLIGENT STANDBY
ORANGE	FULLY LIT (OVER-RIDING BLUE OR CYAN UNDER NORMAL / CONSTANT MODE, OR GREEN AT INTELLIGENT STANDBY STATE)	OIL CHANGE REMINDER. SEE CHAPTER 4.1.3 FOR OIL CHANGE PROCEDURE. RESET CLOCK BY HOLDING FOR 15 SECONDS.
YELLOW	FULLY LIT	SLEEP STATE UNDER CONSTANT MODE (CAUSED BY 5-MINUTE INACTIVITY), OR BEING SWITCHED FROM NORMAL MODE TO CONSTANT MODE WHILE THE UNIT IS IN INTELLIGENT STANDBY STATE (GREEN LIGHTBAR). PRESS THE ON BUTTON WILL TURN THE UNIT BACK ON. SEE CHAPTER 3.2.
RED	FULLY LIT	ABNORMAL STATE / MALFUNCTION -TROUBLE SHOOTING OR CONTACT SUPPORT.

3.2 OPERATING MODES

The machine features two operating modes:

- **Normal Mode** – Factory Default (***Intelligent Standby** – see below)
- **Constant Mode** – Bypassing Intelligent Standby

Under **Normal Mode**, once the spray gun trigger is released for 3 seconds, motor will slow down; when trigger has not been squeezed for 10 seconds, motor will shut down—entering **Intelligent Standby** state. Squeezing the trigger again will immediately restart the motor.

Under **Constant Mode**, when the spray gun trigger is released but has not been released for more than 5 minutes: the motor continues running at working speed.

 Under **Constant Mode**, 5 minutes after the trigger is released (Operator Inactivity), system will go into **SLEEP** state to minimize the risk of overheating; squeezing the trigger again will NOT wake up the unit. Manual turn on (pressing the ON button) is required to resume work. **Normal Mode** is recommended when your work involves frequent breaks lasting over 5 minutes, in order to avoid undesired interruptions.

- **To toggle between two operating modes:**

Step 1: Press and hold down the Pressure Adjustment Dial (P) for 3 seconds—lightbar flashes rapidly.

Step 2: Release Dial (P) before reaching 8 seconds.

Step 3: Lightbar slowly flashes, indicating a successful mode change.

 Holding down the dial for more than 8 seconds will exit without changing the current operating mode.



IT IS RECOMMENDED TO OPERATE IN NORMAL MODE FOR EASE OF USE, ENERGY SAVING, AND TO PRESERVE THE LONGEVITY OF INTERNAL COMPONENTS.

3.3 SPRAY WITHOUT FOAM BLASTER

- Release safety trigger if it is locked.
- With spray nozzle tip pointed at a safe direction, squeeze the trigger and start spraying water.

3.4 SPRAY WITH FOAM BLASTER

Using detergent helps break down dirt quickly and allows high-pressure water to penetrate and remove it more effectively. Apply detergent to a dry surface (it is not necessary to pre-soak unless the object is covered

severely in filth and unable to absorb detergent effectively). Pre-wetting the area may dilute the detergent and reduce its cleaning effectiveness.

- Rotate the foam blaster Bottle counterclockwise 1/4 turn to remove the nozzle assembly.
- Pour detergent into the bottle per detergent manufacturer's diluting guidance.
- Reattach the nozzle by rotating it clockwise 1/4 turn.
- Connect the foam blaster to the quick connector on the spray wand.
- Release the safety trigger and start spraying detergent onto a dry work surface. Allow the detergent to sit briefly before rinsing but do not let it dry on the surface.
- After applying detergent, fill the bottle with clean water and spray for one minute to flush out any residue that may cause clogging for next use.

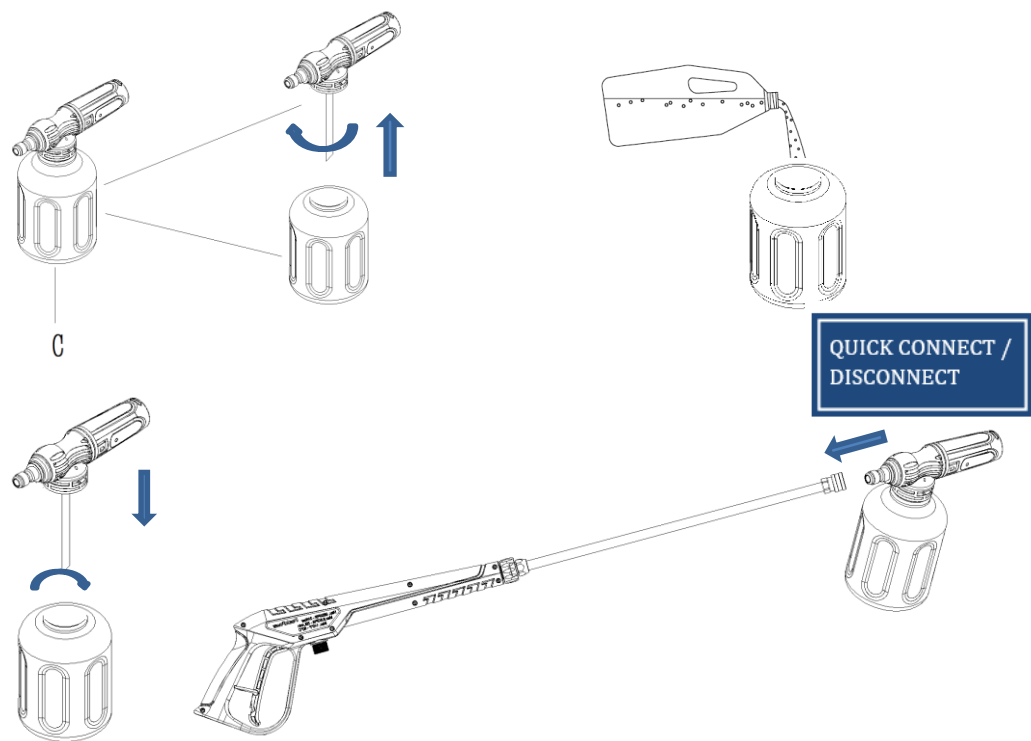

- LETTING CHEMICALS DRY TOO LONG MAY CAUSE DAMAGE TO PAINTED SURFACES!
- NEVER USE THE FOLLOWING CHECMICALS THAT MAY HARM THE MACHINE AND / OR DAMAGE THE CLEANING OBJECT:
 - BLEACH, CHLORINE PRODUCTS OR OTHER CORROSIVE CHEMICALS
 - SOLVENTS SUCH AS PAINT THINNERS, GASOLINE, OILS, ETC.
 - TRI-SODIUM PHOSPHATE
 - AMMONIA
 - ACID-BASED PRODUCTS

3.5 SHUT DOWN PROCEDURE

- Release spray gun trigger.
- Press down the power switch (N) to let it pop back up / fully extended. The green indicate light goes off confirming machine is shut down.
- Unplug power cord from the outlet.
- Aim the spray gun in a safe direction, squeeze and hold the trigger for 10 seconds to release stored water and air pressure from the system.
- Engage the safety lock on the spray gun.



FAILURE TO RELEASE RESIDUAL AIR PRESSURE / WATER INSIDE THE SYSTEM MAY RESULT IN PERSONAL INJURY CAUSED BY THE SUDDEN RELEASE OF HIGH-PRESSURE AIR AND / OR WATER WHEN RE-USING THE MACHINE.

4 CLEANING AND MAINTENANCE

4.1 CLEANING

- Follow shut down procedure and ensure there is no residual pressure in the system.
- Power cord has been unplugged from the outlet.

4.1.1 NOZZLE MAINTENANCE

Clogged nozzle may cause abnormal high pressure build up inside the pump. It is necessary to clean the nozzle when clogging is noticed.

1. Remove nozzle tip (L) by pulling down spring collar (M).
2. Clean nozzle with supplied cleaning needle (R). Rinse with clean water when necessary.

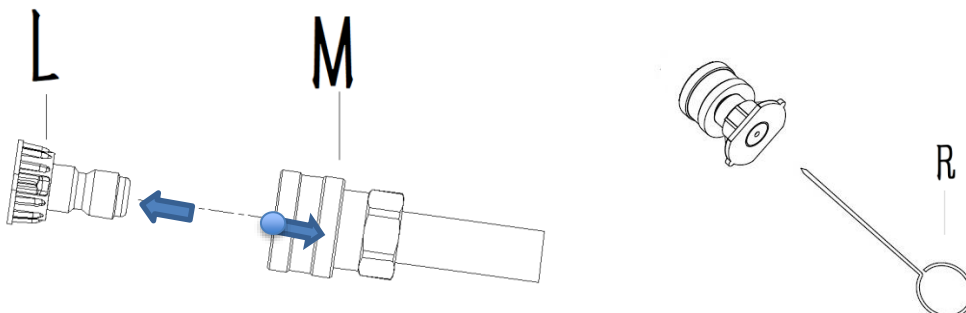

4.1.2 WATER INLET SCREEN CLEANING

Clogged water inlet screen may restrict water flow and damage the pump.

1. Remove the inlet screen from the inlet nut.
2. Rinse the screen with clean water to rid of debris.
3. Replace the screen back into the inlet nut, ensuring that the rubber seal seated securely at the bottom of the nut, and the convex side is facing out.

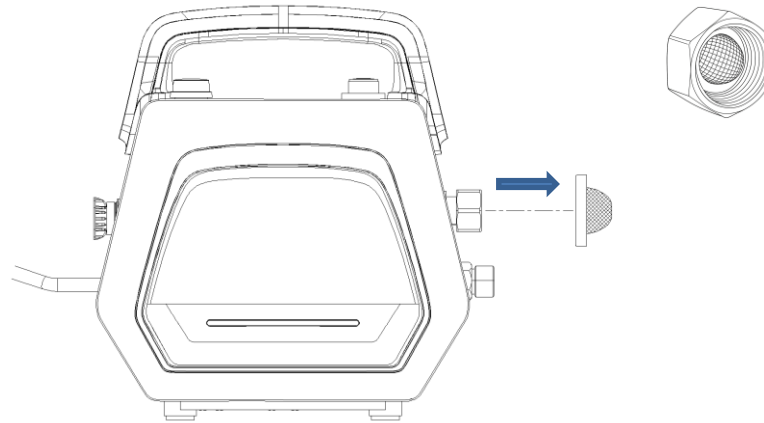

4.1.3 OIL CHANGE

This product is equipment with oil change serviceable pump. Regular oil change is crucial to maximize pump performance and protect internal components from wear and corrosion, preserve the longevity of the machine and maintain product warranty. It is recommended to change oil for every 80-hour of standard duty working time (features a built-in reminder; see Table A2 - Lightbar Indicator). You may change oil more frequently when deemed necessary.

4.1.3.1 OIL DRAIN PROCEDURE

1. Ensure the unit is unplugged from the outlet and there is no residual air pressure within the pump.
2. Recommend to use 15W-40 non-detergent, non-foaming, high quality motor oil that is specifically formulate for high pressure washer pumps.
3. Oil capacity: 300ml
4. Tools required:
 - Long Philip Screw Driver
 - 4mm Allen Wrench (Supplied)
 - Waste Oil Pan / Container
 - Oil Absorbing Cleaning Towel / Rag
 - Rubber / Nitrile Gloves
 - Torque Wrench

Proceed to Steps Below:

1. Remove the front cover by using a long Philip screw driver and unplug the breather valve, as shown below:

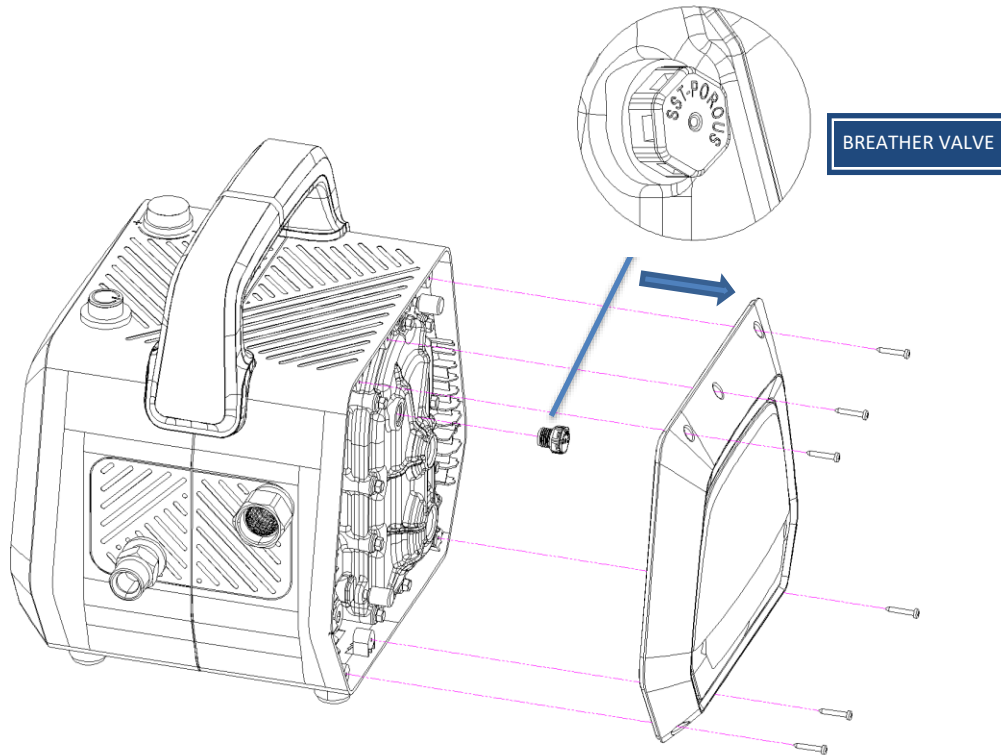

2. Lay the unit down on its back over a flat, secure surface, with the front facing up; it is recommended to use a soft cushion material or a large towel on the working surface to prevent scratches.
3. Use the 4mm Allen wrench (T) supplied, to loosen the oil drain bolt as shown below.

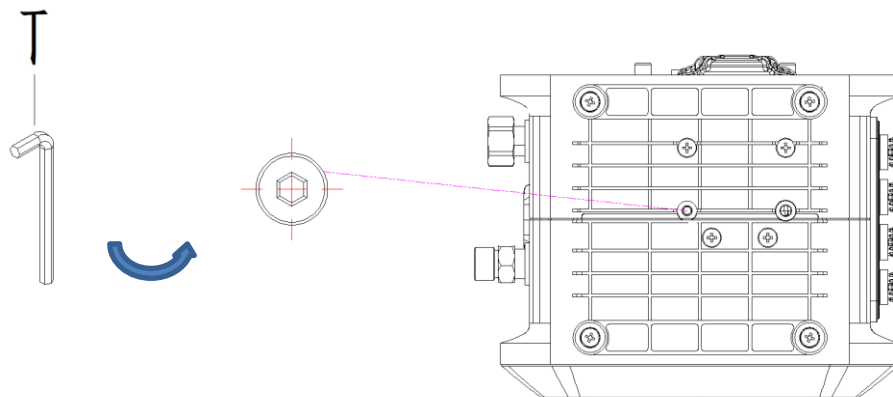

4. With your waste oil pan in place, while holding the unit securely by the handle, tilt or stand up the unit as shown below, completely remove the oil drain bolt to release oil. Another helper is recommended to make the process smoother and mess-free. Drain oil as thorough as possible.

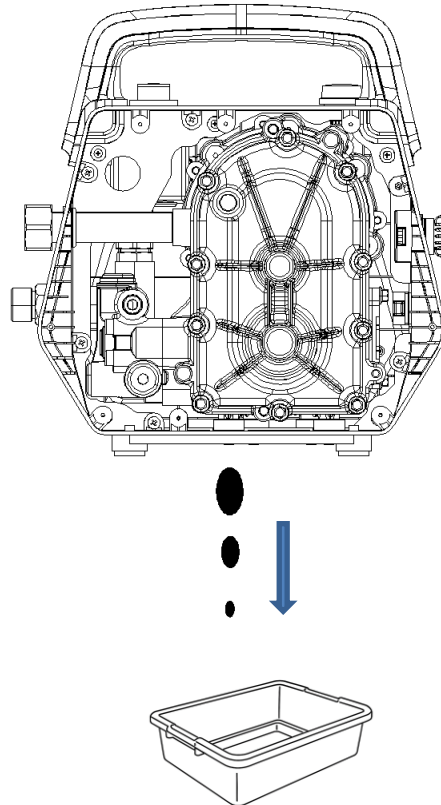

5. Wipe oil residuals off the body; lay the unit down on its back again; replace the bolt and torque it to **15Nm**. Do not over tighten or cross threading!
6. Dispose the waste oil safely and responsibly according to your local environmental laws and regulations.

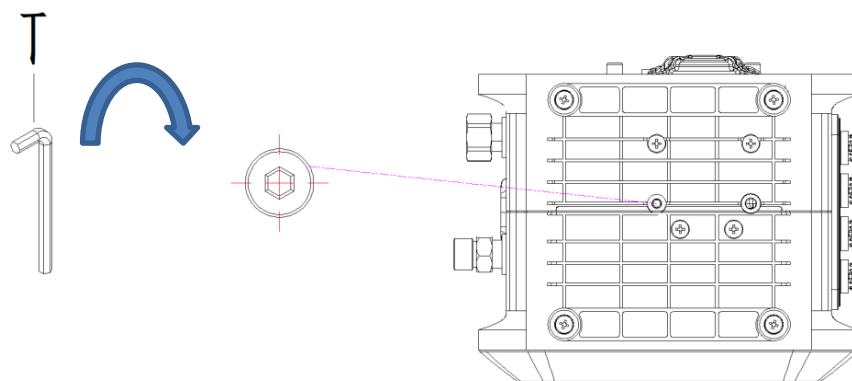

4.1.3.2 OIL RE-FILL

1. Fill oil bottle (G - supplied) up to 300ml with specified motor oil.

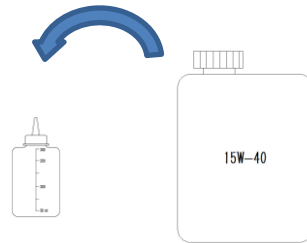

2. Align the bottle nozzle to the breather valve hole and squeeze the bottle to refill oil with gentle, steady squeezes.

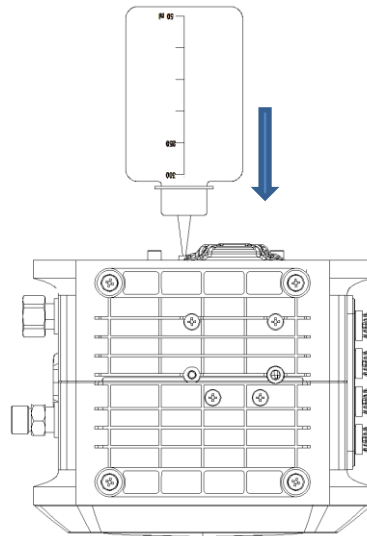

3. Wipe oil residuals off the body once 300ml oil is filled. Replace the breather valve and torque front cover screws to **0.5NM** – Do not overtighten or cross threading!

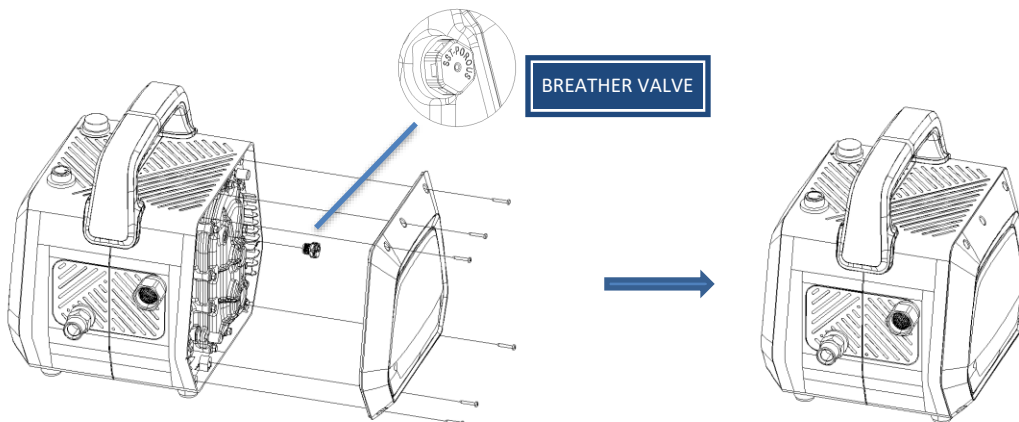

5 TRANSPORTATION AND STORAGE

5.1 TRANSPORTATION

- Disconnect power cord and water hoses before transportation.
- For short distance hand carry, ensure spray nozzle is pointed at the safe direction and all hoses and cords are not entangled.
- Carry the unit only by the handle.
- Do not stack items on top of the unit or press the body panels with heavy objects.
- Place the unit on a stable, flat surface and ensure the unit is fully secured and protected during transportation.
- Damages caused by inappropriate transportation may void warranty.

5.2 STORAGE

- Thoroughly drain water and release pressure from the system. Ensure all components are clean and dry.
- Store the unit indoors at room temperate. Protect the unit from extreme freezing or extreme high temperate.
- Store the unit away from heat source such as fire place, stove, furnace or hot exhaust.
- Prevent the unit from pests damaging power cord or internal components.
- Storage in harsh environment voids warranty.

5.3 Winterization

Winterize your pressure washer may protect and extend its life. In extended winter time, it is recommended to use pressure washer specific antifreeze (Not Supplied) before storage to lubricate internal parts, prevent rust, and avoid pump freezing.

- Inject pressure washer specific antifreeze gently into the inlet nut until overflowing.
- Clean off the excess.
- Must flush out the antifreeze thoroughly with clean water before re-use it to spray on any objects.

6 TECHNICAL SPECIFICATIONS (TABLE A4)

PUMP	PATENTED CRANKSHAFT DRIVEN TRIPLEX PUMP
LOAD VOLTAGE	120V / 60 HZ
RATED CURRENT	14A
PEAK PRESSURE	1500 PSI
WORKING PRESSURE	1200 PSI
WATER FLOW	2.5 GPM
MOTOR TYPE	BRUSHLESS PERMANENT MAGNET MOTOR
HOSE LENGTH	25 FT
POWER CORD	14 AWG 35 FT WITH GFCI PLUG
SOAP BLASTER VOLUME	350ML
WATER INLET	¾ GHT STANDARD GARDEN HOSE CONNECTION
WATER OUTLET	M22 - 14
WATER PROOF RATING	IPX5
WEIGHT	22.5 LBS / 10.2 KG
DIMENSIONS	11 ¼ W X 9 ½ D X 11 5/8 H IN. (286 X 241 X 295 MM)

7 TROUBLESHOOTING



- BEFORE ATTEMPTING ANY TROUBLESHOOTING OR REPAIR, UNPLUG THE UNIT FROM THE POWER OUTLET TO ENSURE SAFETY.
- ALWAYS VERIFY THAT COLD WATER HAS BEEN RUNNING THROUGH THE SYSTEM.

CONDITION	POSSIBLE CAUSE	CORRECTION
Machine does not start.	The unit has been turned off.	Press the ON / OFF button to switch on the unit.
	The power cord has been unplugged.	Ensure the power cord has been plugged in and seated properly.
	The extension cord does not meet minimum gauge requirement.	Use proper extension cord as specified in the manual.
	Any part of the cord / extension cord has been damaged.	Try a different, undamaged cord.
	The power outlet does not supply sufficient power.	Test on a different power outlet that is NOT on the same circuit.
	Circuit breaker has been tripped.	Verify that the unit is not overheating; reset the circuit breaker when deemed safe; use a power outlet from a separate circuit.
Machine runs but no water comes out of the nozzle tip.	Water supply has been shut off.	Turn on the water supply.
	Blockage or kinks in the garden hose	Remove kinks or blockage.
The unit is not delivering high pressure.	Garden hose diameter is too small.	Try a larger diameter garden hose (5/8 to 1 inch diameter).
	Restricted water supply pathway.	Check garden hose for kinks, leaks for blockage.
	Insufficient water supply.	Verify that the faucet valve has been fully opened and water supply pressure is sufficient.
	Clogged water inlet	Clean inlet screen as instructed.
	Pump may be sucking in air.	Check for leaks in all hoses and fittings. Purge the system as instructed.
Fluctuating output pressure.	Clogged inlet screen	Clean inlet screen as instructed.
	Insufficient water supply	Verify that the faucet valve has been fully opened and water supply pressure is sufficient.
	Clogged nozzle tip	Clean nozzle tip as instructed.
	Pump may be sucking in air.	Check for leaks in all hoses and fittings. Purge the system as instructed.
	Hard water / lime calcification / build up	Clean spray gun, hoses and nozzles with de-calcification solutions or distilled vinegar.

CONDITION	POSSIBLE CAUSE	CORRECTION
Foam blaster not producing foams.	Clogged filter in suction tube	Clean with warm water or distilled vinegar.
	Clogged suction tube	Clean / flush the tube or replace if damaged.
	No-foaming detergent is used or detergent is too thick.	Replace with foaming detergent or dilute the detergent.
	Loose connection with the bottle or tube	Verify tight connections.
	Spray nozzle is incorrectly adjusted.	Re-adjust foam blaster nozzle opening.
Machine hums without turning on.	Insufficient voltage caused by extension cord	Test with direct connection to the outlet.
	Insufficient lubrication	Power cycle the unit and verify if the machine operates. Change oil and verify if the condition has been corrected. If problem persists, contact Customer Support.
	Insufficient voltage	Verify supplied voltage on the circuit. Test with another circuit.
	Pressure lock within the system	Turn off the machine, squeeze spray gun trigger to release residual pressure. Turn on the machine to verify if the condition has been corrected. If problem persists, contact Customer Support.
Noisy pump	Clogged inlet screen	Clean inlet screen as instructed.
	Pump may be sucking in air	Check for leaks in all hoses and fittings. Purge the system as instructed.
Noisy motor	Motor overheating or malfunction	Turn off the machine, wait for 15 minutes, turn on the machine to verify if the condition re-appears. If the problem persists, contact Customer Support.
Leaking garden hose	Loose / deteriorated fittings	Tighten fittings or replace worn fittings, washers and O-rings.
Leaking spray wand or nozzles	Components are not properly attached / connected, or caused by loose / deteriorated fittings.	Re-attach all components securely. Replace worn fittings, washers and O-rings. Contact Customer Support for parts needed.
Oil leaks from unit body.	Oil drain bolt or breather valve is not securely seated.	Refer to oil change procedure for proper torque value and tightening procedure. Ensure that oil drain bolt is not cross-threaded. If condition persists, contact Customer Support.

8 WARRANTY

For fast and efficient warranty support, register your product on our website. This allows our customer service team to quickly access your purchase details. If your product is not registered at the time of inquiry, you may be required to register it before warranty assistance can be provided.

Always keep your original purchase receipt as proof of purchase, and have your serial number and purchase details ready when contacting us.

For support, contact: support@maxflowproducts.com

8.1 WARRANTY COVERAGE TERMS

The manufacturer of this product agrees to repair or replace designated parts that prove defective within the warranty period listed below at the manufacturer's sole discretion. Specific limitations / extensions and exclusions apply.

This warranty covers defects in material and workmanship and not parts failure due to normal wear, depreciation, abuse, accidental damage, negligence, improper use, maintenance, water quality or storage. To make a claim under the terms of the warranty, all parts said to be defective must be retained and available for return upon request to a designated warranty service location for warranty inspection. The judgments and decisions of the manufacturer concerning the validity of warranty claims are final. If such a defect is found to be present after inspection, upon presentation of proof of purchase and damage, Manufacturer will elect to either replace the product entirely or provide an appropriate part for replacement (Note: Shipping costs may apply on discretion of manufacturer; No labor warranty. The manufacturer may elect to refund the purchase price in full (within 30-day return window) solely at manufacturer's own discretion.

These warranties pass through to the end user and are non-transferable.

This warranty replaces all other warranties, express or implied, including without limitation and warranties of merchantability or fitness for a particular purpose and all such warranties are hereby disclaimed and excluded by the manufacturer. The manufacturer's warranty obligation is limited to repair and replacement of defective products and provided herein and the manufacturer shall not be liable for any further loss, damages, or expenses - including damages from shipping, accident, abuse, acts of God, misuse, or neglect. Neither is damage from repairs using parts not purchased from the manufacturer or alterations performed by non-factory authorized personnel. Failure to install and operate equipment according to the guidelines put forth in the instruction manual shall void warranty.

THIS WARRANTY DOES NOT COVER:

Damage resulting from shipping (claims must be filed with freighter), accident, abuse, act of God, misuse, or neglect. This warranty also does not cover damage from repairs or alterations performed by non-factory authorized personnel or failure to install and operate equipment according to the guidelines put forth in the instruction manual. The manufacturer will not be liable to any persons for consequential damage, for personal injury, or for commercial loss. What the warranty does not cover includes but not limited to the following:

- Freight damage
- Damage due to chemical deterioration, salt water, rust or corrosion
- Damage caused by parts or accessories not obtained from an authorized dealer or not approved by the manufacturer
- Normal wear of moving parts or components affected by moving parts
- Consumable parts such as: Fuel filter, air filter, spark plug(s), recoil starter rope, oil and lubricant(s)
- Normal periodic maintenance work such as carburetor cleaning and engine oil draining
- Freeze damage

This warranty applies to residential use only. This warranty is void if the equipment is used for commercial, industrial or rental purposes.

RESPONSIBILITY OF ORIGINAL PURCHASER

- To process a warranty claim on your pressure washer, report the concern to: support@maxflowproducts.com.
- Retain original purchase receipt as proof of purchase for warranty work.
- Use reasonable care in the operation and maintenance (such as required oil change) of the product as described in the Instruction Manual.

HIGH-PRESSURE PUMP AND MOTOR (DEFECTS IN MATERIAL AND WORKMANSHIP:

THREE (3) years from the date of purchase.

ACCESSORIES (DEFECTS IN MATERIAL AND WORKMANSHIP):

Including nozzles, hoses, spray guns, wands, foam blaster

Ninety (90) days from the date of purchase.

What is Not Covered?

The warranty is void if the equipment is used for commercial, rental or industrial purposes.

This warranty does not cover accidental damage, unreasonable use, and normal wear and tear like belts, chains and tine, use of improper detergents, freezing, neglect, or non-compliance with the operating Instructions. The warranty does not cover loss of use or other consequential damages arising from any of the above, nor does it cover repairs made or attempted by unauthorized persons.

NOTES



MAXFLOW PRODUCTS ©

All rights reserved. MAXFLOW™, name, logo, and product design are trademarks of MAXFLOW Products and Semper Vista Inc., and may not be used without express written permission.