

TOYOTA

SUPERJ17W

# SUPER JEANS<sup>®</sup>

**STRETCH SERIES**



LIGHT WEIGHT (5,1 KG) EASILY PORTABLE

**EXCLUSIVE GLIDING FOOT**

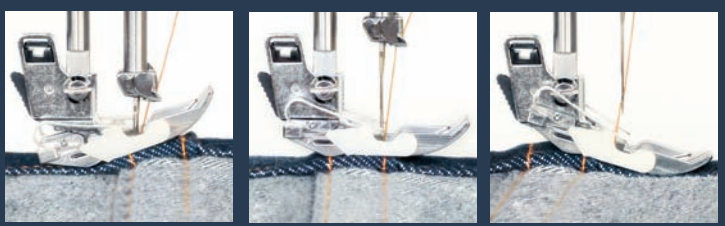

**GLIDE OVER 12 LAYERS**





## Stretch fabrics sewing capability



2 dedicated programmes  
 #13 : this is the reinforced straight stitch to sew & repair stretch fabrics, armholes, sports clothes.  
 #14 : to sew 2 pieces of stretch fabrics & overlock in a same time.

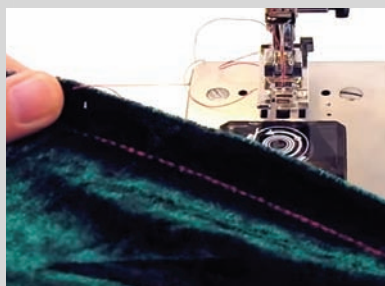

## Glide over 12 layers

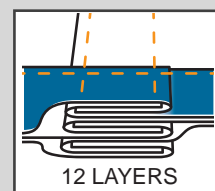

## Ergonomic Design for Easy Sewing

1. Easy to see needle drop point
2. Easy to use large dials, levers and wide sewing area
3. Top loading rotary system with see through cover.
4. Large selection dial
5. Large feed back lever

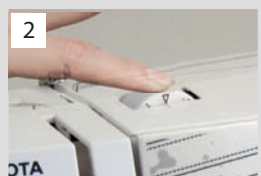

## Built-in Quick Adviser

- How to thread the machine ?
- How to put the bobbin in ?
- Trouble shooting to wind the bobbin
- Trouble shooting for stitch problem



## Built-in needle threader & side thread cutter



Easy to operate

Side thread cutter



## 17 Multi-purpose programmes

### 13 standard stitch programmes

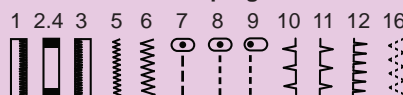

- 1-2-3-4. 4 step buttonhole
- 5-6. Zigzag stitch, overcasting
- 7-8. Straight stitch (small, medium)
- 9. Straight stitch (left side)
- 10-11. Overcasting stitch
- 12. Blind hem stitch
- 16. Mending stitch, thin fabric overcasting

### 2 stretch



- 13. Reinforced straight stitch
- 14. Stretch stitch, overlock

### 2 deco



- 15-17. Decorative stitches



### Standard accessories

- \*Standard needle (x 2)
- \*Jeans needle (x 2)
- \*Ball point needle (x 1)
- \*Gliding foot
- \*Zigzag foot
- \*Overcasting foot
- \*Zipper foot
- \*Blind hem foot
- \*Buttonhole foot, 4 step
- \*Plastic bobbin (x 2)
- \*Spool cap
- \*Buttonhole cutter
- \*Sewing guide
- \*Needle plate screw drive



### Other included accessories

- \*Dust cover
- \*Electronic foot controller
- \*Quick guide instruction manual
- \*Manual CD
- \*Gliding foot instruction manual and sewing tips

## SPECIFICATIONS

### Stretch fabric sewing capability

- Needle threader : Yes
- Side cutter : Yes
- Maximum stitch length : 4mm
- Maximum stitch width : 5mm
- Needle position : center / left
- Net weight : 5,1 kg
- Sewing machine size : 410 x 198 x 294 mm
- Rated voltage : 220-240V
- Rated frequency : 50 Hz
- Rated power : 65 W
- Light bulb : 15 W
- Series : SP100