

# *Redondo*

USER'S MANUAL



MODERN SOUND FOR YOUR CLASSIC

[www.retromanufacturing.com](http://www.retromanufacturing.com)

# TABLE OF CONTENTS

---

WELCOME.....	3
WHAT'S IN THE BOX - REDONDO RS.....	4
WHAT'S IN THE BOX - REDONDO RT.....	5
PRECAUTIONS.....	6
INSTALLATION INSTRUCTIONS.....	9
WIRING DIAGRAM.....	14
<b>OPERATING YOUR REDONDO RS</b>	
BASIC OPERATION.....	19
TONE CONTROLS.....	22
SYSTEM SETTINGS.....	24
<b>OPERATING YOUR REDONDO RT</b>	
BASIC OPERATION.....	29
TONE CONTROLS.....	32
SYSTEM SETTINGS.....	34
USB/APPLE® DEVICE INSTRUCTIONS.....	39
BLUETOOTH® INSTRUCTIONS.....	42
TROUBLESHOOTING.....	43
FREQUENTLY ASKED QUESTIONS.....	44
SPECIFICATIONS.....	47
LIMITED WARRANTY.....	48
REPLACEMENT PARTS.....	49

“Made for iPod®” and “Made for iPhone®” mean that an electronics accessory has been designed to connect specifically to iPod® or iPhone® respectively, and has been certified by the developer to meet Apple performance standards. Apple is not responsible for the operation of this device or its compliance with safety and regulatory standards. Please note that the use of this accessory with iPod® or iPhone® may affect wireless performance. Apple is not responsible for the operation of the device or its compliance with safety and regulatory standards.

iPod® and iPhone® are trademarks of Apple Inc., registered in the U.S. and other countries.

Windows Media® and the Windows® logo are trademarks, or registered trademarks of Microsoft Corporation in the United States and/or other countries.

The Bluetooth® word mark and logos are owned by the Bluetooth® SIG, Inc., and any use of such marks by Retro Manufacturing, LLC are under license. Other trademarks and trade names are those of their respective owners.

## Made for iPod®

(Correct function of earlier versions cannot be guaranteed.)

- iPod touch (4th generation): Ver. 5.1.1
- iPod touch (3rd generation): Ver. 5.1
- iPod touch (2nd generation): Ver. 4.2.1
- iPod nano (6th generation): Ver. 1.1
- iPod nano (5th generation): Ver. 1.0.2
- iPod nano (4th generation): Ver. 1.0.4
- iPod nano (3rd generation): Ver. 1.1.3
- iPod classic (160 GB) (Late 2009): Ver. 2.0.4
- iPod classic (120 GB): Ver. 2.0.1
- iPod classic (80 GB, 160 GB): Ver. 1.1.2

## Made for iPhone®

(Correct function of earlier versions cannot be guaranteed.)

- iPhone 4s: Ver. 5.1.1
- iPhone 4: Ver. 5.1.1
- iPhone 3GS: Ver. 5.1.1
- iPhone 3G: Ver. 4.2.1

For clarity in identifying your model of iPod®, please see Apple's document “Identifying iPod® models” at <http://support.apple.com/kb/HT1353>.

# WELCOME

---

Redondo combines classic styling with the advanced features you expect from a modern car stereo. Redondo consists of four main parts: the display face, the push-buttons, the radio shafts or thumb-rollers and the Motor 3 body.

Redondo comes in two versions: Redondo RS (Redondo Shaft) and Redondo RT (Redondo Thumb-Roller).

## General Features

- Compatible with iPod® and iPhone®
- Built-in Bluetooth® for hands-free calling and wireless audio streaming
- Plays MP3 and WMA files via USB input
- Selectable 32,000 color LCD illumination with user presets
- AM/FM tuner with 30 presets and RDS
- Selectable international tuner frequencies
- Built-in amplifier (25 watts RMS/45 watts peak x 4 channels)
- 3 EQ presets plus user-controlled bass, mid-range, treble, fader and balance adjustment
- InfiniMount shaft/bracket system for maximum installation flexibility
- Available with period-correct knobs or thumb-rollers
- Independently adjustable display face and push-buttons
- Inputs: 2 rear-mounted standard USB ports and 2 rear-mounted auxiliary inputs
- Outputs: 6-channel pre-amp outputs (front, rear, subwoofer)
- Separate power antenna and amplifier turn-on lead(s)
- 2 year parts and labor warranty

The information enclosed in this user's manual is to be used as a guide to assist you with installation and operation of your radio. This guide does not cover every installation possibility, vehicle, or every aspect of the installation process.

Retro Manufacturing, LLC, RetroSound®, or its subsidiaries, assume no responsibility for any installation. This manual may be updated from time to time.

Visit our website for the latest updates: [www.retromanufacturing.com](http://www.retromanufacturing.com).

# WHAT'S IN THE BOX - REDONDO RS

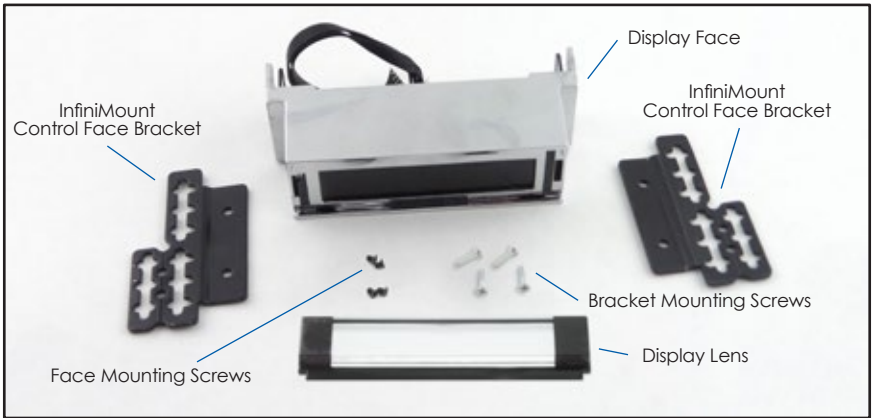

These items are packaged with your display face

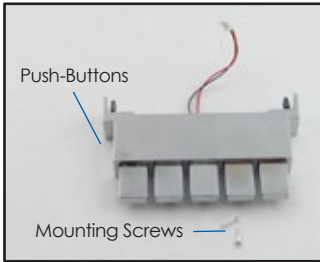

These items are packaged with your push-buttons

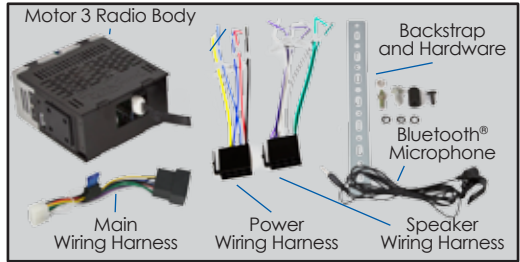

These items are packaged with your Motor 3

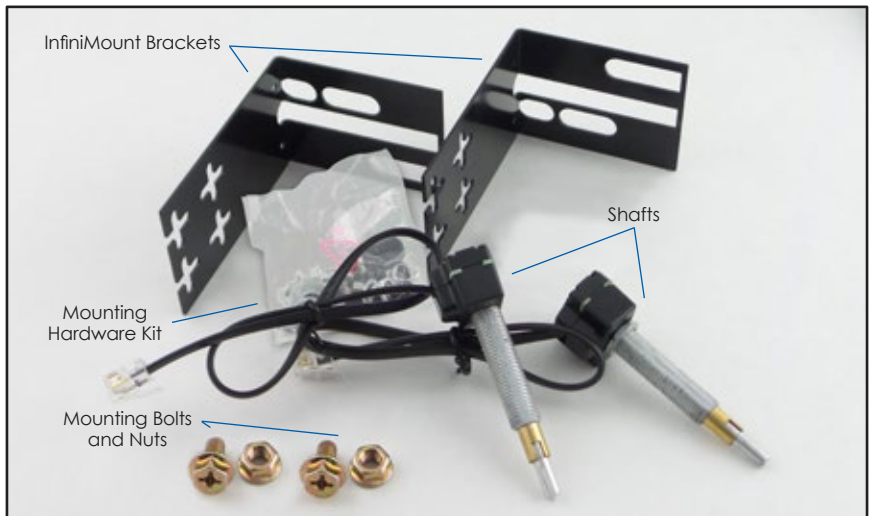

These items are packaged with your shafts

# WHAT'S IN THE BOX - REDONDO RT

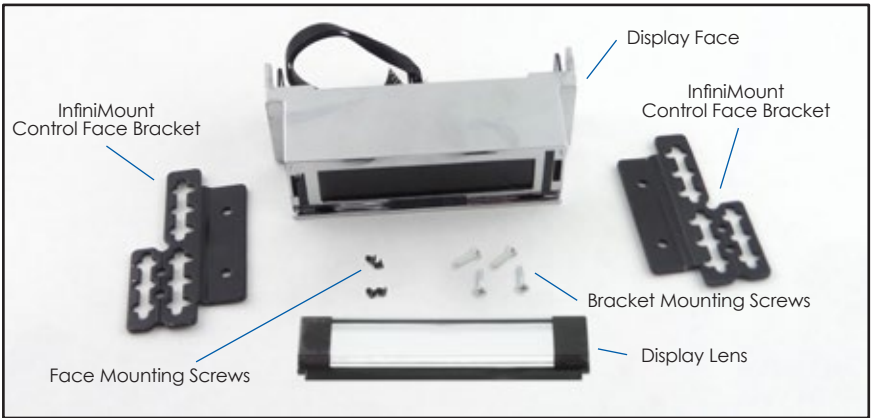

These items are packaged with your display face

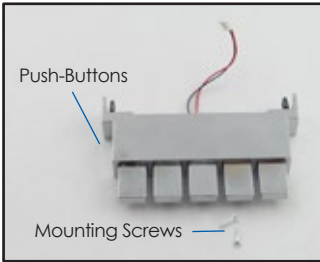

These items are packaged with your push-buttons

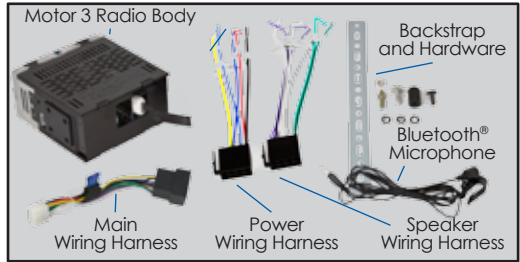

These items are packaged with your Motor 3

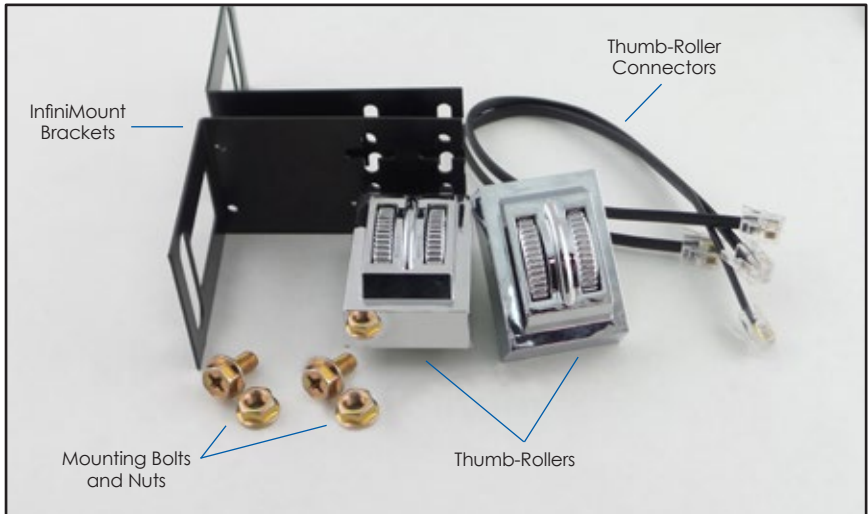

These items are packaged with your thumb-rollers

## PLEASE OBSERVE THESE PRECAUTIONS WHEN INSTALLING AND USING THIS UNIT:

This user's manual does not cover all possible installation scenarios. If you feel you can't install this unit yourself, please take it to a local car audio professional. Feel free to contact us if you have questions about installing your radio.

- Do not disassemble, modify or attempt to repair the unit yourself. If the unit needs to be repaired, consult your dealer or Retro Manufacturing, LLC.
- Do not use the unit when it is out of order. If the unit is out of order or is in an abnormal state (has foreign objects in it, is exposed to water, is smoking or smells), turn it off immediately, remove power and consult your dealer or Retro Manufacturing, LLC.
- Refer fuse replacement to qualified service personnel. If a fuse blows, eliminate the cause and have it replaced by a qualified service technician with the fuse prescribed for this unit. Incorrect replacement of the fuse may lead to fire and damage the unit.
- If the unit does not turn on, check all the connections first. Then check the fuse in your vehicle's fuse box and the fuse at the unit's wiring harness. Do not expose the unit to direct sunlight or excessive heat. Excessive heat will raise the interior temperature of the unit, which may damage it.
- Do not use the unit where it is exposed to moisture or dust. Exposure of the unit to moisture or dust may lead to smoke, fire or other damage to the unit and will void your warranty. Make sure the unit does not get wet in car washes or on rainy days. Exposure to moisture will damage the unit and void your warranty.

# PRECAUTIONS

---

- Installation of this unit requires special skills and experience. For maximum safety, have it installed by your dealer or qualified service professional. Retro Manufacturing, LLC, is not liable for any problems resulting from improper installation of the unit. Always follow the instructions carefully while attempting any installation.
- Follow instructions when wiring the unit. Failure to follow the instructions could cause damage to the unit, fire, injury or death.
- Be careful when routing the wiring and harnesses. Prevent the wires from being damaged by screws or moving parts such as seat rails. Do not route wiring near heat sources or beneath heavy objects that may crush or damage coating. If the wiring must be routed around sharp metal edges, protect them by wrapping them with vinyl tape or similar protection.

**NOTE: Cutting the main wire harness, antenna lead, USB or auxiliary cables will void the warranty of your radio.**

- Use only the designated parts and appropriate tools to install this unit. The use of parts other than those supplied may result in internal damage to the unit.
- Do not interfere with safety-related vehicle components. Never wire or affix this unit to the fuel tank, brakes, suspension, steering wheel, pedals, etc. Check for electric wiring, piping and other items before installing the unit.
- Never install the unit in a location where it interferes with your field of vision.
- Never splice into the power lead to supply other equipment with power.



# PRECAUTIONS

---

- After installation and wiring, always check the normal operation of other electrical equipment before driving.
- Make sure that no wires interfere with driving or getting in and out of the vehicle.
- Insulate all exposed wires to prevent short-circuiting or electric shock.
- Do not operate the unit for prolonged periods with the engine off. Prolonged operation with the engine turned off will drain the battery.
- To prevent accidents, keep the volume of your radio at a level that allows you to hear outside noises such as emergency sirens and train crossing warnings. Prolonged exposure to high volume levels may also result in hearing loss.
- This unit requires 12 volts to both the red and yellow power leads. The unit will not work without 12 volts to both of these leads.
- Disconnect the negative (-) battery cable before beginning the installation. Verify the battery ground by checking that one wire is connected to the vehicle's starter mounting bolt or engine block and the other to the vehicle's chassis using at least 8 gauge wire. Make sure the alternator or generator connections are secure and free from corrosion or dirt.
- This unit is designed for operation with a negative ground 12 volt DC battery system. Do not operate this unit with other battery systems, especially an 18 or 24 volt DC or a positive ground system.

# INSTALLATION INSTRUCTIONS

---

The patented InfiniMount adjustable system allows almost unlimited installation options with independently adjustable controls to accommodate your needs.

To begin, locate the two shafts or thumb-rollers, two InfiniMount brackets, two InfiniMount control face brackets and the mounting screws. If you have a Redondo RS, locate the two large washers and two small washers inside the mounting hardware kit packaged with your shafts (see “What’s in the Box” on page 4 and 5).

## STEP 1: Install InfiniMount Control Face Brackets

First attach the InfiniMount control face brackets to the front of the radio body by sliding them into the slots on the side of the radio and securing them with the four small screws that came in your kit. They can be installed on either side with the extra mounting section at the top or bottom depending on fitment for your vehicle. You can cut this piece off if you need to (see Figure 1). The rear edge of this bracket is bent so that the display face and push-buttons can attach to the front of the radio. Make sure the brackets bend inward towards the center of the radio.

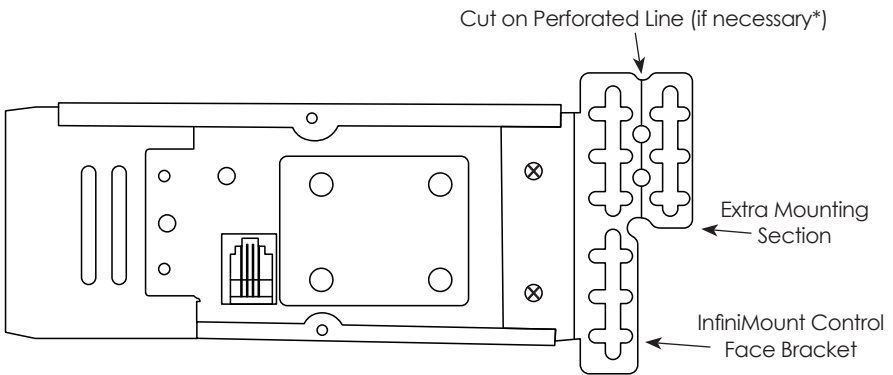

**Figure 1 - Attach InfiniMount Control Face Brackets**

\*For most applications, you will need to cut this part off with tin snips or a rotary cutting tool by cutting along the perforated line (see Figure 1). This will NOT void your warranty.

# INSTALLATION INSTRUCTIONS

## STEP 2: Install the Display Face and Push-Buttons

First, plug the push-buttons into the Redondo display face. Be careful not to damage the plug or wires when plugging in the push-buttons. Next, plug the ribbon cable connected to the Motor 3 radio body into the display face. After plugging in the display face and push-buttons, attach them to the InfiniMount control face brackets (see Figure 2).

**NOTE:** You can tell which side is the top of the Display Face by looking at the location of the lens. There will be more space beneath the lens on the Display Face than at the top (see Figure 2).

Before tightening the screws, adjust the display and push-buttons to match the factory radio opening. For best results, measure the factory radio opening or use the original factory radio for reference. Once they are aligned and in adjustment, tighten the screws.

Finally, install the lens into the display face by lining up the notches on the lens with the slots on the display face and snapping it into place.

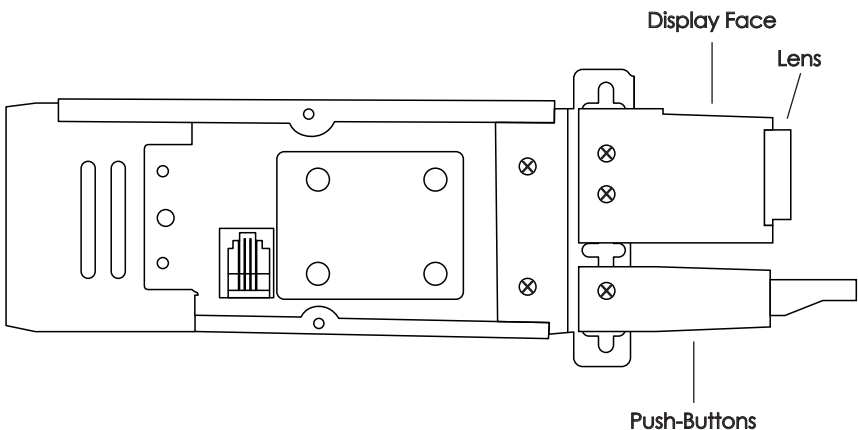

Figure 2 - Attach Redondo Display Face and Push-Buttons

# INSTALLATION INSTRUCTIONS

---

## STEP 3: Install InfiniMount Main Brackets

Attach each InfiniMount bracket to the correct side of the radio using the supplied screws. It may be necessary to adjust the brackets forward, backward, up or down before tightening the screws (see Figure 3). If needed, you may rotate, bend or cut the InfiniMount brackets to achieve the proper fit. Complete the assembly with at least two screws tightened on each side.\*

\*In some installations the brackets must be moved far enough forward or backwards or rotated so that only two screws will align with the threaded screw holes on the radio. Two screws are sufficient to hold the brackets in place.

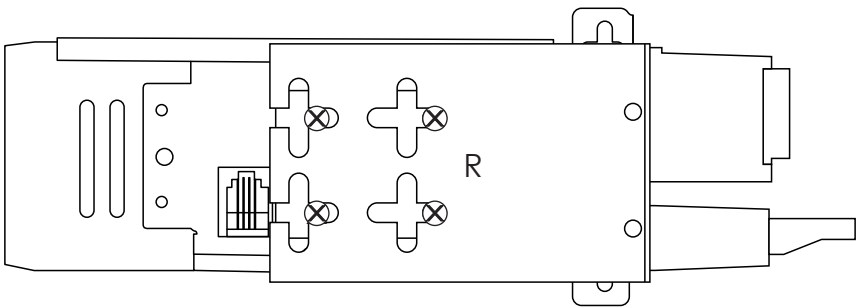

Figure 3 - Attach InfiniMount Brackets

**NOTE:** You may need to cut, trim or bend the brackets to achieve a perfect fit. You can even drill new mounting holes into the bracket if you need to. The InfiniMount system is designed to be modified, and modifying your brackets will NOT void your warranty.

# INSTALLATION INSTRUCTIONS

## STEP 4: Mount Shafts or Thumb-Rollers to Brackets

### Redondo RS

To match the location of your shafts to the proper width of your vehicle's dash, measure the distance between your existing shaft holes from center to center.

Mount a shaft to each bracket using the supplied shaft nuts and washers. Finger tighten the shaft nuts to prepare for the final installation (see Figure 4). Once you ensure the proper width, snug down the screws and nuts (DO NOT OVERTIGHTEN).

**DO NOT OVERTIGHTEN. OVERTIGHTENING THE SHAFT NUTS WILL DAMAGE THE SHAFTS. DAMAGE FROM OVERTIGHTENING WILL VOID YOUR WARRANTY.**

Finally, plug the shafts into each side of the main unit (see Figure 6).

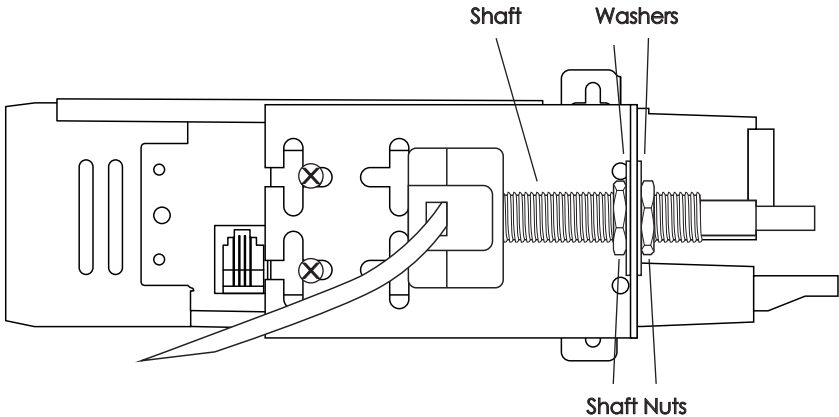

Figure 4 - Mount Shafts to Brackets

# INSTALLATION INSTRUCTIONS

---

## Redondo RT

First, ensure that you have the thumb-rollers right-side up by making sure the plug clips are on top of the plug (see Figure 5), then mount the thumb-rollers to the brackets by snapping them into place. Once the thumb-rollers are snapped into place, they can be adjusted by sliding them side to side. Finally, plug the thumb-roller plugs into the back of the thumb-rollers, plug them into each side of the radio body (see Figure 6).

**NOTE:** Each of the shafts and thumb-rollers can operate on either side of the radio and are not left/right dependent.

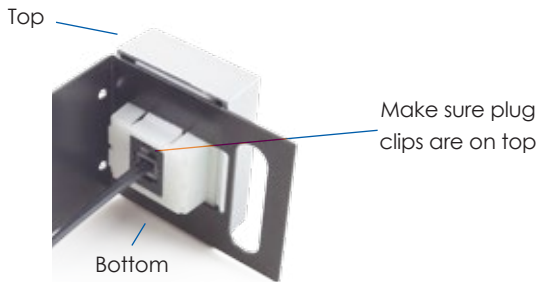

**Figure 5 - Plug in the Thumb-Rollers**

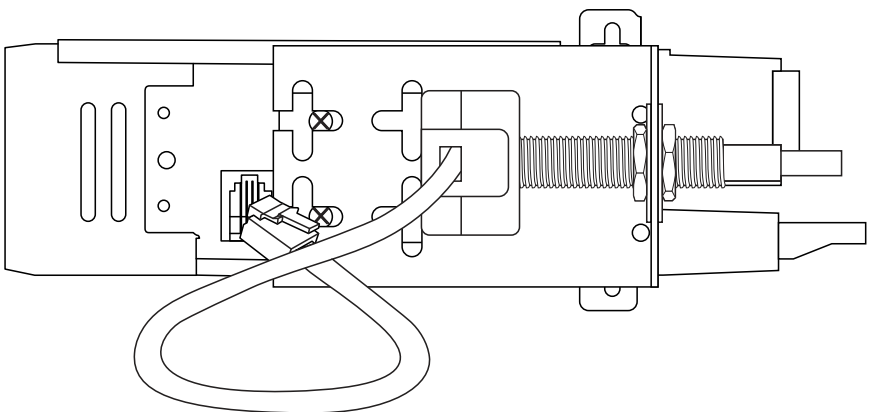

**Figure 6 - Plug the Shafts or Thumb-Rollers into the Body**

# INSTALLATION INSTRUCTIONS

## STEP 5: Complete Wiring Connections

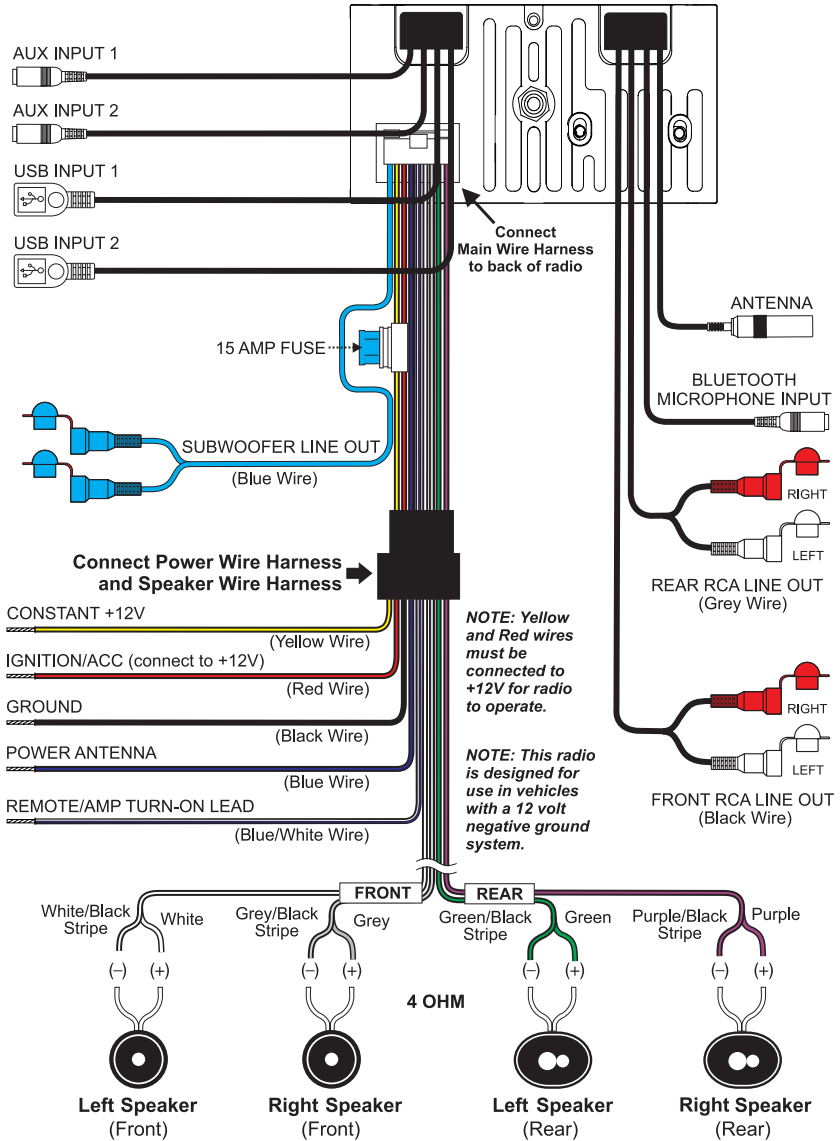

Figure 7 - Wiring Diagram

NOTE: Cutting the wiring harness, antenna lead or auxiliary cable will void your warranty.

# INSTALLATION INSTRUCTIONS

---

**NOTE:** This unit requires +12 volts to both the red and yellow wires to operate properly.

Locate the three wiring harnesses: main wiring harness, power wiring harness and speaker wiring harness (see "What's in the Box" on page 4 and 5). First connect the main wiring harness to the back of the radio. Then connect both the power and speaker wiring harnesses to the black female plug of the main wiring harness.

Next, connect the bare wire ends of your power and speaker wires to the appropriate power and speaker locations in your vehicle (see Figure 7). Have your radio installed by a professional if this part of the install is too difficult.

## Bluetooth® Microphone

Your Bluetooth® microphone enables you to place hands-free phone calls through your Redondo radio. The Bluetooth® microphone input is located at the rear of the Motor 3 radio body. To use your Bluetooth® microphone, you will need plug it into the plug at the rear of the Motor 3 radio body and route it to an accessible location such as the A-pillar or the steering column.

## Rear Auxiliary (AUX) Inputs

Two auxiliary inputs are located at the rear of the Motor 3 radio body. These auxiliary inputs allow you to listen to any external source with a standard headphone output such as a MP3 player, iPod® or iPhone®, portable CD player or portable satellite radio receiver.

**NOTE:** If the auxiliary cables provided are not long enough, you may use our USB/AUX Extension Cable (sold separately) to extend the reach of one cable. This cable also allows the installation of one USB and auxiliary port into the factory location of the cigarette lighter for a factory look and easy access. A male to male 3.5mm auxiliary cable is required to connect your device to the auxiliary port on your radio.



# INSTALLATION INSTRUCTIONS

---

## Rear USB Inputs

Two USB connector cables are located at the rear of the Motor 3 radio body. During installation, you must route the cables to an accessible location.

**NOTE:** If the USB cables provided are not long enough, you may use our USB/AUX Extension Cable (sold separately) to extend the reach of one cable. This cable also allows the installation of one USB and auxiliary port into the factory location of the cigarette lighter for a factory look and easy access.

## STEP 6: Completing Your Installation

### Redondo RS

For Redondo RS, install one set of shaft nuts and washers onto each shaft. Move the radio into place from behind the dash, and hold it into position until the holes at the edge of the InfiniMount brackets are lined up with the factory mounting holes and the shafts slide through the shaft openings in the dash. You may need to adjust the nuts for fitment. Holding the radio in place, use the supplied nut and bolt (see "What's in the Box" on pages 4 and 5) on each side of the InfiniMount brackets to secure the radio to the factory holes in the dash. If your vehicle came with a factory bezel, replace it while checking the alignment of the push-buttons and display face, and adjust as needed. Then install the front shaft nuts and washers to the shafts and gently snug them down.

**DO NOT OVERTIGHTEN. DAMAGE FROM OVERTIGHTENING WILL VOID YOUR WARRANTY.**

### Redondo RT

For Redondo RT, move the radio into place from behind the dash, and hold it into position until the holes at the edge of the InfiniMount brackets are lined up with the factory mounting holes. Holding the radio in place, use the supplied nut and bolt (see "What's in the Box" on pages 4 and 5) on each side of the InfiniMount brackets to secure the radio to the factory holes in the dash. Next, install the backstrap to secure the radio body into place (see Figure 8). Replace the factory bezel while checking the alignment of the push-buttons, display face and thumb-rollers, and adjust as needed.

# INSTALLATION INSTRUCTIONS

## Installing the Backstrap

You'll need to secure the rear of the radio using the supplied backstrap and hardware (see "What's in the Box" on page 4 and 5). The backstrap mounts using the threads at the rear of the radio body and can be bent and adjusted to align with the mounting point of the original factory radio behind the dash (see Figure 8).

**THE SHAFTS ARE NOT STRONG ENOUGH TO SUPPORT THE WEIGHT OF THE RADIO. FAILURE TO SECURE THE RADIO WITH THE BACKSTRAP CAN DAMAGE YOUR SHAFTS AND WILL VOID YOUR WARRANTY.**

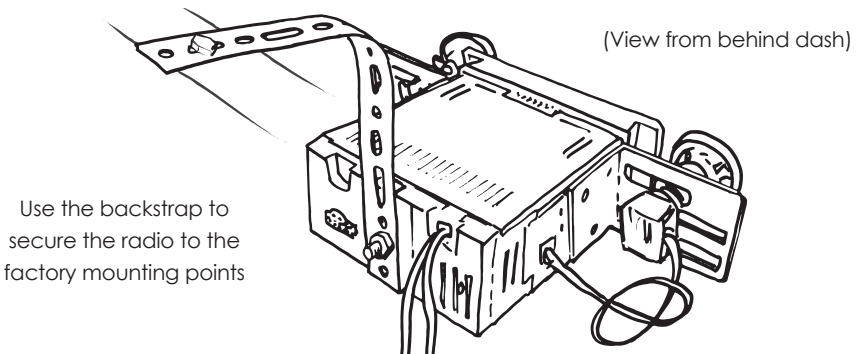

Figure 8 - Backstrap

## Redondo RS

Install your knobs (Redondo RS only) by sliding the rear knobs over the shaft, rotating them into the correct position and pushing them into place. Mount the front knobs by gently pressing them onto the shaft (see Figure 9).

**DO NOT PRESS TOO HARD. PRESSING TOO HARD CAN DAMAGE YOUR SHAFTS AND WILL VOID YOUR WARRANTY.**



Slide rear knobs onto shafts  
and rotate until they slide into place



Slide front knobs onto shafts

Figure 9 - Mounting the Knobs

# INSTALLATION INSTRUCTIONS

---



Redondo RS Finished installation

\*Pictured with Mopar® licensed screen protectors (sold separately)



Redondo RT Finished installation

\*Pictured with Mopar® licensed screen protectors (sold separately)

\*Officially licensed screen protectors sold separately

# OPERATING YOUR REDONDO RS

---

## BASIC OPERATION

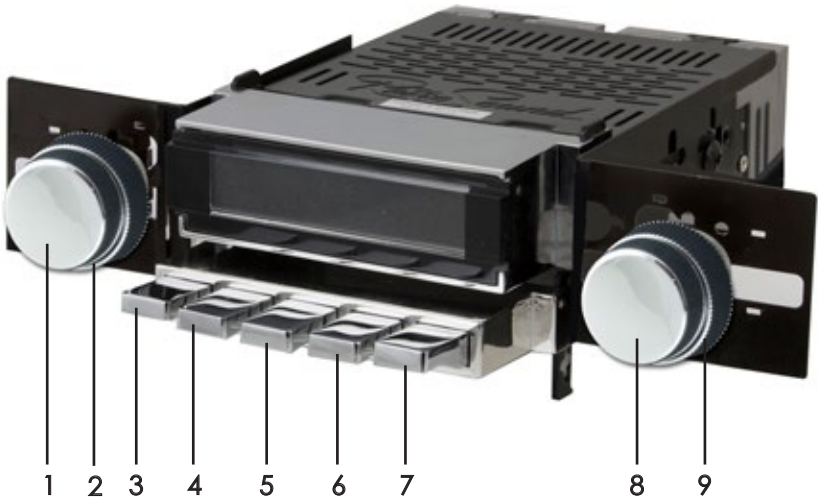

Figure 10 - Front Panel Controls

1. Left-Front Knob
2. Left-Rear Knob
3. Push-Button
4. Push-Button
5. Push-Button
6. Push-Button
7. Push-Button
8. Right-Front Knob
9. Right-Rear Knob



Figure 11 - Left Shaft with Knobs

# OPERATING YOUR REDONDO RS

---

## GENERAL OPERATION

### Power On/Off

Press the left-front knob (#1) to turn the unit on.

RETRO SOUND will appear on the screen.

Press and hold the left-front knob (#1) to turn the unit off.

GOODBYE will appear on the screen to confirm that it has turned off.

### Volume

Rotate the left-front knob (#1) to adjust the volume between 0-46.

### Mode

Rotate the left-rear knob (#2) clockwise to select from available listening sources: RADIO, AUX 1, AUX 2, USB 1, USB 2, BT AUDIO.

**NOTE: The USB source modes will not appear unless a USB device is plugged in.**

The auxiliary and USB inputs are located at the back of the radio body. The auxiliary inputs may be used to play music from any portable device with a standard headphone output, such as a MP3 player, iPod® or iPhone®, portable CD player or portable satellite radio receiver. The USB inputs allow you to control your iPod®/ iPhone® or play music from a flash drive. To use these inputs, the cables must be routed to an accessible area during installation.

### Radio Tuning

Rotate the right-front knob (#8) to tune to the next or previous AM/FM frequency.

**NOTE: When the radio is tuned to a strong stereo FM station, the stereo indicator will appear on the upper right corner of the LCD screen (two oval circles).**

# OPERATING YOUR REDONDO RS

---

## Radio Bands

Turn the right-rear knob (#9) counter-clockwise to toggle through five radio bands (two AM and three FM).

## Storing Radio Presets

There are six radio presets for each radio band. For presets one through five, tune to the desired radio station and then press and hold the appropriate push-button (#3-7) to store into memory. To store preset number six, tune to the station you want to store, then rotate and hold right-rear knob clockwise to store.

## Selecting Radio Presets

To recall radio presets, press the appropriate push-button (#3-7) in the selected radio band. To recall preset six, rotate the right-rear knob (#9) clockwise and release it.

## Mute/Unmute

Press the right-front knob (#8) to mute or unmute the radio.

## STONE CONTROLS

The Stone Controls sub-menu allows advanced tonal adjustments, balance and fader controls and preset equalizer options. To access this sub-menu, press the left-front knob (#1). Repeatedly press the left-front knob (#1) to cycle through the available options. To adjust within the sub-menu, rotate the left-front knob (#1) clockwise or counter-clockwise.

### Digital Signal Processor (DSP)

This sub-menu toggles the Digital Signal Processor (DSP) on and off. Factory default is **DSP OFF**. Activating DSP allows you to choose one of three preset equalization settings:

- **CLASSIC** This setting offers subtle sonic adjustments that lend themselves to classical music.
- **POP** This setting accentuates bass and treble frequencies and is suitable for popular music.
- **ROCK** This setting accentuates treble frequencies and is suitable for rock music.

### Bass

This sub-menu (**BASS**) adjusts bass tones. You may boost or cut low frequencies from +7 to -7.

### Middle

This sub-menu (**MIDDLE**) adjusts mid tones. You may boost or cut mid frequencies from +7 to -7.

### Treble

This sub-menu (**TREBLE**) adjusts treble tones. You may boost or cut high frequencies from +7 to -7.

# OPERATING YOUR REDONDO RS

---

## Balance

This sub-menu (**BAL**) adjusts the stereo balance to the left or the right. This may be helpful in compensating for the position of the driver in relation to the vehicle's speakers. Adjustment range is from 0-12 between the left and right speakers.

## Fader

This sub-menu (**FADER**) adjusts the sound between the front and rear speakers. Adjustment range is from 0-12 between front and rear speakers.

## XBAS

This sub-menu (**XBAS**) boosts bass and treble for listening at low volumes. This should only be used at low volume levels and should be set to **XBAS OFF** at higher volumes.

## Subwoofer ON/OFF\*

This sub-menu (**SUB**) toggles the subwoofer RCA output on or off.

## Subwoofer Volume\*

This sub-menu (**SUB VOL**) adjusts the volume of the subwoofer between 0-12.

## Subwoofer Crossover Frequency\*

This sub-menu (**SUB FREQ**) adjusts of the frequency crossover point of the subwoofer between 80Hz, 120Hz or 160Hz.

## Bass Crossover Frequency

This sub-menu (**BAS FREQ**) adjusts of the frequency crossover of the bass-tones between 60Hz, 80Hz, 100Hz or 200Hz.

\*The Subwoofer sub-menus will only appear when a subwoofer is attached and **SUB ON** is selected in the Subwoofer menu.



# OPERATING YOUR REDONDO RS

---

## Middle Crossover Frequency

This sub-menu (**MID 1.0K**) adjusts of the frequency crossover of the mid-tones between 0.5KHz, 1.0KHz, 1.5KHz or 2.5KHz.

## Treble Crossover Frequency

This sub-menu (**TRE 10.0K**) adjusts of the frequency crossover of the treble-tones between 10.0KHz, 12.5KHz, 15.0KHz or 17.5KHz.

## SYSTEM SETTINGS

The System Settings sub-menu enables access to numerous additional features of your radio. Press and hold the right-front knob (#8) for three seconds to access the System Settings sub-menu. Then repeatedly press the right-front knob (#8) to cycle through the available sub-menu options. Once in a specific sub-menu, rotate the right-front knob (#8) either clockwise or counter-clockwise to adjust options.

### Auto Seek/Manual

This sub-menu toggles between **AUTO SEEK** or **MANUAL** tuning when listening to the radio. In Auto Seek mode, the radio will tune to the next available station when tuning.

### A Store

This sub-menu will automatically fill all radio presets on all radio bands of six presets each with the strongest stations. To activate this feature, once in the system settings, press the right-front knob (#8) until **A STORE** appears on the screen. Then press the left-front knob (#1) to activate. This process can take up to sixty seconds.

# OPERATING YOUR REDONDO RS

---

## Local/Distant

This sub-menu changes the sensitivity of the FM tuner. When listening to the FM tuner, selecting between **LOCAL** and **DISTANT** can aid in listening to weak FM stations or compensate for stations with a signal that is too strong.

## Clock

This sub-menu sets the clock. To adjust the hours, rotate the right-front knob (#8). Adjusting past 12 will toggle the AM/PM indicators. Once the hour is set, press the right-front knob (#8) to adjust the minutes. Once the minutes are set, press the right-front knob (#8) to access the 12/24 menu.

## Clock 12/24

This sub-menu adjusts the clock from a twelve-hour clock to a twenty-four hour clock. The factory default setting is for a twelve hour clock (**CLK 12**).

## Display Frequency/Clock

This sub-menu adjusts the priority screen view between radio frequency (**DISP FREQ**) and clock (**CLK**).

## Clock ON/OFF

This sub-menu toggles the clock off when the radio is off. Default is **CLK ON**.

## Beep ON/OFF

This sub-menu toggles the audible beep confirmation that sounds during operation of the radio. Select **BEEP ON** to hear the audible beep, and **BEEP OFF** to disable the audible beep.

## Display Color (SCAN)

This sub-menu changes the display color. The default setting is **SCAN**, which will scan through all of the available colors. To customize your display color, look for the word **SCAN** in the sub-menu (if a custom color has already been chosen, look for that color name in the sub-menu), then rotate the right-front knob (#8) to select one of the preset colors: **WHITE, GREEN 1, GREEN 2, GREEN 3, ORANGE, RED, PINK, PURPLE 1, PURPLE 2, BLUE 1, BLUE 2, USER, SCAN**.

To create a custom color, select **USER** in the preset color menu, then press the right-front knob (#8) once. This will allow you to edit the RGB values for 32,000 color variations. Rotate the right-front knob (#8) to adjust the reds, then press the same knob (#8) to move to the greens. Repeat this process to adjust the greens and the blues.

**NOTE:** If you lower all RGB settings down to "00" the display will go black, and you will need to reset the radio by disconnecting all power from the unit for 2 minutes. This will reset your radio back to the factory defaults.

## Dimmer

This sub-menu adjusts the radio's display brightness between high (**DIMM HIGH**), mid (**DIMM MID**) and low (**DIMM LOW**).

## Bluetooth® ON/OFF (BT)

This sub-menu toggles Bluetooth® on or off. Bluetooth® must be enabled in order to connect a Bluetooth® device for hands-free operation or streaming audio.

## Bluetooth® Connect/Disconnect

This sub-menu enables the radio to be discoverable on your Bluetooth® device. Choose **BT CONNEX** to allow your device to connect, and **BT DISCON** to disable Bluetooth® connections. To connect your device, choose **BT CONNEX**, then search for "RETROSOUND" in your phone's Bluetooth® device list. Enter password "0000" if prompted.

# OPERATING YOUR REDONDO RS

---

## Radio Data System (RDS) ON/OFF

This sub-menu toggles the RDS function on or off. The default is **RDS ON**.

RDS tuners can automatically tune in stations according to the genre they broadcast. Some RDS tuners can even break in with traffic alerts or emergency broadcasts.

RDS enables your receiver to display text messages (usually call letters and format info) that many FM stations include on a sub-carrier signal within their normal broadcast signal.

The RDS function is always active, and if the FM station you are listening to is broadcasting RDS information, the radio station call letters, song info, artist info and other messages will appear. Not all FM stations use RDS nor will all RDS functions work in every location.

## Program Type (PTY)

This sub-menu enables you select up to 31 predefined program types allowing you to find similar programming by genre.

To change your program type, cycle through the sub-menu system until you see **PTY**. Now press the left-front knob (#1) to activate, then rotate the right-front (#8) knob to select from the program type list. Press the left-front knob (#1) and your selection will be enabled.

Now you will see **PTY SEEK** on the screen which indicates that the radio is searching the FM band for stations with your selected program type. If none are found, it will revert back to the last station selected.

## Alternative Frequency (AF) ON/OFF

This sub-menu enables the radio to automatically search for another frequency that provides the same station when the signal gets weak.

## Traffic Announcements (TA) ON/OFF

This sub-menu toggles the traffic announcements function on or off. The traffic announcements function is part of RDS and allows FM stations to broadcast traffic announcements that scroll across the screen or audible traffic alerts to your radio. Rotate the knob to choose between **TR ON** or **TR OFF** and allow the display to time out to enable your choice.

## Clock Time (CT) ON/OFF

This sub-menu toggles the clock time feature on or off. If the radio station supports clock time, your radio will synchronize its clock with the radio station's clock.

## Area USA/EUR/AUS/JAP/RUS

Redondo has the capability to receive radio broadcasts from around the world. This sub-menu enables you to adjust to broadcasts in your country. Factory default setting is United States (**USA**). Rotate the right-front knob (#8) to toggle between Europe (**EUR**), Australia (**AUS**), Japan (**JAP**) and Russia (**RUS**). To confirm the change, pause to let the sub-menu revert to your tuner. You will see your selected tuner mode: **AREA USA**, **AREA EUR**, **AREA AUS**, **AREA JAP**, **AREA RUS**.

## Volume Last/Adjust

This sub-menu adjusts the volume level at which the radio first turns on. The factory default setting is **VOL LAST**, which sets the turn on volume at the last volume used. **VOL ADJUST** allows you to preset the volume at which the radio first turns on from 0-46.

# OPERATING YOUR REDONDO RT

---

## BASIC OPERATION

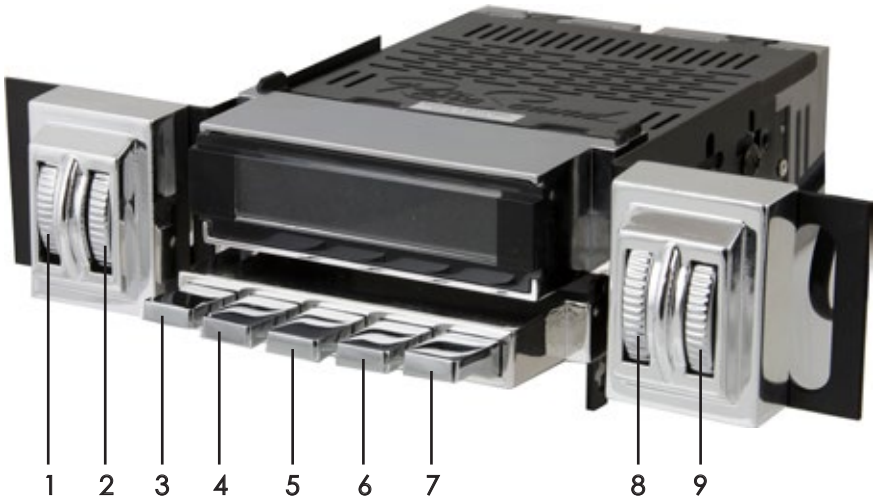

Figure 12 - Front Panel Controls

1. Left Outside Thumb-Roller
2. Left Inside Thumb-Roller
3. Push-Button
4. Push-Button
5. Push-Button
6. Push-Button
7. Push-Button
8. Right Inside Thumb-Roller
9. Right Outside Thumb-Roller



Figure 13 - Thumb-Rollers

## GENERAL OPERATION

### Power On/Off

Press the left inside thumb-roller (#2) to turn the unit on.

RETRO SOUND will appear on the screen.

Press the left inside thumb-roller (#2) to turn the unit off.

GOODBYE will appear on the screen to confirm that it has turned off.

### Volume

Rotate the left outside thumb-roller (#1) up or down to adjust the volume between 0-46.

### Mode

Rotate the left inside thumb-roller (#2) down to select from available listening sources: RADIO, AUX 1, AUX 2, USB 1, USB 2, BT AUDIO.

(The USB source modes will not appear unless a USB device is plugged in).

The auxiliary and USB inputs are located at the back of the radio body. The auxiliary inputs may be used to play music from any portable device with a standard headphone output, such as a MP3 player, iPod® or iPhone®, portable CD player or portable satellite radio receiver. The USB inputs allow you to control iPod®/iPhone® or play music from a flash drive. To use these inputs, the cables must be routed to an accessible area during installation.

# OPERATING YOUR REDONDO RT

---

## Radio Tuning

Rotating the right outside thumb-roller (#9) up or down will seek the next or previous strong AM/FM frequency.

To enable manual tune mode, rotate and hold the right outside thumb-roller (#9) up or down for a couple seconds. The radio station will flash on the display. Now you can rotate the right outside thumb-roller (#9) up or down to manually tune.

**NOTE:** When the radio is tuned to a strong stereo FM station, the stereo indicator will appear on the upper right corner of the LCD screen (two oval circles).

## Radio Bands

Rotate the right inside thumb-roller (#8) up to toggle through five radio bands (two AM and three FM).

## Storing Radio Presets

There are six radio presets for each radio band. For presets one through five, tune to the desired radio station and then press and hold the appropriate push-button (#3-7) to store into memory. To store preset number six, tune to the station you want to store, then rotate the right inside thumb-roller (#8) down and hold to store.

## Selecting Radio Presets

To recall radio presets, press the appropriate push-button (#3-7) in the selected radio band. To recall preset six, rotate the right inside thumb-roller (#8) down to select preset number six.

## Mute

Press the right inside thumb-roller (#8) to mute or unmute.



## STONE CONTROLS

The Stone Controls sub-menu enables advanced tonal adjustments, balance and fader controls and the preset equalizer options. To access this sub-menu, press the left outside thumb-roller (#1). Keep pressing the left outside thumb-roller (#1) to cycle through the available options. To adjust within the sub-menu, rotate the left outside thumb-roller (#1) up or down.

### Digital Signal Processor (DSP)

This sub-menu toggles the Digital Signal Processor (DSP) on and off. Factory default is **DSP OFF**. Activating DSP allows you to choose one of three preset equalization settings:

- **CLASSIC** This setting offers subtle sonic adjustments that lend themselves to classical music.
- **POP** This setting accentuates bass and treble frequencies and is suitable for popular music.
- **ROCK** This setting accentuates treble frequencies and is suitable for rock music.

### Bass

This sub-menu (**BASS**) adjusts bass-tones. You may boost or cut low frequencies from +7 to -7.

### Middle

This sub-menu (**MIDDLE**) adjusts mid-tones. You may boost or cut mid frequencies from +7 to -7.

### Treble

This sub-menu (**TREBLE**) adjusts treble-tones. You may boost or cut high frequencies from +7 to -7.

# OPERATING YOUR REDONDO RT

---

## Balance

This sub-menu (**BAL**) adjusts stereo sound to the left or right. This may be helpful in compensating for the position of the driver in relation to the vehicle's speakers. Adjustment range is from 0-12 between the left and right speakers.

## Fader

This sub-menu (**FADER**) adjusts the sound between the front and rear speakers. Adjustment range is from 0-12 between the front and rear speakers.

## XBAS

This sub-menu (**XBAS**) boosts bass and treble for listening at low volumes. This should only be used at low volume levels and should be set to **XBAS OFF** at high volumes.

## Subwoofer ON/OFF\*

This sub-menu (**SUB**) toggles the subwoofer RCA output on or off.

## Subwoofer Volume\*

This sub-menu (**SUB VOL**) adjusts the volume of the subwoofer between 0-12.

## Subwoofer Crossover Frequency\*

This sub-menu (**SUB FREQ**) adjusts the frequency crossover point of the subwoofer between 80Hz, 120Hz or 160Hz.

## Bass Crossover Frequency

This sub-menu (**BAS FREQ**) adjusts the frequency crossover of the bass-tones between 60Hz, 80Hz, 100Hz or 200Hz.

\*The Subwoofer sub-menus will only appear when a subwoofer is attached and **SUB ON** is selected in the Subwoofer menu.

# OPERATING YOUR REDONDO RT

---

## Middle Crossover Frequency

This sub-menu (MID 1.0K) adjusts the frequency crossover of the mid-tones between 0.5KHz, 1.0KHz, 1.5KHz or 2.5KHz.

## Treble Crossover Frequency

This sub-menu (TRE 10.0K) adjusts the frequency crossover of the treble-tones between 10.0KHz, 12.5KHz, 15.0KHz or 17.5KHz.

## SYSTEM SETTINGS

The System Settings sub-menu enables access to numerous additional features of your radio. Press the right outside thumb-roller (#9) to access the System Settings sub-menu. Then repeatedly press the right outside thumb-roller (#9) to cycle through the available sub-menu options. Once in a specific sub-menu, rotate the right outside thumb-roller (#9) up or down to adjust options.

### Auto Seek/Manual

This sub-menu item is not used on Redondo RT.  
For instructions on tuning your radio see page 31.

### A Store

This sub-menu will automatically fill all radio presets on all radio bands of six presets each with the strongest stations. To activate this feature, press the right outside thumb-roller (#9) until A STORE appears on the screen. Then press the left outside thumb-roller (#1) to activate. This process can take up to sixty seconds.

# OPERATING YOUR REDONDO RT

---

## Local/Distant

This sub-menu changes the sensitivity of the FM tuner. When listening to the FM tuner, selecting between **LOCAL** and **DISTANT** can aid in listening to weak FM stations or compensate for stations with a signal that is too strong.

## Clock

This sub-menu sets the clock. To adjust the hours, rotate the right outside thumb-roller (#9) up. Adjusting past 12 will toggle the AM/PM indicators. Once the hour is set, press the same thumb-roller (#9) again to adjust the minutes in the same way. Once the minutes are set, press the same thumb-roller (#9) to access the 12/24 menu.

## Clock 12/24

This sub-menu adjusts the clock from a twelve hour clock to a twenty-four hour clock. The factory default setting is for a twelve hour clock (**CLK 12**).

## Display Frequency/Clock

This sub-menu adjusts the priority screen view between radio frequency (**DISP FREQ**) and clock (**CLK**).

## Clock ON/OFF

This sub-menu toggles the clock off when the radio is off. Default is **CLK ON**.

## Beep ON/OFF

This sub-menu toggles the audible beep confirmation that sounds during operation of the radio. Select **BEEP ON** to hear the audible beep, and **BEEP OFF** to disable the audible beep.

# OPERATING YOUR REDONDO RT

---

## Display Color (SCAN)

This sub-menu changes the display color. The default setting is **SCAN**, which will scan through all of the available colors. To customize your display color, look for the word **SCAN** in the sub-menu (if a custom color has already been chosen, look for that color name in the sub-menu), then rotate the right outside thumb-roller (#9) to select one of the preset colors: **WHITE, GREEN 1, GREEN 2, GREEN 3, ORANGE, RED, PINK, PURPLE 1, PURPLE 2, BLUE 1, BLUE 2, USER, SCAN**.

To create a custom color, select **USER** and press the right outside thumb-roller (#9) once. This will allow you to edit the RGB values for 32,000 color variations. Rotate the right outside thumb-roller (#9) up or down to adjust the reds, then press the same thumb-roller (#9) to move to the greens. Repeat this process to adjust the greens and the blues.

**Note:** If you lower all RGB settings down to "00" the display will go black, and you will need to reset the radio by disconnecting all power from the unit for 2 minutes. This will reset your radio back to the factory defaults.

## Dimmer

This sub-menu adjusts the radio's display brightness between high (**DIMM HIGH**), mid (**DIMM MID**) and low (**DIMM LOW**).

## Bluetooth® ON/OFF (BT)

This sub-menu turns Bluetooth® on or off. Bluetooth® must be enabled in order to connect a Bluetooth® device for hands-free operation or streaming audio.

## Bluetooth® Connect/Disconnect

This sub-menu enables the radio to be discoverable on your Bluetooth® device. Choose **BT CONNCT** to allow your device to connect, and **BT DISCON** to disable Bluetooth® connections. To connect your device, choose **BT CONNCT**, then search for "RETROSOUND" in your phone's Bluetooth® device list. Enter password "0000" if prompted.

# OPERATING YOUR REDONDO RT

---

## Radio Data System (RDS) ON/OFF

This sub-menu toggles the RDS function on or off. The default is **RDS ON**.

RDS tuners can automatically tune in stations according to the genre they broadcast. Some RDS tuners can even break in with traffic alerts or emergency broadcasts.

RDS enables your receiver to display text messages (usually call letters and format info) that many FM stations include on a sub-carrier signal within their normal broadcast signal.

The RDS function is always active, and if the FM station you are listening to is broadcasting RDS information, the radio station call letters, song info, artist info and other messages will appear. Not all FM stations use RDS nor will all RDS functions work in every location.

## Program Type (PTY)

This sub-menu enables you select up to 31 predefined program types finding similar programming by genre.

To change your program type, cycle through the sub-menu system until you see **PTY**. Now press the left outside thumb-roller (#1) to activate, then rotate the right outside thumb-roller (#9) to select from the program type list. Press the left outside thumb-roller (#1) and your selection will be enabled.

Now you will see **PTY SEEK** on the screen which indicates that the radio is searching the FM band for stations with your selected program type. If none are found, it will revert back to the last station selected.

## Alternative Frequency (AF) ON/OFF

This sub-menu enables the radio to automatically search for another frequency that provides the same station when the signal gets weak.

## Traffic Announcements (TA) ON/OFF

This sub-menu toggles the traffic announcements function on or off. The traffic announcements function is part of RDS and allows FM stations to broadcast traffic announcements that scroll across the screen or audible traffic alerts to your radio. Rotate the right outside thumb-roller (#9) to choose between **TR ON** or **TR OFF** and allow the display to time out to enable your choice.

## Clock Time (CT) ON/OFF

This sub-menu toggles the clock time feature on or off. If the radio station supports clock time, your radio will synchronize its clock with the radio station's clock.

## Area USA/EUR/AUS/JAP/RUS

Redondo has the capability to receive radio broadcasts from around the world. This sub-menu enables you to adjust to broadcasts in your country. Factory default setting is United States (**USA**). Rotate the right outside thumb-roller (#9) to toggle between Europe (**EUR**), Australia (**AUS**), Japan (**JAP**) and Russia (**RUS**). To confirm the change, pause to let the sub-menu revert to your tuner. You will see your selected tuner mode: **AREA USA**, **AREA EUR**, **AREA AUS**, **AREA JAP**, **AREA RUS**.

## Volume Last/Adjust

This sub-menu adjusts the volume level at which the radio first turns on. The factory default setting is **VOL LAST**, which sets the turn on volume at the last volume used. **VOL ADJUST** allows you to preset the volume at which the radio first turns on from 0-46.

# USB/APPLE® DEVICE INSTRUCTIONS

---

## Connecting a USB/Apple® Device

The USB 1 and USB 2 inputs are located at the rear of the radio body. The USB cables must be routed to a convenient and accessible location for plugging in USB devices.

Once you've turned on your radio and connected your flash drive, iPod®/iPhone® or supported USB device to one of the USB inputs, the radio will display **USB 1** or **USB 2** for three seconds. Then the radio will automatically find your songs and begin playing them.

The  icon appears on the lower part of the display during USB playback.

## About MP3/WMA Files

MP3 (MPEG Audio Layer-3) and WMA (Windows Media Audio) is a format for compressed audio files. When your radio is in USB mode (USB 1 or USB 2), you can play MP3 and unprotected (no DRM) WMA files on a flash drive.

### Common facts about these compressed-sound formats:

- High bit rate and high sampling frequencies are recommended for high sound quality.
- Selecting VBR (Variable Bit Rate) is not recommended because playing time is not displayed properly and there may be some audible skipping artifacts. The playback sound quality differs depending on the encoding circumstances. For details, refer to the user manual of your encoding software.
- When adding MP3 files to your flash drive, it is recommended to set the bit rate to "fixed" at 128 kbps or better.
- When adding WMA files to your flash drive, it is recommended to set the bit rate to "fixed" at 64 kbps. Do not set the copy protect attribute on the WMA file or you will not be able to play the track.
- Redondo will read only FAT32 formatted flash drives. This radio will NOT read NTFS formatted drives.
- Redondo will read files placed in the root directory first before playing files in the folder structure of the drive.
- Redondo will play your MP3 or WMA files in the same order that you copy them to your USB device – the files copied first will play first.



# USB/APPLE® DEVICE INSTRUCTIONS

---

Caution! Except for private use, duplicating audio data (including MP3/WMA) or distributing, transferring or copying it, whether free or paid for without permission of the original copyright holder is strictly prohibited by law and international treaty.

## Viewing MP3/WMA Song Information

When playing MP3/WMA files from the USB source, you can view the track name, album name and artist (ID-3) information automatically from these files. Once the USB drive is inserted, the following info will scroll across the screen in the following order: **F-DIR** (folder directory), **MP3 FILE** (file name of song), **ALBUM** (name of album) **ARTIST** (name of artist), **SONG** (name of song).

To cycle through the ID-3 information on-screen, rotate the left-rear knob (#2) counter-clockwise (Redondo RS) or rotate the left inside thumb-roller (#2) up (Redondo RT). The ID-3 information will time out after a few seconds and will revert to the default ID-3 information.

To access the clock when in USB mode, rotate the left-rear knob (#2) counter-clockwise or rotate the left inside thumb-roller (#2) up until the clock appears. The clock will time out after a few seconds and will revert to the default ID-3 information.

**NOTE:** Not all music software handles ID-3 information the same way. Some software will produce MP3 files with ID-3 information that is not readable by Redondo. If this occurs, you may need to use a converter or ID-3 editor to change the ID-3 information for the artist, album and song information to display properly on Redondo.

# USB/APPLE® DEVICE INSTRUCTIONS

---

## USB Playback Mode

The preset buttons on the front of the radio's control face (#3-7) will enable you to play/pause, listen to 10 seconds of each song (INT), repeat the track you're listening to (RPT), randomly shuffle all songs from a USB flash drive (RDM), and navigate folders.

To play or pause, press button (#3).

To activate/deactivate scan, press button (#4).

To activate/deactivate shuffle, press button (#5).

To go to the previous folder, press button (#6).

To go to the next folder, press button (#7).

To switch to the next song, rotate the right-front knob (#8) clockwise (Redondo RS) or rotate the right outside thumb-roller (#9) up (Redondo RT).

To switch to the previous song, rotate the right-front knob (#8) counter-clockwise or rotate the right outside thumb-roller (#9) down.

You can cycle through the folders while seeing the folder names. To do this, rotate the right-rear knob (#9) counter-clockwise or rotate the right inside thumb-roller (#8) up to see the folder name, then cycle through the folders by using the right-front knob (#8) or right outside thumb-roller (#9). Press the right-front knob (#8) or right inside thumb-roller (#8) to select a folder.

To activate/deactivate repeat, turn the right-rear knob (#9) clockwise or rotate the right inside thumb-roller (#8) down.

# BLUETOOTH® DEVICE INSTRUCTIONS

---

## BLUETOOTH® INSTRUCTIONS

### Bluetooth® Hands-Free and A2DP Streaming Operation

You can make and receive phone calls using a Bluetooth® enabled phone connected to your radio, controlling basic functions via the radio interface. When a call comes in, the radio music source will be muted, and the call will broadcast through your car's speaker system. You can also listen to music stored on a A2DP enabled Bluetooth® device.

### Pairing a Bluetooth® Device

When connecting a Bluetooth® device for the first time, you must first pair the device with the unit. For most devices, pairing only needs to be done once.

To pair your device first make sure the Bluetooth® function is turned on in the radio sub-menu. Then, change the **BT DISCOV** function to **BT CONNED** to make your radio discoverable (ensure Bluetooth® is enabled on your device). Now search for a new Bluetooth® device from the phone (this may take up to 30 seconds) and select "RETROSOUND" from the Bluetooth® device list. If prompted, enter "0000" for the PIN. If successful, "PAIRING OK" will be displayed on the LCD screen. The paired device will then connect to radio automatically.

On some devices, you may need to select "SET AS AUTHORIZED" (or similar) to ensure your radio will automatically pair on future usage.

**PAIRED NOTIFICATION DISPLAY:** When the Bluetooth® device is paired with your radio, the Bluetooth® icon will appear on the LCD screen. This will occur whenever you use the system while the paired device is within range.

### Making and Receiving Calls

To answer a phone call, rotate the left-rear knob (#2) counter-clockwise or rotate the left inside thumb-roller (#8) up. To place a call, simply dial the number on your cell phone, and the call will broadcast to your radio. To hang up, rotate the left-rear knob (#2) counter-clockwise again or rotate the left inside thumb-roller (#2) down.

# TROUBLESHOOTING

---

Problem	Possible Cause	Action to Solve Problem
Radio will not turn on (no lights, no sound)	12 volt Batt+ wire is not connected or is receiving incorrect voltage	Check all connections for proper voltage with a volt meter. Voltage range: 12-15 volts
	+12 volt accessory wire is not connected or receiving incorrect voltage	Check the +12 volt accessory wire connection
	Ground wire not connected	Check the ground connection
	Fuse on Batt+ is blown	Replace the blown fuse
No sound heard from unit but unit lights up	Volume may be turned all the way down or muted	Turn the volume up or unmute
	Internal amp is in protection mode	Check the speaker leads for any grounded or shorted wires
	Wrong source mode selected	Make sure the unit is in the desired source mode (RADIO, AUX 1, AUX 2, USB 1, USB 2, BT AUDIO)
Unit blows fuses	Possible short in wiring	Incorrect fuse used. Make sure only fuses with correct 15 amp ratings are used and check all wiring connections for possible short
	Battery is hooked up backwards	Make sure the battery is properly connected
USB Error	Invalid media / device type	Please review page 39 for which formats and devices are acceptable for playback

## System Reset

To restore/reset the unit to factory defaults, remove all power from the unit, wait 5 minutes and then reconnect power.

# FREQUENTLY ASKED QUESTIONS

---

## **Do your radios work on 6 volt systems or on positive ground systems?**

No. Our radios are 12 volt, negative ground only. After-market converters and inverters are available but must have at least 10 amps of continuous output.

## **I'm having problems getting the radio to turn on.**

RetroSound® radios require 12 volts to both power leads. The red lead (+12 volt accessory) goes to a switched power source, and the yellow to a constant +12 volt power source. Using a volt meter, check the voltage when the key is turned from "off" to "on." If there is a significant drop in the voltage, the circuit that the yellow lead is attached to cannot handle the additional draw of the radio. You will need to find another circuit that can handle the additional draw of the radio, or you will need to go directly to the battery.

## **What size speaker wire do you recommend I use?**

We recommend using 16 gauge wire for the speakers.

## **I have all 4 speakers connected to the radio, and the display is lit up like it is working. But there's no sound coming out.**

This usually indicates one of two things:

- The speaker wires may be touching each other or the vehicle chassis at some point. Check each speaker lead from radio to speaker.
- The speaker impedance may be below 4 ohms. Older speakers are usually not compatible with modern electronics.

A full line of compatible speakers are available on our website [www.retromanufacturing.com](http://www.retromanufacturing.com).

# FREQUENTLY ASKED QUESTIONS

---

**My car originally came with a switch to control my automatic antenna. Can I use the RetroSound® radio's remote antenna wire to control my antenna?**

No you cannot. Your factory antenna is known as "semi-automatic." It requires a switch to either extend or retract the antenna. You must retain this switch to control your antenna. The RetroSound® radio's power antenna wire is for more modern "fully-automatic" antennas not requiring a separate switch. Compatible fully-automatic antennas are available on our website [www.retromanufacturing.com](http://www.retromanufacturing.com).

**The sound output is all mid-range, with very little bass and a strangled-sounding upper range. What is wrong?**

One of your speaker wires is connected backwards. This is called being "out of phase." Check to make sure positive is wired to positive and negative to negative on all your speakers.

**Will cutting or bending the InfiniMount brackets void the warranty or harm the unit?**

No. The patented RetroSound® InfiniMount bracket system has been designed specifically to be bent, cut and modified to simplify radio installation. Modification to the radio's brackets is actually encouraged to ensure proper fit.

If you have questions about modifying the bracket system, contact us at [tech@retromanufacturing.com](mailto:tech@retromanufacturing.com) or call us at 888.325.1555.

**How much should I tighten the shaft nuts when installing the brackets and mounting the radio to the dash?**

**DO NOT OVERTIGHTEN** the shaft nuts. The shaft nuts are **NOT** designed to secure the radio to the dash. There is a backstrap included which works with the shaft nuts to secure the radio to the dash. Overtightening the shaft nuts could break the shafts. Retro Manufacturing, LLC will not be responsible for broken shafts due to overtightening of the shaft nuts.

# FREQUENTLY ASKED QUESTIONS

---

**I have your radio with an amplifier connected but hear a whining/buzzing sound through the speakers when I step on the accelerator. Why?**

If you have an external amplifier installed and experience a high-pitched noise that varies with the engine's RPM, there are many possible solutions:

- Make sure the amplifier's gain controls are not turned all the way up. Amplifiers amplify everything, including noise.
- Try grounding the amplifier closer to where it is installed.
- Try a filter on the amplifier's 12 volt power lead. Make sure to use a filter that includes a ground wire.
- On rare occasions, noise can be introduced through the antenna lead. If disconnecting the antenna makes the noise go away, you need to replace or repair the antenna plug where it goes into the radio.

**When I plug in my flash drive, the screen says **USB ERR**, and it won't play the files I placed on the drive. Why?**

- Make sure the files on the drive are .mp3 or unprotected .wma (Windows Media Audio) files. iTunes files are .m4a format and need to be converted to .mp3 format – which can easily be done using iTunes.
- Verify the capacity of the flash drive. Redondo will only play 1gb up to 32gb size flash drives.
- Make sure the flash drive is not NTFS formatted. Always use the FAT32 format (most drives are formatted with FAT32 from the factory). Be sure to do a full format rather than a quick format, and check that none of the files or folders have names longer than 64 characters. It is very important that none of the audio files have DRM. Use only MP3 files or unprotected Windows Media format files.

# SPECIFICATIONS

---

## FM

Tuning Range (USA, EUR, AUS, JAP, RUS tuning capable) with RDS.....	87.5-107.9MHz
Antenna Terminal.....	External Antenna Connector
Usable Sensitivity.....	12.5 dBf
Selectivity.....	75 dB @ 400kHz
Signal to Noise Ratio.....	62 dB (stereo), 67 dB (mono)
Harmonic Distortion @ 1 kHz.....	0.8% (stereo), 0.5% (mono)
Separation.....	32 dB @ 1kHz
Frequency Response.....	30-16,000 Hz

## AM

Tuning Range (USA, EUR, AUS, JAP, RUS tuning capable).....	530-1710 kHz
Antenna Terminal.....	External Antenna Connector

## General

Dimensions (display face).....	3.5" W x 1" H x 2.5" (with mounts) D
Dimensions (push-buttons).....	3.5" W x .5" H
Dimensions (radio body).....	3.96" W x 1.98" H x 4.30" D
Power Requirements.....	10.5-14.4 volts
Current Consumption (during operation).....	Max. 15A
Current Consumption (car off).....	<3.5 mA
Output Power (@ 14.4 volts @ 4 ohm @ 1% THD).....	25x4 watts RMS / 45x4 watts Max Power
Output Impedance.....	4ohm
Low Level Output (4 channels).....	2.85 volts
AUX 1 Input.....	>300 mV / 6 kΩ
AUX 2 Input.....	>300 mV / 6 kΩ
USB 1 Input.....	.5V (USB female input)
USB 2 Input.....	.5V (USB female input)

**NOTE: All specifications are subject to change without notice.**



# LIMITED WARRANTY

## Limited Warranty

If your unit does not work properly because of defects in materials or workmanship, Retro Manufacturing, LLC (collectively referred to as "the warranter") will for the length of the period indicated in the chart below at its option either (a) repair your unit with new or refurbished parts, or (b) replace it with a new or refurbished unit. The warranty period starts with the date of original purchase. The decision to repair or replace will be made by the warranter.

CATEGORIES	PARTS	LABOR
Redondo Radio	Two (2) Years	Two (2) Years

During the "Labor" warranty period, there will be no charge for labor. During the "Parts" warranty period, there will be no charge for parts. You must mail in your unit prepaid during the warranty period. This warranty only applies to products purchased and serviced in the United States or Puerto Rico. This warranty is extended only to the original purchaser of a new product which was not sold "as is."

A purchase receipt or other proof of the original purchase date is required for warranty service.

To handle a warranty issue, contact us at [tech@retromanufacturing.com](mailto:tech@retromanufacturing.com) or 888.325.1555 for a Return Authorization (RA) number. All returns and warranty issues must be accompanied by a Return Authorization number. Any product received without a RA number will be refused.

### LIMITED WARRANTY-LIMITS AND EXCLUSIONS

This warranty ONLY COVERS failures due to defects in materials or workmanship, and DOES NOT COVER normal wear and tear or cosmetic damage. The warranty ALSO DOES NOT COVER damages which occurred during shipment, failures which are caused by products not supplied by the warranter, failures which result from accident, misuse, abuse, neglect, moisture, bug infestation, mishandling, misapplication, alteration, faulty installation, set-up adjustment, maladjustment of consumer control, improper maintenance, improper antenna, inadequate signal reception or pickup, power line surge, improper voltage supply, lightning, modification, commercial use (such as use in hotels, offices, restaurants, or other business uses) or rental use of the product, or service by anyone other than Retro Manufacturing, LLC, or damage that is attributable to acts of God.

THERE ARE NO EXPRESS WARRANTIES EXCEPT AS LISTED UNDER "LIMITED WARRANTY". THE WARRANTER IS NOT LIABLE FOR INCIDENTAL OR CONSEQUENTIAL DAMAGES RESULTING FROM THE USE OF THIS UNIT, OR ARISING OUT OF ANY BREACH OF THIS WARRANTY. (As examples, this excludes damages for lost time, cost of having someone remove or re-install an installed unit if applicable, travel to and from the servicer, and loss of media, data or other memory contents. The items listed are not exclusive, but are for illustration only.) ALL EXPRESS AND IMPLIED WARRANTIES, INCLUDING THE WARRANTY OF MERCHANTABILITY, ARE LIMITED TO THE PERIOD OF THE LIMITED WARRANTY.

Some states do not allow the exclusion or limitation of incidental or consequential damages, or limitations on how long an implied warranty lasts, so the exclusions may not apply to you. This warranty gives you specific legal rights and you may also have other rights which vary from state to state. If a problem with this unit develops during or after the warranty period, you may contact your dealer or Retro Manufacturing, LLC.

# REPLACEMENT PARTS

---

We also make speakers, kick-panels, amplifiers, antennas and accessories. See our full line of products at [www.retromanufacturing.com](http://www.retromanufacturing.com).

If you need replacement parts, contact us at [sales@retromanufacturing.com](mailto:sales@retromanufacturing.com) or call 888.325.1555

(See “What’s in the Box” on page 4 or 5 to confirm the part(s) needed).

**NOTE: If you return a radio to us for credit, any missing parts will be debited.**

## Replaceable Items

- Main Wiring Harness
- Power Wiring Harness
- Speaker Wiring Harness
- Metal Backstrap
- Metal Hardware Pack
- Plastic Washer Kit
- Shafts or Thumb-Rollers
- InfiniMount Brackets (pair)
- InfiniMount Display Face Brackets (pair)
- Knobs
- Display Lenses

## Purchase Notes

Record the place and date of purchase for future reference.

Model No. ....

Serial No. ....

Purchase Date .....

Purchased From .....

Keep this information and your sales receipt in a safe place.

# INSTALLATION NOTES

---

Series of horizontal dotted lines for writing installation notes.

*Retro*<sup>®</sup>  
**MANUFACTURING**

MODERN SOUND FOR YOUR CLASSIC