

ETL 8FT BALLAST BYPASS T8 TUBE

96" long, FA8 & R17d Base, dual end powered 100-277V



SPECIFICATIONS

INPUT VOLTAGE	AC100-277V
PF	>0.9
CRI	>80
LIGHT EFFICIENCY	130-140lm/w
BASE	FA8, R17D, G13
VIEWING ANGLE	180°
THD	<20%
DIMMABLE	No
MATERIAL	Aluminum + PC
OPERATION TEMPERATURE	-68 - 122 °F
ENVIRONMENT	Dry, Damp
RATED LIFETIME	50,000 hours
CERTIFICATION	ETL DLC5.1
CCT	3000K-6500K

CERTIFICATIONS/WARRANTY



ADVANTAGE

- Double-end powered
- FA8/R17d HO base
- F96T8 or F96T12 Replacement
- Bypass Ballast, No ballast needed
- Clear/Striped/Milky Cover are available
- Tubes are rated at 50,000 hours life
- Environmentally friendly without mercury

ACCESSORIES

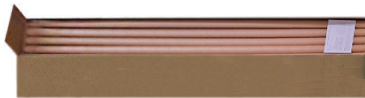

PACKING: PAPER TUBE INDIVIDUAL PACKING

DIMENSION	DIMENSION/ EACH TUBE
8FT	93.90 x 1.19 x 1.30"
PCS/CTN	DIMENSIONS/ ONE CTN
20	94.88 x 7.87 x 6.49"
WEIGHT/ ONE CTN	
34.17lbs	

INSTALLATION

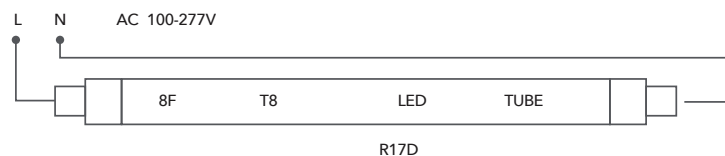
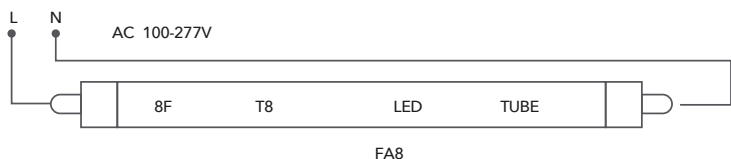

ETL 8FT BALLAST BYPASS T8 TUBE

FA8 & R17D



DIMENSIONS

MAXIMUM DIMENSION	A (INCH)	B (INCH)	C (INCH)	D (INCH)	TUBE DIAMETER
8FT FA8	93.31"	93.89"	1.14"	1.3"	1.19"
8FT R17D	93.31"	93.97"	1.14"	1.3"	1.19"

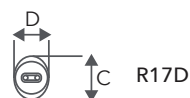
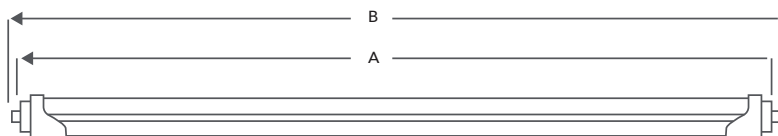
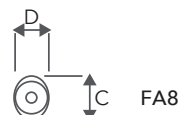
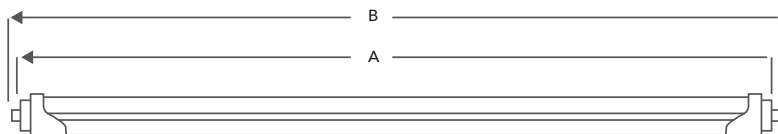

PRODUCT DETAILS

SKU	WATT	BASE	DIFFUSER	LENGTH	DIMMER	DLC5.1	ETL
GT-T88F40W-FA8-FT (4000K)	40W	FA8	Frosted	8FT	Triac	Yes	Yes
GT-T88F40W-FA8-FT (5000K)	40W	FA8	Frosted	8FT	Triac	Yes	Yes
GT-T88F40W-FA8-FT (6500K)	40W	FA8	Frosted	8FT	Triac	Yes	Yes
GT-T88F40W-FA8-CN (4000K)	40W	FA8	Clear	8FT	No	No	Yes
GT-T88F40W-FA8-CN (5000K)	40W	FA8	Clear	8FT	No	No	Yes
GT-T88F40W-FA8-CN (6500K)	40W	FA8	Clear	8FT	No	No	Yes
GT-T88F40W-R17D-FN (4000K)	40W	R17D	Frosted	8FT	No	No	Yes
GT-T88F40W-R17D-FN (5000K)	40W	R17D	Frosted	8FT	No	No	Yes
GT-T88F40W-R17D-CN (4000K)	40W	R17D	Clear	8FT	No	No	Yes
GT-T88F40W-R17D-CN (5000K)	40W	R17D	Clear	8FT	No	No	Yes
GT-T88F40W-R17D-CN (6500K)	40W	R17D	Clear	8FT	No	No	Yes

DATE:	LOCATION:
TYPE:	PROJECT:
CATALOG#:	QTY:
CATALOG#:	QTY: