



# COMMERCIAL HARDWARE

## PRODUCT CATALOGUE

Architectural products inspired by design  
Commercial Hardware Limited



# Table Of Contents

---

Issue 01 – Commercial Hardware Ltd

## Contents

---

|                  |     |
|------------------|-----|
| DOOR HANDLES     | 08  |
| DOOR CLOSERS     | 22  |
| LOCKS            | 32  |
| CYLINDERS        | 50  |
| PANIC HARDWARE   | 58  |
| ACCESS CONTROL   | 66  |
| DOOR HINGES      | 74  |
| BOLTS & LATCHES  | 80  |
| DOOR ACCESSORIES | 86  |
| PATCH FITTINGS   | 96  |
| WINDOW HARDWARE  | 106 |
| JIGTECH          | 118 |



## About Us

**Commercial Hardware is one of the UK's leading suppliers of high-quality architectural ironmongery to both trade and individual customers.**

Since establishing in 2014, we have quickly become trusted suppliers for a wide range of door ironmongery, with all our products being carefully selected by industry specialists.

Whether you are working on a commercial or domestic project, you can rest assured that you'll be able to find the best door hardware directly from us. If there is a specific product which you require that isn't shown in the catalogue, please feel free to get in contact, and our sales team will work around the clock to source the perfect item for your requirements.



### Cost-Effective

We pride ourselves on giving you the best prices on all the name brands.



### High Quality Products

All our products are carefully selected to help ensure you get the best quality products at the right price.



### 24/7 Premium Support

Our support team offer 24/7 around the clock service to help with any advise, issues or enquiries.



### Fast & Safe Delivery

We offer next day delivery on all stock items that are packaged securely and shipped safely to you.

ALL THE  
KNOWN  
BRANDS







## Door Closers

Page 24

## Door Knobs

Page 21



## Hinges

Page 76

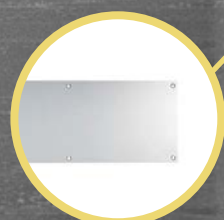

## Kickplates

Page 91

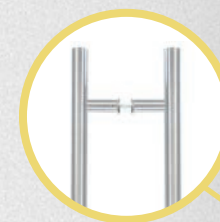

## Pull Handles

Page 12

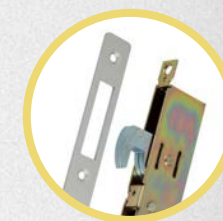

## Hook Locks

Page 34



## Euro Cylinders

Page 57



## Transom Closers

Page 28



## Armsets

Page 29

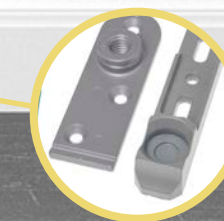

## Bottom pivots

Page 29

**We stock a wide range of door hardware...**

**To suit all your needs.**



# DOOR HANDLES



COMMERCIAL HARDWARE

## Handles

## MEASURING GUIDE

STRAIGHT PULL HANDLE

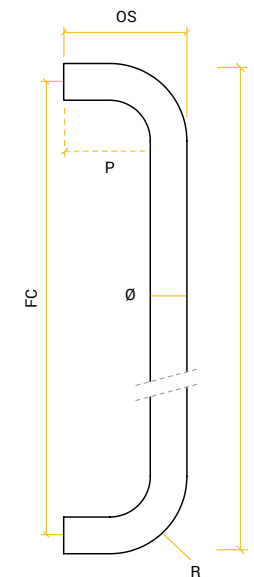

GUARDSMAN PULL HANDLE

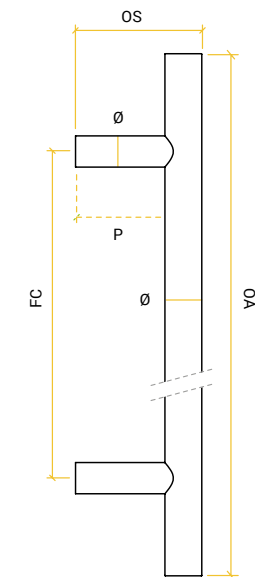

MITRED PULL HANDLE

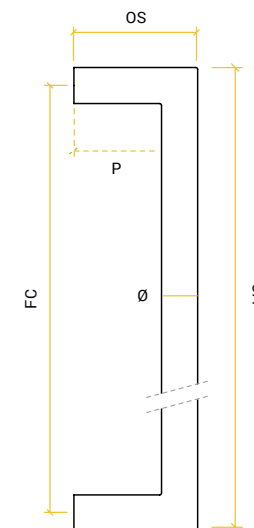

CRANKED PULL HANDLE

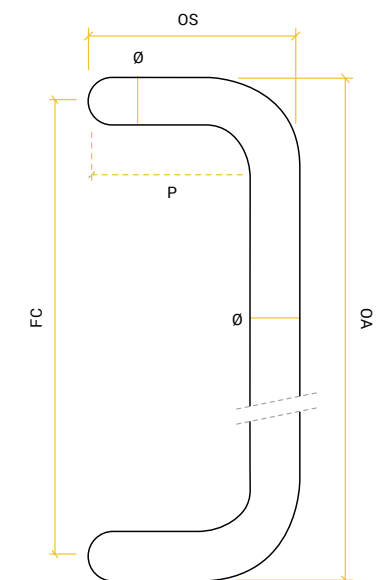

- Fixing Centres - FC
- Overall Length - O/A
- Projection - P
- Offset Size - OS
- Diameter - Ø

Handles

PULL HANDLES

Cranked Back to Back Pull Handles



- Features:
- 300mm c/c x 32mm Ø
  - 425mm c/c x 32mm Ø
  - 600mm c/c x 32mm Ø
  - 900mm c/c x 32mm Ø
  - Bespoke sizes available upon request
  - Satin stainless steel finish
  - Universal fixings for aluminium, composite, glass and timber doors.

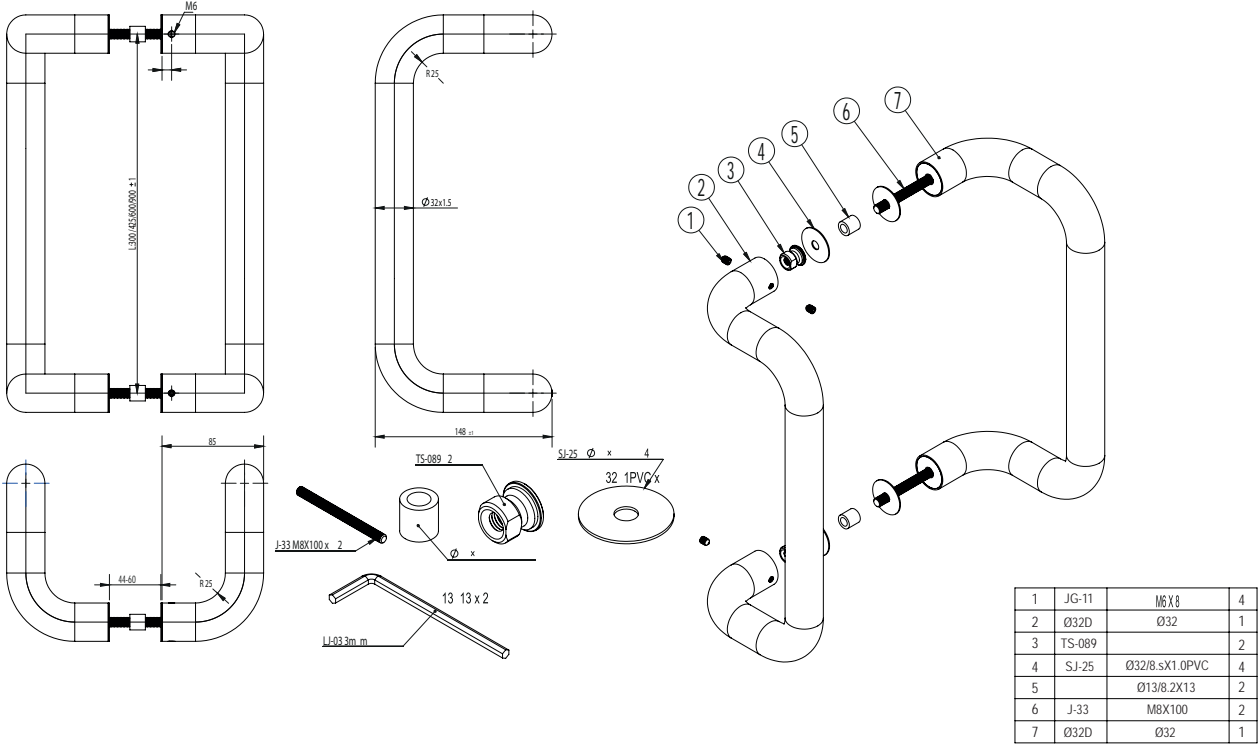

Handles

PULL HANDLES

Semi Circular Back to Back Pull Handles



- Features:
- 300mm c/c x 32mm Ø
  - Bespoke sizes available upon request
  - Satin stainless steel finish
  - Universal fixings for aluminium, composite, glass and timber doors.

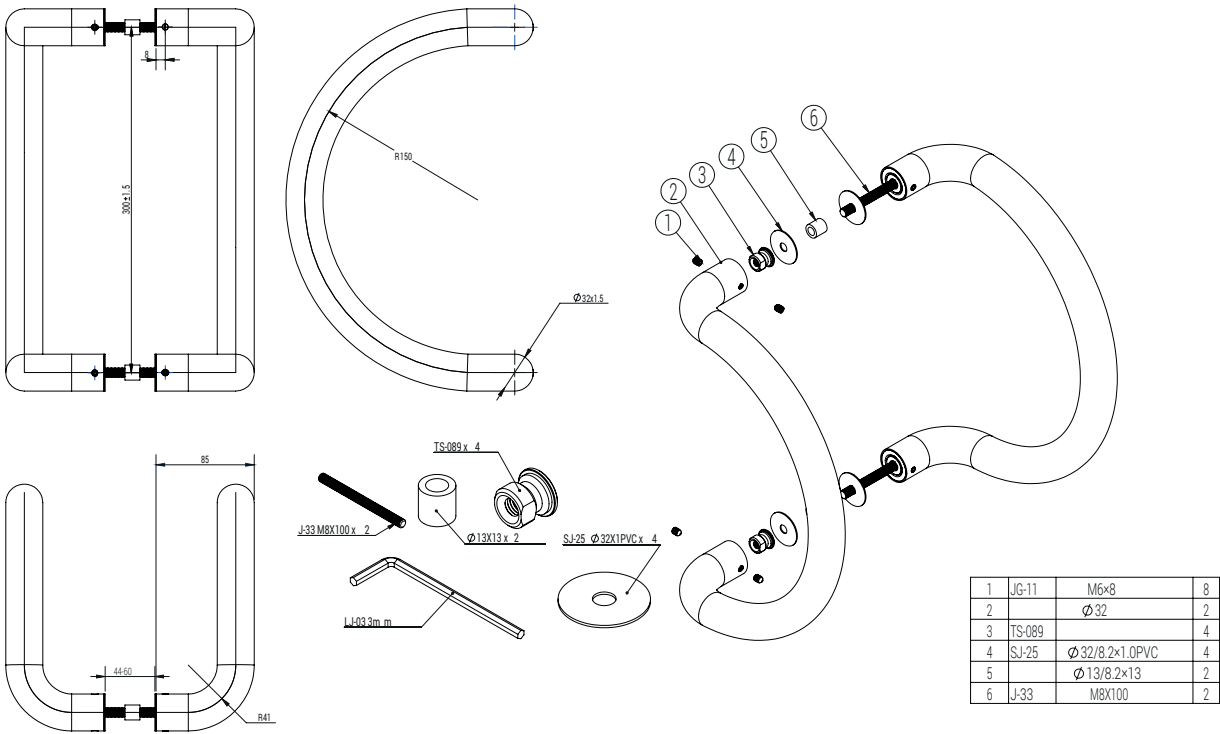

Handles

PULL HANDLES

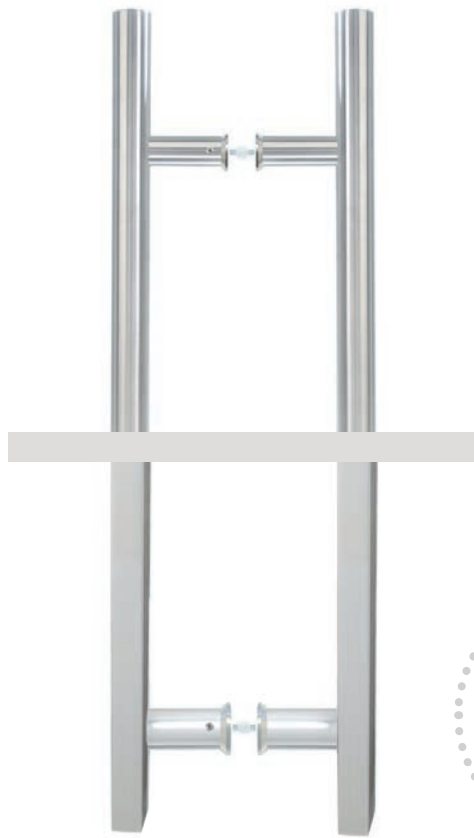

Guardsman T Bar Back To Back Pull Handle

- Features:
- 900mm c/c x 32mm ø
  - Wide range of sizes available upon request
  - Satin stainless steel finish
  - Universal fixings for aluminium, composite, glass and timber doors.



Rectangular version available

Offset pillars version available

|   |        |                 |   |
|---|--------|-----------------|---|
| 1 |        | ø32             | 2 |
| 2 | JG-09  | M6x6            | 8 |
| 3 | TS-089 |                 | 4 |
| 4 |        | Ø 13/8.2x13     | 2 |
| 5 | J-33   | M8x100          | 2 |
| 6 | SJ-23  | Ø 25/8.2x1.0PVC | 4 |

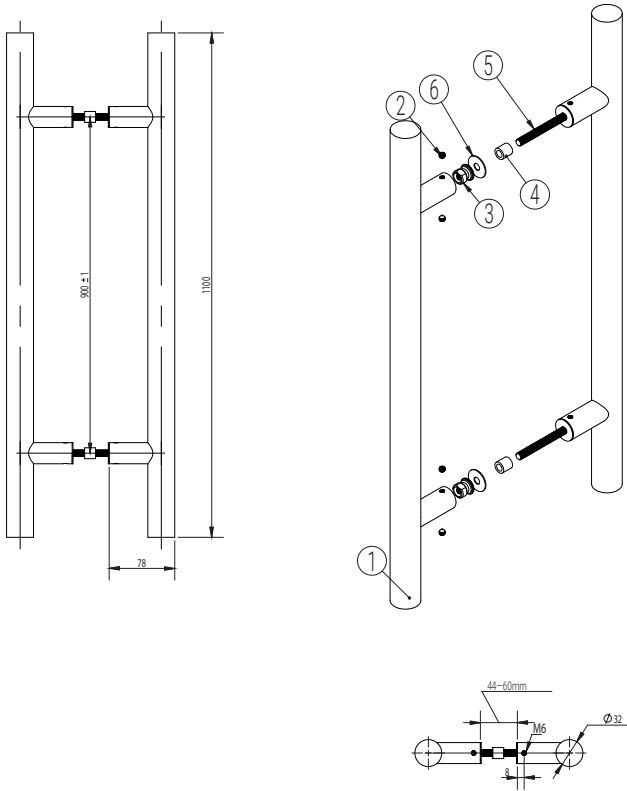
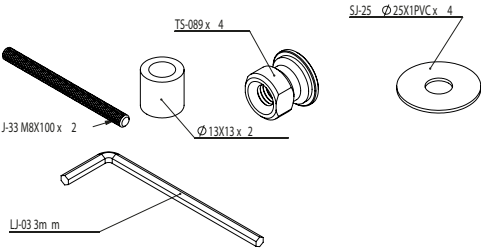

Handles

PULL HANDLES



Full Height Back to Back Pull Handle

- Features:
- Supplied with 3000mm c/c x 38mm ø pole
  - Complete with concealed cranked fixing brackets - To allow poles to be cut down, if required.
  - Satin stainless steel finish.
  - Universal fixings for aluminium, composite, glass and timber doors.



Comes with Cranked Fixing Brackets

|    |       |                 |   |
|----|-------|-----------------|---|
| 1  | B     | Ø 32.5/M8 Ø x10 | 4 |
| 2  | MJ-06 | Ø 35x Ø 7.5     | 8 |
| 3  | A     | Ø 32.5/9 Ø x10  | 8 |
| 4  | N108  | Ø 41/ Ø 38      | 4 |
| 54 | 5*    | AM1350 45 L     | 2 |
| 64 | 5*    | AM1350 45 R     | 2 |
| 7  |       | M8x45           | 4 |

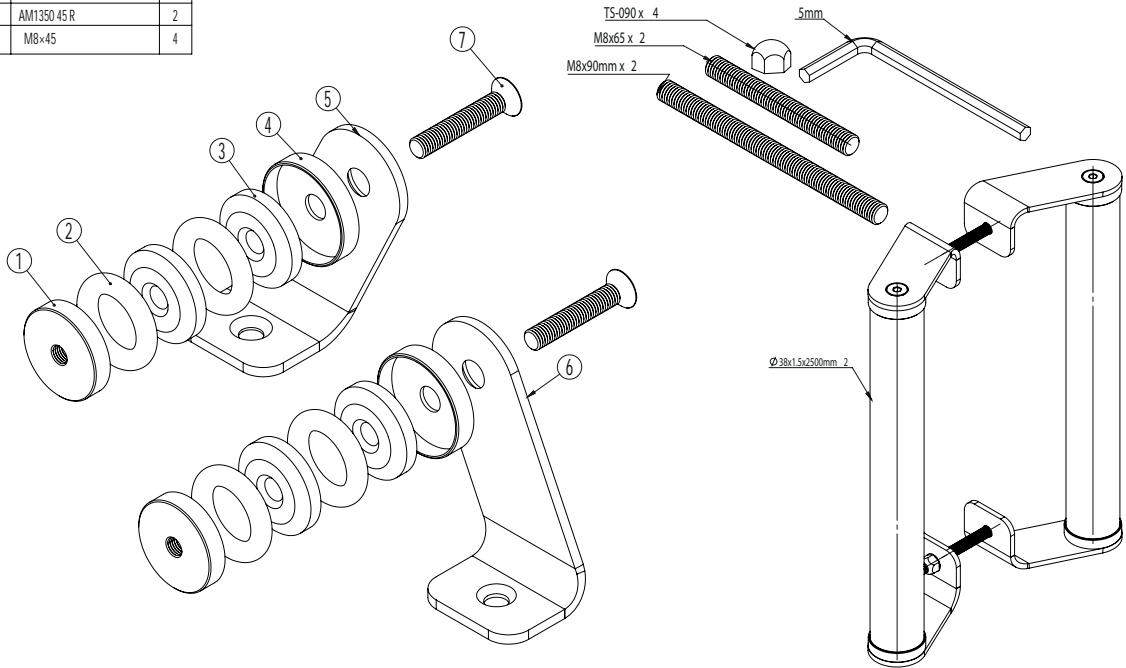



Handles

PULL HANDLES



Straight Pull Handle

Features:

- Standard sizes available & bespoke upon request
- Satin & polished stainless steel finishes
- Universal fixings for aluminium, composite, glass and timber doors.

Finishes:



SSS, PSS



Mitred Pull Handle

Features:

- Standard sizes available & bespoke upon request
- Satin & polished stainless steel finishes
- Universal fixings for aluminium, composite, glass and timber doors.

Finishes:



SSS, PSS

Handles

LEVER HANDLES



Lever Handle & Cam Plug

Features:

- Suits 44mm thick doors
- Cam plug non handed - reversible in the field
- Suitable for aluminium and steel doors

Finishes:



SSA

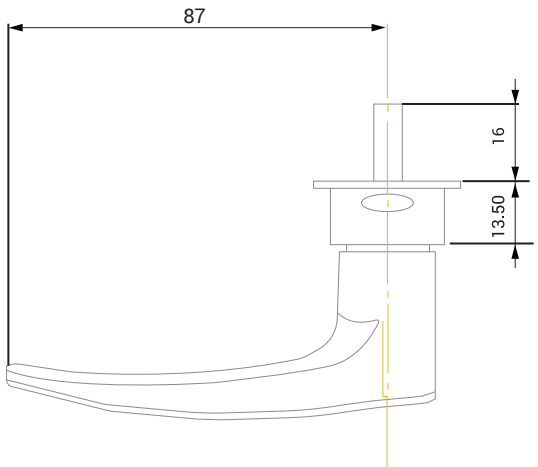
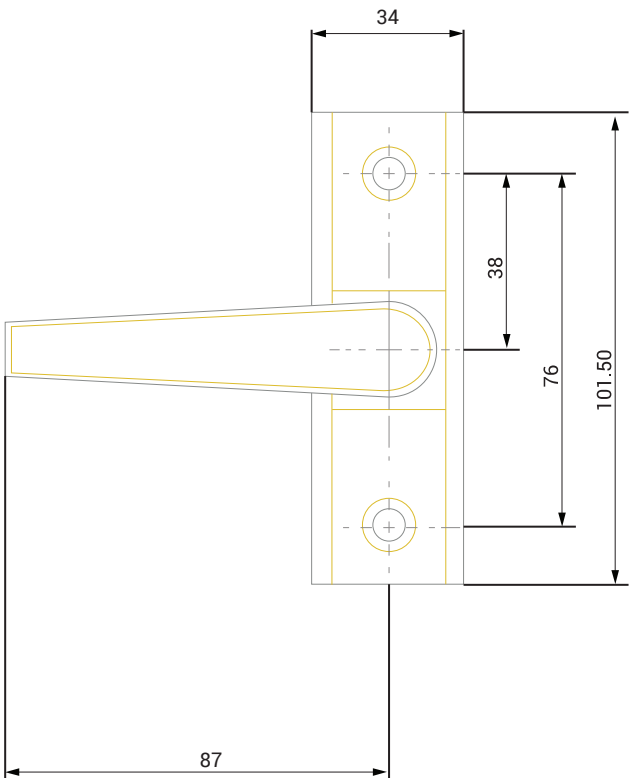

Handles

LEVER HANDLES

Winged Lever on Rose



Features:

- Screw on Rose
- Bolt through and screw fixings included
- Micro-tight spindle
- Sprung loaded

Finishes:

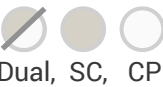

Dual, SC, CP

Return Lever on Rose



Features:

- Grub screw fit plate
- Micro-tight spindle
- Bolt through fixings included
- Concealed fix
- Sprung loaded

Finishes:



SSS, PSS, SAA

Handles

LEVER HANDLES

Lever on Backplate



Features:

- Screw on rose
- Bolt through and screw fixings included
- Micro-tight spindle
- Sprung loaded
- Available in latch lock, Euro & bathroom backplate

Finishes:



SC, PC



Return Lever on Backplate



Features:

- Grub screw fit plate
- Micro-tight spindle
- Bolt through fixings included
- Concealed fix
- Sprung loaded
- Interchangeable plates

Finishes:



SSS, PC



## Handles

## PAD HANDLES



## Finishes:

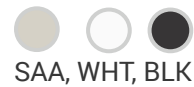

SAA, WHT, BLK

## Aluminium Pad Handle

## Features:

- Aluminium pad handle is the perfect set choice for commercial aluminium doors
- Ever popular handle is easily installed
- Complete with all the required fixings
- The handle has a height of 230mm or 300mm

## Handles

## UPVC HANDLES



## Finishes:



WHT, BLK, PB, SC, PC

## Universal Retrofit Door Handle

## Features:

- One handle designed to fit 75% of multi-point locks
- Sprung lever door handle
- 270mm long backplate to cover any existing holes
- Adaptable vertical handle position to suit lock centres between 59mm - 96mm
- Fits the majority upvc door mechanisms

## Paddle Handle



## Finishes:



SAA

## Features:

- Paddle handle for use with round cylinder deadlatches
- Suits 44mm thick doors
- Cam plug non-handed - reversible in the field
- Suitable for aluminium and steel doors



## PAS 24 Door Handle

## Features:

- High security door handle
- TS007 BSI kitemark 2 star rating / PAS 24 Enhanced Security / Secured by design Accredited
- 92 PZ with 122mm fixing centres

## Finishes:



WHT, BLK, PB, SC, PC



Official Police Security Initiative



Handles

DOOR KNOBS



Finishes:



Ball Mortice Knob

Features:

- Unsprung rose
- 50mm rose dia.
- 55mm ball dia.
- 90mm projection



Finishes:



Centre Door Knob

Features:

- Concealed fix square rose
- Substantial square centre door knob on a cylindrical stem
- Universal fixings for aluminium, composite, glass and timber doors.



Finishes:



Ringed Mortice Knob

Features:

- 50mm knob dia.
- 70mm rose dia.
- 82mm projection
- Solid construction
- Grub screw spindle fixing
- Unsprung rose

Handles

DOOR KNOBS



Finishes:



BALA Entrance

Features:

- Concealed fixing from one side
- Set of two keys included
- Lightly sprung for ease of opening
- Ideal for use throughout your home and in communal areas



Finishes:



BALA Privacy

Features:

- Ideal for bedrooms
- Suitable for private rooms in shared houses
- Can be locked from both sides
- Slam latch auto deadlocked when closed
- Emergency release slot on the outside



Finishes:



BALA Passage

Features:

- Concealed fixing from one side
- A non-locking latch knob set - allowing easy access to rooms at all times
- Lightly sprung for ease of opening
- Ideal for use throughout your home and in communal areas on internal doors where a lock is not required

# DOOR CLOSERS



## Door Closers

## DOOR CLOSER APPLICATION

### MOUNTING POSITIONS

There are three common positions in which a door closer can be mounted, each one is dependent upon the type and use of the door.

• Fig.1

DOOR MOUNTED  
PROJECTING ARM,  
PULL-SIDE

The most common application, provides a high degree of door control and range of adjustment. The closer is mounted on the pull side of the door with the arm mounted on the frame. When the door opens the arm passes over the door.

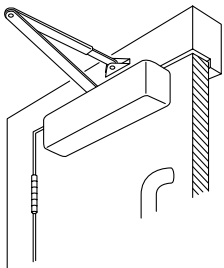

• Fig.61

TRANSOM MOUNTED  
PROJECTING  
ARM PUSH-SIDE

The closer is mounted on the frame above the door. The foot is mounted on the push side of the door. This position is intended for external doors opening outward to protect the closer from external elements.

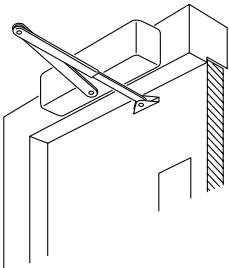

• Fig.6

DOOR MOUNTED  
PARALLEL ARM,  
PUSH-SIDE

The closer is mounted on the push side of the door. When the door opens, the closer arm swings with the angle of the door. This position stops the closer protruding into the room and is suitable for use on narrow door frames.

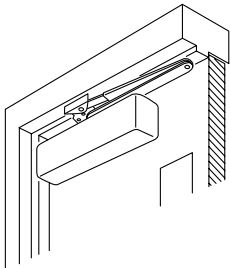

### DOOR CLOSER FEATURES

#### POWER SIZE

The Power Size of a door closer is measured in accordance with the Closing Torque that is achievable on the closing cycle.

The BS EN 1154 Standard classifies closers from a Size 1 through to a size 7 and recommends the use in accordance with the door width and door mass (weight).

Power Sizes can be fixed, selectable or adjustable.

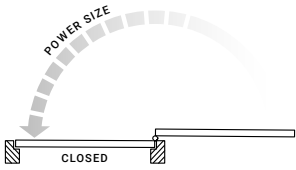

#### ADJUSTABLE CLOSING SPEED

Controlled door closers offer adjustability to the speed that the door will operate, the closing speed has adjustment from the maximum opening angle through to the last 10 to 15°.

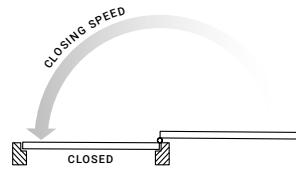

#### ADJUSTABLE LATCH ACTION

This allows speed adjustability on the last 10 to 15° to assist with overcoming latches and seals.

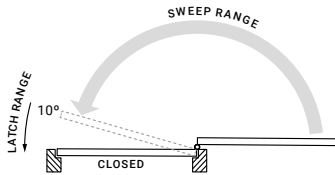

#### ADJUSTABLE BACKCHECK

The backcheck function slows the speed of the door whilst in the opening cycle, the function is to prevent damage being caused to the door, associated hardware or adjacent walls in the event of the door being flung open (Backcheck is not an alternative to a door stop).

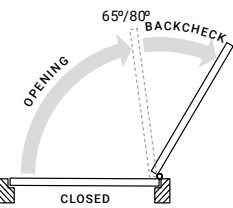

#### ADJUSTABLE DELAYED ACTION

The delayed action function slows the first part of the closing cycle down. Its function is particularly useful for disabled / elderly who may need additional time to pass through the doorway, delayed action normally releases around 70° where the standard closing speed will then commence.

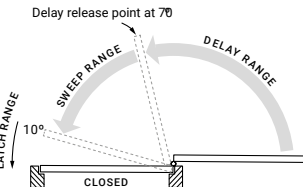

### FIRE SAFETY – CONTROL OF THE SPREAD OF FIRE AND SMOKE

All dedicated fire-resistant doors should be fitted with a door closer that is successfully tested to BS EN 1154.

A closed fire-resisting door is designed to withstand attack by fire for a specified period of time, installation of a door closer will ensure that the door is mechanically closed when not in use.

#### BS EN 1154:1997

This is the European standard for the performance of controlled door closing devices. It uses a 6 digit coding system to give clear details on the capabilities and performance levels of what the specific door closer model has been tested and approved to.

Example 4 8 2 1 1 4

The below detail gives the breakdown of each code:

#### DIGIT 1 CATEGORY OF USE

Grade 3 : For closing doors from at least 105° open  
Grade 4 : For closing doors from 180° open

#### DIGIT 2 TEST CYCLES

Grade 8 – 500,000 test cycles

#### DIGIT 3 TEST DOOR MASS/SIZE

| 1                      | 2                           | 3              | 4                 | 5                   | 6       | 7                          | 8                                 | 9  |
|------------------------|-----------------------------|----------------|-------------------|---------------------|---------|----------------------------|-----------------------------------|--|
| Door closer power size | Recommended door leaf width | Test door mass | Closing moment    |                     |         | Any other angle of opening | Opening moment between 0° and 60° | Door closer efficiency between 0° and 4° |
|                        |                             |                | Between 0° and 4° | Between 68° and 92° | Nm min. | Nm min.                    | Nm max.                           | % min.                                   |
| 1                      | < 750                       | 20             | 9                 | < 13                | 3       | 2                          | 26                                | 50                                       |
| 2                      | 850                         | 40             | 13                | < 18                | 4       | 3                          | 36                                | 50                                       |
| 3                      | 950                         | 60             | 18                | < 26                | 6       | 4                          | 47                                | 55                                       |
| 4                      | 1100                        | 80             | 26                | < 37                | 9       | 6                          | 62                                | 60                                       |
| 5                      | 1250                        | 100            | 37                | < 54                | 12      | 8                          | 83                                | 65                                       |
| 6                      | 1400                        | 120            | 54                | < 87                | 18      | 11                         | 134                               | 65                                       |
| 7                      | 1600                        | 160            | 67                | < 140               | 29      | 18                         | 215                               | 65                                       |

#### DIGIT 4 FIRE BEHAVIOUR

Grade 0 – Not suitable for use on fire/smoke door assemblies  
Grade 1 – Suitable for use on fire/smoke door assemblies

#### DIGIT 5 SAFETY

All doors closers are required to satisfy the essential requirement of safety in use. Therefore only Grade 1 is identified.

#### DIGIT 6 CORROSION RESISTANCE

Five grades of corrosion resistance are identified according to EN 1670:  
Grade 0 – No defined corrosion resistance  
Grade 1 – Mild resistance  
Grade 2 – Moderate resistance  
Grade 3 – High resistance  
Grade 4 – Very high resistance

Door Closers

SURFACE MOUNTED



Adjustable Power  
Size 2-4

Testing & Standards:

- CE marked against EN1154
- Included in successful fire test to EN1634
- Suitable for use on timber fire doors of up to 120 minutes fire resistance.
- Safe in use
- High corrosion resistance

Product Overview:

An efficient, durable and stylish variable power overhead door closer. Suitable for most applications particularly those with constant use which require a backcheck function.

FIG 1



Finishes:



SSS, PSS, PB

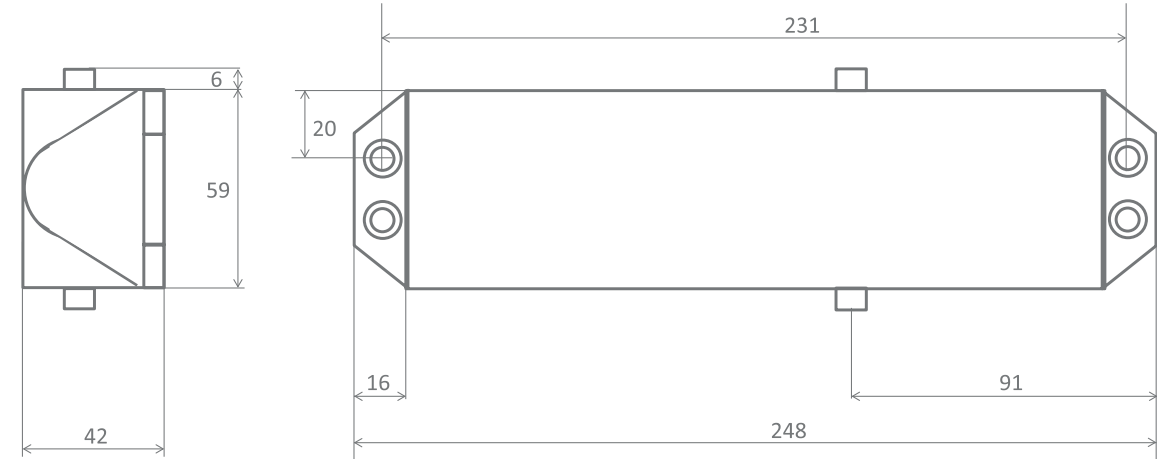

Door Closers

SURFACE MOUNTED



Adjustable Power  
Size 2-5

Testing & Standards:

- CE marked against EN1154
- Included in successful fire test to EN1634
- Suitable for use on timber fire doors of up to 120 minutes fire resistance and 240 minutes on steel doors
- Certifire approved - refer to CF689 for scope of approval
- Safe in use
- High corrosion resistance

Product Overview:

A highly efficient, durable and stylish variable power overhead door closer. Suitable for most applications particularly those with public use.

FIG 1



FIG 6



Finishes:



SSS, PSS, PB

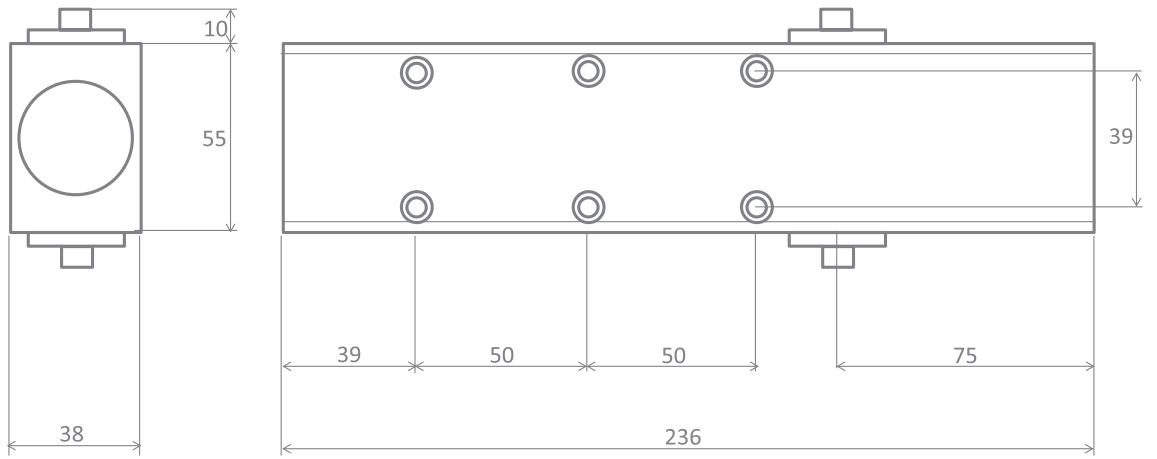



Door Closers

SURFACE MOUNTED



Adjustable Power Size 2-4 Guide Rail

Product Overview:

A durable and stylish variable power overhead guide rail door closer. Suitable for a variety of applications where BS8300/Equalities Act/Approved Document 'M' is not a requirement.

Features:

- CE marked against EN1154
- Included in successful fire test to EN1634
- Suitable for use on timber fire doors of up to 120 minutes fire resistance
- Safe in use
- High corrosion resistance

Finishes:

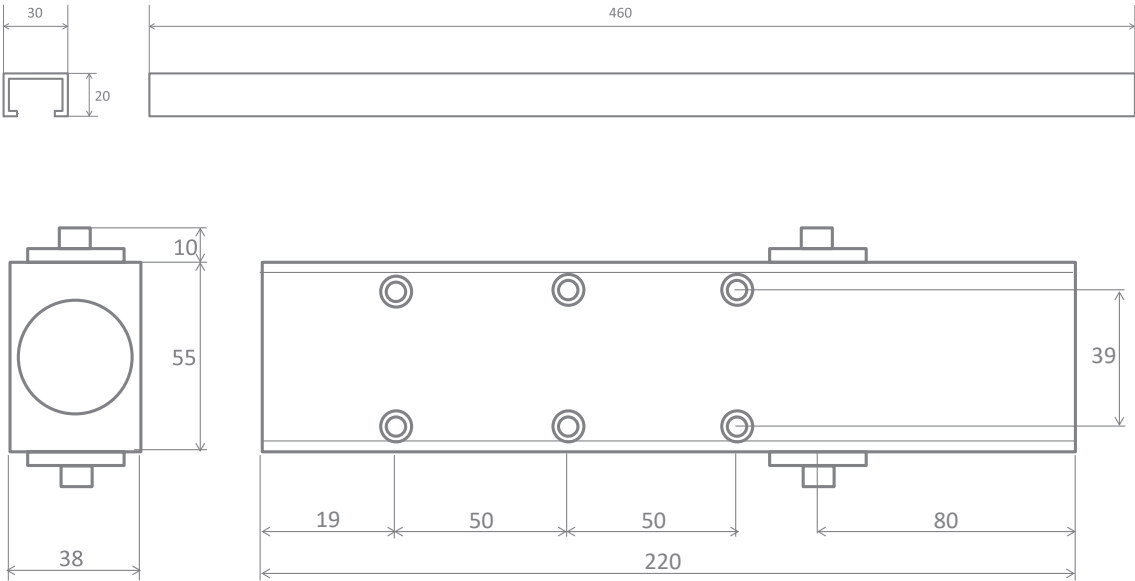

Door Closers

SURFACE MOUNTED



Fixed Power Size 3

Product Overview:

A durable and stylish variable power overhead guide rail door closer. Suitable for a variety of applications where BS8300/Equalities Act/Approved Document 'M' is not a requirement.

Features:

- Suitable for doors upto 60kg, 950mm wide
- For inward and outward opening doors
- Non-handed
- Adjustable closing speed
- Adjustable latch speed
- BS EN 1634
- BS EN 1154 : 1996

Finishes:

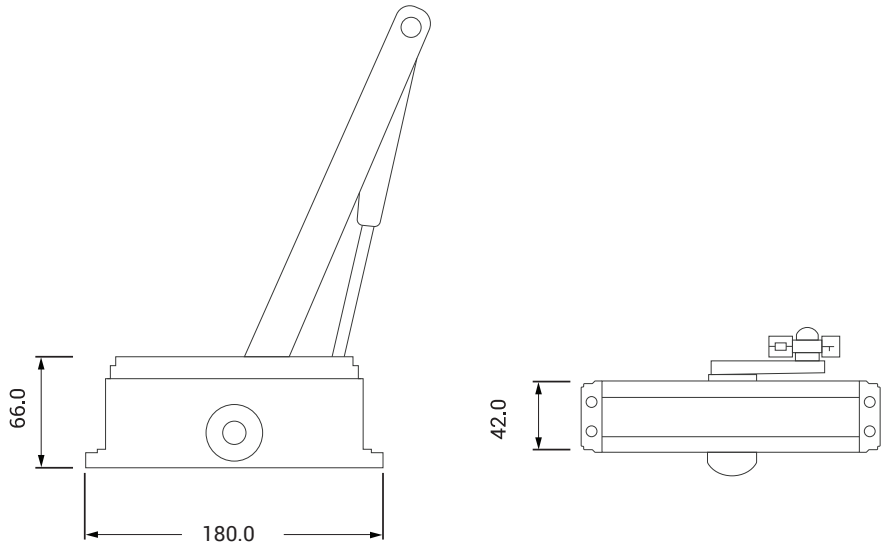
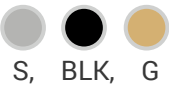

Door Closers

TRANSOM MOUNTED



Transom Door Closer

| Power size           | 2   | 3    | 4    |
|----------------------|-----|------|------|
| Max. Door width (mm) | 900 | 1000 | 1100 |
| Max. Door width (kg) | 100 |      |      |

Features:

- Fixed power size 2/3/4
- Adjustable closing & latching speed
- Maximum door opening angle at 130°
- Mechanical hold-open 90°
- Concealed transom mount
- Complete with 65mm or 70mm fixing brackets & Fixings

Accessories:

- Standard side load arm
- Short side load arm
- End load arm
- Front bracket
- Back bracket
- Standard pivot
- Heavy duty pivot max door weight: 150kg

Application Ranges:

- Suitable for single & double doors
- Available for light, medium & heavy duty doors

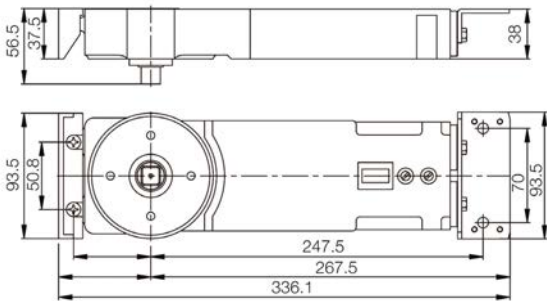
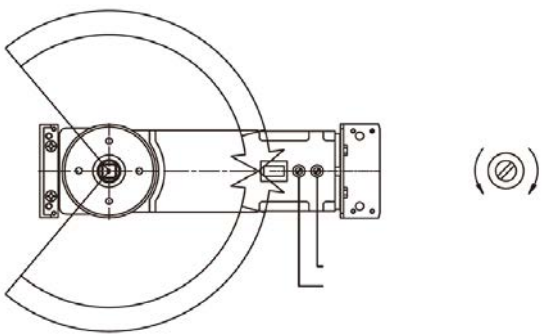

Door Closers

TRANSOM ACCESSORIES



Arm Sets

Features:

- End load arm, standard side load arm & short side load arm
- Fully adjustable
- Hole and centre lines in channel for easy location of pivot point.
- Offering adjustment through hinge stile.
- All armsets are supplied complete with fixings blocks and tag plates



Bottom Pivots

Features:

- Heavy duty
- RS10 Heavy duty
- Standard
- All bottom pivots are supplied with fixings

Door Closers

FLOOR SPRINGS



Universal Floor Spring

Product Overview:

Offering adaptability to almost any installation. The closer’s compact body permits its use where a larger closer would be prohibitive.

Features:

- Adjustable spring sizes
- Non-handed unit suitable for both single and double-acting doors
- Controlled closing with two independent values
- Single point hold open available at 90°
- Single point hold open available at 105°

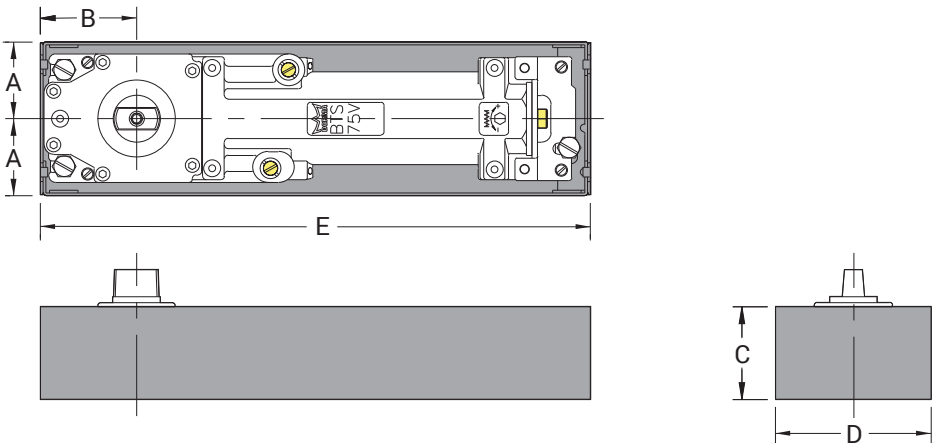

|             | A                | B         | C  | D     | E      |
|-------------|------------------|-----------|----|-------|--------|
| Inches      | 1-7/16 – 1-13/16 | 2 – 2-1/4 | 2  | 3-1/4 | 11-1/4 |
| Millimeters | 36 – 46          | 51 – 57   | 51 | 82    | 285    |

Door Closers

FLOOR SPRINGS



Heavy Duty Universal Floor Spring

Product Overview:

Offers the perfect combination between freedom of creation and greatest reliability by their concealed floor mounting, providing a multitude of functions at the same time.

Features:

- Adjustable spring sizes
- Non-handed unit suitable for both single and double-acting doors
- Controlled closing with two independent values
- Single point hold open available at 90°
- Single point hold open available at 105°

- 1. Closing speed adjustment valve
- 2. Latching speed adjustment valve
- 3. Plug connector with cable for EMB & FLB power supply

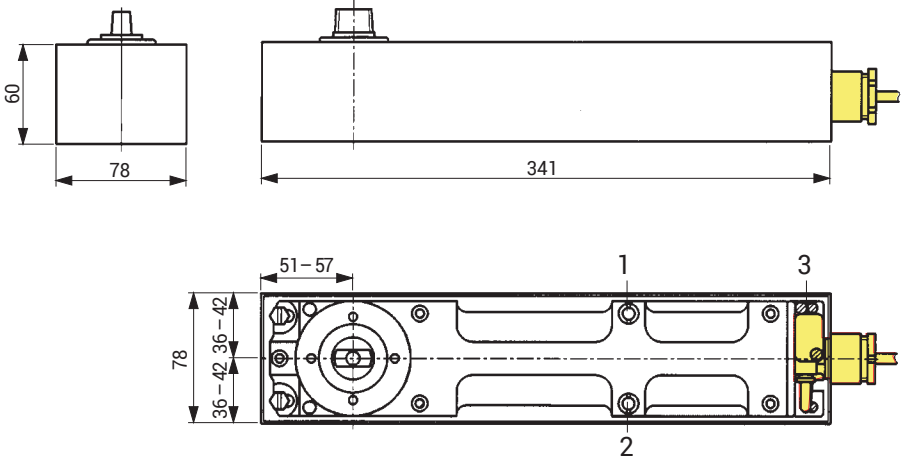



# LOCKS



COMMERCIAL HARDWARE

Locks

## LOCK HANDING GUIDE

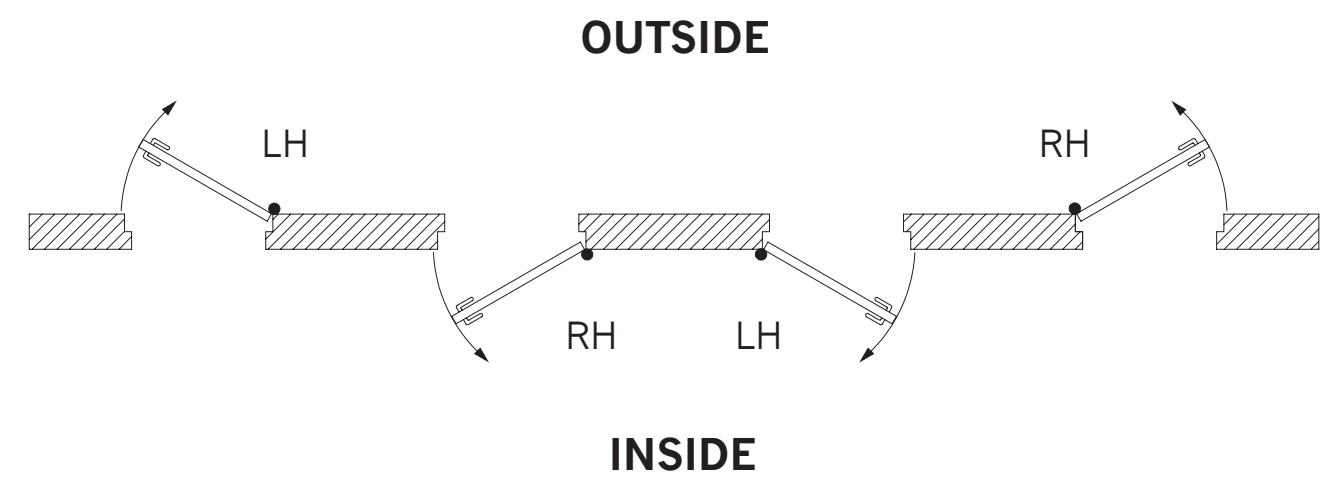
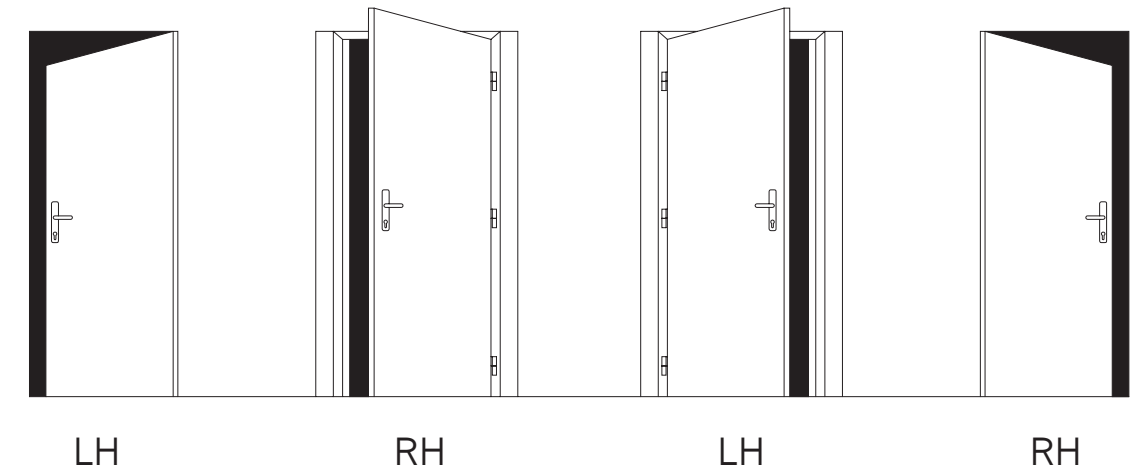

## Locks

## HOOK LOCK



## Euro Profile Hook Lock

## Features:

- Steel case with corrosion resistance
- Bolt throw 19mm
- Lock bolt 34mm x 12.5mm
- Complete with faceplate
- Round cylinder available

## Backset Options:

- 25mm (31/32") backset
- 30mm (1-1/8") backset
- 40mm (1-1/2") backset

Mortice hook lock accessories  
on the next page

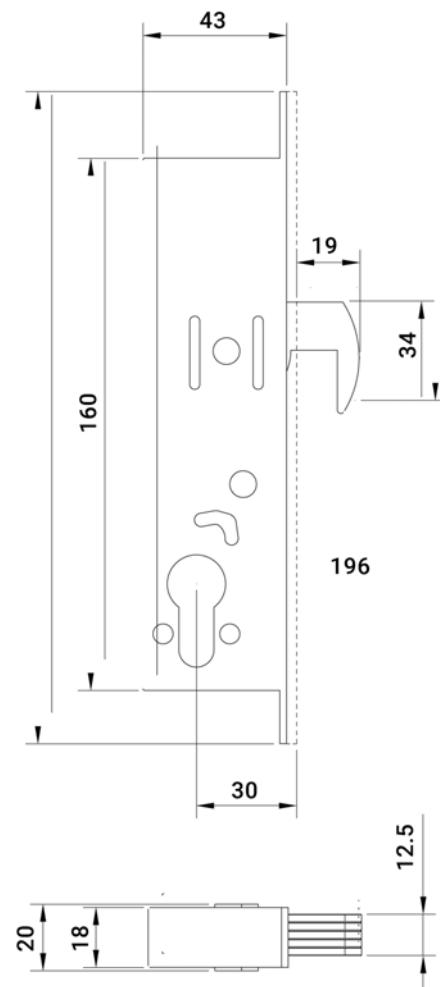

## Locks

## ACCESSORIES



## Mounting Bridges

## Features:

- Sold as pairs
- Complete with fixings
- To suit round and Euro profile hooklocks

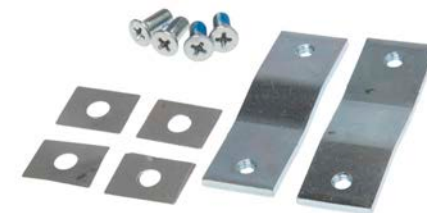

## Fixing Kits

## Features:

- Deadlatch fixing kit
- Complete with fixings
- To suit round and Euro profile deadlatches



## Trim Plate

## Features:

- To suit armoured strike plate
- Complete with fixings
- Available as flat or radius profile



## Armoured Strike Plate

## Features:

- To suit Euro profile or round cylinder hooklocks
- Complete with fixings

Locks

DEADLATCH

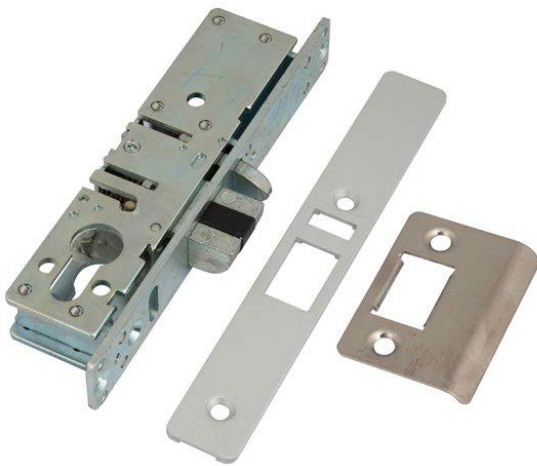

Euro Profile Deadlatch

Case Size & Backset Vary Depending On Version:

Backset Options:

- 25mm (31/32") backset
- 28mm (1-1/8") backset
- 38mm (1-1/2") backset

Case:

Steel with corrosion resistant plating.

Latchbolt:

Fully reversible latchbolt - without the need to open the case. Latchbolt complete with Hardened Steel Internal Pins

Faceplate:

173.5 x 25mm  
Aluminium Material,  
Finish: Matt/Satin Anodised Aluminium  
Complete With: Flat Faceplate and Strikeplate

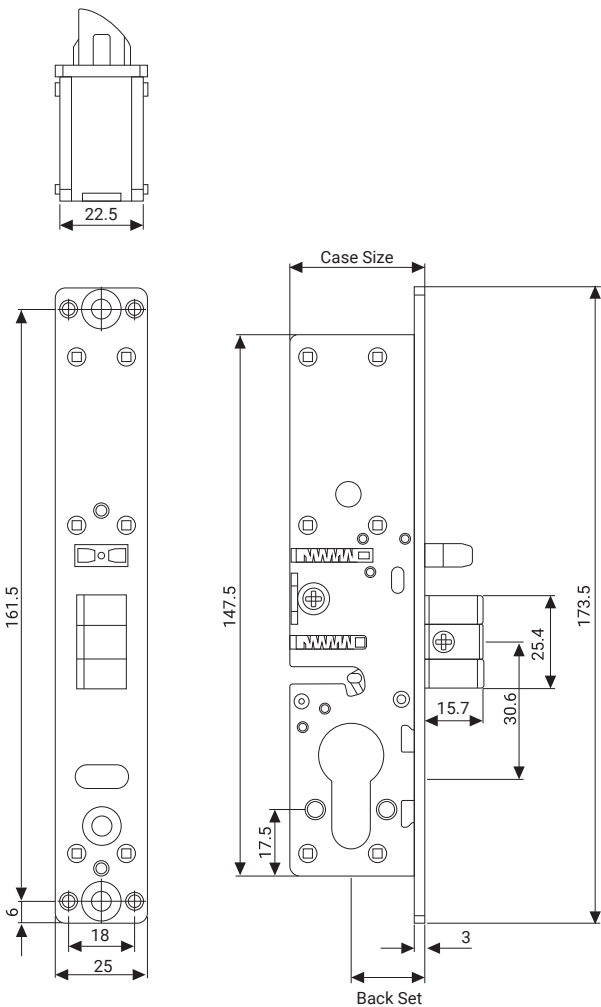

Locks

DEADLATCH

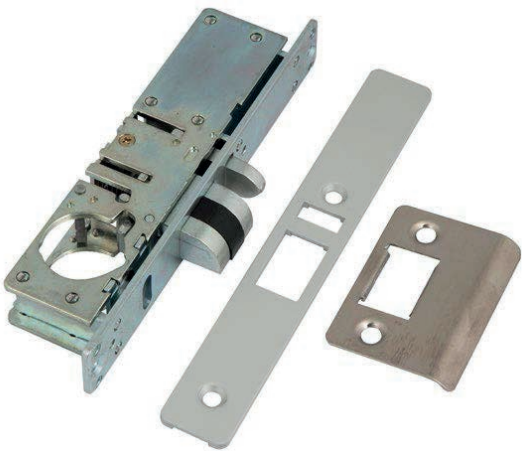

Round Cylinder Deadlatch

Case Size & Backset Vary Depending On Version:

Backset Options:

- 25mm (31/32") backset
- 28mm (1-1/8") backset
- 38mm (1-1/2") backset

Case:

Steel with corrosion resistant plating.

Latchbolt:

Fully reversible latchbolt - without the need to open the case. Latchbolt complete with Hardened Steel Internal Pins

Faceplate:

173.5 x 25mm  
Aluminium Material,  
Finish: Matt/Satin Anodised Aluminium  
Complete With: Flat Faceplate and Strikeplate

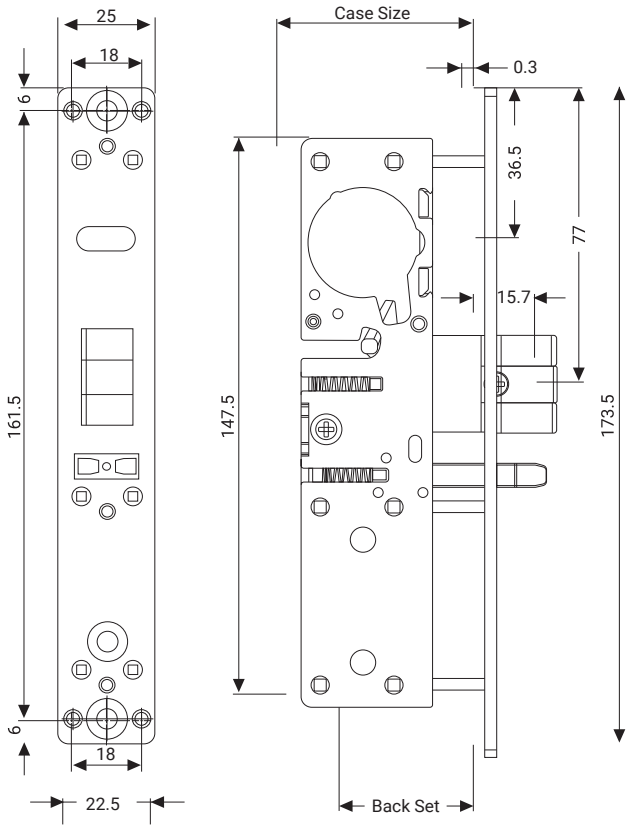

## Locks

## DEADLOCK



## High Security Hooklock

## Features:

- Complies with BS EN 12209 at security grade 6
- Bolt withstands 10kN side load in unsupported application and 6kN end load
- Barbolt with anti-spread feature incorporating the benefits of hookbolt
- Enclosed mechanism prevents potential for tampering while under attack
- Specifically designed to fit into thermally broken and shopfront applications

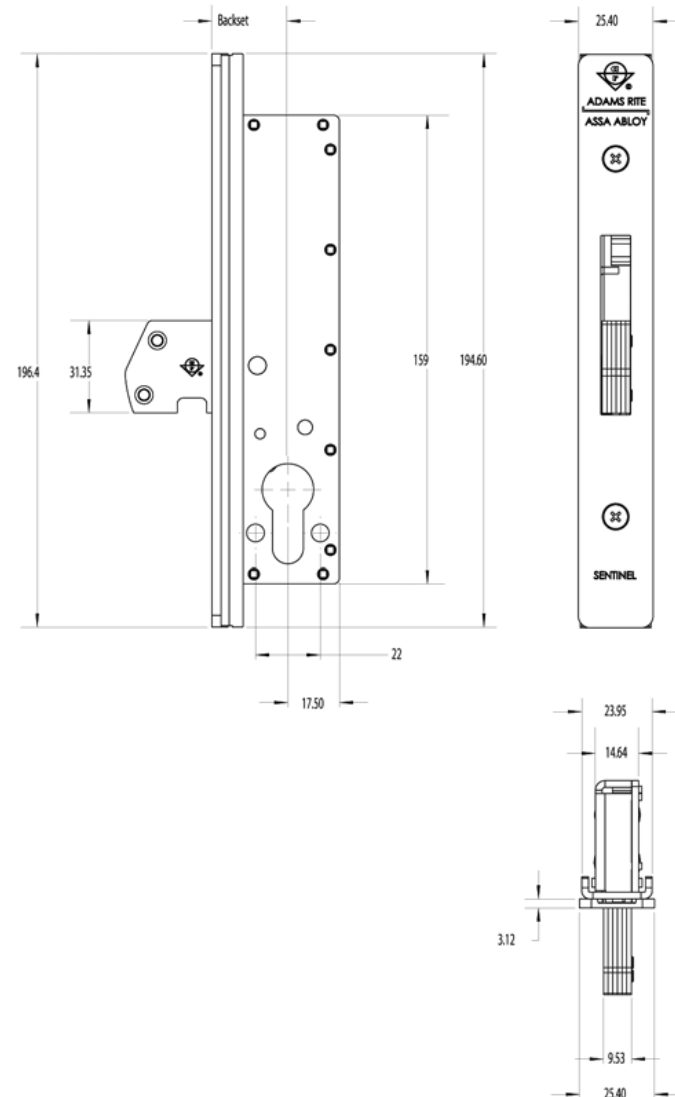

## Locks

## NARROW STYLE



## Narrow-Style Sash Lock

## Features:

- For European profile cylinder.
- Key action on latch bolt.
- Single throw dead bolt.
- Easy reversible latch bolt.
- Backset 25, 30, 35, 40 and 45 mm.
- Distance 92 mm.
- U-forend on request.
- Forend stainless steel.
- Dead and latch bolt die-cast bright nickel-plated.
- Without strike plate.
- Latch, Anti-Panic, Nightlatch versions available

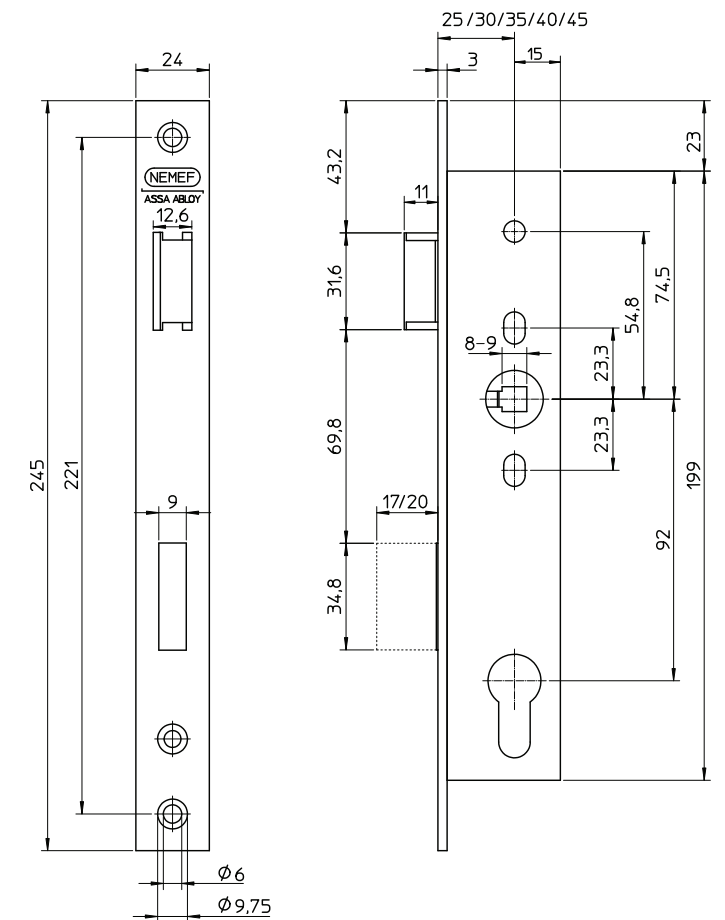

Suitable for inner & entrance doors.



## Locks

## DIN LOCK

Square Profile  
Din Lock

## Features:

- Available with 55 & 60mm backsets
- Case size (55mm backset) – 85 x 165mm
- Case size (60mm backset) – 90 x 165mm
- Available as Euro, sash, nighlatch & bathroom
- Stainless steel latch bolt & dead bolt
- Includes grip tight follower spring
- Includes anti-rattle strike and dust box
- Available in square and radius profiles

## Locks

## MULTIPOINT LOCK

Auto Locking  
Multi-point Lock

## Features:

- Automatically locks as soon as door is closed
- Suitable for aluminium, composite, glass & timber doors
- Available for right and left handed with keeps to suit



## Lift To Lock Set

## Features:

- 90mm case size
- 60mm backset
- Square profile & radius profile available
- Grade 304 stainless steel latchbolt & deadbolt
- Anti-rattle strike
- Grip tight follower
- 72mm c/c
- For use with lift to lock lever

Latch & Deadbolt  
Multi-point Lock

## Features:

- Suitable for Upvc, composite & timber doors
- To be used with lever handles with 30mm & 45mm backset
- Tested to PAS24 & accredited to Secured by Design



Door Lever Set -  
Push on Rose

Locks

## UPVC LOCK CASES



## ERA Latch &amp; Deadbolt Split Spindle

## Features:

- Suitable for left or right handed doors
- 92mm Centres
- 8mm Split Spindle

## Backset Options:

- 30mm backset
- 35mm backset
- 45mm backset

Locks

## UPVC LOCK CASES



## Lockmaster Double Spindle Latch &amp; Deadbolt

## Features:

- Suitable for left and right handed doors
- 62mm/92mm Centres
- 8mm Double Spindle

## Backset Options:

- 35mm backset
- 45mm backset

## GU Old Style Latch &amp; Deadbolt Single Spindle



## Features:

- Suitable for left or right handed doors
- 92mm Centres
- 8mm Spindle Split Single

## Backset Options:

- 30mm backset
- 35mm backset

## Maco Latch &amp; Deadbolt Single Spindle



## Features:

- Suitable for left hand right handed doors
- 92mm Centres
- 8mm Single Spindle

## Backset Options:

- 28mm backset
- 35mm backset

Locks

MORTICE DEADLOCKS



3 Lever Deadlock

Features:

- Complete with 2 keys & fixings
- Solid brass deadbolt
- 60 Minute fire rated

Backset Options:

- 44.5mm backset
- 57mm backset

Finishes:  
NP, PB,

Locks

MORTICE SASH LOCKS



3 Lever Sashlock

Features:

- Complete with 2 keys & fixings
- Solid Brass Deadbolt & latch
- 60 minute fire rated

Backset Options:

- 44.5mm backset
- 57mm backset

Finishes:  
NP, PB,



5 Lever Deadlock

Features:

- Complete with 2 keys & fixings
- Solid brass deadbolt
- Tested to bs3621 & accredited to secured by design

Backset Options:

- 44.5mm backset
- 57mm backset

Finishes:  
SC, PC, PB

Secured by Design  
Official Police Security Initiative



5 Lever Sashlock

Features:

- Complete with 2 keys & fixings
- Solid brass deadbolt
- Tested to BS3621 & accredited to Secured by Design

Backset Options:

- 44.5mm backset
- 57mm backset

Finishes:  
SC, PC, PB

Secured by Design  
Official Police Security Initiative

## Locks

## EURO LOCK CASES



## Euro Profile Sashlock

## Features:

- Complete with fixings
- Solid brass deadbolt & latch
- 60 Minute fire rated

## Backset Options:

- 44.5mm backset
- 57mm backset

## Finishes:



SSS PB,

## Locks

## NIGHT LATCH



## Locking Night Latch

## Features:

- Non-deadlocking nightlatch
- 60mm backset
- Bolt can be locked from inside with snib

## Backset Options:

- 40mm backset
- 60mm backset

## Finishes:



WHT, BLK, PB, SC, PC,



## Euro Profile Deadlock

## Features:

- Complete with fixings
- Solid brass deadbolt
- 60 Minute fire rated

## Backset Options:

- 44.5mm backset
- 57mm backset

## Finishes:



SSS, PB,



## BS3621 Nightlatch

## Features:

- Conforms to British Standard 8621:2007
- Key-less lever on the inside of the door
- High security integral cylinder pull protects the cylinder from being drilled.

## Backset Options:

- 40mm backset
- 60mm backset

## Finishes:



PB, PC, SC, SN



## Locks

## PADLOCKS



## High Security Padlock

## Features:

- Hardened molybdenum shackle
- Corrosion resistant body
- Anti-drill protection
- Weather protected key slot
- Option to retain shackle after opening

## Padlock



## Features:

- 3 Keys
- Non key retaining
- Double locking
- Hardened steel shackle
- Not suitable for exterior use
- Available keyed to differ & keyed alike

## Locks

## FIRE BRIGADE LOCKS

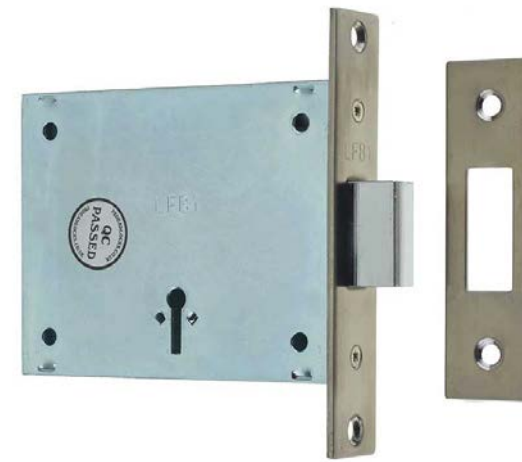

## Mortice Lock

## Features:

- Mortice deadlock
- Key operated on both sides
- Available as FB1 & FB2
- All keys sold separate



FB keys Sold Separately



## Reversible Slamlock

## Features:

- Reversible Latch
- Available as FB4
- All keys sold separate

# CYLINDERS



COMMERCIAL HARDWARE



**COMMERCIAL  
HARDWARE**

A range which comprises of single, double & turn cylinders with euro & oval bodies. Keyed to differ, keyed alike or master keyed versions are available.

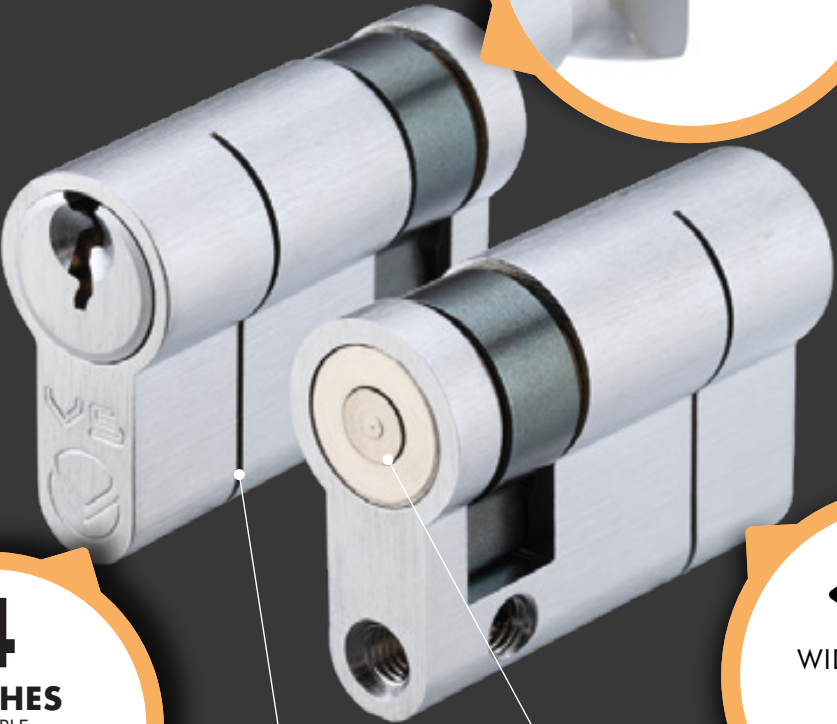

Break-off system

Adjustable CAM



**DID YOU KNOW ...**

**WE OFFER OUR OWN BESPOKE CYLINDER  
KEYING SERVICE?**  
CALL US ON 0333 355 3801 FOR INFORMATION.

## CYLINDERS KEYING GUIDE

### KEYED TO DIFFER

EACH LOCK IS OPENED BY ITS OWN UNIQUE KEY, WHICH DOES NOT OPEN ANY OTHER LOCK.

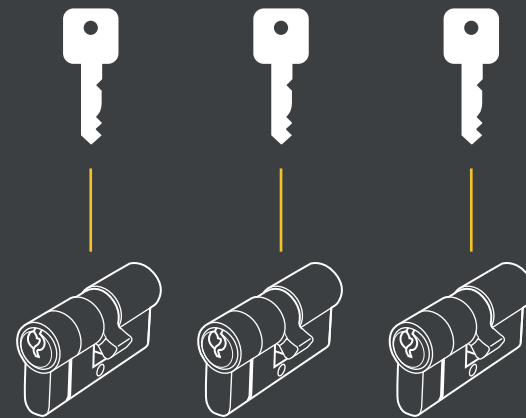

### KEYED ALIKE

ALL CYLINDERS IN THE SET ARE OPENED BY THE SAME KEY, THIS OPTION PROVIDES SAME KEY CONVENIENCE AND ELIMINATES THE NEED FOR MULTIPLE KEYS WHERE NUMEROUS CYLINDERS ARE USED.

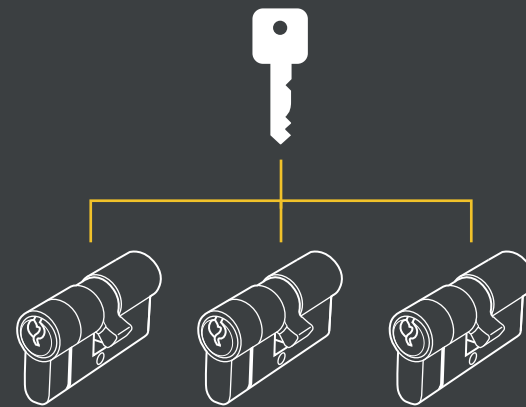

### UNDER MASTER KEY

WHERE ALL CYLINDER LOCKS ARE OPENED BY A SINGLE MASTER KEY THEN EACH OF THE CYLINDER LOCKS ARE OPENED BY THEIR OWN KEY, OFTEN REFERRED TO AS THE SLAVE, CHANGE OR DIFFER KEYS.

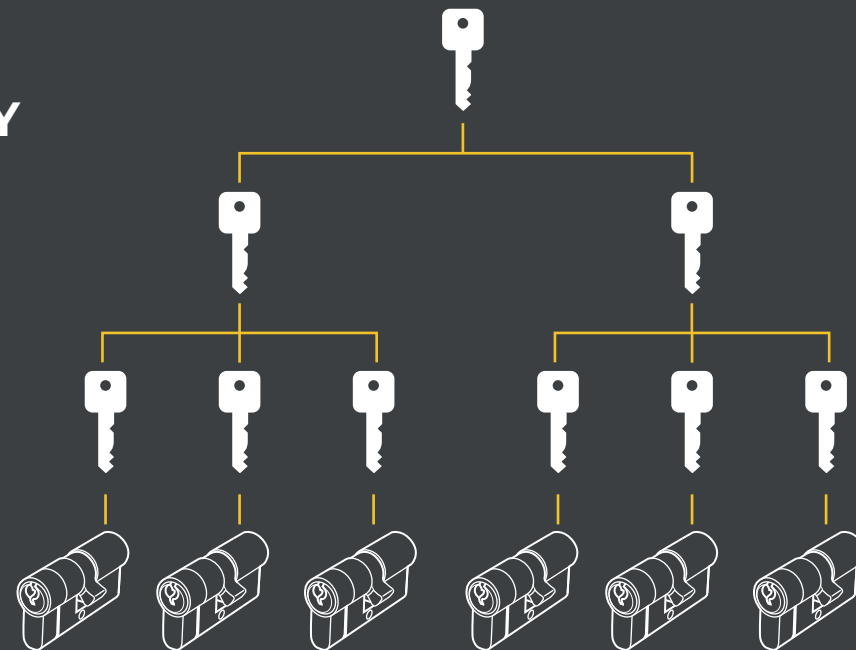

## Cylinders

## MEASURING CYLINDERS GUIDE

### How To Measure a Cylinder

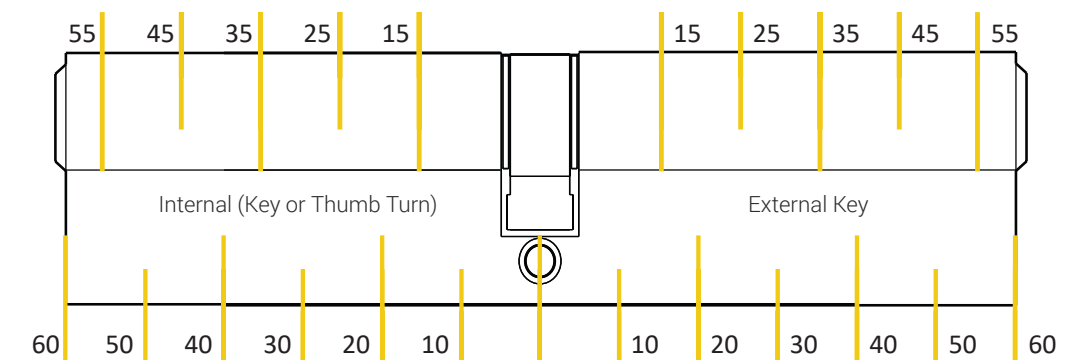

All Dimensions are in mm

## CYLINDER STANDARDS



Cylinders

EURO PROFILE CYLINDERS

Euro Single Cylinder



Finishes:

- SC, PB, BK, PC

Standards:



Features:

- BS EN 1303
- BS EN 1634-1
- Anti-drill, Anti-pick & Anti-snap
- Adjustable cam
- Complete with 3 keys & fixing pin
- Full range of sizes available

Cylinders

RIM CYLINDERS

Rim Cylinder



Finishes:

- SC, PB, BK, PC

Standards:



Features:

- BS EN 1303
- BS EN 1634-1
- Anti-drill & Anti-pick
- Complete with 3 keys & trim ring



Finishes:

- SC, PB, BK, PC

Standards:



Euro Double Cylinder

Features:

- BS EN 1303
- BS EN 1634-1
- Anti-drill, Anti-pick & Anti-snap
- Complete with 3 keys & fixing pin
- Full range of sizes available
- Offset sizes available



Finishes:

- SC

Standards:



Threaded Rim Cylinder

Features:

- BS EN 1303
- BS EN 1634-1
- Anti-drill & Anti-pick
- Complete with 3 keys & trim ring



## Cylinders

## EURO PROFILE CYLINDER

## Cylinders

## EURO PROFILE CYLINDER



## Finishes:

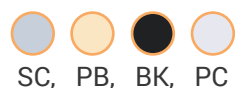

## Standards:



## Euro Cylinder &amp; Turn

## Features:

- BS EN 1303
- BS EN 1634-1
- Anti-drill, Anti-pick & Anti-snap
- Complete with 3 keys & fixing pin
- Full range of sizes available
- Offset sizes available



## 3 Star Cylinder



## Profile Options:

- Half (single) cylinder
- Double cylinder
- Thumbturn cylinder

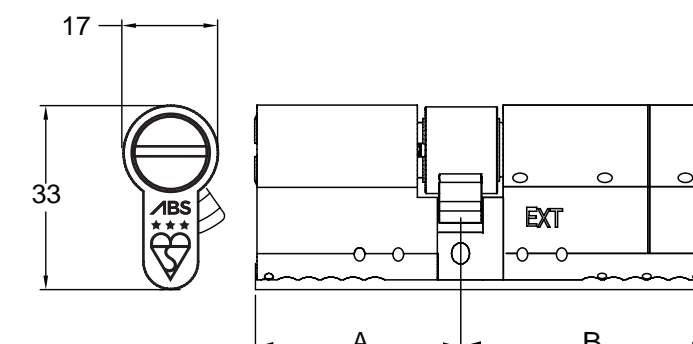

## 1 Star Euro Cylinder



## Finishes:



## Features:

- Security Standard Kitemark BS EN 1303
- Anti-drill, Anti-pick & Anti-snap
- Complete with 3 keys & fixing pin
- Full range of sizes available
- Offset sizes available
- Available as single, double & Thumbturns

## Features:

- SS312 Sold Secure Diamond Grade
- 3 Star British Kitemark - TS007:2014 (KM 586135)
- Secured by Design Accredited (Police preferred specification)
- Patented Snap Secure Technology
- Pick, Drill & Bump Resistant
- Pin-in-Pin and magnetic pin technology
- 6 Trap Pins for advance pick resistance
- 16 Anti-drill pins
- Double, single and thumbturn formats available
- Three keys per cylinder
- Secure online key registering
- Keyed alike key/key pairs are available ex stock
- Key alike with ABS Euro cylinders, Rim cylinders & padlocks

## Finishes:



# PANIC HARDWARE



COMMERCIAL HARDWARE

## Panic Hardware

## APPLICATIONS

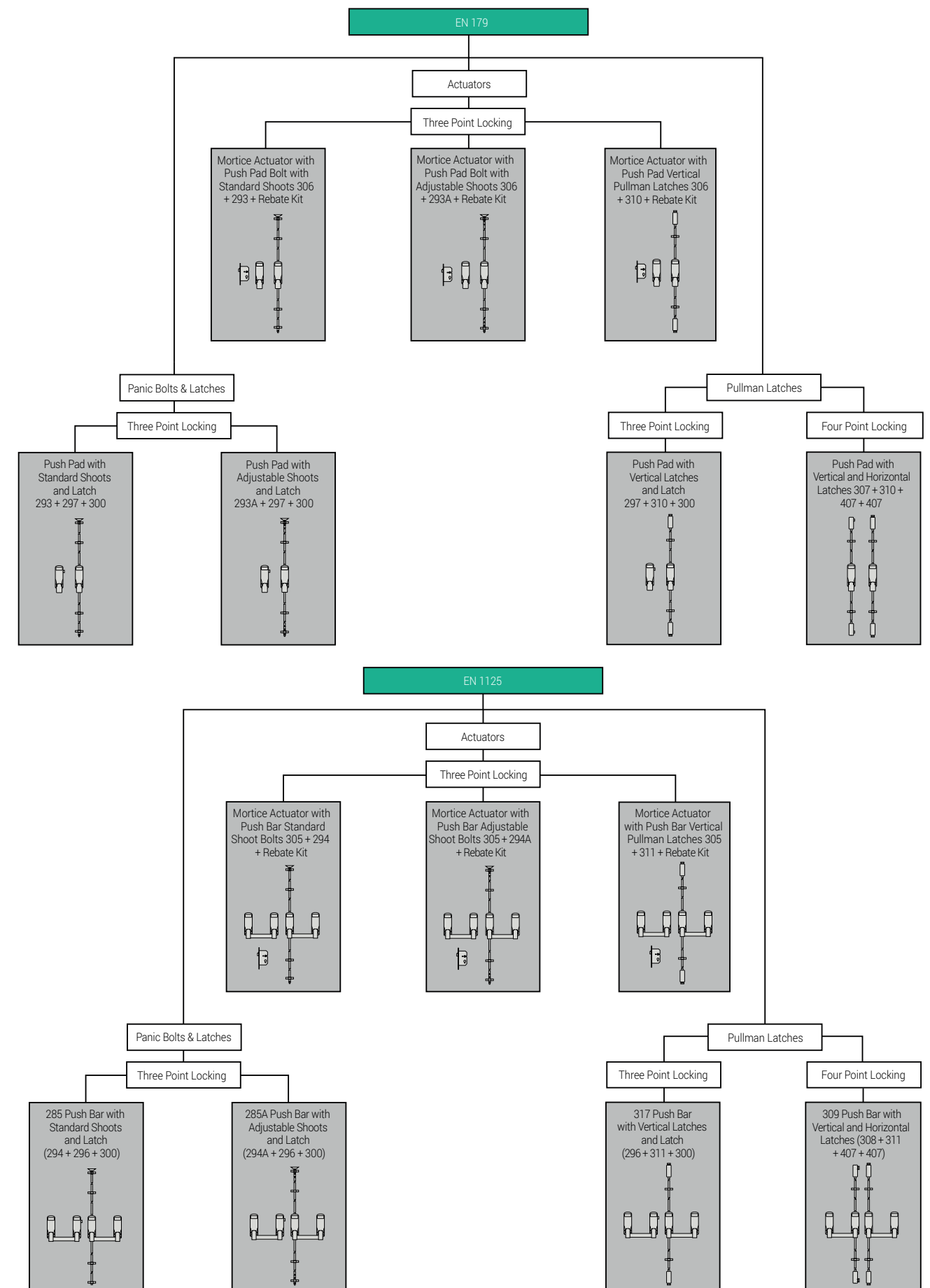

Panic Hardware

## EXIT DEVICE

Concealed Rod  
Crash Bar

## Features:

- Range of horizontal cross bars and push bars are compliant to BS EN 1125.
- The cross bar is extruded aluminium in a silver satin, dark bronze, green or black anodised finish.
- The exit devices have nylon bushes for silent operation, with heavy duty lever springs for durable operation of the lever arms.
- Suitable for narrow and widestile doors.
- All fixings are concealed to ensure an aesthetically pleasing finish. The exit device houses do not exceed 120 x 186mm projection.
- Heavy duty lever springs for durable operation of lever arms
- Standard model suitable for doors of up to 1155mm wide
- Extra wide model long crossbow suitable for doors up to 1220mm wide

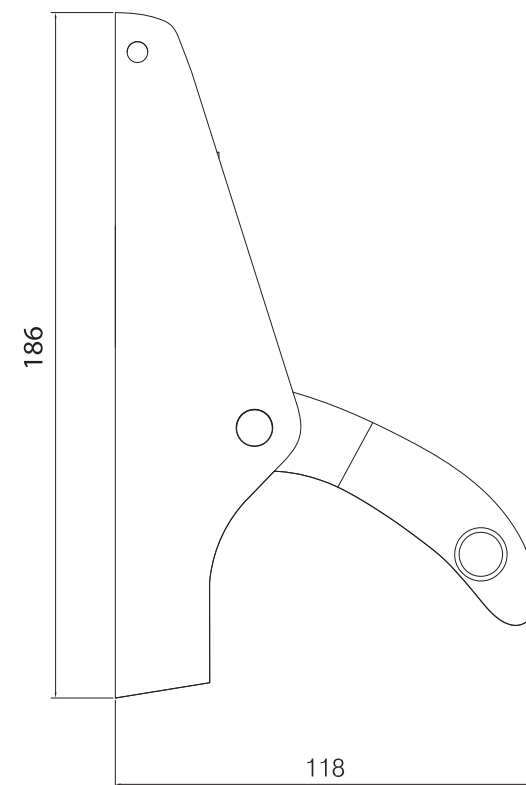

Panic Hardware

## EXIT DEVICE

Concealed Rod  
Paddle Handle

## Features:

- Emergency device installed to the opening jamb
- Push paddle handle with engraved "PUSH"
- Compliant to BS EN 179
- Finished in Satin Chrome
- Operating paddle handle and lever do not exceed 120 mm x 186 mm projection
- Standard mortice rim cylinder lock available as option

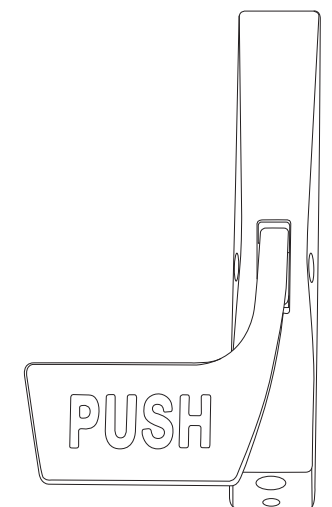

HAND OF DOOR

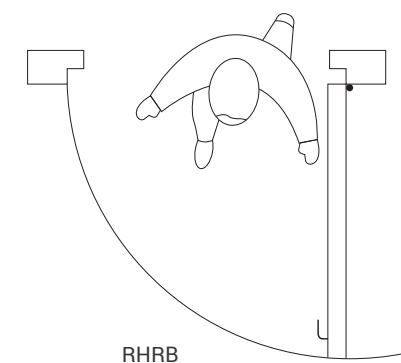
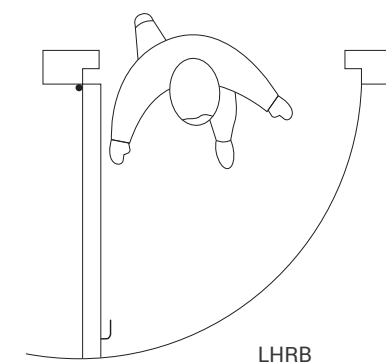

## Panic Hardware

## EXIT DEVICE



### Concealed Rod Soft Touch Bar

## Features:

- Heavy duty lever springs and internal mechanism for durable, smooth operation.
- Plated steel and stainless steel internal components.
- 8.5mm diameter, steel locking rods.
- 16mm bolt throw
- Suitable for door widths as narrow as 700mm and 2135mm high.
- Extruded aluminium touch bar, anodized finish with coloured alloy end caps to match.

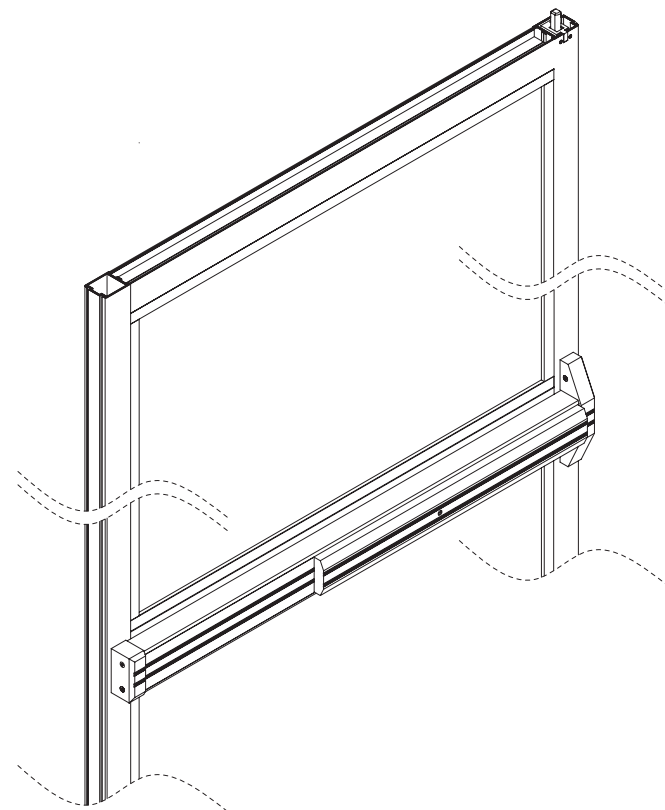

HAND OF DOOR

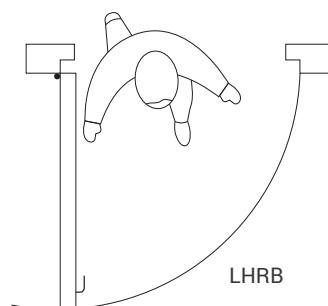

LHRB

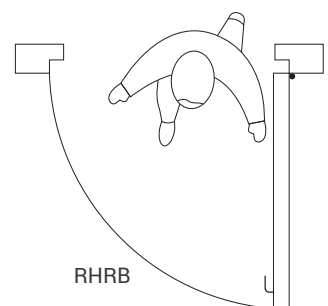

RHRB

## Panic Hardware

## EXIT DEVICE



### Outside Locking Handle

## Features:

- Key controlled
- Outside trim
- For use concealed exit devices.
- Uses screw in mortice cylinder with ms type cam.
- Not handed (field reversible).
- Covering a range of thickness doors from 46mm - 67mm.

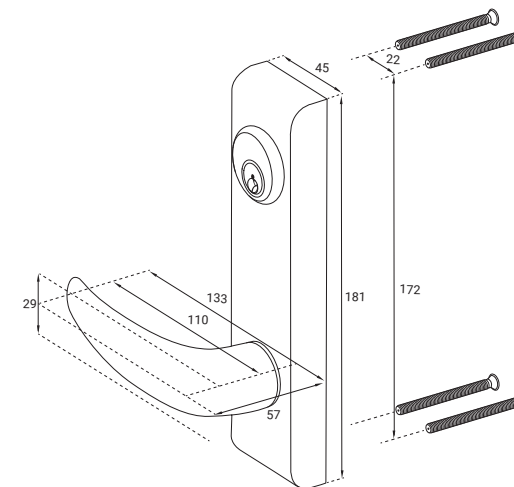
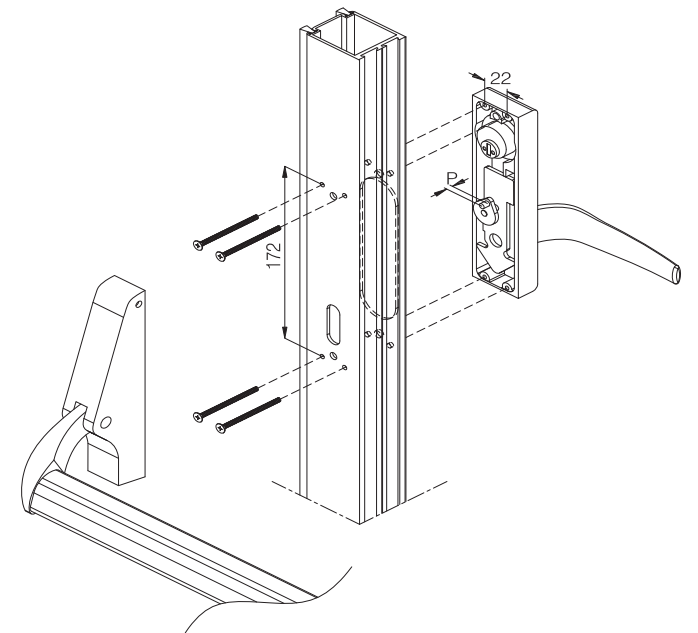



Panic Hardware

EXIT DEVICE



502A-B  
Push Bar Panic latch

Slimline Surface Mounted Hardware



501-B  
Push Bar  
Panic latch



512-B  
Push Bar  
Emergency  
Exit Bolt with  
Vertical  
Pullman



522-B  
Push Bar  
Emergency  
Exit Bolt with  
Horizontal  
Pullman

Features:

- Non-handed
- CE marked for safety
- Surface mounted
- 38mm wide footprint
- Suitable for doors with narrow stiles
- Microswitch version available
- Standard colours: silver, white with green cross bar and black with red cross bar
- Available in most RAL colours

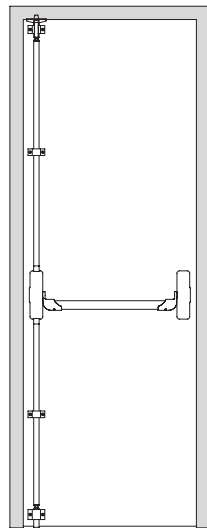

502A-B

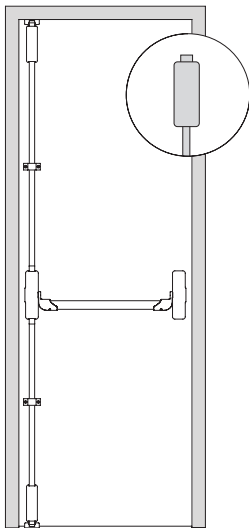

522-B

Panic Hardware

EXIT DEVICE



Surface Mounted Panic Hardware



296  
Reversible  
Panic Latch



284  
Double  
Door Set for  
Non-Rebated  
Double Doors



285  
Double  
Door Set  
for Rebated  
Double Doors

Features:

- Non-handed
- CE marked for safety
- Surface mounted
- 38mm wide footprint
- Suitable for doors with narrow stiles
- Microswitch version available
- Standard colours: silver, white with green cross bar and black with red cross bar
- Available in most RAL colours

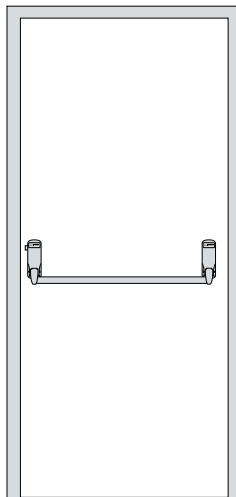

294

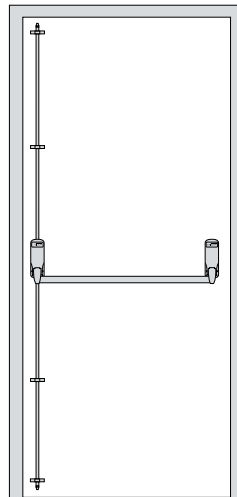

296

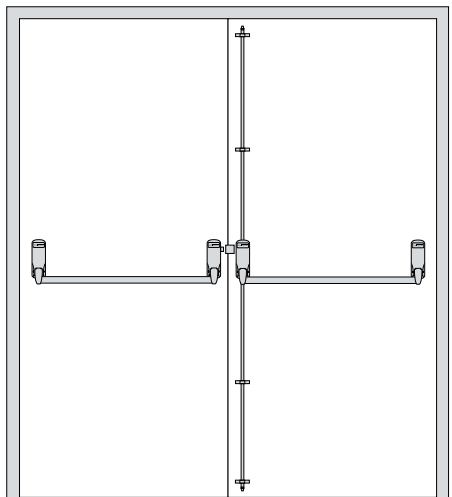

284-5

# ACCESS CONTROLS



COMMERCIAL HARDWARE

Access Control

ELECTRIC STRIKE

## Universal 12/24V DC Electric Strike

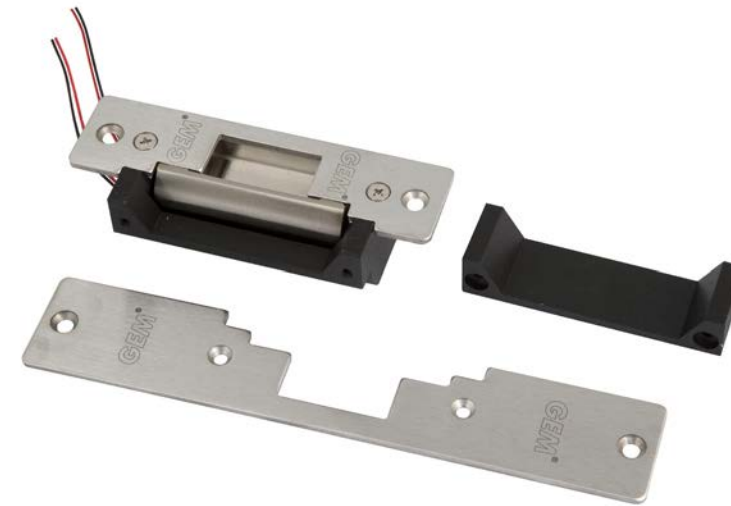

### Features:

- Power Input: 12 V DC (24V DC available by special order)
- Voltage Tolerance:  $\pm 15\%$
- Current Draw: 0.25 A@12 VDC; 0.15 A@24 VDC (at temperature 20°C)
- Sensor Switch monitored output (GK-310M), Rating 2A@125V, indicates the lockset locked or unlocked status
- Operating Temperature: -10~45°C
- Humidity: 0~95% non-condensing
- Lock's surface Temperature (when the power is on):  $\leq$  current temperature +20°C
- 2000 LBS jaw strength pull testing
- Tested to 1,000,000 cycles
- Weight (Approx.) : 400 g

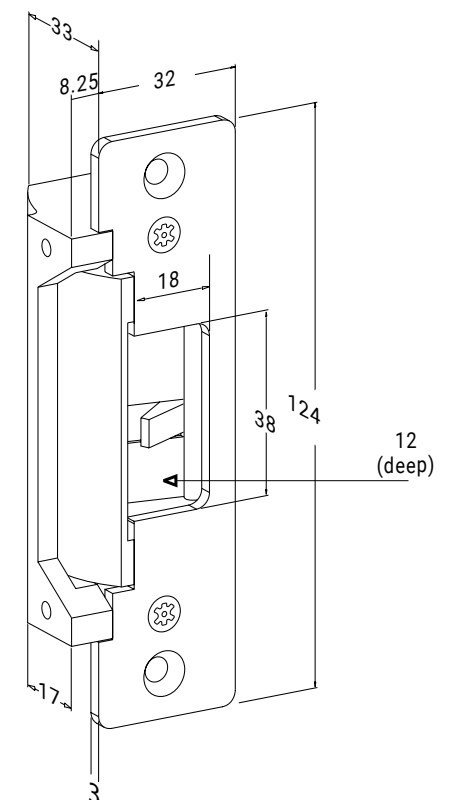

Access Control

ERA HOMEGUARD

Access Control

ERA HOMEGUARD



ERA Smart Home Security

Features:

- High reliability
- Aluminium anodized casing
- MOV provides spike and surge protection
- Dual voltage 12 or 24 VDC (selectable)
- Single voltage only 12 VDC (10002BZ)
- Anti-Residual magnetism function



Invincible Smartphone Dual Network Alarm System

Install the Hub & accessories to your selected locations.

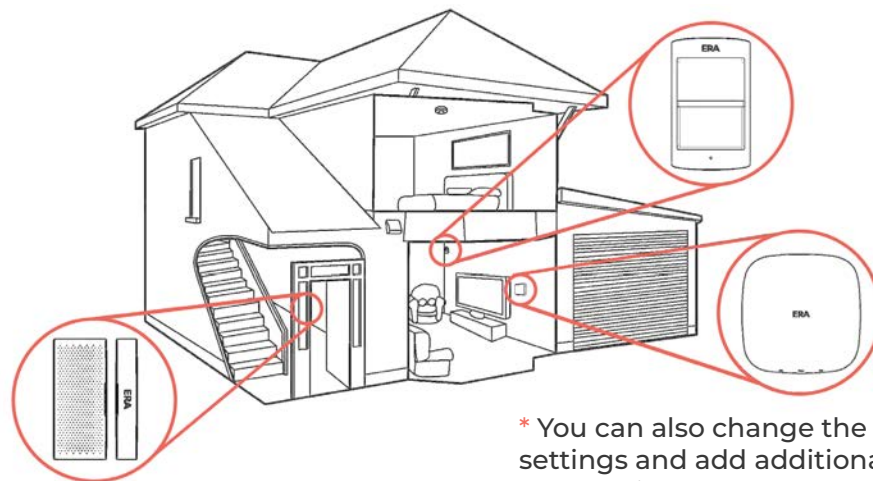

\* You can also change the accessory settings and add additional accessories such as smoke, water & vibration within the APP.

ERA  
Total Security

Accessories

ERA IP116



WIFI Camera

105dB Siren



External Powered Siren

105dB Siren  
(Solar)



Solar Charged Wireless External Siren

Y-Cam



Outdoor Dummy Siren

Y-Cam Protect



Remote Control

PIR Motion Sensor



Pet-Friendly PIR

PIR Sensor



Ceiling PIR Sensor

Magnetic Sensor



Door/Window Magnetic Sensor



Alarm Accessories



Y-Cam Protect  
Outdoor Camera



ERA DoorCam - Smart  
Home WiFi Video Doorbell

## Access Control

## MAGNETS



## 10001 Series Mag Lock

## Product Overview:

- Operating voltage: 12/24 VDC
- Current draw: 500mA/12VDC; 250mA/24VDC (at temperature 20°C)
- Operating temperature: -10~55°C(14~131°F)
- Humidity: 0~95% non-condensing.
- Holding force: Up to 600 lbs(272 Kg)
- Dimensions:
  - Magnet:(L) 250, (W) 42, (D) 26 mm
  - Armature plate:(L) 185, (W) 38, (D) 12 mm
  - Mounting plate:(L) 250, (W) 25, (D) 5 mm
- Net Weight: 2.0 Kg

## Features:

- High reliability
- Aluminium anodized casing
- MOV provides spike and surge protection
- Dual voltage 12 or 24 VDC (selectable) Single voltage only 12 VDC (10002BZ)
- Anti-Residual magnetism function

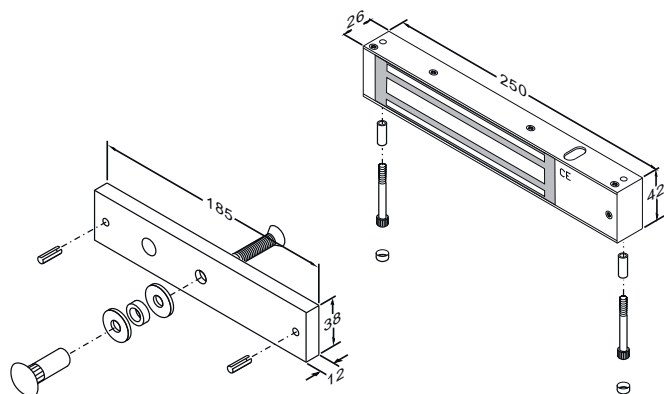

For more technical information  
please email our sales team

## Access Control

## SMART HANDLE



## Yale Conexis L1

## Features:

- Operating temperature -15oC to 55oC
- IP55 weather resistant
- PAS 24 compliant
- Low power consumption - batteries last up to 1 year
- 4 x AA batteries
- 2 year guarantee with UK Customer Support

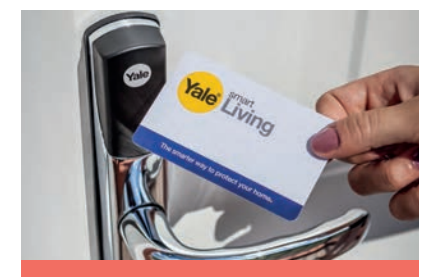
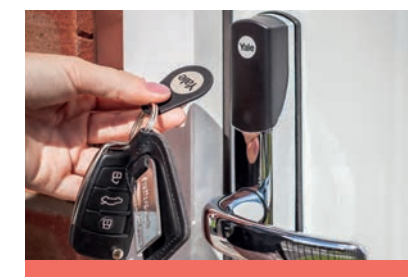



## Access Control

## ELECTRIC STRIKE



## Ultraline Strike

## Features:

- Fail-Safe/Fail-Secure: Field selectable at time of installation.
- Case: Approximately 1" x 3-3/8" x 1-1/16" deep.
- Faceplate: Measures 1-1/4" x 6-7/8". 7430 has flat faceplate.
- Voltage: Field selectable to match power source of 12, 16, or 24 VAC/VDC.
- Finish Available: 626 Clear Anodized



## Sub Cover

## Features:

- This is a lip extension to suit the 7400 Ultraline Electric Strike

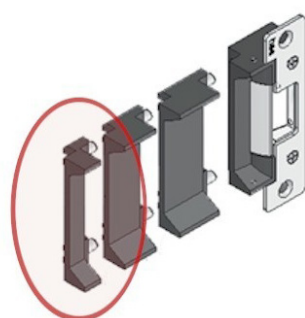

3 Sizes available  
ask more info

## Access Control

## DIGITAL LOCKS



## Digital Lock for Aluminium Doors

## Features:

- Complete with 60mm Stainless Steel Latch
- Suitable for DDA applications
- New & improved clutch and coding chamber design
- Clutched keypad handle
- Cycle tested to 100'000 operation
- Over 2000 code combinations available



## Digital Lock With Optional Holdback

## Features:

- 1000+ combinations
- For internal or external applications
- Simple installation
- Optional holdback
- Suitable for 35-60mm thick doors
- Supplied complete with tubular latch and fixings

# DOOR HINGES



## Hinges

## A BRIEF GUIDE TO HINGES

### STANDARD DOORS

- Is it a fire, smoke or emergency escape door?
- The size and weight of the door?
- Is it an internal or external door; is it near the coast or in a swimming pool?
- Is it to be used in an office environment with minimal use or for higher volume traffic such as a hospital, school or shopping centre?
- Is there any other door hardware to be fitted that may affect performance (ie door closer, door stops).

### FORCES OPERATING ON A DOOR

There are two main forces that the hinge has to cope with. The vertical load; and, as hinged doors are side-hung, the horizontal or lateral load.

The **vertical load** is a direct result of the gross door weight.

The **horizontal load** is created by:

- The door weight
- The door height to width ratio
- Where the hinges are positioned.

The wider the door is in relation to its height, the greater the side load that the hinges and their fixings have to support.

### ADJUSTED DOOR WEIGHT

Hinge specification is also determined by the adjusted door weight. We recommend wherever possible to refer to the actual weight supplied by the door manufacturer.

| Adjusted door weight calculation table |   |              |                        |
|--|---|--------------|------------------------|
| Actual Door Weight                     | Doors of excess width, please refer to Side Loading Calculation table |              | = Adjusted Door Weight |
|  | Door Closer   | +20%         |                        |
|  | Door Closer (Backcheck )  | +75%         |                        |
|  | Extra Heavy Use<br>Light Use  | +10%<br>-10% |                        |

Fig.1

### STANDARD DOORS

The standard positioning when fitting three hinges to a door. This gives the most effective load bearing capability.

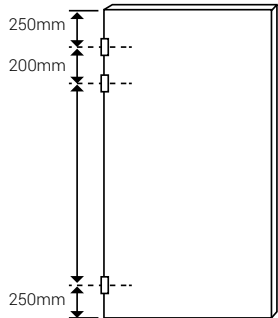

Fig.2

### LIGHTWEIGHT DOORS

Three hinges may be fitted as shown. On doors subject to warping (such as glazed doors), fit a third hinge at the centre of the door.

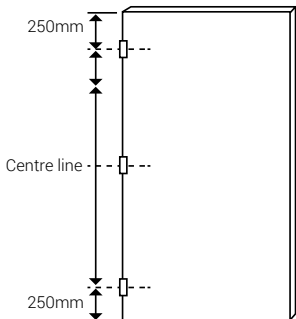

Fig.3

### HEAVY DOORS

When load bearing is the prime consideration, fit four hinges as shown.

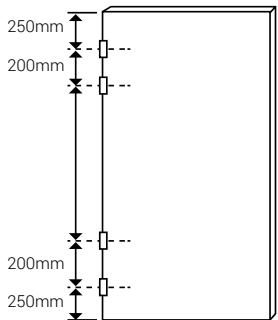
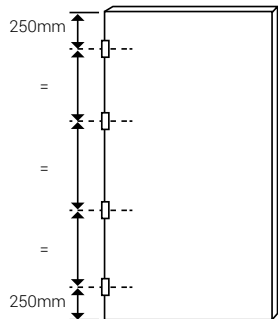

Fig.4

### TALL DOORS (OVER 2100MM)

On all door or those which are particularly subject to warping (such as glazed doors) fit four hinges equally spaced, as shown.



Hinges

DOOR HINGES



Ball Bearing Hinge

Features:

- BS EN 1935 : 2002 Grade 13
- 76 x 50 x 2mm
- 102 x 76 x 3mm
- Radius & Squared Profiles
- Complete with fixings

Finishes:

- SSS, PB, PSS, PCB

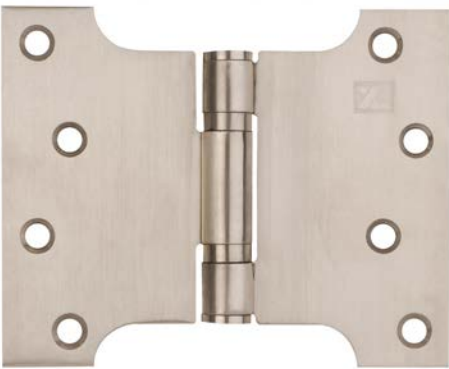

Parliament Hinge

Features:

- Available in various sizes
- Complete with fixings

Finishes:

- SSS, PB, PC

Hinges

DOOR HINGES



Lift-Off Hinge

Features:

- BS EN 1935 : 2002 Grade 11
- 102 x 76 x 3mm
- Stainless steel
- Lift-off hinge
- Left & Right Handed available
- Radius Profile
- Complete with fixings

Finishes:

- SSS, PB, PSS



Rising Butt Hinge

Features:

- 76 x 50 x 2mm
- 102 x 76 x 2.5mm
- Left & Right Handed available
- Complete with fixings

Finishes:

- SSS, PB

Hinges

DOOR HINGES



Square Pivot Hinge

- Features:
- Grade 304 Stainless steel
  - Designed to allow the door to open outwards in the case of an emergency
  - Use with Pivot Emergency Release
  - Maximum door weight 80kg

Finishes:



SSS



Piano Hinge

- Features:
- Complete with fixings
  - Available in various sizes

Finishes:



SSS, PB, PSS

Hinges

DOOR HINGES



UPVC Butt Hinge

- Features:
- Available in flat and angled formats
  - Up to 1.5mm of adjustment to cater for all weather-seal types
  - 115mm Hinge
  - Removable pin for ease of assembly with security grub screw

Finishes:



WHT, BR, BLK



Mini 3D Hinge

- Features:
- 3 way adjustment combining product excellence with ease of fabrication
  - Simple allen key adjustment enables door movement to be compensated

Finishes:



WHT, BR, BLK, PC, G



# BOLTS & LATCHES



COMMERCIAL HARDWARE

## Bolts & Latches

## LATCHES



### Finishes:



SSS, PB, PSS, PCB

## Tubular Latch

### Features:

- Bolt through, with guided latch bolt
- Adjustable strike
- Backset options; 44, 56, 83, 106, 132mm
- Radius & squared profiles



### Finishes:



SC, PC,

## Smart Latch

### Features:

- 57mm Backset Latch (70mm Total)
- Privacy, Passage versions available



### Finishes:



SSS, PB, PSS

## Adjustable Roller Latch

### Features:

- Brass roller latch
- Concealed adjustment
- 45mm depth
- Supplied with matching strike plate and fixing screws

Bolts & Latches

RACK BOLTS



Finishes:

- SSS, PB, PSS, PCB



Suitable with turn & release

Tubular Deadbolt

Features:

- Bolt through, with guided dead bolt
- Backset options; 44, 56, 83, 106, 132mm
- Radius & squared profiles

Bolts & Latches

RACK BOLTS



Finishes:

- SC, PB, PC

Barrel Bolt

Features:

- Heavy duty
- Complete with three keeps & fixings
- 16mm bolt dia.
- Face-fix
- 100, 150, 200, 300, 450, 600 x 38mm



Finishes:

- SC, PB, PC

Indicator Bolt

Features:

- Indicator 40 x 60mm
- Lock 65 x 40mm



Finishes:

- SC, PB, PC

Slide Surface Bolt

Features:

- Simple slide function
- Complete with three keeps & fixings
- Face-fix
- 102, 150, 202 x 36mm



Finishes:

- SC, PB, PC, PCB



Suitable with rack bolt key

Rack Bolt

Features:

- Backsets options; 17, 32mm
- With solid brass bolt
- Complete with fixings

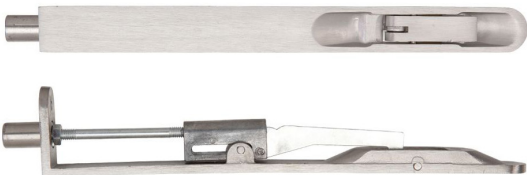

Finishes:

- SSS, PSS



Suitable with Dust Socket

Lever Action Flush Bolt

Features:

- 150, 203, 305, 247, 309, 914 x 20mm
- 11mm dia. bolt
- 15mm bolt throw
- Adjustable bolt throw
- Square & Radius profile

## Bolts &amp; Latches

## FLUSH BOLTS

## Squared Flush Bolt



## Features:

- 130 x 26mm
- Square profile
- With anti-rattle sleeve
- Hardend steel bolt
- Complete with fixings

## Finishes:



SAA

## Bolts &amp; Latches

## TOP CENTRES

## Adjustable Top Centre



## Features:

- Top centre for double action doors
- For timber and metal doors
- Complete with fixing screws
- Centre of pivot 50 mm from end of plate

## FINISHES:



S

## Radius Flush Bolt



## Features:

- Zinc plated with anti-rattle sleeve
- 7mm zinc plated steel rod with 40mm thread length
- Deep finger recess and large lever for easy operation
- Corners 2.5mm radius for easy matching of cut out
- Comes complete with guide

## Finishes:



SAA

## Light Duty Top Centre



## Features:

- Suitable in combination with 4000 and 6000 Series Closers
- Material Die Cast
- Comes with Bottom Pivot

## Finishes:



S

# DOOR ACCESSORIES



COMMERCIAL HARDWARE

## Door Accessories

## LETTER PLATES

### Letter Plate & Extension Sleeve



#### Finishes:



WHT, BLK, PB, SAA

#### Features:

- Full 180 degree opening
- 300mm x 72mm
- Fully weatherproofed outside flap for easy operation
- Blind fixing provides extra security
- The rectangular cut out area eliminates the need for additional fixing holes

### Stainless Steel Letterplates



#### Finishes:



WHT, BLK, G, SSS, PSS

#### Features:

- External flap opens up to 180 degrees
- Fully sprung loaded
- 40/80 depth sleeves options
- Contains external weather-seal and internal draught seal
- Internal nylon brush seal to reduce air filtration
- Complete with fixings



Door Accessories

SIGNAGE



Lettering & Numbers

- Features:
- 50, 75, 100mm
  - Face-fix
  - BS EN 1634-1
  - Other variants are available
  - Complete with fixings

Finishes:  
SSS, PSS



Door Signage

- Features:
- 75mm
  - Face-fix
  - BS EN 1634-1
  - Other variants are available
  - Complete with fixings

Finishes:  
SSS, PSS, SAA

Door Accessories

DOOR STOPS



Finishes:  
SC, PB, PC

Cylinder with Rose

- Features:
- 76mm Projection
  - Face-fix
  - BS EN 1634-1
  - Other variants are available



Finishes:  
SC

Portable Door Stop

- Features:
- Non-slip rubber base
  - Various sizes are available



Finishes:  
SC, PB, PC

Domed Floor Mounted

- Features:
- BS EN 1634-1
  - 31mm cylinder
  - 35mm projection
  - Complete with concealed-fixings

Door Accessories

FLUSH PULLS



Finishes:



Flush Pull

Features:

- 102 x 45mm
- 10mm depth
- Complete with fixings



Finishes:



Half Moon  
Flush Pull

Features:

- 90mm dia.
- 19mm deep
- Complete with fixings



Finishes:



Flush Ring Pull

Features:

- Available in various sizes
- Complete with fixings

Door Accessories

PLATES



Finger Plates

Features:

- Cut to size
- For Internal use
- Pre-Drilled countersunk holes
- Plate thickness 1.2mm

Finishes:



Kick Plates



Features:

- Cut to size
- For internal use
- Pre-drilled countersunk screw holes
- Plate thickness 1.2mm

Finishes:



Door Accessories

DOOR FURNITURE

Door Accessories

CABINET HARDWARE



Door Viewer  
With Glass Lens

Features:

- BS EN 1634-1
- 14mm dia.
- 180 degree angle of vision
- Suitable for 35-55mm doors

Finishes:



Magnetic Catch

Features:

- 45 x 15 x 14mm
- Complete with fixings

Finishes:



Victorian  
Cupboard Knob

Features:

- 25, 32, 38, 45mm knob dia.
- Complete with fixings

Finishes:



Urn Door Knockers

Features:

- Available as 5 or 6" inch
- Available with or without spyhole
- Durable high quality finish
- Includes face fix mounting bracket

Finishes:



Cabinet Pull Handle

Features:

- 96, 128, 160mm fixing centres
- Rear-fix
- Forged brass

Finishes:



Door Accessories

ESCUTCHEONS

Door Accessories

DOOR CHAINS



Finishes:



Blank & Euro Profile

Features:

- 52mm push on rose dia.
- Complete with fixings
- BS EN 1634-1



Finishes:



Heavy Duty Door Chain

Features:

- BS EN 1634-1
- 200mm chain length
- Complete with fixings



Finishes:



Face Fixed & Self Adhesive

Features:

- Self adhesive 67.5 x 30 x 2mm
- Face fixed 70 x 28 x 7mm
- Complete with fixings



Finishes:



Secure Ring Door Restrictor

Features:

- Specially designed for UPVC and composite doors
- Can be fitted in under 5 minutes
- Easy to use & suitable for all abilities
- Feel secure when opening the door



Finishes:



Security PAS24

Features:

- BS EN 1634-1
- 30 & 60min timber door tested
- Rotating cylinder guard
- For Euro Profile cylinder locks
- Hidden fixings



Finishes:



Door Chain Restrictor With Ring

Features:

- Suitable for almost any style of door
- Door chain with locking ring for handle
- No drilling of door required
- Wall mounted keep with extra long screws
- Protects against burglary and theft
- Made from die-cast zinc



# PATCH FITTINGS



Glass

## Standard Assembly Types

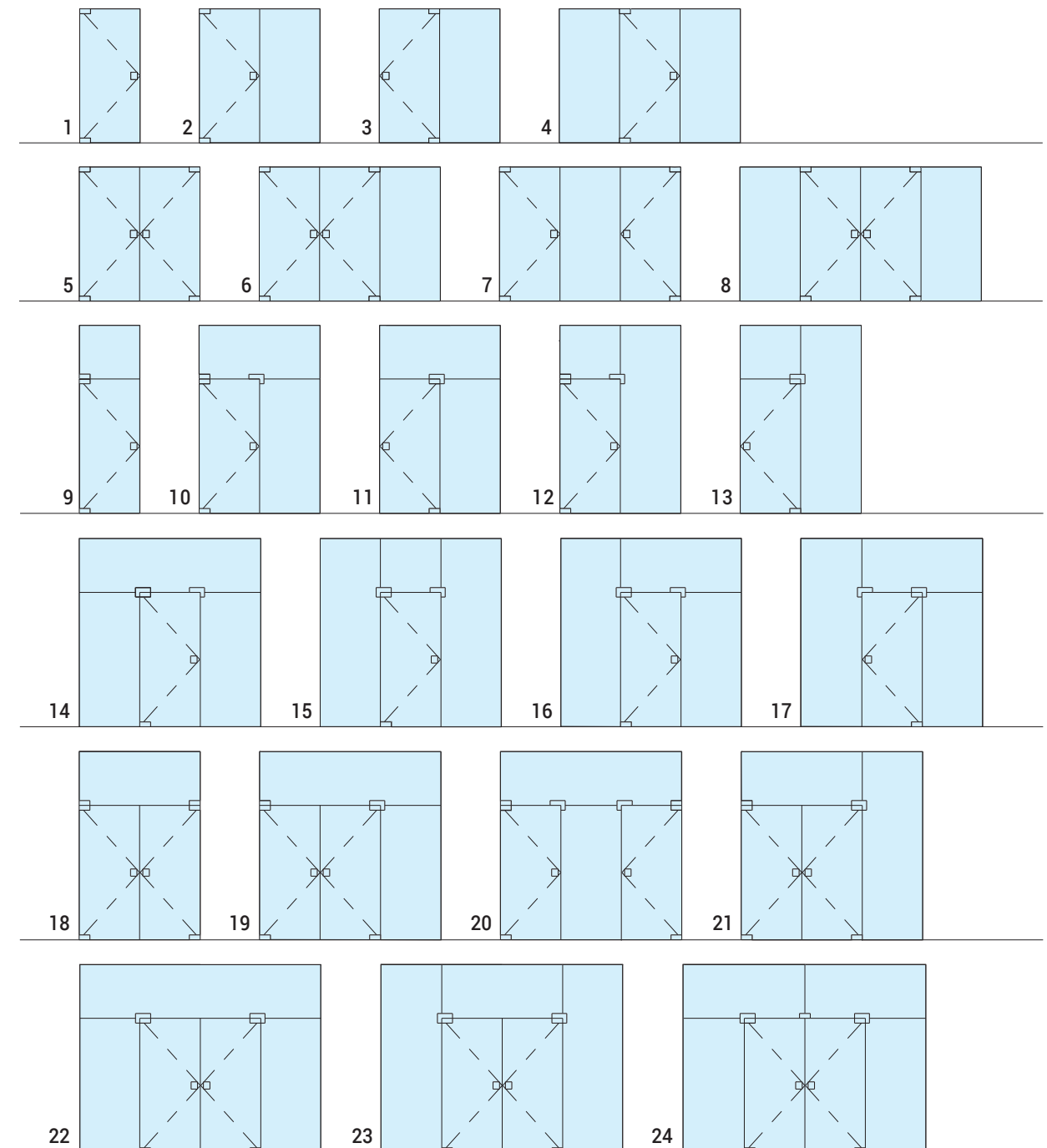

COMMERCIAL HARDWARE

Glass

## PATCH FITTING



## Top Patch

Top Patch

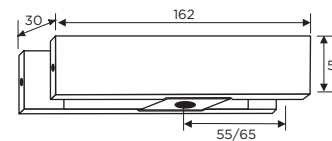
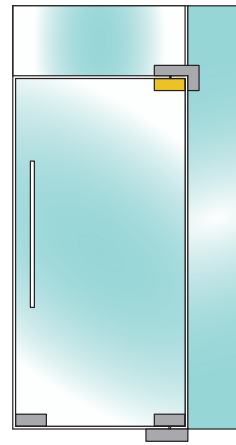

## Features:

- Top patch
- Variable pivot point to 55 to 65mm
- Quick release covers
- Finish: SSS 304
- Dimensions: 162 x 51 x 30mm

Glass

## PATCH FITTING



## Over Panel &amp; Side Panel Patch

Over Panel Connector

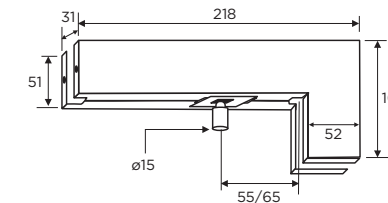
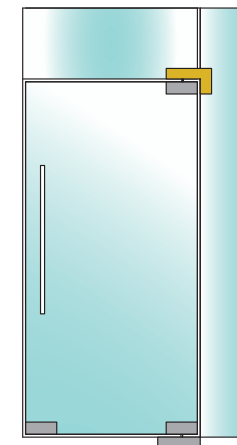

## Features:

- Connects over panel and side panel with Top patch
- Pivot pin 15mm diameter
- Adjustable pivot point 55 to 65mm
- Quick release covers
- Finish: SSS 304
- Dimensions: 218 x 51 x 51mm



## Bottom Patch

Bottom Patch

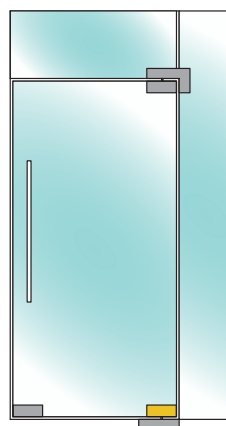

## Features:

- Bottom patch
- Variable pivot point to 55 to 65mm
- Compatible with ozone floor spring fs11400
- Quick release covers
- Base material casting: aluminium alloy
- Finish: SSS 304
- Dimensions: 162 x 51 x 30mm



Over Panel and Side Panel Connector (Lock Strike)

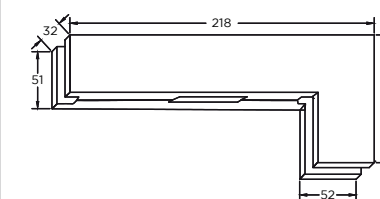
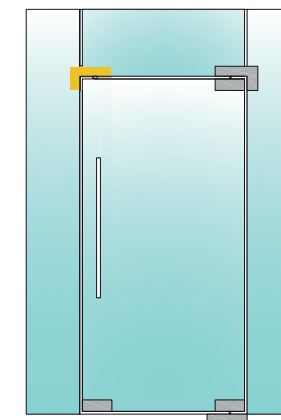

## Over Panel &amp; Side Panel Strike Box

## Features:

- Over panel and side panel connector patch with strike insert for opl-1
- Quick release covers
- Finish: SSS 304
- Dimensions: 218 x 51 x 32mm

Glass

## PATCH FITTING

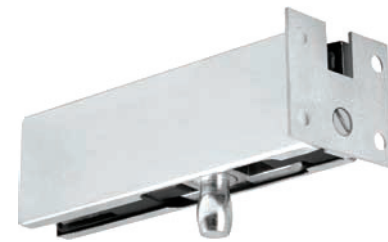

### Over Panel Patch with Wall Plate

Over Panel Wall Patch

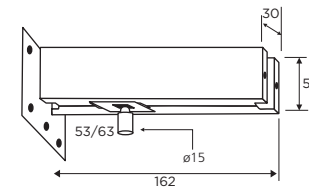
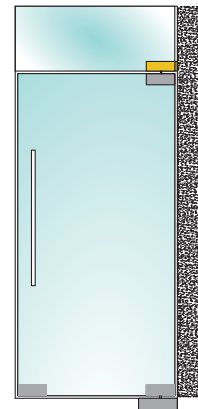

#### Features:

- Pivot pin 15mm diameter
- Over panel patch secured on-to sidewall
- Quick release covers
- Base material casting: aluminium alloy
- Finish: SSS 304
- Dimensions: 162 x 51 x 30mm

Glass

## PATCH FITTING



### Top & Bottom Rail

#### Features:

- To suit glass thickness 10/12mm
- Rails can be cut to size
- 80mm / 100mm options available
- Finishes: SSS, SIM SS

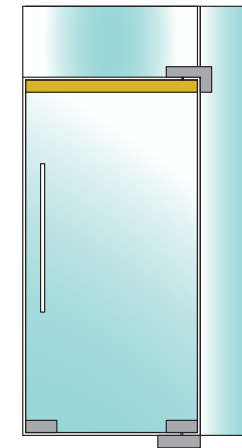

### Corner Patch Lock Strike

Corner Patch Lock Strike

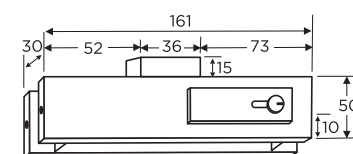
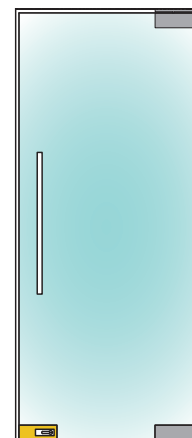

#### Features:

- Corner patch lock
- With a Euro profile cylinder and strike plate
- Dead bolt projection 15mm (single throw)
- Three high security computer keys
- Base material casting: aluminium alloy
- Quick release covers
- Finish: sss 304
- Dimensions: 161 x 50 x 30mm



### Top & Bottom Rail with Lock

#### Features:

- To suit glass thickness 10/12mm
- Rails can be cut to size
- 80mm / 100mm options available
- Finishes: SSS, SIM SS

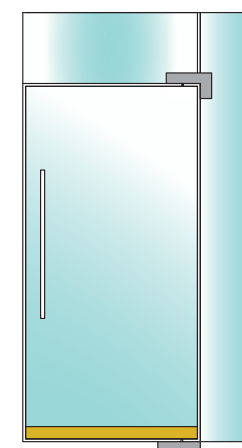

Glass

## PATCH FITTING



Center Patch Lock

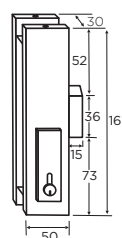
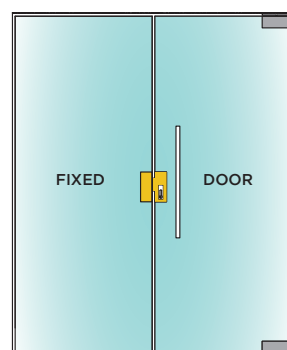

## Centre Lock

## Features:

- Centre Patch Lock
- With a Euro Profile Cylinder and Strike Box
- Dead Bolt Projection 15mm (Single Throw)
- Three High Security Computer Keys
- Base material casting: Aluminium Alloy
- Quick release covers
- Finish: SSS 304
- Dimensions: 161 x 50 x 30mm

Glass

## PATCH FITTING



Magnetic Lock Set

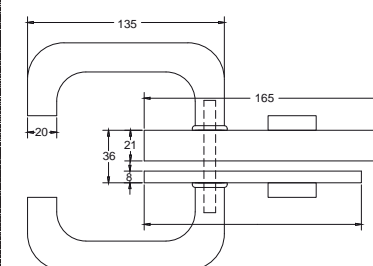
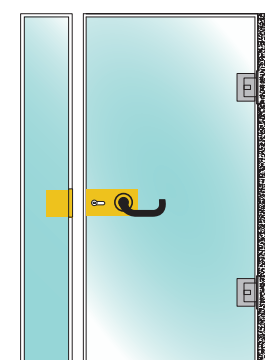

## Magnetic lock set

## Features:

- Top patch
- Variable pivot point to 55 to 65mm
- Quick release covers
- Finish: SSS 304
- Dimensions: 162 x 51 x 30mm



Center Patch Strike

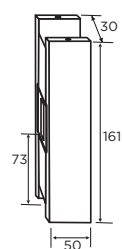
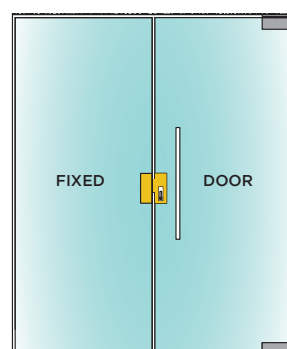

## Centre Strike

## Features:

- Strike box accepts OPL-2A dead bolt
- Base material casting: Aluminium alloy
- Quick release covers
- Finish: SSS 304
- Dimensions: 161 x 50 x 30mm



Magnetic Lock with Accessories

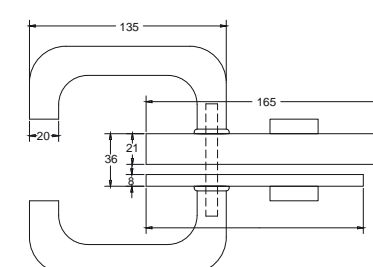
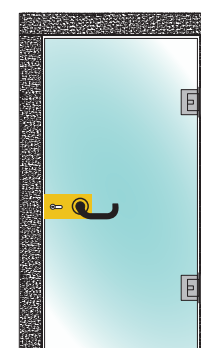

## Magnetic lockset with accessories

## Features:

- Bottom patch
- Variable pivot point to 55 to 65mm
- Compatible with ozone floor spring FS11400
- Quick release covers
- Base material casting: Aluminium Alloy
- Finish: SSS 304
- Dimensions: 162 x 51 x 30mm



Glass

## PATCH FITTING



## Handle Set

## Features:

- Return Style Handle
- Aluminium Alloy
- Finish: SSS 304

Handle Set

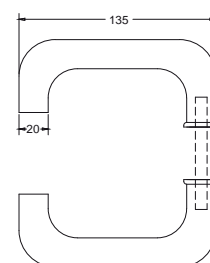
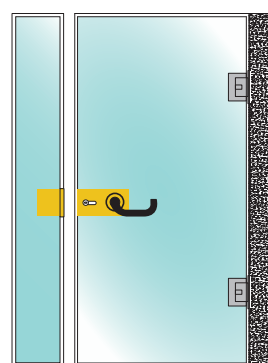

Glass

## PATCH FITTING



Stainless Steel Top Pivot

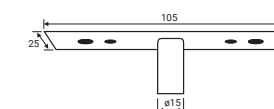
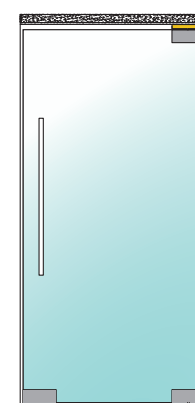

## Stainless Steel Top Pivot

## Features:

- Stainless steel pivot
- Wear resistant pivot pin
- Pivot held in overhead structure
- Material: stainless steel grade 304
- Finish: SSS 304
- Dimensions: 105 x 25mm

## Latch Body Only

## Features:

- Thumb or key turn options
- Max Glass Thickness 10-12mm
- Tested for 200,00 Cycles

Latch Body Only

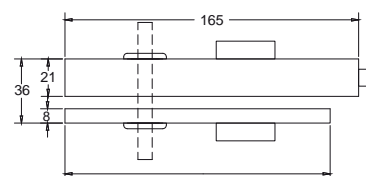
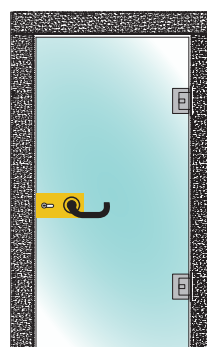

Bottom Free Swing Pivot

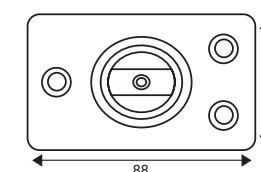
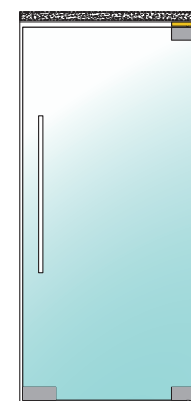

## Bottom Free Swing Pivot

## Features:

- Mini floor hinge
- 360° Smooth door movement
- Suitable for OPF-3
- Finish: SSS 304
- Dimensions: 88 x 55mm

# WINDOW HARDWARE

---



COMMERCIAL HARDWARE



**Cockspur  
Handle**

Page 111

**Espag  
Handle**

Page 111

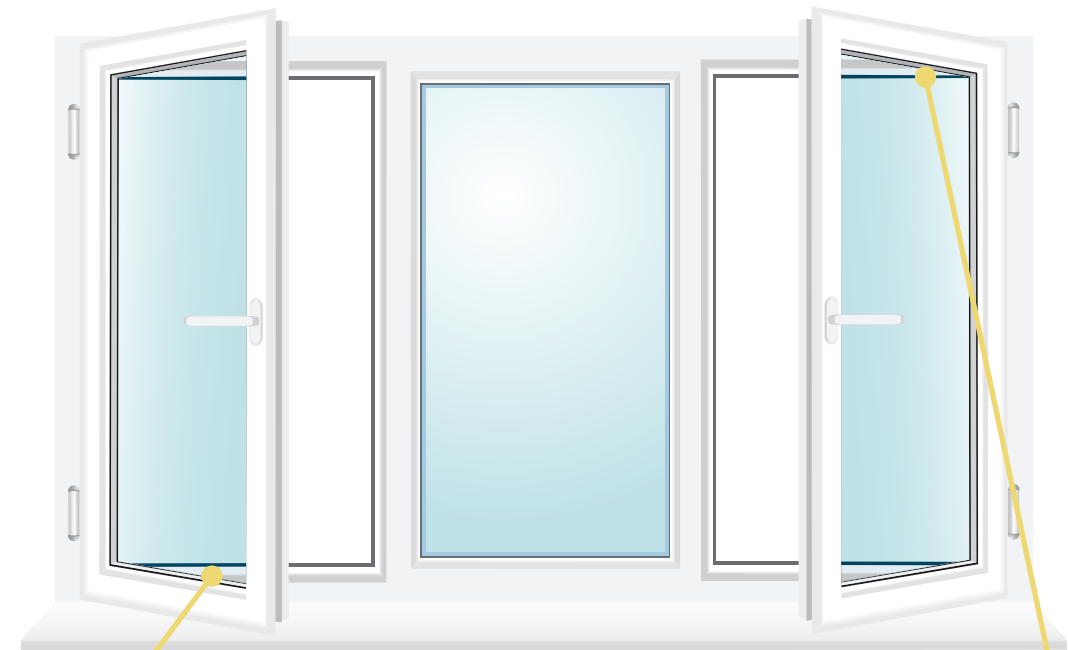

**Restrictor  
Stay**

Page 110



**Friction  
Hinge**

Page 108



Friction Stay

Features:

- A range of top and side hung variants
- Side hung - 12" and 16", Top hung - 8" - 24"
- Manufactured from high quality 430 grade Stainless Steel
- Adjustable slider to suit both loading & environmental conditions
- Achieves in excess of 3Kn loading to BS7950:1997 when fitted with steel Anti-Jemmy
- 13 & 17mm stack height variants suitable for all popular profiles
- Sold in pairs
- Austenitic variant available on application

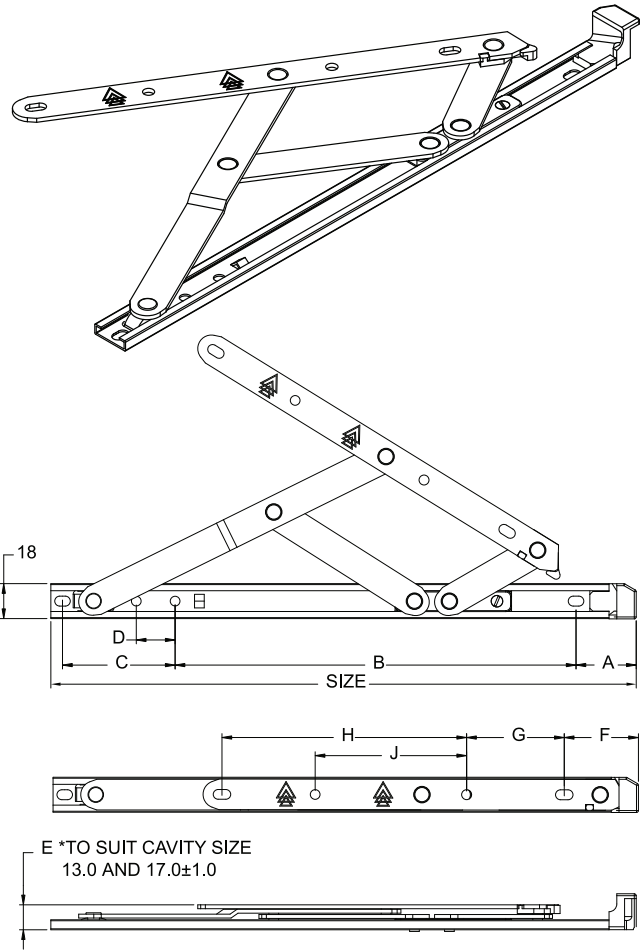

\* For sizing please contact CHL

FRICTION STAY - DIMENSIONS

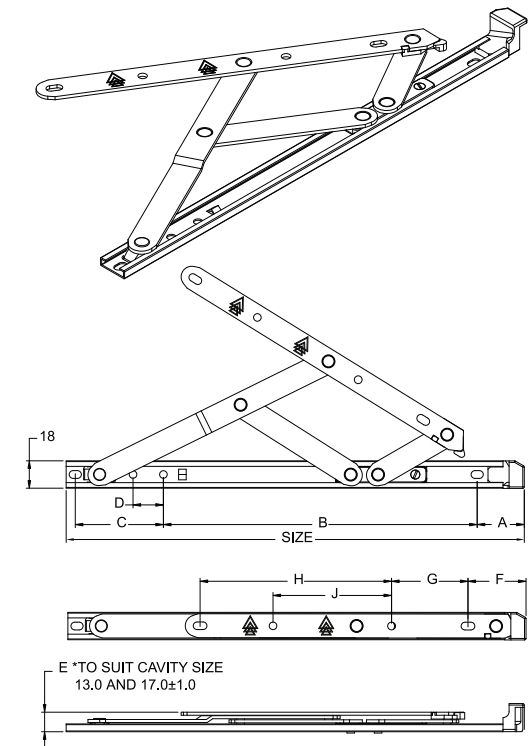

| DIMENSIONS - MM |        |      |       |       |       |       |      |       |       |      |
|-----------------|--------|------|-------|-------|-------|-------|------|-------|-------|------|
|                 | SIZE   | A    | B     | C     | D     | E     | F    | G     | H     | J    |
| SIDE HUNG       | 12"    | 30.5 | 193.0 | 71.0  | -     | 13/17 | 37.5 | 71.0  | 99.0  | -    |
|                 | 16"    | 30.5 | 242.5 | 121.0 | 49.0  | 13/17 | 36.0 | 120.5 | 98.5  | -    |
| TOP HUNG        | 8"     | 30.5 | 131.0 | 34.0  | -     | 13/17 | 37.5 | 10.0  | 122.0 | -    |
|                 | 10"    | 30.5 | 176.0 | 38.0  | -     | 13/17 | 37.5 | 28.5  | 126.5 | -    |
|                 | 12"    | 30.5 | 206.0 | 58.0  | -     | 13/17 | 37.5 | 51.0  | 126.5 | -    |
|                 | 16"    | 30.5 | 242.5 | 121.0 | 49.0  | 13/17 | 36.0 | 120.5 | 98.5  | -    |
|                 | 20"    | 30.5 | 209.5 | 252.5 | 115.5 | 13/17 | 36.0 | 170.5 | 99.0  | -    |
|                 | 24"    | 30.5 | 209.5 | 352.5 | 165.5 | 13/17 | 36.0 | 220.5 | 99.0  | -    |
|                 | 24" HD | 30.5 | 209.5 | 352.5 | 165.5 | 13/17 | 36.0 | 125.5 | 104   | 95.0 |

PRODUCT CODES

|           | STACK HEIGHT |      | SIZE (") | OPEN ANGLE (0) | MAX WEIGHT (KG) | MAX VENT SIZE (MM) W X H |
|-----------|--------------|------|----------|----------------|-----------------|--------------------------|
|           | 13mm         | 17mm |          |                |                 |                          |
| SIDE HUNG | ✓            |      | 12       | 60             | 22              | 600 X 1200               |
|           |              | ✓    | 12       | 60             | 22              | 600 X 1200               |
|           | ✓            |      | 16       | 60             | 24              | 650 X 1200               |
|           |              | ✓    | 16       | 60             | 24              | 650 X 1200               |
| TOP HUNG  | ✓            |      | 8        | 80             | 12              | 1200 X 350               |
|           |              | ✓    | 8        | 80             | 12              | 1200 X 350               |
|           | ✓            |      | 10       | 85             | 14              | 1200 X 400               |
|           |              | ✓    | 10       | 85             | 14              | 1200 X 400               |
|           | ✓            |      | 12       | 85             | 16              | 1200 X 550               |
|           |              | ✓    | 12       | 85             | 16              | 1200 X 550               |
|           | ✓            |      | 16       | 60             | 20              | 1200 X 800               |
|           |              | ✓    | 16       | 60             | 20              | 1200 X 800               |
|           | ✓            |      | 20       | 45             | 24              | 1200 X 900               |
|           |              | ✓    | 20       | 45             | 24              | 1200 X 900               |
|           | ✓            |      | 24       | 40             | 27              | 1200 X 1000              |
|           |              | ✓    | 24       | 40             | 27              | 1200 X 1000              |
|           | ✓            |      | 24       | 40             | 35              | 1200 X 1200              |
|           |              | ✓    | 24       | 40             | 35              | 1200 X 1200              |

Window Hardware

WINDOW RESTRICTORS



Finishes:  
SSS

Restrictor Stay

- Features:
- Manufactured in austenitic stainless steel
  - Maximum corrosion resistance to ensure durability
  - Screws into eurogroove to supplement existing devices
  - Can be used as an add-on security solution that can be retrofitted
  - Available in a variety of stud heights to suit different profiles

Window Hardware

COCKSPUR HANDLES



Finishes:  
PVC, PB, GG, BR, PC, SC, G

Inline Espag Locking Handle

- Features:
- Modern contemporary handle suitable for windows fitted with an espagnolette lock
  - Ergonomically designed flush button with key deadlocking for security
  - Heavy duty sprung latch creates a positive click on closing giving you peace of mind the window is locked
  - Fully suites to our Perfectly Matching range of hardware available in 10 finishes



Finishes:  
WHT, G, BR, PC

Safety Locking Restrictor Cable

- Features:
- Classified in accordance with BS EN: 13126-1: 2011 (includes BS EN 13126-5) Grade 3 Impact Resistance, for building hardware restricted devices on windows and doors
  - Compliant child resistant locking device for windows and balcony doors in accordance with BS EN 16281: 2013
  - Suitable for domestic and commercial applications and for PVCu, Timber and Aluminium windows and doors.



Finishes:  
SC, PB, BK, PC

Cockspur Locking Window Handle

- Features:
- Designed with a slender grip, the cockspur has been engineered with a simple release button
  - Universal handle suitable for replacing on existing cockspur handles
  - Available in two nose heights with a selection of wedges to suit alternatives windows
  - Suitable for pvcu, timber and aluminium casement windows



# WINDOW CONTROL



COMMERCIAL HARDWARE

## Window Control

## WINDOW CONTROL

### Window Types



### Installation Examples

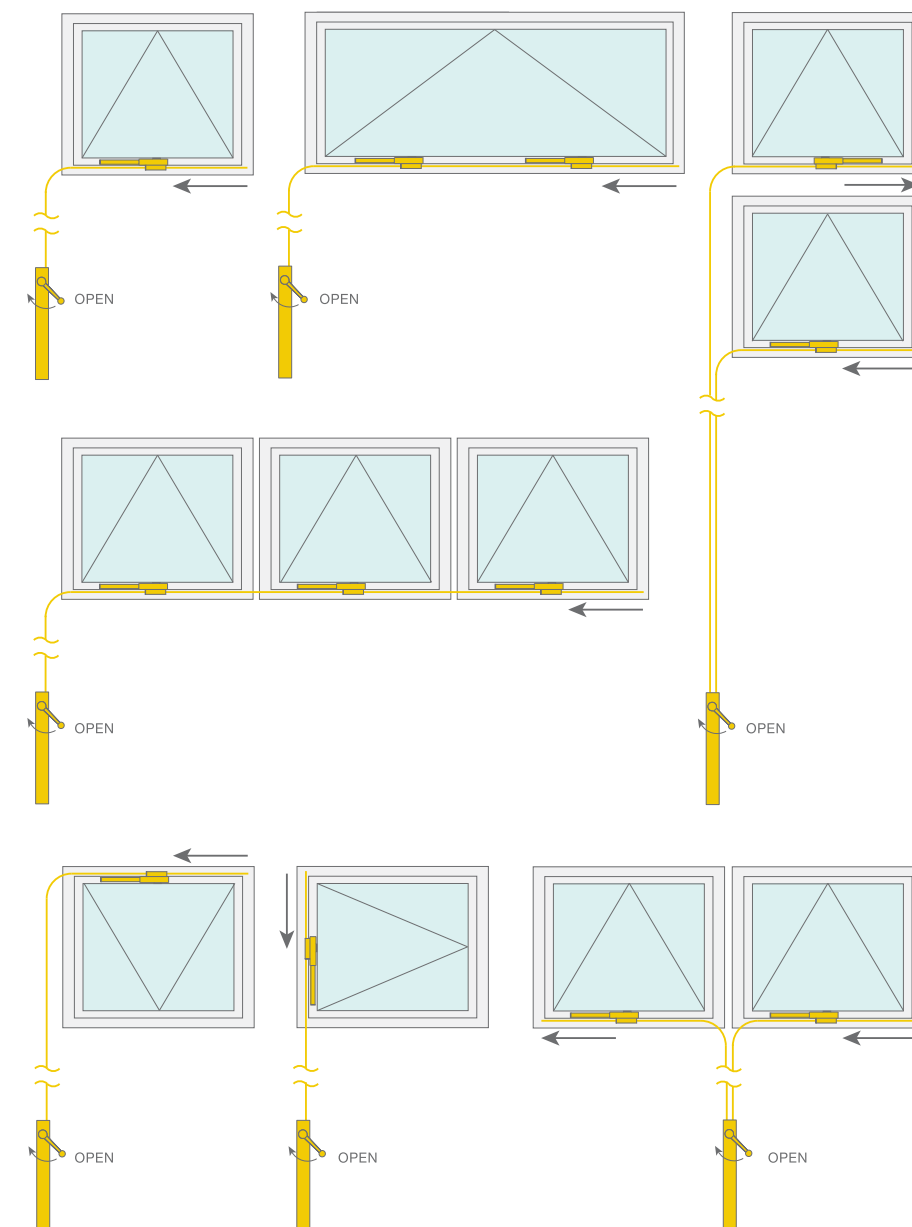

Window Control

ELECTRONICALLY OPERATED

Electric Actuator Opener



Window Type;



Top-Hung  
Awning



Bottom-Hung  
Hopper

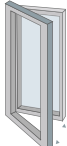

Side-Hung  
Casement

Features:

- 100-400mm opening stroke (adjustable)
- Suitable for most window types
- Double link chain (stainless steel)
- Supplied with 1.5m cable
- Available as 24 & 230V DC

Finishes:

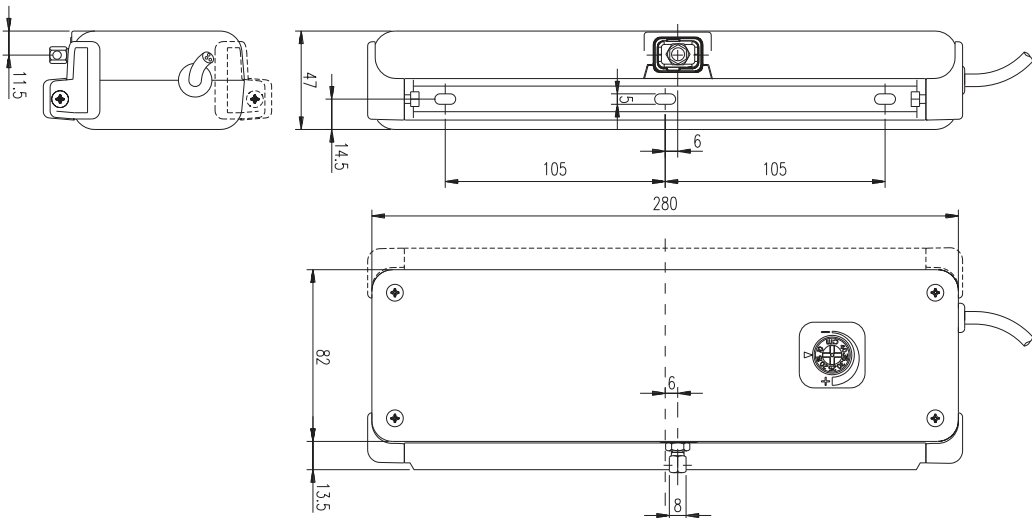

Window Control

ELECTRONICALLY OPERATED

Controls & Accessories



Rocker Switch



Control Unit (Radio)



Control Unit & Weather  
Station



Key Switch



24V DC Transformer



24V DC Transformer  
(Radio)



Control Unit



Control Unit



Window Control

## MANUALLY OPERATED

## Operator Handles

## Features:

- For use with manual chain openers to operate high level windows
- Standard & Heavy duty options available
- Available in White, Grey & Black



## Chain Openers

## Features:

- For use with manual operating handles to open high level windows
- Available as 250 or 380mm opening stroke (adjustable)
- Available in White, Grey & Black



## Conduit &amp; Cable

## Features:

- Conduit supplied in 3M lengths (can be cut to size)
- Inner steel cable which fits inside the conduit to drive the gearbox of the operator (can be cut to size)
- Conduit available in White, Grey & Black



Window Control

## MANUALLY OPERATED

## Conduit Tools

## Features:

- Conduit Tool used to form groove in the end of the conduit
- Conduit former to bend conduit to the correct radius to ensure smooth operation



## Saddle Clips &amp; Connectors

## Features:

- Saddle bracket to fix conduit to window frame or wall
- Conduit connector to connect two lengths of conduit together for longer conduit runs



## Fixing Brackets for Chain Openers

## Features:

- Bracket to fix to Chain Openers onto window
- Brackets available to suit UPVC, Aluminium, timber & bottom hung windows
- Available in White, Grey & Black



# JIGTECH

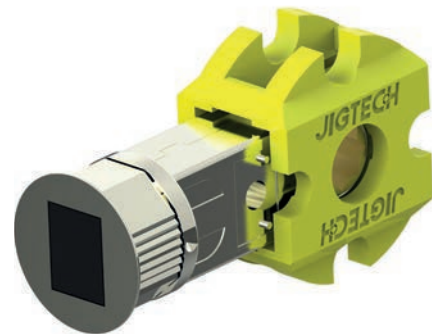

COMMERCIAL HARDWARE

**JIGTECHPRO**<sup>TM</sup>  
THE SMART DOOR HANDLE FITTING SYSTEM

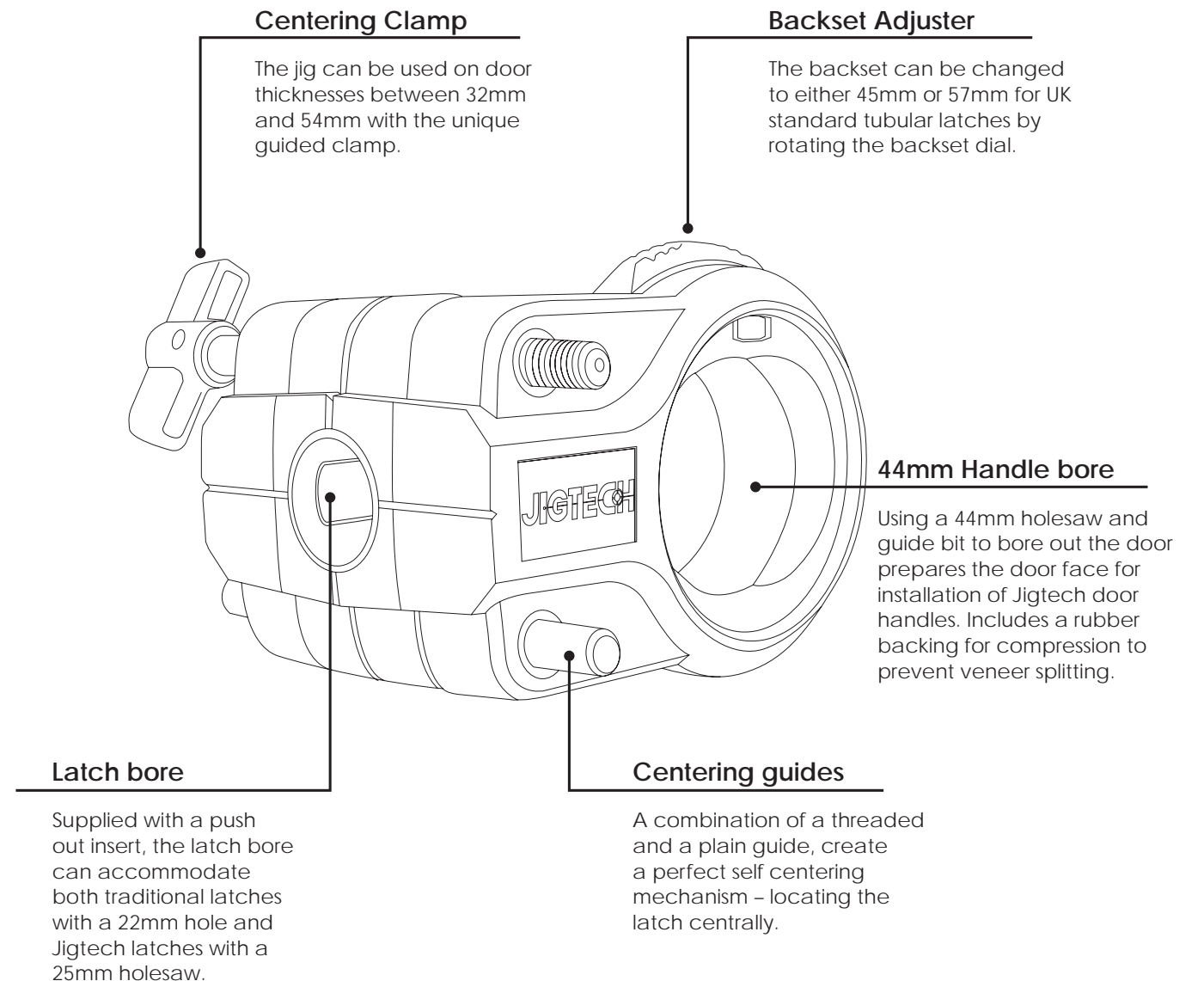

## What's included?

The Jigtech Pro Installation Kit is a premium quality product. Supplied in a robust carry case, containing the full range including: the jig, holesaws and arbors, spade bit and unique latch tappers and keep locators for the professional installer.

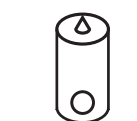

KEEP  
LOCATOR



LATCH  
TAPPER



SPADE BIT



JIG



25MM  
HOLESAW  
& ARBOR



44MM  
HOLESAW  
& ARBOR



JIGTECH

LEVER HANDLES

Premium Range

Solar Lever

- Available as push button privacy (sold separately)
- Factory assembled for fast fitting
- Suits 35-44mm door thickness
- 54mm fixing packs available
- Grub screw fix rose
- Door width marked spindle for ease

Available in: PCP SCP ANB BNKL



Ultro Lever

Available in: PCP SCP DUAL FINISH



Harrier Lever

Available in: PCP SCP DUAL FINISH



Eden Lever

Available in: PCP SCP



Viper Lever

Available in: PCP SCP



Sabre Lever

Available in: PCP SCP



Condor Lever

Available in: PCP SCP

|               | PCP     | SCP     | ANB     | BLNK    | PCP/SCP<br>DUAL FINISH | PEB |
|---------------|---------|---------|---------|---------|------------------------|-----|
| SOLAR LEVER   | JTFI000 | JTFI200 | JTFI600 | JTFI400 | •                      | •   |
| ULTRO LEVER   | •       | •       | •       | •       | JTFI065                | •   |
| HARRIER LEVER | •       | •       | •       | •       | JTFI070                | •   |
| EDEN LEVER    | JTFI015 | JTFI215 | •       | •       | •                      | •   |
| VIPER LEVER   | JTFI010 | JTFI210 | •       | •       | •                      | •   |
| SABRE LEVER   | JTFI005 | JTFI205 | •       | •       | •                      | •   |
| CONDOR LEVER  | JTFI020 | JTFI220 | •       | •       | •                      | •   |

JIGTECH

LEVER HANDLES

Contract Range



Cresta Lever

- Available as push button privacy (sold separately)
- Factory assembled for fast fitting
- Suits 35-44mm door thickness
- 54mm fixing packs available
- Grub screw fix rose
- Door width marked spindle for ease

Available in: PCP SCP



Vecta Lever

Available in: PCP SCP



Riva Lever

Available in: PCP SCP



Parma Lever

Available in: PCP SCP DUAL FINISH

|              | PCP     | SCP     | ANB | BLNK | PCP/SCP<br>DUAL FINISH | PEB |
|--------------|---------|---------|-----|------|------------------------|-----|
| CRESTA LEVER | JTC2000 | JTC2200 | •   | •    | •                      | •   |
| VECTA LEVER  | JTC2020 | JTC2220 | •   | •    | •                      | •   |
| RIVA LEVER   | JTC2025 | JTC2225 | •   | •    | •                      | •   |
| PARMA LEVER  | •       | •       | •   | •    | JTC2065                | •   |



JIGTECH

TUBULAR LATCHES

Smart Latches

The full range of latches and bolts are supplied with a Jigtech spacer in attractive visual packaging. A comprehensive array of finishes are available in smart and rectangular forends, both mechanical and soft strike magnetic function can be specified. All latches are available in push button privacy function, for use with Jigtech privacy cover roses.

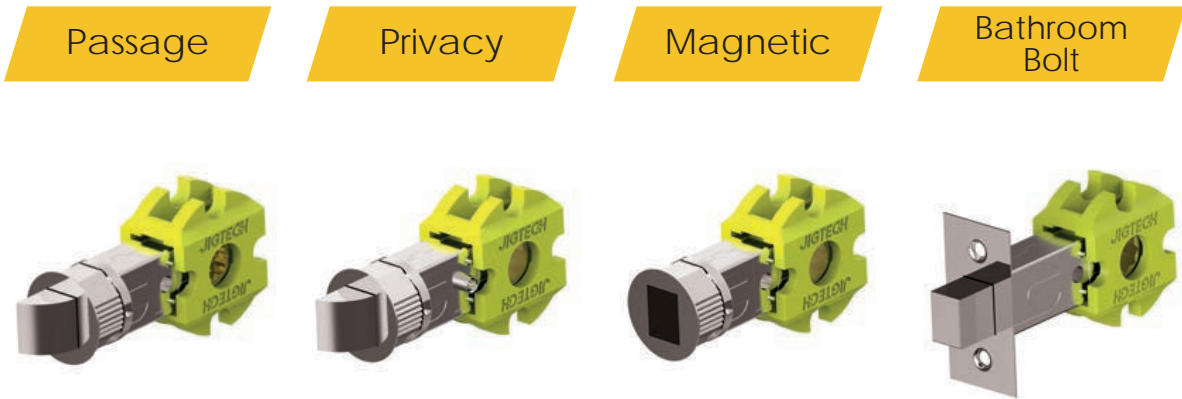

Suitable for passage doors, the fast fit Jigtech latch is supplied with both rectangular and round keeps for use on new or existing frames.

An ideal alternative to a bathroom lock, push button privacy is quick to install. Emergency unlocking through the external rose operating a concealed push button.

Introducing the Jigtech soft strike magnetic latch range. Featuring soft buffered closing and concealed dead bolts, magnetic latches are available in both passage and privacy.

Suitable for bathroom doors, the bathroom bolt series is used in conjunction with Jigtech fast fit bathroom turn and release sets. Supplied with a 5mm spindle.

Features and Benefits

All Jigtech latches are supplied with Jigtech spacers as standard in a high quality branded pouch bag with fitting instructions.

Every smart latch is supplied with both round and rectangular strike plates and tidies. Magnetic smart latches are supplied with buffered round and rectangular strike plates and tidies as standard.

Magnetic smart latches are also supplied with frame buffers and drill bits for soft close frame contact.

Push button privacy covers available - see the accessory section.

JIGTECH

TUBULAR LATCHES

Smart Latches

**Smart Standard Passage**

- Compatible with Jigtech door furniture
- Available in 45mm and 57mm backset
- Supplied with both round and standard keep

Available in: PCP SCP BNKL PEB ANB

**Smart Standard Bathroom Bolt**

Available in: PCP SCP BNKL PEB ANB

Only available in 57mm backset

**Smart Standard Privacy Passage**

Available in: PCP SCP BNKL PEB ANB

Only available in 57mm backset

**Standard Passage**

Available in: PCP SCP BNKL PEB ANB

**Standard Bathroom Bolt**

Available in: PCP SCP BNKL PEB ANB

Only available in 57mm backset

**Standard Privacy Passage**

Available in: PCP SCP BNKL PEB ANB

Only available in 57mm backset

|                                | PCP     |         | SNP     |         | BNKL    |         | PEB     |         | ANB     |         |
|--------------------------------|---------|---------|---------|---------|---------|---------|---------|---------|---------|---------|
|                                | 45mm    | 57mm    | 45mm    | 57mm    | 45mm    | 57mm    | 45mm    | 57mm    | 45mm    | 57mm    |
| SMART STANDARD PASSAGE         | JTL4021 | JTL4020 | JTL4221 | JTL4220 | JTL4321 | JTL4320 | JTL4421 | JTL4420 | JTL4521 | JTL4520 |
| SMART STANDARD BATHROOM BOLT   | •       | JTL4023 | •       | JTL4223 | •       | JTL4323 | •       | JTL4423 | •       | JTL4523 |
| SMART STANDARD PRIVACY PASSAGE | •       | JTL4022 | •       | JTL4222 | •       | JTL4322 | •       | JTL4422 | •       | JTL4522 |
| STANDARD PASSAGE               | JTL4001 | JTL4000 | JTL4201 | JTL4200 | JTL4301 | JTL4300 | JTL4401 | JTL4400 | JTL4501 | JTL4500 |
| STANDARD BATHROOM BOLT         | •       | JTL4003 | •       | JTL4203 | •       | JTL4303 | •       | JTL4403 | •       | JTL4503 |
| STANDARD PRIVACY PASSAGE       | •       | JTL4002 | •       | JTL4202 | •       | JTL4302 | •       | JTL4402 | •       | JTL4502 |

JIGTECH

TUBULAR LATCHES

Magnetic Latches

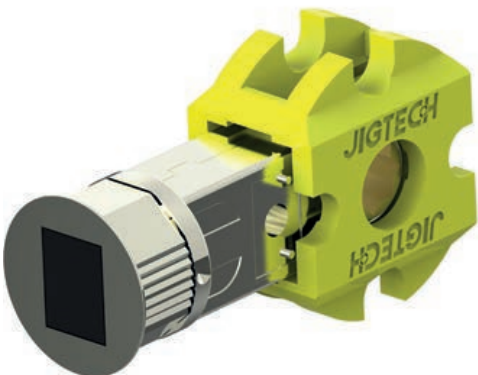

Smart Magnetic Passage

- Compatible with Jigtech door furniture
- Available in 45mm and 57mm backset
- Supplied with both round and standard keep

Available in: PCP SNP



Smart Magnetic Privacy

Available in: PCP SNP

Only available in 57mm backset



Magnetic Passage

Available in: PCP SNP

Available in 45mm & 57mm Backset



Magnetic Privacy

Available in: PCP SNP

Only available in 57mm backset

|                        | PCP     |         | SNP     |         | BNKL |      | PEB  |      | ANB  |      |
|------------------------|---------|---------|---------|---------|------|------|------|------|------|------|
|                        | 45mm    | 57mm    | 45mm    | 57mm    | 45mm | 57mm | 45mm | 57mm | 45mm | 57mm |
| SMART MAGNETIC PASSAGE | JTL4061 | JTL4060 | JTL4261 | JTL4260 | •    | •    | •    | •    | •    | •    |
| SMART MAGNETIC PRIVACY | •       | JTL4062 | •       | JTL4262 | •    | •    | •    | •    | •    | •    |
| MAGNETIC PASSAGE       | JTL4041 | JTL4040 | JTL4241 | JTL4240 | •    | •    | •    | •    | •    | •    |
| MAGNETIC PRIVACY       | •       | JTL4042 | •       | JTL4242 | •    | •    | •    | •    | •    | •    |

JIGTECH

ACCESSORIES

Jigtech Pro Accessories

Jigtech accessories feature two product ranges; replacement tools for installation, and door furniture accessories for push button privacy latches and bathroom turns.

Accessories are supplied in Jigtech brand stand up pouch bags for optimal display and presentation.



25mm Holesaw & Arbor

- Full replacement set of 25mm holesaw and arbor for use with the Jigtech system



Keep Locator

- Specially designed tool for aligning the keep to the latch bolt



32mm Spade Bit

- 32mm Spade Bit
- Pre-marked depth gauge for accurate keep depth drilling



Latch Tapper

- Specially designed tool for flush fitting all latch types into door borehole

|                             |         |
|-----------------------------|---------|
| 44mm HOLES AW & ARBOR       | JTA5011 |
| 44mm HOLES AW               | JTA5002 |
| 25mm HOLES AW & ARBOR       | JTA5010 |
| 25mm HOLES AW               | JTA5001 |
| 32mm SPADE BIT              | JTA5003 |
| KEEP LOCATOR & LATCH TAPPER | JTA5103 |



Escutcheons



Round Bathroom Turn

- Factory assembled for fast fitting
- Suits 35-44mm door thickness
- 54mm fixing packs available
- Grub screw fix rose
- Supplied with 5mm spindles



Round Privacy Rose Cover

- Converts passage to privacy function
- Compatible with Jigtech privacy latches
- Supplied as a pair
- Grub screw fix



Square Bathroom Turn

- Fits over round base roses to convert to square privacy roses
- Compatible with Jigtech privacy latches
- Supplied as a pair
- Grub screw fix



Square Rose Cover Passage & Privacy

- Fits over round base roses to convert to square passage or privacy roses
- Compatible with Jigtech passage and privacy latches
- Supplied as a pair
- Grub screw fix

Features and Benefits

Jigtech bathroom turn release sets and Jigtech Privacy are the fast fitting alternative to bathroom locks.

Bathroom turn and release sets feature the unique Jigtech sleeves for fast fitting and perfect alignment. Prepare the door with the Jigtech jig and then fit with a Jigtech bathroom dead bolt.

Privacy rose covers are used with Jigtech privacy latches. A cover pack and privacy latch is used to convert passage to privacy. Every passage set base rose is drilled to suit a privacy rose cover.

|                           | PCP     | SCP     | BNKL    | ANB     | PCP/SCP DUAL FINISH |
|---------------------------|---------|---------|---------|---------|---------------------|
| ROUND BATHROOM TURN       | JTA5500 | JTA5501 | JTA5503 | JTA5505 | JTA5510             |
| ROUND PRIVACY ROSE COVER  | JTA5200 | JTA5201 | JTA5203 | JTA5205 | •                   |
| SQUARE BATHROOM TURN      | JTA5600 | JTA5601 | JTA5603 | JTA5605 | •                   |
| SQUARE PRIVACY ROSE COVER | JTA5400 | JTA5401 | JTA5403 | JTA5405 | •                   |
| SQUARE PASSAGE ROSE COVER | JTA5300 | JTA5301 | JTA5303 | JTA5305 | •                   |





# how to order.

## Online Stores



## In-Store



Unit 1C Neander  
Lichfield Rd Ind Estate  
Tamworth, Staffordshire  
B79 7XA

## Over The Phone



We take payments over  
the phone  
**0333 355 3801**



# how to pay.

## PayPal



We accept paypal  
payments

## Cash or Card



Don't want an account, no  
problem you can pay by either  
card or cash in-store, online or  
over the phone.

## Apply for a trade account



Inquire today  
**0333 355 3801**



## NOTES

Offering next day delivery on all stock items nationwide and in-store collection, giving you expert knowledge and friendly service. Commercial hardware is the only call you need to make.

## Follow us on Social Media



<https://www.facebook.com/commercialhardwarelimited>



<https://www.linkedin.com/company/commercial-hardware-ltd/>



<https://www.instagram.com/commercialhardware/>

## Why not pop into our trade counter

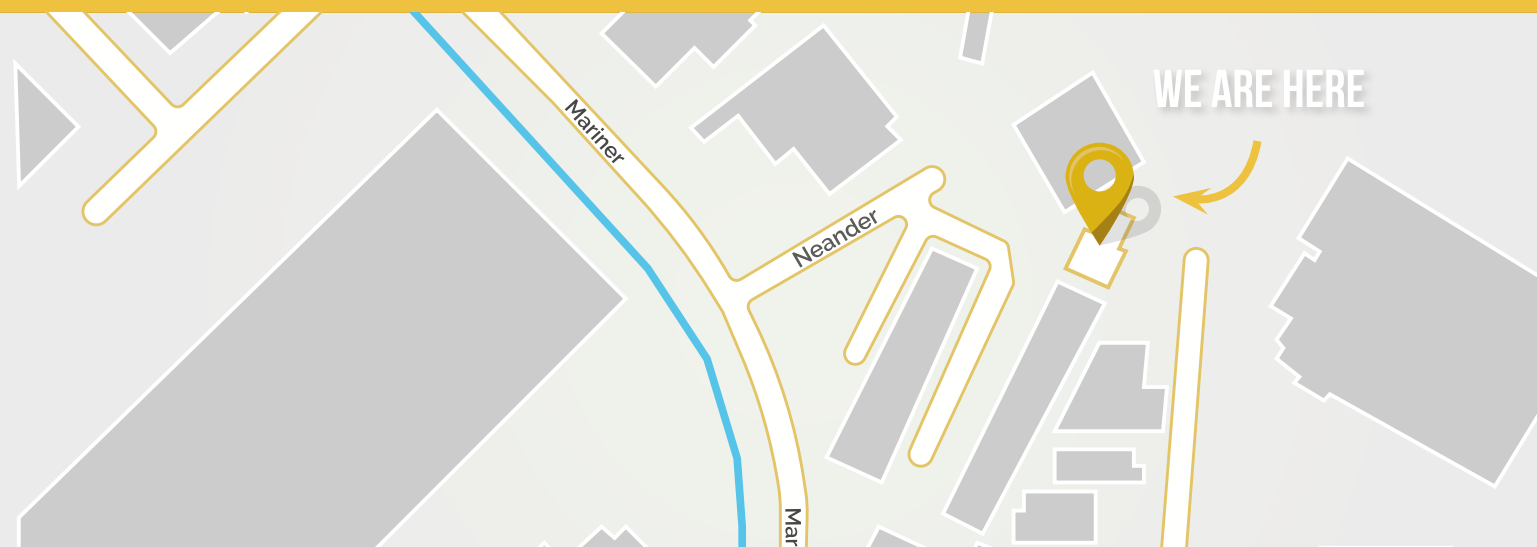





# **COMMERCIAL HARDWARE**

Commercial Hardware Ltd  
Unit 1C Neander,  
Lichfield Road Industrial Estate  
Tamworth  
B79 7XA

T : +44 (0) 333 355 3801

E : [sales@commercialhardware.co.uk](mailto:sales@commercialhardware.co.uk)

W : [www.commercialhardware.co.uk](http://www.commercialhardware.co.uk)