

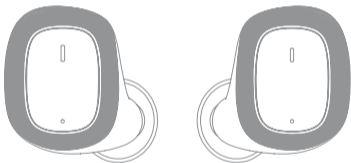

**COBBLE PRO**



Cobble Pro TWS Earbuds  
With Mic

## Appearance

Earbuds LED

Control  
Surface

Earbuds

Charging Cradle

Cradle LED

Remove these  
thin transparent  
films before use.

Micro USB Charging Port

A detailed line drawing of a charging case and two earbuds. The case is open, showing two earbuds resting in their respective slots. Each earbud has a dotted pattern on its top surface, representing the control surface. Labels with leader lines point to various parts: 'Earbuds LED' points to the top of the earbuds; 'Control Surface' points to the dotted area; 'Earbuds' points to the earbuds themselves; 'Charging Cradle' points to the case; 'Cradle LED' points to a small light on the front of the case; and 'Micro USB Charging Port' points to the port on the bottom of the case. A callout box with a black border contains the text 'Remove these thin transparent films before use.' with dashed lines pointing to thin, dotted films covering the earbuds and the cradle's contact points.

## Pairing Instruction

1. Earbuds will automatically turn on once they are taken out from the charging cradle. Put both earbuds on your ears.



2. You will hear an audio cue “Left Channel, Right Channel” respectively, followed by 3 beeps. Please go into the Bluetooth search screen of your device and search for “Cobble Pro Lite L” and connect.

Please **always** connect to the "Cobble Pro Lite L" when you want to use them in stereo mode. Connecting to R when you want to use the right side separately.

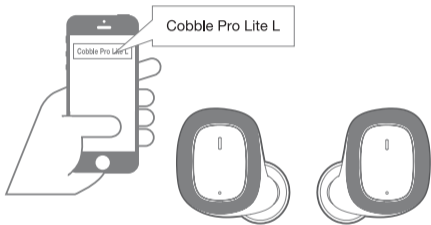

3. A final audio cue "Phone Connected" **will** be heard to confirm you connected **successfully** in stereo mode. You can now enjoy your stereo music.

In case you have difficulties to pair up your earbuds, you can do the following steps:

1. Press and hold the multifunction button on both sides for 4 sec to turn off the earbuds, an audio cue "Power Off" will be heard.



2. Press and hold the multifunction button on both sides for 20 seconds. The earbuds will come on and enter pairing mode, where the LEDs on the earbuds will flash blue and red. Once the Left and Right earbuds are connected you will hear the audio cue "Left Channel, Right Channel" as normal connection.

3. You will need to pair the earbuds with your playback device again.

## Playback Control

The multifunction button controls the playback when they're pressed in different ways.

### During Music Playback

Channel	Single Tap	Double Tap	Long Press
R	Play/Pause	Vol+	Next Track
L	Play/Pause	Vol-	Previous Track

### During Call

Channel	Single Tap	Long Press
R/L	Pickup Call	Reject Call

### At Anytime

Channel	Triple Tap
R/L	Siri/Google Assistant

## Charging The Earbuds

Put the earbuds into the cradle for charging. A fully charged cradle can charge the earbuds up to 5 times.

When you put an operating earbud into charging cradle, it will automatically shut down the earbud and charge it.

Usually the right side will charge up quicker than the left side, this is normal because the L side job load is heavier and will drain battery faster than the R side.

Earbud LEDs	Earbud Status
Red	Charging in progress
Off	Fully Charged

## Charging The Cradle

Connect the cradle to a USB power source with the micro USB cable bundled for charging. You can keep the earbuds inside the cradle while charging.

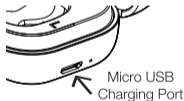

Cradle LED	Status
Blinking Red	Cradle Battery is Charging
Red	Cradle Battery is Fully Charged
Blue	Cradle is charging earbuds

## Specifications

- **Wireless Specification:** BT Version 5.0
- **Wireless Profile:** A2DP, AVRCP, HSP
- **Wireless Range:** 10M
- **Dynamic Driver / Diameter:** 5.5mm
- **Frequency range:** 2.40GHz-2.48GHz
- **Music play-time:** 4 hours
- **Standby time:** About 100 hours
- **Power Input:** 5V/1A