



COBBLE PRO



Cobble Pro TWS Earbuds
With Mic

Appearance

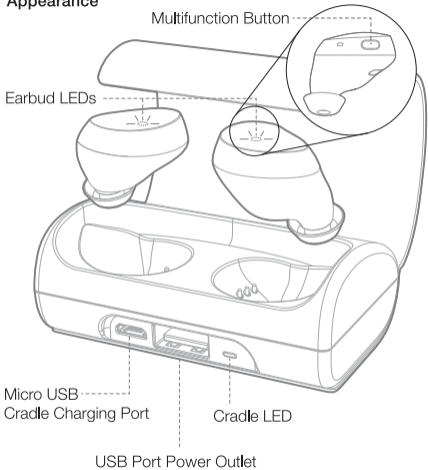

Pairing Instruction

1. Earbuds will automatically turn on once they are taken out from the charging cradle. Put both earbuds on your ears.

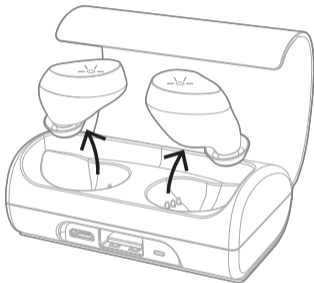

2. You will hear an audio cue “Left Channel, Right Channel” respectively, then a beep from the left side for every 5 seconds. Please go into the Bluetooth search screen of your device and search for “Cobble Pro TWS L” and connect.

Please always connect to the "Cobble Pro TWS L" when you want to use them in stereo mode. Connecting to R when you want to use the right side separately.

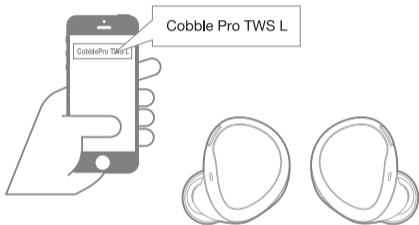

3. A final audio cue "Phone Connected" will be heard to confirm you connected successfully in stereo mode. You can now enjoy your stereo music.

In case you have difficulties to pair up your earbuds, you can do the following steps:

1. Press and hold the multifunction button on both sides for 4 sec to turn off the earbuds, an audio cue "Power Off" will be heard.



2. Press and hold the multifunction button on both sides for 20 seconds. The earbuds will come on and enter pairing mode, where the LEDs on the earbuds will flash blue and red. Once the Left and Right earbuds are connected you will hear the audio cue "Left Channel, Right Channel" as normal connection.

3. You will need to pair the earbuds with your playback device again.

Playback Control

The multifunction button controls the playback when they're pressed in different ways.

During Music Playback

Channel	Single Tap	Double Tap	Long Press
R	Play/Pause	Vol+	Next Track
L	Play/Pause	Vol-	Previous Track

During Call

Channel	Single Tap	Long Press
R/L	Pickup Call	Reject Call

At Anytime

Channel	Triple Tap
R/L	Siri Activation (iOS devices only)

Charging The Earbuds

Put the earbuds into the cradle for charging. A fully charged cradle can charge the earbuds up to 10 times.

When you put an operating earbud into charging cradle, it will automatically shut down the earbud and charge it.

Usually the right side will charge up quicker than the left side, this is normal because the L side job load is heavier and will drain battery faster than the R side.

Earbud LEDs	Earbud Status
Red	Charging in progress
Blinking Red	Almost Fully Charged
Off	Fully Charged

Charging The Cradle (Wireless/Wired)

You can keep the earbuds inside the cradle while charging.

Wireless: Place the cradle onto a wireless charger. Align the cradle to the center of your charging pad.

Wired: Connect the cradle with micro USB cable for charging.

Cradle LED	Status
Blinking Red	Cradle Battery is Charging
Red	Cradle Battery is Fully Charged
Blue	Cradle is charging earbuds/Phone

Use the Cradle as an Emergency Power Source

The cradle has a 1300mAh battery inside and has an output of 5V/1A. Connect the cradle to your device by attaching a USB cable to the cradle's "USB Port Power Outlet".

Specifications

- **Wireless Specification:** BT Version 5.0
- **Wireless Profile:** A2DP, AVRCP, HSP
- **Wireless Range:** 10M
- **Dynamic Driver / Diameter:** 5.5mm
- **Frequency range:** 2.40GHz-2.48GHz
- **Music play-time:** 3.5 hours
- **Standby time:** About 100 hours
- **Power Input:** 5V/1A **Output:** 5V/1A