

MT604 Load Cell



Features

Single Point Load cell
 Capacities 1000kg and 2000kg
 Air Craft quality Aluminium
 Silicone Sealed
 800mm*800mm platform size

Applications

Platform scales
 Process weighing scales
 Floor Scales

Specifications

Capacity	Kg	1000 , 2000kg
Combined Error	(%FS)	≤±0.020
Creep (30 minutes)	%FS/30min	≤±0.024
Temperature effect on sensitivity	(%FS/10C)	≤±0.012
Temperature effect on zero	(%FS/10C)	≤±0.020
Output sensitivity	(mv/v)	2.0±0.2
Input resistance	(Ω)	415+/- 15
Output resistance	(Ω)	350+/-3.5
Insulation resistance	(MΩ)	≥ 5000 (50VDC)
Zero balance	(%FS)	2.0
Temperature, Compensated	(°C)	-10~+40
Temperature, Operating	(°C)	-20~+60
Excitation, Recommended	(V)	5~12(DC)
Excitation, Max	(V)	18(DC)
Safe overload	(%FS)	150
Ultimate overload	(%FS)	300



Millennium Mechatronics Limited
 Email: info@meltrons.com | www.meltrons.com



MT604 Load Cell

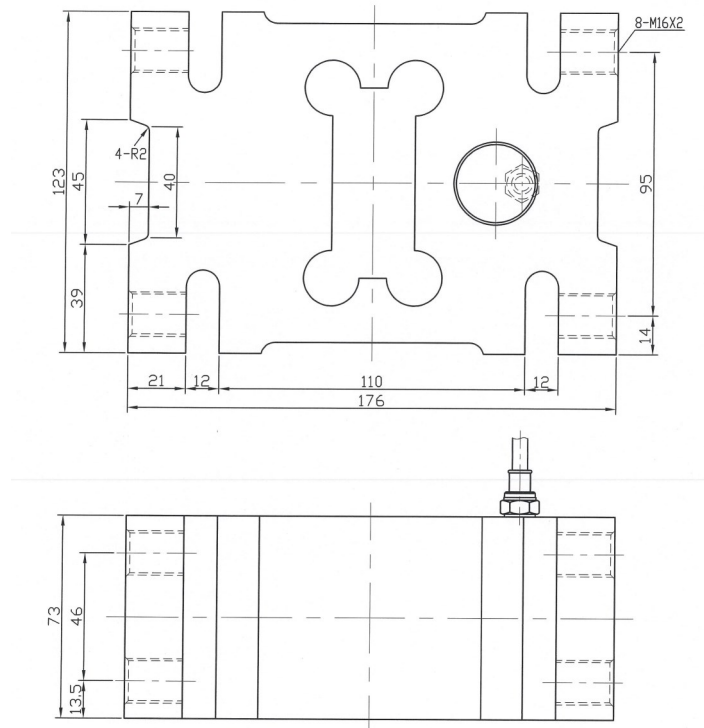

Dimensions (mm)

Cable

6 Core, 5.5mm dia

Cable Length: 3m

Color Code

Exc+ Red, Exc- Black

Sig+ Green, Sig- White

Screen- Yellow

Specifications are subject to change without notice for improvement

MT604EV01-14072015



Millennium Mechatronics Limited
Email: info@meltrons.com | www.meltrons.com

