

LAWN EDGING INSTALLATION GUIDE

PARTS

- Lawn Edging Strip
- Pegs

TOOLS

- Spade
- Spirit Level
- Hack Saw
- PPE
- Stainless Steel Wood Screws (4.5 x 45mm)
- Driver
- Rubber Mallet
- Tape Measure

STEPS

1

Mark out the length of where the lawn edge will go and using the tip of a spade dig a small trench along the line.

The trench will need be at least (5mm) wide and (250mm) deep to allow 2/3 of the lawn edging strip in the ground.

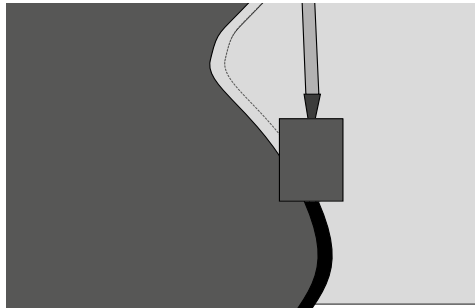

2

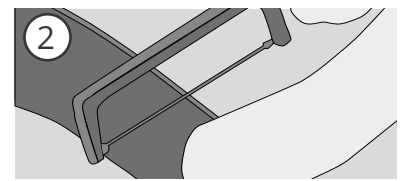

Use a tape measure to measure the linear length of the trench and if necessary use a hack saw to cut the lawn edging strip to size.

3

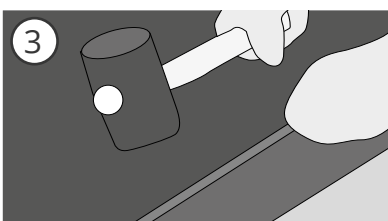

Use a rubber mallet and spirit level to level and secure the lawn edging strip along the trench line.

4

Place pegs on the flower bed side of the lawn edge every 50cm and hammer down with the rubber mallet so they are flush with the levelled lawn edge strip.

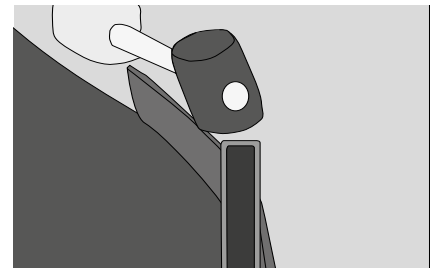

5

Screw through the lawn edging strip into the pegs. Use two screws per peg to secure. Pre-drilling is not necessary unless the placement of the screws is less than 20mm from the edge of the lawn edge strip.

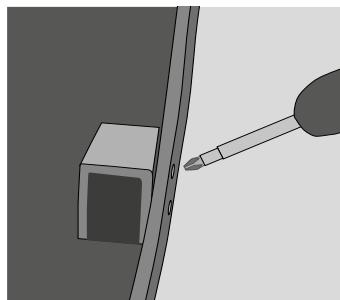

6

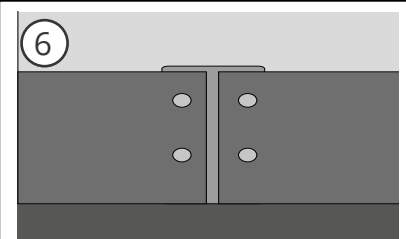

Where two strips meet, use a peg and screws to secure. Leave a 6mm gap between strips to allow room for expansion.

