

Specifications

2030

Compact Pendant Pushbutton Station

NEMA Type 4X Enclosure

Hubbell's Compact Pendant Stations are typically used to control industrial cranes and hoists or the remote control of industrial machines.

This high-quality pendant station features a tough molded polymer housing that meets the most rigorous requirements of industrial applications and their environments for control of electric hoists. The compact pendant is rated NEMA 4X when used with the cord connector kit.

- Safety Yellow high impact polymer enclosures.
- A compact pendant station engineered to fit the hand comfortably.
- Choice of single-speed, two-speed, or on-off capabilities.

- Mechanical interlock on reversing stations prevents actuating both pushbuttons simultaneously.
- UL and CSA listed.
- Ambient Temperature Range -20° to 158°F (-29° to 70°C)
- Optional - Cord Connector Kit - to permit use in NEMA 4X watertight, dust-tight, and corrosion resistant applications or for outdoor use.

Application

Industrial plants have expanded the use of electric motor driven hoists (over the chainfall types) as the need for greater hoist capacity has increased. These electric motor hoists are an excellent application for the Hubbell Compact Pendant. Especially in areas where the stations are subject to operational abuse.

Locations include jib cranes on building columns, small overhead hoists on gantry cranes, and even the operation of hoists applied to single girder cranes.

These pendant stations are designed for the comfort of the operator in controlling the hoists and built to withstand hostile environments in the industrial arena.

Most of the electric hoists have reversing electrical relays or contactors which can be controlled from a single control contact and these pendant stations are designed for those hoist applications, not for the direct power handling of the motor current in the pendant station.

Jogging operation of floor-mounted machines away from the main operator's station is generally associated with only one motion, easily handled by the pendant station applied to an umbilical cord.

These stations have also been used very successfully for winch control on recreational vehicles and tow trucks and for dock control with carriers in the food industries.



Diagrams & Dimensions

2030

Contact Ratings – Single Break Single Speed Two Speed

Single Speed		Two Speed	
AC NEMA A300	120V 6A 240V* 3A	AC NEMA B300	120V 3A 240V* 1.5A
DC NEMA P300	125V 1.1A 250V 0.55A	DC	125V — 250V —

* OSHA limits pendant voltage to 150VAC or 300VDC

Wiring Diagrams

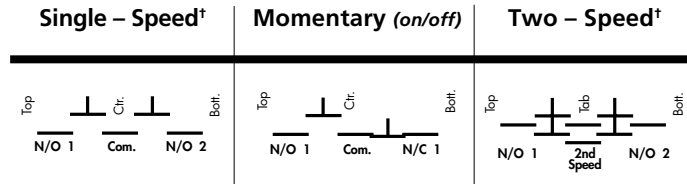

† Single-speed and two-speed stations are mechanically interlocked to prevent actuating both buttons simultaneously.

Compact Pendant Assembly

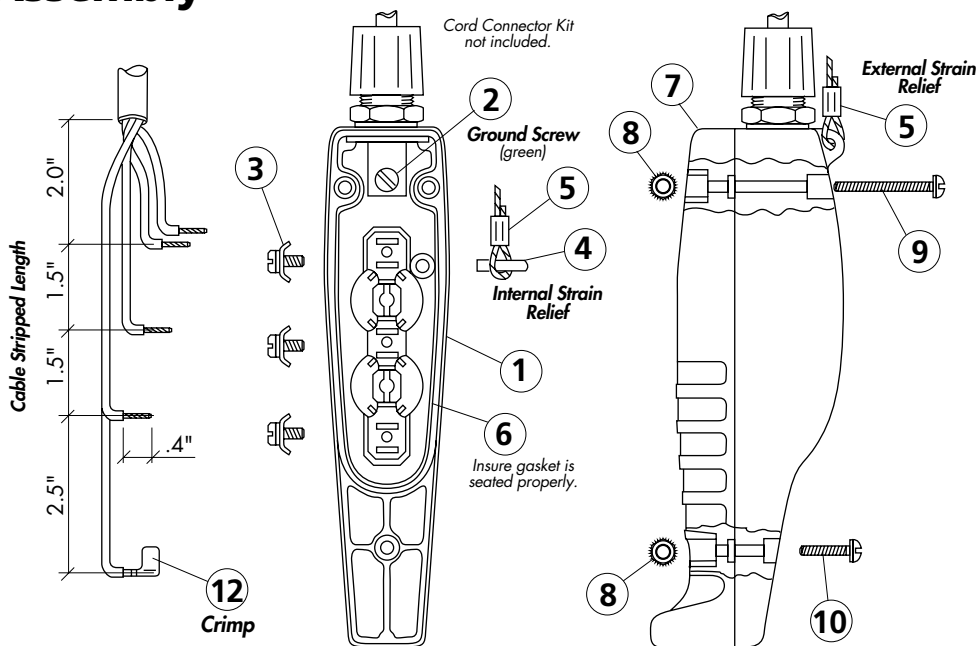

Label Pack

UP	DOWN
ON	OFF
IN	OUT
FWD	REV
RIGHT	LEFT
RAISE	LOWER
START	STOP
OPEN	CLOSE
NORTH	SOUTH
EAST	WEST

Cord Connector Kit Assembly

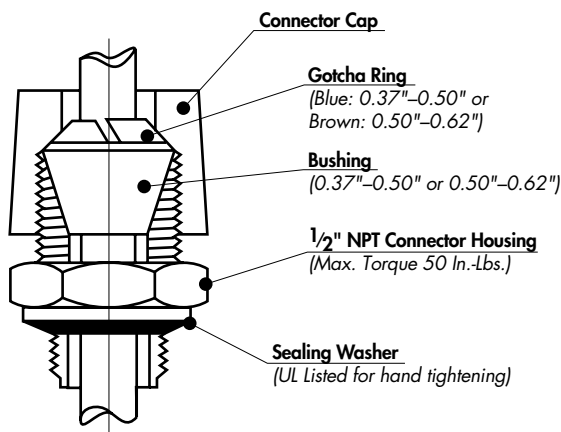

Compact Assembly Parts List

Part No.	Qty.	Assembly Parts Listing
1	1	Front Housing
2	1	1/2" NPT Locknut Gnd. Brkt.
3	3	Terminal Clamps
4	1	Pin *
5	1	Crimp Sleeve *
6	1	Gasket
7	1	Rear Housing
8	3	#8-32 Hex Nut
9	2	#8-32 x 1 3/4" Lg. R.H.M.S.
10	1	#8-32 x 1" Lg. R.H.M.S.
11	1	Button Labels (not shown)
12	1	90° Terminal (Two-Speed Only)

* Discard items no. 4 and 5 if not used as shown.