

INSTALLATION INSTRUCTIONS

MH-1008, MH-1012 Universal Forklift Tablet Mount

*For 3" wide x 3.75" deep max size rectangle tubing.
Not recommended for round or odd shape tubing.*

TOOLS REQUIRED:

7/16" Wrench

PARTS and MOUNTING HARDWARE:

MH-1008

<u>QTY</u>	<u>DESCRIPTION</u>	<u>PART#</u>
1	Front mounting base	CM005259
1	Backing plate	CM010254
8	1/4" Serrated nut	GSM30023
4	1/4" x 4.5" Carriage bolt	GSM32026

MH-1012

<u>QTY</u>	<u>DESCRIPTION</u>	<u>PART#</u>
1	Front mounting base	CM005259
1	Backing plate	CM010254
8	1/4" Serrated nut	GSM30023
4	1/4" x 4.5" Carriage bolt	GSM32026

MH-1008

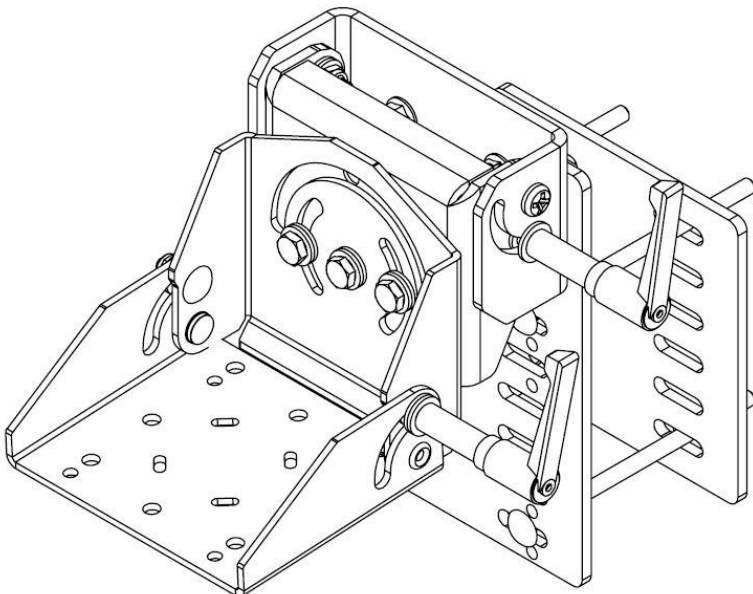

MH-1012

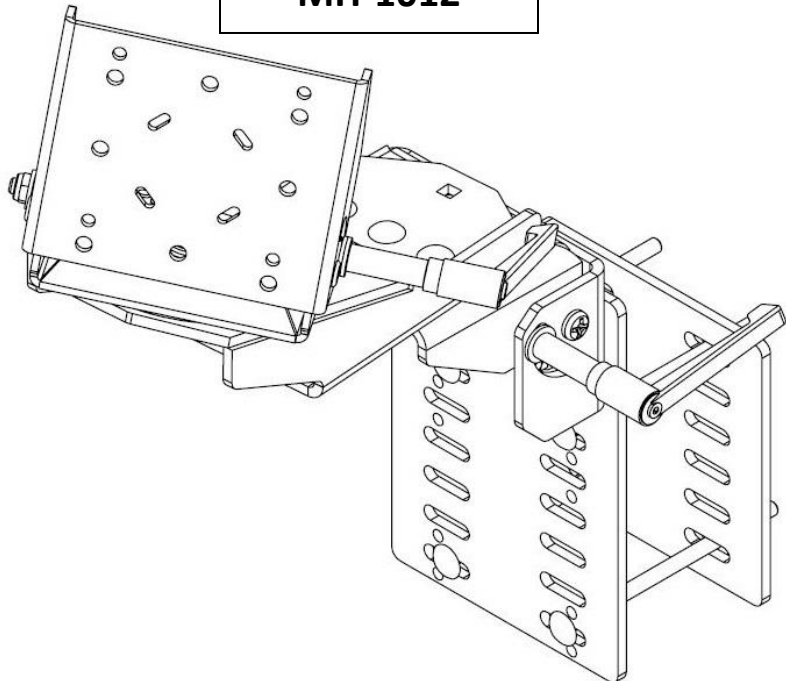



Determine mounting height on post. Add backing plate and hardware.

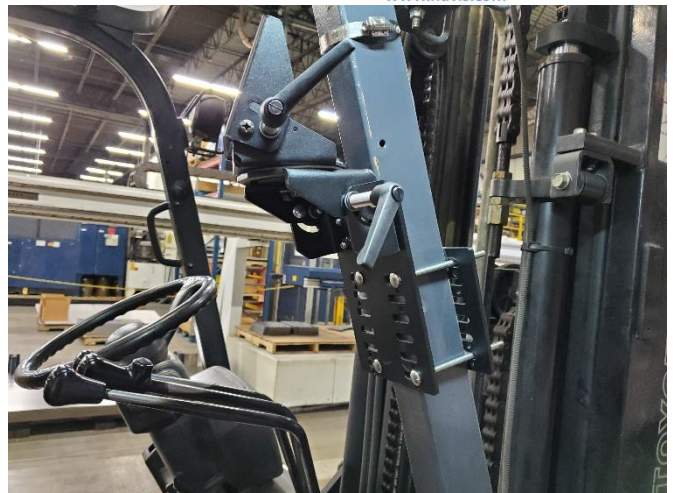

Verify line of sight and fully tighten hardware.



Add device and double check a control accessibility. Adjust as needed.



MH-108 installation now complete.

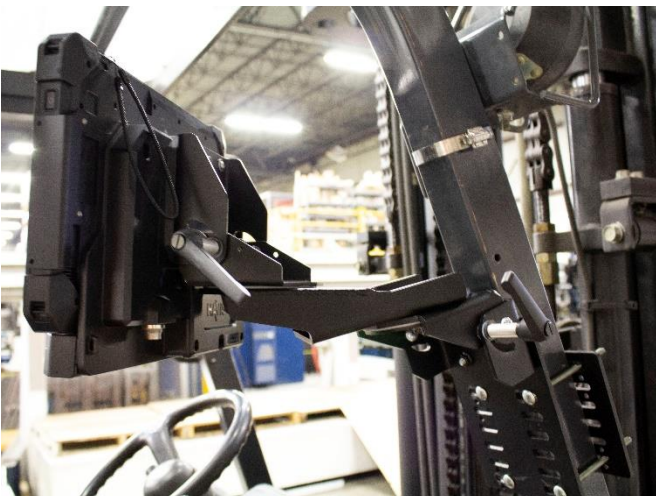

Repeat above process for MH-1012.

For additional strength, lock handle may be removed and a permanent bolt and nut combination installed.



MH-1012 installation is now complete.