

# MD-501

## Rugged Forklift Mount

### INSTALLATION MANUAL

### Adjustments

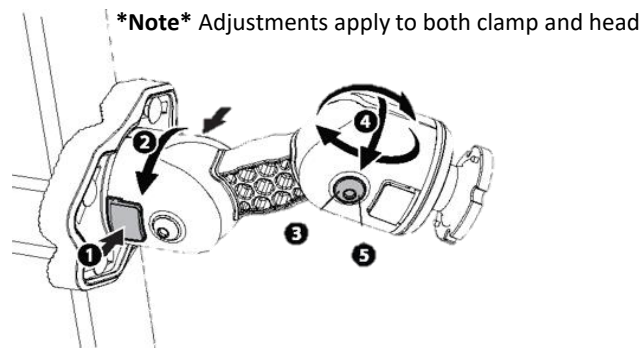

- 1 To rotate arm/head-squeeze buttons on both sides
- 2 Rotate arm position- release buttons – confirm lock
- 3 To position arm/head – loosen adjustment pin using provided 3/16" hex key (K)
- 4 Move arm/head into position
- 5 Using hex key (K), torque adjustment pins up to 50 in lbs.

### Get Started

- A Mount assembly
- B Clamp block
- C Clamp bolt 5-1/2" (4)
- D Clamp bolt 4-1/2" (4)
- E Clamp bolt 3-1/2" (4)
- F Phillips M4 flat head (4)
- G 1/4" flat washer (4)
- H 1/4-20 locknut (4)
- I VESA Plate
- J Nut Plate
- K 3/16" Hex Key

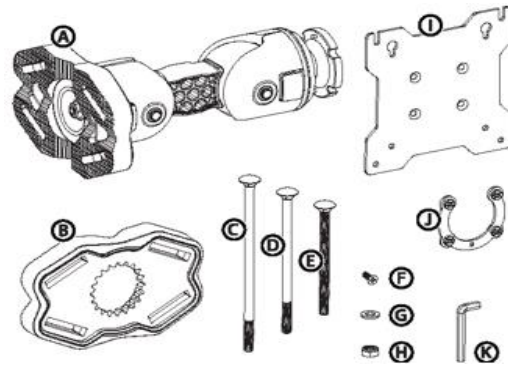

### Installation

- \*Note\* Adapts to columns of any shape, 1"-4" (25.4-101.6 mm)
- \*Note\* Clamp mounts in horizontal or vertical orientation

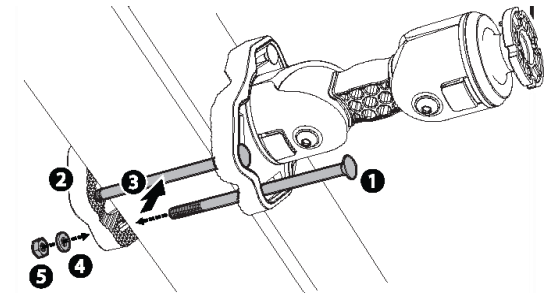

- 1 Select clamp bolt (C,D,E) – insert into slots on mount (4x)
- 2 Position clamp (B) against column and into clamp bolts
- 3 Push clamp bolts snug against column
- 4 Assemble washers (G) (4x)
- 5 Thread locknuts (H)(4x) using a 7/16" wrench-torque, no more than 30 in lbs.

### Attachments – VESA Mount

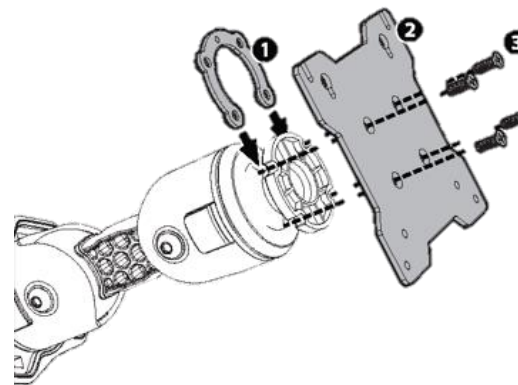

- 1 Insert nut plate (J) around collar on head assembly
- 2 Place VESA Plate (I) (or other device/bracket/etc.)
- 3 Using a #2 phillips screwdriver, thread M4 flat head screws (F) (4x) into nut plate

### Attachments – direct mount

- \*Note\* Hex head screws with washer are suggested for the easiest installation

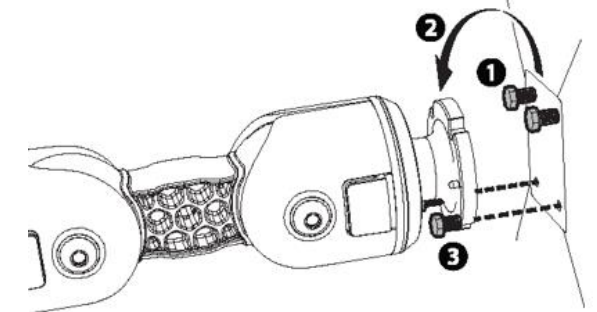

- 1 Thread two screws (not provided) into device
- 2 Hang the device onto mount head
- 3 Thread other two screws through mount head and into the device as shown