

SETUP GUIDE

KADET

5G ROUTER

SETTING UP

1 Insert Cards & Power On

When powered up, your Kadet router will broadcast both 2.4GHz and 5GHz Wi-Fi signal with the SSID: KAT-xxxx and KAT-xxxx-5G.

! Hot plug for TF card and Nano-SIM card are not supported for this router.

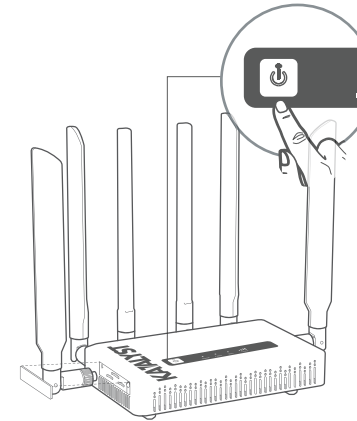

After inserting cards, turn on the router by pressing the power button.

2 Connect via Wi-Fi

Connect to the Wi-Fi called KAT-xxxx or KAT-xxxx-5G, and then input the default Wi-Fi password which is the last 8 digits of the serial number and is also printed on the bottom label of the router.

Wi-Fi	<input type="checkbox"/>
✓ KAT-xxxx	<input checked="" type="checkbox"/>
Search the SSID and connect to it.	
Password	••••••••

3 Advanced Settings

While connected to your router, visit <https://192.168.8.1> in your browser to access advanced settings and configuration options.

Connect via LAN

or

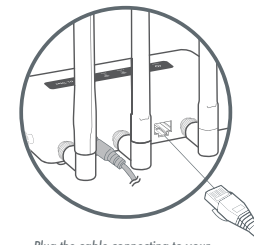

Plug the cable connecting to your computer into LAN port

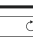
	https://192.168.8.1	
---	---	---

SUPPORT

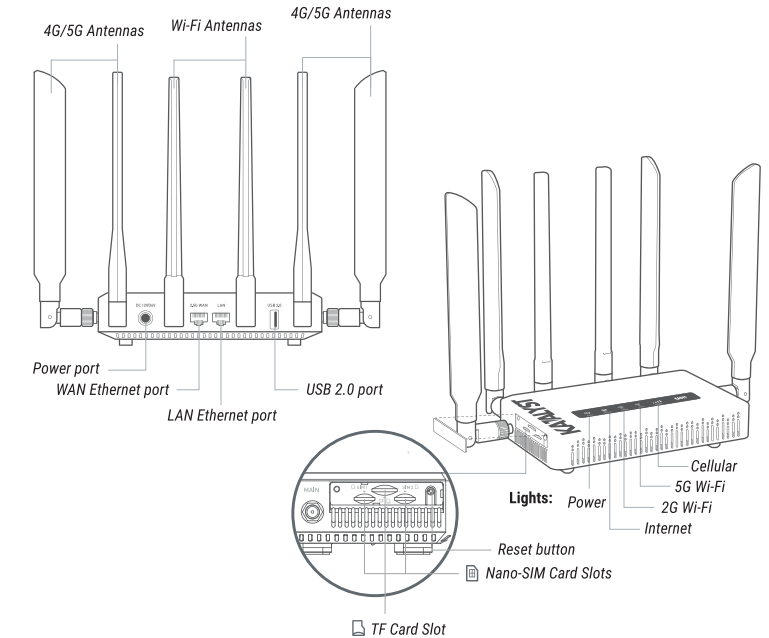

Repair/Reset

If you cannot access the web-based setup page or cannot connect to the router, you can press the reset button:

- Press and hold for 3 seconds, and then release to repair your network.
- Press and hold for 10 seconds, and then release to reset the router to factory settings. All user data will be cleared.

Technical Support

- For further questions, you can get help by emailing us at support@katalystbrand.com

WARRANTY

- We provide **1-year limited warranty** for routers and **3-month limited warranty** for accessories.
- Extra warranty may apply according to the local law in which the product purchase took place.
- Highly recommend using the included **12V/2.5A** power adapter.
- Any damage to the router caused by not following the instructions will render this warranty null and void.
- Any damage to the router caused by modifying the PCBA, components or case will render this warranty null and void.
- Issues caused by the use of third-party firmware may not get official support from us.
- Any damage to the router caused by inappropriate use, e.g. inappropriate voltage input, high temperature, dropping in the water or on the ground will render this warranty null and void.
- Pictures on the instructions are only for reference. We reserve the right to change or modify these materials without further notice.

FCC ID: 2A5KA-F219

1. This device complies with Part 15 of the FCC Rules. Operation is subject to the following two conditions:
- (1) This device may not cause harmful interference, and
 - (2) This device must accept any interference received, including interference that may cause undesired operation.
2. Changes or modifications not expressly approved by the party responsible for compliance could void the user's authority to operate the equipment.
3. Note: This equipment has been tested and found to comply with the limits for a Class B digital device, pursuant to part 15 of the FCC Rules. These limits are designed to provide reasonable protection against harmful interference in a residential installation. This equipment generates uses and can radiate radio frequency energy and, if not installed and used in accordance with the instructions, may cause harmful interference to radio communications. However, there is no guarantee that interference will not occur in a particular installation. If this equipment does cause harmful interference to radio or television reception, which can be determined by turning the equipment off and on, the user is encouraged to try to correct the interference by one or more of the following measures:
- Reorient or relocate the receiving antenna.
 - Increase the separation between the equipment and receiver.
 - Connect the equipment into an outlet on a circuit different from that to which the receiver is connected.
 - Consult the dealer or an experienced radio/TV technician for help important announcement.

FCC SAR statement

This equipment complies with FCC radiation exposure limits set forth for an uncontrolled environment. End user must follow the specific operating instructions for satisfying RF exposure compliance. This transmitter must not be co-located or operating in conjunction with any other antenna or transmitter. The portable device is designed to meet the requirements for exposure to radio waves established by the Federal Communications Commission (USA). These requirements set a SAR limit of 4 W/kg averaged over ten gram of tissue. The highest SAR value reported under this standard during product certification for use when properly worn on the Limbs.



Bolt Brands, LLC.
8435 Ellerson Dr, Unit 7,
Mechanicsville, VA 23111,
United States

INSTALLATION

Adhesive Mount

- 1** Peel off the matte white film and attach the adhesive pad to the wall mount. This will be a permanent application.

Tip: Before installing Kadet, we recommended speed-testing different locations to determine the best location to mount. (If installing in an interior location with multiple walls, you may get a better signal near a window.)

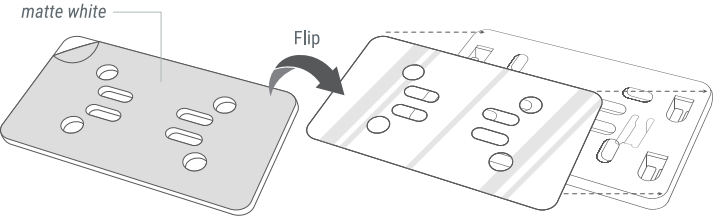

- 2** Peel off the glossy transparent film and then stick the adhesive pad onto a clean and dry glass surface.

ⓘ **Caution:** Please avoid sticking the adhesive pad to rough or wet surfaces, as this could potentially result in the device falling off and sustaining damage.

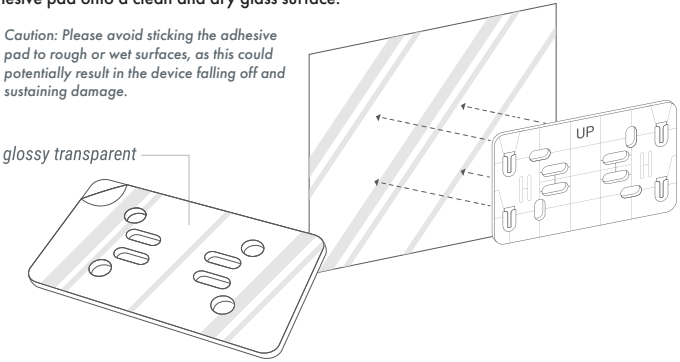

- 3** Attach the router to the wall mount.

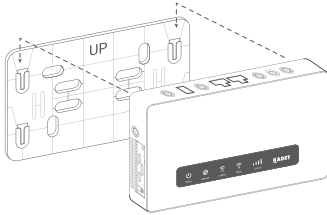

⚠ Maintain a minimum distance of 20 cm between the router and individuals while charging.

Screw Fixed Mount

- 1** Align the wall mount to the wall. Secure 4 screws through the wall mount holes into the wall.

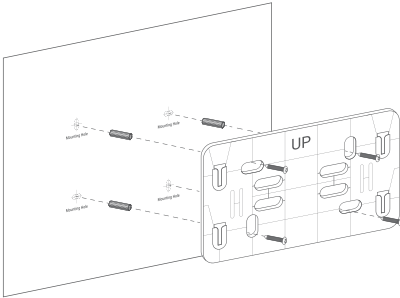
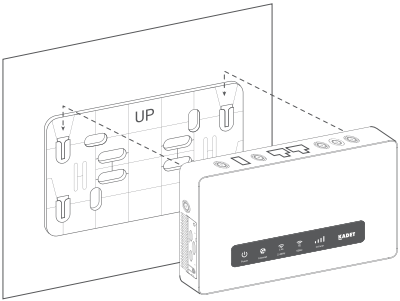

Diagram of Installing Mounting Frame

- 2** Attach the router to the wall mount.



If you need to remove or reposition the router, first remove the router from the mount and then slowly twist the mount with pressure. Once removed, the mount can be repositioned using the same installation instructions. The gel material can be rinsed if it is dirty and prevents proper adhesion to the mounting surface.