



**ONLINE DESIGN SERVICES
FIRST STEPS**



FAWN INTERIORS STUDIO
OLD DOWN COTTAGE
SWELLING HILL
ARLESFORD SO24 0DA

01962 435 035
© FAWN INTERIORS STUDIO

STEP 1
FILL IN CLIENT QUESTIONNAIRE

This enables us to get a feel for the use of the rooms, your style, colour likes and dislikes, etc.

This can be done by email or, alternatively, we can cover this off on a call.

CLIENT QUESTIONNAIRE

What is the overall goal you are trying to achieve?

.....

What is your timeframe?

Is the work to be done in stages?.....

.....

What is your budget?.....

Who lives in the property?

.....

Does anyone have any allergies?.....

Do you have any current or intended pets?

Do you have any family history / travelling items / storytelling that you would like to incorporate?.....

.....

.....

Any family habits / rituals / hobbies to be considered?.....

.....

.....

Do you have any favourite colours?

.....

Are there any colours you dislike?

.....

What existing furniture or artwork is there?

.....

.....

.....

.....

.....

STEP 2
TAKE PICTURES OF YOUR ROOMS

Take pictures of the rooms from each of the four corners. Portrait/vertical, rather than landscape/horizontal, is best to ensure all light fittings are included. Take pictures at the brightest time of day.

You will need:
- a decent phone camera, or normal camera

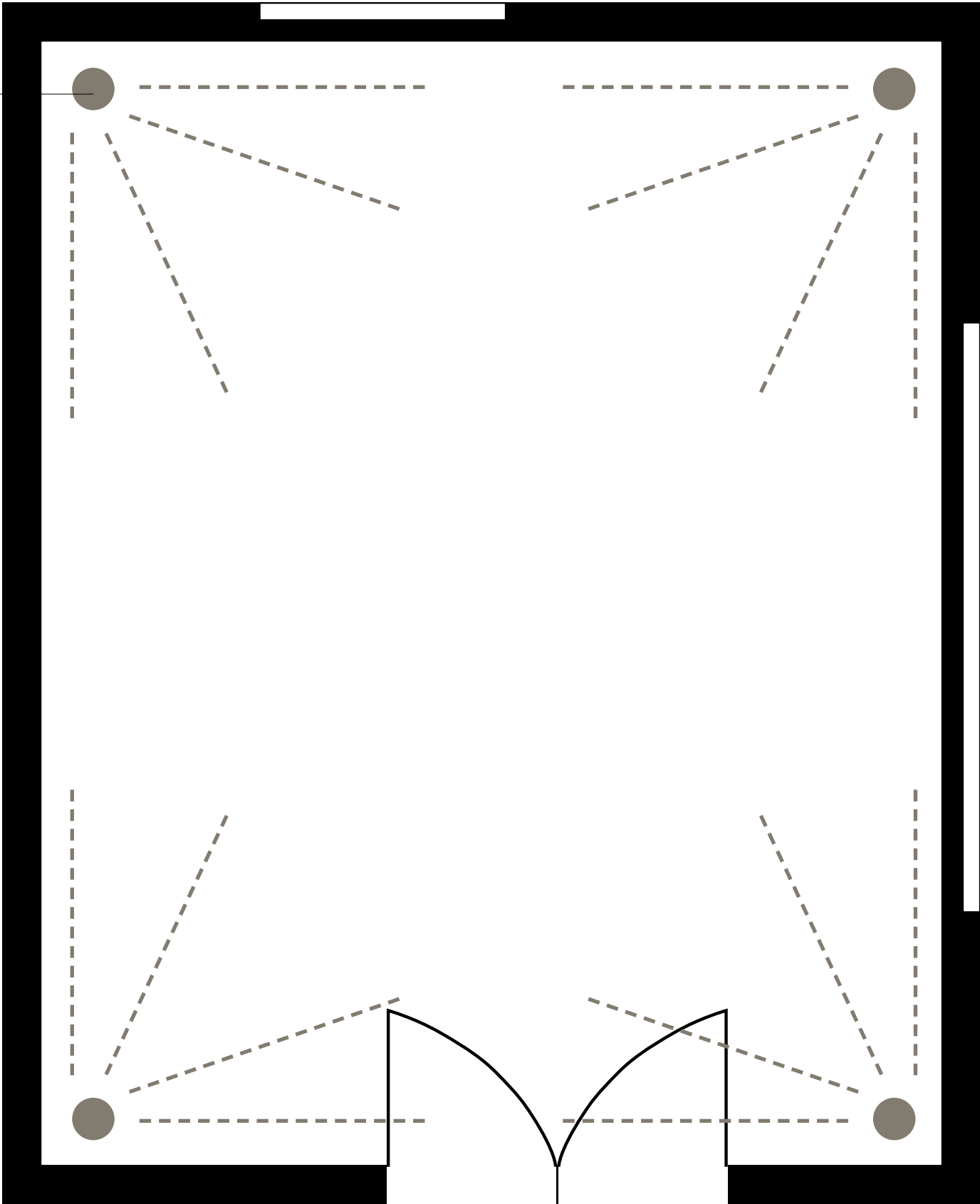

FAWN INTERIORS STUDIO
OLD DOWN COTTAGE
SWELLING HILL
ARLESFORD SO24 0DA

01962 435 035
© FAWN INTERIORS STUDIO

STEP 3
SKETCH & MEASURE YOUR ROOMS

Measure the room and provide a rough sketch with the measurements.

We will need:
the length and width of the room, ceiling height, distance between windows, height underneath windows, height and width of window and doors

You will need:
- a long tape measure
- an extra pair of hands

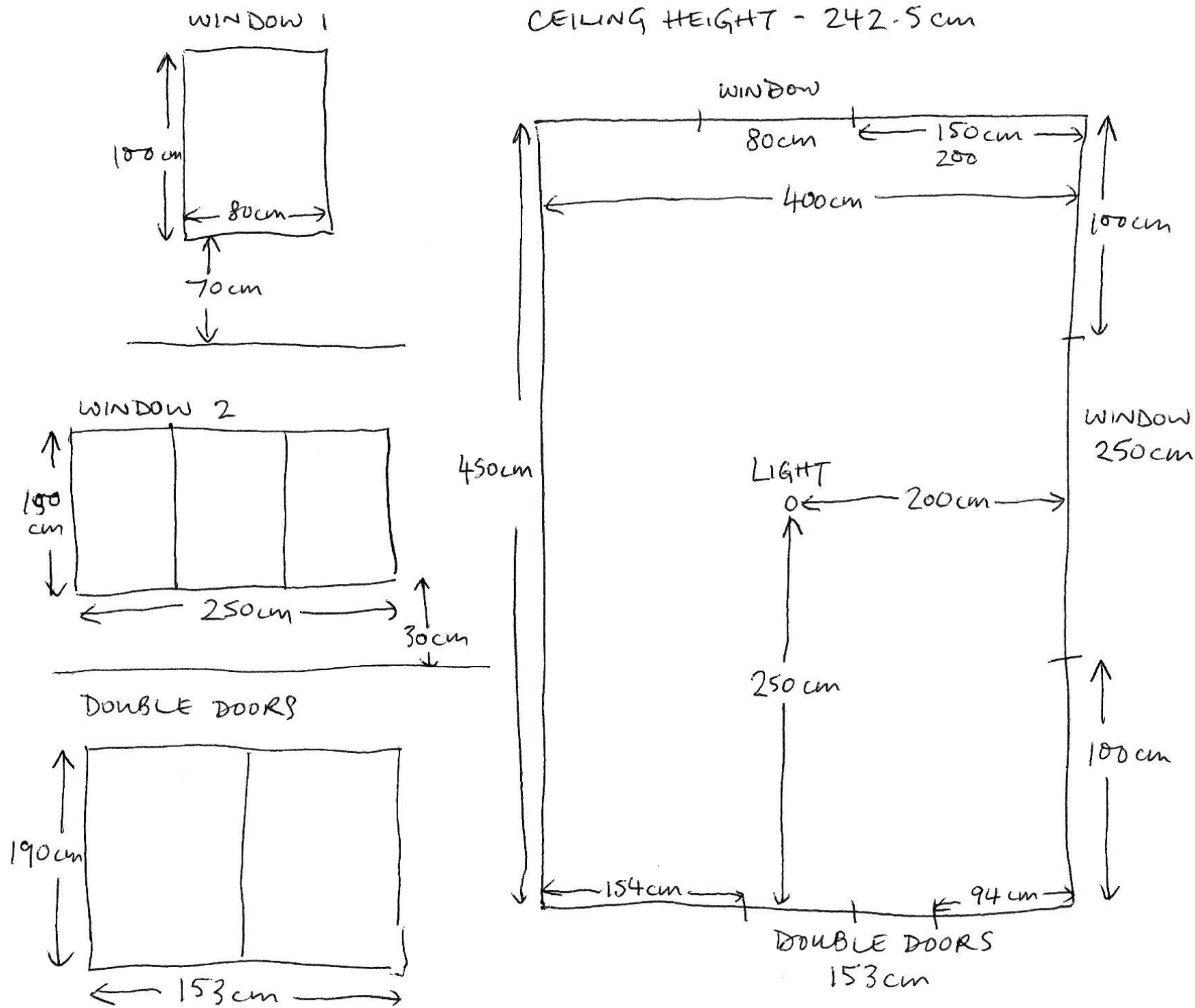

FAWN INTERIORS STUDIO
OLD DOWN COTTAGE
SWELLING HILL
ARLESFORD SO24 0DA

01962 435 035
© FAWN INTERIORS STUDIO

STEP 4
EXISTING FURNITURE

Take pictures of existing furniture from all possible angles, and measure each piece.

We will need:
the height, width and depth in cm.

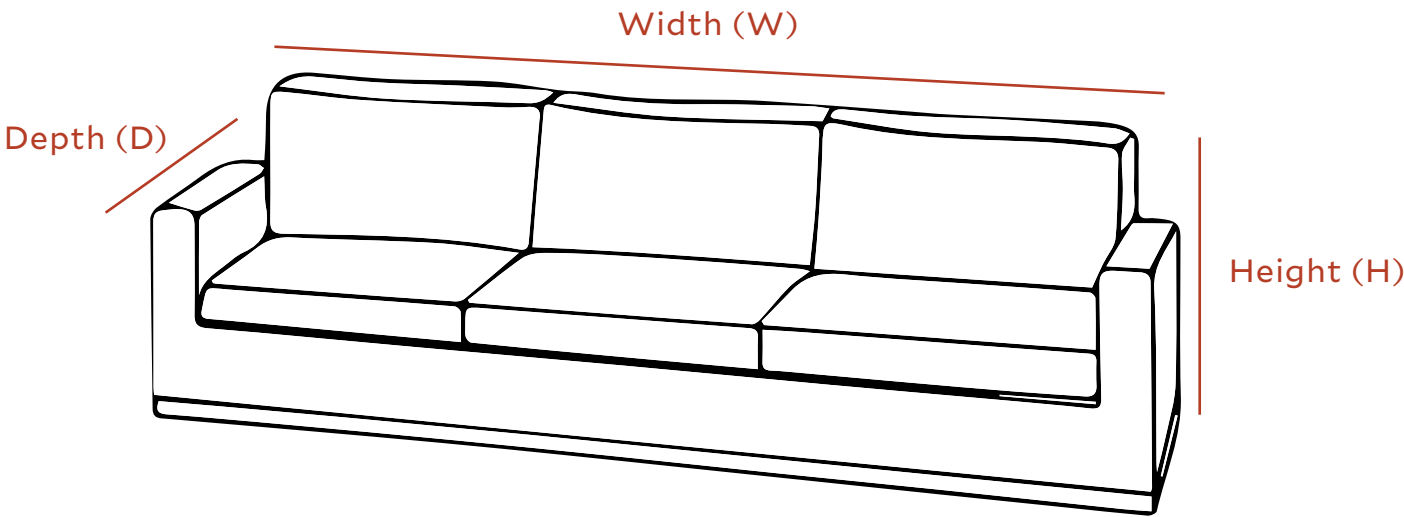
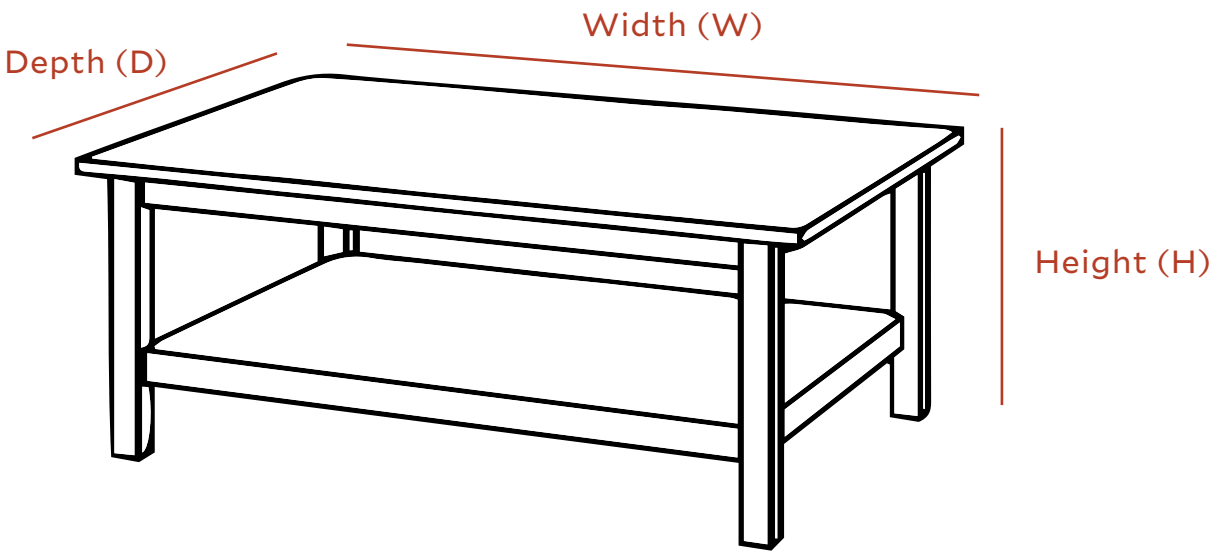

ONLINE DESIGN SERVICES DESIGN STAGES



FAWN INTERIORS STUDIO
OLD DOWN COTTAGE
SWELLING HILL
ARLESFORD SO24 0DA

01962 435 035
© FAWN INTERIORS STUDIO

STAGE 1
MOOD BOARDS

We prepare general inspirational mood boards covering the entire project for your approval.

You will receive 2 concepts to choose from.

Timeline: 1 week

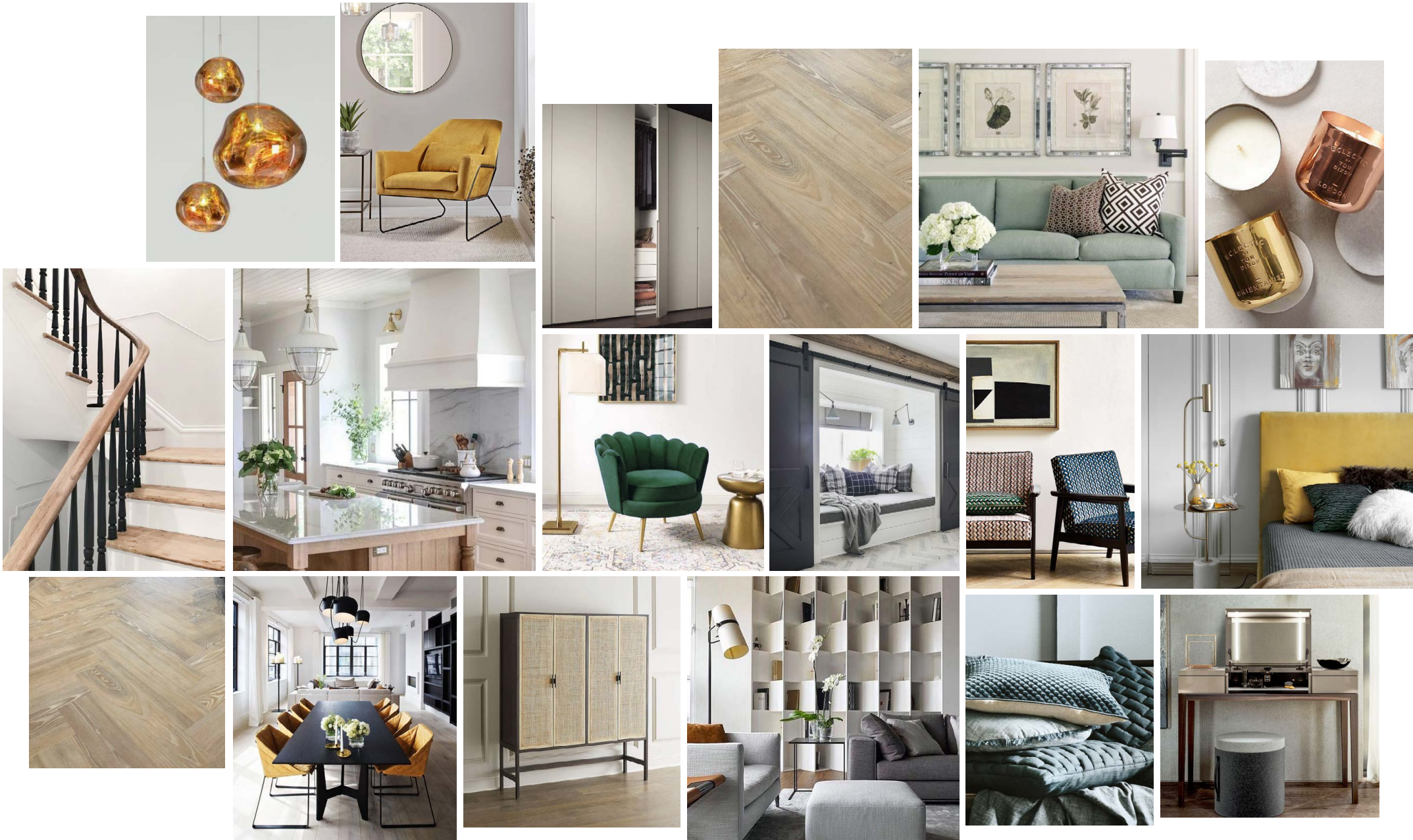

COLOURS



MATERIALS

OAK
BRASS
COPPER
VELVET
LEATHER
GLASS
CERAMIC



FAWN INTERIORS STUDIO
OLD DOWN COTTAGE
SWELLING HILL
ARLESFORD SO24 0DA

01962 435 035
© FAWN INTERIORS STUDIO



FAWN INTERIORS STUDIO
OLD DOWN COTTAGE
SWELLING HILL
ARLESFORD SO24 0DA

01962 435 035
© FAWN INTERIORS STUDIO

STAGE 2
ALL SOURCING

For the second stage, we will provide a full presentation with room plans, room mockups and all sourcing. We will separately mail you all samples. After receipt of everything, we will schedule a call to present it all.

Timeline: 2-3 weeks

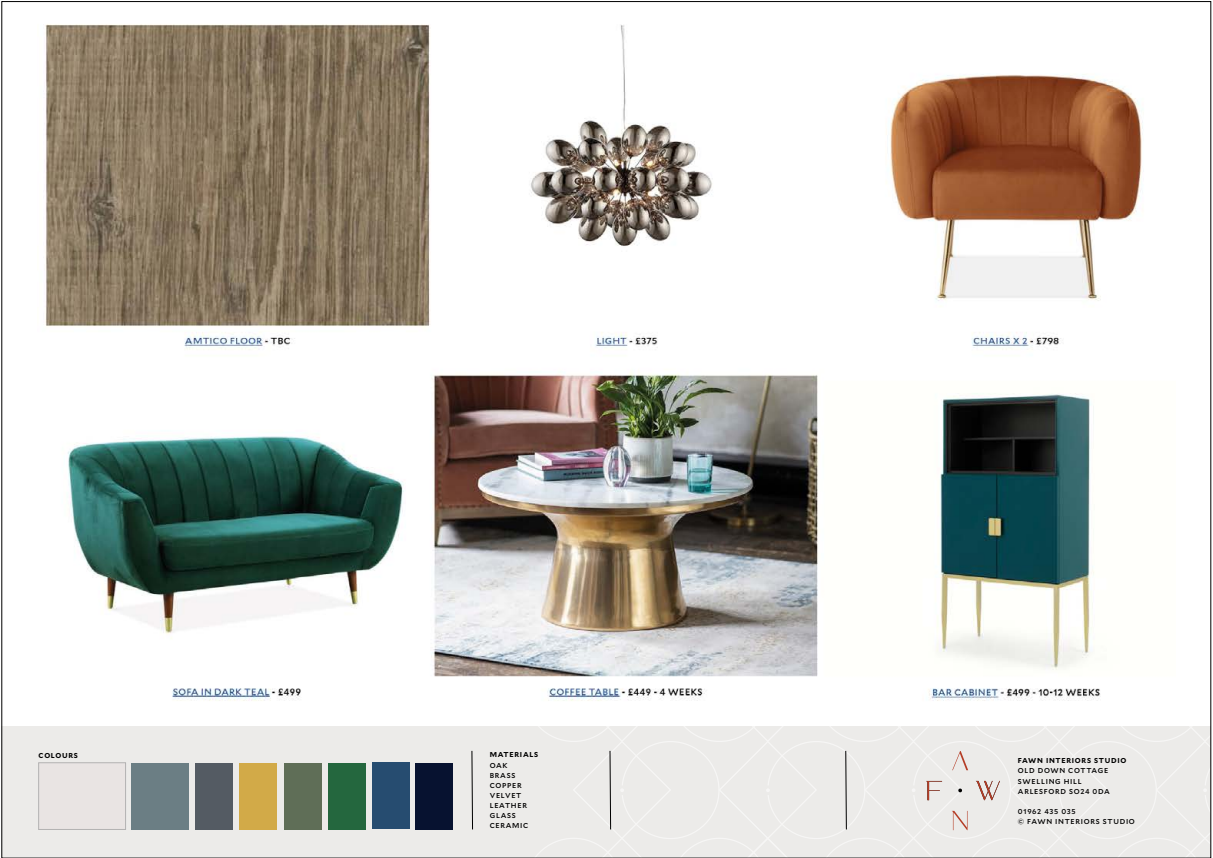
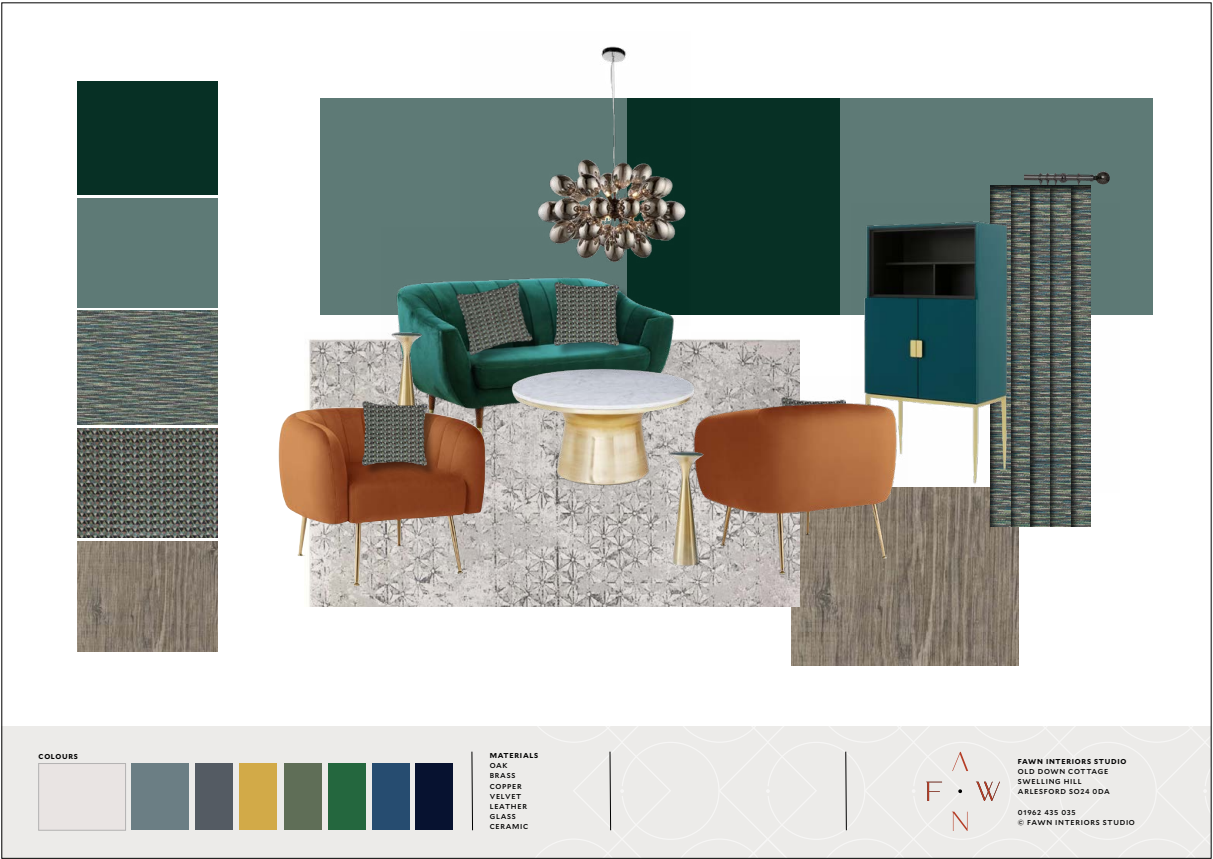
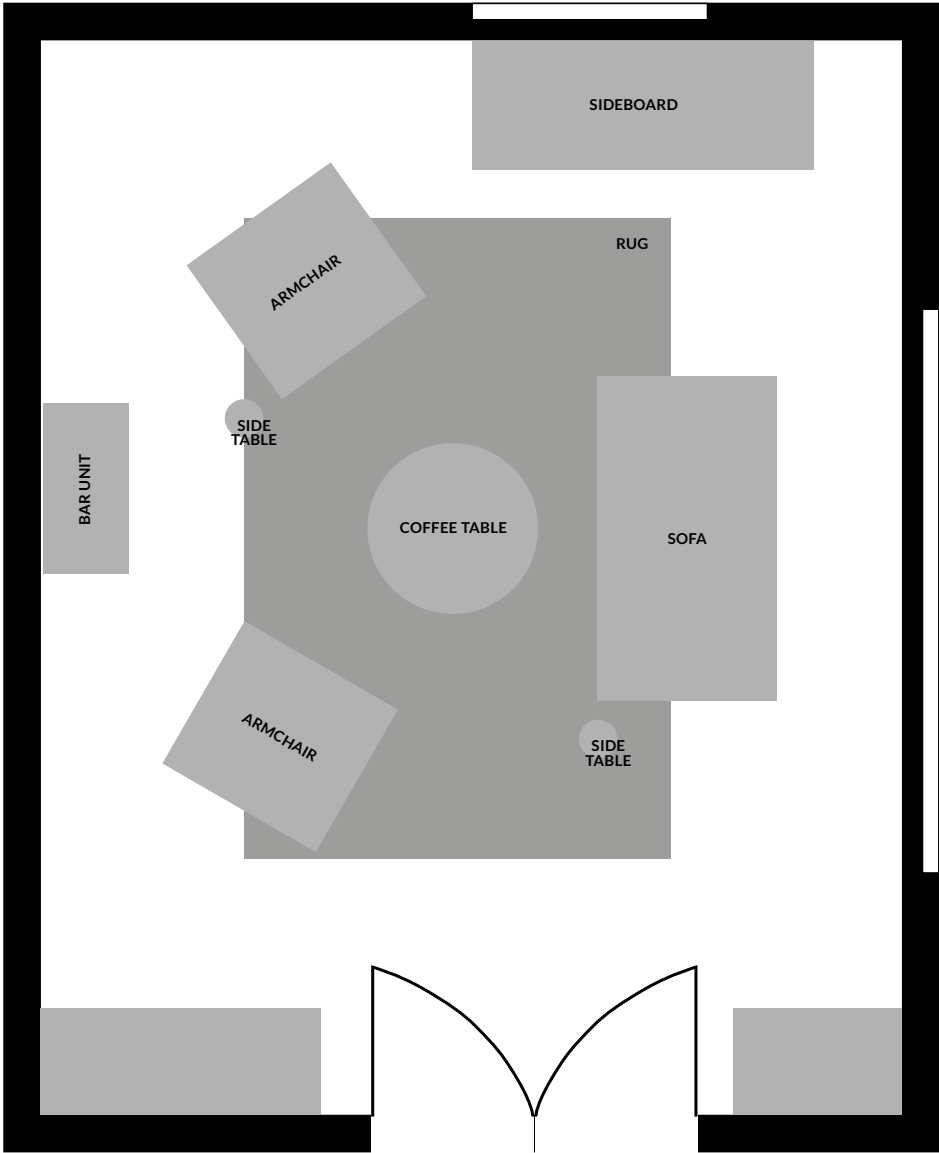

STAGE 2
ROOM PLAN & ROOM MOCKUP

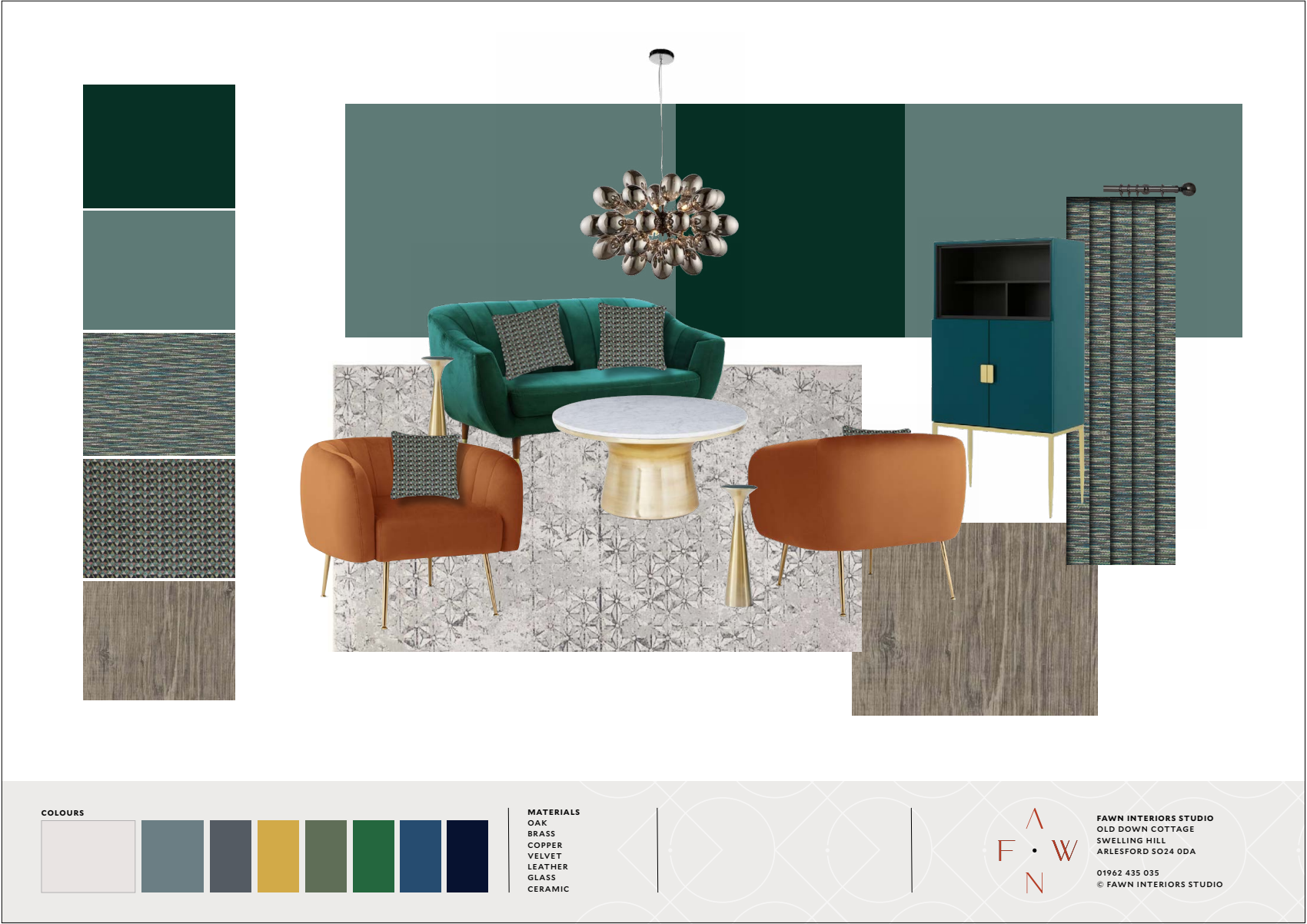
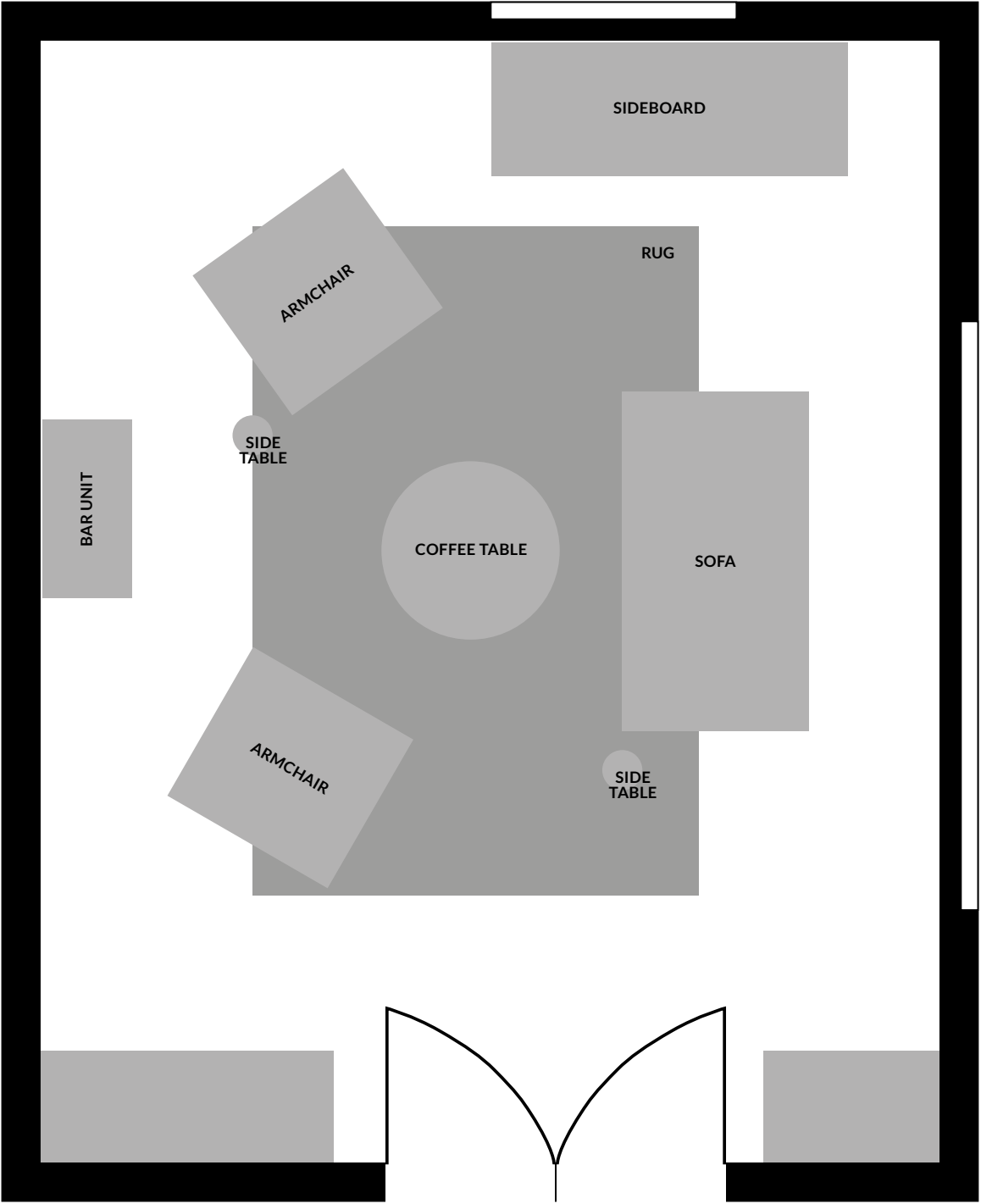

FAWN INTERIORS STUDIO
OLD DOWN COTTAGE
SWELLING HILL
ARLESFORD SO24 0DA
01962 435 035
© FAWN INTERIORS STUDIO

STAGE 2
SOURCING BOARDS

With hyperlinks to online sites



[AMTICO FLOOR](#) - TBC



[LIGHT](#) - £375



[CHAIRS X 2](#) - £798



[SOFA IN DARK TEAL](#) - £499



[COFFEE TABLE](#) - £449 - 4 WEEKS



[BAR CABINET](#) - £499 - 10-12 WEEKS

COLOURS



MATERIALS

OAK
BRASS
COPPER
VELVET
LEATHER
GLASS
CERAMIC



FAWN INTERIORS STUDIO
OLD DOWN COTTAGE
SWELLING HILL
ARLESFORD SO24 0DA
01962 435 035
© FAWN INTERIORS STUDIO



FAWN INTERIORS STUDIO
OLD DOWN COTTAGE
SWELLING HILL
ARLESFORD SO24 0DA
01962 435 035
© FAWN INTERIORS STUDIO

STAGE 2 SAMPLES

We mail all samples such as:

- fabrics for curtains, blinds, cushions and upholstery
- wooden flooring, carpets or tiles for living areas, bedrooms, kitchens and bathrooms
- ironmongery for bespoke joinery or to customise existing furniture
- painted A4 colour boards









FAWN INTERIORS STUDIO
OLD DOWN COTTAGE
SWELLING HILL
ARLESFORD SO24 0DA



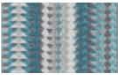

01962 435 035
© FAWN INTERIORS STUDIO

STAGE 3
GUIDES & BRIEFS

We prepare a guide/brief for each part of the project so that you can complete it with confidence. We are also happy to have a chat and answer questions from any suppliers, by phone or email.

Timeline: 1 week

  	SOFT FURNISHINGS PLAN	
	RECEPTION ROOM 1	4 x 40X40cm self-piped cushions in Jane Churchill Esino in Indigo/ Aqua https://designs.colefax.com/Design/J0043-03 Goblet curtains and waterfall roman blind (inside recess) in Jane Churchill Bassi in Teal/Emerald https://designs.colefax.com/Design/J964F-06 Curtain pole from Hallis Hudson in Black Nickel https://www.halliswebshop.com/hh_ea/esa/ItemDetails.jsp?@where.ItemID@EQ=2175R%2F120&sessionkey=9VRZ-8Q7U-VUEH-0G65-S152-XPP9-49AQ-3I28#
	KITCHEN & DINING ROOM	Waterfall roman blinds (inside recess) in Romo Feria in Cerulean https://www.romo.com/collections/prints-weaves/parada/feria/cerulean Eyelet curtains (on existing pole) in Blendworth Cosmopolitan 037 https://www.blendworth.co.uk/shop/a-z-by-design/cosmopolitan-design/cosmopolitan-037/?v=79cba1185463
   	SNUG	Triple pleat curtains and waterfall roman blind (inside recess) in Blendworth Cosmopolitan 033 https://www.blendworth.co.uk/shop/a-z-by-design/cosmopolitan-design/cosmopolitan-033/?v=79cba1185463 Curtain pole from Hallis Hudson in Black Nickel https://www.halliswebshop.com/hh_ea/esa/ItemDetails.jsp?@where.ItemID@EQ=2175R%2F120&sessionkey=9VRZ-8Q7U-VUEH-0G65-S152-XPP9-49AQ-3I28#

JOINERY PLAN	
ENTRANCE ROOM CUPBOARDS	
 	 
Image ref for storage over door, not a style ref	
BRIEF: Create two boot-room type cupboards (to store coats and bags) on either side of the double doors, with a connecting cornice/storage above the doors so that the units look like one large piece when doors are closed. Doors to have fixed plantation-style slats. Internally there should be hooks at 2 levels and two shelves - one at the top for hats and small bags, and one below for double-stacking of large bags. To be finished in Little Greene 'Pleat' and ironmongery will be supplied.	

ANY FURTHER QUESTIONS
PROJECTS@FAWNINTERIORS.CO



THANK YOU