

# LAMIART SERIES

## QUICK AND SIMPLE TO USE POUCH LAMINATOR

- Carrier-free operation
- Quality hot and cold lamination
- Colour printing foil transfer
- Lamiboard mounting up to 3mm
- Choice of machine A3, A2
- Variable temperature and speed control
- One-touch pre-set function keys
- Roller protection system
- Hot roller technology for bubble-free photo lamination



LAMIART  
320LSI

### FEATURES

- Temper proof, long-term protection
- Lamination with a wide variety of patterns and materials
- Cold lamination - Pressure Sensitive lamination
- Colour printing - terrific colours transfer onto black/white photocopies
- Soft finish lamination using Photonex patterned materials
- Single side lamination
- Image transfers with GMP transfer paper
- Mount and display photos using Lamiboard

### APPLICATIONS

- Menus
- Maps
- Posters
- Price Lists
- Leaflets
- Certificates
- Business Cards
- ID and Membership Cards

LAMIART  
470LSI



LAMIART  
320I



- In offices, restaurants, clubs, hospitals, schools and colleges, Lamiart Laminators provide a distinctively different solution for enhancing the appeal of printed documents while protecting them from damage.
- Safe and simple to use, you just slip the materials to be laminated into the ready made plastic pouch and then feed it into the laminator and in seconds you have an attractively laminated document.

## 4 SIMPLE STEPS TO LAMINATION



**STEP 1**  
Press the power switch "On" (located at the rear of the laminator).



**STEP 2**  
Press "Hot" key for hot lamination.



**STEP 3**  
Insert document into pouch laminator.

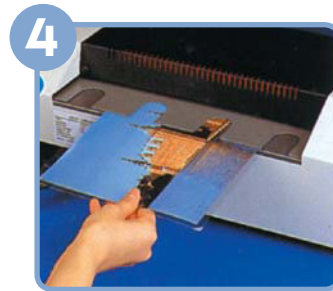

**STEP 4**  
Within seconds you have a laminated document.

Model Name	Lamiart 3201	Lamiart 320LSI	Lamiart 470LSI
Laminating Speed	1500mm / min	1500mm / min	1500mm / min
Laminating Width	320mm	320mm	470mm
Laminating Films	75mic ~ 250mic	75mic ~ 250mic	75mic ~ 250mic
Substrate Thickness	80g/m <sup>2</sup> ~ 250g/m <sup>2</sup>	80g/m <sup>2</sup> ~ 250g/m <sup>2</sup>	80g/m <sup>2</sup> ~ 250g/m <sup>2</sup>
Mounting Thickness	3mm	3mm	3mm
Power Requirements	220 ~ 240V, 50/60Hz	220 ~ 240V, 50/60Hz	220 ~ 240V, 50/60Hz
Power Consumption	1100W, 7.0A	1100W, 8.3A	1500W, 8.3A
Warm-up Time	3 minutes	3 minutes	3 minutes
Heating System	Hot roller internal infrared heater	Hot roller internal infrared heater	Hot roller internal infrared heater
Operating Temperature	160°C Max.	160°C Max.	160°C Max.
Speed Control	Knob and volume	Key Pad	Key Pad
Temperature Control	Knob and volume	Key Pad	Key Pad
Cooling System	Shading pole motor	Shading pole motor	Shading pole motor
Dimensions (WxLxH)	510 x 317 x 165mm	510 x 317 x 165mm	670 x 317 x 165mm
Type of Main Motor	DC W-Geared Motor / 36V70	DC W-Geared Motor / 36V70	DC W-Geared Motor / 36V70

GMP reserves the right to change specifications without prior notice.