

## NRS11-253

### Lima Cylindrical MR16 GU10 Luminaire

Lamp: (1) 50W MR16 GU10 120V (included)

#### PRODUCT DESCRIPTION

Line voltage cylindrical GU10 MR16 luminaire with tempered glass sleeve extending in front and back of the light source. Locking front glass protects lamp and provides easy lamp maintenance with minimal interference with original fixture aiming. Luminaire has small stem extending from body ring, allowing full aiming and 350° adjustment with a low profile.

#### SPECIFICATION

##### HOUSING

Main body constructed from one-piece 0.07" die-cast aluminum.

##### STEM

Material: 0.07" die-cast aluminum.

##### ELECTRICAL

##### WIRING

Size: 18 Gauge AWG 200°C, 300V

##### SOCKET

GU10 porcelain base with nickel plated copper contacts.

##### UNIVERSAL CONNECTOR

Construction: 0.07" die cast aluminum shell

Contacts: Copper for positive and neutral Copper contact spring on top to provide solid contact with ground conductor located on top of rail.

##### FINISHES

Brushed Nickel, Bronze, and Silver are available.

##### LABELS AND LISTINGS

UL and cUL Listed for dry location only.

**NORALIGHTING.**

Type

Project

Catalog No.

Lamp/Wattage

#### DIMENSIONS

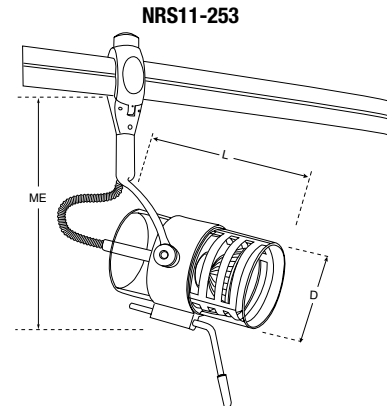

Diameter : 2-3/8"  
Length : 4-1/4"  
Max. Extension : 8-7/8"



#### Lima Cylindrical Luminaire

Catalog No.	Finish
NRS11-253	BN = Brushed Nickel BZ = Bronze S = Silver

Create a complete item number: Example: NRS11-253BN

**NORALIGHTING.**

6505 Gayhart St., Commerce, CA 90040 • Phone: 800.686.6672 • FAX: 800.500.9955 • [www.noralighting.com](http://www.noralighting.com)  
e-mail: [nora@noralighting.com](mailto:nora@noralighting.com) • Specifications subject to change without notice. © 2014